

LeeBoy[®]

Operations, Service, and Parts Manual



LEEBOY MODEL 8515E CONVEYOR PAVER

Manual No. 1017255-03

This manual applies to
Serial Number 195172
and above.

CLICK HERE TO **DOWNLOAD** THE COMPLETE MANUAL

- Thank you very much for reading the preview of the manual.
- You can download the complete manual from: www.heydownloads.com by clicking the link below



- Please note: If there is no response to CLICKING the link, please download this PDF first and then click on it.

CLICK HERE TO **DOWNLOAD** THE COMPLETE MANUAL

Spray Down	7-48
Tow Point Assembly	7-50
Hydraulic Manifold - Upper	7-52
Hydraulic Manifold - Lower	7-54
Hydraulic Oil Cooler	7-56
Generator	7-58
Hydraulic Cylinders	7-60
Dash Assembly - Controls	7-62
Dash Assembly - Mounting	7-64
Control Box Assembly (1 of 2).	7-66
Control Box Assembly (2 of 2)	7-68
Seat Assembly & Details	7-70
HD Screed Overview - Sloping and Non-Sloping	7-72
HD Screed Frame Assembly (1 of 2)	7-74
HD Screed Frame Assembly (2 of 2)	7-76
HD Screed Extension Assembly - Left	7-78
HD Screed Extension Assembly - Right.	7-80
HD Screed Slide Plate Assembly	7-82
HD Screed Pull Arm Assembly - Left	7-84
HD Screed Pull Arm Assembly - Right	7-86
HD Screed Thickness Adjuster - Standard	7-88
HD Screed Endgates.	7-90
HD Screed Vibrators and Walkboards	7-92
HD Screed Citrus Tank.	7-94
HD Screed Control Assembly	7-96
Option - HD Berm Screed Overview	7-98
Option - HD Berm Screed Ext. Assembly - Left (1 of 2).	7-100
Option - HD Berm Screed Ext. Assembly - Left (2 of 2)	7-102
Option - HD Berm Screed Ext. Assembly - Right (1 of 2).	7-104
Option - HD Berm Screed Ext. Assembly - Right (2 of 2).	7-106
Option - HD Berm Screed Remote Assembly	7-108
Option - HD 3:1 Depth Screws (1 of 2).	7-110
Option - HD 3:1 Depth Screws (2 of 2).	7-112
Option - HD Screed Heated Endgates	7-114
Option - HD Screed Heated Safety Edge Endgates.	7-116
Option - HD Miscellaneous Options	7-118

NOTICE

The safety messages that follow have NOTICE level hazards.

Any part that is found defective as a result of inspection or any part whose measured value does not satisfy the standard or limit must be replaced.

Always tighten components to the specified torque. Loose parts can cause damage to the machine or cause it to operate improperly.

Only use replacement parts approved by LeeBoy. Other replacement parts may affect warranty coverage.



Follow the guidelines of the EPA or other governmental agencies for the proper disposal of hazardous materials such as engine oil, diesel fuel, and engine coolant. Consult the local authorities or reclamation facility.

Dispose of hazardous materials in accordance with all applicable laws and regulations. Never dispose of hazardous materials by dumping them into a sewer, on the ground, or into groundwater or waterways.

Clean all accumulated dirt and debris away from the body of the paver and its components before you inspect the paver or perform preventive maintenance procedures or repairs. Operating a paver with accumulated dirt and debris will cause premature wear of paver components. Accumulated dirt and debris also hinders effective paver inspection.

Retrieve any tools or parts that may have dropped inside of the paver to avoid improper paver operation.

If any alert indicator illuminates during paver operation, stop the engine immediately. Determine the cause and repair the problem before continuing to operate the paver.

MACHINE PRECAUTIONS

Hot Material Precautions

- Wear protective gear for face, hands, feet, and body when operating the paver.
- Allow machine to cool before repairing or maintaining working components.
- If hot asphalt touches skin, flush area immediately with cold water. DO NOT apply ice to the affected area. DO NOT ATTEMPT TO REMOVE ASPHALT CEMENT with products containing solvents or ammonia. Natural separation will occur in about 48 to 72 hours. Get medical attention as soon as possible.
- DO NOT remove radiator cap, drain plugs, service grease fittings, or pressure taps while engine is hot. Add coolant to the radiator and perform other services only when the engine is stopped and fully cooled.

Hydraulic Systems Precautions

- Ensure all components are in good working condition. Replace any worn, cut, abraded, flattened or crimped hoses and metal lines.
- DO NOT attempt makeshift repairs using tape, clamps or cements. The hydraulic system operates under extremely high pressure and such repairs could cause serious injury.
- Wear proper hand and eye protection when checking for a high pressure leak. Use a piece of wood or cardboard as a back stop to isolate and identify leaks.

⚠ WARNING Hydraulic oil under pressure can cause serious personal injury. Check for oil leaks with a piece of cardboard. DO NOT expose hands to possible high-pressure oil. Turn off engine before attempting to tighten oil lines and fittings.

- Escaping pressurized hydraulic fluid has force sufficient to penetrate the skin, which could cause serious personal injury. Ensure all pressure is relieved before disconnecting line, hoses or valves.
- If injury from concentrated high pressure steam or hydraulic fluid occurs, seek medical attention immediately. Injuries resulting from hydraulic fluid penetrating the skin's surface can result in serious infections or toxic reactions.



Table 2-3. Performance Specifications

ITEM	SPECIFICATION
Travel Speed	0 - 230 feet per minute (FPM) [0 - 3.9 meters per minute (MPM)].
Paving Speed	0 - 140 FPM [0 - 2.4 MPM]
Recommended Paving RPMs	1800 RPMs
Maximum Paving Depth	6 in (152 mm)

Table 2-5. Electrical Specifications

ITEM	SPECIFICATION
Battery	12 Vdc Maintenance Free, 12 Volts
Cold Cranking Amps (CCA)	1000 CCA
Alternator	12-Volt, Negative-Ground, 60 Amps
Starter Voltage and Type	12-Volt, Negative-Ground

Table 2-6. Lubricant Specifications

ITEM	SPECIFICATION
Engine Oil	15W-40, API, CH-4, CI-4
Hydraulic Oil	All-Weather 32
Torque Hub	90 WT Gear Oil
Grease	Shell Avania EP Grease or Equivalent
Chain Lube	Chain Lube Agent

Table 2-7. Machine System Capacity Specifications

ITEM	SPECIFICATION
Engine Lubrication Oil (Refill Capacity)	15 qts (14.2 L)
Hydraulic Oil Tank	53 gal (151.4 L)
Torque Hubs	32 oz (.35 L) each
Diesel Fuel Tank	18.5 gal (70 L)
Spraydown Tank	7 gal (26 L)
Antifreeze	Glycol-Based, Extended Life; 3.6 gal (13.8 L)

Table 2-8. Hydraulic Pressures Specifications

ITEM	SPECIFICATION
Drive	3625 psi (249.9 Bar)
Conveyors	3400 psi (234 Bar)
Auger	3400 psi (234 Bar)
Track Tensioning Relief	1500 psi (103.4 Bar)
Charge Pressure	350 - 400 psi (24 - 27.6 Bar)

COMPONENTS OVERVIEW

This section describes the major components for the LeeBoy 8515E Conveyor Paver. Become familiar with these components before operating the machine.



Dual Operator Platforms

The dual operator platforms allow easy and convenient access for controls of most paver functions. The paver can be operated from the left or right side, depending upon which control panel side is active and best suited to the working conditions. Controls can also be lowered to operate as a low deck or the high deck option with an assistant standing on the screed walkboard.



Engine

The LeeBoy Model 8515E Conveyor Paver is equipped with a Kubota V3800-TIE4F, 74 HP (55.2 kW) diesel engine--a strong performer with the latest technology. The engine is accessible through several access doors, with a front service door where fuel filter components are located for easier access.

This electronically-controlled engine offers the latest in innovative emission solutions that comply with stringent regulations (EPA/CARB Tier 4 and EU Stage IIIB) for exhaust after-treatment that optimizes combustion. This Tier 4 Final fuel-efficient engine complies with emission requirements established by the U.S. Environmental Protection Agency (EPA) to reduce diesel particulate matter (DPM) and other toxins released into the air.

Advanced emission-control devices and low-sulfur fuel requirements--only Ultra-Low Sulfur Diesel (ULSD) can be used in these engines--combine with after-treatment methods such as Exhaust Gas Recirculation (EGR) and Diesel Particulate Filters (DPF).

The air cleaner removes fine particles such as dust, sand, chaff and lint from the air. As air is taken into the air cleaner assembly, the cyclone action deposits some of the fine particles in the evacuator that is mounted on the bottom of the air cleaner housing. The fuel filter removes contaminants from diesel fuel before it flows into the injection pump where it is injected into the engine combustion chamber.

The radiator mounted in front of the engine cools the engine. As coolant flows through the radiator, airflow from the engine-driven fan removes heat.

Refer to the Engine Operator's Manual accompanying your paver for additional engine information.

Track System

The paver drive system contains two heavy-duty torque hubs that propel the hydrostatically-powered, self-cleaning tracks with self-adjusting front idlers. Two-speed motors power tough planetary drives for smooth operation.

4-FUNCTION REMOTE SCREED CONTROLS

The 4-function remote screed extension control boxes feature automatic auger dials above the controller box (left control box shown).

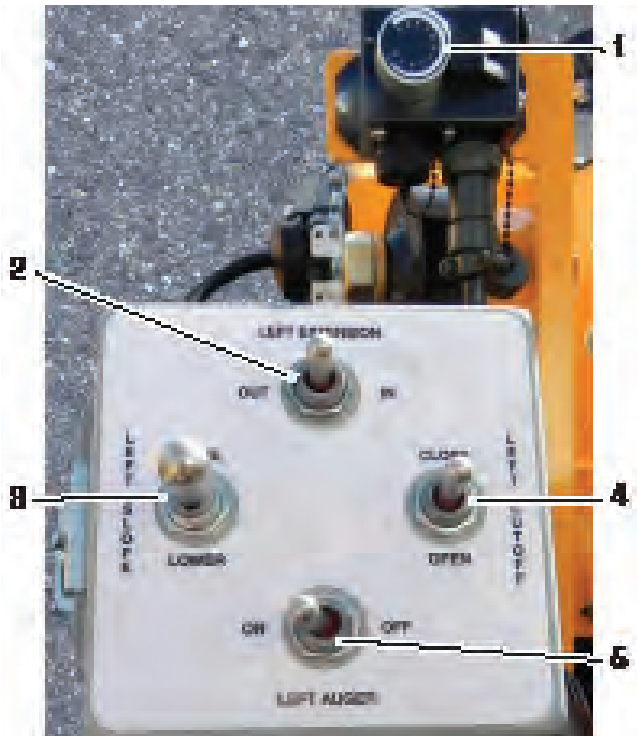

Figure 3-8. Screed Control Box (Left Box Shown)

ITEM NO.	CONTROL NAME	FUNCTION
1	Automatic Auger Dial	Controls auger height of the material in the endgate. The auger switch must be turned on to AUTO and the sonic auger sensor installed for the auger dials to function.
2	Screed Extension	Extends and retracts screed extension.
3	Slope Raise/Lower	Option: Raises and lowers the asphalt slope if equipped.
4	Under Auger Material Cut-Offs Switch	Opens and closes under auger material cut-offs.
5	Auger Switch	Turns auger on and off.

System Info

Scroll through the Menu list using the UP/DOWN soft keys, then press the select () soft key when the cursor (>) points to the desired information. **(Figure 4-11)** The screen displays the engine model, serial number, ECU Software ID, fuel rate, and the amount of time since the last active regeneration process was performed.



Figure 4-11. System Info Screen

Press the UP/DOWN soft keys to scroll to the screen with application and configuration information. **(Figure 4-12)**



Figure 4-12. Application and Configuration Information Screen

Lamp Info

This screen shows the Diesel Particulate Filter (DPF) Lamp symbols and provides a description along with cautionary information for each symbol. Use the UP/DOWN soft keys to scroll to each symbol. **(Figures 4-13 to 4-16)**



Figure 4-13. High Exhaust Temperature Due to DPF Regeneration Symbol Screen



Figure 4-14. Needs Regenerating Screen

Activate/Deactivate Operator Control Station

Only one operator control station can be activated at a time for the paver to function. While the paver is typically operated from the left side, the operator can change the active station at any time using the following procedure:

1. Place both joysticks in the NEUTRAL (center) position. **(Figure 4-38)**
2. Move the RUN/STOP switch to the STOP position on the control box not being used to deactivate:
 - The Run/Stop switch controls stopping the machine and also activating/deactivating the operator control station. When the switch is set to the STOP position, that operator control station is deactivated. When switch is set to RUN, that operator control station is activated.
 - BOTH joysticks must be in the NEUTRAL position and BOTH Run/Stop switches in the STOP position to change from one steering control box to the other.
3. Activate the control box being used by setting the Run/Stop switch to the RUN position.
4. Start the engine and allow the engine to warm a few minutes.

NOTICE If the joysticks are in the forward position and the Run/Stop switch is in the STOP position, the Plus One will disable the control box after a set period of time. This is a safety measure in the event the operator leaves the station with the control box still active. The operator must move joysticks to NEUTRAL (center) position, then toggle the Run/Stop switch from RUN to STOP and back to RUN again to regain control.

Steering and Speed Control

Use the dual joysticks for steering and speed control. **(Figure 4-38)** It is important to move the joysticks SLOWLY. Lift up on the joystick(s) and move either FORWARD or REVERSE. The joystick collar will lock back into place in the NEUTRAL position. The RUN/STOP switch applies parking brake when set to the STOP position.



Figure 4-38. Steering and Speed Control Box

- 1 - Left and Right Joysticks
- 2 - Joystick Collar
- 3 - RUN/STOP Switch

NOTE: To slow the paver, move joysticks closer to the neutral position.

NOTE: To stop the paver, pull joysticks back to the neutral position.

CAUTION Be aware of the terrain and driving conditions. Adjust speed accordingly.

- To drive the paver forward, lift up on the joysticks and push forward to reach the desired speed.
- To move in reverse, lift up on the joysticks and move backwards to reach desired speed.
- Return joysticks to the neutral position to stop paver.
- To steer the unit to the left, SLOWLY push the right joystick farther forward than the left joystick. The farther the joystick is pushed, the more the paver turns. Slow and easy adjustments are required for safe operation.

- For increased positive crown push down on adjuster.
 - For increased negative crown pull up on adjuster.
3. Use the gauge at the center of the screed above the standing platform. If the needle is above the zero, you will have positive crown. If the needle is below the zero, you will have negative crown.
 4. To get exact crown or valley, measure the distance between a flat level surface to the center bottom portion of screed. Make adjustments with crown and valley control.
 - Positive crown is when the middle of the mat is raised to permit water to drain to each side. **(Figure 4-58)**
 - Negative crown is the lower in the center of the screed plate, often used in an alley where drainage is necessary. **(Figure 4-58)**

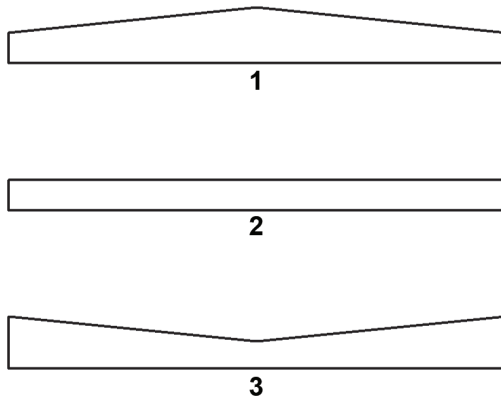

Figure 4-58. Crown Settings

- 1 - Positive (+)
- 2 - Zero (0)
- 3 - Negative (-)

NOTE: Crown may be placed in the leading edge and/or the trailing edge of the screed plate. Crown in the leading edge aids material flow under the screed plate only. Trailing edge crown puts a crown in the mat.

Example: The trailing edge crown is 0 and the leading edge crown is 1/8 inch. There will not be any crown in the mat, but the material flow under the screed plate will be improved.

Mat Texture Adjustment

There are three adjusters in each screed extension, however the adjusters at each end are preset by the dealer and do not need adjustment.

Adjust the mat texture using the Angle-of-Attack (AOA) adjustment screw in the center to produce a smoother or coarser mat texture. **(Figure 4-59)**

- The screed extension should be hot before making any adjustments.
- Spray the bottom of the screed with cleaning solvent BEFORE heating the screed.

CAUTION NEVER spray cleaning solvent or release agent on or near a hot screed heating or near open flame. Cleaning solvent and release agents are flammable and could cause serious personal injury.

NOTE: Do not allow release agent chemicals to run onto the ground.

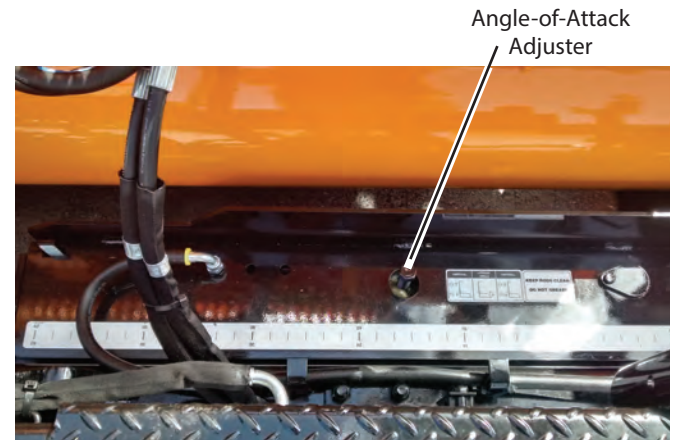

Figure 4-59. AOA Adjustment

To make the AOA adjustment:

1. Spray down and heat the screed extension if needed.
2. Turn the AOA adjuster in the direction for desired result:
 - Turning the AOA adjuster counterclockwise will increase the pressure on the back of the extension, which gives a smoother, slicker finish.
 - Turning the adjusters clockwise will decrease the pressure on the back of the extension, resulting in a coarser finish.

NOTE: Too much pressure on the back of the screed extension will take the weight off the screed wear plate and cause poor material compacting, resulting in a poor finish.

MAINTENANCE SCHEDULE

Before performing any maintenance procedures on the LeeBoy Model 8515E Conveyor Paver, review the safety information in **Section 1**.

⚠ WARNING Always use the appropriate and correct sized tools for the task at hand to prevent damage or possible injury.

⚠ WARNING Always wear heat-resistant gloves when handling hot components.

Following the maintenance schedules and procedures

will maintain the paver in top operating condition and provide years of trouble-free operation. Refer to the Engine Operator's Manual accompanying your paver for more detailed engine service information.

When performing any routine maintenance, always include the previous routine maintenance hours in the higher hourly schedule.

NOTICE Changing oil and cleaning the paver should only be done in a designated area where the oil and chemicals can be contained. These by-products should be discarded in accordance with environmental regulations.

Table 5-1. Periodic Maintenance Schedule

SYSTEM	ITEM	Every 10 Hours Daily	Every 50 Hours Weekly	Every 100 Hours Monthly	Every 250 Hours Quarterly	Every 500 Hours Semi-Annually	Every 1000 Hours Annually
Paver	Lubricate paver.	X					
Engine	Check oil level.	X					
	Check coolant level.	X					
	Replace coolant.					X	
	Check air filter.		X				
	Change air filters.				X		
	Replace fuel filter.				X		
	Change oil and oil filter. (Initial 50 Hours)				X		
	Adjust main engine belt.				X		
	Replace main engine belt.					X	
Hydraulic	Check hydraulic oil level.	X					
	Change hydraulic oil.						X
	Change hydraulic filter.				X		
	Check torque hub oil.		X				
	Change torque hub oil.					X	
	Drain hydraulic tank. Replace strainer.						X
Mechanical	Adjust conveyor drive chains.			X			
	Adjust conveyor flight chains.			X			
	Adjust auger chains.			X			
	Adjust screed extension top guide.			X			

Check Engine Lubrication Oil

The engine lubrication oil must be kept at a level above the ADD mark, but not above the FULL mark, on the engine lubrication oil dipstick. **(Figure 5-14)** Access the engine through the front engine access panel in the paver hopper.

WARNING DO NOT check the oil while the engine running. Hot oil can spew and cause serious personal injury.

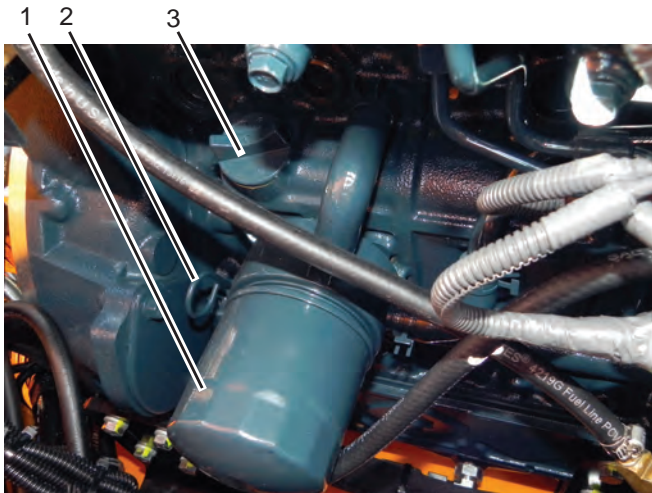

Figure 5-14. Engine Oil Dipstick and Oil Filter

- 1 - Oil Filter
- 2 - Oil Dipstick
- 3 - Oil Fill Cap

To check the engine lubrication oil level:

1. Park the machine on a level surface and turn off the engine.
2. Wait five minutes to allow the oil to return to the oil pan so you can obtain an accurate measurement of the engine oil level.
3. Clean the area around the engine oil dipstick before removing it from the engine.
4. Remove the dipstick from the engine and checking the oil level. The oil level should be above the ADD mark--but not above the FULL mark--on the dipstick.
5. Add oil if needed.

Change Engine Oil and Filter

The engine lubrication oil and oil filter must be changed at the same time. **(Figure 5-14)**

To change the engine lubrication oil:

1. Park the paver on a level surface and turn off the engine.

WARNING Change the engine lubrication oil while the engine is WARM, not hot. Hot oil can cause serious personal injury.

2. If needed, wait until the engine lubrication oil has cooled a little. Oil should be warm, not hot.
3. Locate oil drain hose on right side of the paver.
4. Place a container large enough to hold 15 quarts (14.2 liters) of oil underneath the drain hose.
5. Remove cap on end of the hose and drain all engine oil into the container.
6. Reinstall cap back onto the hose and reinsert hose back into place.
7. Fill the engine with 15 quarts (14.2 liters) of oil at the oil fill cap.
8. Check oil level using the oil dipstick.
9. Dispose of used oil in accordance with local and federal environmental laws.

NOTICE DO NOT change the engine lubrication oil filter while the engine is running. Serious engine damage will occur.

Use the following procedures to change the oil filter:

1. Wipe the area around the oil filter and its mounting base with a clean cloth.
2. Place the empty container under the filter element.
3. Use a filter removal wrench to remove the filter, turning counterclockwise.
4. Drain and discard the oil filter in accordance with Step 9 above, including the rubber gasket.
5. Wipe inside the oil filter head using a clean, lint-free cloth.
6. Rub a little oil on the rubber gasket area of the new filter element.
7. Fill the new filter with fresh oil.
8. Install the new filter element onto the filter head. Carefully tighten the filter (by hand only).

To correctly apply dielectric grease:

- Apply a thin, visible, uniform coat using **ONLY** high-quality dielectric grease (Dow Corning 4 or equivalent) across the **MALE** connector.
 - Coating too thin may not fill the gaps between pins.
 - Coating too thick may prevent proper connection or force pins or seals out.
- Plug in the male connector.

CAUTION DO NOT force connector to lock if too much grease has been applied.

CAUTION Excessive grease application does not allow a proper connection by preventing the plugs from locking into place, and can cause damage to the connector seals.



Figure 5-28. Incorrect Application of Dielectric Grease

REPLACEMENT PROCEDURES

Front Idler

Follow this procedure for replacing the front idler (**Figure 5-29**):

1. Raise conveyor and insert safety prop. (**Page 5-6**)
2. Locate track tensions manifold and back the relief cartridge out of the aluminum block about three turns until you hear the tension pressure release.

NOTE: Perform this additional step for poly or steel tracks only: Rotate the track so the master pin is at the rear bottom of the front idler and back up the paver until the track clears the front idler.

3. Jack up the paver at least two feet (61 cm) off the ground for enough clearance under the undercarriage to perform this procedure.

DANGER Crush hazard! Always use safety blocks in addition to jack when working under the paver to prevent serious injury or even death.

4. Remove the clip pin from the cylinder rod and idler bracket. Idler will slide out.
5. Remove the idler bracket and bolt to the new idler.
6. Install idler, ensuring cylinder and clip pin are aligned properly.
7. Lower sprocket back down toward the track chain, ensuring the sprocket is about one (1) inch (2.54 cm) from the chain.

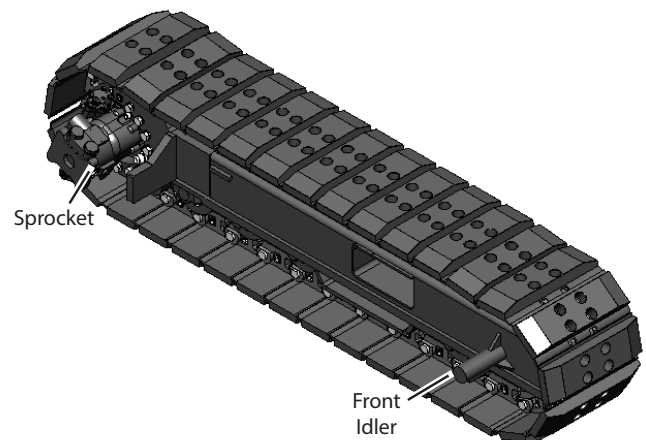

Figure 5-29. Front Idler

5

Conveyor Switch Replacement

If you need to replace the conveyor switches, follow these instructions, using the color codes for wiring (**Figure 5-44**) to ensure the conveyor switches on the conveyor flap are wired correctly:

1. Raise the conveyor flap 6-1/2 to 7 inches (16.5 to 17.8 cm) from the bottom of the tank mount support.
2. With the switch installed and the conveyor paddle hanging down:
 - Using a multimeter, measure the ohms across the black and white wires.
 - Using a multimeter, measure the ohms across the red and green wires.

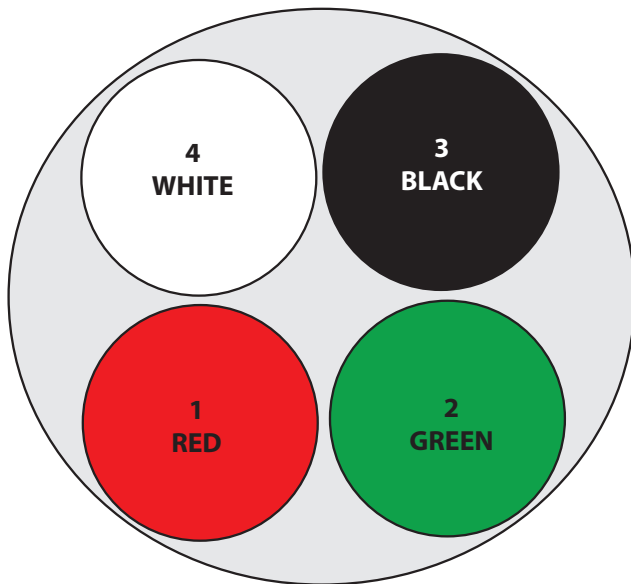

Figure 5-44. Conveyor Switch Wiring

3. Wire the switch using the wires that show continuity.
4. Repeat Steps 2 - 3 for the second switch.

NOTE: The switches are sealed and potted, therefore, they are not serviceable.

Replace Radiator Hoses

Radiator hoses should be replaced if worn or frayed. (See **Section 7, Illustrated Parts List (IPL)** for hose and component replacement part numbers.) Access the radiator from the top access panel.

⚠ WARNING This procedure should only be performed when the machine is not running.

⚠ WARNING DO NOT remove the radiator cap while the engine is still hot. The radiator is under pressure serious injury can occur if removed while hot.

1. Turn off ignition, remove key, and allow the engine to cool down.
2. Carefully remove the radiator surge tank cap. (**Figure 5-45**)

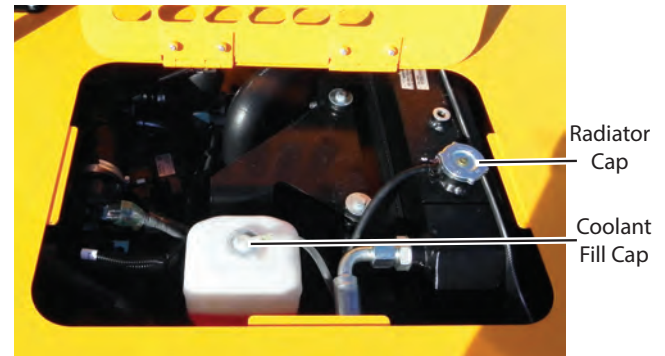

Figure 5-45. Radiator and Coolant Fluid Caps

3. Remove plug under the radiator tank and drain radiator fluid into a container large enough to hold 5.5 gallons (20.8 liters).
4. Remove the upper and lower hoses by loosening the hose clamps on each.
5. Disconnect hoses and inspect for damage.
 - If clamps are not damaged, retain for reinstallation (or replace if damaged).
6. Install new hoses and reconnect with hose clamps.

5

PV480 DIAGNOSTIC TROUBLE CODE (DTC) CHART

LEGEND

SPN: Suspect Parameter Number

EGR: Exhaust Gas Recirculation

NE-G: Negative Ground

SCV: Selective Control Valve

DC: Direct Current

PLV: Pressure Limiting Valve

DDC: Direct Digital Control

ETC: Electronic Throttle Control

MPROP: Manifold Pressure Rail Operating Pressure

EEPROM: Electrically Erasable Programmable Read-Only Memory

DPF: Diesel Particulate Filter

ECU: Engine Control Unit

NE: Neutral

MAF: Mass Air Flow

IC: Integrated Circuit

CAN: Controller Area Network

SW: Switch

CCVS: Current Controlled Voltage Source

FMI: Failure Mode Identifier

CPU: Central Processing Unit

G: Ground

PM: Particulate Matter

EBC: Electronic Brake Control

CM: Control Module

TSC: Torque Speed Control

SPN	FMI	DTC	SYMPTOM/CAUSE	RECOVERY FROM ERROR
29	3	Accelerator position sensor 2: High	Battery short circuit out of sensor/harness. Voltage of accelerator position sensor 2 is 4.8V or less.	Forced idle. (Accelerator = 0%) Diagnostic counter = zero
29	4	Accelerator position sensor 2: Low	Ground short circuit or open circuit of sensor/harness. Voltage of accelerator position sensor 2 is 0.3V or less.	Forced idle. (Accelerator = 0%) Diagnostic counter = zero
91	2	Accelerator position sensor correlation error	Deviation from designed correlation in two sensors. Voltage of accelerator position sensor 1 is 4.8V or less.	Forced idle. (Accelerator = 0%) Diagnostic counter = zero
91	3	Accelerator position sensor 1: High	Battery short circuit or open circuit of sensor/harness. Voltage of accelerator position sensor 1 is 4.8V or less.	Forced idle. (Accelerator = 0%) Diagnostic counter = zero
91	4	Accelerator position sensor 1: Low	Ground short circuit or open circuit of sensor/harness. Voltage of accelerator position sensor 1 is 0.3 or less.	Forced idle. (Accelerator = 0%) Diagnostic counter = zero
100	1	Oil pressure error.	Engine oil pressure.	Key switch turn OFF.
102	3	Boost pressure sensor: High	Failure of sensor. Voltage of boost pressure sensor is 4.9V or above.	Key switch turn OFF. (Default value is set in consideration with high altitude usage. Engine power drops.)
102	4	Boost pressure sensor: Low	Failure of sensor. Voltage of boost pressure sensor is 0.2V or below.	Key switch turn OFF. (Default value is set in consideration with high altitude usage. Engine power drops.)
108	3	Barometric pressure sensor error: High	Barometric voltage 4.4V or more.	Diagnostic counter = zero (Default value is set in consideration with high altitude usage. Engine power drops.)



Section 6

SCHEMATICS

	Page
Schematics	6-1
Main Harness - 4 Function Screed Control (1 of 8)	6-3
Main Harness - 4 Function Screed Control (2 of 8)	6-5
Main Harness - 4 Function Screed Control (3 of 8)	6-7
Main Harness - 4 Function Screed Control (4 of 8)	6-9
Main Harness - 4 Function Screed Control (5 of 8)	6-11
Main Harness - 4 Function Screed Control (6 of 8)	6-13
Main Harness - 4 Function Screed Control (7 of 8)	6-15
Main Harness - 4 Function Screed Control (8 of 8)	6-17
Main Harness - 9 Function Screed Control (1 of 8)	6-19
Main Harness - 9 Function Screed Control (2 of 8)	6-21
Main Harness - 9 Function Screed Control (3 of 8)	6-23
Main Harness - 9 Function Screed Control (4 of 8)	6-25
Main Harness - 9 Function Screed Control (5 of 8)	6-27
Main Harness - 4 Function Screed Control (6 of 8)	6-29
Main Harness - 9 Function Screed Control (7 of 8)	6-31
Main Harness - 9 Function Screed Control (8 of 8)	6-33
Control Box Assembly - 4 Function Screed Control (1 of 3)	6-35
Control Box Assembly - 4 Function Screed Control (2 of 3)	6-37
Control Box Assembly - 4 Function Screed Control (3 of 3)	6-39
Control Box Assembly - 9 Function Screed Control (1 of 3)	6-41
Control Box Assembly - 9 Function Screed Control (2 of 3)	6-43
Control Box Assembly - 9 Function Screed Control (3 of 3)	6-45
C4 Dash to Pedestal Jumper Harness	6-47
C3 Dash to Pedestal Jumper Harness	6-49



MAIN HARNESS - 4 FUNCTION SCREED CONTROL (5 OF 8)

Schematic for Part # 1016579

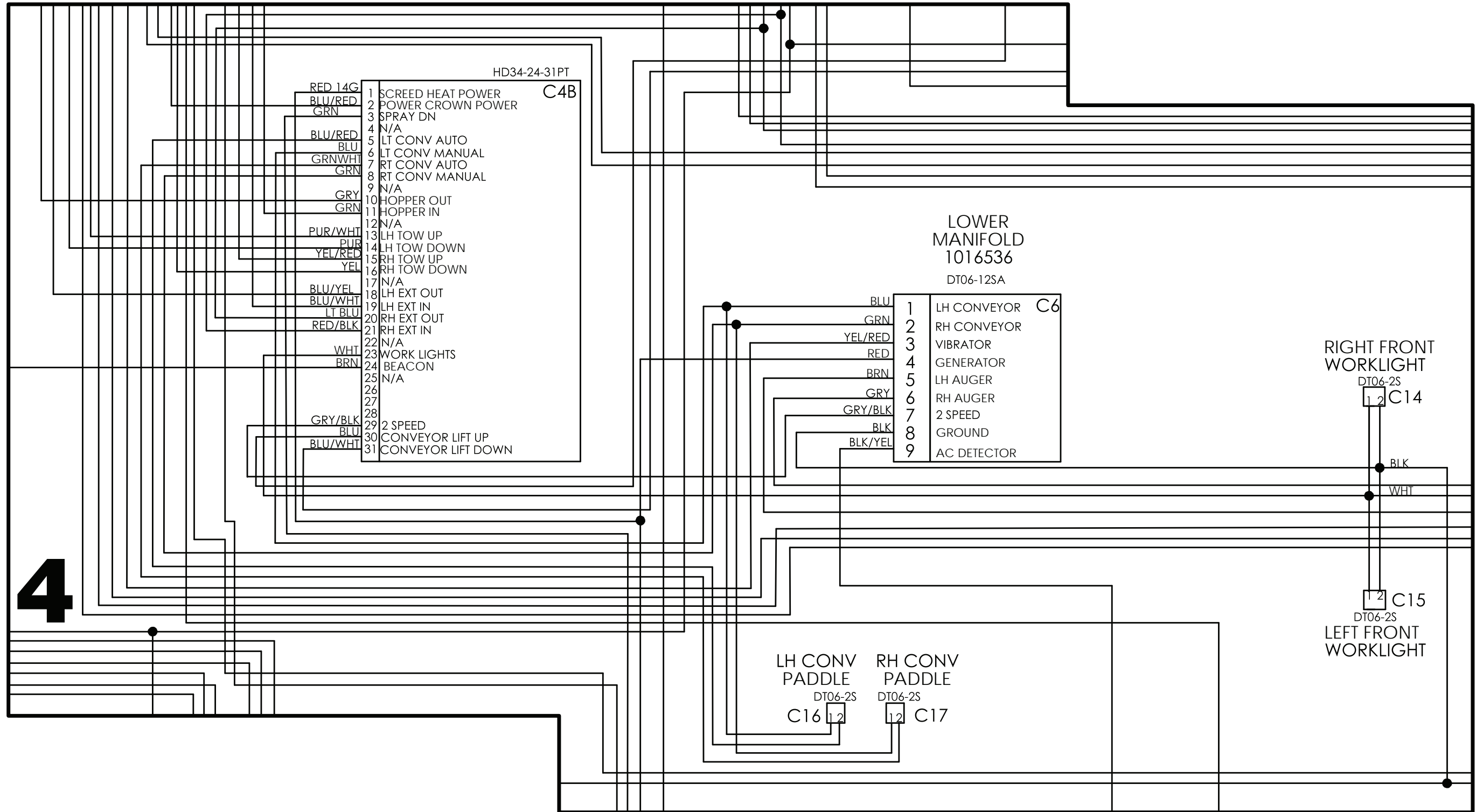
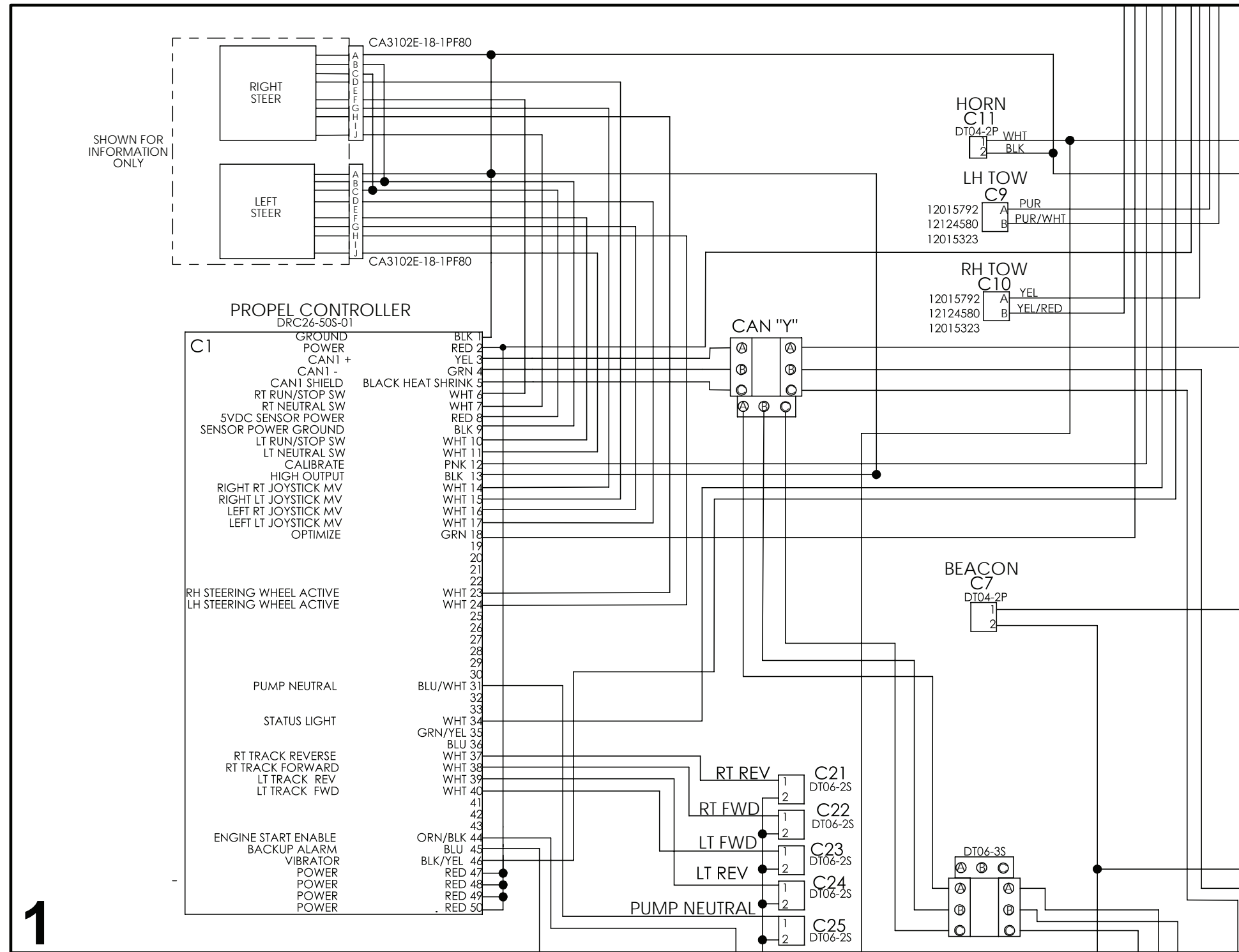

Figure 6-5. Main Harness - 4 Function Screed Control (5 of 8)

MAIN HARNESS - 9 FUNCTION SCREED CONTROL (2 OF 8)

Schematic for Part # 1017840



1

Figure 6-10. Main Harness - 9 Function Screed Control (2 of 8)

MAIN HARNESS - 9 FUNCTION SCREED CONTROL (7 OF 8)

Schematic for Part # 1017840

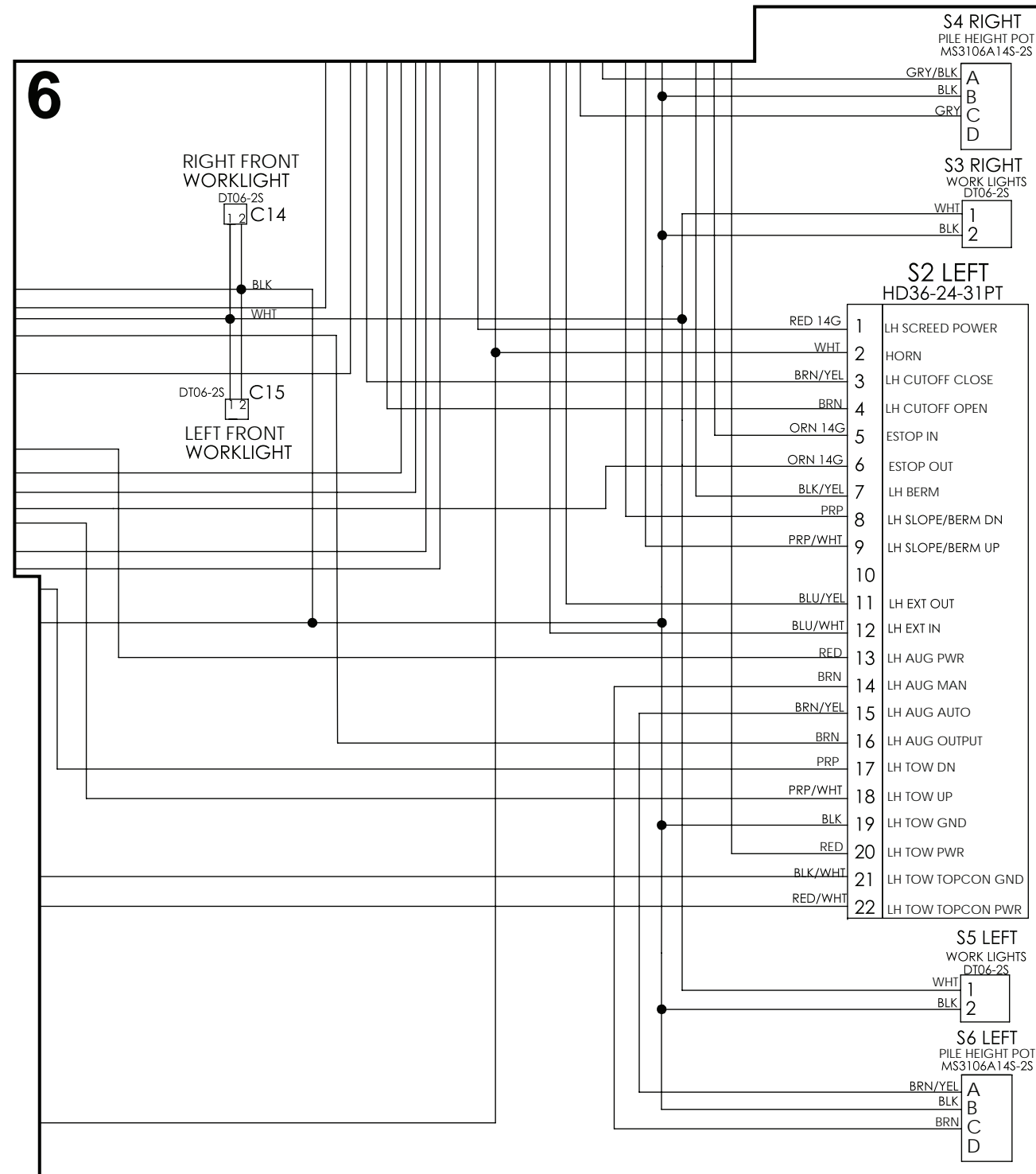
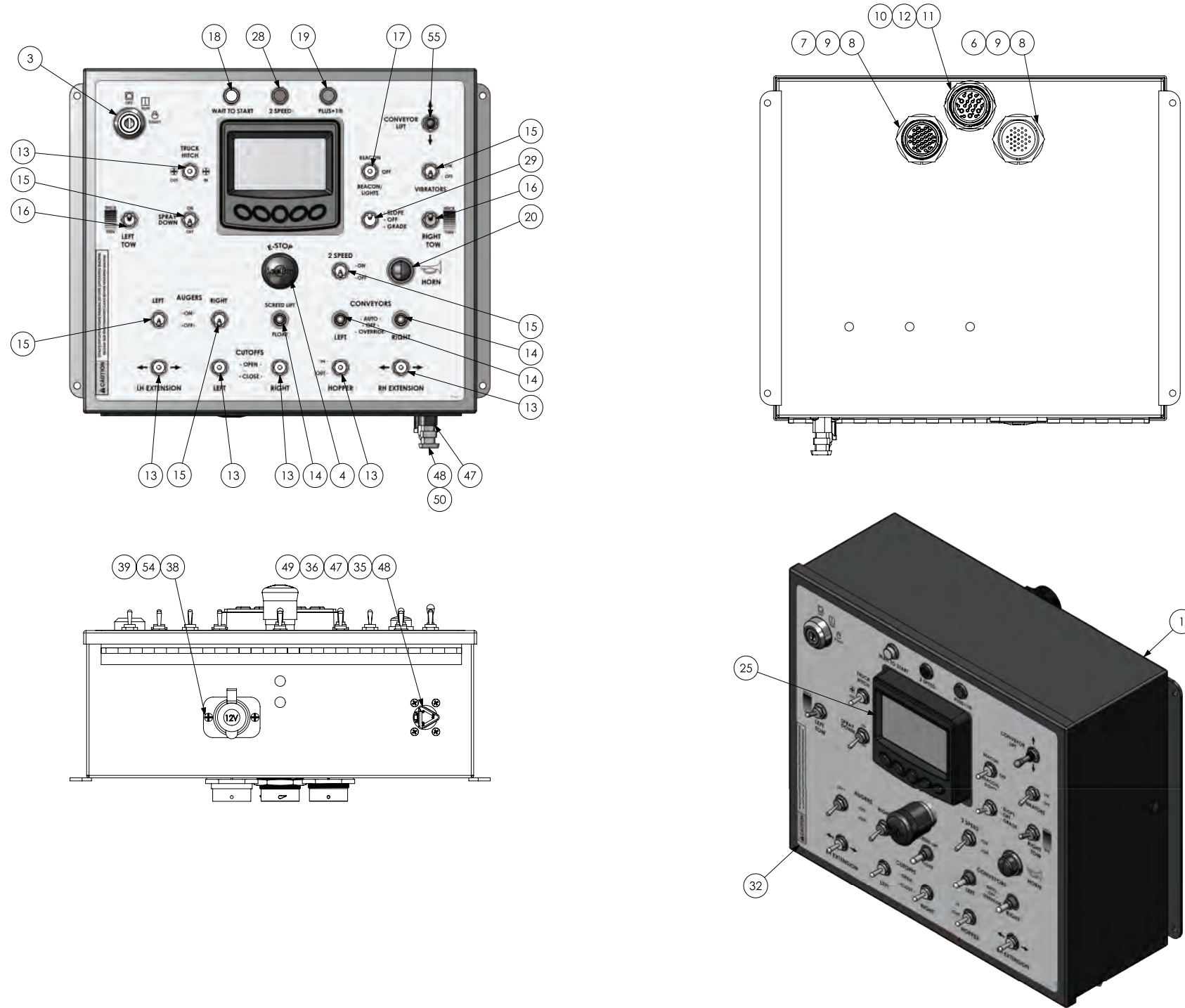

Figure 6-15. Main Harness - 9 Function Screed Control (7 of 8)

CONTROL BOX ASSEMBLY - 9 FUNCTION SCREED CONTROL (1 OF 3)

Schematic for Part # 1018700



ITEM NO.	PART NUMBER	QTY	DESCRIPTION
1	1017810	1	ENCLOSURE, CONTROL BOX, 8520, 8515E, 6150/150D
2	1007228-03	1	PANEL, WITH NOTCH, 8616
3	39146-14	1	SWITCH,IGN,W/HEAT ST
4	1010672	1	SWITCH,EMER STOP, 1-NC
5	1010692	1	CONTACT BLOCK, 1-NC, EATON
6	981916	1	CONN,31-PIN,RECPT,HD34-24-31, DEUTSCH
7	1015381	1	CONNECTOR, 31 PIN, HD34-24-31ST
8	981916-02	2	CONN,LOCK WASHER,24 SHELL
9	981916-01	2	CONN,NUT,24 SHELL
10	1014909	1	RECEPTACLE, 19 PIN, DEUTSCH HDP20 SERIES
11	1011855	1	CONNECTOR, WASHER, DEUTSCH HDP20 SERIES
12	1011854	1	CONNECTOR, NUT, DEUTSCH HDP20 SERIES
13	851392	6	SWITCH,TOGGLE,3-POS,SPDT,MOM
14	900030	3	SWITCH,TOGGLE,AUTO CONVEYOR *
15	851391	5	SWITCH,TOGGLE,SPST,2-POS
16	37521	2	SWITCH,TOGGLE,3-POS, 2 POL, MOM
17	851090613	2	SWITCH,TOGGLE,SPDT,3-POS
18	1010500	1	LIGHT,INDICATOR, WHITE
19	31985	1	LIGHT,GREEN,DASH,.50 HOLE
20	982249	1	SWITCH,PUSH BUTTIN
21	36086	3	BRACKET,RELAY MOUNT
22	36085	3	RELAY,12VDC,SPDT,40 AMP,5 PIN
23	20934592	1	RELAY,75 AMP,SPST
24	986546	1	CIRCUIT BREAKER,10A
25	1016158	1	DISPLAY, PV480, V3874 T4F
26	1016260	1	BRACKET, MOUNT, TOGGLE SWITCH
27	1016261	1	DECAL, OPER, CALIBRATE
28	31986	1	LIGHT,BLUE,DASH,.50 HOLE
29	851390	1	SWITCH,TOGGLE,DPDT,3-POS
30	1017351	1	DECAL, OPER, RELAY DIAGRAM 8515E/8520/150D/6150
31	1017345	1	DECAL, OPER, FUSE DIAGRAM 8515E/8520
32	1017811	1	DECAL, OPER, CONTROL BOX, 8520/8515E
33	1013122	1	CONNECTOR, 35 POS, AMP SEAL PLUG, BLACK
34	685060	1	FUSE BLOCK,18 GANG,ATC
35	122-#8-32-8F	4	PHMS, CROSS, #8-32 X 0.5, FT
36	215-#8-32	4	NUT,HEX,MACH,LW,#8-32
37	122-#8-32-6F	6	PHMS, CROSS, #8-32 X 0.375, FT
38	123-#10-24-8F	2	FHMS, CROSS, #10-24 X 0.5, FT
39	215-#10-24	2	NUT,HEX,MACH,LW,#10-24
40	303-#8	2	WASHER, LOCK, EXT TOOTH, #8
41	122-#8-32-16F	4	PHMS, CROSS, #8-32 X 1, FT
42	36342	3	FUSE,20 AMP,ATC
43	36340	11	FUSE,10 AMP,ATC
44	36746	1	FUSE,5 AMP,ATC
45	37303	1	FUSE,25 AMP,ATC
46	36341	2	FUSE,15 AMP,ATC
47	1010657	1	CONNECTOR, 03-PIN, PANEL MOUNT, DEUTSCH, DT04-3P
48	989179	1	CONNECTOR, 03-PIN, PLUG, W/120 OHM
49	982456	3	PIN, DEUTSCH, 14-16AWG
50	983211	1	CONNECTOR, WEDGELock, DEUTSCH, W3P
51	989178	1	CONNECTOR,03-PIN,SOCKET,Y,DEUTSCH
52	983210	2	CONNECTOR,03-PIN,WEDGE,PLUG, DEUTSCH
53	1000649	2	CONNECTOR,03-PIN,SOCKET,DT06-3S-EP11
54	1011147	1	LIGHTER, CIGARETTE
55	851393	1	SWITCH,TOGGLE,3-POS,SPDT,MOM LK
56	35044	2	DIODE, 3 AMP, PLASTIC, 1N5402

Figure 6-20. Control Box Assembly - 9 Function Screed Control (1 of 3)

SCREED CONTROL BOX ASSEMBLY, 4 FUNCTION - LEFT

Schematic for Part # 1016618

ITEM NO.	PART NUMBER	QTY	DESCRIPTION
1	1016101-01	1	ENCLOSURE, CONTROL BOX, SCREED, 4 SWITCH, RH
2	1016248	1	DECAL, SCREED CONTROL BOX, RH
3	851391	1	SWITCH, TOGGLE, SPST, 2-POS
4	851392	2	SWITCH, TOGGLE, 3-POS, SPDT, MOM
5	851393	1	SWITCH, TOGGLE, 3-POS, SPDT, MOM LK
6	3400DI	1	WATER TIGHT CONN, 3/4 X 3/4 MPT

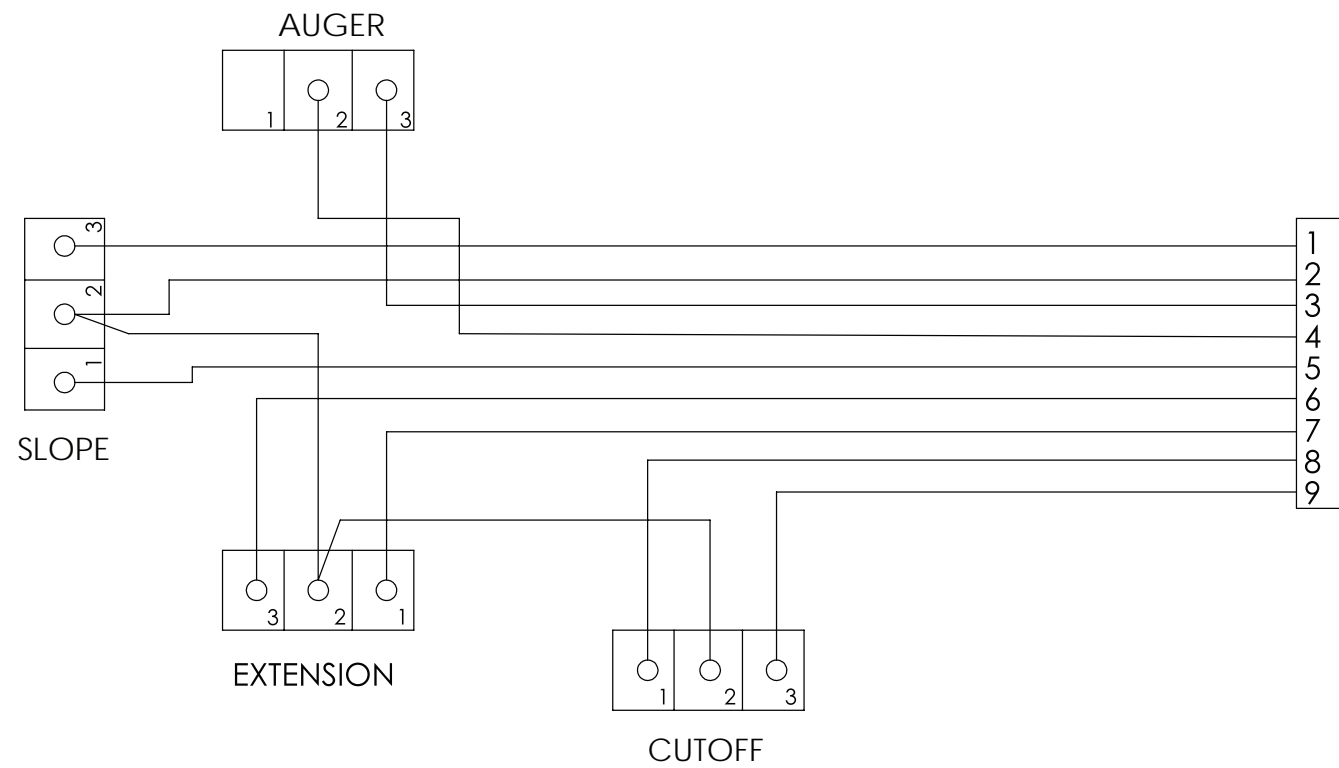

DT04-12P		
1	WHT/BLK	SLOPE RAISE
2	RED	POWER
3	GRN	AUGER ON
4	WHT	AUGER POWER
5	ORG	SLOPE LOWER
6	BLU	EXT IN
7	BLK	EXT OUT
8	PRP	CUTOFF CLOSE
9	BRN	CUTOFF OPEN

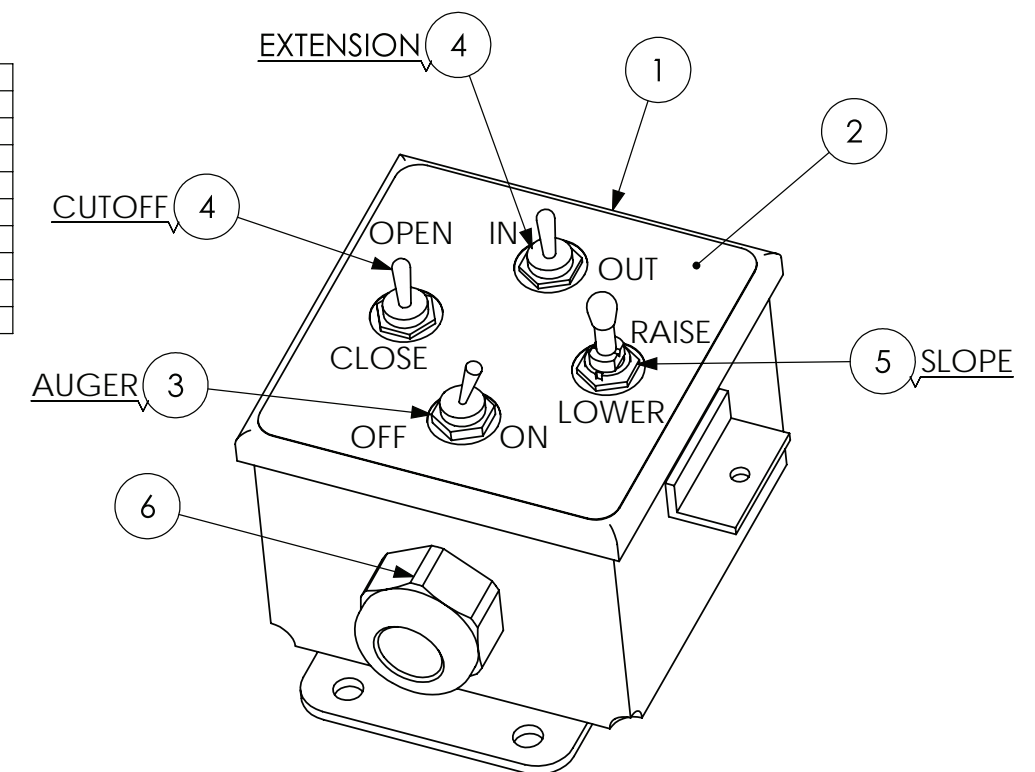

Figure 6-25. Screed Control Box Assembly, 4 Function - Left

SCREED HEAT CONTROL BOX ASSEMBLY (2 OF 2)

Schematic for Part # 1016891

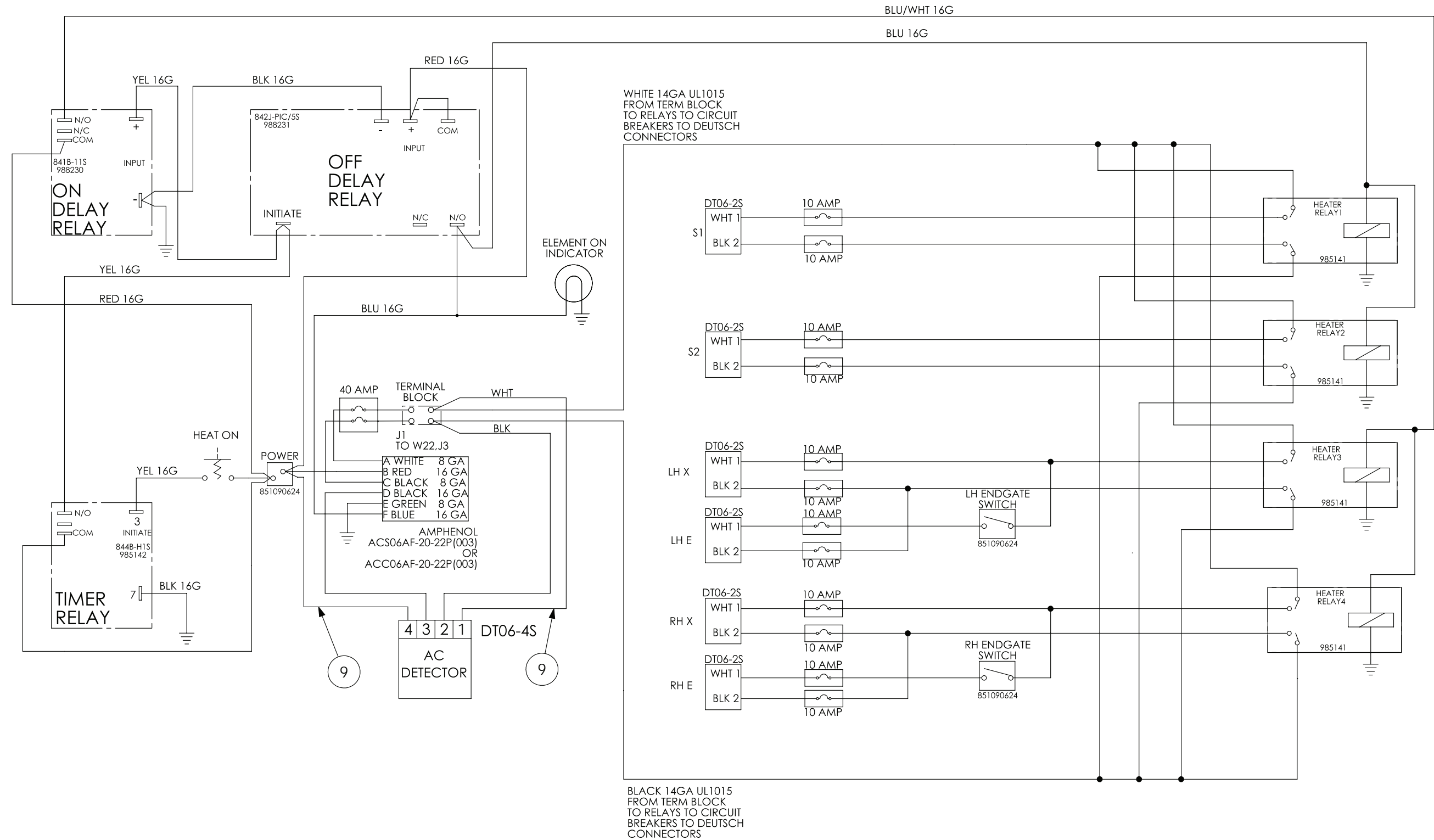
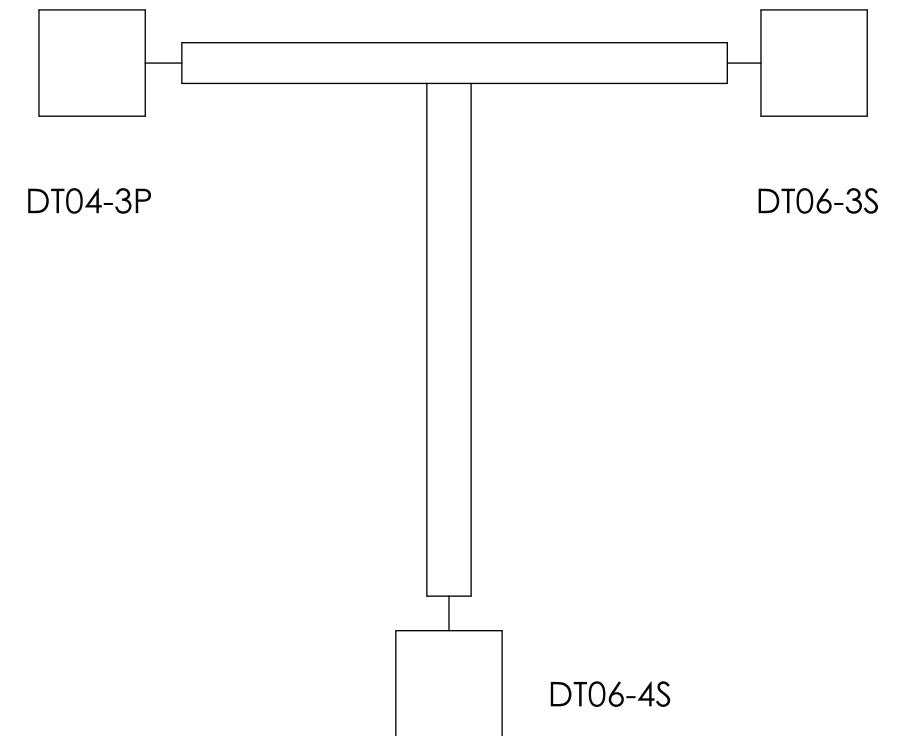
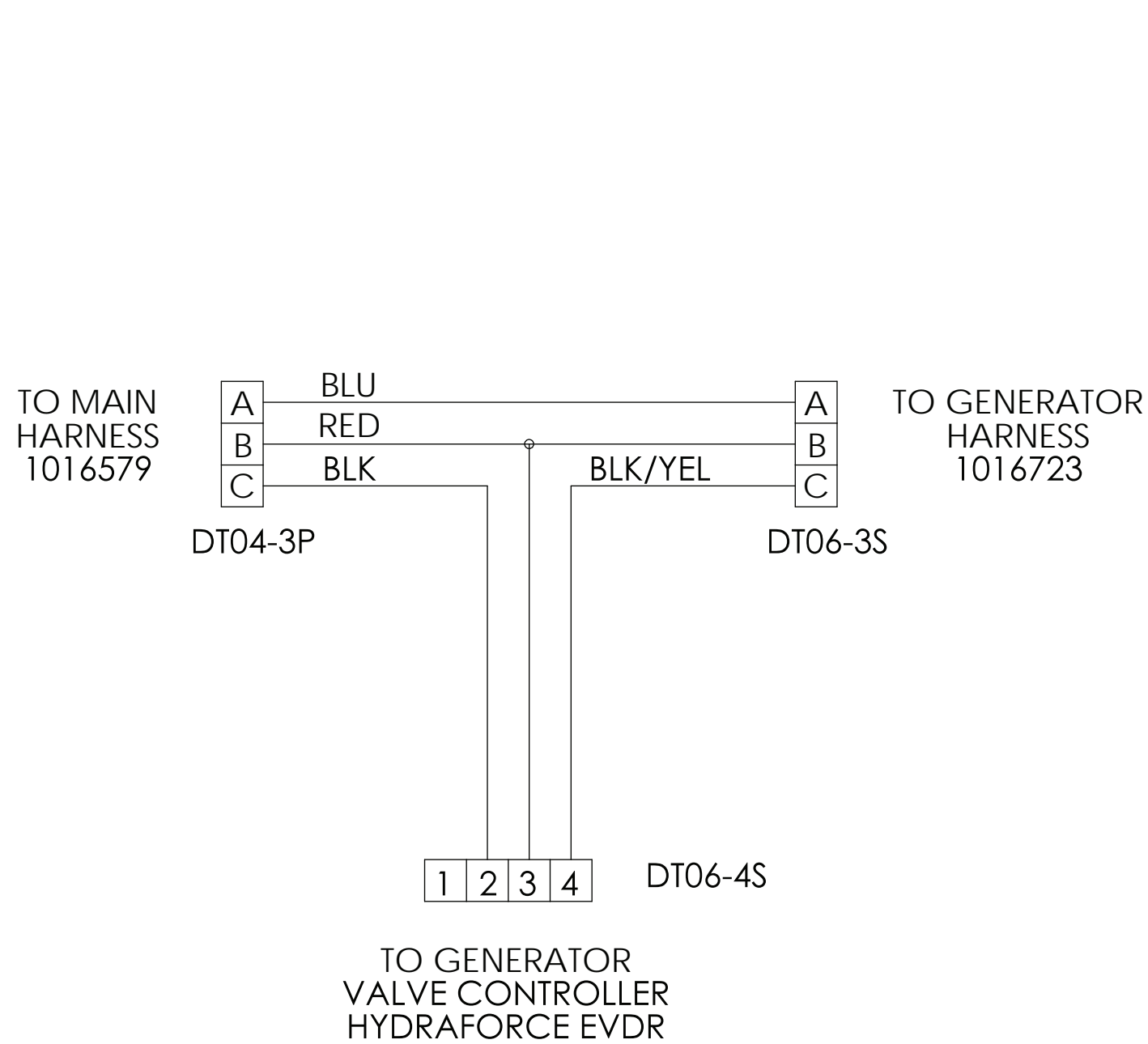

Figure 6-30. Screed Heat Control Box Assembly (2 of 2)

GENERATOR VALVE ADAPTER HARNESS

Schematic for Part # 1017192



BILL OF MATERIALS			
ITEM	LB PART NUMBER	QTY	DESCRIPTION
	35150-5	3 FT	WIRE, BLACK, 18AWG TXL
	35150-1	4 FT	WIRE, RED, 18AWG, TXL
	35150-16	3 FT	WIRE, BLACK/YELLOW, 18 AWG, TXL
	35150-3	0.5 FT	WIRE, BLUE, 18AWG, TXL
	983200	1	CONN,3-PIN SOCKET,DT04-3P
	983211	1	CONNECTOR, WEDGELOCK, DEUTSCH, W3P
	983201	1	CONN,03-PIN,PLUG,DT06-3S DEUTSCH
	983210	1	CONNECTOR, 03-PIN, WEDGE, PLUG, DEUTSCH
	983203	1	CONN,04-PIN,PLUG,DT06-4S DEUTSCH
	983212	1	CONN,WEDGE,PLUG,4S,DEUTSCH
	982448	6	TERMINAL,SOCKET,DEUTSCH,14-16
	982456	3	PIN, DEUTSCH, 14-16AWG
	73192-02	1	SEAL PLUG, DEUTSCH, WHITE, SIZE 16-12

Figure 6-35. Generator Valve Adapter Harness

ELECTRONIC STEERING CORD

Schematic for Part # 851548-04

ITEM NO.	PART NUMBER	QTY	DESCRIPTION
1	CS3106A-18-1S-472	2	AMPHENOL CONNECTOR

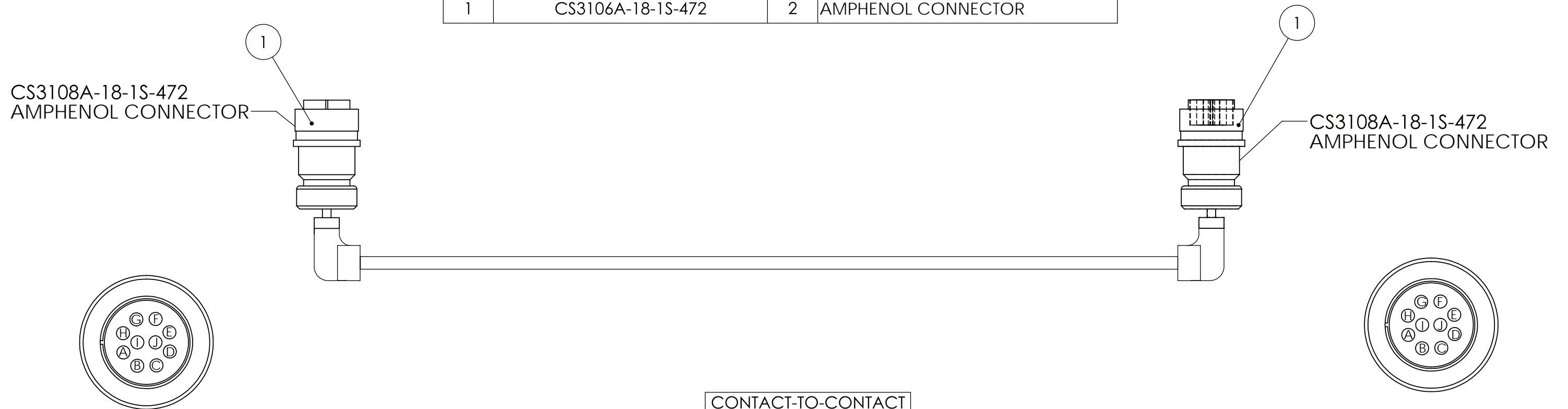

CONTACT-TO-CONTACT	
A	A
B	B
C	C
D	D
E	E
F	F
G	G
H	H
I	I
J	J

Figure 6-40. Electronic Steering Cord

CLICK HERE TO **DOWNLOAD** THE COMPLETE MANUAL

- Thank you very much for reading the preview of the manual.
- You can download the complete manual from: www.heydownloads.com by clicking the link below



- Please note: If there is no response to CLICKING the link, please download this PDF first and then click on it.

CLICK HERE TO **DOWNLOAD** THE COMPLETE MANUAL

HYDRAULIC SCHEMATIC (4 OF 5)

Schematic for Part # 1016855

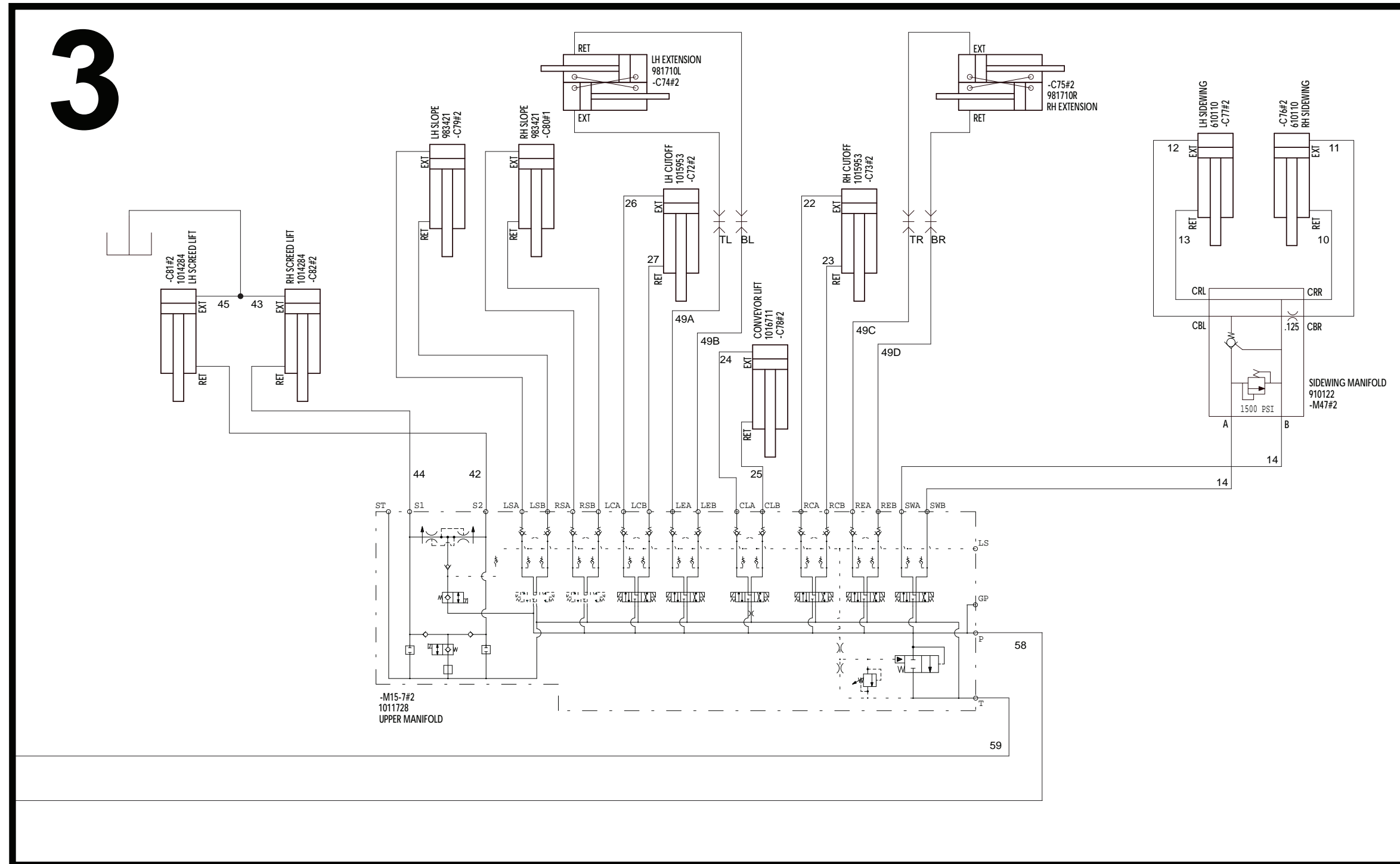

Figure 6-45. Hydraulic Schematic (4 of 5)

Track Assembly - Poly Pads/Cast Steel (1 of 2)

Item No	Part Number	Qty	Description	Remarks
GRP	1017203		Group - PolyPad Drive	
REF	1009742	1	Polypad Track/Undercarriage Assembly - Right	Includes Item 2a
REF	1009741	1	Polypad Track/Undercarriage Assembly - Left	Not Shown; Includes Item 2b
1	851101P	2	Track Assembly w/Polypads	Includes Items 29 - 39
3a	1008789	1	Undercarriage Weldment - Right	
3b	1008788	1	Undercarriage Weldment - Left	Not Shown
4	1001589	2	Track Idler	
5	811329ASRV	2	Front Track Idler Yoke, Short	
6	811331	2	Hydraulic Cylinder, Track Tensioner	
REF	811331-01	A/R	Seal Kit, Track Tensioner Cylinder	
7	FS2404-10-08	2	Connector Adapter, -10 ORFS/-8 NPTF	
8	851644	2	Track Tensioner Cylinder Breather	Included with Item 6
9	870307	2	Cotter Pin, .177, 7 GA	
10	102-M10-1.5-30-10.9F	8	CSSH, M10x1.5 x 30, C10.9, FT	
11	307-M10	8	Washer, Lock, Hi-Collar, M10	
12	811326	6	Track Roller, B/O	
13	851566	2	Track Roller, B/1, N/S	
14	100-M12-1.75-50-8.8F	8	CSHH, M12x1.75 x 50, C8.8, FT	
15	302-8	A/R	Washer, Lock, 1/2	
16	300-8	8	Washer, Flat, SAE, 1/2	
17	100-M12-1.75-40-8.8F	A/R	CSHH, M12x1.75 x 40, C8.8, FT	
18	1006737	2	Track Sprocket (Comer)	
19	1008779	2	Torque Hub w/Disconnect (Comer)	
20	811366	2	O-Ring, Hydraulic Motor to Torque Hub	
21	59941203	A/R	Seal, Hydraulic Drive Motor	
22	811362	2	Hydraulic Drive Motor, 2-Speed	
REF	851494	1	Pump Servo Cover Gasket	Not Shown
23	102-M12-1.75-40-8.8F	4	CSSH, M12x1.75 x 40, C8.8, FT	
24	307-M12	4	Washer, Lock, Hi-Collar, M12	
25	1008903	2	Low Socket Cap Screw, M16x2 x 45	
26	307-M16	A/R	Washer, Lock, Hi-Collar, M16	
27	1008895	8	Low Socket Cap Screw, M16x2 x 35	
28	100-M16-2-65-8.8F	18	CSHH, M16x2 x 65, C8.8, FT	
29	302-10	A/R	Washer, Lock, 5/8	
30	100-M16-2-30-8.8F	A/R	CSHH, M16x2 x 30, C8.8, FT	
31	851104	A/R	Poly Track Pad, 14"	
32	853195	A/R	Track Chain Link - Right	
33	853194	A/R	Track Chain Link - Left	
REF	811306	A/R	Master Track Link Pin	Includes Items 32-35
34	811307	A/R	Track Link Pin	

Conveyor Assembly (1 of 2)

Item No	Part Number	Qty	Description	Remarks
GRP	1017200		Group - Conveyor Assembly	
1	985669SRV	1	Front Lip Guard Assembly	
2	1013152SRV	1	Front Lip Weldment - Right	
3	1013153SRV	1	Front Lip Weldment - Left	
4	100-8-13-20-5F	6	CSHH, 1/2-13 x 1.25, GR5, FT	
5	302-8	6	Washer, Lock, 1/2	
6	301-8	6	Washer, Flat, USS, 1/2	
7	1016760	1	Hopper Safety Rod Weldment	
8	204-8-13-5	1	Nut, Lock, Stover, 1/2-13, GR5	
9	300-8	2	Washer, Flat, SAE, 1/2	
10	855346	12	Conveyor Plate Washer	
11	105-10-11-32-F	4	CSFHS, 5/8-11 x 2.00, FT	
12	301-10	4	Washer, Flat, USS, 5/8	
13	302-10	4	Washer, Lock, 5/8	
14	216-10-11-5	4	Nut, Hex, Thick, 5/8-11, GR5	
15	851133SRV	1	Conveyor Center Cover	
16	985581	1	Front Lip Clamp	
17	105-8-13-24-F	1	CSFHS, 1/2-13 x 1.50, FT	
18	105-6-16-12-F	5	CSFHS, 3/8-16 x .75, FT	
19	802112SRV	1	Guard Clamp	
20	100-9-12-24-5F	2	CSHH, 9/16-12 x 1.50, GR5, FT	
21	302-9	2	Washer, Lock, 9/16	
22	840162	1	Conveyor Center Rear Rubber	
23	802114	1	Conveyor Center Weld Plate	
24	105-10-11-14-F	8	CSFHS, 5/8-11 x .875, FT	
REF	851127RSRV	1	Conveyor Bottom Pan - Right	Includes Items 25-28
25	855878	1	Conveyor Pan, Rear - Right	
26	855879	1	Conveyor Pan, Front - Right	
27	100-10-11-20-5F	4	CSHH, 5/8-11 x 1.25, GR5, FT	
28	204-10-11-5	4	Nut, Lock, Stover, 5/8-11, GR5	
REF	851127LSRV	1	Conveyor Bottom Pan - Left	Includes Items 27-30
29	855881	1	Conveyor Pan, Rear - Left	
30	855882	1	Conveyor Pan, Front - Left	
31	100-6-16-24-5F	3	CSHH, 3/8-16 x 1.50, GR5, FT	
32	301-6	9	Washer, Flat, USS, 3/8	
33	204-6-16-5	3	Nut, Lock, Stover, 3/8-16, GR5	
34	981511	18	Fender Washer, 3/8	
35	100-6-16-20-5F	12	CSHH, 3/8-16 x 1.25, GR5, FT	

Rear Auger Assembly (1 of 2)

Item No	Part Number	Qty	Description	Remarks
1	981685	1	Auger Motor Cover Assembly	
2	201-8-13-5	10	Nut, Hex, Heavy, 1/2-13, GR5	
3	302-8	A/R	Washer, Lock, 1/2	
4	301-8	2	Washer, Flat, USS, 1/2	
5	100-8-13-22-5	10	CSHH, 1/2-13 x 1.375, GR5	
6	981695SRV	1	Auger Support Cover	
7	100-5-18-16-5	6	CSHH, 5/16-18 x 1.00, GR5	
8	302-5	6	Washer, Lock, 5/16	
9	300-5	6	Washer, Flat, SAE, 5/16	
10	910170	2	Hydraulic Cylinder, 2.50 x 4.00 x 1.25 Rod	Includes Items 11,12
11	240030	2	Clevis Pin, 1.00 x 3.25 w/1.50 Head	
12	80338	4	Cotter Pin, .188 x 2.00	
13	FS2501-06-06-FG	2	Elbow Adapter, 90°, -6 ORFS/ -6 NPTF	
14	1006988	2	Cut-Off Cylinder Mounting Shaft	
15	100-8-13-32-5	6	CSHH, 1/2-13 x 2.00, GR5	
16	300-8	A/R	Washer, Flat, SAE, 1/2	
17	1016517	1	Cut-Off Assembly - Left	
18	1016518	1	Cut-Off Assembly - Right	
19	1007064	2	Cut-Off Hinge Bar	
20	400-4-20	2	Roll Pin, 1/4 x 1.25	
21	1007269	2	Auger Clamp, 12"	
22	102-6-16-24-F	4	CSSH, 3/8-16 x 1.50, FT	
REF	1017640	2	Auger Motor Assembly	Includes 23,24
23	260130	2	Hydraulic Motor, 22.0 CIR	
24	FS6400-08-10-O	2	Straight Adapter, -8 ORFS/-10 O-Ring	
25	981696	2	Motor Mount	
26	860030	2	Sprocket, 60B 14 x 1-6 Spline	
27	985815	2	Roller Chain, 60H x 51 Pitch	
28	100-10-11-22-5F	4	CSHH, 5/8-11 x 1.375, GR5, FT	
29	302-10	12	Washer, Lock, 5/8	
30	300-10	4	Washer, Flat, SAE, 5/8	
31	102-8-13-20-F	8	CSSH, 1/2-13 x 1.25, FT	
32L	1019051	1	Auger Assembly w/Mount, 12" - Left	Includes Items 29,33-38,39L,40-46
32R	1019052	1	Auger Assembly w/Mount, 12" - Right	Includes Items 29,33-38,39R,40-46
33	1007270SRV	2	Shaft w/Sprocket, 12" Auger	Includes Items 34,35
34	1007323	2	Auger Bearing Spacer Washer	

Engine Assembly - Radiator

Item No	Part Number	Qty	Description	Remarks
REF	1016478	1	Kubota Engine, T4F, 74HP	
1	988673-13	1	Radiator/Cooler Assembly	
2	1002184-04	1	Radiator Cap	
3	FS6400-12-16-O	2	Straight Adapter, -12 ORFS/-16 O-Ring	
4	FS6500-12-12-FG	2	Elbow Adapter, 90°, -12 ORFS/-12 ORFS	
5	FS6602-12-12-12-FG	1	Swivel Run Tee Adapter, -12 ORFS/-12 ORFS/-12 ORFS	
6	1016478-01	1	Radiator Fan	
7	1005365-23	1	Radiator Fan Guard	
8	1009384-12	1	Lower Radiator Mount	
9	1009384-18	1	Radiator Support Bracket	
10	1001166-57	4	Radiator Mount Isolator	
11	1006963-15	1	Upper Radiator Hose	
12	1006963-16	1	Lower Radiator Hose	
13	986537-46	1	Coolant Recovery Tank	
14	1009384-08	1	Recovery Tank Bracket	
15	100-6-16-32-5	4	CSHH, 3/8-16 x 2.00, GR5	
16	308-6-24	4	Washer, Fender, 3/8 x 1.50	
17	100-6-16-16-5F	2	CSHH, 3/8-16 x 1.00, GR5, FT	
18	301-6	5	Washer, Flat, USS, 3/8	
19	100-6-16-12-5F	3	CSHH, 3/8-16 x .75, GR5, FT	

Hoods and Covers - Left

Item No	Part Number	Qty	Description	Remarks
1	1016421	1	Center Hood Weldment	
2	1016486	1	Radiator Deflector Assembly	
3	1016419	1	Engine Cover & Deflectors Weldment	
4	100-5-18-14-5F	A/R	CSHH, 5/16-18 x .875, GR5, FT	
5	302-5	A/R	Washer, Lock, 5/16	
6	301-5	A/R	Washer, Flat, USS, 5/16	
7	1016542	1	Engine Cover Weldment - Left	
REF	1016468	1	Side Access Door Assembly - Left	Includes Items 8-12
8	1016442	1	Access Door Mount - Left	
9	1016435	1	Edge Trim - Upper	
10	1016438	1	Edge Trim - Lower	
11	1016467	1	Access Door - Left	
12	980460	3	Lever Latch	
REF	35560	A/R	Replacement Key	
13	100-6-16-12-5F	2	CSHH, 3/8-16 x .75, GR5, FT	
14	302-6	2	Washer, Lock, 3/8	
15	300-6	2	Washer, Flat, SAE, 3/8	
16	1015504	1	Floor Board Grating - Left	
17	1016550	1	Driver Side Toeboard	
18	1016417	1	Rear Side Access Cover	
19	1016548	1	Top Access Door	
20	980316	2	Hinge	
21	204-5-18-5	8	Nut, Lock, Stover, 5/16-18, GR5	

Hydraulic Manifold - Lower

Item No	Part Number	Qty	Description	Remarks
GRP	1019159		Lower Manifold Assembly w/ ORFS Adapters	Includes Items 1-13
1	FS6400-04-04-O	3	Straight Adapter, -4 ORFS/-4 O-Ring	
2	DP6400-04-O	1	Test Point Coupling, -4 O-Ring	
3	FS6400-08-12-O	1	Straight Adapter, -8 ORFS/-12 O-Ring	
4	FS6801-04-04-NWO-FG	1	Elbow Adapter, 90°, -4 ORFS/-4 O-Ring	
5	FS6801-08-10-NWO-FG	1	Elbow Adapter, 90°, -8 ORFS/-10 O-Ring	
6	FS6802-12-12-NWO-FG	1	Elbow Adapter, 45°, -12 ORFS/-12 O-Ring	
7	FS6400-08-08-O	7	Straight Adapter, -8 ORFS/-8 O-Ring	
8	FS6801-04-04-NWO-FG X 078	1	Elbow Adapter, 90°, -4 ORFS/-4 O-Ring, .078 Orifice	
9	FS6400-06-06-O	1	Straight Adapter, -6 ORFS/-6 O-Ring	
10	FS6400-12-08-O	2	Straight Adapter, -12 ORFS/-8 O-Ring	
11	FS6400-10-10-O	3	Straight Adapter, -10 ORFS/-10 O-Ring	
12	FS6802-08-08-NWO-FG	4	Elbow Adapter, 45°, -8 ORFS/-8 O-Ring	
13	1018639	1	Valve Driver, EGDR-0101A, 10 kW Gen Controller	
REF	1019175	1	Hydraulic Filter Assembly w/ORFS Adapters, 3000 PSI, 25 GPM	Includes Items 14-17
14	FS6500-12-12-FG	1	Elbow Adapter, 90°, Swivel, -12 ORFS/-12 ORFS	
15	FS6540-12-12-O	1	Swivel Straight Adapter, -12 ORFS/-12 O-Ring	
16	984594	1	Hydraulic Filter Assembly	
REF	984594-01	1	Hydraulic Filter Element	Not Shown
17	FS6400-10-12-O	1	Straight Adapter, -10 ORFS/-12 O-Ring	
REF	1017982	1	Hydraulic Manifold, Motor Functions w/10 kW Gen Controller	Includes Items 17-26
18	1015402-04	1	Cartridge Relief Valve	
19	1017450-03	1	EP10-S35T-0-N-230	
20	1016083-02	2	Valve, SP12-21AP-0-N-0-E	
21	1002070-01	5	Coil, 4303712	
22	983644-02	3	Valve, SV12-23P-0-N-00	
23	1015402-03	2	Relief Valve, RV50-26A-0-P-50/27	
24	1006953-09	1	Valve, SV08-30-0-N-00	
25	1006953-15	1	Coil, 4303612	
26	1017450-02	1	Valve, PV70-33C-0-N-00	
27	1000825-01	1	Coil, 4303212	
REF	1016536	1	Lower Manifold Harness	Not Shown

Dash Assembly - Mounting

Item No	Part Number	Qty	Description	Remarks
1	1007239	1	Aluminum Dash Assembly	
2	1007332	2	Dash Slide Rail w/Holes	
3	100-4-20-12-5F	22	CSHH, 1/4-20 x .75, GR5, FT	
4	302-4	22	Washer, Lock, 1/4	
5	1008093	2	Dash Slide Stop Bracket	
6	1007263	1	Enclosure Mounting Plate	
7	100-7-14-28-5	3	CSHH, 7/16-14 x 1.75, GR5	
8	301-7	3	Washer, Flat, USS, 7/16	
9	1007266	3	45mm V-Guide Wheel	
10	300-7	3	Washer, Flat, SAE, 7/16	
11	302-7	3	Washer, Lock, 7/16	
12	200-7-14-5	3	Nut, Hex, 7/16-14, GR5	
13	1007333	1	Dash Pin Lock Plate	
14	1000835	1	Spring Loaded Pull Pin	
15	100-5-18-12-5F	2	CSHH, 5/16-18 x .75, GR5, FT	
16	302-5	8	Washer, Lock, 5/16	
17	1012975SRV	1	Plus 1 Controller, 50 Pin	
18	1016654	1	Dash Support Weldment	
19	100-8-13-24-5	6	CSHH, 1/2-13 x 1.50, GR5	
20	302-8	6	Washer, Lock, 1/2	
21	100-4-20-40-5	4	CSHH, 1/4-20 x 2.50, GR5	
22	300-4	8	Washer, Flat, SAE, 1/4	
23	204-4-20-5	4	Nut, Lock, Stover, 1/4-20, GR5	
24	930029	1	Extension Spring, .177 x 1.50 x 7.00	
25	1017487	1	Outer Tube Pedestal Support Weldment	
26	1017488	1	Inner Tube Pedestal Support Weldment	
27	1017374	1	Column Height Adjustment Pin	
28	100-10-11-52-5	2	CSHH, 5/8-11 x 3.25, GR5	
29	300-10	4	Washer, Flat, SAE, 5/8	
30	204-10-11-5	2	Nut, Lock, Stover, 5/8-11, GR5	
31	981916	2	Receptacle Connector, 31 Pin, HD34-24-31PT	
32	981916-02	2	Lockwasher, 24 Shell Connector	
33	981916-01	2	Nut, 24 Shell Connector	
34	1011854	1	Nut, Connector, HDP20 Series	
35	1011855	1	Washer, Connector, HDP20 Series	
36	1014909	1	Receptacle, 19 Pin, HDP20 Series	
37	1007264	1	Dash Channel Cover	
38	100-5-18-16-5	6	CSHH, 5/16-18 x 1.00, GR5	
39	300-5	6	Washer, Flat, SAE, 5/16	

Seat Assembly & Details

Item No	Part Number	Qty	Description	Remarks
REF	1016967	2	Seat Assembly w/Short Post	Includes Items 1-5
1	360010	2	White Seat Assembly w/Armrest	
2	988640SRV	2	Seat Post Assembly - Short	
3	200-5-18-5	8	Nut, Hex, 5/16-18, GR5	
4	302-5	12	Washer, Lock, 5/16	
5	72836	2	Pin, 1/2 x 3.00 w/Cotter Pin	
REF	984862	8	Vinyl Cap, Black	
6	853963	1	Tool Box	
7	160320	1	Back Up Alarm, 107 dB	
8	1013307	2	Circular LED Light w/Deutsch Connector	
9	20190773	1	Horn, Low Pitch	
10	989469SRV	1	Beacon Light Post Assembly	
11	1013234	1	Beacon Mount	
12	1013231	1	Beacon Light, LED Amber Strobe	
13	100-5-18-16-5	4	CSHH, 5/16-18 x 1.00, GR5	
14	300-5	4	Washer, Flat, SAE, 5/16	

HD Screed Extension Assembly - Right

Item No	Part Number	Qty	Description	Remarks
REF	1006379SRV	1	Screed Extension Assembly - Right	Includes All Items
1	1009631	1	Screed Extension Front Assembly - Right	Includes Items 2 - 28
2	854447SRV	1	Shaft, ϕ .688 x 43.50	
3	1006390	2	Vertical Adjuster Assembly	
4	1006380SRV	1	Extension Heatbox Assembly - Right	Includes Items 5 - 11
5	100-6-16-12-5F	14	CSHH, 3/8-16 x .75, GR5, FT	
6	302-6	24	Washer, Lock, 3/8	
7	100-6-24-16-5F	6	CSHH, 3/8-24 x 1.00, GR5, FT	
8	300-6	9	Washer, Flat, SAE, 3/8	
9	985123	3	Screed Extension Element Clamp	
10	985120	1	Bar, .25 x 1.50 x 36	
11	986522	1	Insulation, .25 x 1.00 x 12.00 w/Adhesive	
12	987890SRV	1	Heating Element, 1000W/220V, 41"	
13	2405-6-6	1	Adapter, Connector, -6 JIC / -6 NPTF	
14	1006439	2	Extension Adjuster Cover	
15	100-6-16-16-5F	5	CSHH, 3/8-16 x 1.00, GR5, FT	
16	118-12-28-5/8x11	1	Shoulder Bolt, ϕ 3/4 x 1.75L, 5/8-11	
17	300-12	1	Washer, Flat, SAE, 3/4	
18	200-10-11-5	1	Nut, Hex, 5/8-11, GR5	
19	1006401	1	AOA Adjuster Assembly	
20	1006398	1	Extension Access Cover Plate	
21	100-5-18-16-5F	10	CSHH, 5/16-18 x 1.00, GR5, FT	
22	200-5-18-5	10	Nut, Hex, 5/16-18, GR5	
23	1006400	1	Extension Strikeoff Plate	
24	200-6-16-5	3	Nut, Hex, 3/8-16, GR5	
25	1008664	1	Extension Vibrator Weldment	
26	1006536	1	Endgate Bracket Plate w/Holes	
27	100-6-24-12-5F	2	CSHH, 3/8-24 x .75, GR5, FT	
28	100-14-9-40-5	1	CSHH, 7/8-9 x 2.50, GR5	
29	300-14	1	Washer, Flat, SAE, 7/8	
30	202-14-9-5	1	Nut, Jam, 7/8-9, GR5	
31	1007098SRV	1	Outer Extension Assembly - Right	
32	100-8-13-40-5	2	CSHH, 1/2-13 x 2.50, GR5	
33	200-8-13-5	2	Nut, Hex, 1/2-13, GR5	
34	1007099SRV	1	Inner Extension Assembly - Right	
35	1006395	2	Vertical Lift Bar	
36	100-8-13-28-5	6	CSHH, 1/2-13 x 1.50, GR5	
37	300-8	6	Washer, Flat, SAE, 1/2	
38	204-8-13-5	6	Nut, Lock, Stover, 1/2-13, GR5	
REF	1015990SRV	A/R	Extension Element Hose & Wiring Kit	

HD Screed Pull Arm Assembly, 9 Function - Right

Item No	Part Number	Qty	Description	Remarks
1	1017802	1	Screed Arm Weldment, Adjustable - Right	Includes All Items
2	855504	1	Bar, 1/4 x 1 x 5	
3	855496	1	Shaft, 3/8 CR x 1-1/2	
4	1017803	1	Screed Control Box Mount	
5	1008917	1	Pivot Tube	
6	851156	1	Round Knob, 1.375 x 3/8-16	
7	1008934	1	Quick Release Pin	
8	100-6-16-40-5	1	CSHH, 3/8-16 x 2.50, GR5	
9	300-6	4	Washer, Flat, SAE, 3/8	
10	204-6-16-5	2	Nut, Lock, Stover, 3/8-16, GR5	
11	100-6-16-36-5	1	CSHH, 3/8-16 x 2.25, GR5	
12	200-5-18-5	1	Nut, Hex, 5/16-18, GR5	
13	302-5	1	Washer, Lock, 5/16	
14	300-5	1	Washer, Flat, SAE, 5/16	
15	1013307	1	LED Circular Light w/Deutsch Connector	
16	1017792	1	Screed Control Box Assembly, 9 Function - Right	Includes Items 17-25
17	851391	1	Toggle Switch, 2-POS	2-Speed, High/Low
18	851392	3	Toggle Switch, 3-POS, SPDT, MOM	
19	35049	1	Knob	
REF	1010077	1	Rheostat, 35 Ohm/25W	Not Shown
20	1015381	1	Connector, 31 Pin, HD34-24-31ST	
21	851090613	1	Toggle Switch, SPDT, 3-POS	
22	37521	1	Toggle Switch, DPDT, 3-POS, MOM	
23	982249	1	Push Button Switch	
24	1010672	1	Emergency Stop Switch, 1-NC	
25	1017794	1	Decal - Screed Control - Right	

HD Screenshot Control Assembly

Item No	Part Number	Qty	Description	Remarks
REF	1016891	1	Control Box Assembly, 10kW	
1	100804	1	Enclosure, 10 x 8 x 4	
2	851090624	3	Toggle Switch, SPDT, 2-POS	
3	982249	1	Push Button Switch	
4	1011180	1	Decal - Electric Heat	
5	1017228	2	Water Tight Conduit Connector	
6	985140	5	Circuit Breaker, 15A, Pan Mount	
7	1009228	8	Circuit Breaker, 10A	
8	35136-7	2	Plastic Hole Plug, .875, Flush Mount	
9	1016892	1	Circuit Breaker Boot	
10	31983	1	Red Light	
11	985687	1	Amphenol Connector, 06-Pin Male	
12	988230	1	Time Delay Relay, ON, 10A	
13	985142	1	Electric Timer, 06 - 60 MIN	
14	988231	1	Off Delay Timer, 5 Seconds	
15	1017190	1	AC Detector, Generator Control	
16	1016901	1	Circuit Breaker, 40A, Generator Protection	
17	985138-04	1	Terminal Block w/Cover	
18	985141	4	Relay, 12VDC, DSPT, 25A, N/O	
19	100-4-20-12-5F	4	CSHH, 1/4-20 x .75, GR5, FT	
20	302-4	4	Washer, Lock, 1/4	
21	200-4-20-5	4	Nut, Hex, 1/4-20, GR5	
REF	1016723	1	Load Control Box to Bulkhead Harness	Not Shown

Option - HD Berm Screed Extension Assembly - Right (2 of 2)

Item No	Part Number	Qty	Description	Remarks
38	1007991	1	Element Backup Plate, 12"	
39	1015918	1	Heating Element, 500W/240V, 11"	
40	1015358	1	Rear Asphalt Blocker Plate	
41	105-4-20-12-F	2	CSFHS, 1/4-20 x .75, FT	
42	118-8-40-3/8x16	1	Shoulder Bolt, \varnothing 1/2 x 2.5L, 3/8-16	
43	118-12-40-5/8x11	1	Shoulder Bolt, \varnothing 3/4 x 2.5L, 5/8-11	
44	300-10	1	Washer, Flat, 5/8	
45	204-10-11-5	1	Nut, Lock, Stover, 5/8-11, GR5	
46	1006439	2	Extension Adjuster Cover	
47	1006401	1	AOA Adjuster Assembly	
48	118-12-28-5/8x11	1	Shoulder Bolt, \varnothing 3/4 x 1.75L, 5/8-11	
49	1015947	1	Screed Bulkhead Union Adapter	
50	1006395	1	Vertical Lift Bar	
51	100-8-13-28-5	6	CSHH, 1/2-13 x 1.75, GR5	
52	300-8	12	Washer, Flat, SAE, 1/2	
53	204-8-13-5	6	Nut, Lock, Stover, 1/2-13, GR5	
54	1006398	1	Extension Access Cover Plate	
55	100-5-18-16-5	10	CSHH, 5/16-18 x 1.00, GR5	
56	302-5	12	Washer, Lock, 5/16	
57	300-5	12	Washer, Flat, SAE, 5/16	
58	1015351	1	Main Asphalt Blocker Plate	
59	1015423SRV	1	Vibrator Mount Weldment	
60	1015356	1	Adjuster Mount Plate	
61	100-5-18-12-5F	2	CSHH, 5/16-18 x .75, GR5, FT	
62	1015357	1	Hinge Rod Retainer Tab	
63	200-6-16-5	1	Nut, Hex, 3/8-16, GR5	

Option - HD Screed Heated Safety Edge Endgates

Item No	Part Number	Qty	Description	Remarks
GRP	1017025		Group - HD Heated Endgates and Safety Edge	
REF	1015990SRV	1	Extension Element Hose & Wiring Kit	
REF	1011187SRV	1	Heated Edge HD Endgate Assembly - Left	Includes Items 1a,3a,5 - 29
REF	1011156SRV	1	Heated Edge HD Endgate Assembly - Right	Includes Items 1b,3b,5 - 29
1a	1011189	1	Heated Safety Edge Main Plate Weldment - Left	Includes Items 2a, 4
1b	1011161	1	Heated Safety Edge Main Plate Weldment - Right	Includes Items 2b, 4
2a	1011206	1	Safety Edge Depth Screw Bracket - Left	
2b	1011205	1	Safety Edge Depth Screw Bracket - Right	
3a	1011190	1	Heated Safety Edge HD Skid Weldment - Left	
3b	1011165	1	Heated Safety Edge HD Skid Weldment - Right	
4	890092SRV	2	Depth Screw Endgate Assembly	(1) Per Assembly
5	1011195	2	Heated Safety Edge HD Hinge Pin Weldment	(1) Per Assembly
6	100-6-16-16-5F	2	CSHH, 3/8-16 x 1.00, GR5, FT	(1) Per Assembly
7	302-6	6	Washer, Lock, 3/8	(3) Per Assembly
8	301-6	2	Washer, Flat, USS, 3/8	(1) Per Assembly
9	113-6-16-12	8	Set Screw, HSKT, Cup, 3/8-16 x .75	(4) Per Assembly
10	200-6-16-5	8	Nut, Hex, 3/8-16, GR5	(4) Per Assembly
11	1011155	2	Element Backup Bar	(1) Per Assembly
12	1011158	2	Heating Element, 500W/220V, 30"	(1) Per Assembly
13	1011453	2	Safety Edge Spring Mechanism	(1) Per Assembly
14	100-10-11-36-5	4	CSHH, 5/8-11 x 2.25, GR5	(2) Per Assembly
15	300-10	8	Washer, Flat, SAE, 5/8	(4) Per Assembly
16	217-10-11	4	Nut, Lock, Flexloc, 5/8-11, Full, LT	(2) Per Assembly
17	100-6-16-24-5F	4	CSHH, 3/8-16 x 1.50, GR5, FT	(2) Per Assembly
18	980458	2	Tilt Screw Retainer Bar	(1) Per Assembly
19	980457	2	Tilt Screw Swivel Shaft	(1) Per Assembly
20	890081SRV	2	Tilt Screw	(1) Per Assembly
21	855579	2	CR Shaft, ø1.00 x 4.50	(1) Per Assembly
22	1011235	2	Endgate Adjustment Tube	(1) Per Assembly
23	870276	4	Hand Grip	(2) Per Assembly
24	1015380	2	Sonic Sensor Bracket Weldment	(1) Per Assembly
25	920070	2	Thumb Screw, 3/8-16 x 1.00	(1) Per Assembly
26	1008905	2	Sonic Sensor Mount	(1) Per Assembly
27	100-6-16-12-5F	2	CSHH, 3/8-16 x .75, GR5, FT	(1) Per Assembly
28	300-6	4	Washer, Flat, SAE, 3/8	(2) Per Assembly
29	204-6-16-5	2	Nut, Lock, Stover, 3/8-16, GR5	(1) Per Assembly

Option - Legend Sloping Screed Frame Assembly

Item No	Part Number	Qty	Description	Remarks
1	985547SRV	1	Legend Screed Base w/Slope	Includes item 18, 19, 20
2	870182	1	Crown & Valley Assembly - Rear	
3	870172	1	Crown & Valley Assembly - Front	
4	870190	1	Chain, Roller, 40 x 52 Pitch	
5	988376	1	Crown And Valley Locking Bar	
7	985124	2	Screed Base Element Cover	
8	981659	2	Pivot Bar	
9	981711	2	Pivot Cover Plate	
10	981661	2	Cylinder Mount Pin	
11	985121	2	Bar, .375 x 1.50 x 42	
12	987886SRV	2	Heater Element, 1750W/220V, 46.5"	
13	987216SRV	1	Wear Plate Assembly	
14	981656	1	Rail Mount Plate	
15	981656	1	Rail Mount Plate	
16	981658	2	Bottom Rail Bar	
17	981657	2	Top Rail Bar	
18	985149	2	Screed Lid Cover	
19	985147	1	Screed Cover Plate - Right	
20	985148	1	Screed Cover Plate - Left	
21	100-6-24-16-5F	24	CSHH, 3/8-24 x 1.00, GR5, FT	
22	302-6	24	Washer, Lock, 3/8	
23	851191	1	Hydraulic Cylinder, 2.00 x 12.00/30.00 x 1.25 - Left	
24	851192	1	Hydraulic Cylinder, 2.00 x 12.00/30.00 x 1.25 - Right	
REF	851191-01	A/R	Hydraulic Cylinder Seal Kit	
25	983421	2	Hydraulic Cylinder, 2.75 x 2.00 x 1.125	

Option - Legend Screed Slide Plates

Item No	Part Number	Qty	Description	Remarks
1	1002186	1	Slide Plate Assembly w/Chrome Rods	
2	1002181	1	Slide Plate Assembly	
4	988588	4	Bushing	
5	851256	4	Snap Ring	
6	988601	2	Chrome Rod	
7	300-8	4	Washer, Flat, SAE, 1/2	
8	302-8	4	Washer, Lock, 1/2	
9	100-8-20-24-5	4	CSHH, 1/2-20 x 1.50, GR5	

Option - Legend Screed Citrus Tank

Item No	Part Number	Qty	Description	Remarks
1	1008862SRV	1	Legend Screed Citrus Tank Assembly	Includes Items 2 - 7
2	140030FL	1	Fuel Tank Cap - Lockable	
3	140030FN	1	Fuel Cap Filler Neck	
4	140030GK	1	Fuel Filler Strainer & Gasket Kit	
5	100-10-11-60-5	2	CSHH, 5/8-11 x 3.50, GR5	
6	302-10	2	Washer, Lock, 5/8	
7	200-10-11-5	2	Nut, Hex, 5/8-11, GR5	
8	31959	1	Straight Fitting, 06MP-06HB, Push On	
9	480160	1	Ball Valve - 3/8	
10	6274	1	Straight Fitting, 06MP-06FPX	
11	853211085	1	90° Fitting, 06MP-06MP	
12	1016514	1	Tool Tray Assembly	
13	985234-01	1	Manual Case	
14	100-5-18-28-5	2	CSHH, 5/16-18 x 1.75, GR5	
15	300-5	4	Washer, Flat, SAE, 5/16	
16	204-5-18-5	2	Nut, Lock, Stover, 5/16-18, GR5	
17	100-4-20-14-5	4	CSHH, 1/4-20 x .875, GR5	
18	300-4	8	Washer, Flat, SAE, 1/4	
19	204-4-20-5	4	Nut, Lock, Stover, 1/4-20, GR5	

Option - 24" Auger Extension

Item No	Part Number	Qty	Description	Remarks
OPT	982521SRV	1	Option - 24" Auger Extension w/Shield	
1	851228SRV	1	24" Auger Extension Shield - Left	
REF	851227SRV	1	24" Auger Extension Shield - Right	Not Shown
2	851230SRV	1	24" Auger Extension - Left	Includes Items 3 & 4
REF	851229SRV	1	24" Auger Extension - Right	Not Shown, Includes Items 3 & 4
3	854003	2	Chain Coupling Sprocket Half w/Hole	
4	900404	2	Double Row Chain Assembly, 50-2	
5	851231SRV	2	Auger Extension Support	
6	200-16-8-5	4	Nut, Hex, 1-8, GR5	

Option - Truck Hitch Assembly

Item No	Part Number	Qty	Description	Remarks
OPT	1017214	1	Option - Truck Hitch	
REF	1008796	1	Truck Hitch Assembly w/Counter-Weight	Includes Items 1 - 29
1	930015	1	Pivotbar Support Weldment	
2	930025SRV	1	Truck Hitch Extension Arm - Left	
3	930020SRV	1	Truck Hitch Extension Arm - Right	
4	930065SRV	2	Truck Hitch Cover	
5	100-6-16-20-5	16	CSHH, 3/8-16 x 1.25, GR5	
6	302-6	16	Washer, Lock, 3/8	
REF	1019876	1	Truck Hitch Hydraulic Cylinder Assembly	Includes Items 7,29
7	930070	1	Hydraulic Cylinder, 1.50 x 30.00 x 1.00 Rod	
8	1000285	2	Clevis Pin, 1.00 x 2.50	
9	80338	2	Cotter Pin, .188 x 2.00	
10	930075	2	Truck Hitch Roller Assembly Shaft	
REF	930060	2	Tuck Hitch Roller Assembly	Includes Items 11, 12
11	856854	2	Round Tube	
12	810110	8	Push Roller Bearing, 1.250	
13	810102	2	Push Bar Roller Assembly w/Bearings	Includes Item 12
14	100-8-13-20-5F	2	CSHH, 1/2-13 x 1.25, GR5, FT	
15	302-8	2	Washer, Lock, 1/2	
16	855735	2	Flat Washer, .500 x 2.00 x .188	
17	930030SRV	2	Truck Hitch Wheel Weldment	
18	100-10-11-20-5F	2	CSHH, 5/8-11 x 1.25, GR5, FT	
19	302-10	2	Washer, Lock, 5/8	
20	856046	2	Flat Washer	
REF	930040	2	Round Tube Assembly	Includes Items 21, 22
21	856855	2	Round Tube	
22	810070	4	Bushing, 2.00	
23	620400	2	Locking Collar, 2.00	
24	930045SRV	2	Guide Wheel Axle Assembly	
25	930055	2	Guide Wheel Assembly	
26	930050	4	Radial Ball Bearing, 1.50	
27	851112	2	Washer	
28	104-406-1A	2	CSFH, 1/2-13 x 1.25, FT	
29	FS2501-06-06-FG	2	Elbow Adapter, 90°, -6 ORFS/-6 NPTF	
30	1017213	1	Truck Hitch Option - Valving Only	Includes Items 31-34
REF	1019168	1	Truck Hitch Valve Assembly w/Adapters	Includes Items 31-33
31	852250	1	Truck Hitch Valve	
32	FS6400-04-08-O	6	Straight Adapter, -4 ORFS/-8 O-Ring	
33	FS6500-04-04-FG	2	Swivel Elbow Adapter, 90°, -4 ORFS/-4 ORFS	
34	1019160	1	Truck Hitch Hose Kit	Not Shown

Description	Part No.	Figure No.	Item No.
Adjuster Screw	1006431	7-50	44
Adjuster Screw Cap	1006434	7-41	2
Adjuster Screw Cap	1006434	7-50	1
Adjuster Sleeve w/Ball Joint	1006429	7-41	20
Adjuster Sleeve w/Ball Joint	1006429	7-50	45
Adjusting Swivel Nut Assembly	890070	7-65	10
Adjusting Swivel Nut Assembly	890070	7-66	10
Air Breather Assembly	1010255	7-13	3
Air Breather Mount Weldment	1011395	7-18	19
Air Inlet Hood, 3.75"	1002917-29	7-13	1
Alternator	1009253-21	7-13	10
Alternator Bracket	1009253-31	7-13	9
Aluminum Cable Sleeve, 1/16"	981981	7-74	6
Aluminum Cable Sleeve, 1/16"	981981	7-75	7
Aluminum Condulet Plug, 3/4	920238-5	7-49	13
Aluminum Condulet, 3/4	920238-2	7-49	10
Aluminum Dash Assembly	1007239	7-27	1
Aluminum Diamond Plate Step	985168	7-32	16
AM Module & Cable Assembly	987053SRV	7-76	10
AM Module Cable Only	985866-02	7-76	12
AM Module Only	985866-01	7-76	11
Amphenol Connector, 06-Pin Male	985687	7-45	11
AOA Adjuster Assembly	1006401	7-34	19
AOA Adjuster Assembly	1006401	7-35	19
AOA Adjuster Assembly	1006401	7-47	47
AOA Adjuster Assembly	1006401	7-48	47
Asphalt Blocker Plate - Upper	1015323	7-32	10
Assembly, 20 Feet Ski	851584SRV	7-74	GRP
ATM Blade Fuse, 20A	1017776-20	7-15	2
ATM Blade Fuse, 30A	1017776-30	7-15	4
ATM Blade Fuse, 5A	1017776-05	7-15	3
Auger Assembly w/Mount, 12" - Left	1019051	7-8	32L
Auger Assembly w/Mount, 12" - Right	1019052	7-8	32R
Auger Back Wear Plate, 12"	1016721	7-8	57
Auger Bearing	1007267	7-8	35
Auger Bearing Spacer Washer	1007323	7-8	34
Auger Clamp, 12"	1007269	7-8	21
Auger Cutoff Hydraulic Cylinder Assembly	1019174	7-25	REF
Auger End Mount - Long	1019053-01	7-8	44

Description	Part No.	Figure No.	Item No.
CSHH, 3/8-16 x 2.00, GR5	100-6-16-32-5	7-32	22
CSHH, 3/8-16 x 2.00, GR5	100-6-16-32-5	7-60	16
CSHH, 3/8-16 x 2.00, GR5	100-6-16-32-5	7-61	16
CSHH, 3/8-16 x 2.25, GR5	100-6-16-36-5	7-39	11
CSHH, 3/8-16 x 2.25, GR5	100-6-16-36-5	7-40	11
CSHH, 3/8-16 x 2.50, GR5	100-6-16-40-5	7-39	8
CSHH, 3/8-16 x 2.50, GR5	100-6-16-40-5	7-40	8
CSHH, 3/8-24 x .75, GR5, FT	100-6-24-12-5F	7-34	27
CSHH, 3/8-24 x .75, GR5, FT	100-6-24-12-5F	7-35	27
CSHH, 3/8-24 x 1.00, GR5, FT	100-6-24-16-5F	7-34	7
CSHH, 3/8-24 x 1.00, GR5, FT	100-6-24-16-5F	7-35	7
CSHH, 3/8-24 x 1.00, GR5, FT	100-6-24-16-5F	7-47	5
CSHH, 3/8-24 x 1.00, GR5, FT	100-6-24-16-5F	7-48	5
CSHH, 3/8-24 x 1.00, GR5, FT	100-6-24-16-5F	7-56	18
CSHH, 3/8-24 x 1.00, GR5, FT	100-6-24-16-5F	7-57	21
CSHH, 3/8-24 x 1.00, GR8, FT	100-6-24-16-8F	7-58	14
CSHH, 3/8-24 x 1.00, GR8, FT	100-6-24-16-8F	7-59	14
CSHH, 3/8-16 x 2.50, GR5	100-6-16-40-5	7-33	7
CSHH, 5/16 x .75, GR5, FT	100-5-18-12-5F	7-19	26
CSHH, 5/16 x .875, GR5, FT	100-5-18-14-5F	7-19	17
CSHH, 5/16-18 x .75, GR5, FT	100-5-18-12-5F	7-27	15
CSHH, 5/16-18 x .75, GR5, FT	100-5-18-12-5F	7-47	61
CSHH, 5/16-18 x .75, GR5, FT	100-5-18-12-5F	7-48	61
CSHH, 5/16-18 x .875, GR5, FT	100-5-18-14-5F	7-17	4
CSHH, 5/16-18 x .875, GR5, FT	100-5-18-14-5F	7-18	2
CSHH, 5/16-18 x 1.00, GR5	100-5-18-16-5	7-8	7
CSHH, 5/16-18 x 1.00, GR5	100-5-18-16-5	7-10	18
CSHH, 5/16-18 x 1.00, GR5	100-5-18-16-5	7-27	38
CSHH, 5/16-18 x 1.00, GR5	100-5-18-16-5	7-30	13
CSHH, 5/16-18 x 1.00, GR5	100-5-18-16-5	7-47	55
CSHH, 5/16-18 x 1.00, GR5	100-5-18-16-5	7-48	55
CSHH, 5/16-18 x 1.00, GR5, FT	100-5-18-16-5F	7-23	7
CSHH, 5/16-18 x 1.00, GR5, FT	100-5-18-16-5F	7-34	21
CSHH, 5/16-18 x 1.00, GR5, FT	100-5-18-16-5F	7-35	21
CSHH, 5/16-18 x 1.25, GR5	100-5-18-20-5	7-58	17
CSHH, 5/16-18 x 1.25, GR5	100-5-18-20-5	7-59	17
CSHH, 5/16-18 x 1.75, GR5	100-5-18-28-5	7-44	14
CSHH, 5/16-18 x 1.75, GR5	100-5-18-28-5	7-67	14
CSHH, 5/8-11 x 1.00, GR5, FT	100-10-11-16-5F	7-3	11

Description	Part No.	Figure No.	Item No.
Guard Clamp	802112SRV	7-4	19
Guide Bar	920061	7-7	27
Guide Bar Assembly	853887SRV	7-7	24
Guide Bar Inner Tube	920051	7-7	26
Guide Bar Outer Tube	920041	7-7	25
Guide Wheel Assembly	930055	7-77	25
Guide Wheel Axle Assembly	930045SRV	7-77	24
-H-			
Hair Pin Clip, Clevis Pin	870307	7-74	8
Hair Pin Clip, Clevis Pin	870307	7-75	12
Hand Grip	870276	7-42	13
Hand Grip	870276	7-51	18
Hand Grip	870276	7-52	23
Handle Nut, 5/8-11	300060	7-76	3
Harness Bracket	1009253-29	7-14	2
HD Chromed Screed Extension Shaft	1006415	7-36	5
HD Endgate Assembly - Left	1006443SRV	7-42	1a
HD Endgate Assembly - Left	1006443SRV	7-51	1a
HD Endgate Assembly - Right	1006560SRV	7-42	1b
HD Endgate Assembly - Right	1006560SRV	7-51	1b
HD Screed Insulation	1015018	7-33	4
HD Slide w/o Shaft Assembly	1006445	7-36	2
HD Slide w/Shaft Assembly	1006416	7-36	1
Heat Box Assembly - 4 Adjust	988319SRV	7-60	2
Heat Box Assembly - 4 Adjust	988319SRV	7-61	2
Heat Box Assembly - Single Adjust	987872SRV	7-58	2
Heat Box Assembly - Single Adjust	987872SRV	7-59	2
Heat Box Cover Assembly - 4 Adjust	988292SRV	7-60	14
Heat Box Cover Assembly - 4 Adjust	988292SRV	7-61	14
Heat Box Cover Assembly - Single Adjust	988291	7-58	12
Heat Box Cover Assembly - Single Adjust	988291	7-59	12
Heat Box Hinge Pin	1015350	7-47	2
Heat Box Hinge Pin	1015350	7-48	2
Heated Edge HD Endgate Assembly - Left	1011187SRV	7-52	REF
Heated Edge HD Endgate Assembly - Right	1011156SRV	7-52	REF
Heated Endgate Depth Screw Bracket - Left	1011204	7-42	2a
Heated Endgate Depth Screw Bracket - Left	1011204	7-51	2a
Heated Endgate Depth Screw Bracket - Right	1011203	7-42	2b

Description	Part No.	Figure No.	Item No.
Pin, Position Lock	1013870	7-75	13
Pipe Bushing, 12MP-08FP, Steel	99985	7-53	26
Pipe, .75 x 1.00, SCH 80	854032	7-7	33
Pivot Bar	981659	7-57	8
Pivot Cover Plate	981711	7-32	3
Pivot Cover Plate	981711	7-57	9
Pivot Housing Tube	981660	7-32	4
Pivot Plate Weldment - Left	1015424SRV	7-32	7b
Pivot Plate Weldment - Right	1015412SRV	7-32	8b
Pivot Tube	1008917	7-39	5
Pivot Tube	1008917	7-40	5
Pivotbar Support Weldment	930015	7-77	1
Planetary Adapter Tube	1014924	7-50	27
Planetary Box Coupler	1014927	7-50	38
Planetary Drive Flight Screw Assembly - Left	1014929	7-50	REF
Planetary Drive Flight Screw Assembly - Right	1014928	7-50	REF
Planetary Drive Reduction Box	1014921	7-50	35
Planetary Threaded Rod	1014931	7-50	34
Plastic Hole Plug, .875, Flush Mount	35136-7	7-45	8
Plug Adapter, -10 O-Ring	6408-10-O	7-10	15
Plug Adapter, -16 O-Ring	6408-16-0	7-1	42
Plug Adapter, -16 O-Ring	6408-16-0	7-2	30
Plug Adapter, -4 O-Ring	6408-4-O	7-10	7
Plug Adapter, -6 O-Ring	6408-06-O	7-10	38
Plug Adapter, Hex Socket, -12 O-Ring	6409-12-O	7-10	36
Plug Adapter, Hex Socket, -6 O-Ring	6409-6-O	7-10	29
Plug Adapter, Hex Socket, -8 O-Ring	6409-8-O	7-10	26
Plug Adapter, Hex Socket, O-Ring, -6	6409-6-O	7-21	11
Plug Connector	989179	7-29	26
Plus 1 Controller, 50 Pin	1012975SRV	7-27	17
Poly Track Pad, 14"	851104	7-1	31
Polypad Track/Undercarriage Assembly - Left	1009741	7-1	REF
Polypad Track/Undercarriage Assembly - Right	1009742	7-1	REF
Power Block Relay	1009253-41	7-15	1
Power Cable, Ultrasonic	982796	7-42	23
Power Crown Adjuster Plate	1008600	7-53	5
Power Crown Center Weldment	1008667	7-53	6
Power Crown Composite Bushing	1000960	7-53	8
Power Crown Cover	1008168	7-53	1

Description	Part No.	Figure No.	Item No.
Tilt Screw	890081SRV	7-51	14
Tilt Screw	890081SRV	7-52	20
Tilt Screw Retainer Bar	980458	7-42	8
Tilt Screw Retainer Bar	980458	7-51	12
Tilt Screw Retainer Bar	980458	7-52	18
Tilt Screw Swivel Shaft	980457	7-42	9
Tilt Screw Swivel Shaft	980457	7-51	13
Tilt Screw Swivel Shaft	980457	7-52	19
Time Delay Relay, ON, 10A	988230	7-45	12
Toggle Switch	851393	7-28	18
Toggle Switch	851393	7-29	16
Toggle Switch	851393	7-37	14
Toggle Switch	851393	7-38	14
Toggle Switch	851393	7-63	12
Toggle Switch	851393	7-64	12
Toggle Switch Mounting Bracket	1016260	7-28	32
Toggle Switch Mounting Bracket	1016260	7-29	30
Toggle Switch Weather Boot	851440	7-49	6
Toggle Switch, 2-POS	851391	7-37	13
Toggle Switch, 2-POS	851391	7-38	13
Toggle Switch, 2-POS	851391	7-39	17
Toggle Switch, 2-POS	851391	7-40	17
Toggle Switch, 2-POS	851391	7-63	11
Toggle Switch, 2-POS	851391	7-64	11
Toggle Switch, 2-POS, SPST	851391	7-28	9
Toggle Switch, 2-POS, SPST	851391	7-29	9
Toggle Switch, 3-POS, DPDT	851390	7-28	17
Toggle Switch, 3-POS, DPDT	851390	7-29	14
Toggle Switch, 3-POS, DPDT, MOM	37521	7-28	10
Toggle Switch, 3-POS, DPDT, MOM	37521	7-29	10
Toggle Switch, 3-POS, SPDT	851090613	7-28	13
Toggle Switch, 3-POS, SPDT	851090613	7-29	15
Toggle Switch, 3-POS, SPDT, MOM	851392	7-28	8
Toggle Switch, 3-POS, SPDT, MOM	851392	7-29	8
Toggle Switch, 3-POS, SPDT, MOM	851392	7-37	12
Toggle Switch, 3-POS, SPDT, MOM	851392	7-38	12
Toggle Switch, 3-POS, SPDT, MOM	851392	7-39	18
Toggle Switch, 3-POS, SPDT, MOM	851392	7-40	18
Toggle Switch, 3-POS, SPDT, MOM	851392	7-63	10

CLICK HERE TO **DOWNLOAD** THE COMPLETE MANUAL

- Thank you very much for reading the preview of the manual.
- You can download the complete manual from: www.heydownloads.com by clicking the link below



- Please note: If there is no response to CLICKING the link, please download this PDF first and then click on it.

CLICK HERE TO **DOWNLOAD** THE COMPLETE MANUAL