

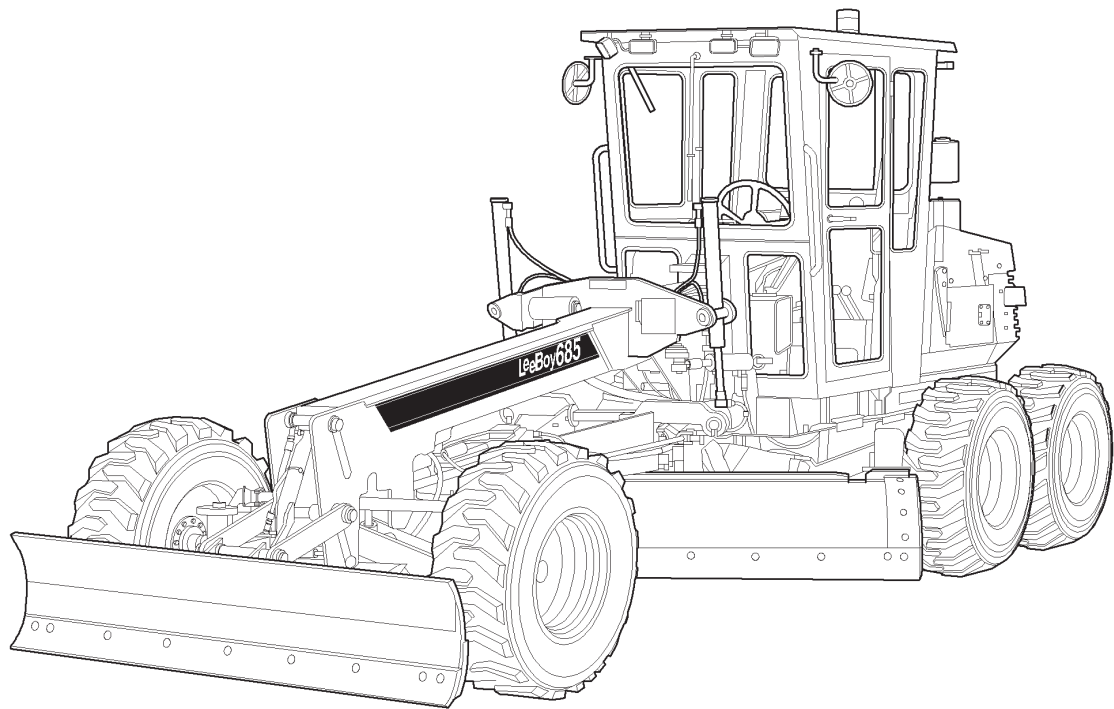

OPERATIONS, SERVICE AND PARTS MANUAL



685B MOTOR GRADER MANUAL

Manual No. 985685

For Units With Serial #400 and higher

CLICK HERE TO **DOWNLOAD** THE COMPLETE MANUAL

- Thank you very much for reading the preview of the manual.
- You can download the complete manual from: www.heydownloads.com by clicking the link below



- Please note: If there is no response to CLICKING the link, please download this PDF first and then click on it.

CLICK HERE TO **DOWNLOAD** THE COMPLETE MANUAL



TABLE OF CONTENTS

	Page
GENERAL INFORMATION	1-2
DESCRIPTION AND SPECIFICATIONS	1-2
CONTROLS	1-2
OPERATION	1-2
MAINTENANCE	1-2
REPLACEMENT PROCEDURES	1-2
NAMEPLATE	1-2
RECEIVING THE MOTOR GRADER	1-2

TABLE 2-3. MACHINE DIMENSIONS (see Figure 2-8)

ITEM	SPECIFICATION
Overall Weight	15,200 pounds (6895 kg)
Overall Length	21 feet 8 inches (6.6 m)
Overall Width	7 feet (2.1 m)
Overall Height8 feet 6 inches (2.6 m) with Canopy 9 feet (2.7 m) with Cab

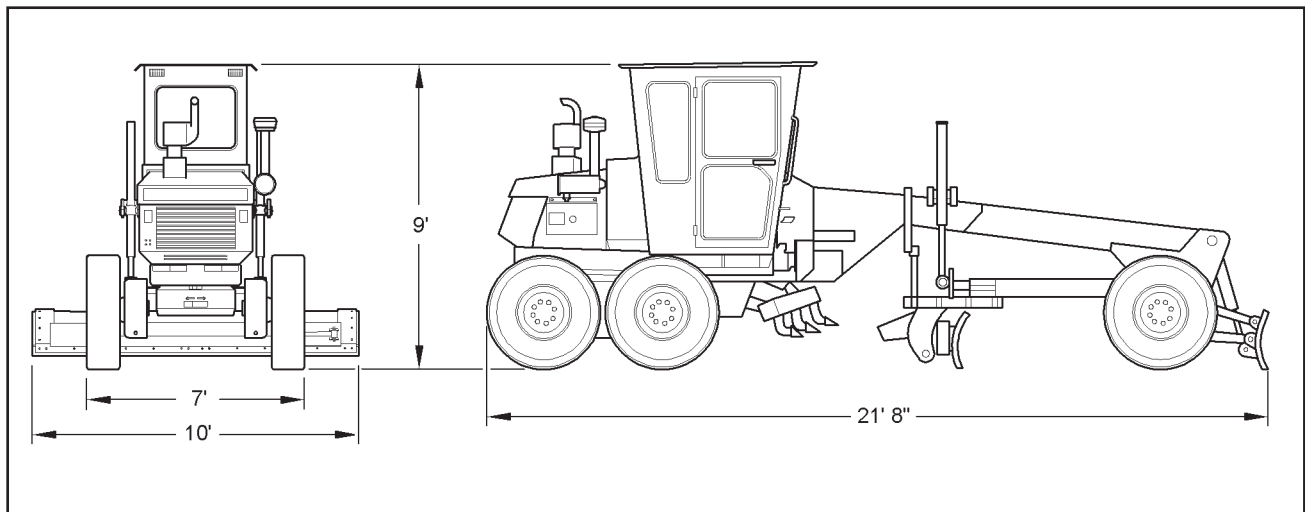

FIGURE 2-8. OUTLINE DIMENSIONAL DRAWING

TABLE 2-4. MOLDBOARD DIMENSIONS

ITEM	SPECIFICATION
Width	10 feet (3 m)
Height	18 inches (457 mm)
Side Shift	3 feet (914 mm)
Tilt	30 degrees
Raised Clearance	13.5 inches (343 mm)
Penetration	12 inches (305 mm)
Rotation	120 degrees

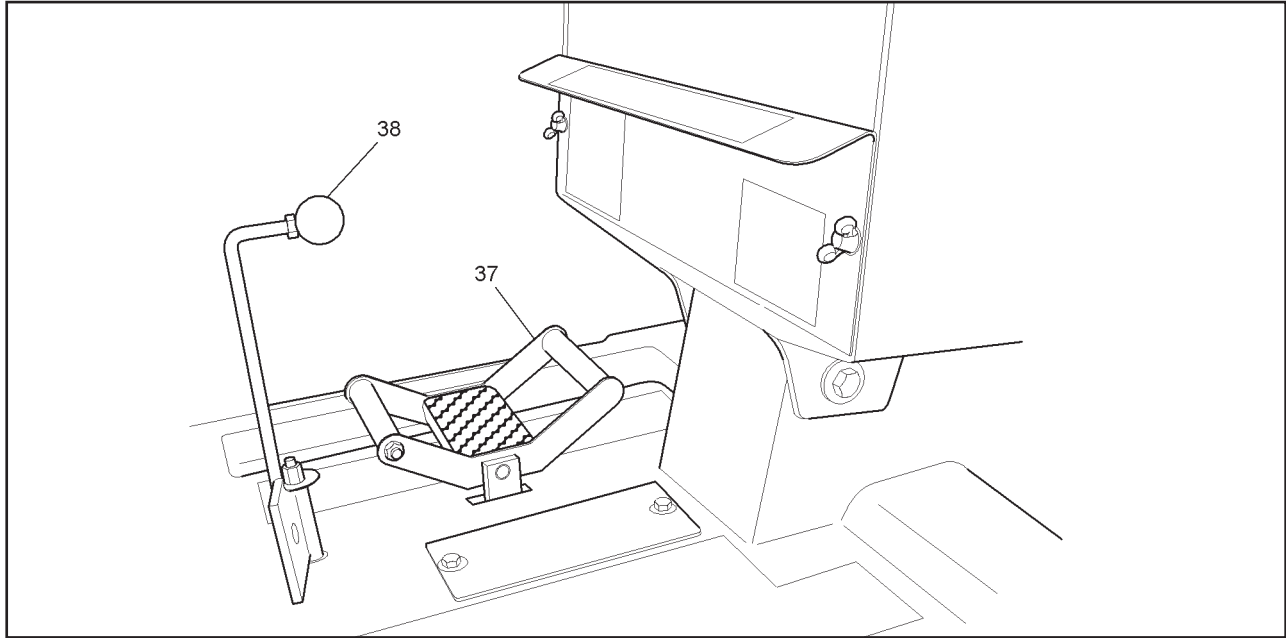

FIGURE 3-4. TRACTION FOOT PEDAL AND LOCK

TABLE 3-1. OPERATING CONTROLS, INDICATORS, AND GAUGES

FIG. REF	ITEM	CONTROL NAME	TYPE	FUNCTION
3-1	1	Rotating Beacon Light	ON/OFF 2-position toggle	Controls operation of the safety flashing light on top of the cab or canopy. This light warns traffic of slow moving equipment.
3-1	2	Rear Window Wiper	ON/OFF 2-position toggle	Controls operation of the optional cab rear window wiper motor.
3-1	3	Windshield Defroster	ON/OFF 2-position toggle	Controls operation of the optional cab windshield defroster.
3-1	4	Heater	HIGH/LOW 2-position toggle	Controls operation of the optional cab heater fan.
3-1	5	Work Lights	ON/OFF 2-position toggle	Controls operation of the work lights mounted on the cab or canopy. These lights are used to illuminate the work area when working at night.
3-1	6	Headlights	ON/OFF 2-position toggle	Controls operation of the headlights. These lights are used to illuminate the road or area in front of the machine during operation or transport.
3-1	7	Windshield Wipers	ON/OFF 2-position toggle	Controls operation of the windshield wipers.
3-1	8	Dome Light	ON/OFF 2-position toggle	Controls operation of the optional cab interior light.

blends the top.

4. Any ridges left in the center can be spread at high speed with a straight blade.

BANK CUTTING

1. Make a first pass at base of bank to level and smooth a platform for the machine.
2. Shift top of blade forward and place heel in front of rear wheel center.
3. Tilt blade forward and lean wheels slightly toward bank.
4. Position machine frame straight with all wheels at base of bank or, if more reach is needed, articulate slightly to position front inside wheel on bank.

NOTE: There are three methods for setting depth of cut: maneuvering lift cylinders, changing blade pitch, and leaning wheels.

5. After first bank cut, clean any loose material from bottom of bank.

SLOPE WORK

1. If possible, make a first pass from above slope to establish angle as follows:
 - a. Side-shift moldboard toward slope.
 - b. Set blade angle slightly toward rear of machine with a slight forward tilt.
 - c. Position blade as far down slope as possible and make first pass.

NOTE: The machine can be straight frame or articulated for extra reach.

2. On second pass, lean front wheels toward slope and position upper front wheel above windrow to prevent front end from drifting down. Articulate rear wheels down slope to increase stability of machine.
3. Position toe of blade forward and angled so materials are spilled off heel slightly between rear wheels. Set blade pitch ahead of vertical plane and side shift toward the uphill side. Repeat procedure until dirt is deposited at toe of slope.
4. Establish toe of slope by cleaning windrow away from bottom.
5. When working on steep slopes, a rollover with the machine articulated is unlikely; however,

extreme caution should be used when working on slopes steeper than three to one.

CUL-DE-SACS

1. Articulate machine to inside, shift moldboard to outside, and side shift blade slightly to inside.
2. Tilt blade forward 5° to 10°.
3. Travel in low gear; fast idle with front wheels leaned toward direction of turn.
4. After curb is poured, backfill against the outside of curb for support.
5. For finish grading as turns become shorter, the moldboard can be shifted toward the center. Any excess material deposited in the center can be removed.

TABLE 4-1. LUBRICATION CHART

ITEM NO.	TYPE LUBE	DESCRIPTION AND LOCATION	INTERVAL
1	A	ARTICULATE JOINT (Until grease escapes from the upper and lower joints)	Monthly
2	A	CYLINDER ENDS (All) (Until grease escapes from the clevis joints)	Weekly
3	A	CHAIN BOX PIVOTS	Monthly
4	B	DOOR HANDLES	Monthly
5	A	BALL DRAWBAR (Until grease escapes from the ball joint)	Daily
6	A	PEDAL, DRIVE (Until grease escapes from the pedal joint)	Weekly
7	A	STEERING RODS AND TIE RODS (Until grease escapes from the king pin joints)	Daily
8		Not Used	
9	A	FRONT BLADE PIVOTS	Weekly
10	A	BEARINGS, FRONT WHEEL (See instructions for cleaning, packing and adjusting the wheel bearings)	1000 Hours
11	A	KING PIN BEARINGS	Monthly
12		Not Used	
13	A	TRUNIONS (Until grease escapes from the trunnion joints)	Daily
14	A	PINS, MOLDBOARD PIVOT (Until grease escapes from the pin joints)	Weekly
15	A	TRUNION HOUSING	Daily
16	A	STABILIZER ROD ENDS, Moldboard (Until grease escapes from rod end joints)	Weekly
17		Not Used	
18		Not Used	
19		Not Used	
20		Not Used	
21		Not Used	
22	A	TURNTABLE (Until grease is visible underneath and around turntable mounting)	Weekly
23	A	LEVERS, CONTROL	Weekly
24	A	AXLE PIVOT	Weekly
25	A	BRAKE CALIPER ASSEMBLY	Monthly
26	A	DOOR HINGES	Monthly

LEGEND

- A GREASE WITH SHELL AVANIA EP GREASE OR EQUIVALENT
- B SPRAY WITH OIL OR CHAIN LUBRICANT

5. Open radiator petcock and drain coolant into a suitable container. Dispose of coolant properly.
6. Open engine block drain plugs (see engine manufacturer's Operation and Maintenance manual). Drain coolant into a suitable container.
7. Using a good quality coolant system flush product, flush the cooling system using the product directions.
8. Close petcock and engine drains. Fill radiator to full level with 50/50 mixture of antifreeze and water. Contact the local authorized dealer for information on local coolant protection levels.
9. Inspect radiator cap for wear and damage. Perform pressure/temperature test if necessary. Replace cap as necessary.
10. Start engine and run for 15 to 30 minutes to purge air from the engine block. Check coolant recovery tank and fill as necessary.
11. Check recovery tank frequently for proper coolant level.

CLEANING ENGINE VENTILATION TUBE (BLOW-BY TUBE)

Refer to the engine manufacturer's operation and maintenance manual for additional information on engine service. Use manufacturer's recommendations for engine ventilation tube cleaning.

CHECKING ENGINE SPEED

Refer to the engine manufacturer's operation and

maintenance manual for additional information on engine service. Use manufacturer's recommendations for engine speed and adjustments.

Check the illustrated parts listing (IPL) for illustrations of the throttle lever needed for adjustment.

FUEL SYSTEM

Draining Fuel Tank Sump

WARNING: Diesel fuel is highly flammable. Keep all sparks and flames away when draining fuel. Do not smoke when filling fuel tank or working on fuel system.



1. Remove fuel tank filler cap.
2. Remove fuel tank drain plug (see Figure 4-4).
3. Allow water and sediment to drain from fuel tank into a suitable container. Dispose of fuel properly.
4. Install drain plug.

Changing Engine Fuel Filters

Refer to the engine manufacturer's operation and maintenance manual for additional information on engine service. Use manufacturer's recommendations for engine fuel filter replacement and bleeding the fuel system.

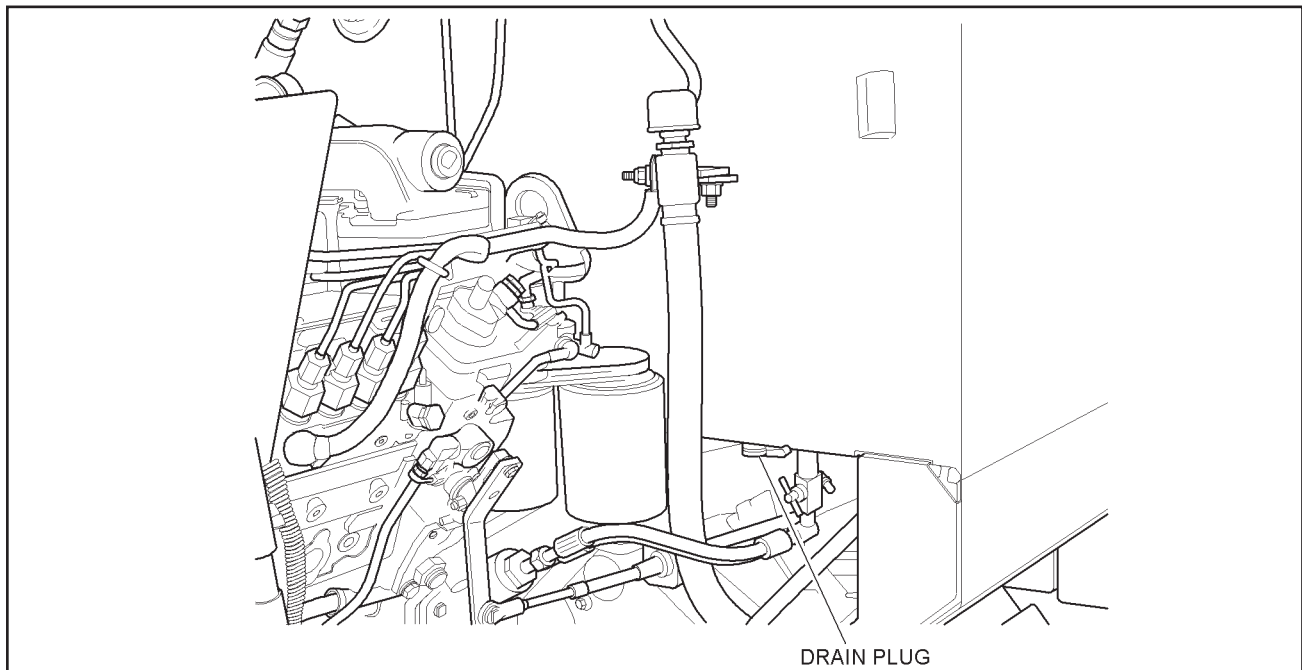

FIGURE 4-4. DRAINING FUEL TANK SUMP

4. Clean the filter head mounting surface and inspect for dislodged seals from the old filter element.

Installation

1. Lightly lubricate element with clean hydraulic oil.
2. Install element on the filter head hand tight plus one-half turn.
3. Open supply line gate valve.
4. Check hydraulic tank sight gauge and fill as necessary. Refer to Section 4, MAINTENANCE.
5. Start engine and check operation. Repair leaks as necessary.

REPLACING EXHAUST SYSTEM

NOTE: Allow engine to cool completely.

Removal

1. Remove flex pipe to muffler exhaust clamp.
2. Remove muffler to hood mounting bolts and lock washers.
3. Remove muffler.
4. Remove muffler extension exhaust clamp.
5. Remove exhaust extension.

Installation

1. Install exhaust extension on muffler. Secure with exhaust clamp.
2. Install exhaust clamp on flex pipe.
3. Place muffler in position on the hood and over the flex pipe. Secure muffler with lock washers and bolts.

REPLACING RADIATOR/OIL COOLER ASSEMBLY

NOTE: Allow engine to cool completely.

Removal

1. Remove engine access panels, hood, and grill.

NOTE: Dispose of engine coolant in an environmentally safe manner. Contact local recycling centers or environmental officials for coolant disposal instructions.

2. Drain the engine coolant system. Dispose of coolant properly.

3. Thoroughly clean the radiator and oil cooler assembly especially the area surrounding hydraulic hoses and fittings.
4. Tag and disconnect hydraulic hoses from the oil cooler. Immediately plug hoses and oil cooler ports to prevent contamination of the hydraulic system.
5. Remove the radiator upper and lower radiator hoses.
6. Disconnect the radiator overflow hose.
7. While supporting the radiator, remove the radiator mounting bolts and washers.
8. Remove the radiator/oil cooler.

Installation

1. Position the replacement radiator/oil cooler and secure with mounting bolts and washers.
2. Install overflow hose and secure with clamp.
3. Install upper and lower radiator hoses and secure with hose clamps.
4. Using tags created during removal, connect hydraulic hoses to oil cooler fittings.
5. Fill radiator with coolant mixture consisting of at least 50/50 mix of anti-freeze and water.
6. Inspect and test radiator cap. Replace if necessary.
7. Install grill, hood, and engine access panels.
8. Start engine and check operation. Repair leaks as necessary.

REPLACING AIR CLEANER ASSEMBLY

NOTE: Allow engine to cool completely.

Removal

1. Thoroughly clean and dry the air cleaner assembly.
2. Disconnect the air outlet hose clamp.
3. Loosen the precleaner clamp and precleaner.
4. Loosen the stack intake extension clamp and extension.
5. Remove the air cleaner end cover, primary element, and safety element.
6. Remove screws from the band clamp.
7. Remove the air cleaner housing.

CLICK HERE TO **DOWNLOAD** THE COMPLETE MANUAL

- Thank you very much for reading the preview of the manual.
- You can download the complete manual from: www.heydownloads.com by clicking the link below



- Please note: If there is no response to CLICKING the link, please download this PDF first and then click on it.

CLICK HERE TO **DOWNLOAD** THE COMPLETE MANUAL

TROUBLESHOOTING CHART (Continued)

SYMPTOM	CAUSE	REMEDY
Starter motor continues to turn after engine starts.	Starter solenoid stuck.	Gently tap solenoid. Replace solenoid.
	Starter pinion gear not disengaging from flywheel.	Gently tap starter motor. Repair or replace starter motor.
	Ignition switch malfunction.	Check for 12 volts at "st" terminal with ignition switch in the ON position. If 12 volts available, replace ignition switch.
Excessive noise when cranking engine.	Broken teeth on flywheel ring gear or starter pinion gear.	Replace starter motor or ring gear.
	Major engine malfunction.	See authorized dealer.
Battery uses too much water.	Battery overcharged.	With batteries fully charged, check alternator charging rate. Repair or replace alternator.
	Cracked or broken battery case.	Replace battery.
Cracked battery case.	Battery hold down clamps too tight, loose or missing.	Replace battery and install hold down clamps properly.
	Frozen batteries.	Keep battery fully charged during cold weather. Replace batteries.
Low battery output.	Low water level.	Fill with distilled water and charge.
	Corroded or loose battery cable connections.	Clean and tighten all connections.
	Broken or loose battery posts.	Replace battery.
	Loose, slipping alternator belt.	Replace alternator belt.
	Low alternator output.	Test and replace alternator.
Alternator warning light stays on or voltmeter shows low charge.	Alternator.	Load test alternator and replace as necessary.
Alternator charging rate to high (batteries hot or boiling).	Alternator.	Load test alternator and replace as necessary.
Noisy alternator.	Alternator bearings.	Remove alternator belt and turn alternator by hand. If pulley turns rough, repair or replace alternator.
	Worn drive belt.	Check and replace belt.
	Internal alternator malfunction.	Repair or replace alternator.
Horn will not sound.	Horn fuse.	Check and replace fuse.
	Horn ground connection.	Check and repair ground connection.
	Horn connection.	Check and repair horn connection.
	Horn is inoperable.	Replace horn.



ILLUSTRATED PARTS LIST

FIGURE 1. MAIN FRAME & BOOM

FIG ITEM	PART NUMBER	NOMENCLATURE 123456	UNITS PER ASSY
1	100014	MAIN FRAME ASSEMBLY(SHOWN WITH CANOPY CAB ATTACHED)	1
2	100024	BOOM ASSEMBLY	1
3	100032	GUARD, DIFFERENTIAL	1
4	100042	CLAMP HALF, REAR AXLE	2
5	100051	DOOR, TOOL BOX	1
6	100060	CYL, HYD, ARTICULATION	2
6A	100060-1	SEAL KIT, HYD. CYL.	1
7	100071	CLAMP HALF, ARTICULATING SHAFT	2
8	220360	BUSHING	4
8A	100080A	BUSHING	4
8B	100080B	BUSHING	4
9	100090	SEAL	2
10	100102	SHAFT, ARTICULATION	1
11	100110	BEARING CONE	2
12	100120	BEARING CUP	2
13	100090	SEAL	1
14	100141	NUT, ARTICULATING SHAFT	1
15	100152	MOUNT, LIFT CYLINDER	2
16	100161	RETAINER, LIFT CYLINDER	2
17	100170	BUSHING, CYLINDER LIFT	12
18	100250	WASHER, FLAT	2
19	100180	PINTLE HOOK	1
20	100190	CHECK VALVE, ARTICULATION LOCK	1
21	35494	FITTING, HYD.	1
22	100214	CAB, CANOPY (USED WITH CANOPY ONLY)	1
23	100204	CANOPY, CAB	1
24	100230	CSHH, .750-16 X 3.75 GR8	4
25	100240	CSHH, .625-18 X 4.50 GR8	8
26	930041	BUSHING, HYD. CYL. CLEVIS	2
27	210060	PIN, CLEVIS	4
28	80338	PIN, COTTER	4
29	80706	WASHER, FLAT	4
30	859443	ADAPTER, HOSE, W/.063 ORIFICE	2
31	920070	SCREW, WING, .375-16 X 1.00	1
32	119-3	WASHER, FLAT, SAE, .375	1
33	118-7	WASHER, LOCK, .625	4
34	118-8	WASHER, LOCK, .750	8
35	102-407-1A	CSHH, .500-13 X 1.50	4

FIGURE 3. FRONT WHEEL ASSIST CONT.

FIG ITEM	PART NUMBER	NOMENCLATURE 123456	UNITS PER ASSY
35	A120330AL	TIRE & WHEEL ASSY, LH	1
35A	110340A	TIRE, GOOD YEAR SOFTRAC 36" X 13.5" X 15"	2
36	A120330AR	TIRE & WHEEL ASSY, RH	1
37	210010	BUSHING, CENTER PIVOT	4
38	110361	SHAFT, CENTER PIVOT	1
39	110130B	BUSHING, CLEVIS	2
40	BL30000-15	SET SCREW	2
41	BL30000-10	MOTOR, HYD, FRONT WHEEL DRIVE ASSIST	2
42	72161	ROLL PIN, .375 X 3.00	1
43	BL30000-16	MANIFOLD, EQUA-TRAC, AWD	1
44	BL30000-17	SOLENOID VALVE, EQUA-TRAC	1
45	BL30000-18	COIL, SOLENOID VALVE	1
46	X280	FITT, STR, 10MJ-12MB	4
47	71775	FITT, 90, 12MJ-12MB	2

FIGURE 6 .FRONT BLADE AND SCARIFIER

FIG ITEM	PART NUMBER	NOMENCLATURE 123456	UNITS PER ASSY
1	132010	CYL, HYD, SCARIFIER LIFT	1
1A	132010-1	SEAL KIT, HYD. CYL.	1
2	132024	FRAME, SCARIFIER	1
3	132031SRV	PIN, LOCK, SCARIFIER SHANK	5
4	132040	SHANK W/ TOOTH, SCARIFIER	5
5	132050	TOOTH, SCARIFIER	5
6	132060	PIN, SCARIFIER FRAME MOUNT	2
7	131014	ASSY, FRONT DOZER BLADE	1
8	131020	CUTTING EDGE, 7', FRONT BLADE	1
9	131033SRV	FRAME, FRONT BLADE LOWER	1
10	131041	SHAFT, LOWER REAR PIVOT	1
11	131051SRV	SHAFT, LOWER FRONT PIVOT	1
12	131061SRV	SHAFT, UPPER PIVOT	2
13	859363SRV	ARM, UPPER PIVOT	2
14	131090	CYL, HYD, FRONT BLADE LIFT	1
14A	130050-1	SEAL KIT, HYD. CYL.	1
15	100250	WASHER, FLAT	2
16	984892	PIN, COTTER, .188 X 2.00	2
17	130220	PLOW BOLT, .625-11 X 2.00	A/R
18	118-7	WASHER, LOCK, .625	A/R
19	116-7	NUT, HEX, .625-11	A/R
20	210060	PIN, CLEVIS, 1.00 X 2.625	2
21	930039	PIN, COTTER, .188 X 2.00	2
22	119-10	WASHER, FLAT, SAE, 1.00	2
-23	982027SRV	FRONT BLADE (OPTION)	AR

FIGURE 11. TURBO HOOD PACKAGE, MUFFLER AND COMPONENTS

FIG ITEM	PART NUMBER	NOMENCLATURE 123456	UNITS PER ASSY
1	140014	HOOD	1
2	988408	MUFFLER, EXHAUST	1
3	160240-12	PIPE, FLEXIBLE EXHAUST (TURBO)	1
4	160010	ELBOW, EXH, 90, 3.00	1
5	161250	CLAMP, MUFFLER, 3.00	3
6	160261	COVER, RADIATOR FILL	1
7	102-205-1A	CSHH, .375-16 X 1.00	5
8	119-3	WASHER, FLAT, SAE, .375	8
9	118-3	WASHER, LOCK, .375	4
10	143-3	NUT, LOCK, .375	1

FIGURE 16. CONTROL LEVERS AND INSTRUMENTATION

FIG ITEM	PART NUMBER	NOMENCLATURE 123456	UNITS PER ASSY
1	140231	PEDAL, FOOT	1
2	140240A	ROD, 635 FOOT PEDAL PIVOT	1
3	140250	KNOB	1
4	140261	LEVER, NEUTRAL SAFETY, LOCK, 685 PEDAL	1
5	140270	ROD, FORWARD & REVERSE	1
6	920090	BALL JOINT	2
7	140621	PANEL, R.H.	1
8	670060	SPRING, PRESSURE RELEASE	1
9	986616	LEVER, SHIFTER	1
10	160100	CABLE, HIGH/LOW SHIFTER	1
11	140320	LEVER, V.V. MOTOR OR THROTTLE	2
12	140331SRV	ACTUATOR ARM, THROTTLE OR MOTOR CONTROL	3
13	859361	SHAFT, LEVER MOUNT	6
14	490080	SPRING WASHER, 5/8"	1
15	160090	CABLE, V.V. MOTOR OR THROTTLE	4
16	140361	BRACKET	2
17	350060	U-BOLT, .375	2
18	140370	TACH/HOUR METER, MURPHY	1
19	140380	GAUGE, FUEL LEVEL MURPHY	2
20	35668	GAUGE, VOLTMETER MURPHY	2
21	140400	GAUGE, WATER TEMP. MURPHY	4
22	140410	GAUGE, OIL PRESSURE MURPHY	1
23	140420	PANEL, IGNITION CONTROL MURPHY	2
24	140430	CIRCUIT BREAKER	2
25	140440	WARNING LIGHT, ENGINE SHUT DOWN MURPHY	1
26	140450	WARNING BUZZER, ENGINE SHUT DOWN MURPHY	1
27	500010	SWITCH, IGNITION MURPHY	1
27A	500010-1	IGNITION KEY MURPHY	AR
28	140471	PANEL, L.H.	1
29	859216	SUPPORT, CENTER SEAT (USED WITH BOTH CAB & CANOPY CAB ARRANGEMENT)	1
30	810050	CLEVIS	1
31	140470	RELAY, ENGINE SHUT DOWN SWITCH	1
32	140490	ADAPTER, PIPE TO HOSE MURPHY	1
33	140510	ADAPTER, PIPE TO HOSE MURPHY	1
34	140520	HOSE 3/16" X 8' MURPHY	1
35	670350	BALL JOINT, 3/8" -24, W/STUD	2
	33964	BACK-UP ALARM SWITCH	N/S
	720290	SOLONOID (EXTRA)	N/S
	720110	HORN	N/S
	982250	HEAD LIGHT SWITCH	N/S

FIGURE 21. CARRIER ASSEMBLY

FIG ITEM	PART NUMBER	NOMENCLATURE 123456	UNITS PER ASSY
1		HOUSING, REAR AXLE	1
2	ST2007A	BEARING, CONE (DIFFERENTIAL)	1
3	565919-1	BEARING, CUP (DIFFERENTIAL)	1
4		GEAR, RING AND PINION	1
5	917217R1	BEARING, CUP (PINION OUTER)	1
6	306276C91	BEARING, CONE (PINION OUTER)	1
7		CAP, BEARING RETAINER	1
8	69023R92	BEARING ASSEMBLY (STRAIGHT ROLLER)	1
9	454755C1	SEAL, OIL	1
10	306276C91	BEARING, CONE (PINION INNER)	1
11	917217R1	BEARING, CUP (PINION INNER)	1
12	584255C1	BOLT, HEX (STANDARD)	1
13	54557H	WASHER, FLAT	1
14	077HN103	NUT, HEX	1
15	R30SS101	SLEEVE, TRANSMISSION SHAFT	1

FIGURE 26. DECAL PLACEMENT

FIG ITEM	PART NUMBER	NOMENCLATURE 123456	UNITS PER ASSY
	160210SRV	DECAL KIT	
1		BELOW VALVE BANK ON LEFT SIDE	1
2		INSIDE CAB, LEFT SIDE AGAINST OUTSIDE PANEL	1
3		ON LEFT SIDE OF THE HOOD	1
4		ON RIGHT SIDE, CENTERED & ONE QUARTER DISTANCE FROM TOP	1
5		ON TOP PLATE OF SCARIFIER, Y2" FROM EDGE, BOTH SIDES	1
6		LEFT SIDE HOOD PANEL, BELOW FILTER VIEWING HOLE	1
7		ON SADDLE LIFT CYLINDER SUPPORT, CENTERED FACING OPERATOR, ALSO CENTERED ON TOP OF CONSOLE	1
8		ON THE REAR FRAME, RED TO OUTSIDE COMERS	1
9		RIGHT SIDE OF CONSOLE, BELOW WARNING LIGHT	1
10		LEFT SIDE, UPPER LEFT COMER OF HYDRAULIC TANK	1
11		CENTERED BELOW STEERING WHEEL ON CONSOLE	1
12		BELOW VALVE BANK, ON LEFT LOWER SIDE OF VALVE COVER PANEL	1
13		RIGHT SIDE, CENTERED AND CLOSE TO TOP OF FUEL TANK	1
14		INSIDE CAB, AHEAD OF LEFT SIDE CONTROL LEVERS	1
15		ON CANOPY CROSS SUPPORT, MOUNTED TO CENTER PLATE	1
16		INSIDE CAB, ON VALVE COVER PANEL ALIGNED TO CORRECT VALVES	1
17		RIGHT SIDE, ON VALVE BANK SUPPORT HOUSING	1
18		INSIDE CAB, ON TOP OF INSTRUMENT PANEL	1
19		LEFT SIDE, MOUNTED TO VALVE BANK SUPPORT HOUSING	1
20		INSIDE CAB, LEFT SIDE OF SEAT TO THE REAR OF CONTROL LEVER	1
21		INSIDE CAB, LEFT SIDE OF SEAT TO THE REAR OF CONTROL LEVER	1
22		BOTH SIDES ON CANOPY SUPPORT COLUMNS, AS SHOWN	1
23		RIGHT SIDE OF SEAT AHEAD OF PARKING LEVER	1
24		RIGHT SIDE OF SEAT TO THE RIGHT OF CONTROL LEVER	1
25		RIGHT SIDE CENTERED TO TOOL BOX DOOR	1
26		ON LIFT CYLINDER SUPPORT, CENTERED FACING FRONT	1
27		RIGHT BOOM FROM GUSSET OF LIFT CYLINDER SUPPORT FORWARD	1
27A		LEFT BOOM FROM GUSSET OF LIFT CYLINDER SUPPORT FORWARD	1
28		UNDER "POWERED BY CUMMINS" ON DECAL NO.	1
29		REAR PANEL OF HOOD	1
30		ON FRAME FROM REAR COMER TOWARD FRONT, BOTH SIDES	1

CLICK HERE TO **DOWNLOAD** THE COMPLETE MANUAL

- Thank you very much for reading the preview of the manual.
- You can download the complete manual from: www.heydownloads.com by clicking the link below



- Please note: If there is no response to CLICKING the link, please download this PDF first and then click on it.

CLICK HERE TO **DOWNLOAD** THE COMPLETE MANUAL