



XR620/621

Operation & Safety Manual



(702) 636-2969
(800) 497-1704

1415 W. Bonanza Rd. Las Vegas, NV 89106
www.XtremeManufacturing.com

CLICK HERE TO **DOWNLOAD** THE COMPLETE MANUAL

- Thank you very much for reading the preview of the manual.
- You can download the complete manual from: www.heydownloads.com by clicking the link below



- Please note: If there is no response to CLICKING the link, please download this PDF first and then click on it.

CLICK HERE TO **DOWNLOAD** THE COMPLETE MANUAL

Warning



Wear appropriate protective clothing. Personal protective equipment can include, but is not limited to hardhat, gloves, footwear, safety glasses or goggles, and hearing protection. Make sure clothing is snug and properly belted. **DO NOT** wear loose clothing, jewelry, watches, or anything that can catch on forklift controls, moving parts, etc. Failure to wear the proper protective clothing could result in death or serious injury.

Before Starting Forklift

Warning



Keep the Operation and Safety Manual on the forklift at all times. Contact Xtreme Manufacturing for replacement manuals.



Clearly define responsibilities and procedures for operating the forklift and all attachments. **DO NOT** proceed until you seek expert assistance from a qualified person if any doubt or question arises about the correct or safe methods for operating the forklift.



To avoid death or serious injury, carefully read and understand all instructions before operating the forklift. **DO NOT** operate, modify, repair, or maintain the forklift unless you read and understand the instructions and warnings in this and all other applicable manuals and technical publications. Follow all State and Federal health and safety laws and/or local regulations.



Consult Material Safety Data Sheets (MSDS) for chemical hazards and first aid instructions. MSDS should be available from the manufacturer or supplier of the fluid.

Warning



Perform a pre-operation inspection and functional tests at the beginning of each work shift. Perform the pre-operation inspection first. **DO NOT** perform the pre-operation inspection with the engine running or hot. Contact with moving or heated parts could cause death or serious injury.



Perform the pre-operation inspection and functional tests in an open area. Inspections and functional tests may require assistance. Keep the assistant visible and a safe distance from the forklift to prevent death or serious injury.



Become familiar with all safety and hazard labels, regulations, and procedures. Make sure all proper safety and hazard labels are attached to the forklift and remain legible.



A brief description of controls, indicators, and instruments is provided as a convenience for the operator. These descriptions **DO NOT** provide complete operation instructions. Read and understand the entire manual to prevent death, serious injury, or equipment damage.



Keep fingers and feet away from moving parts or pinch points to prevent pinching or crushing. **DO NOT** allow anyone between the tires and the forklift frame while operating the forklift. Doing so can result in death or serious injury.



Always check the condition of the seat belt and mounting hardware before operating the forklift. If the seat belt or mounting hardware is defective, it may not properly restrain the operator, resulting in death or serious injury.

- **DO NOT** operate the forklift until the seat belt or mounting hardware is replaced, if worn or damaged.
- The seat belt **MUST** be worn while operating the forklift. Failure to wear the seat belt could result in death or serious injury.

Front View

(front of chassis)

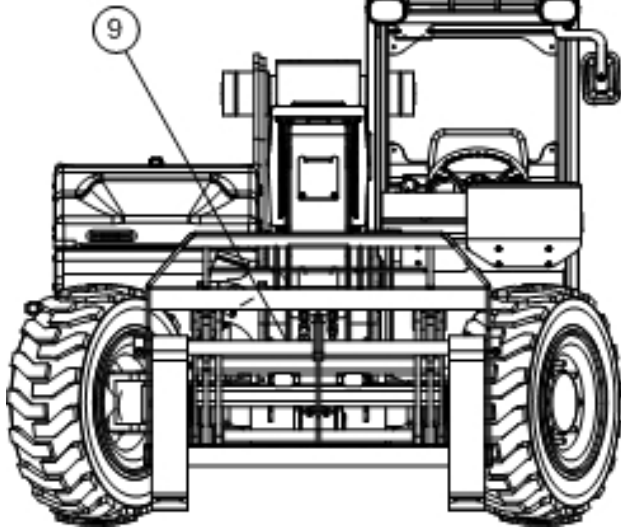

Figure 3-3. Label Legend Front View.

Rear View

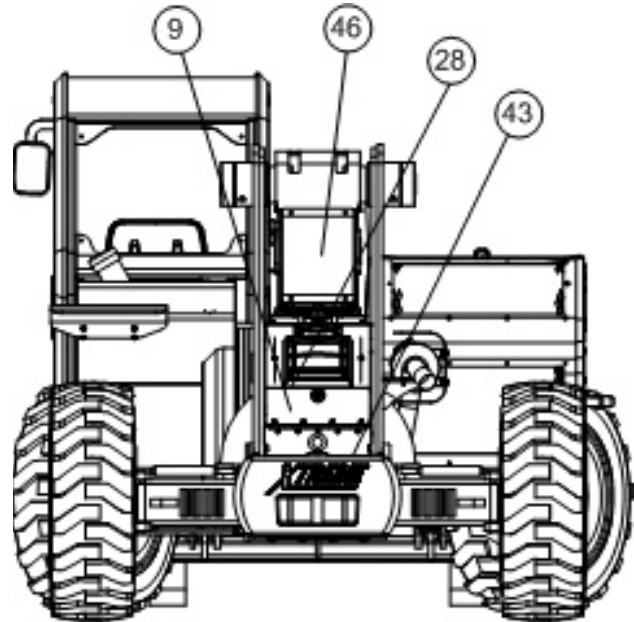

Figure 3-4. Label Legend Rear View.

Cab View

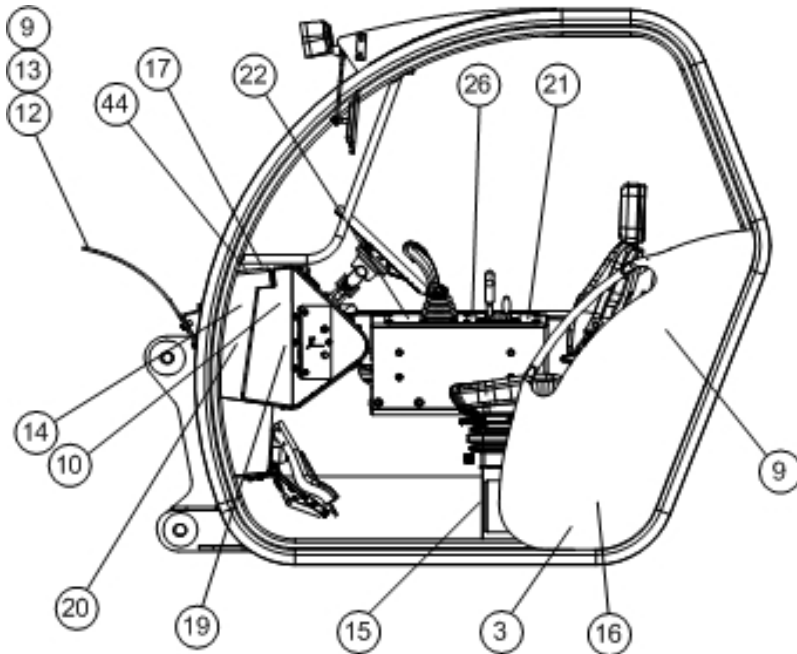

Figure 3-5. Label Legend Cab View.

THIS PAGE INTENTIONALLY LEFT BLANK

Declutch Switch

The Declutch switch (in conjunction with the service brake) disengages the hydrostatic drive to prevent the forklift from moving while raising or lowering a load.

- When the Declutch switch is set to ON and the service brake applied, the hydrostatic drive is disengaged.
- When the Declutch switch is set to OFF, the hydrostatic drive remains engaged when the travel select lever is set to either FORWARD or REVERSE.



Figure 6-29. Declutch Switch.

Boom Control

The boom control handle has variable motions from the center position that control boom and tilt functions.



Figure 6-30. Boom Control Handle.

The boom control handle is used to raise, lower, extend, retract the boom, and tilt the attachment.

NOTE: The boom control handle is a variable speed control. Function speed is proportional to handle movement. The more the handle is moved in the appropriate direction, the faster the corresponding function will occur.

NOTE: Increasing engine speed can increase boom lift and extend speed.

NOTE: Two (2) boom functions can be performed at the same time by moving the handle into the corner between two (2) functions. For example, moving the handle to the forward, left corner will lower and retract the boom at the same time.

Before Starting Forklift

Warning



Failure to use proper safety procedures when mounting and dismounting the forklift could result in death or serious injury.

- Keep steps clear of dirt, mud, snow, ice, debris, and other hazards.
- Face the forklift for mounting or dismounting. Use hand holds and steps to maintain three (3) points of contact at all times, either both hands and one foot or both feet and one hand.
- DO NOT use the controls, steering wheel, or foot pedals as hand holds or steps. Avoid accidentally engaging or disengaging a control.



DO NOT jump from the forklift. Clothing can get caught on pedals, levers, or other protruding parts. Landing on uneven surfaces could result in death or serious injury.

1. Master battery disconnect on.
2. Use safe mounting/dismounting procedures to enter the operator cab.
3. Adjust the operator seat for position and comfort. (Refer to Seat Adjustment section in this manual)
4. Adjust mirrors (this may require assistance).
5. Fasten seat belt.
6. Make sure the travel select lever is set to NEUTRAL (N) and the Parking Brake is ON (engaged).

NOTE: The engine will only start when the travel select lever is in NEUTRAL (N) and the Parking Brake switch is ON (engaged).



Figure 7-5. Travel Select Lever Must Be In NEUTRAL (N) To Start The Reach Forklift.

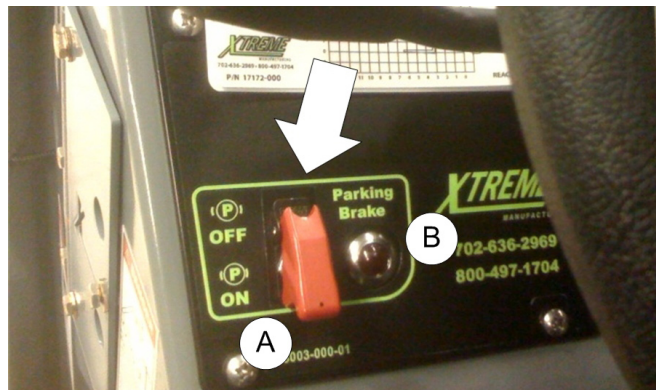

Figure 7-6. Parking Brake Switch (A) Must Be ON (Engaged) To Start The Reach Forklift.

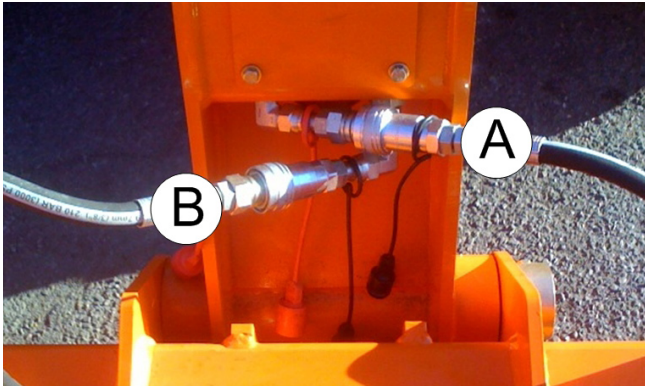

Figure 7-25. Disconnect Quick Attach Couplers. (A) Male Coupler. (B) Female Coupler.

7. Remove quick attach pin keeper.

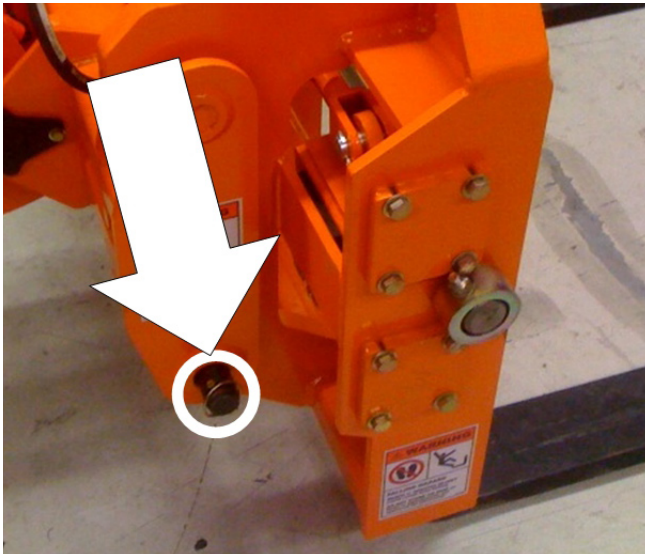

Figure 7-26. Remove Quick Attach Pin Keeper.

8. Remove the pin at the bottom of the adapter.

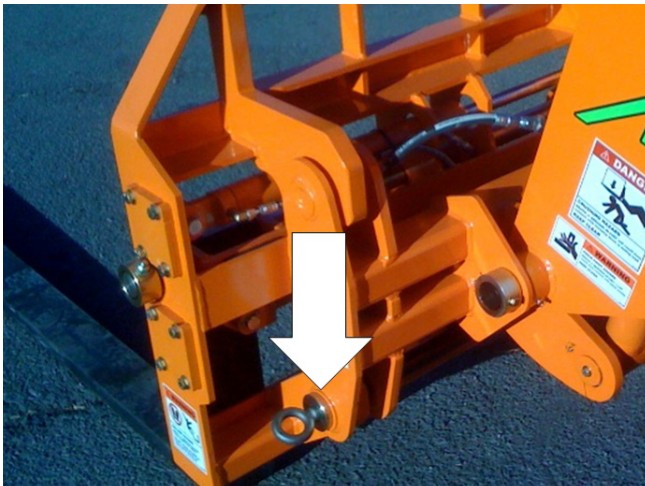

Figure 7-27. Pull Pin from Attachment and Quick Attach Adapter.

For information call (800) 497-1704

9. Lower the attachment to the ground in a level position.



Figure 7-28. Lower Attachment to Ground in Level Position.

10. Tilt and lower boom until pivot pins (A) have disconnected from attachment hooks (B).

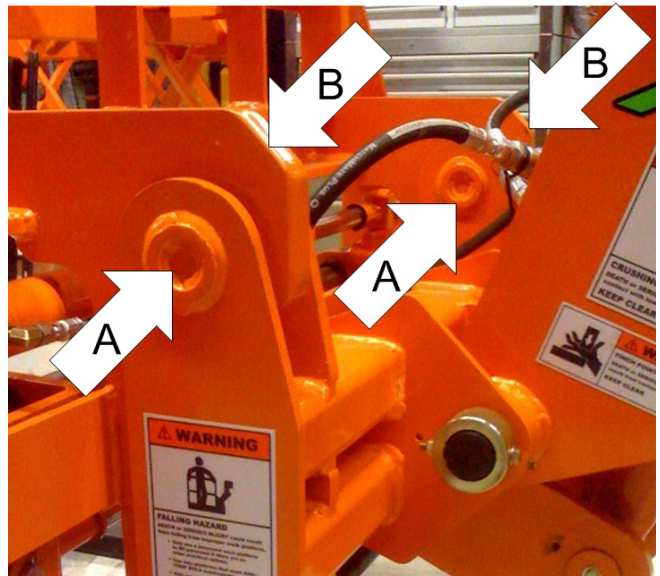

Figure 7-29. Tilt and Lower Boom to Release Pivot Pins (A) from Attachment Hooks (B).

11. Retract the boom to fully disconnect the attachment from the quick attach link.

CLICK HERE TO **DOWNLOAD** THE COMPLETE MANUAL

- Thank you very much for reading the preview of the manual.
- You can download the complete manual from: www.heydownloads.com by clicking the link below



- Please note: If there is no response to CLICKING the link, please download this PDF first and then click on it.

CLICK HERE TO **DOWNLOAD** THE COMPLETE MANUAL