



XR1270

Operation & Safety Manual



(702) 636-2969
(800) 497-1704

1415 W. Bonanza Rd. Las Vegas, NV 89106
www.XtremeManufacturing.com

CLICK HERE TO **DOWNLOAD** THE COMPLETE MANUAL

- Thank you very much for reading the preview of the manual.
- You can download the complete manual from: www.heydownloads.com by clicking the link below



- Please note: If there is no response to CLICKING the link, please download this PDF first and then click on it.

CLICK HERE TO **DOWNLOAD** THE COMPLETE MANUAL

Warning



Wear appropriate protective clothing. Personal protective equipment can include, but is not limited to hardhat, gloves, footwear, safety glasses or goggles, and hearing protection. Make sure clothing is snug and properly belted. **DO NOT** wear loose clothing, jewelry, watches, or anything that can catch on forklift controls, moving parts, etc. Failure to wear the proper protective clothing could result in death or serious injury.

Before Starting Forklift

Warning



Keep the Operation and Safety Manual on the forklift at all times. Contact Xtreme Manufacturing for replacement manuals.



Clearly define responsibilities and procedures for operating the forklift and all attachments. **DO NOT** proceed until you seek expert assistance from a qualified person if any doubt or question arises about the correct or safe methods for operating the forklift.



To avoid death or serious injury, carefully read and understand all instructions before operating the forklift. **DO NOT** operate, modify, repair, or maintain the forklift unless you read and understand the instructions and warnings in this and all other applicable manuals and technical publications. Follow all State and Federal health and safety laws and/or local regulations.



Consult Material Safety Data Sheets (MSDS) for chemical hazards and first aid instructions. MSDS should be available from the manufacturer or supplier of the fluid.

Warning



Perform a pre-operation inspection and functional tests at the beginning of each work shift. Perform the pre-operation inspection first. **DO NOT** perform the pre-operation inspection with the engine running or hot. Contact with moving or heated parts could cause death or serious injury.



Perform the pre-operation inspection and functional tests in an open area. Inspections and functional tests may require assistance. Keep the assistant visible and a safe distance from the forklift to prevent death or serious injury.



Become familiar with all safety and hazard labels, regulations, and procedures. Make sure all proper safety and hazard labels are attached to the forklift and remain legible.



A brief description of controls, indicators, and instruments is provided as a convenience for the operator. These descriptions **DO NOT** provide complete operation instructions. Read and understand the entire manual to prevent death, serious injury, or equipment damage.



Keep fingers and feet away from moving parts or pinch points to prevent pinching or crushing. **DO NOT** allow anyone between the tires and the forklift frame while operating the forklift. Doing so can result in death or serious injury.



Always check the condition of the seat belt and mounting hardware before operating the forklift. If the seat belt or mounting hardware is defective, it may not properly restrain the operator, resulting in death or serious injury.

- **DO NOT** operate the forklift until the seat belt or mounting hardware is replaced, if worn or damaged.
- The seat belt **MUST** be worn while operating the forklift. Failure to wear the seat belt could result in death or serious injury.

Front View

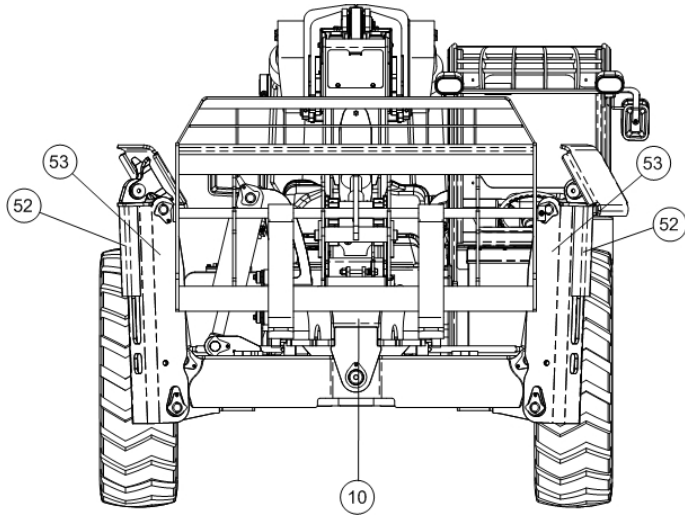

Figure 3-3. Label Legend Front View.

Rear View

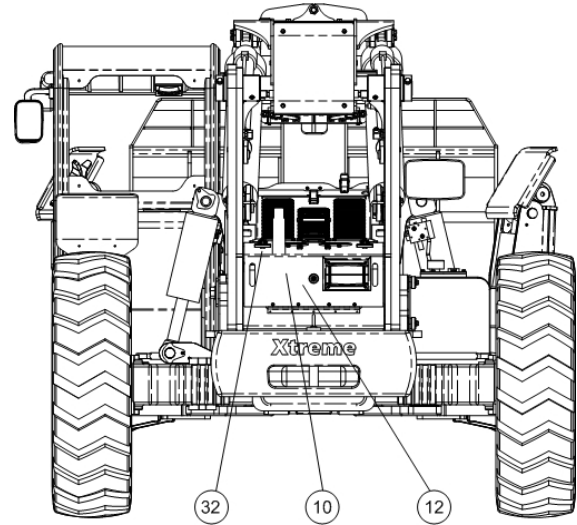

Figure 3-4. Label Legend Rear View.

Cab View

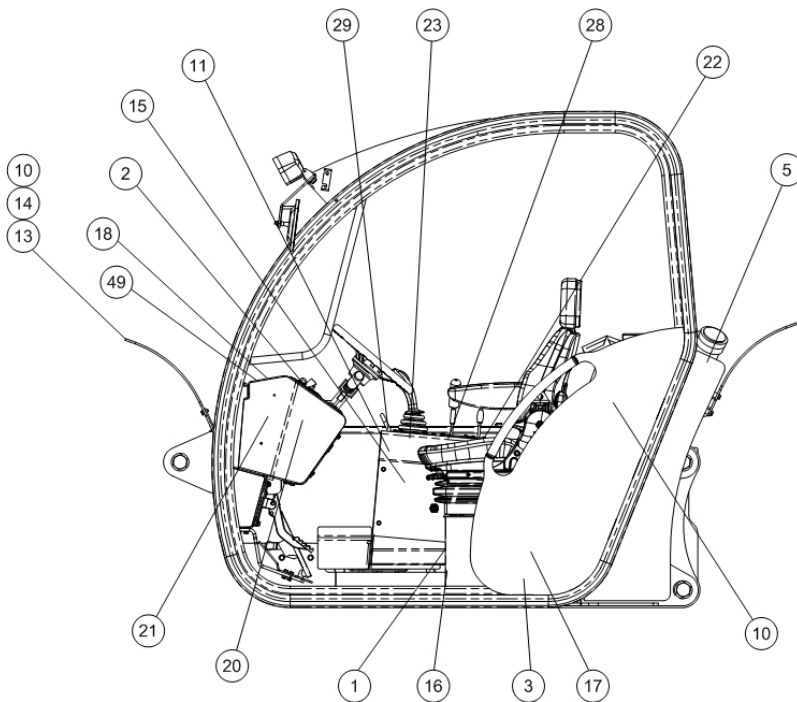
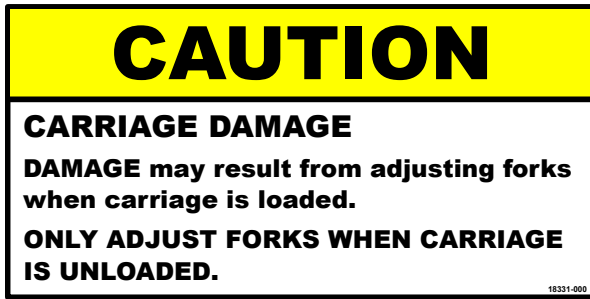
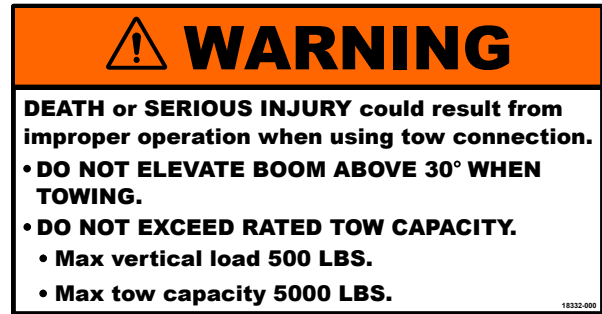

Figure 3-5. Label Legend Cab View.



49) 18331-000



50) 18332-000



51) 18307-001



52) 18306-001



53) 18306-000

Low Brake Pressure Indicator

The low brake pressure indicator illuminates if the hydraulic brake oil pressure gets low.

If the low brake pressure indicator is illuminated, do not release parking brake or engage transmission until light is out. If light does not go out, stop the forklift, follow proper shut down procedures, tag the forklift with "Do Not Operate" tags, and have a qualified mechanic service or repair the forklift **BEFORE** placing it into service again.

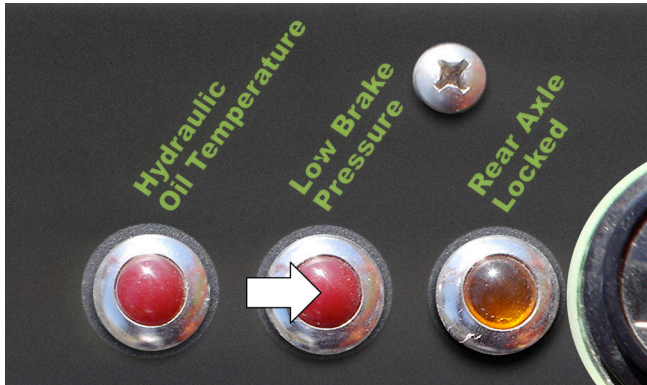

Figure 6-21. Low Brake Pressure Indicator.

Rear Axle Lock Indicator

The rear axle lock indicator illuminates when the forklift is in the axle lock mode. The rear axle locks when the parking brake is set to ON (engaged), or the transmission is in NEUTRAL or the service brake is applied, and when the boom is above 40°.

If the rear axle lock indicator does not illuminate, stop the forklift, follow proper shut down procedures, tag the forklift with "Do Not Operate" tags, and have a qualified mechanic service or repair the forklift **BEFORE** placing it into service again.

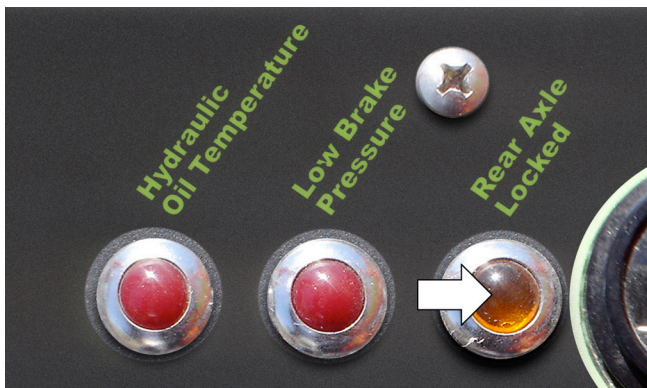

Figure 6-22. Rear Axle Lock Indicator.

Hourmeter

The hourmeter indicates and records engine operating hours and has a total readout of 9,999.9 hours. Use the hourmeter to establish a forklift maintenance schedule.

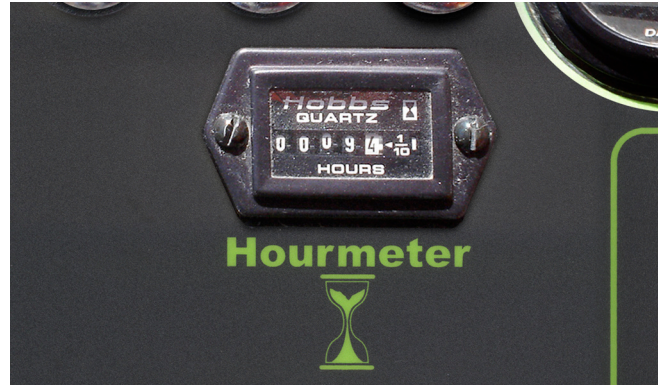

Figure 6-23. Hourmeter.

Voltage Gauge

The voltage gauge indicates the amount of charge (in volts). Normal system voltage is between 11 and 15 volts.

If the voltage gauge shows abnormal readings, stop the forklift, follow proper shut down procedures, tag the forklift with "Do Not Operate" tags, and have a qualified mechanic service or repair the forklift **BEFORE** placing it into service again.

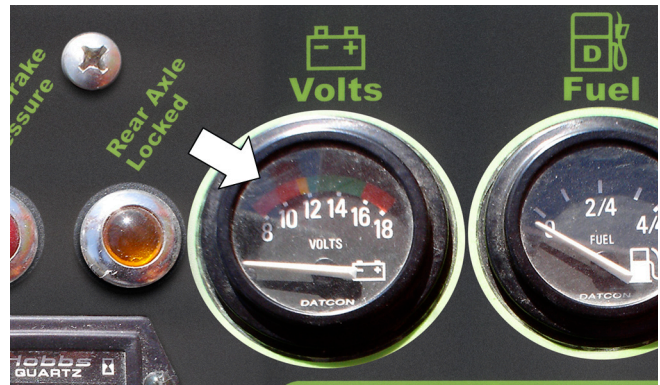

Figure 6-24. Voltage Gauge.

Pre-Operation Inspection Checklist

Walk around the ENTIRE forklift while visually performing the pre-operation inspection.

- Check that "Do Not Operate" tags have not been placed on the forklift.
- Check that load capacity charts are legible.
- Check that frame level indicator is working properly.
- Check condition and operation of the seat belt and mounting hardware.
- Check that Operation and Safety Manual is in the protective case and legible.
- Check forks for welds, cracks, misalignment, or any other damage.
- Check that carriage assembly crossbar is straight and in place to prevent forks from changing position or coming off the carriage.
- Check all hydraulic hoses and hose connections for wear or leaks.
- Check tilt cylinder for leaks or any other damage.
- Check boom for straightness or any other damage.
- Check all four (4) tires and wheels for:
 - Punctures, cracks, cuts, gouges, bulges, foreign objects, or any other damage to tires.
 - Loose or missing lug nuts.
 - Bent flanges or any other damage to rims.
- Check front and rear sway cylinders and hoses for leaks or any other damage.
- Check mirrors for cracks, cleanliness, and proper adjustment.
- Check hydraulic reservoir sight gauge for proper fluid level. Add hydraulic fluid, if necessary.
- Check engine compartment for:
 - Loose or damaged belts, hoses, and radiator blades.
 - Coolant reservoir level. Add radiator coolant, if necessary.
 - Engine oil level. Add engine oil, if necessary.
 - Electrical wires and connectors.
- Check transmission fluid level.
- Check front and rear axles for leaks or any other damage.
- Check main boom cylinders and hydraulic lines for leaks or any other damage.
- Check battery terminals for corrosion.
- Check battery for cracked, melted, or damaged case.
- Check electrical connections on rear sway cylinder.
- Check that all labels are legible. Replace any damaged or illegible labels.
- Check that operator's cab is empty of all trash, debris, or any loose items.
- Check that personal belongings are secured in the personal storage box.
- Check that pedals, and non-skid surfaces are clean and free of grease, oil, dirt, snow, or ice.

Date: _____ Initials: _____

The maximum load capacity for this forklift is 12,000 pounds (5,443 kilograms). The matched pair or set of forks used on this forklift should have total load ratings which equal or exceed 12,000 pounds (5,443 kilograms). When the load rating of the forklift differs from the load capacity of the forks, the lower value becomes the overall load capacity.

Standard Carriage Operation

The standard carriage uses manually adjustable forks and can be tilted up or down by using the thumb switch on the control handle.

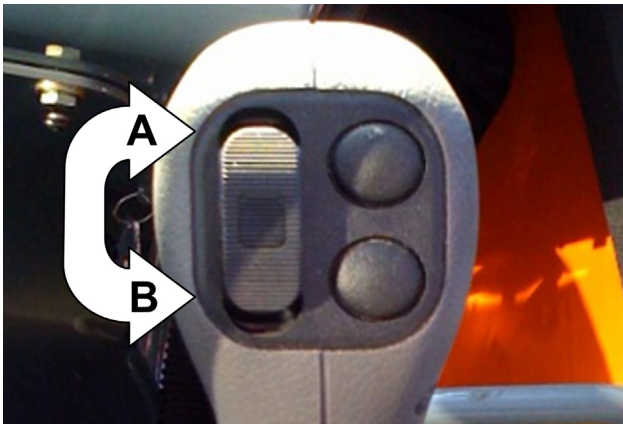

Figure 7-18. Attachment Tilt Control Switch. (A) Attachment Tilt Down. (B) Attachment Tilt Up.

Swing Carriage Operation (Optional)

The swing carriage pivot left or right using the auxiliary attachment control lever.



Figure 7-19. Auxiliary Attachment Control Lever.

Warning



Hydraulic attachments have a maximum hydraulic pressure rating. Failure to make sure the attachment is equipped with a pressure reducing valve, or is rated to be equal or greater than 4,000 psi (276 bar), which is the maximum pressure of the forklift auxiliary hydraulic system at the quick-disconnect couplers, could result in death or serious injury.

When the auxiliary attachment control lever is moved right or left it activates hydraulic pressure through the quick attach couplers to move the carriage.

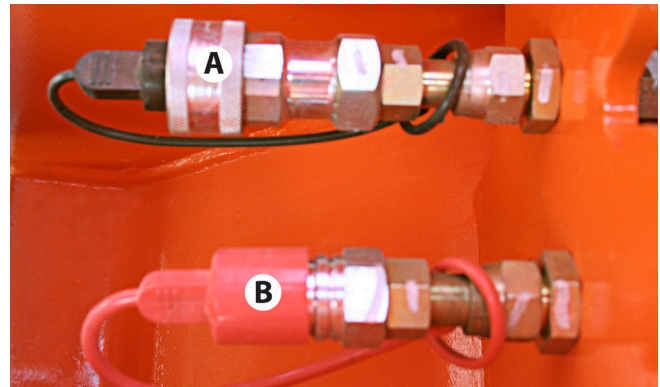

Figure 7-20. Quick Attach Couplers For Hydraulic Systems. (A) Female Coupler. (B) Male Coupler.

Quick Attach System

This forklift includes a quick attach system that allows for easy attachment changes. Perform attachment connection and removal procedures on level ground.

Attachment Connection

Warning



Improper connection of an auxiliary attachment can result in death or serious injury. Attachments not locked into place could become unstable and fall on the operator or other personnel near the forklift, which could result in death or serious injury.

- Make sure attachment locking devices are always in place.
- DO NOT operate the forklift until you have positive indication that the quick attach pin and lock lever are fully engaged.

Standard Carriage Load Capacity Chart

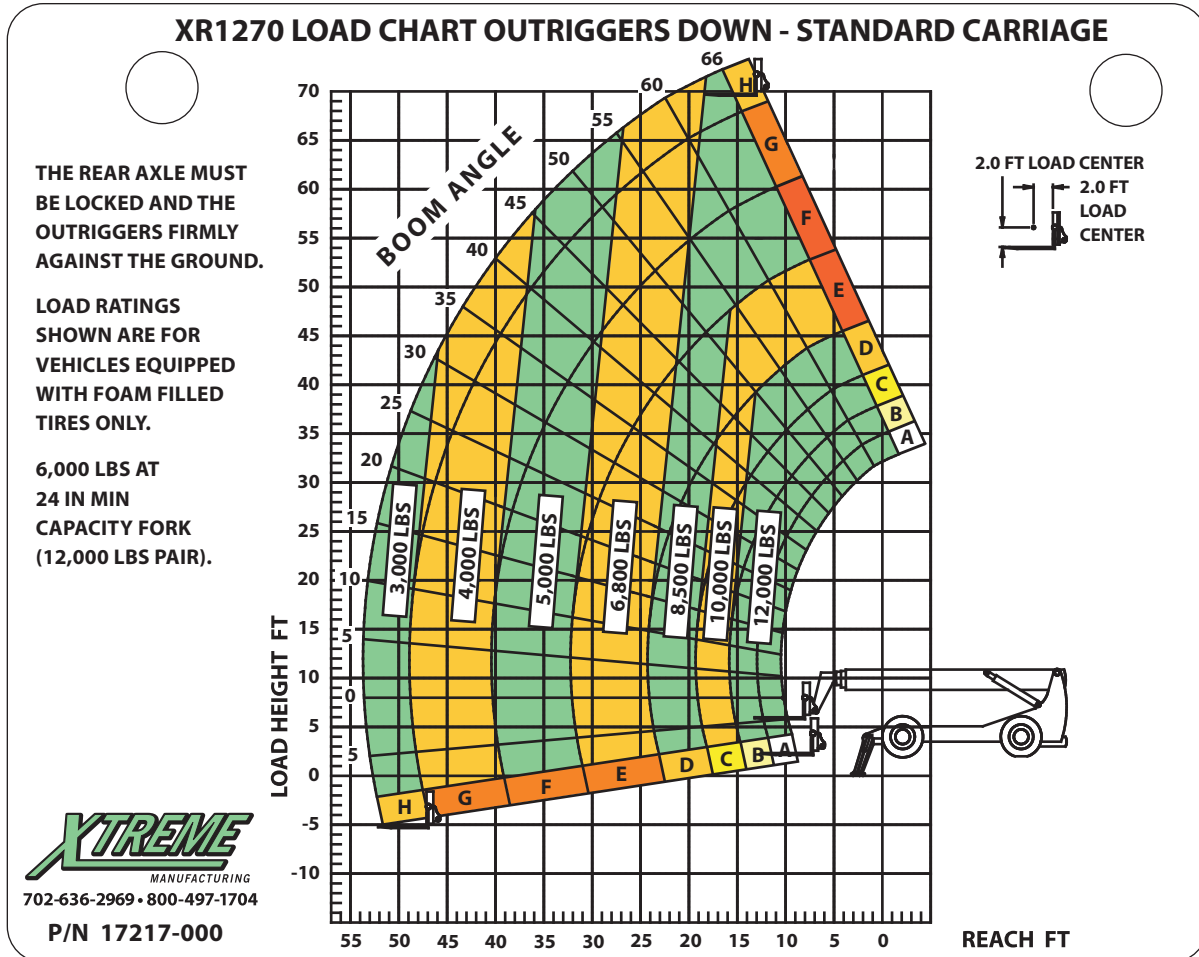

Figure 7-40. Standard Carriage Load Capacity Chart

CLICK HERE TO **DOWNLOAD** THE COMPLETE MANUAL

- Thank you very much for reading the preview of the manual.
- You can download the complete manual from: www.heydownloads.com by clicking the link below



- Please note: If there is no response to CLICKING the link, please download this PDF first and then click on it.

CLICK HERE TO **DOWNLOAD** THE COMPLETE MANUAL