

Operation Manual

Truck Mounted Crane **GS-900BR**

Model: GS-900BR-1
Serial No.: 291126-

Operate this machine only after reading this Manual.
Keep this Manual in the cab so that it can be reviewed
at any time.

CLICK HERE TO **DOWNLOAD** THE COMPLETE MANUAL

- Thank you very much for reading the preview of the manual.
- You can download the complete manual from: www.heydownloads.com by clicking the link below



- Please note: If there is no response to CLICKING the link, please download this PDF first and then click on it.

CLICK HERE TO **DOWNLOAD** THE COMPLETE MANUAL

Crane Control System

In Cab (ISO Layout)

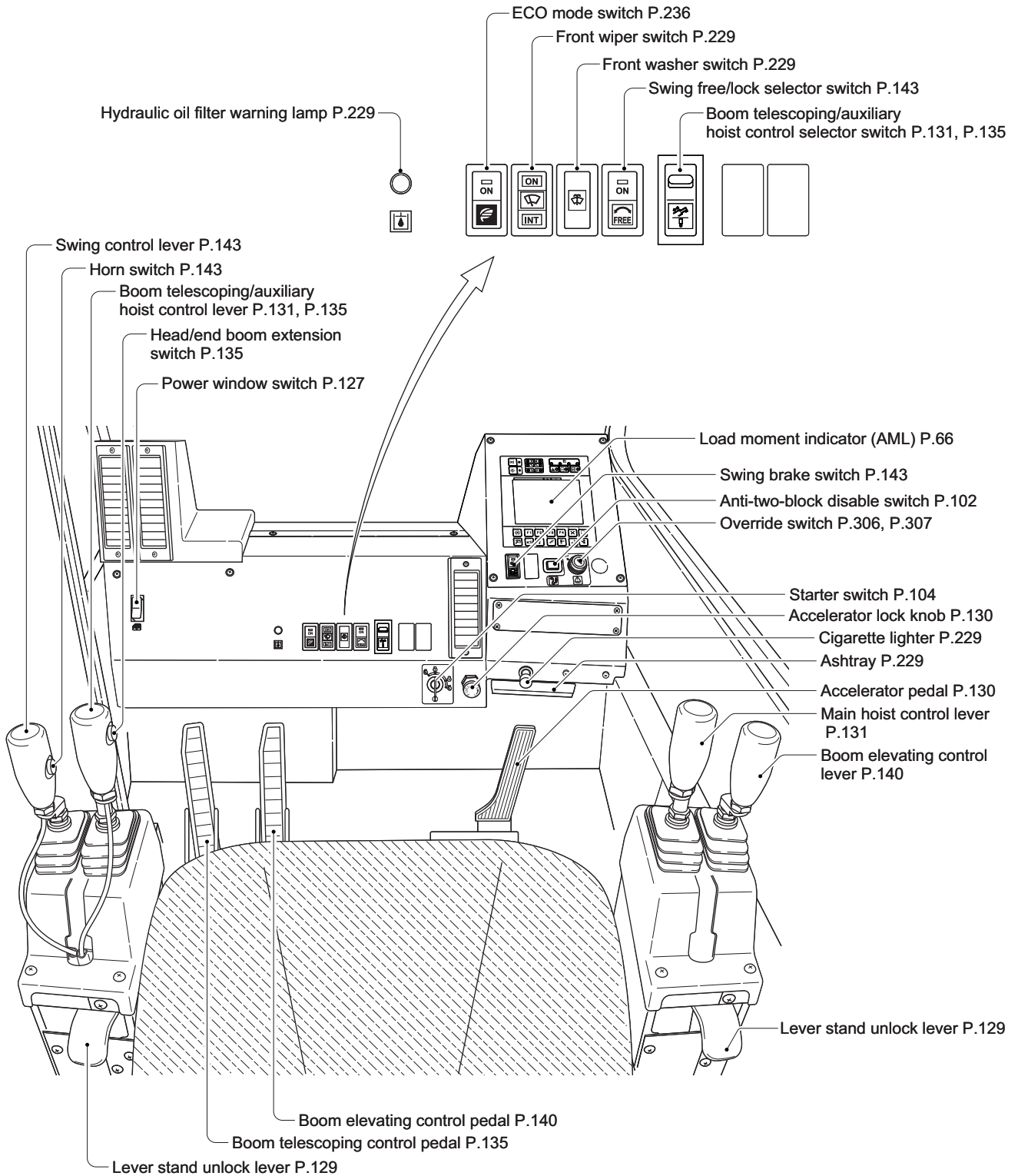

K07294-00E

Precautions for Traveling on Roads

• Observe Traveling Conditions

The laws and regulations in the destined countries and regions may restrict some road traveling conditions. Check the traveling conditions for the vehicle before traveling, and observe all the laws and regulations applicable to the vehicle.

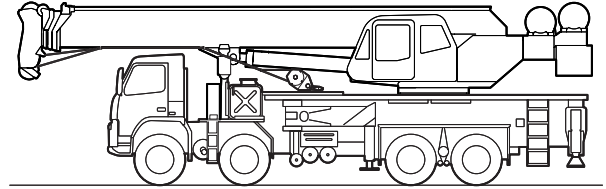

K07818-000

• Do not Travel with Cargo Loaded

Traveling with cargos may cause unexpected accidents such as a falling of the cargo. Use a dedicated machine such as a truck to carry a cargo.

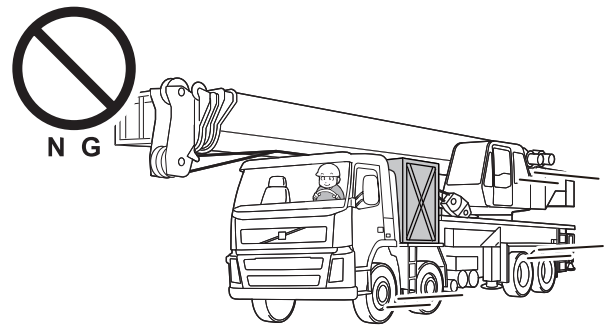

K07819-00E

• Be Careful of Overhead Objects

Accidents may occur depending on the height of overhead objects such as electric wires. When traveling, check the major specifications, and be careful of the overhead clearance from the overhead objects such as the electric wires for the trains, overpasses, and tunnels.

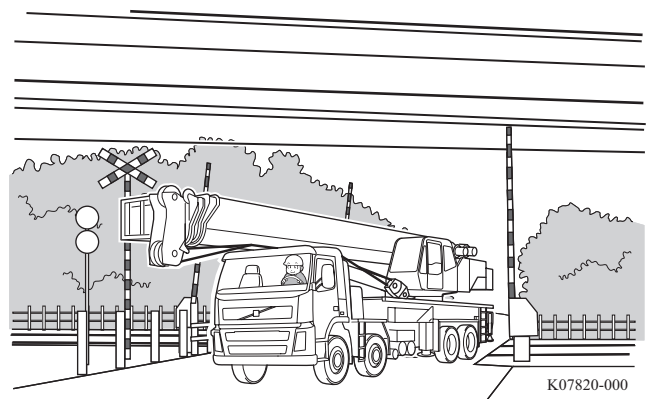

K07820-000

• Drive Safely

Always keep a safe distance when following any vehicle. Drive at moderate speeds.

Turning the steering wheel too rapidly can overturn the crane.

Avoid abrupt driving practices such as speeding, sudden starts, extreme braking or sharp steering.

• Precaution When Jib is Mounted (1)

Do not lift individual loads by the boom and jib respectively. The boom and jib may be damaged, or the machine may overturn.

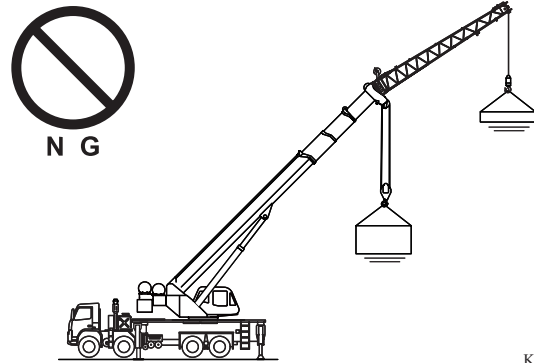

K04597-00E

• Precautions When Jib is Mounted (2)

When you lift up a single load using both main and auxiliary winches, observe the following points in accordance with the rated lifting capacity table.

- Register the boom status as jib lift.
- Make sure that the mass of the load including the lifting devices is within the rated lifting capacity for jib lift.

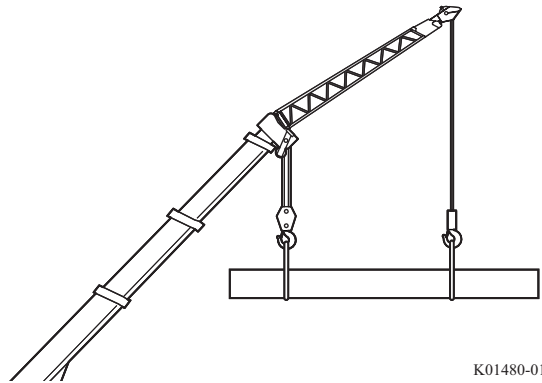

K01480-01E

If the main winch wire rope is paid out while a load is lifted, the gravity center of the load can move and cause an overload. Operate carefully so as not to cause overloading.

• Precautions When Jib is Mounted (3)

Pay attention to the followings during lifting with the boom while the jib is mounted.

- Observe the value of the rated lifting capacity chart according to the actual boom and jib condition.
- During lifting with the boom while the jib is mounted, the crane stops just before the moment ratio reaches 100 %.

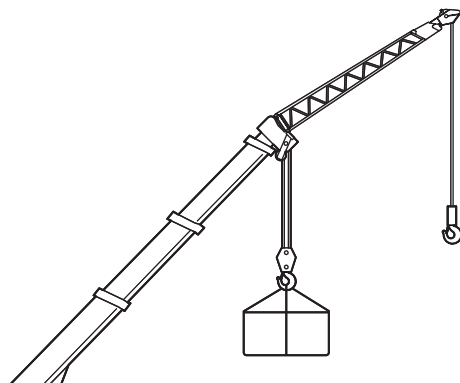

K01472-01E

(1) Caution for radiator fan

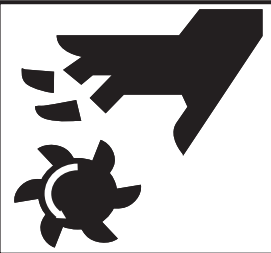
	⚠ DANGER
	Keep hands away. Fan starts automatically. Stop engine to service.
	⚠ PERIGO
	Mantenha as mãos afastadas. O ventilador liga automaticamente. Parar o motor para manutenção.

323-913-51050-0
323-913-51050-0

(4) Caution for radiator fan

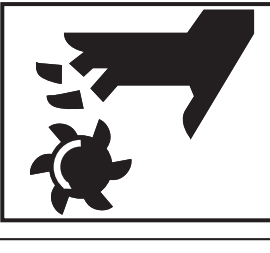
	⚠ DANGER
	Keep hands away. Fan starts automatically. Stop engine to service.
	⚠ PERIGO
	Mantenha as mãos afastadas. O ventilador liga automaticamente. Parar o motor para manutenção.

325-100-52010
325-100-52010-0

(2) Caution for counterweight cylinders

⚠ DANGER
To avoid serious injury or equipment damage, do not swing superstructure when counterweight cylinders are extended. Make sure the counterweight lock pins are inserted before swinging superstructure. Make sure the counterweight cylinders are full retracted after counterweight is removed.
⚠ PERIGO
Para evitar ferimentos graves ou danos ao equipamento, não girar a superestrutura quando os cilindros do contrapeso estiverem estendidos. Certifique-se que os pinos de trava do contrapeso estão inseridos, antes de girar a superestrutura. Certifique-se que os cilindros estão completamente retraídos após a remoção do contrapeso.

323-913-71010
323-913-71010-0

(5) Caution for being caught by boom

	⚠ DANGER
	Keep clear of lowering or raising boom to avoid serious injury.
	⚠ PERIGO
	Não se aproxime à lança em movimento para evitar ferimentos graves.

343-987-21022-0
343-987-21022-0

(6) Caution for swinging

	⚠ DANGER
	Swinging structure stay clear to prevent severe personal injury or death.
	⚠ PERIGO
	Mantenha distância da estrutura de giro para evitar ferimentos graves ou fatais.

343-987-21032-0
343-987-21032-0

(3) Caution for crushing

	⚠ DANGER
	Keep clear of moving parts to prevent severe personal injury.
	⚠ PERIGO
	Mantenha-se afastado das partes móveis para evitar ferimentos graves.

323-913-72010-0
323-913-72010-0

(7) Caution for jib mounting and stowing

⚠ DANGER
When mounting or stowing the jib, you should know and follow the TADANO instruction manual. Failure to follow the TADANO instruction manual may result in property damage and or personal injury or death.
⚠ PERIGO
Ao montar ou acondicionar o jib, deve consultar o manual de instrução da TADANO. Caso contrário, poderá resultar em dano no equipamento ou ferimentos graves.

343-987-21052-0
343-987-21052-0

12. Check the actual number of parts of line with LOAD MOMENT INDICATOR (AML-C) before operation. Maximum lifting capacity is restricted by the number of parts of line of LOAD MOMENT INDICATOR (AML-C). Limited capacity is as determined from the formula,

$$\text{Single line pull for main winch } 5,600 \text{ kg (12,300 lbs.)} \times \text{number of parts of line.}$$
13. The boom angle before loading should be greater to account for deflection. For rated lifting capacities, the loaded boom angle and the load radius is for reference only.
14. The 11.5 m (37.7') boom length capacities are based on boom fully retracted. If not fully retracted [less than 15.56 m (51') boom length], use the rated lifting capacities for the 15.56 m (51') boom length.
15. Extension or retraction of the boom with loads may be attempted within the limits of the RATED LIFTING CAPACITIES. The ability to telescope loads is limited by hydraulic pressure, boom angle, boom length, crane maintenance, etc.
16. For lifting capacity of single top, deduct the weight of the load handling equipment from the rated lifting capacity of the boom. For the lifting capacity of single top, the net capacity shall not exceed 5,600 kg (12,300 lbs.) including the main boom hook mass attached to the boom.
17. When the base jib or top jib or both jibs are removed, set the jib state switch to the REMOVED position.
18. When erecting and stowing jib, be sure to retain it by hand or by other means to prevent its free movement.
19. Use "ANTI-TWO BLOCK" disable switch when erecting and stowing jib and when stowing hook block. While the switch is pushed, the hoist does not stop, even when overwind condition occurs.
20. For boom length 44.0 m (144.4') or less and 35.87 m (117.7') or longer with jib, rated lifting capacities are determined by loaded boom angle only in the column headed "44.0 m (144.4') boom+jib".
 For boom length 35.87 m (117.7') or less with jib, rated lifting capacities are determined by loaded boom angle only in the column headed "35.87 m (117.7') boom+jib". For angles not shown, use the next lower loaded boom angle to determine allowable capacity. (telescoping MODE I)
 For boom length 44.0 m (144.4') or less and 39.93 m (131') or longer with jib, rated lifting capacities are determined by loaded boom angle only in the column headed "44.0 m (144.4') boom+jib".
 For boom length 39.93 m (131') or less with jib, rated lifting capacities are determined by loaded boom angle only in the column headed "39.93 m (131') boom+jib". For angles not shown, use the next lower loaded boom angle to determine allowable capacity. (telescoping MODE II)
21. When lifting a load by using jib (aux. winch) and boom (main winch) simultaneously, do the following:
 - Enter the operation status as jib operation, not as boom operation.
 - Before starting operation, make sure that mass of load is within rated lifting capacity for jib.
22. Before telescoping the boom, set the telescoping mode selector switch to MODE I or MODE II fully retracted. A change of the telescoping mode is not permissible when the boom has been partially or fully extended.

DEFINITIONS

1. Load Radius: Horizontal distance from a projection of the axis of rotation to supporting surface before loading to the center of the vertical hoist line or tackle with load applied.
2. Loaded Boom Angle: The angle between the boom base section and the horizontal, after lifting the rated lifting capacity at the load radius.
3. Working Area: Area measured in a circular arc about the centerline of rotation.
4. Freely Suspended Load: Load hanging free with no direct external force applied except by the hoist line.
5. Side Load: Horizontal side force applied to the lifted load either on the ground or in the air.

Display Change

When the display change key is pressed, the content in the display panel changes as follow.

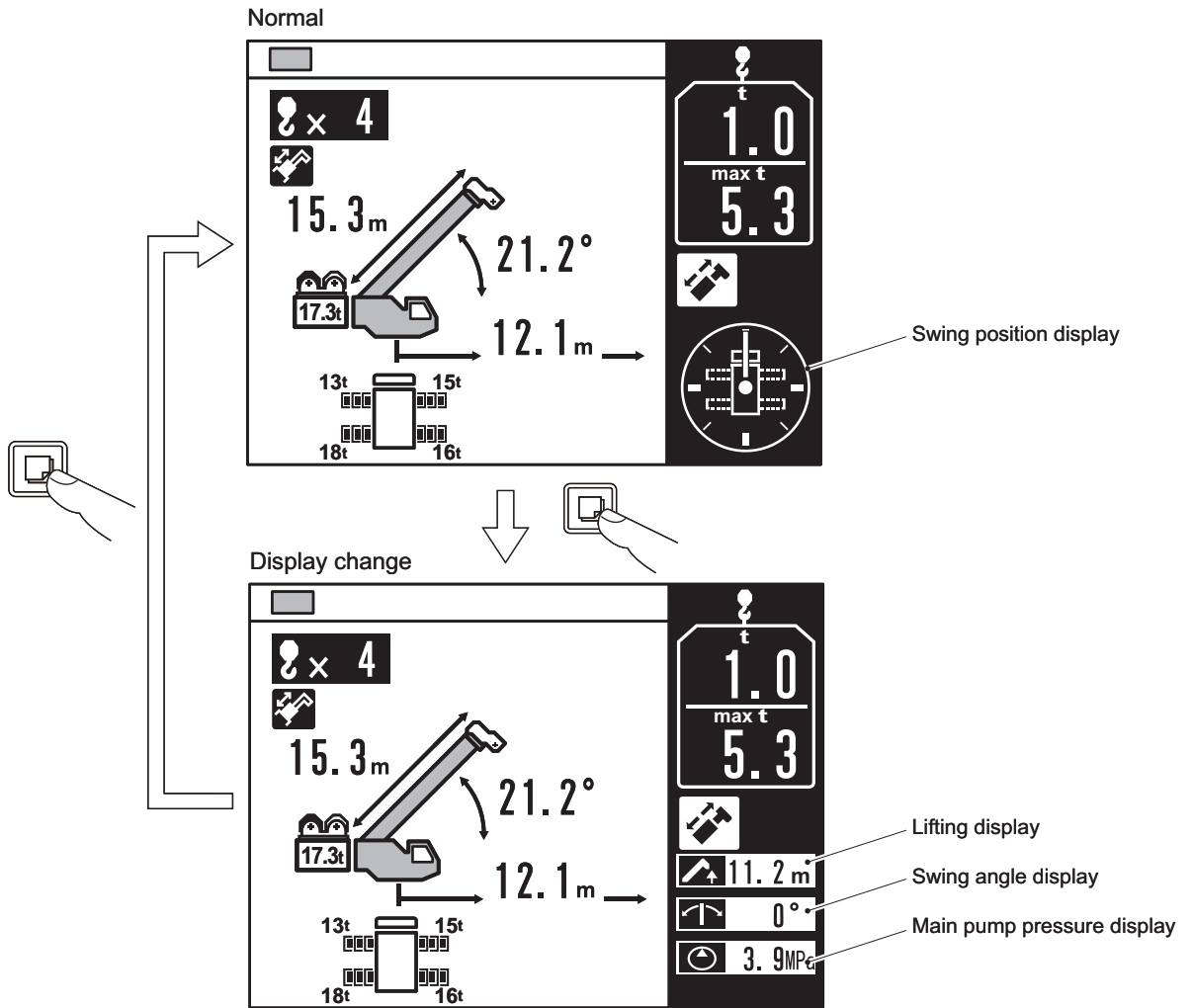

K07875-00E

15. Press the set key for registration.

- After registration is completed, the pop-up window closes and the load moment indicator returns to the crane operation status.

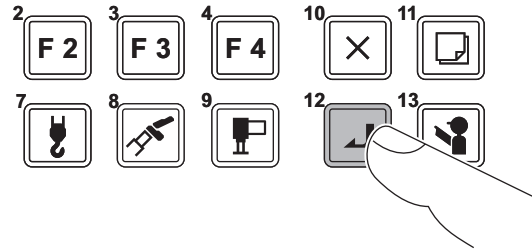

K00678-000

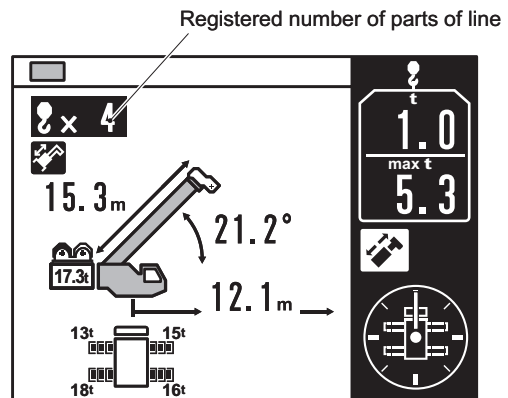
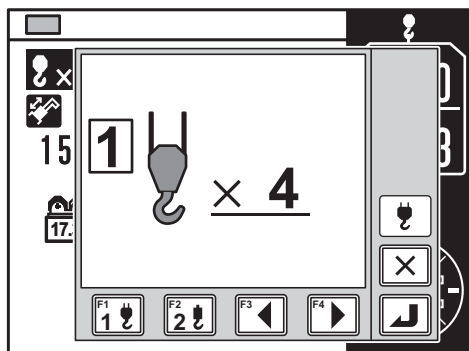

K07879-00E

16. Turn the jib status switch, and register the jib mount status.

- REMOVED: The jib is removed.
- EQUIPPED: The jib is equipped.
- When the switch is turned to "REMOVED", the jib dismount icon appears on the display panel.

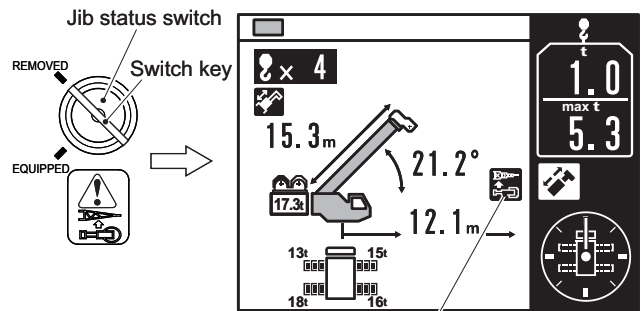

Jib dismount icon

K07880-00E

⚠ WARNING

If the position of the switch does not correspond to the actual jib mount status, the load moment indicator accuracy decreases and it may cause an overturning and damage.

☞ The mass decreases after the jib is removed, and it affects the load moment indicator load accuracy.

☞ The switch key can be inserted/ removed either in the "REMOVED" or "EQUIPPED" position.

Registration of Swing Range Limit Function

1. Press the working range limit key and select the item (left swing limit or right swing limit) to be registered.
 - The symbol for the selected item flashes.
 - Every time the working range limit key is pressed, the item to be selected changes in the following order.
 1. Lifting height limit
 2. Load radius limit
 3. Boom angle upper limit
 4. Boom angle lower limit
 5. Left swing limit
 6. Right swing limit
 - The illustration on the right shows an example of display, in which "left swing limit" is selected.

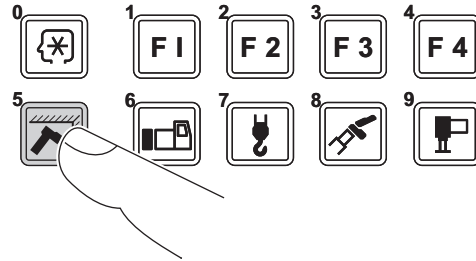

K00696-000

 Instead of the working range limit key, the F3 (Backward) key or F4 (Forward) key can be used to change the display of the item to be selected.

 To abort the registration, press the cancel key. The pop-up window closes and the load moment indicator returns to the crane operation status before registration.

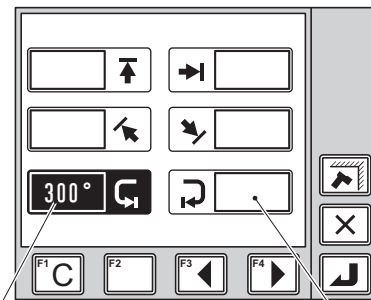

Left swing limit is highlighted.
Current swing angle is displayed.

Right swing limit

K00698-00E

Jack supporting pressure alarm setting

The upper and lower limit warning values of the jack supporting pressure can be set.

Upper limit warning of jack supporting pressure:

When the maximum supporting pressure of the 4 outrigger jacks exceeds the registered upper limit warning value, the error code "W0283" is displayed and load moment indicator built-in buzzer sounds. To stop the alarm, perform boom retracting, boom raising or winch hoisting down in order to reduce the load radius.

Lower limit warning of jack supporting pressure:

When the minimum supporting pressure of the 4 outrigger jacks falls below the registered lower limit warning value, the error code "W0282" is displayed and load moment indicator built-in buzzer sounds. To stop the alarm, perform boom retracting, boom raising or winch hoisting down in order to reduce the load radius.

1. Select the icon of jack supporting pressure alarm setting and press the set key.
 - The pop-up window for the jack supporting pressure limit registration appears.
2. Use the F3 (Upper limit warning value) or F4 (Lower limit warning value) key to choose either upper or lower limit value.
 - The selected item is highlighted.
3. Press the F1 (-) or F2 (+) key to change the value.
4. Press the set key.
 - After registration is completed, the pop-up window closes and the load moment indicator returns to the crane operation status.

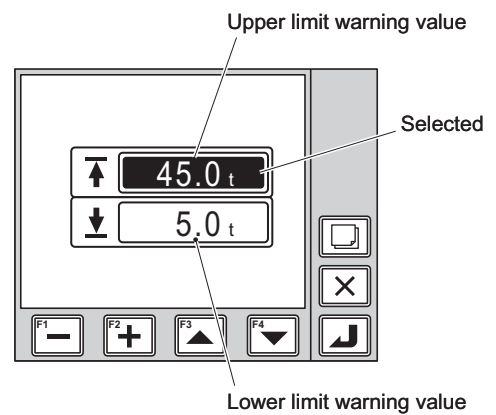

K07679-00E

 To cancel the registration, press the cancel key. The pop-up window closes and the load moment indicator returns to the crane operation status with the registration not changed.

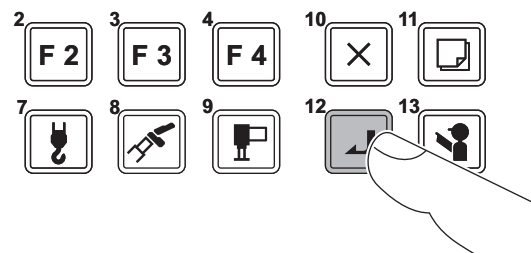

K00678-00E

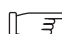
 Even after the load moment indicator is turned off, the registered information is retained. When the load moment indicator is turned on, the operation starts with the retained information.

PTO "OFF" Operation

1. Run the engine at idle.
2. Depress the clutch pedal all the way.
3. Set the PTO switch to "OFF".
 - The indication "PTO EC RSL" on the instrument panel goes out.
4. Return the clutch pedal slowly.
 - The hydraulic pump is not driven.

Instrument panel

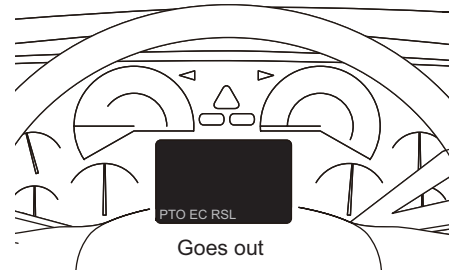

K05012-00E

9. Press the jack switch.
 - The jack switch indicator lights up.
10. Press and hold the extend switch and the central control switch until all the jack cylinders are extended fully.

NOTICE

When the jack cylinder is fully extended during jack extending operation, the pressure inside the cylinder is increased and as a result, the indicator shows a larger value than the actual one. To see the actual pressure value, retract the jacks to release the pressure enclosed. Use the pressure indicator as a reference value.

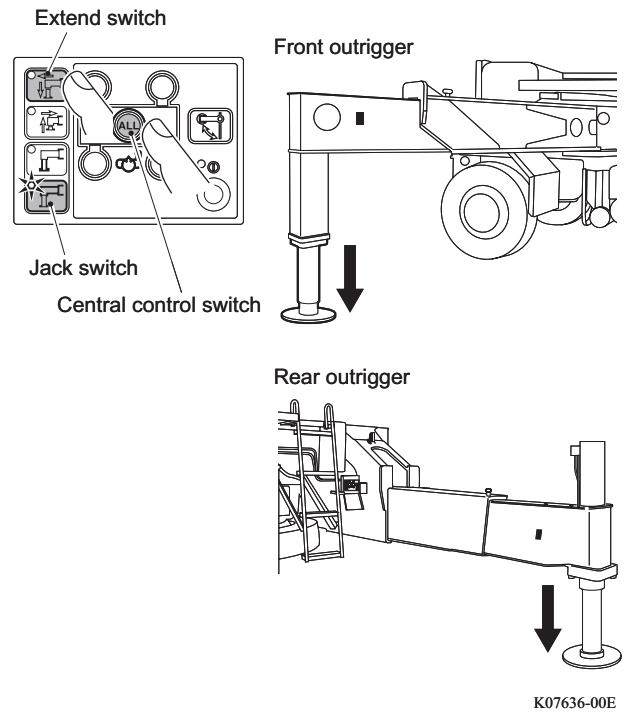

11. Check that the machine is set up horizontally using the bubble level.

If the machine is not set up horizontally, refer to "Level Set-up" (page 121) to set it up horizontally.

 - When the bubbles in the level are within the marking lines, the machine is set up horizontally.

WARNING

The machine may sometimes be supported by the 3 jack cylinders. Operation in this status may cause an overturning accident. Check the setting condition of the outrigger floats. If there is any outrigger float not contacting the ground properly, adjust it.

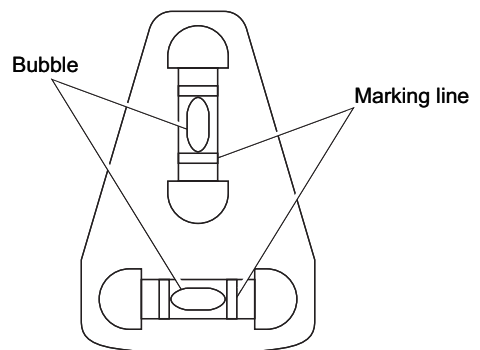

Accelerator Operation

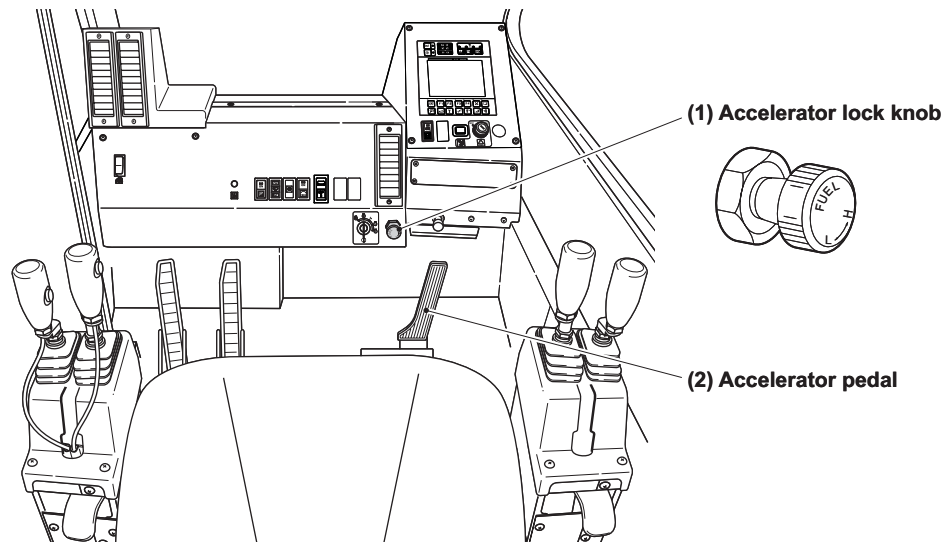

K07644-00E

(1) Accelerator Lock Knob

Used to make a fine adjustment of the engine speed by turning the knob.

When turned in the "H" direction, the engine speed increases. When turned in the "L" direction, the engine speed decreases.

(2) Accelerator Pedal

Accelerates or decelerates the engine speed from idling speed to the maximum speed depending on the depressed amount.

Boom Elevating Operation

The figures in this chapter show the ISO layout of levers and pedals.

For TADANO layout of levers and pedals, refer to "In Cab (TADANO Layout)" (page 11).

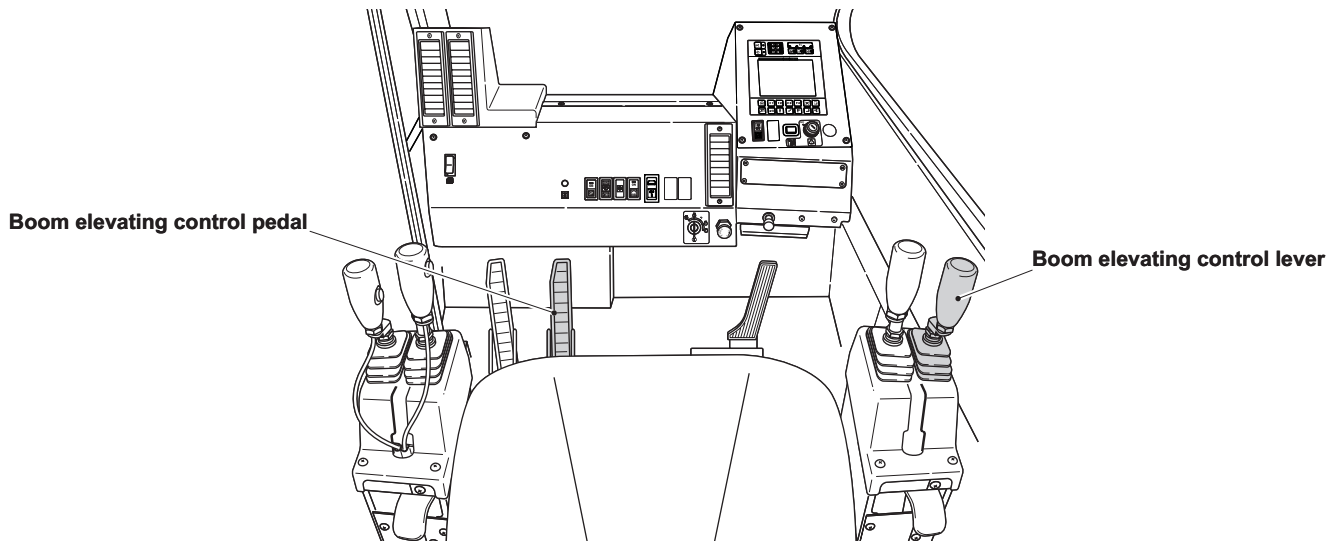

K07648-00E

Boom Elevating Operation

⚠ DANGER

Do not put your arm or head out of the window during crane operation. Otherwise, they may be caught between the boom and the cab, resulting in a fatal and serious accident.

⚠ WARNING

- Abrupt lever operation may cause the load to bounce or sway, resulting in an accident causing an injury or machine damage. Operate the lever slowly.
- Never lift a load off the ground or pull in a load by boom raising operation. The boom does not stop automatically even when an overload occurs, and it may cause an overturning accident or damage to the machine. Lift a load off the ground by the hoisting up operation.

6. Pass the wire rope through on the rope arresters under the boom using the jib handle.

 If the wire rope is too tense and you cannot put it on the rope arrester, loosen it slightly by winding down the main winch.

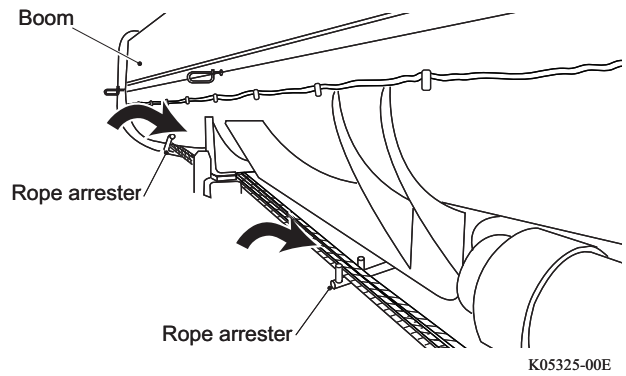

7. Lower the boom fully and stow it on the boom rest.
8. Wind up the main winch until the wire rope is tensioned slightly.

NOTICE

Be careful not to tension the wire rope too much and damage it.

9. Secure the hook block with the hook block retainer fitting.

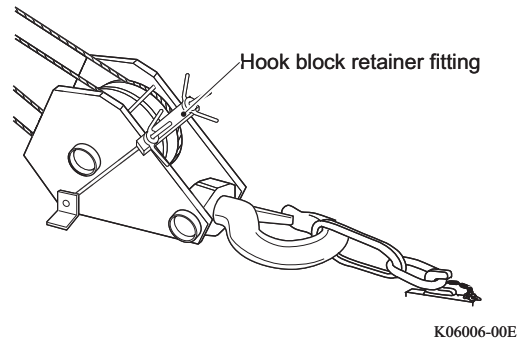

Mounting Single Top

⚠ WARNING

When working at an elevated place, use a platform and operate safely to prevent a falling accident.

1. Extend the outriggers, and set up the crane horizontally.
2. Lower the boom all the way.
3. Pull out the stowing pin, and rotate the single top forward.

⚠ CAUTION

Do not stand in the single top rotation path. The single top may rotate suddenly by its own weight, causing an injury.

 Insert the stowing pin to the original position.

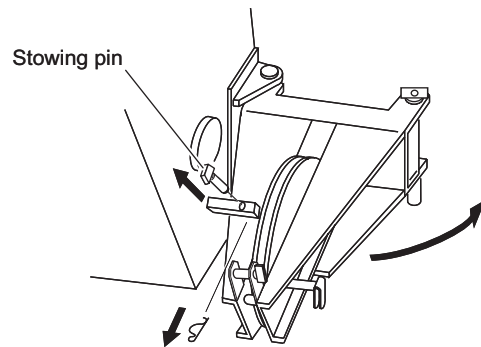

K01947-00E

4. Insert the connecting pin to fix the single top.

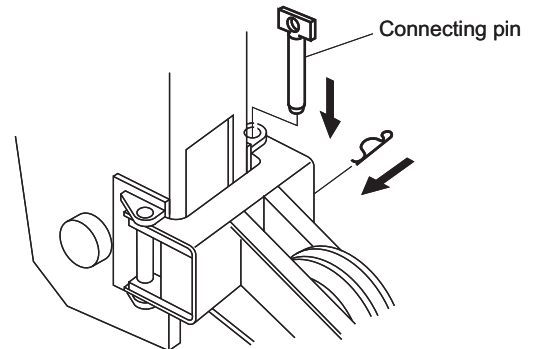

K01948-00E

CLICK HERE TO **DOWNLOAD** THE COMPLETE MANUAL

- Thank you very much for reading the preview of the manual.
- You can download the complete manual from: www.heydownloads.com by clicking the link below



- Please note: If there is no response to CLICKING the link, please download this PDF first and then click on it.

CLICK HERE TO **DOWNLOAD** THE COMPLETE MANUAL

Registration of Jib Status

⚠ WARNING

If the switch position does not correspond to the actual jib status, the load moment does not indicate the correct value of the load or it may cause an overturning and damage.

When the jib lift is not required for work, the jib can be dismantled from the crane.

When the jib is dismantled, the reduction of the mass affects the measurement of the load moment indicator.

Set the jib status switch according to the actual jib status.

“REMOVED” … The jib is dismantled.

“EQUIPPED” … The jib is mounted.

- When the switch is set to "REMOVED", the jib dismantment icon appears on the display panel of the load moment indicator.

 The switch key can be inserted/removed either when the jib status switch is in the "REMOVED" or "EQUIPPED" position.

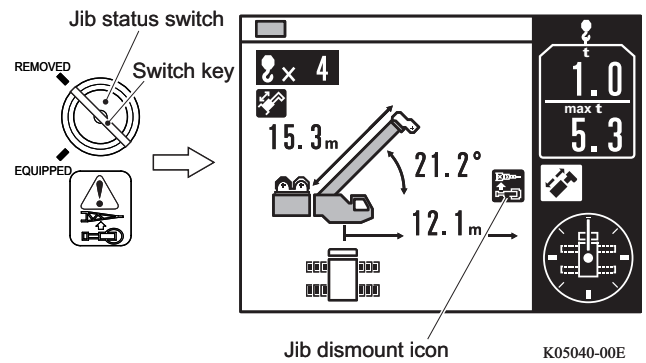

- 23.** Mount the rope socket to the bracket of the base jib with the fixing pin.

NOTICE

Mount the rope socket always in the direction as shown in the illustration. If mounted upside down, the rope socket may contact the lower surface of the jib and be damaged during hoisting operation.

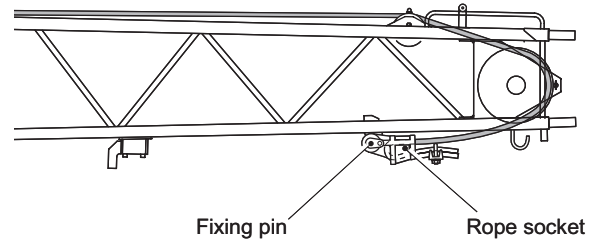

K07995-00E

Pass the wire rope under the guide roller.

- 24.** Wind up the wire rope slowly, and align the connecting pin (H) with the pin hole on the upper side of the top boom.

NOTICE

Do not extend or lower the boom. Such operations can cause damage to the jib.

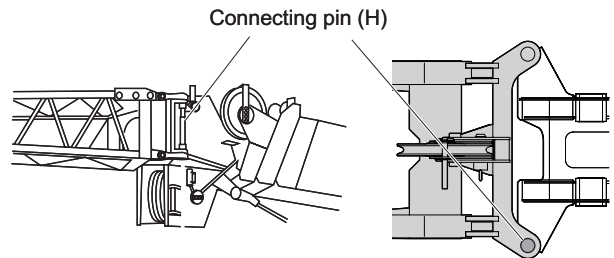

K02062-00E

- 25.** Check that the connecting pin (H) is aligned with the pin hole on the upper side of the base jib, and insert the connecting pin (H) using the jib handle.

Insert the connecting pin (H) securely until the red tapes on the thread appear.

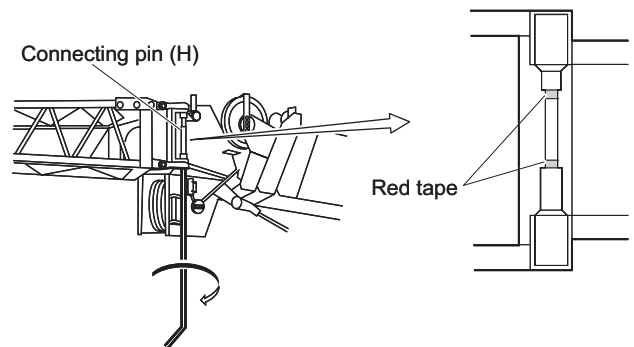

K02063-00E

- 26.** Wind down the wire rope to loosen the wire rope slightly.

- 27.** Remove the rope socket from the bracket of the jib.

26. While holding the guide rope, pull out the set pin (E), and attach it to the guide.

⚠ WARNING

Check that the boom angle is 3° or more before pulling out the set pin (E). If the set pin is pulled out with the jib inclined sharply, the speed when jib swings forward increases, and it may cause an accident.

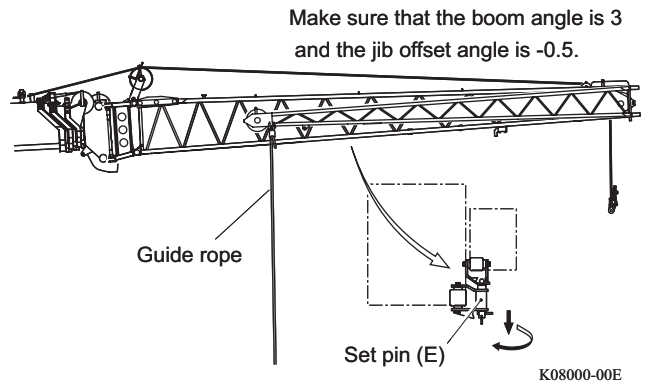

27. Pull the guide rope to swing the top jib forward.

⚠ WARNING

Do not enter the area within the jib swing path or under the jib. The jib may move unexpectedly and cause an injury.

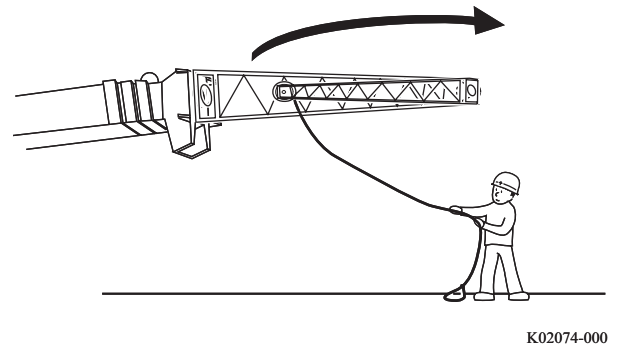

NOTICE

Before swinging the jib, be sure to retract the boom fully. Otherwise, the boom can be damaged.

28. Lower the boom, and insert the connecting pins (I). Then, secure them with the snap pins.

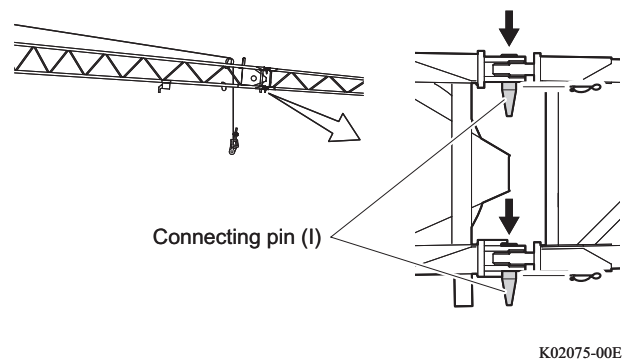

10. Pass the rope socket through the weight for anti-twoblock device, and then mount it to the auxiliary hook block.

⚠ WARNING

Securely tighten the fixing pin mounting bolt of the rope socket using a wrench. In addition, after mounting the rope socket, secure the pin with the split pin so that it will not be pulled out. Improper mounting may cause the rope socket to come off and a lifted load to fall, resulting in an accident.

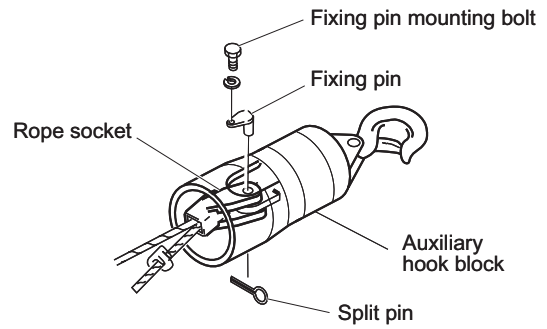

K02067-00E

11. Register the lift status to the load moment indicator.

Now, change of the jib offset angle is completed.

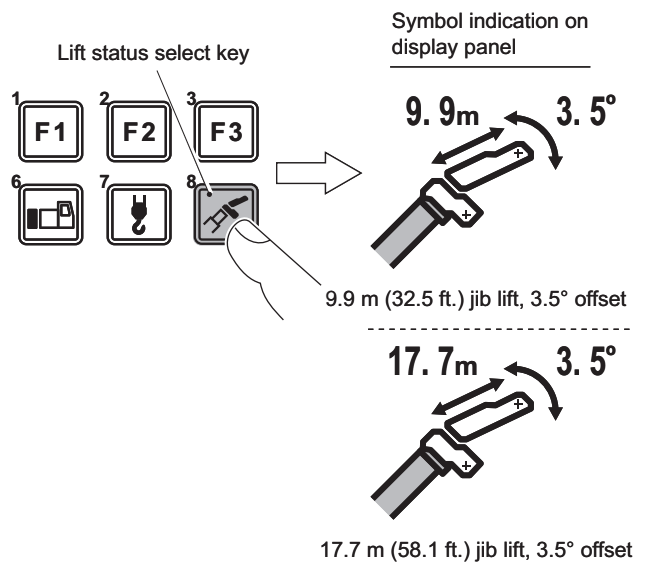

K07661-00E

(4) Mount the rope socket to the support of the jib, and stow the anti-twoblock device in the top of the base jib.

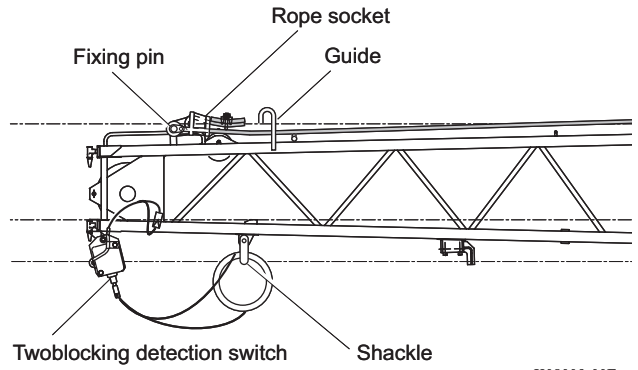

K08009-00E

(5) Wind up the auxiliary wire rope to loosen the wire rope slightly.

NOTICE
<ul style="list-style-type: none"> • Do not wind up the auxiliary wire rope excessively. The support of the jib will be cut. • Make sure that the auxiliary wire rope is loosened when stowed. If the rope is tensioned, raising the boom may damage the wire stowing support.

24. Register the lift status to the load moment indicator.

25. Check the following item.

- The crane automatically stops when the main hook block is over-hoisted.

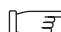
 If it does not stop automatically, refer to the step 4 and check that the wire is securely connected.

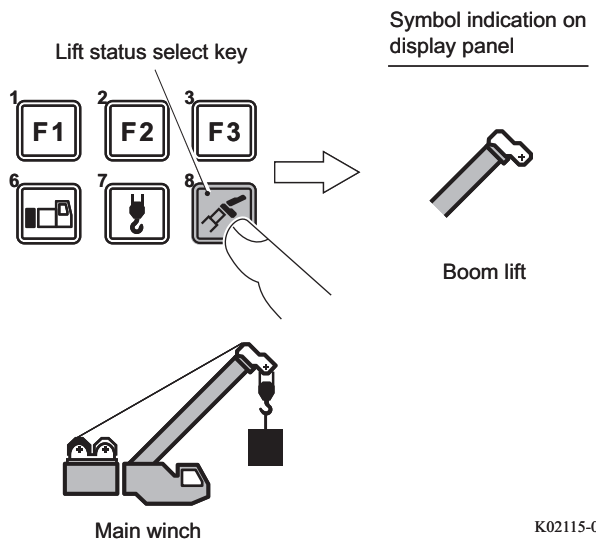

K02115-01E

Now, stowing of the base jib is completed.

Counterweight Combinations

⚠ WARNING

Do not operate the crane when the counterweight combination is other than specified here. The crane can overturn due to reduced stability.

Counter	Counterweight combinations
0 t	—
1.4 t	(1)
9.7 t	(1) + (2) + (4)
17.3 t	(1) + (2) + (3) + (4)

(*) : 1 each at front and rear

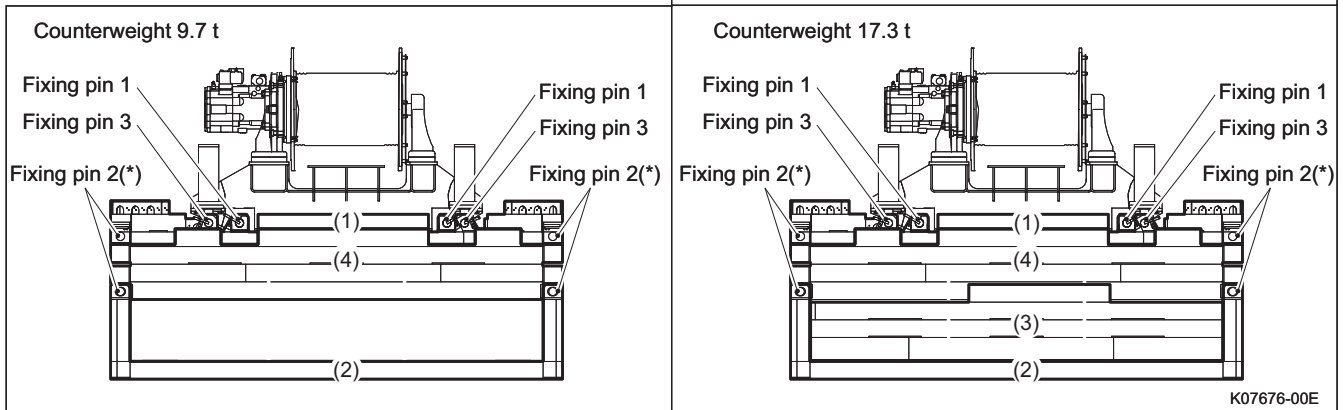

K07676-00E

Lifting Positions

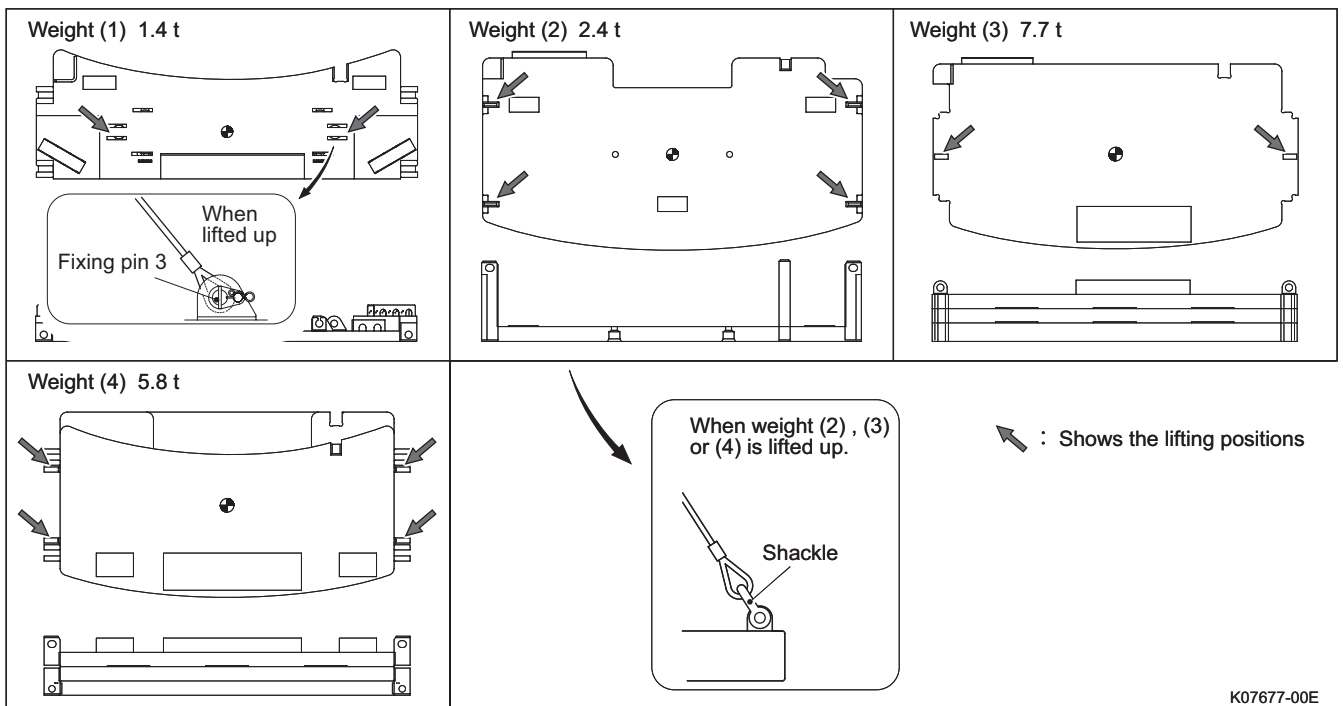

K07677-00E

Air Conditioner

NOTICE

Observe the following to prevent a failure in the air conditioner.

- Use the air conditioner with the engine started. Before stopping the engine, be sure to set the power switch of the air conditioner to "OFF".
- In front of the air vent louver, do not place obstacles which disturb air flow.

Dehumidifying/Cooling Operation

 Cooling operation enables to reduce temperature and humidity. The temperature is suitable for you when it is lower than the outside temperature by 5 to 8°C (9 to 14 °F). Do not turn the temperature level down excessively, and do not expose to cool air for long time. Be sure to set the suitable temperature level.

 Dehumidifying operation makes inside the cab dry.

1. Start the engine.
2. Press the power switch.
 - The power of the air conditioner is turned on and the indication of LCD appears.
3. Set the air conditioner switch to "ON".
 - The dehumidifying/cooling function activates, and the snow-shaped sign appears.

 When the outside temperature drops to approx. 0°C (32 °F), the dehumidifying/cooling function does not operate.

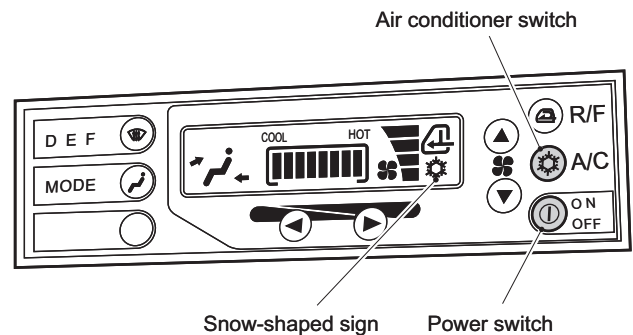

K01965-00E

MEMO

• Check after Maintenance

If you neglect the operational checks after maintenance, it can delay the discovery of oil leakage or malfunction. This can cause an accident.

After a maintenance work, check that the operation of the components where maintenance has been performed is normal, there is no oil leakage, and no bolts are left untightened.

Note that the maintenance does not end until you confirm that the machine operates properly.

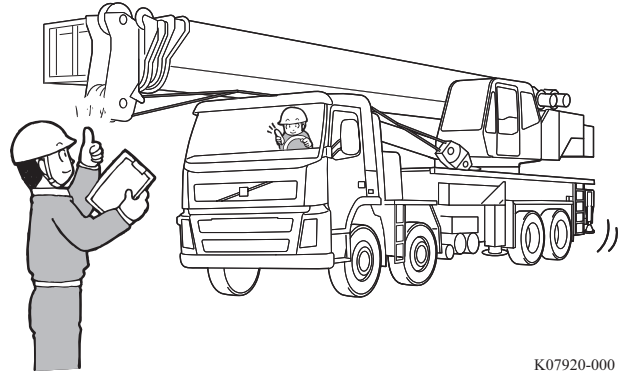

K07920-000

• Disposing of Waste

Improper disposal of waste, such as waste oil from the machine and used filter, pollutes the environment.

When you drain waste oil from the machine, collect it in a container. Do not pour the waste oil on the ground, or do not discharge it into a river or pond.

When you dispose of the waste oil, fuel, coolant, brake fluid, solvent, filters, batteries or other toxic substances, request an industrial waste disposal contractor for their disposal.

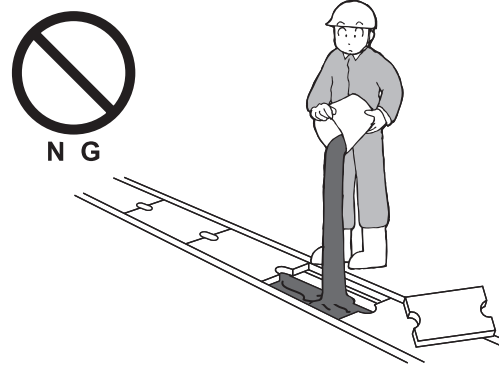

G61027-00E

• Never Release Fluorocarbons into Atmosphere

In order to protect the global environment, observe the precautions below.

- (1) Do not emit the refrigerants (fluorocarbons) enclosed in these products.
- (2) Collect the refrigerants (fluorocarbons) enclosed in these products when disposing of these products.

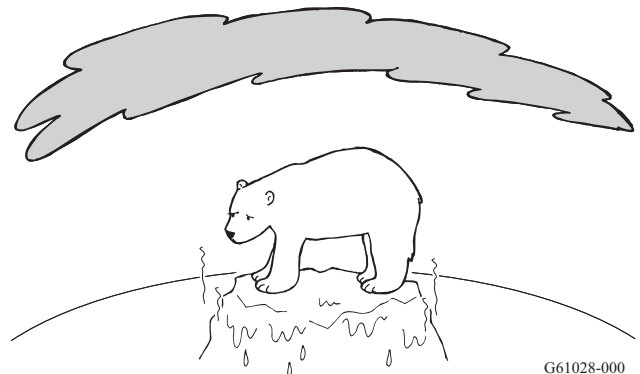

G61028-000

1. Operating status of anti-two-block device
 2. Operating status registration and load moment indicator function check
 3. Operating status of flood lamp
 4. Mounting status of steps and rails
- Counterweight mounting/dismounting system
 1. Counterweight cylinder mounting status
 2. Counterweight cylinder operation/oil leakage

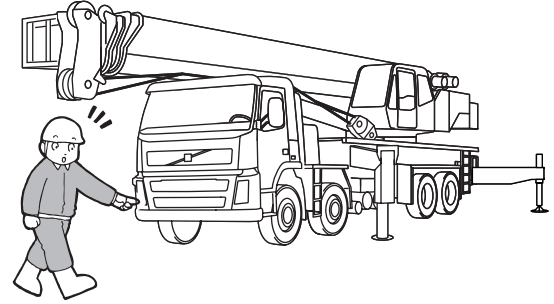

K07664-000

Operating Status Registration and Load Moment Indicator Function Check

Register the operating status to the load moment indicator, and perform the load moment indicator functional check.

 For about operating status registration and load moment indicator function check, refer to "Operating Status Registration and Load Moment Indicator Function Check" (page 73).

If any abnormality is found, contact your nearest TADANO distributor or dealer for inspection and maintenance.

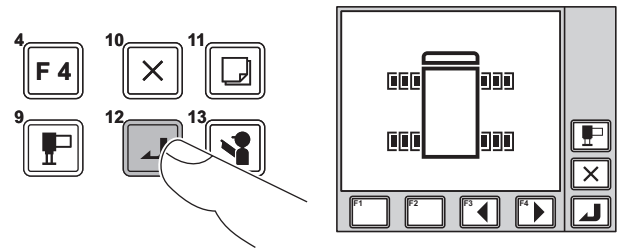
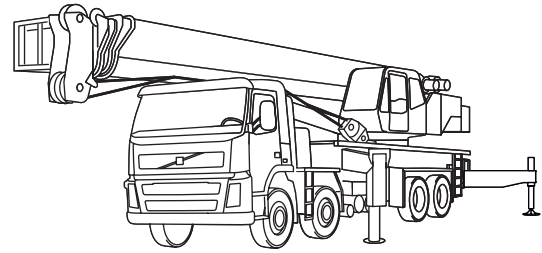

K07666-000

Operating Status of Flood Lamp

Turn the flood lamp switch to "ON" to check the lighting status of the flood lamp.

If it does not light up, contact your nearest TADANO distributor or dealer for inspection and maintenance.

Mounting Status of Steps and Rails

Check the access path to the cab for damage.

If damage is found, contact your nearest TADANO distributor or dealer for inspection and maintenance.

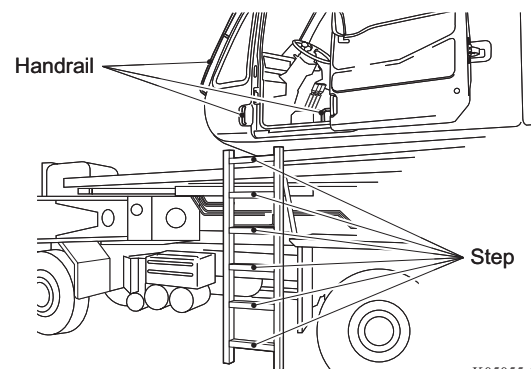

K05055-00E

Swing Speed Reducer

⚠ CAUTION

The speed reducer is very hot immediately after an operation, and you may suffer burns if you work on it, let the speed reducer cool down until it can be touched by bare hands before starting the work.

Checking Oil Level

1. Extend the outriggers, and set up the machine horizontally.
2. Raise the boom to an angle where it does not hinder the work.
3. Remove the level plug and check the oil level. When the oil level reaches the bottom of the plug hole, the oil amount is sufficient. If it is insufficient, add oil through the filler plug hole.
4. Wrap seal tape around the level plug and filler plug, and tighten them.

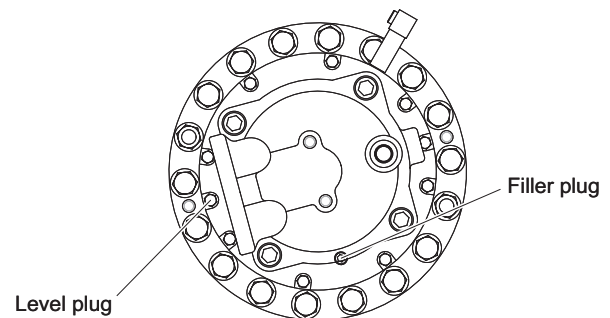

K02011-00E

Electrical System

Maintenance Table

No.	Item	Points/ Quantity	Inspection and maintenance interval					
			1 week	100 h	300 h	600 h		
				1 month	3 months	6 months		
1	Fuse replacement		When fuse has blown					

Replacing Fuses

NOTICE

- To prevent a short circuit, set the starter switch to "OFF", and disconnect the cable from the negative terminal of the battery before fuse replacement.
- Using a fuse exceeding the rated capacity may burn out wiring or electrical components if a short circuit occurs. Be sure to use a fuse with the specified capacity for replacement.
- If a fuse has blown again even after the replacement, there are other possible causes. Contact your nearest TADANO distributor or dealer for inspection.

3. Wind up the winch to wind the wire rope around the drum until a length only sufficient for attaching it to the hook block is left.

Pay attention to the following when winding the rope.

- At the start of the winding, wind the rope along the guide at the verge of the drum.
(See Fig. 1)
- For the first layer of winding, put the rope in the grooves on the drum.
- When you wind over another layer of windings, set the rope in the valleys between the ropes.
(See Fig. 2)

Fig. 1

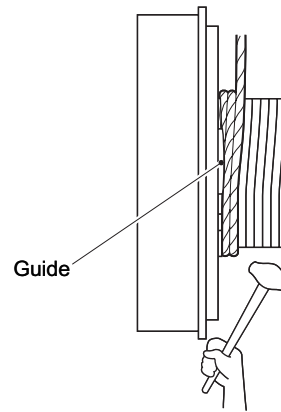
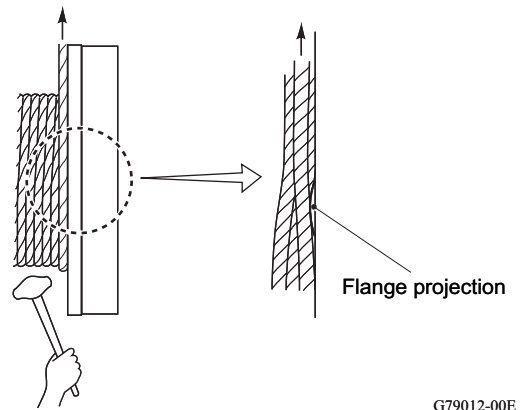



Fig. 2



G79012-00E

4. After you reeve the rope through the boom and hook block sheaves in the pattern appropriate to the number of part lines, pass it through the weight for anti-two-block device.

 For information on how to reeve the wire rope, refer to "Reeving the Wire Rope" (page 151).

5. Pass the wire rope through the rope socket, and secure it with the wire clip.

NOTICE

Pay attention to the orientations and positions of the wedge and wire clip installation.

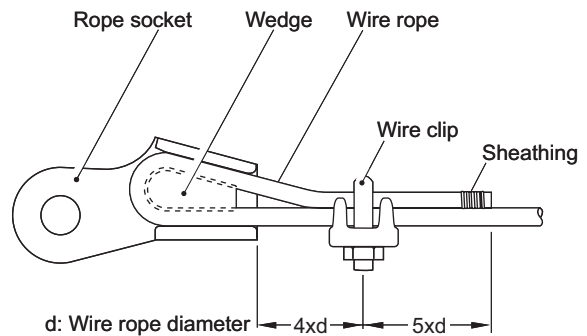

G79013-02E

5. Press the outrigger status select key and F3 or F4 key to enter the actual outrigger extension status.

- Outrigger status select key
Select a target outrigger.
- F3 key
Extend (When a left-side outrigger is selectde).
Retract (When a right-side outrigger is selectde).
- F4 key
Retract (When a left-side outrigger is selectde).
Extend (When a right-side outrigger is selectde).

6. Press the set key to register the setting.

7. Stow the crane.

8. Set the outrigger status emergency register switch to "OFF" and remove the key.

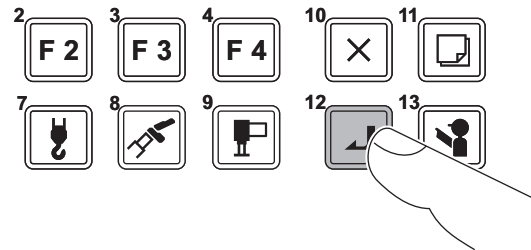

K00678-000

Overall Dimensions

No.	Dimension
1. Float size	φ400 mm (1' 3-3/4")
2.	4,650 mm (15' 3-1/8")
3.	3,071 mm (10' 7/8")
4. Outrigger maximum extension width	7,000 mm (22' 11-5/8")
5. Tail swing radius	4,200 mm (13' 9-3/8")
6.	2,729 mm (8' 11-1/2")
7.	4,650 mm (15' 3-1/8")
8. Overall width	2,590 mm (8' 6")
9. Rear overhang	2,680 mm (8' 9-1/2")
10. Wheel base (3rd to 4th axle)	1,370 mm (4' 5-7/8")
11. Wheel base (2nd to 3rd axle)	3,705 mm (12' 1-7/8")
12. Wheel base (1st to 2nd axle)	1,995 mm (6' 6-1/2")
13.	1,520 mm (4' 11-7/8")
14. Front overhang	3,725 mm (12' 2-5/8")
15. Overall length	13,890 mm (45' 6-7/8")
16. Overall height	4,000 mm (13' 1-1/2")

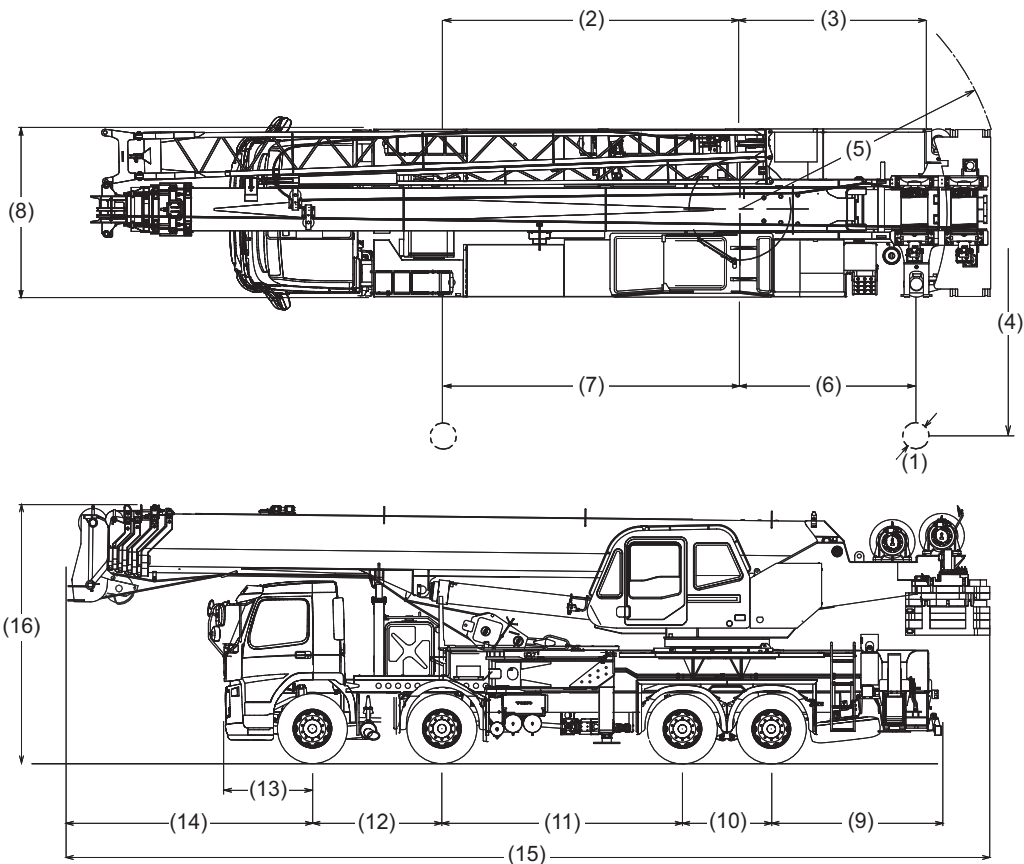

K07671-000

(7)

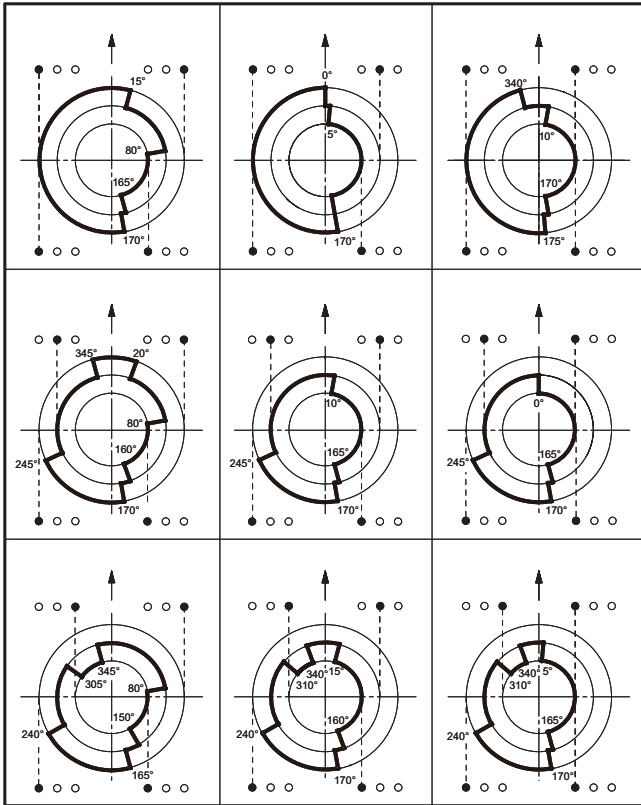

(8)

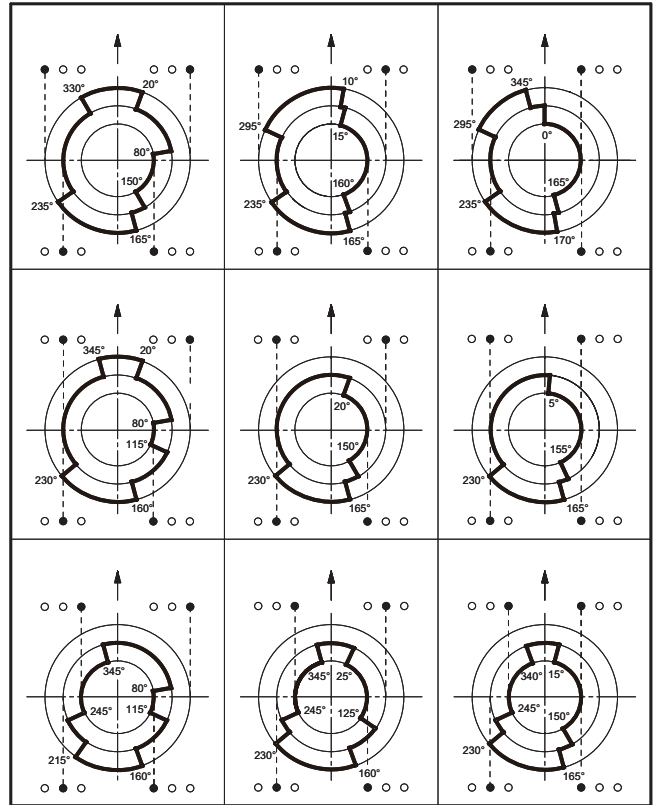

(9)

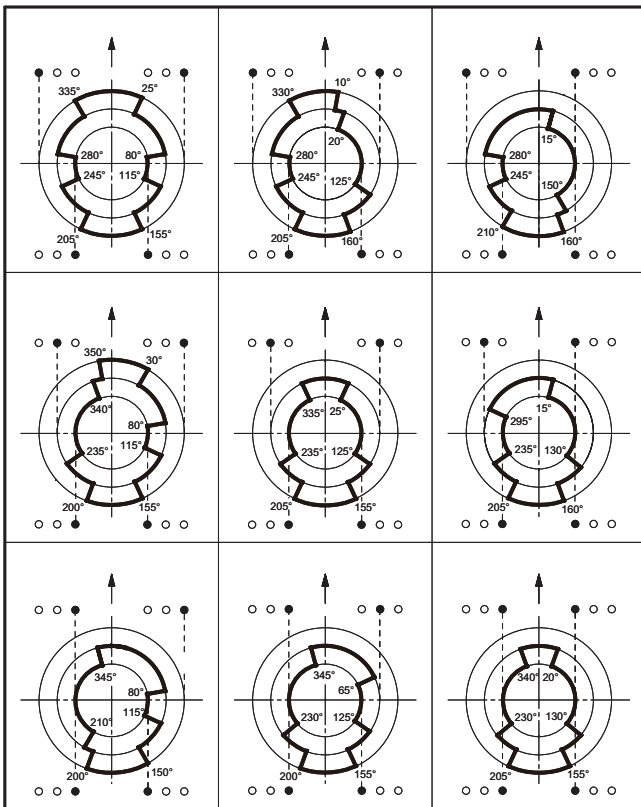

• Examples

- Area (1) (350° to 115° range) :MID capacity.
- Area (2) (115° to 190° range) :MAX capacity.
- Area (3) (190° to 195° range) :MID capacity.
- Area (4) (195° to 350° range) :MIN capacity.

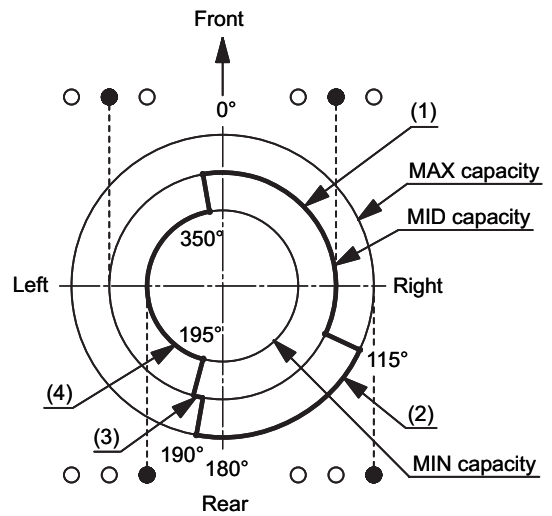

K10156-00E

CLICK HERE TO **DOWNLOAD** THE COMPLETE MANUAL

- Thank you very much for reading the preview of the manual.
- You can download the complete manual from: www.heydownloads.com by clicking the link below



- Please note: If there is no response to CLICKING the link, please download this PDF first and then click on it.

CLICK HERE TO **DOWNLOAD** THE COMPLETE MANUAL