

Operation & Maintenance Manual

PC3000-1

HYDRAULIC MINING EXCAVATOR

SERIAL NUMBERS PC3000-1 6202

This material is proprietary to Komatsu Mining Germany GmbH and is not to be reproduced, used, or disclosed except in accordance with written authorization from Komatsu Mining Germany GmbH.

It is our policy to improve our products whenever it is possible and practical to do so. We reserve the right to make changes or improvements at any time without incurring any obligation to install such changes on products sold previously.

Due to this continuous program of research and development, revisions may be made to this publication. It is recommended that customers contact their distributor for information on the latest revision.

Copyright 2006 Komatsu
Printed in U.S.A.
Komatsu Mining Germany

CLICK HERE TO **DOWNLOAD** THE COMPLETE MANUAL

- Thank you very much for reading the preview of the manual.
- You can download the complete manual from: www.heydownloads.com by clicking the link below



- Please note: If there is no response to CLICKING the link, please download this PDF first and then click on it.

CLICK HERE TO **DOWNLOAD** THE COMPLETE MANUAL



- 1.5.2.9** For carrying out overhead assembly work always use specially designed or otherwise safety-oriented ladders and working platforms. Never use machine parts as a climbing aid. Wear a safety harness when carrying out maintenance work at greater heights.
Keep all handles, steps, handrails, platforms, landings and ladders free from dirt, snow and ice.
- 1.5.2.10** Clean the machine, especially connections and threaded unions, of any traces of oil, fuel or preservatives before carrying out maintenance/repair. Never use aggressive detergents. Use lint-free cleaning rags.
- 1.5.2.11** Before cleaning the machine with water, steam jet (high-pressure cleaning) or detergents, cover or tape up all openings which - for safety and functional reasons - must be protected against water, steam or detergent penetration. Special care must be taken with electric motors and switchgear cabinets.
- 1.5.2.12** Ensure during cleaning of the machine that the temperature sensors of the fire-warning and fire-fighting systems do not come into contact with hot cleaning agents as this might activate the fire-fighting system.
- 1.5.2.13** After cleaning, remove all covers and tapes applied for that purpose.
- 1.5.2.14** After cleaning, examine all fuel, lubricant, and hydraulic fluid lines for leaks, loose connections, chafe marks and damage. Any defects found must be rectified without delay.
- 1.5.2.15** Always tighten any screwed connections that have been loosened during maintenance and repair.

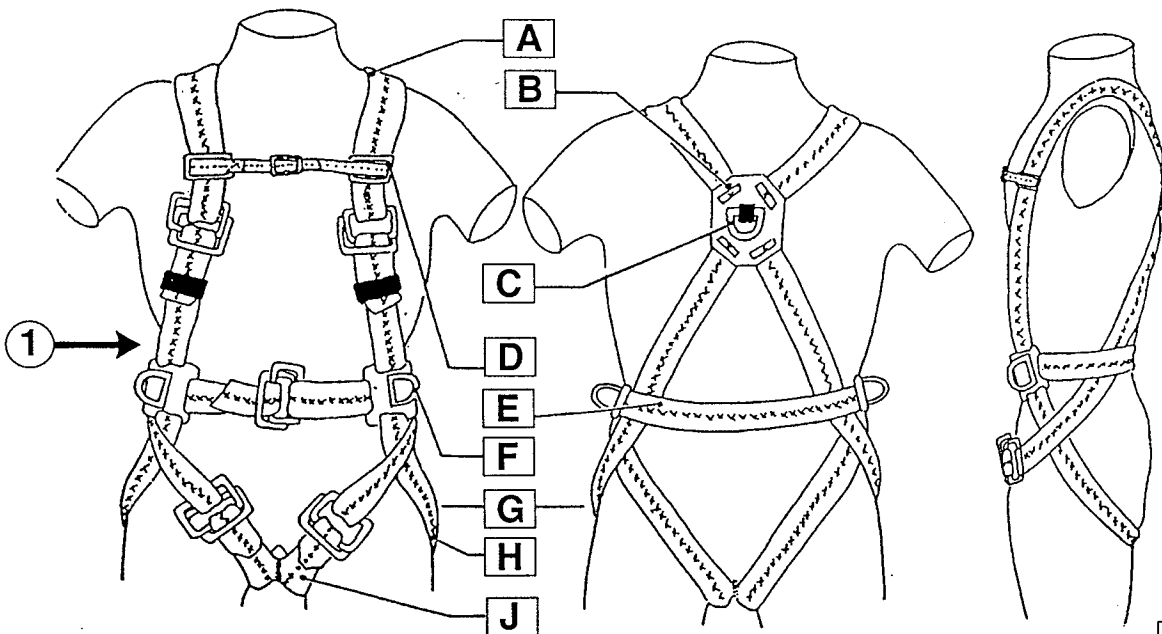
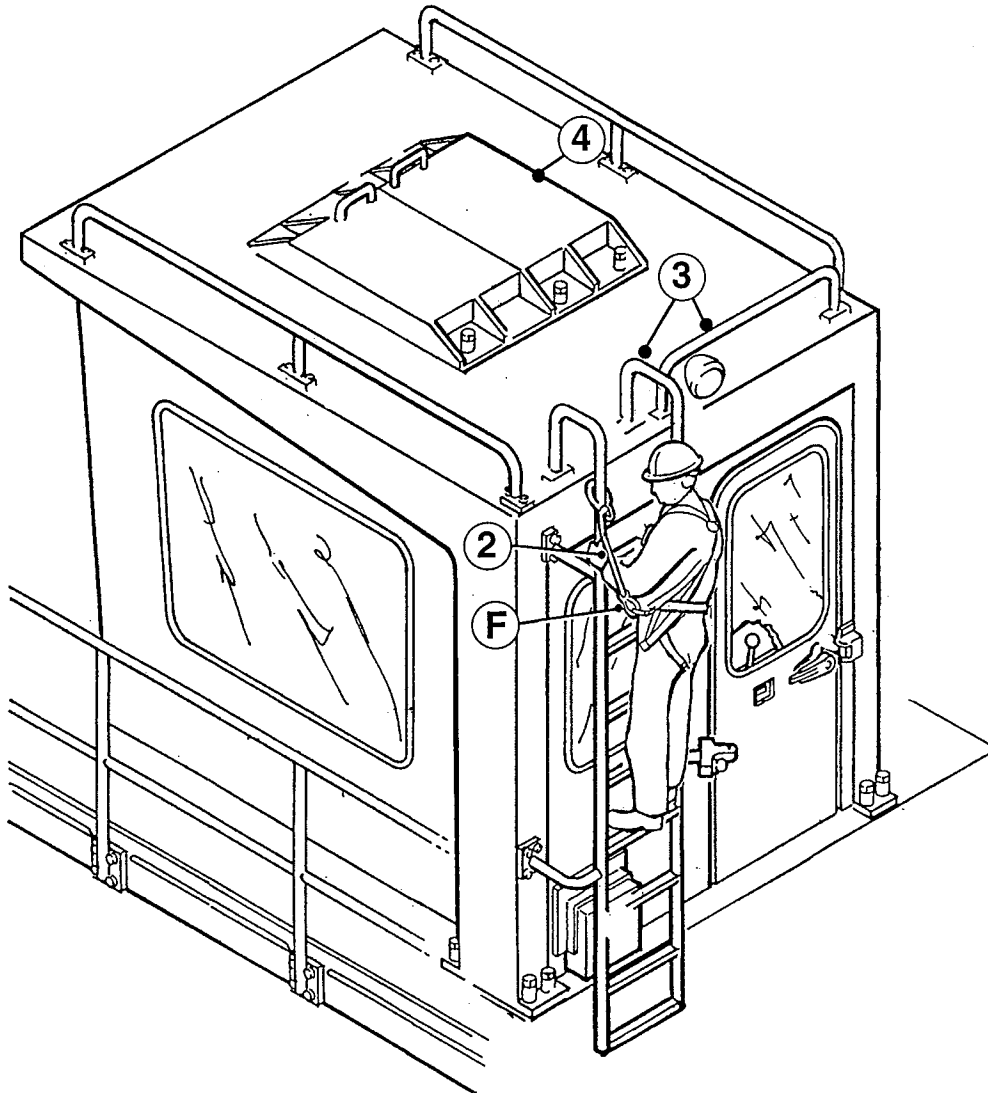

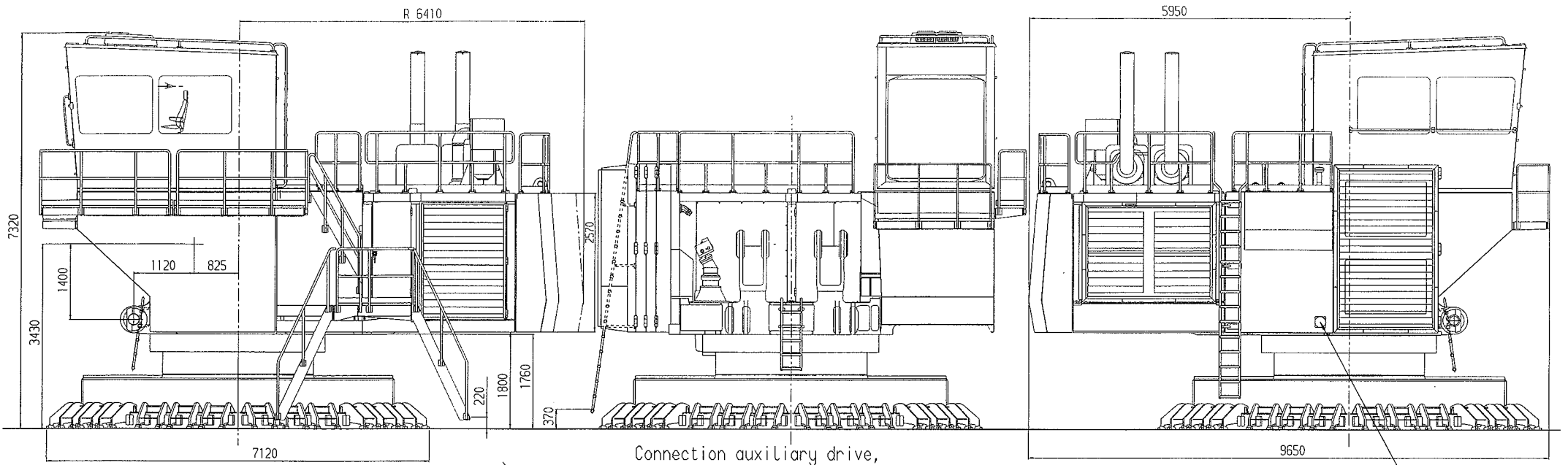

Connection auxiliary drive,

3m above pontoon deck.
Complete quick coupling
will be delivered by KMG

- pressure side, hose size
20 mm inside diameter
pressure 300 bar
- return side, hose size
50 mm inside diameter
low pressure, max. 10 bar

Nothing should stand higher
than 1700 mm from the
pontoon deck in the area
between the max.ladder radius
R 5600 mm and the max.
turning radius of the
counterweight R 6410 mm.

Max.turning radius of Longer ladders (deck must be free inside that radius)

Preheating connection
about 2 m above
pontoon deck
(plug-in assembled
by yards)

Identnr.: 9252054001

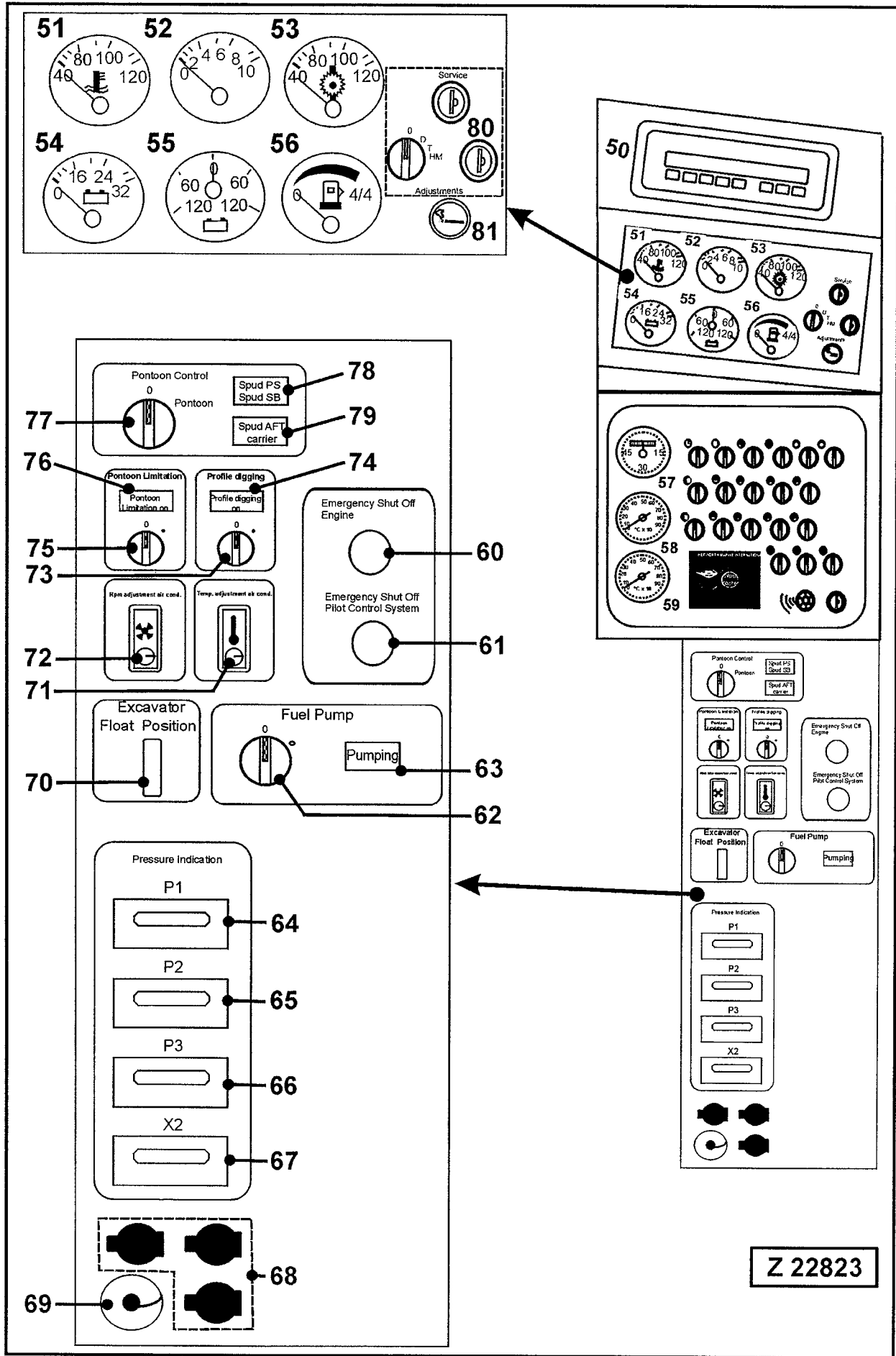

Z 22823

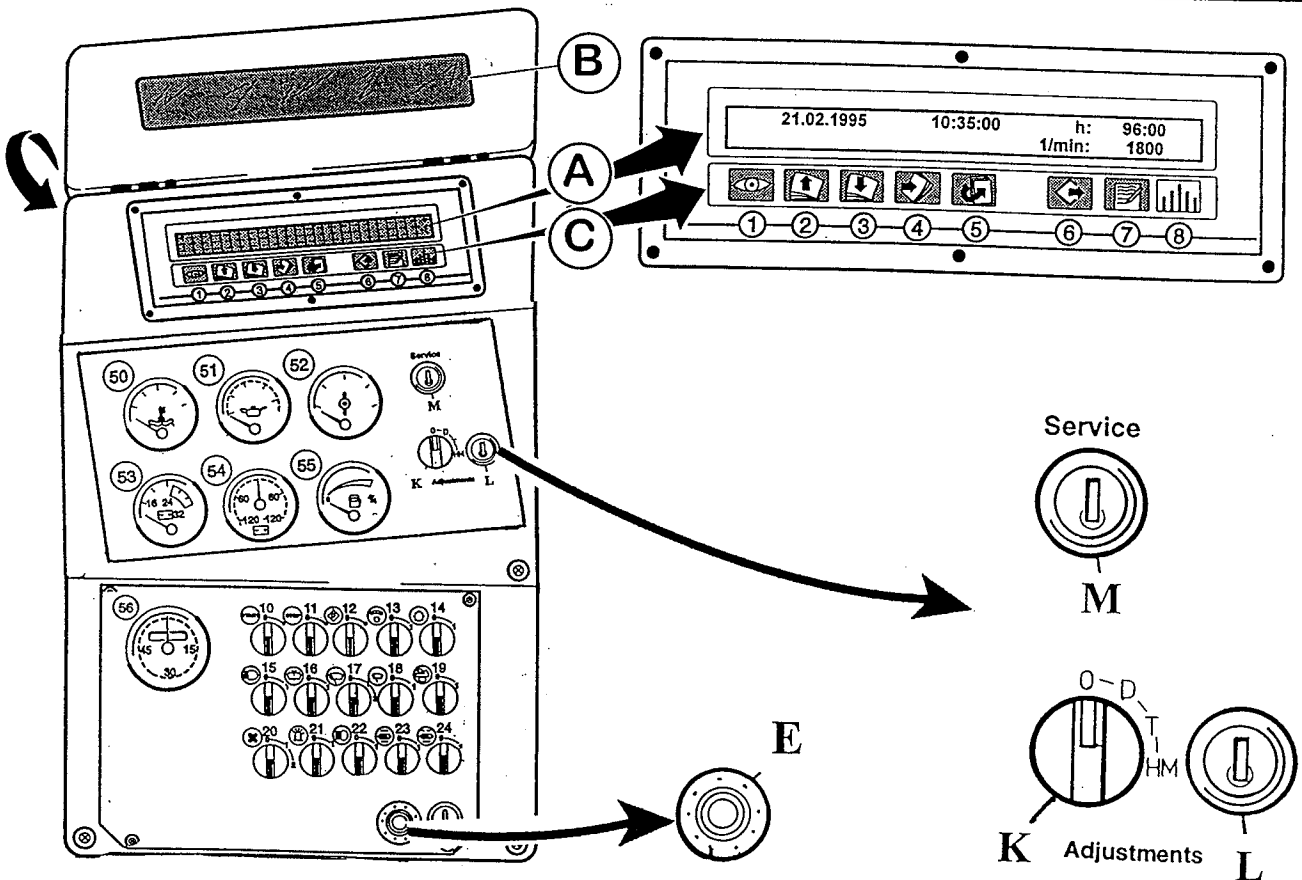
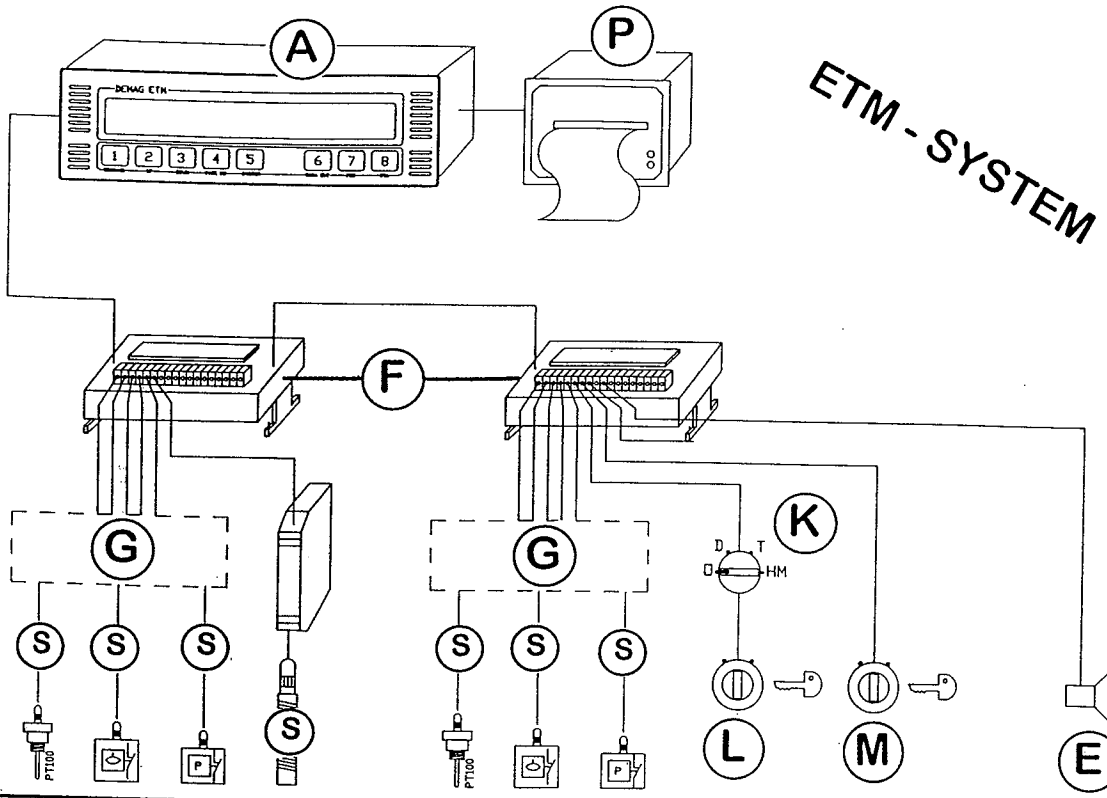

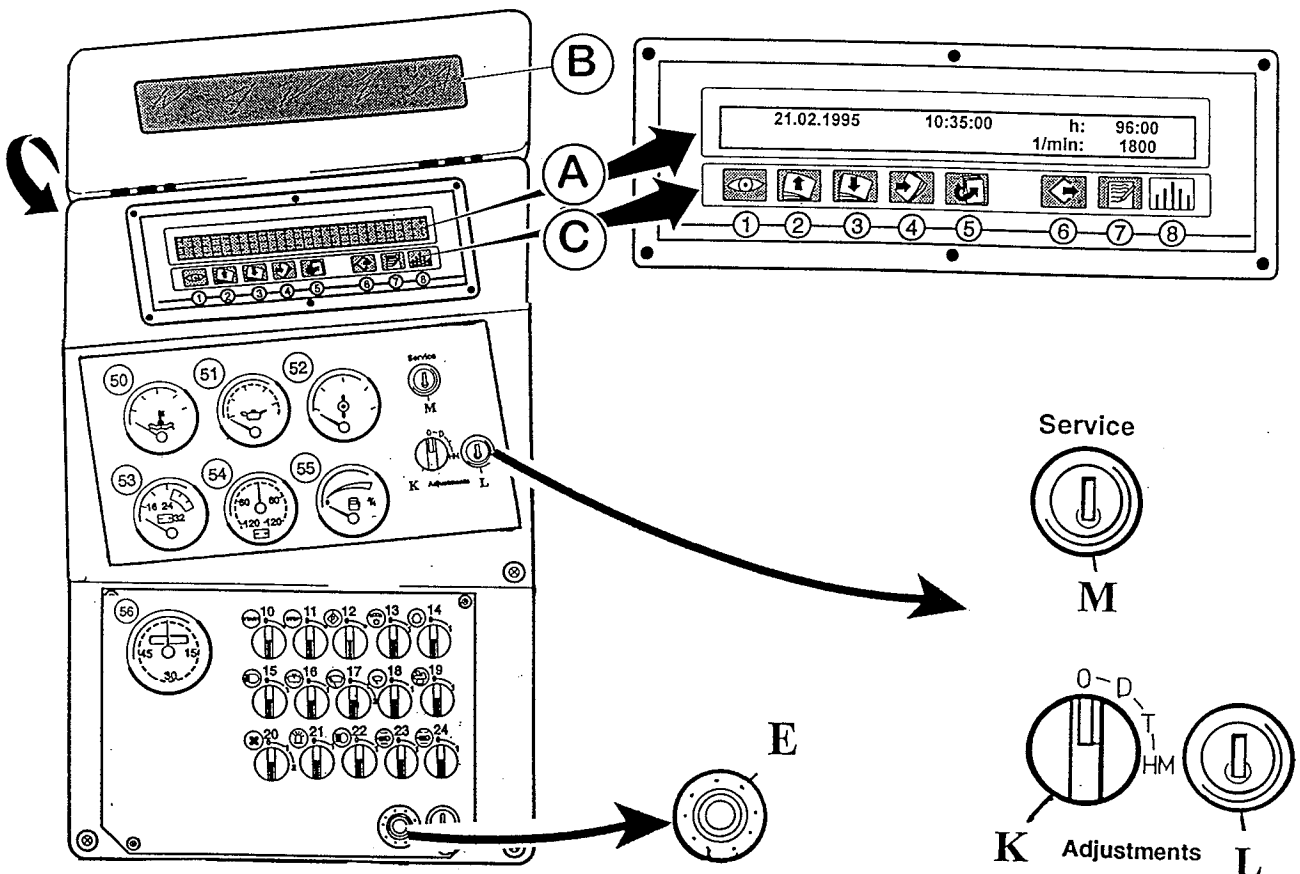
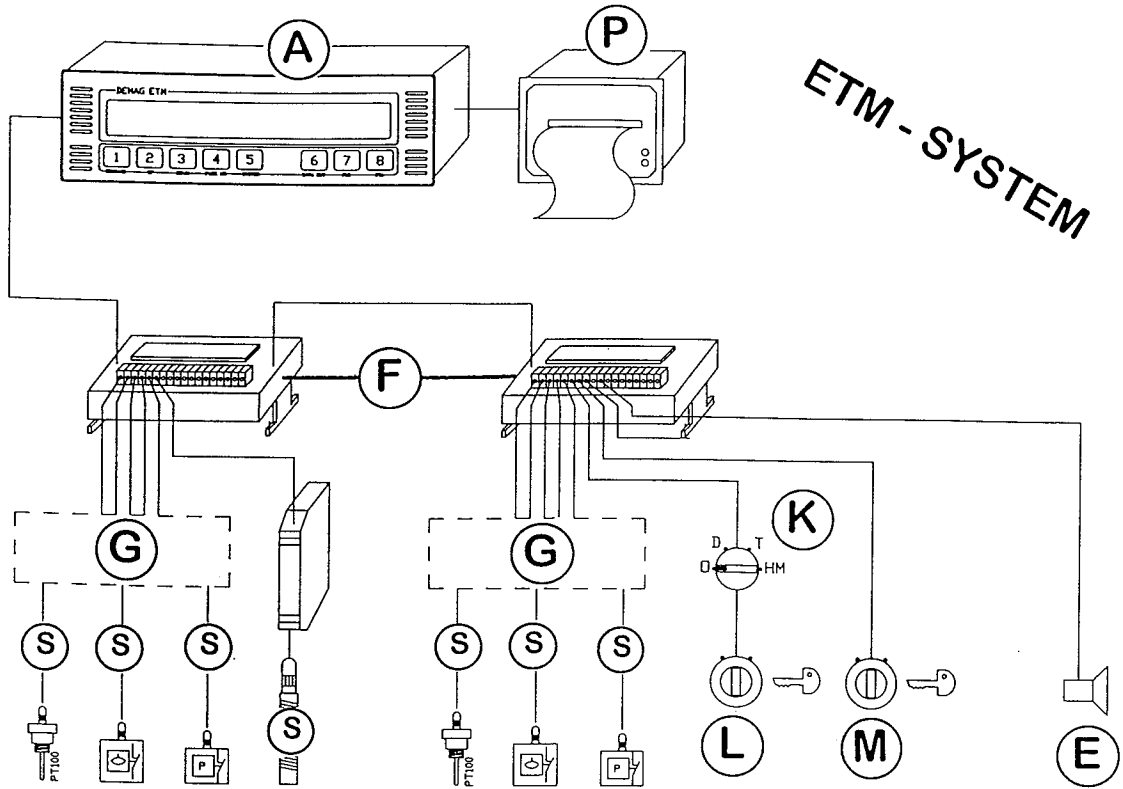

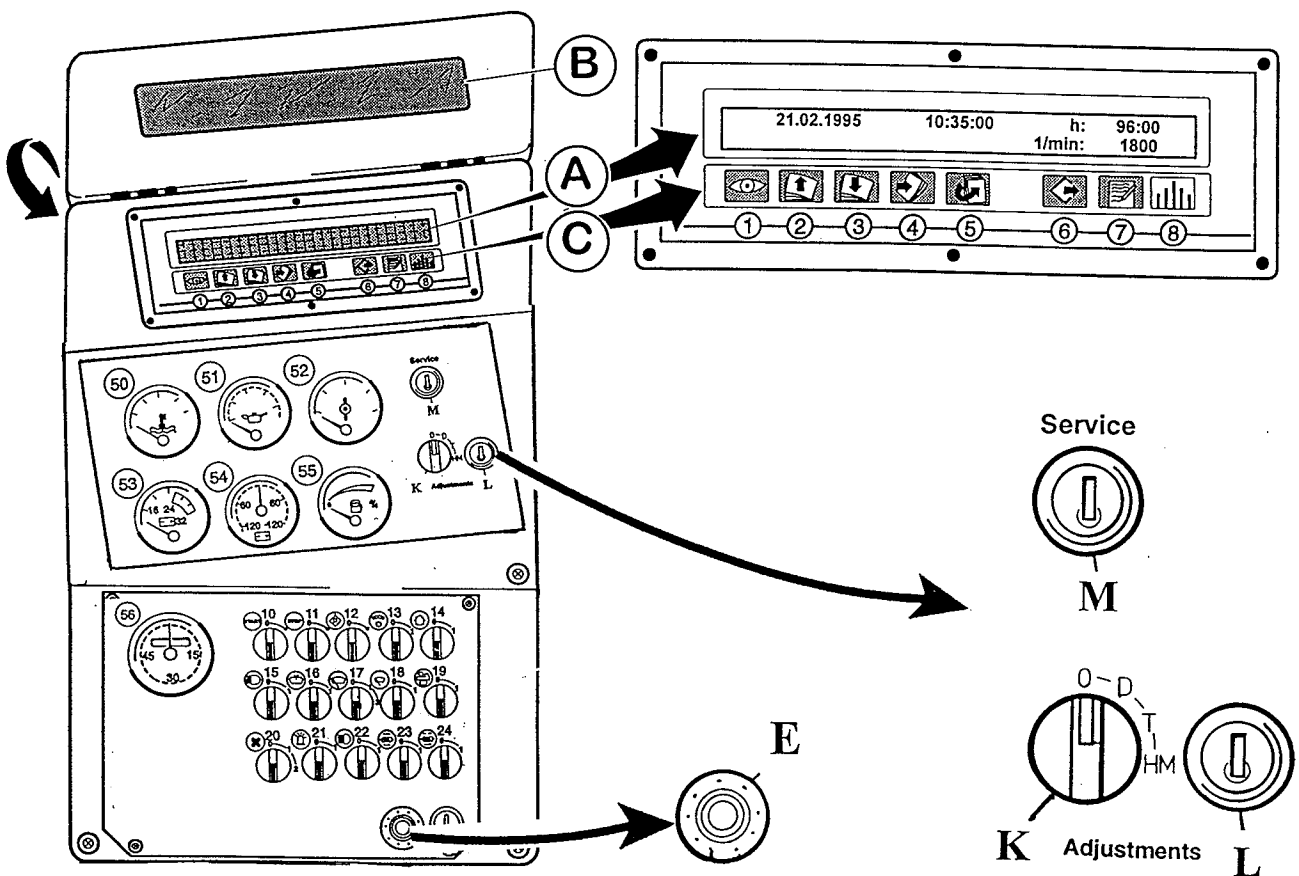
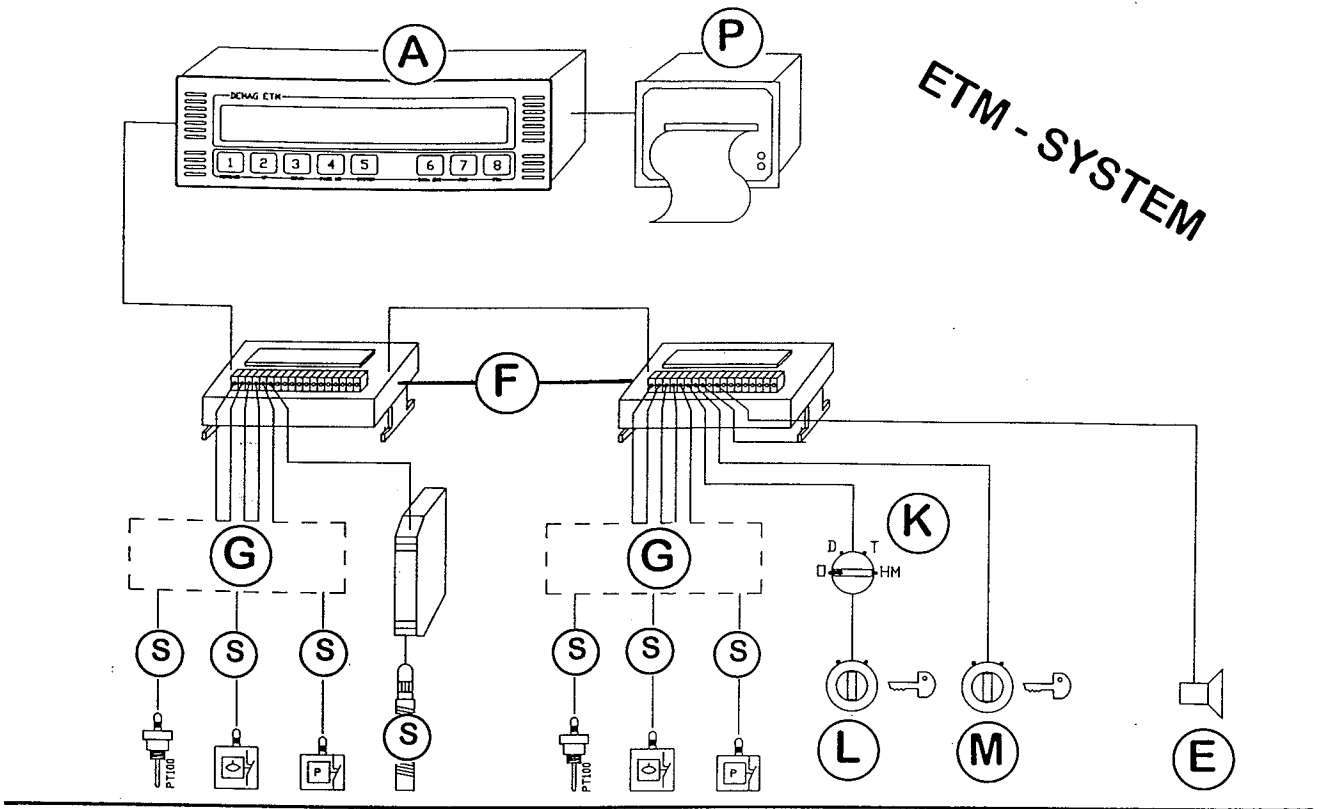

(Z 20282)

TABLE OF MESSAGES**Message Pages Number 27 to 30.****Page No.:**

27: # date:
new date

28: # time:
new time

29: # operating hours h:
new operating hours

30: # protocol cancelled
statistics cancelled

Time Diagram of Statistics Print

The diagram below shows an example, how the time without faults (Good) and the time with faults (Err) could be distributed within the total operating time of the ETM.

TE: Total operating time of the ETM

T1/T2/T3/T4: Total time of a message

T Err: Total time of all messages

T Good: Total time without messages

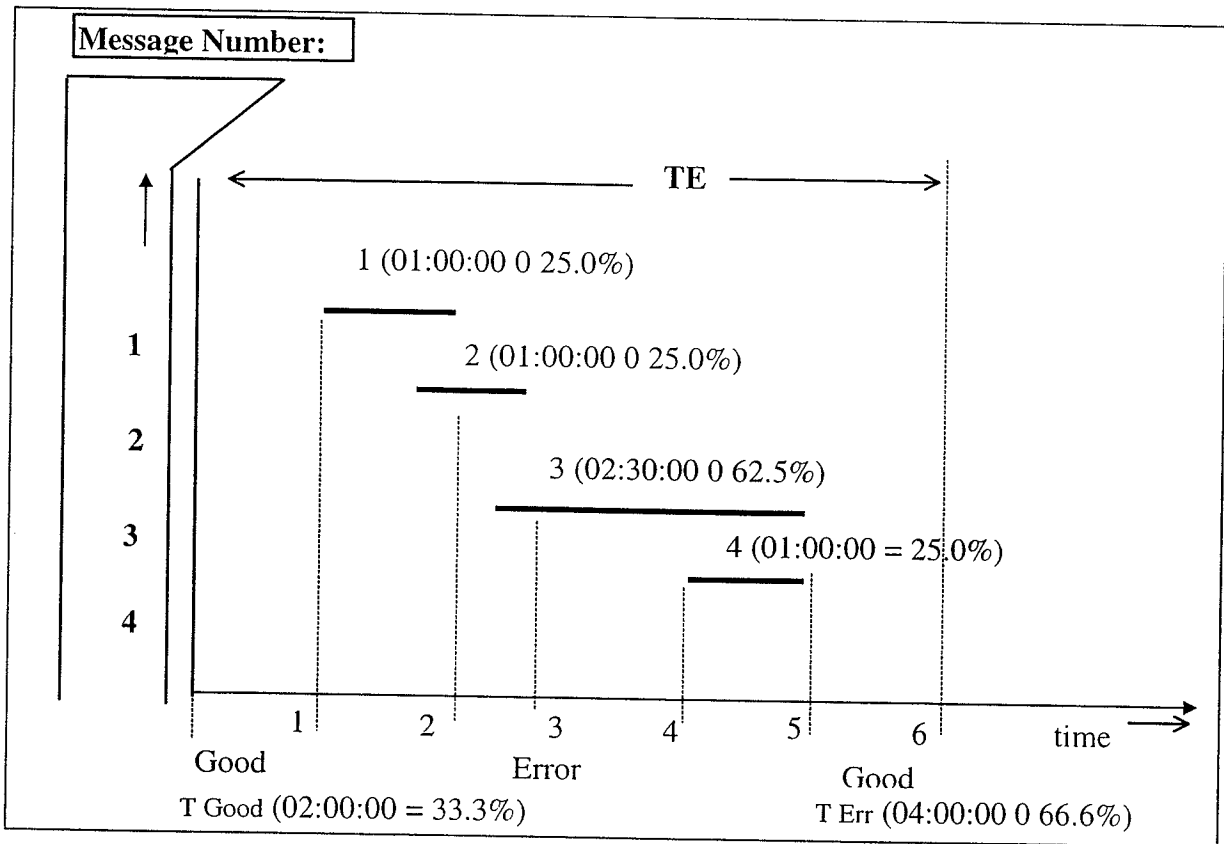

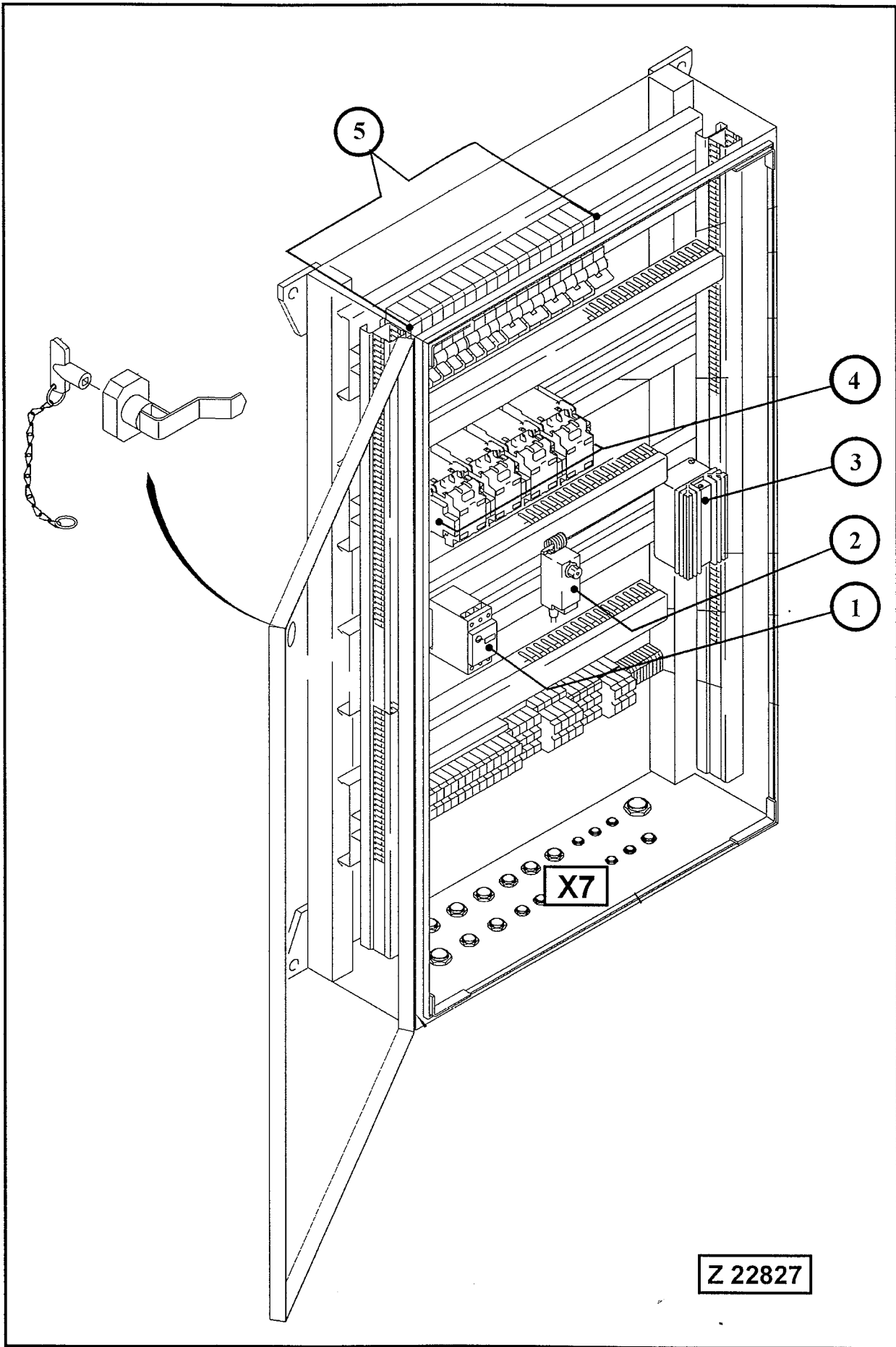

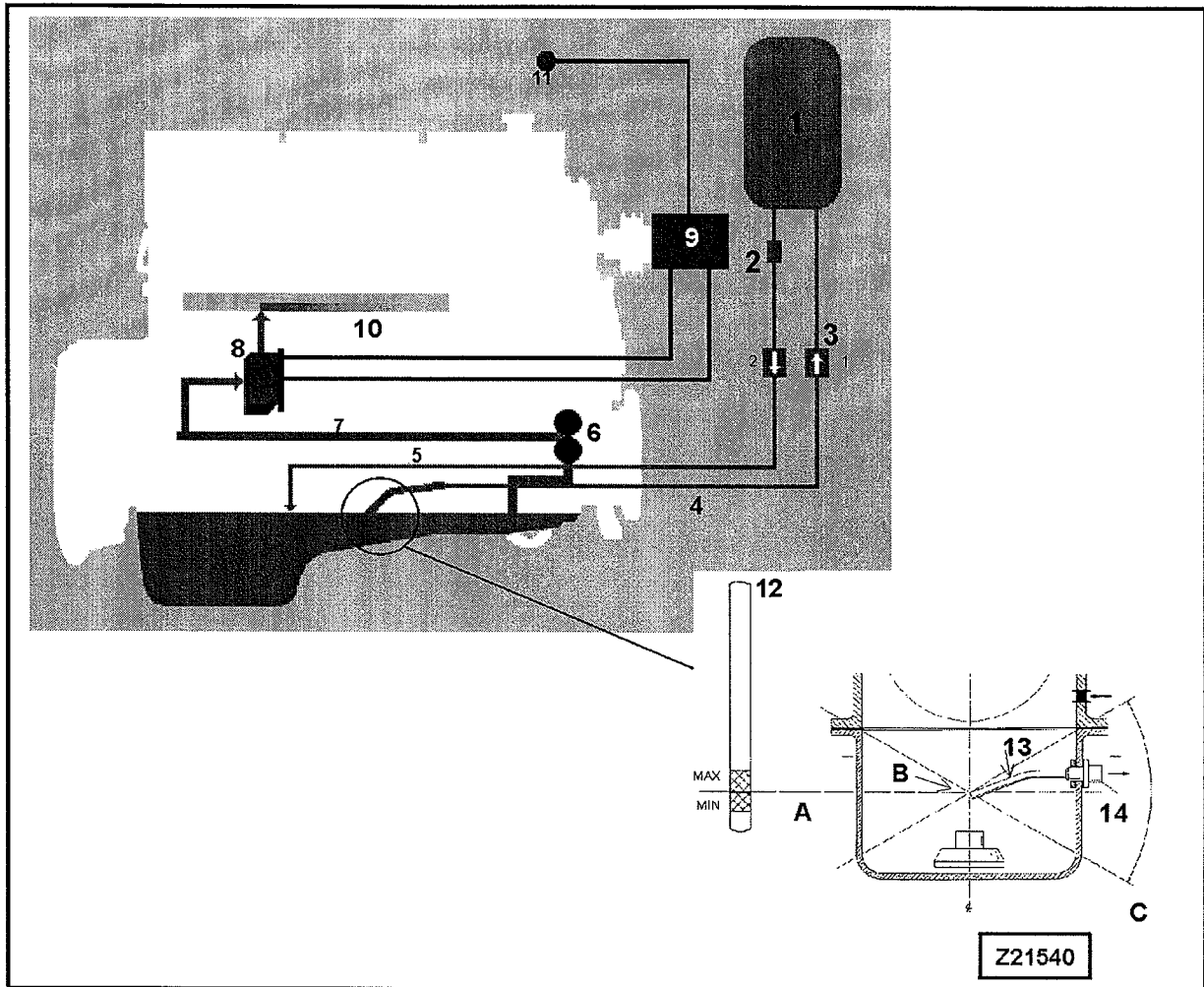

OIL BURNING SYSTEM CENTINEL COMBINED WITH RESERVE SYSTEM

Legend for illust. Z 21540 (schematic illustration)

- | | |
|-------------------------------------|--|
| (1) Engine oil reserve tank | (10) Fuel/lube oil blend return to fuel tank |
| (2) Oil filters | (11) System function indicator LED's |
| (3) Pump unit | (12) Oil level gauge |
| (4) Suction oil to reserve tank | (13) Oil withdrawal tube |
| (5) Supply oil from tank to oil pan | (14) Withdrawal adapter plate |
| (6) Engine oil pump | (A) Oil level with engine running |
| (7) Main oil rifle | (B) Control point for filling / withdrawal |
| (8) Oil control valve | (C) Roll or tilt oil level |
| (9) Centinel Control Module (CCM) | |

Brief description of system function

The combined "Centinel - Reserve" system is a continuous oil replacement system of electromechanical design and can extend oil change intervals through continuous oil exchange. This is accomplished by injecting engine oil at a controlled rate, proportional to fuel consumed, into the fuel system for consumption. Make-up oil is introduced into the engine by the oil supply system "Reserve", maintaining an optimal engine oil level.

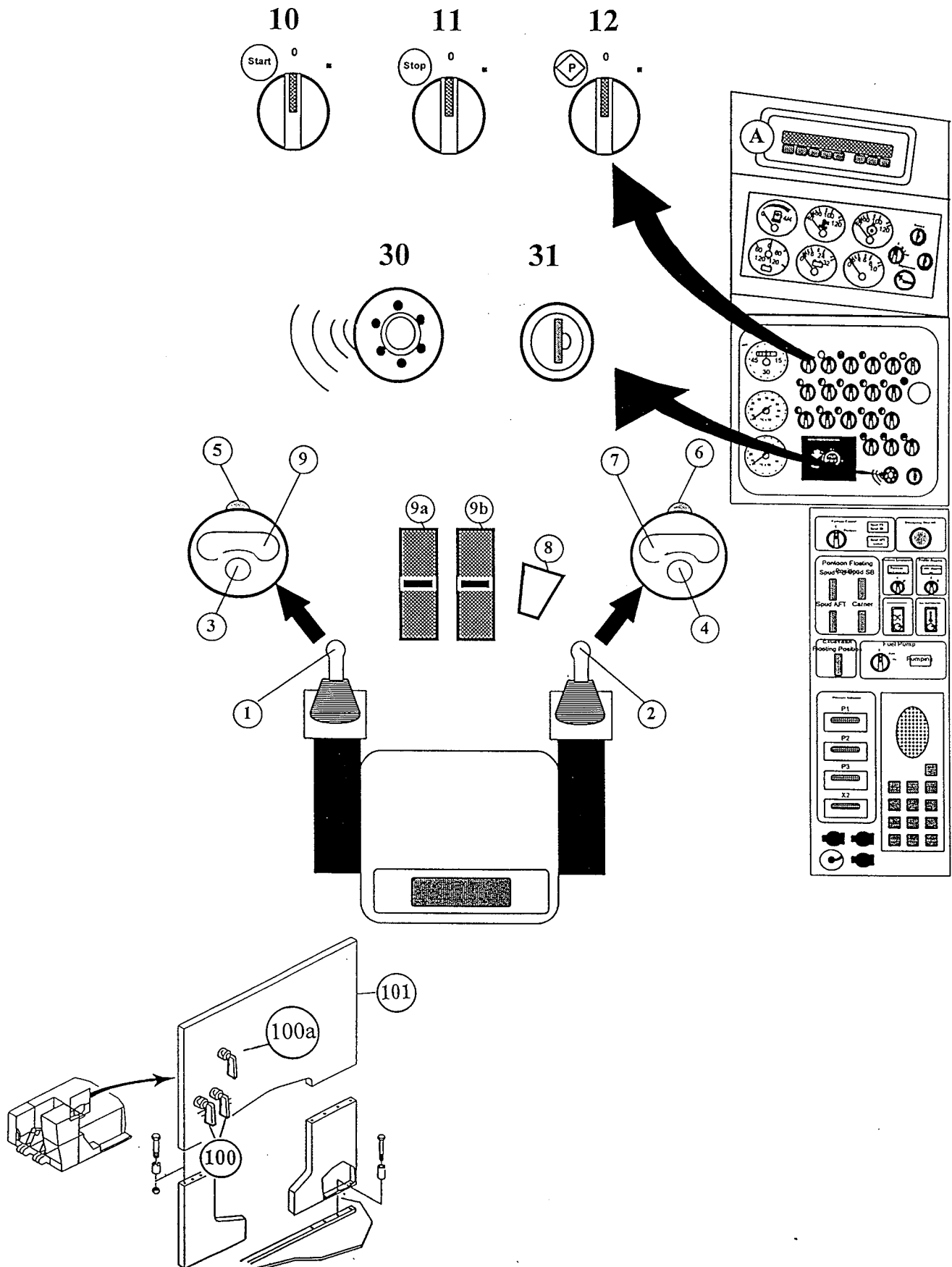

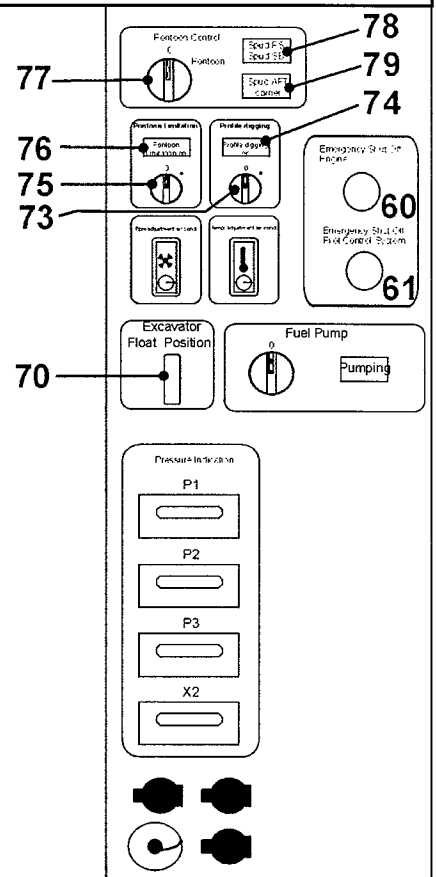
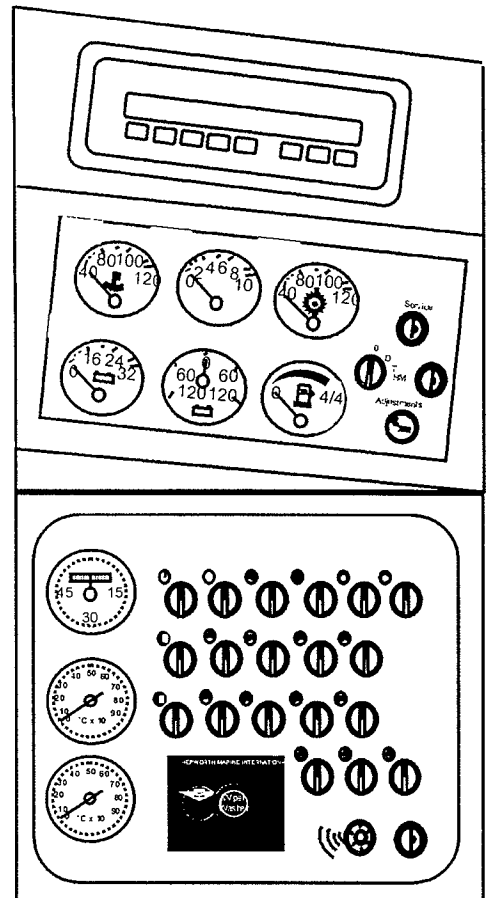
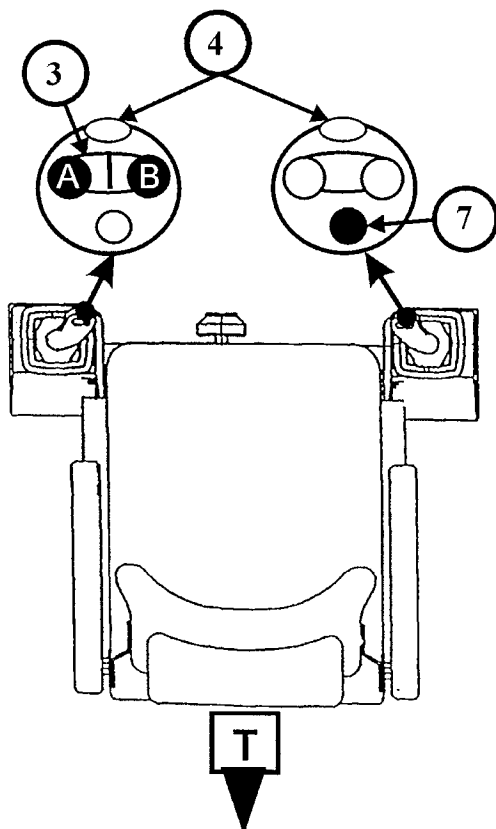
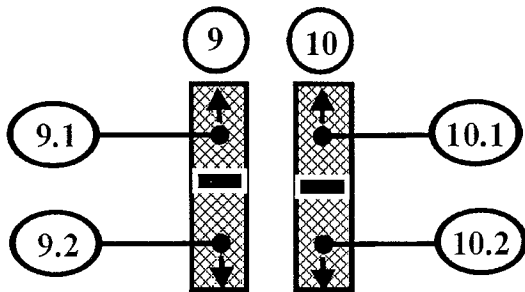
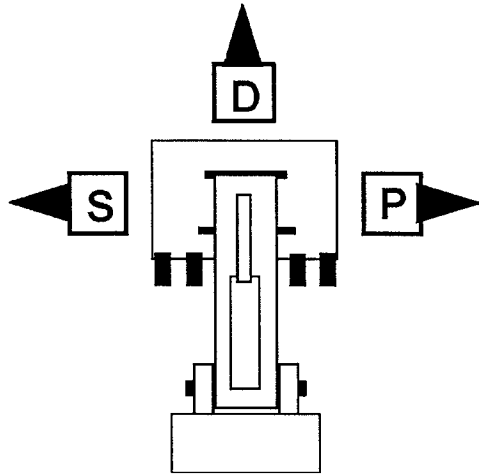

Z 22840

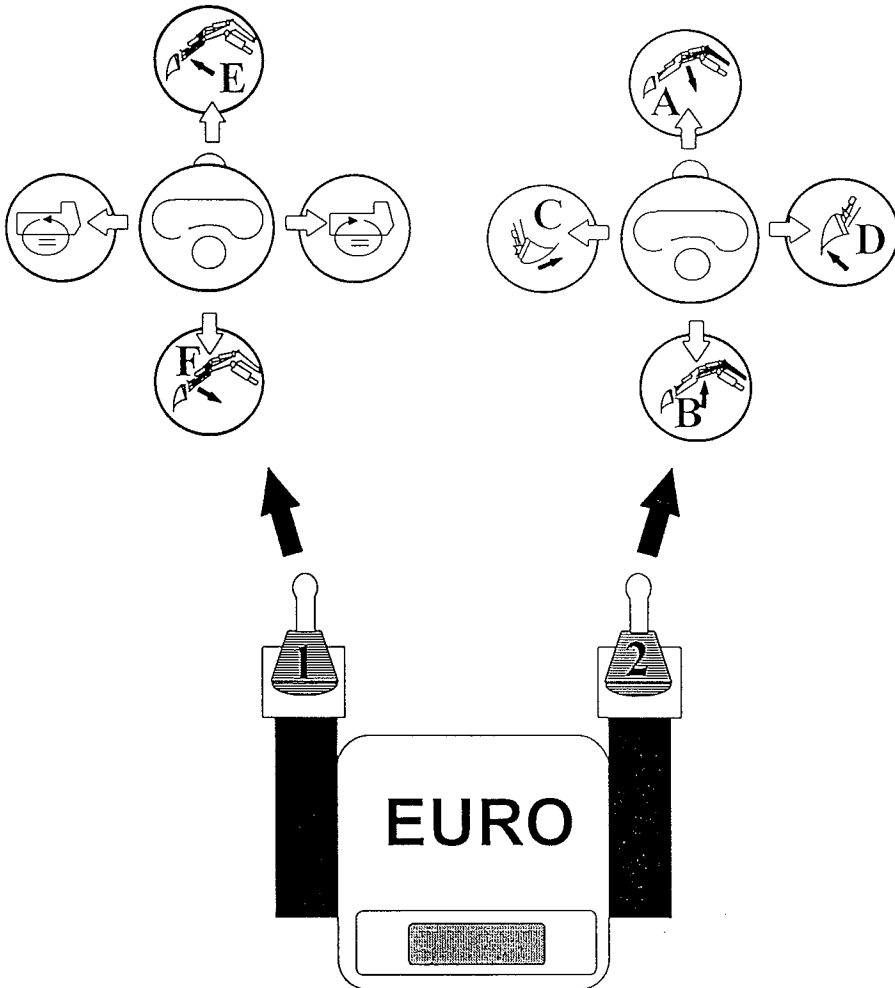
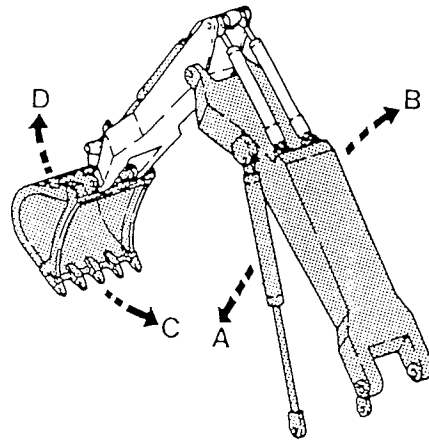
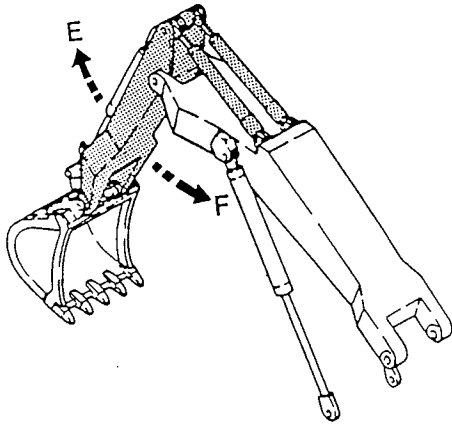

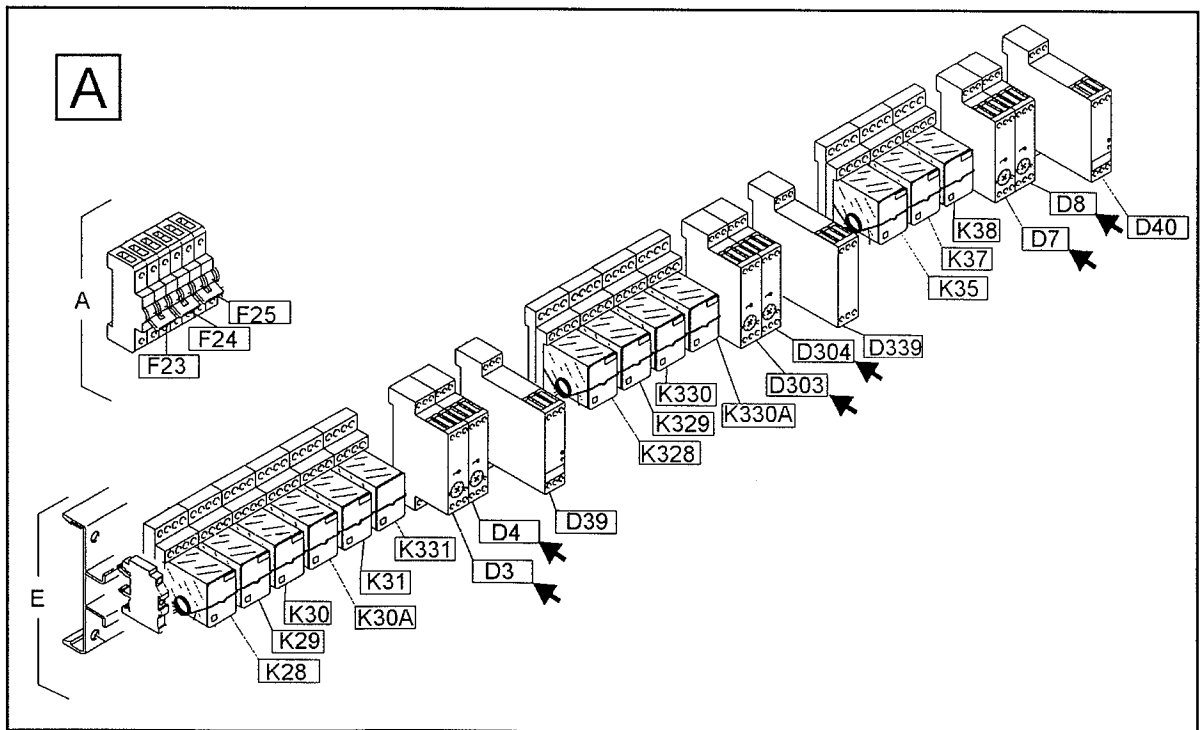
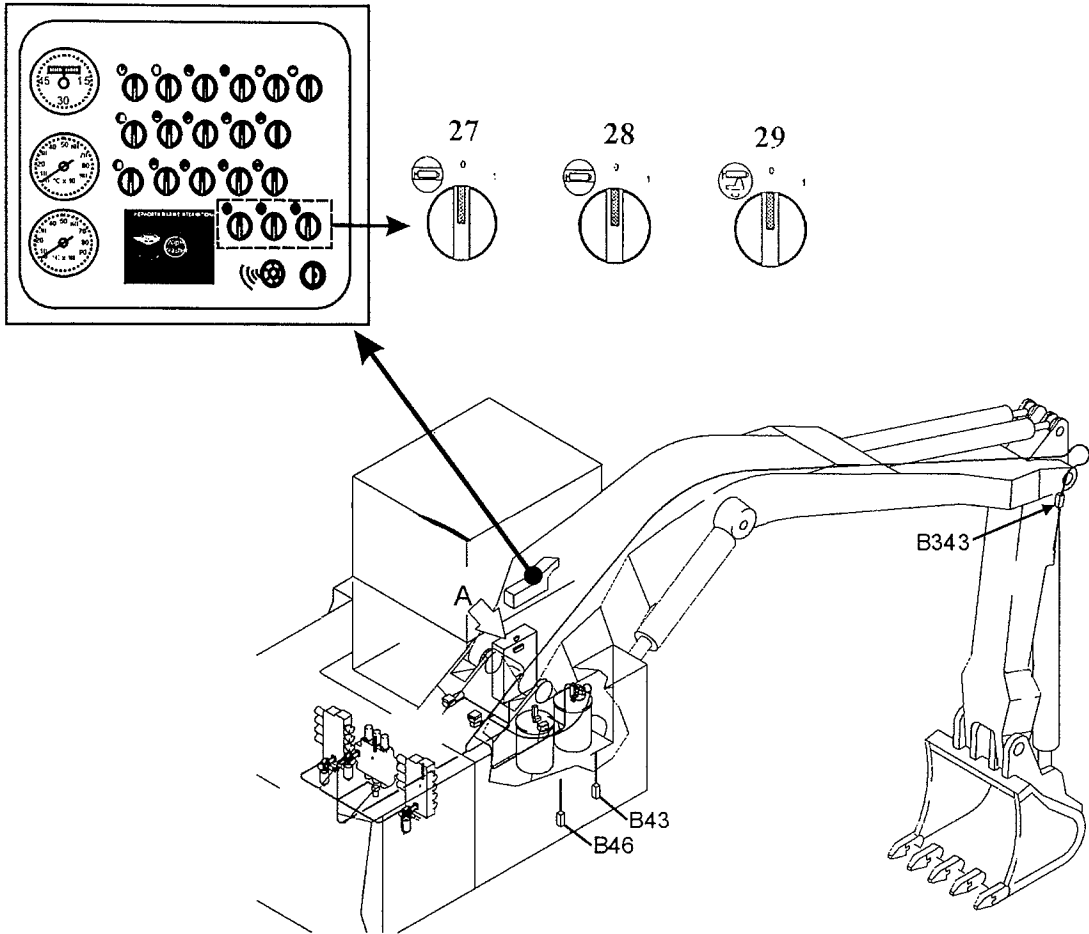

CLICK HERE TO **DOWNLOAD** THE COMPLETE MANUAL

- Thank you very much for reading the preview of the manual.
- You can download the complete manual from: www.heydownloads.com by clicking the link below



- Please note: If there is no response to CLICKING the link, please download this PDF first and then click on it.

CLICK HERE TO **DOWNLOAD** THE COMPLETE MANUAL

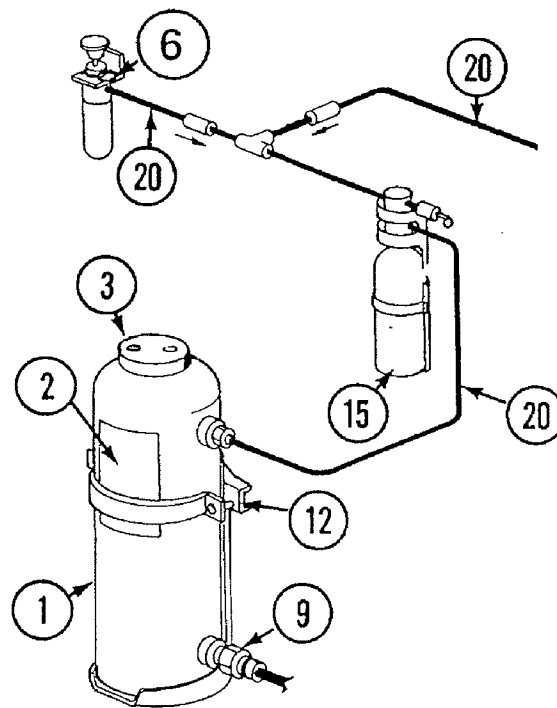
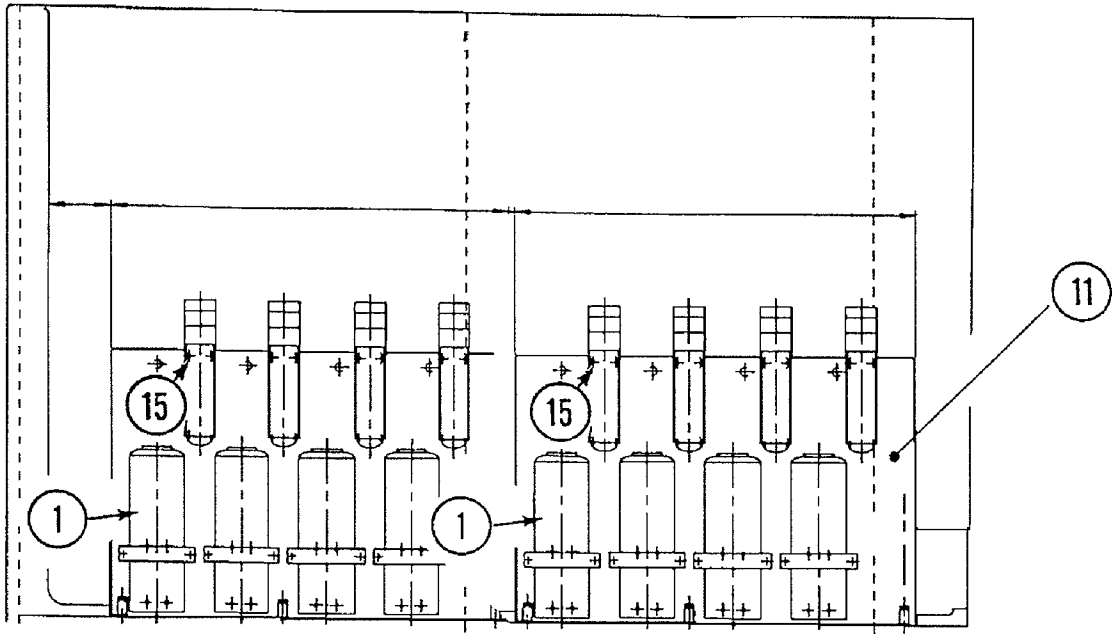

Z 20966

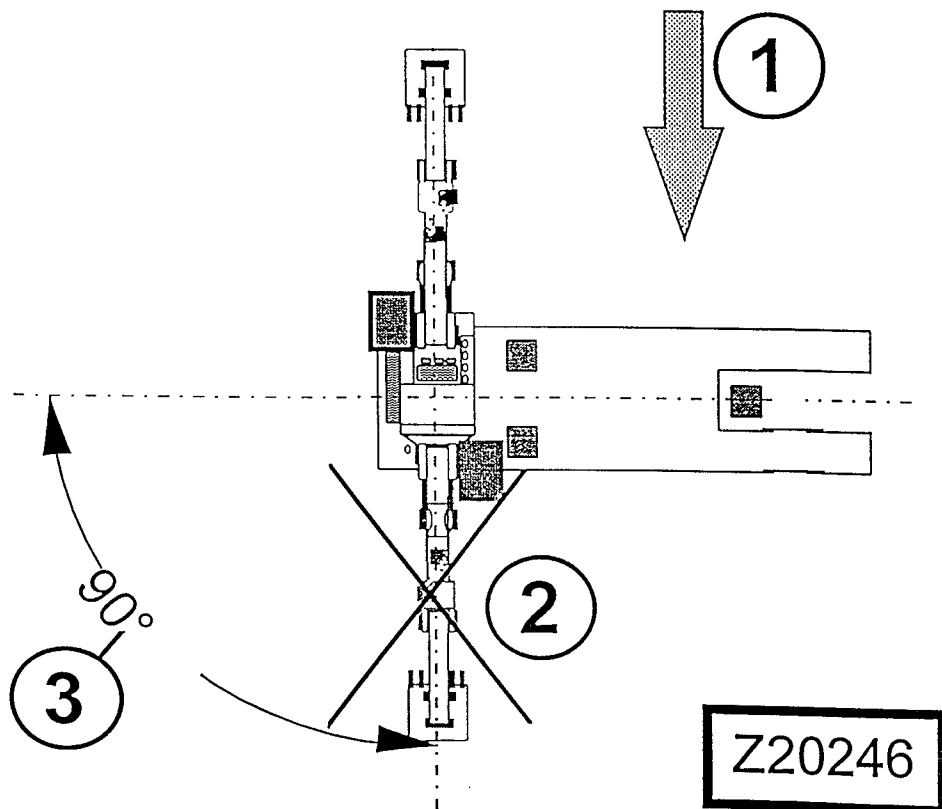
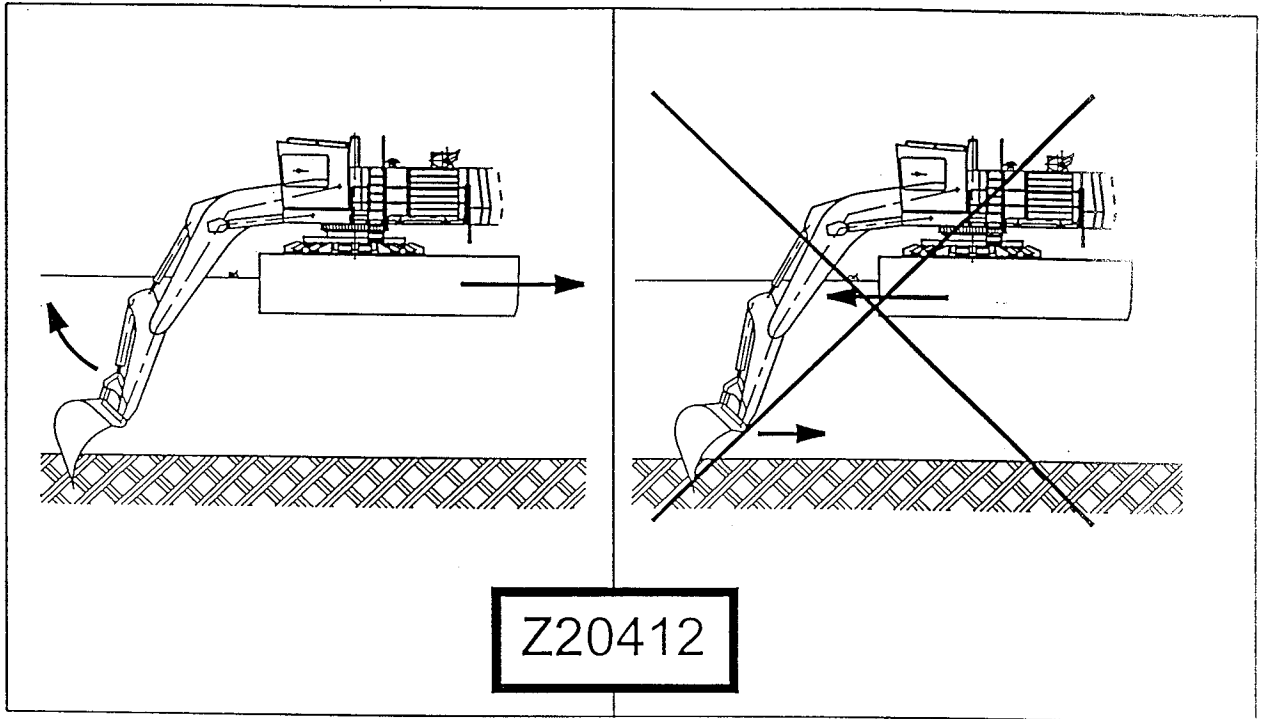

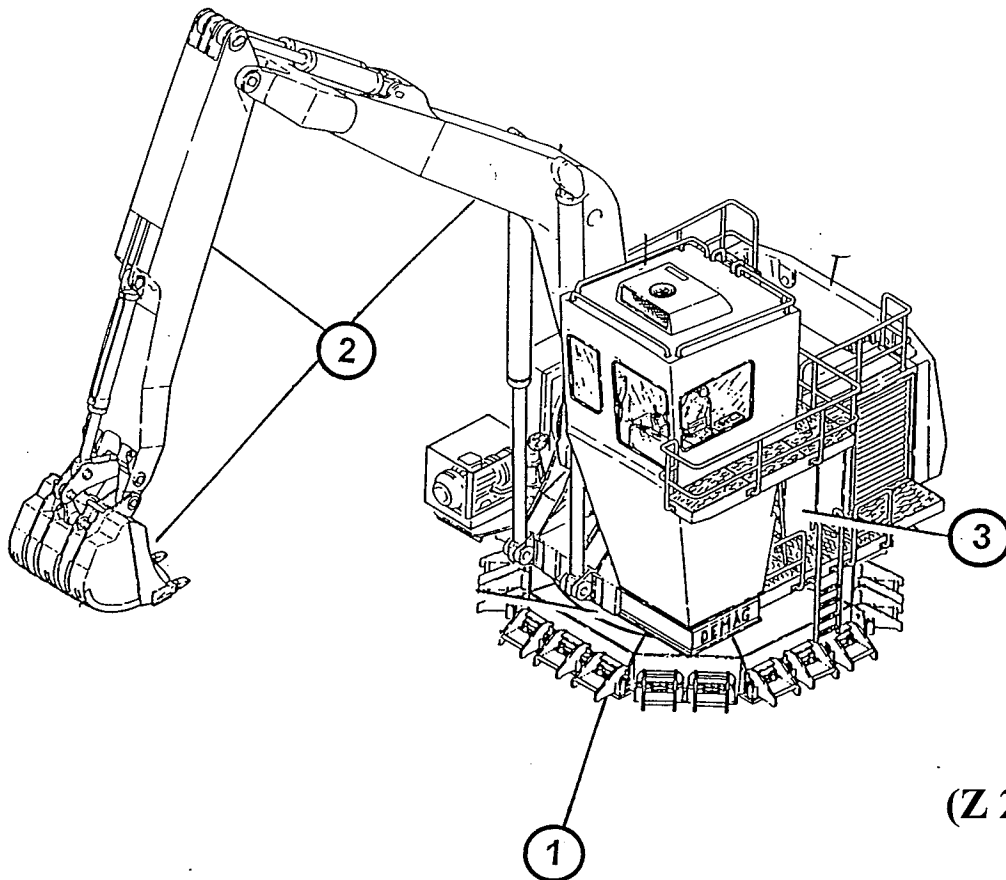
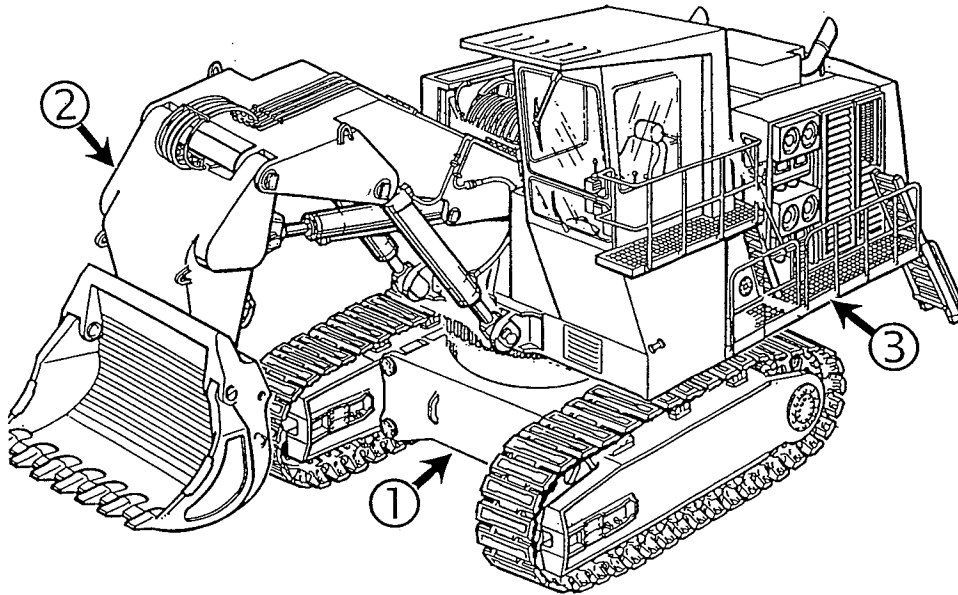



7. Relieve all pressure in the hydraulic system before servicing the hydraulic system.
8. Oily cloth and inflammable material must be removed from the machine. Clean the excavator before starting maintenance work.
9. Switch-off battery main switch and remove key, before working on the electrical system.
10. Wear safety clothing, goggles, respirator and other safety devices, whenever working conditions make this necessary. Observe the local safety rules.
11. Never allow unauthorized persons access to the machine during lubrication and maintenance work.
12. After servicing, remove oily cloth, inflammable material and all tools from the machine
13. Clean the Excavator with a steam jet, especially after servicing fuel system, engine and hydraulic system.
14. Be sure to reinstall safety devices, guards or shields after adjusting and/or servicing the machine.

Service Intervals	No.	Service Point	Service
When necessary (For details refer to section 6.8)	120	Engine air cleaners	Maintenance
	121	Additional fuel system water separator	Drain water or change element
	122	Slew gear ring	Immediately apply grease if bare spots are visible
	123	Lubrication systems	Replace or fill grease containers
	124	--	--
	125	--	--
	126	--	--
	127	--	--
	128	Hydraulic system	Service the oil filter units according to ETM display
	129	Cold starting aid (1)	Replace fluid cartridges
	130	Electrical System	Check circuit breakers and fuses

- (1) Perform Maintenance according to the separate Engine Operation and Maintenance Manual filed in volume 2 binder.

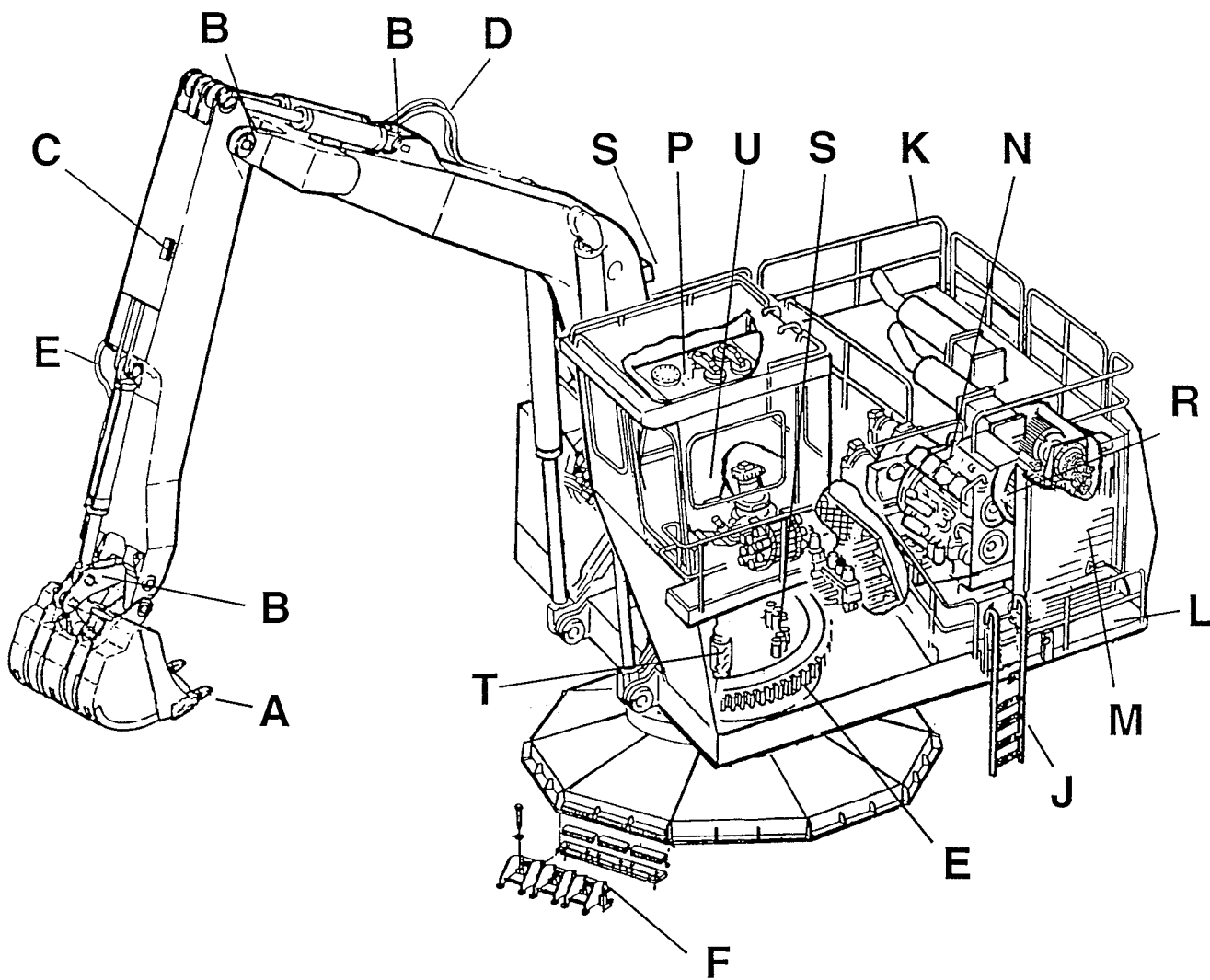

(Z 20245)

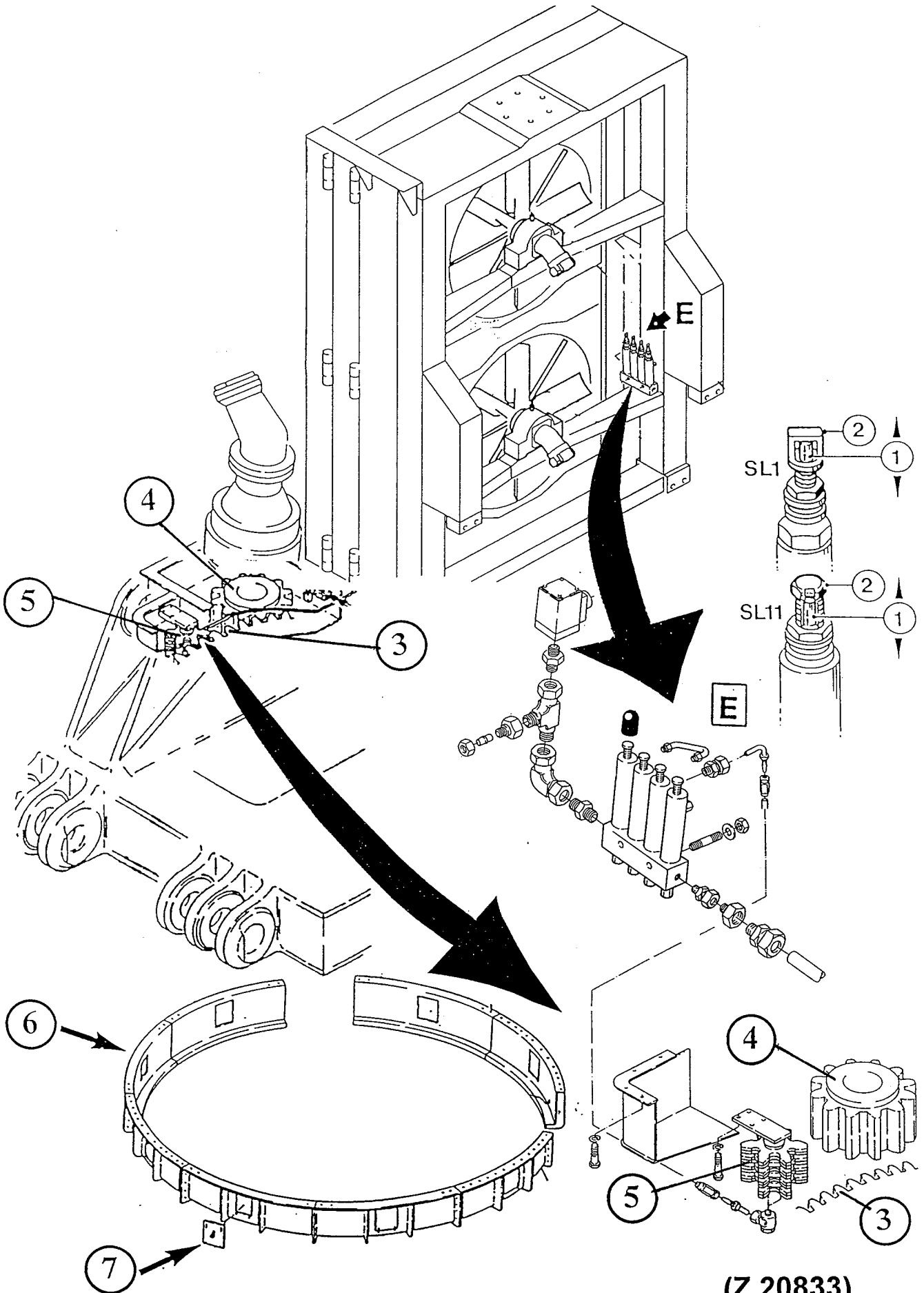

(Z 20833)

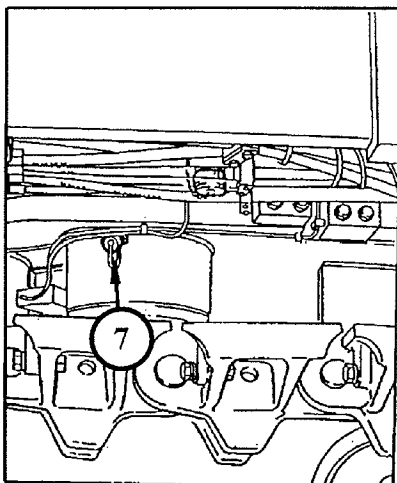
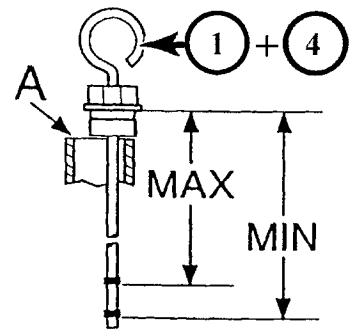
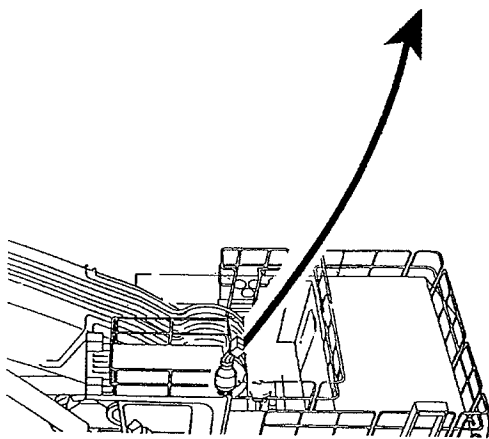
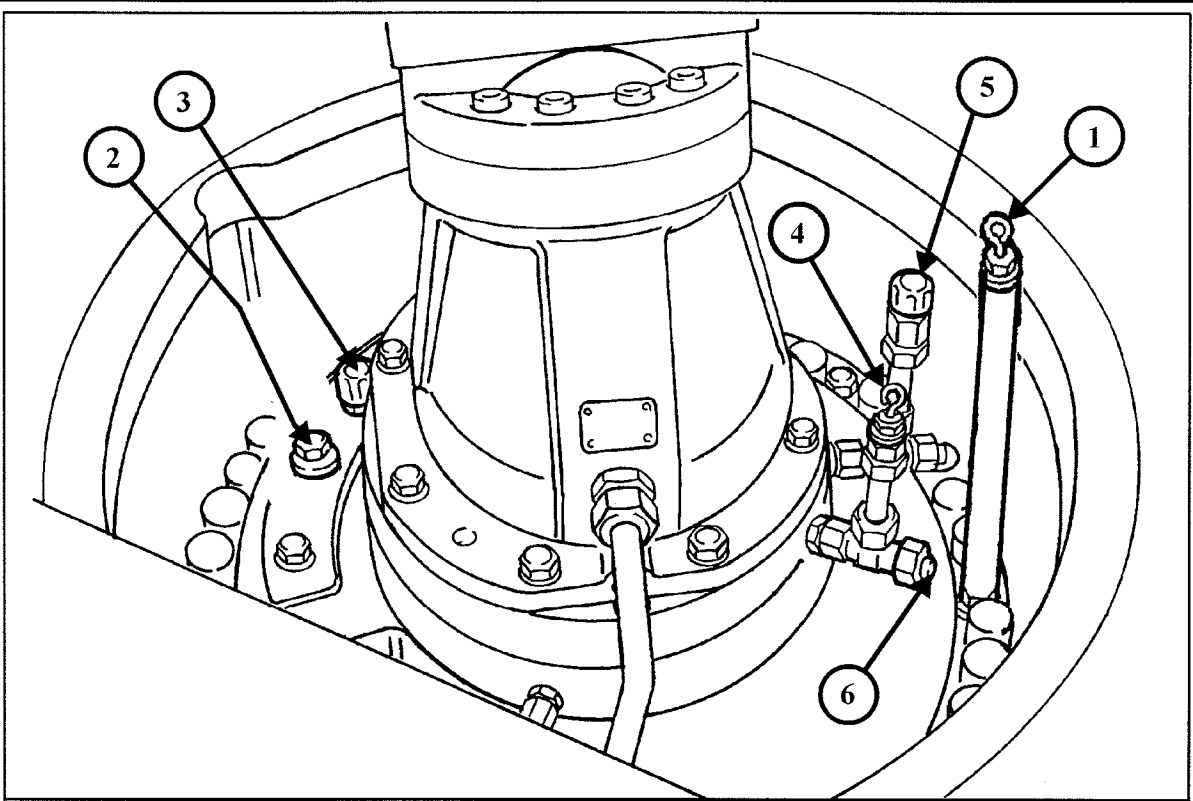

Z 22913

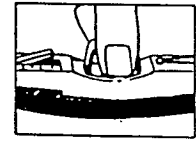
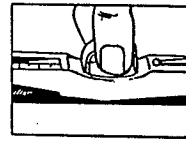
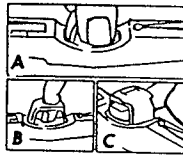
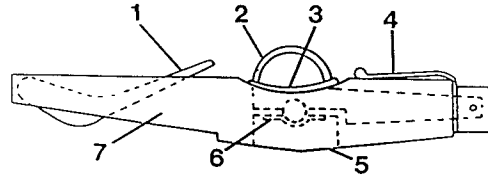
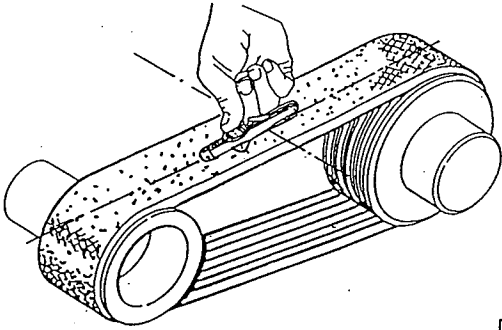

D

E

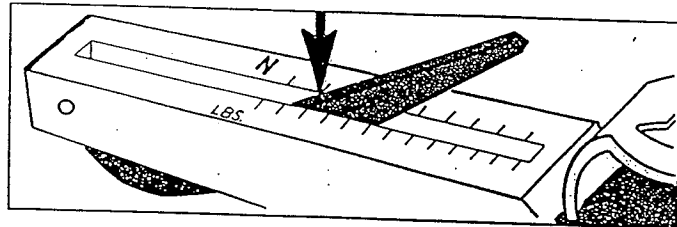

F

(Z 21133)

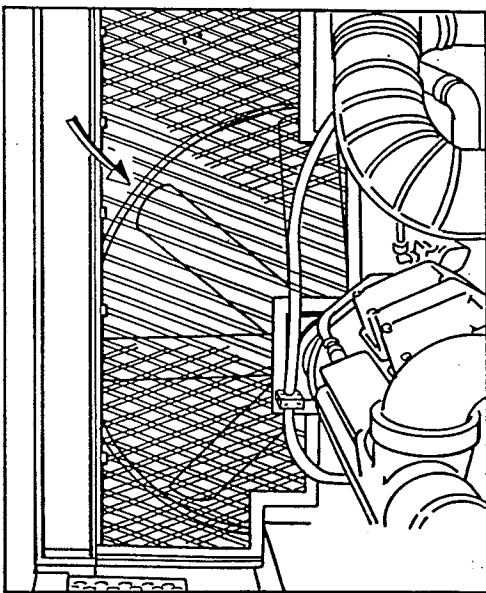

(Z 13579)

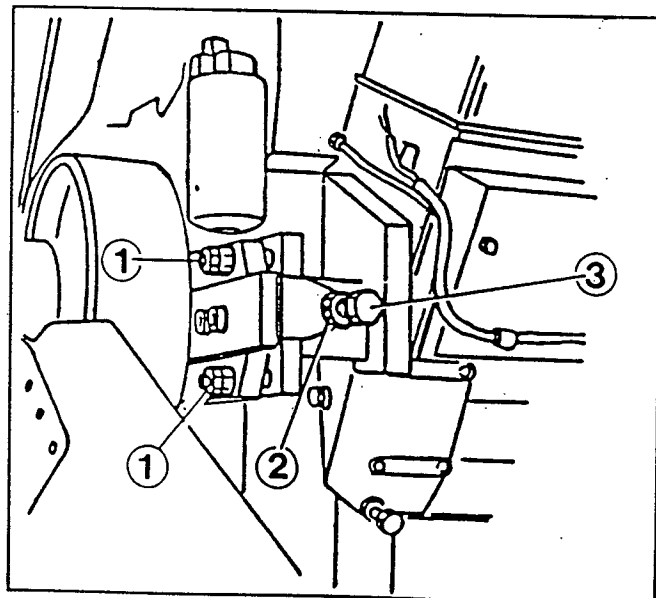

(Z 3175)

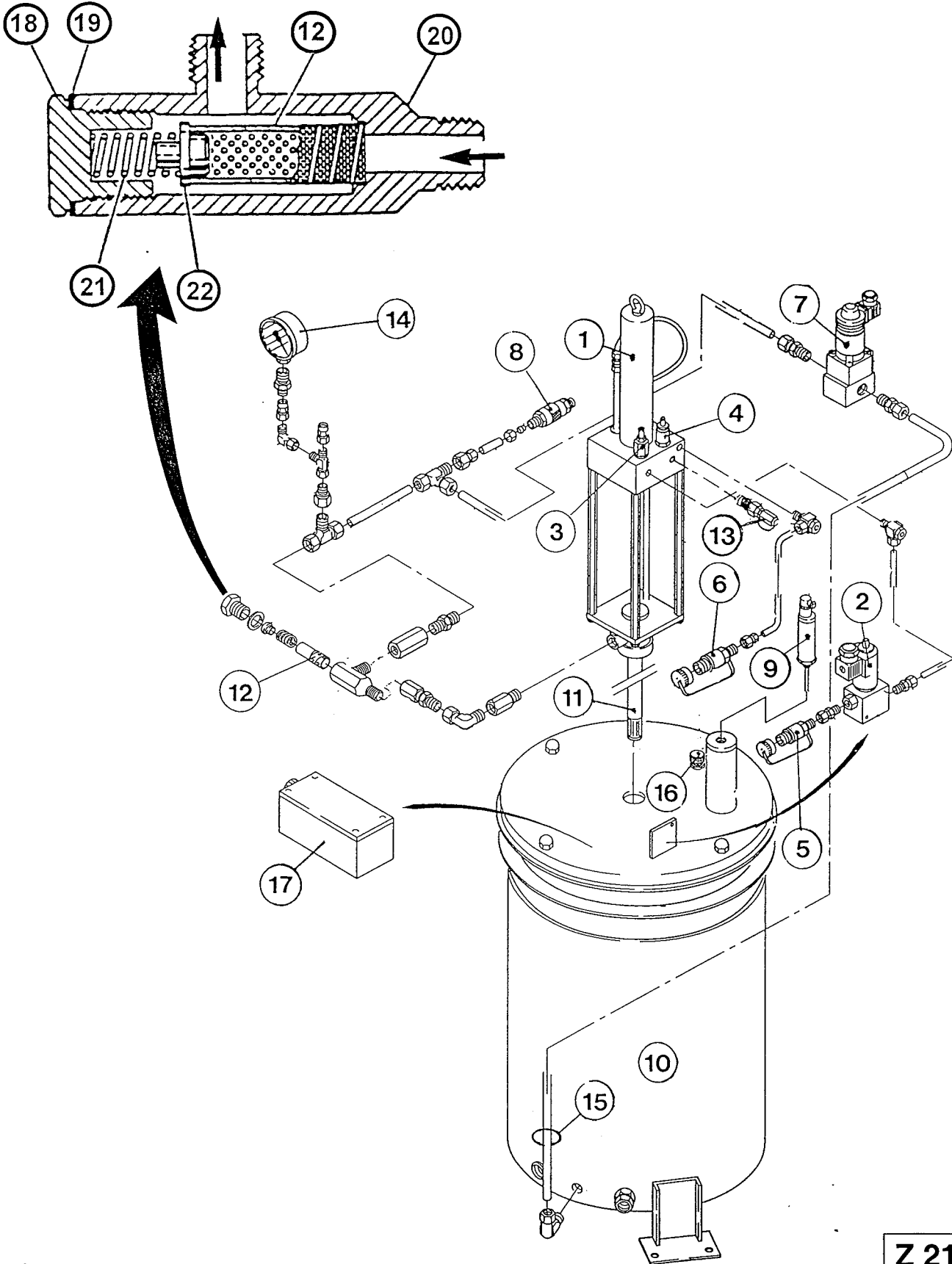

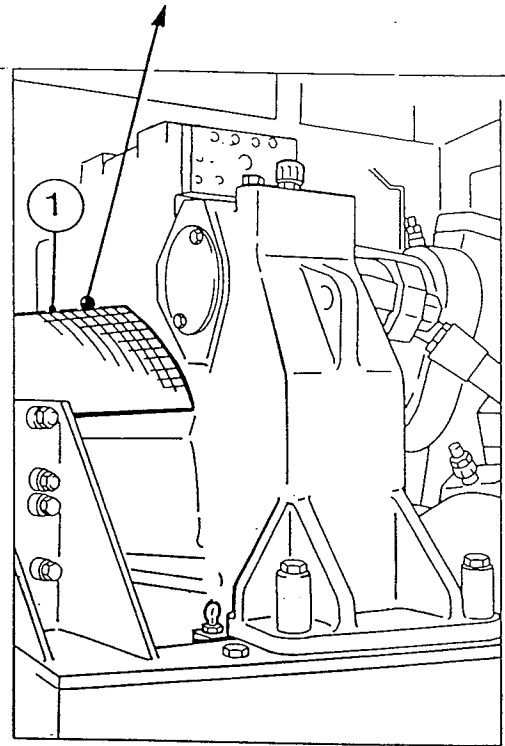
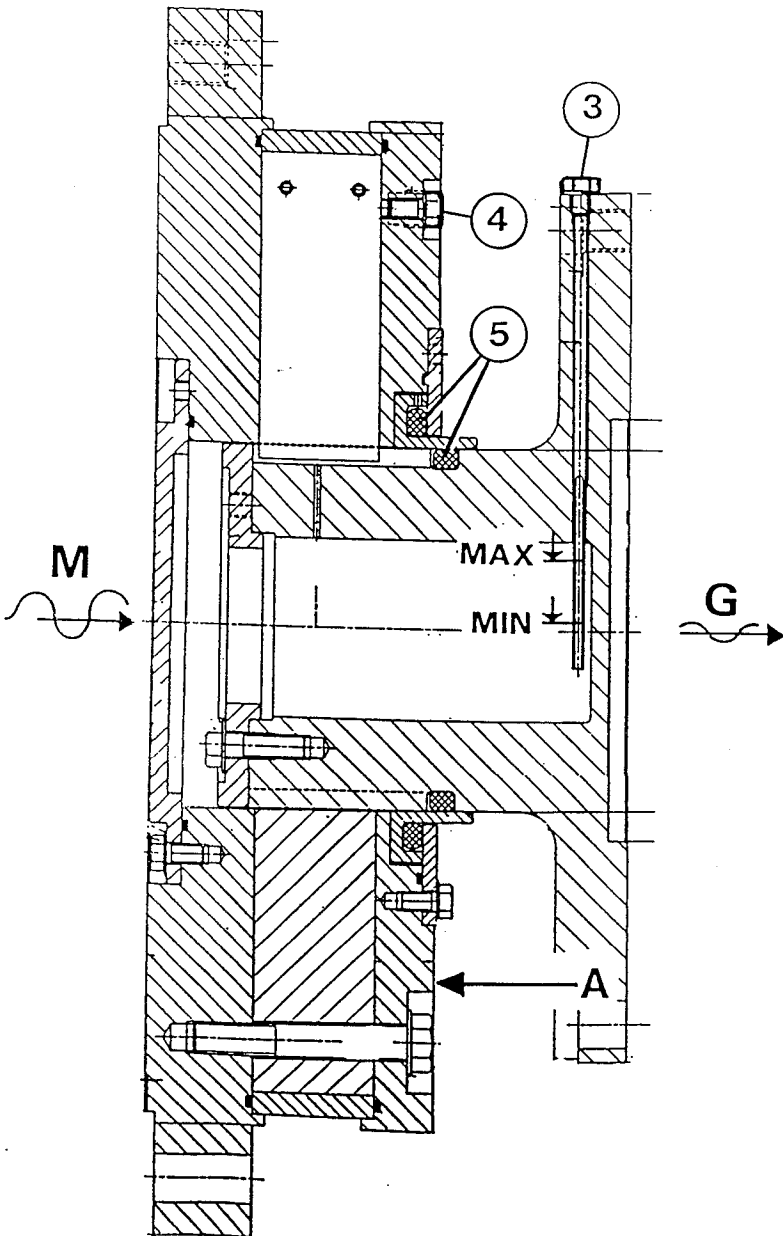
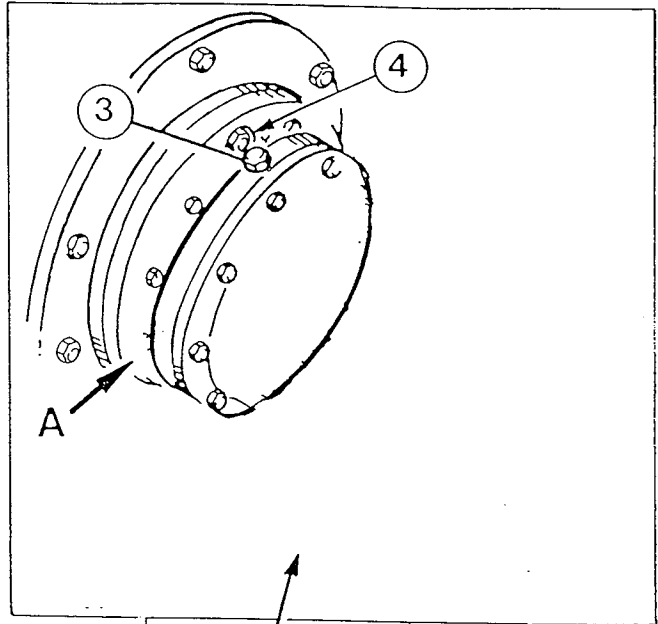
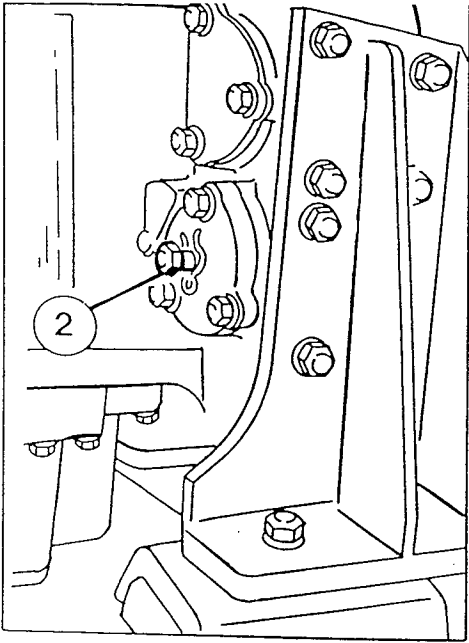

(Z 20703)

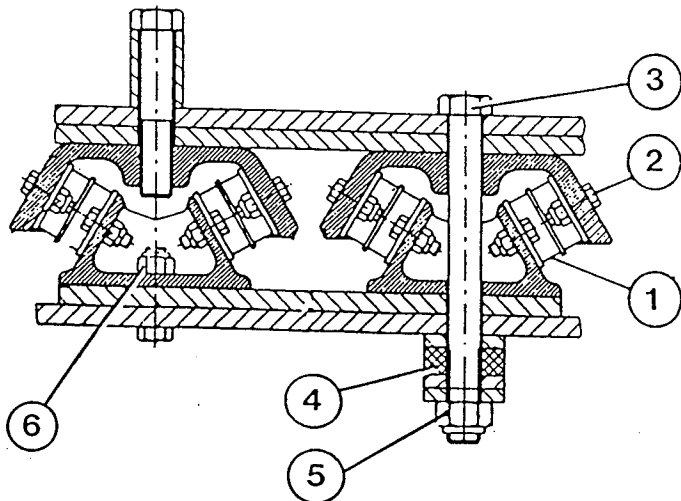
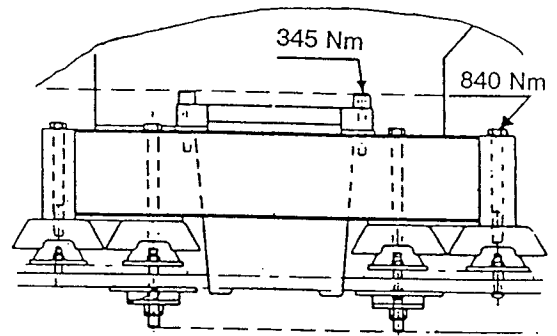
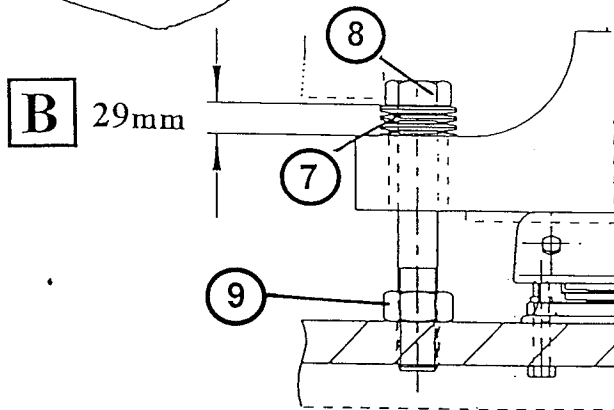
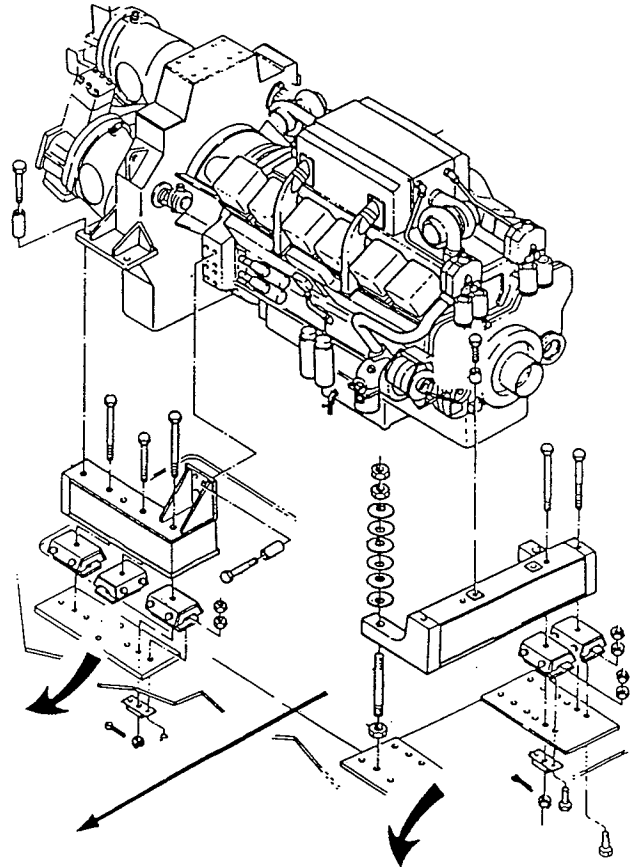
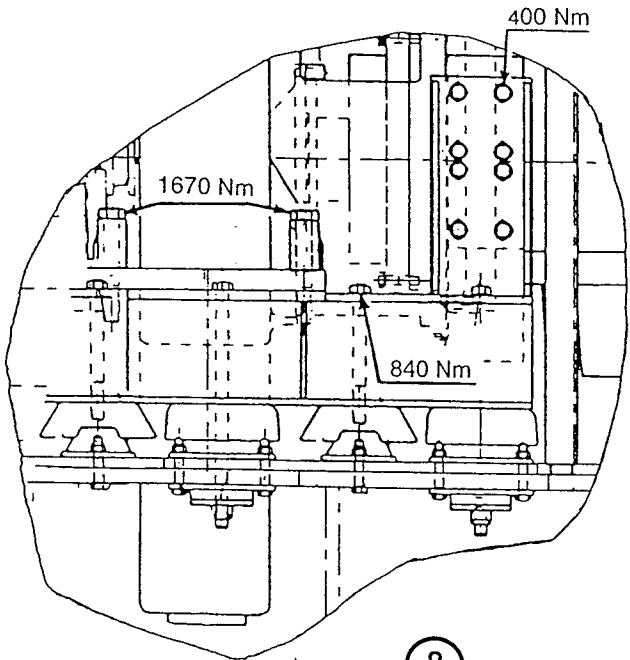

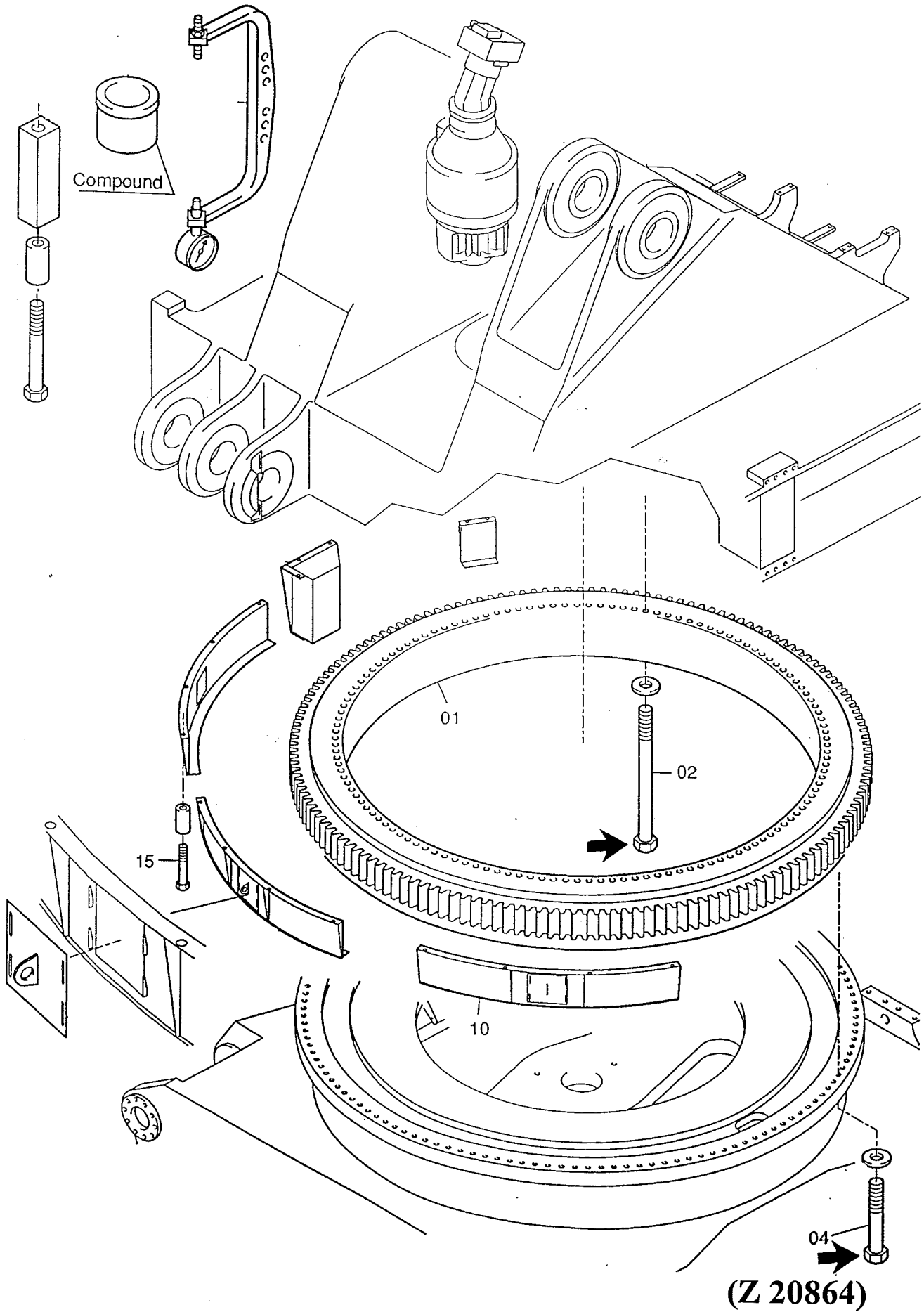

(Z 20864)

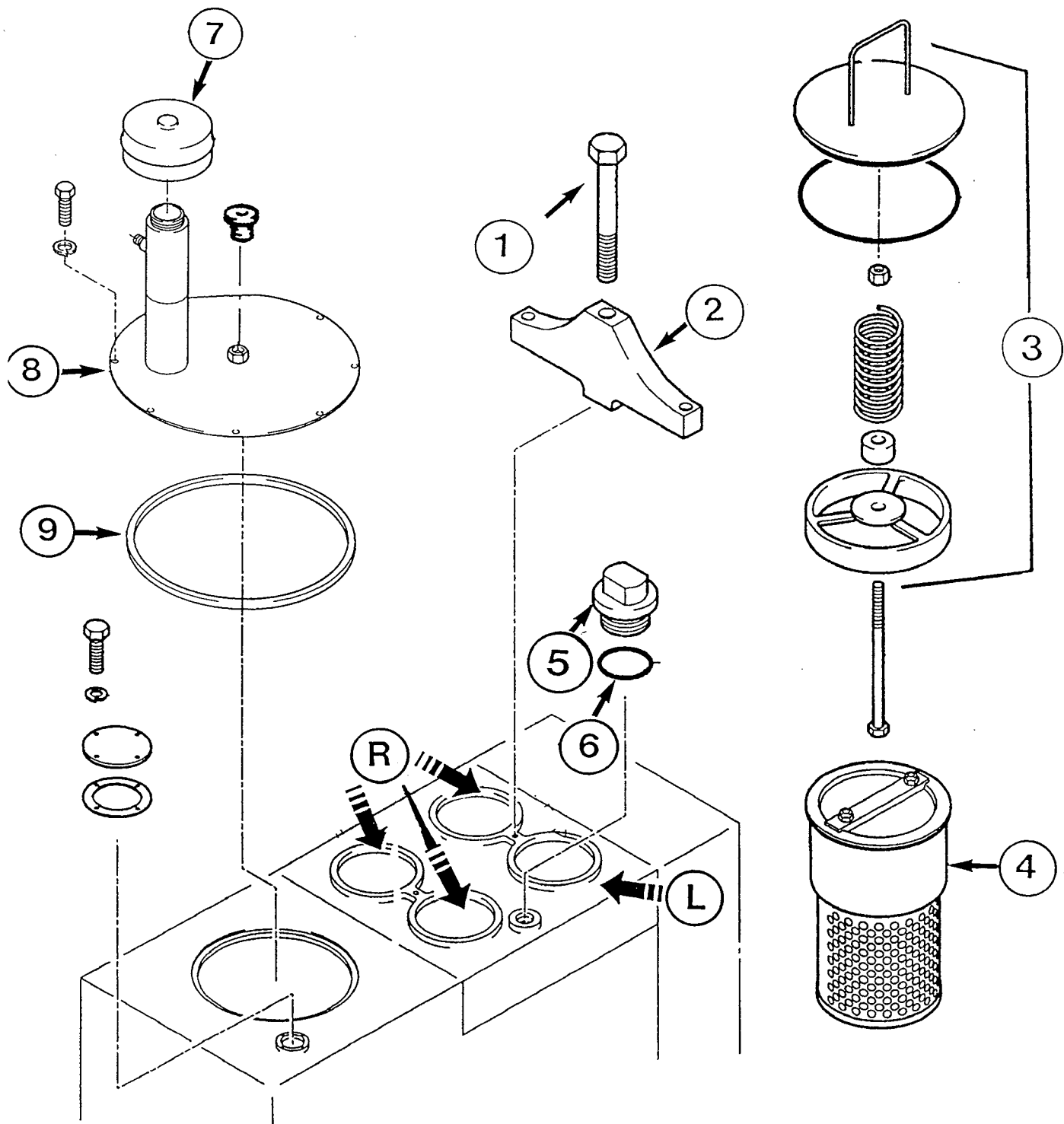

(Z 20872)

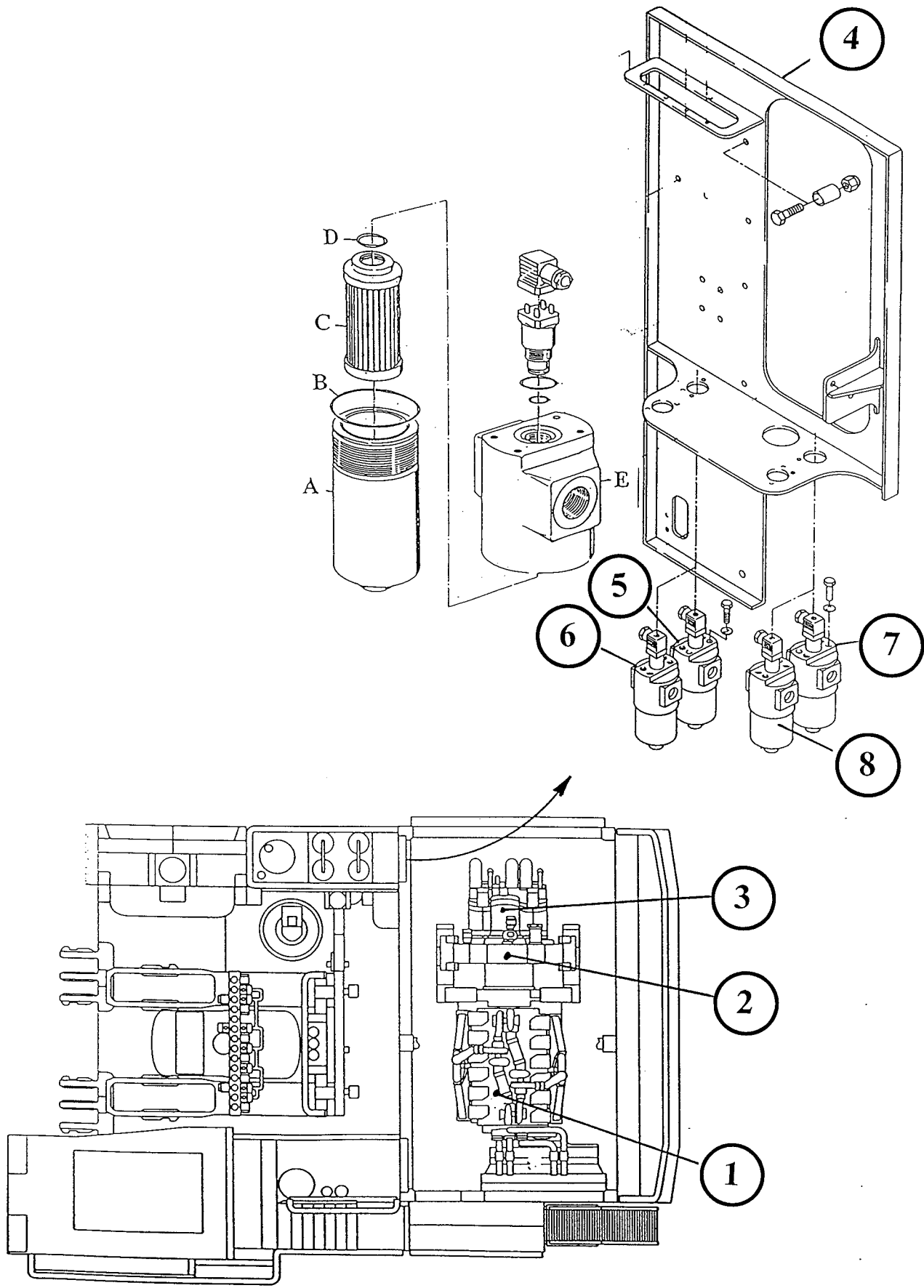

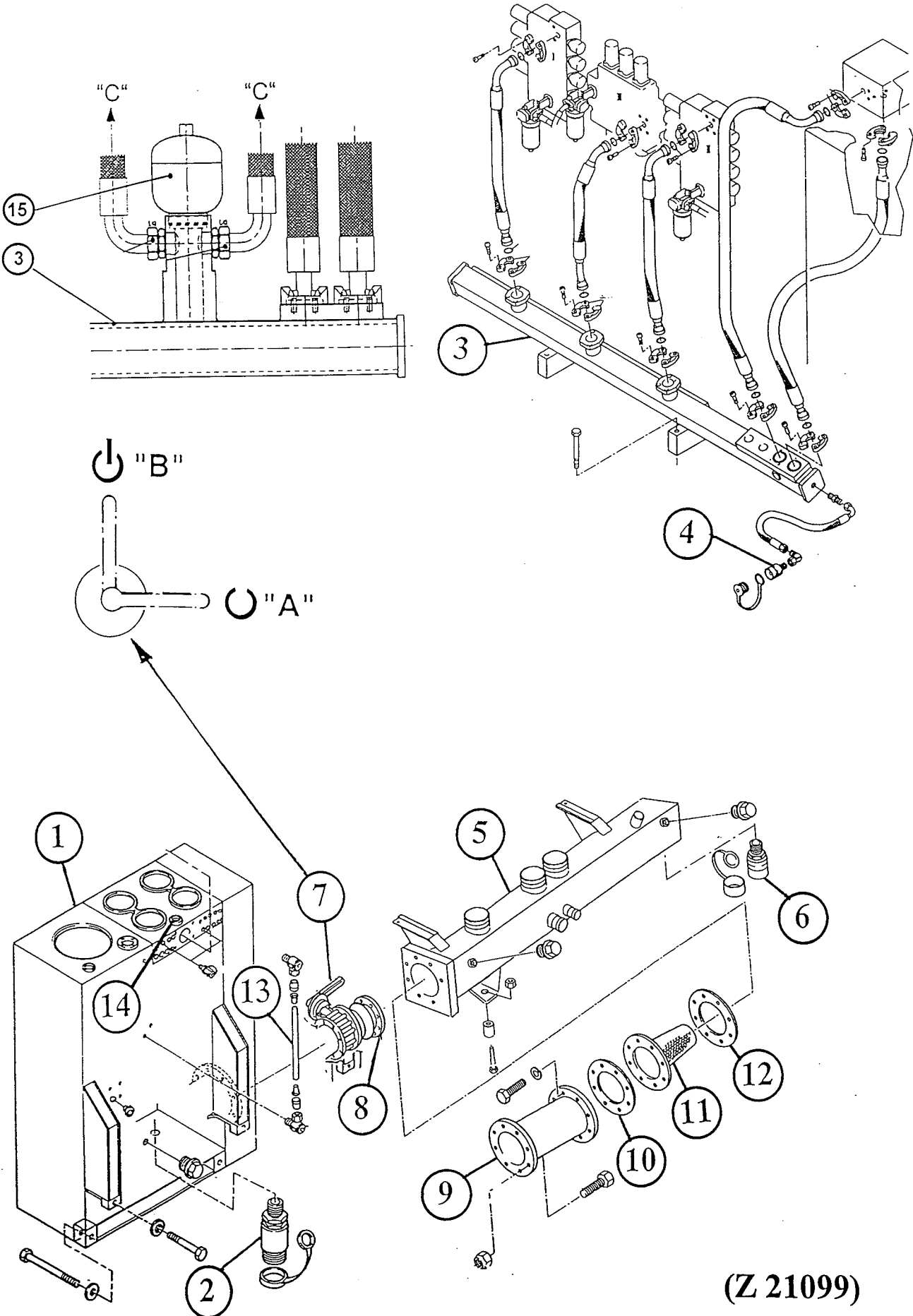

(Z 21099)

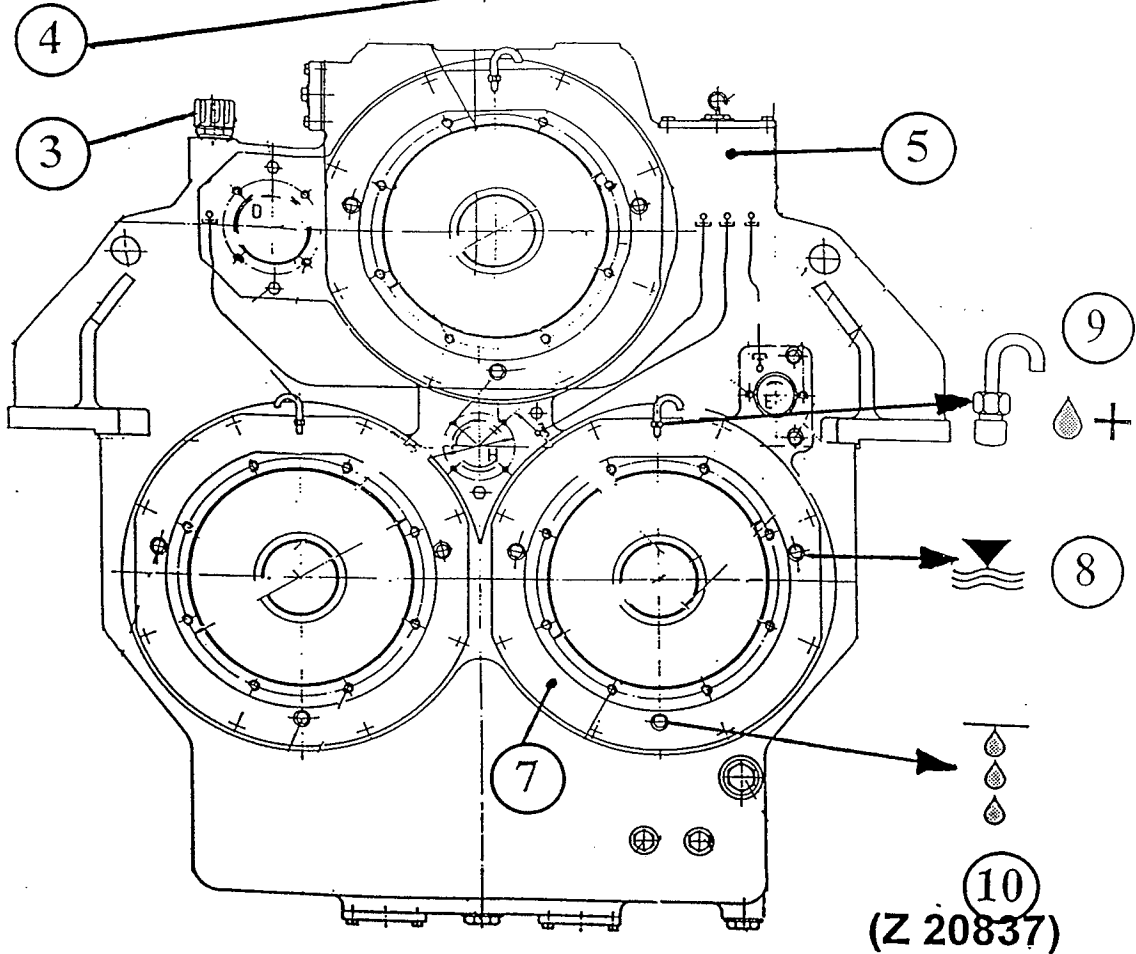
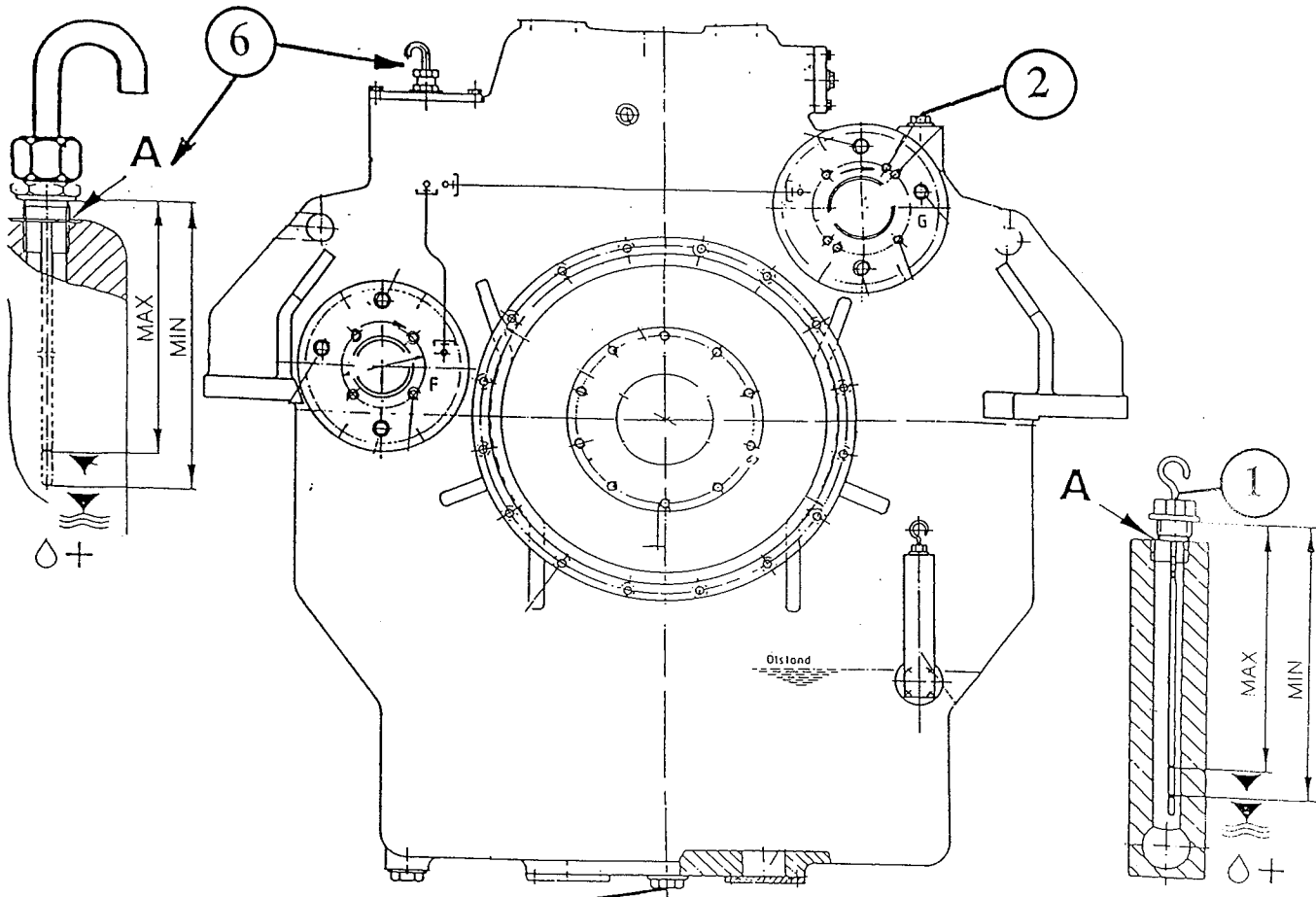

(Z 20837)

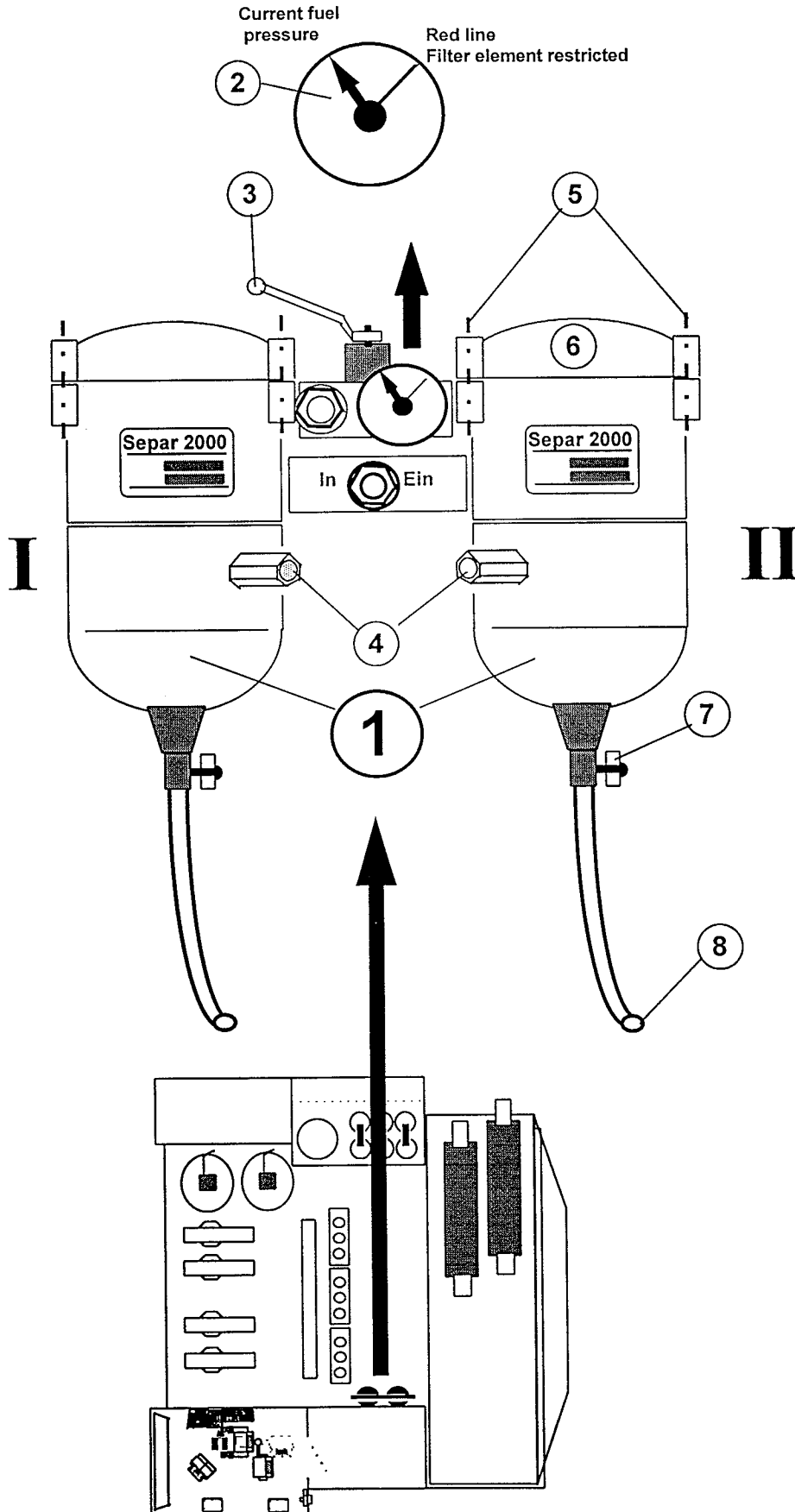

(Z 21049)

CLICK HERE TO **DOWNLOAD** THE COMPLETE MANUAL

- Thank you very much for reading the preview of the manual.
- You can download the complete manual from: www.heydownloads.com by clicking the link below



- Please note: If there is no response to CLICKING the link, please download this PDF first and then click on it.

CLICK HERE TO **DOWNLOAD** THE COMPLETE MANUAL