

S175
S175
HIGH FLOW



Bobcat®

Operation & Maintenance Manual

S/N 517625001 & Above
S/N 518115001 & Above

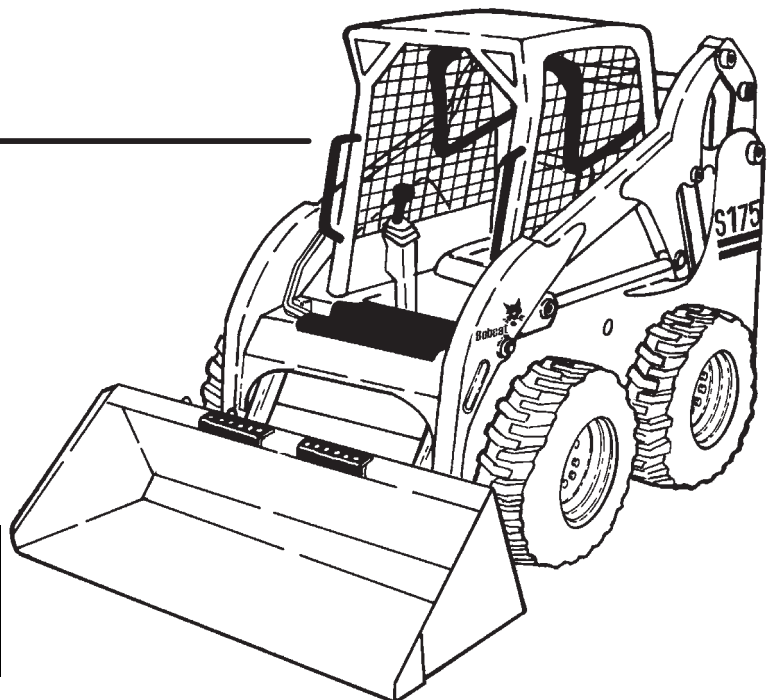

Doosan purchased Bobcat Company from Ingersoll-Rand Company in 2007. Any reference to Ingersoll-Rand Company or use of trademarks, service marks, logos, or other proprietary identifying marks belonging to Ingersoll-Rand Company in this manual is historical or nominative in nature, and is not meant to suggest a current affiliation between Ingersoll-Rand Company and Bobcat Company or the products of either.

**EQUIPPED WITH
BOBCAT INTERLOCK
CONTROL SYSTEM (BICS™)**

6901827 (4-03) Revised (5-12) (6)

An **IR** Ingersoll-Rand business

Printed in U.S.A.

© Bobcat Company 2003

CLICK HERE TO **DOWNLOAD** THE COMPLETE MANUAL

- Thank you very much for reading the preview of the manual.
- You can download the complete manual from: www.heydownloads.com by clicking the link below



- Please note: If there is no response to CLICKING the link, please download this PDF first and then click on it.

CLICK HERE TO **DOWNLOAD** THE COMPLETE MANUAL

FEATURES AND ACCESSORIES

Model S175 Bobcat loaders are equipped with the following standard items:

- Adjustable Cushion Seat
- Automatically Activated Glow Plugs
- Auxiliary Hydraulics: Variable Flow / Maximum Flow
- Bob-Tach
- Bobcat Interlock Control System (BICS™)
- Deluxe Cab
- Dual Path Cooling System
- Engine/Hydraulic System Shutdown
- Instrumentation: Hourmeter Engine Temperature and Fuel Gauges and Warning Lights
- Lift Arm Support Device
- Lights, Front and Rear
- Operator Cab, Deluxe (ROPS & FOPS)
- Parking Brake
- Seat Bar
- Seat Belt
- Spark Arrestor Exhaust System
- Tires 10–16.5 Bobcat Heavy Duty, 8 Ply Rating

Below is a list of some equipment available from your Bobcat Loader dealer as Dealer and / or Factory Installed Accessories and Factory Installed Options. See your Bobcat dealer for other available options, accessories and attachments.

Accessory Wire Harness	Lift Kit(s)
Advanced Control System (ACS) (Selectable Foot Pedal or Hand Control)	Locking Fuel Cap
Advanced Hand Controls	Power Bob-Tach
Attachment Control Device (ACD)	Radiator Screen Kit
Back-up Alarm	Rear Auxiliary Hydraulics
Catalytic Exhaust Purifier	Rear Window Wiper
Cab Enclosure Kit	Side Window Kit
Cab Enclosure (Vinyl)	Seat Belt with 3-Point Restraint
Counterweight Kit	Seat Belt – 3 inch Wide
Cover Kit (Pedal / Footrest Area)	Special Applications Kit
Deluxe Sound Cab	Tailgate Lock
Deluxe Suspension Seat	Tires
Deluxe Instrumentation (With Keyless Start)	Ultra Grip Tread
Dual Attachment Control Kit	Flotation
Engine Heater	Solid
Fire Extinguisher	Top and Rear Cab Windows
FOPS Kit (Level II)	Warning Lights
Front Door Kit	Four-Way Flasher (Includes Direction Signals)
Heater Kit	Rotating Beacon
Horn	Strobe Light
Hydraulic Bucket Positioning (Includes On/Off Selection)	Weighlog Kit

***Specifications subject to
change without notice***

OPERATING INSTRUCTIONS

ATTACHMENTS & BUCKETS	23.
Hand Lever Bob-Tach	
Installing The Bucket Or Attachment	24
Removing The Bucket Or Attachment	25
Power Bob-Tach (If Equipped)	
Installing The Bucket Or Attachment	26
Removing The Bucket Or Attachment	27
DAILY INSPECTION	16.
ENGINE SPEED CONTROL	8.
HYDRAULIC CONTROLS	11.
Attachment Auxiliary Hydraulics	13.
Attachment Control Device (ACD) (If Equipped)	15
Auxiliary Hydraulics Button	13.
Disengage	13.
Maximum Flow Only	13.
Variable Flow	13.
Bucket Position Valve Operation (If Equipped)	15
Front Auxiliary Hydraulics Operation	13
Variable Flow	13.
Maximum Flow Only	13.
Foot Pedals	11.
Lift Arm Float Position	
Lift Arm Operation	
Tilt Operation	
Advanced Hand Controls (If Equipped)	11
Lift Arm Float Position	
Lift Arm Operation	
Tilt Operation	
High Flow Hydraulics Operation	14.
Quick Couplers	12.
Rear Auxiliary Hydraulics Operation (If Equipped)	13
Releasing Hydraulic Pressure	12.
Secondary Front Auxiliary Hydraulics (If Equipped)	14
INSTRUMENT PANEL IDENTIFICATION	3.
Cab Light	7.
Left Panel	
Standard & Deluxe Instrument Panels	3.
Right Panel	
Standard Instrument Panel (With Key Switch)	4.
Deluxe Instrument Panel (With Keyless Start)	5.
Option & Field Accessory Panels	
Side Console	6.
Front-Center Panel	6.
LIFT ARM BY-PASS CONTROL	7.
LIFTING THE LOADER	34.
Single Point Lift	34.
Four Point Lift	34.
MONITORING THE DISPLAY PANEL	22

OPERATING INSTRUCTIONS

HYDRAULIC CONTROLS

Put your feet on the pedals (or footrests) and KEEP THEM THERE any time you operate the loader.

Two foot pedals (or hand controls) (Item 1) [A] and [B] control the hydraulic cylinders for the lift and tilt functions.

Foot Pedals

Lift Arm Operation [A]

The left pedal controls the lift arms.

Push on the bottom (heel) (Item 2) [A] of the pedal to raise the lift arms.

Push on the top (toe) (Item 3) [A] of the pedal to lower the lift arms.

Lift Arm Float Position [A]

Push the top (toe) (Item 3) [A] of the pedal all the way forward until it locks into the *float* position.

Use the *float* position of the lift arms to level loose material while driving backward.

Push the bottom of the left pedal to unlock from the *float* position.

Tilt Operation [B]

The right pedal controls the bucket.

Push the bottom (heel) (Item 2[B]) of the pedal to tilt the bucket backward.

Push the top (toe) (Item 3) [B] of the pedal to tilt the bucket forward.

Hand Controls (If Equipped)

Lift Arm Operation [A]

The left hand lever controls the lift arms.

Move the left hand lever away from the operator (Item 4) [A] to raise the lift arms.

Move the left hand lever toward the operator (Item 5) [A] to lower the lift arms.

Lift Arm Float Position [A]

To Engage: Press and hold the Float Button (Item 6) [A] while the lever is in neutral. Move the lever to the lift arm down position (Item 5) [A], then release the button.

To Disengage: Press Float Button again or move the lever to the lift arm up position (Item 4) [A].

Use the *float* position of the lift arms to level loose material while driving backward.

Move the left hand lever upward to unlock from the *float* position.

Tilt Operation [B]

The right hand lever controls the bucket.

Move the right hand lever toward the operator (Item 5) [B] to tilt the bucket backward.

Move the right hand lever away from the operator (Item 4) [B] to tilt the bucket forward.

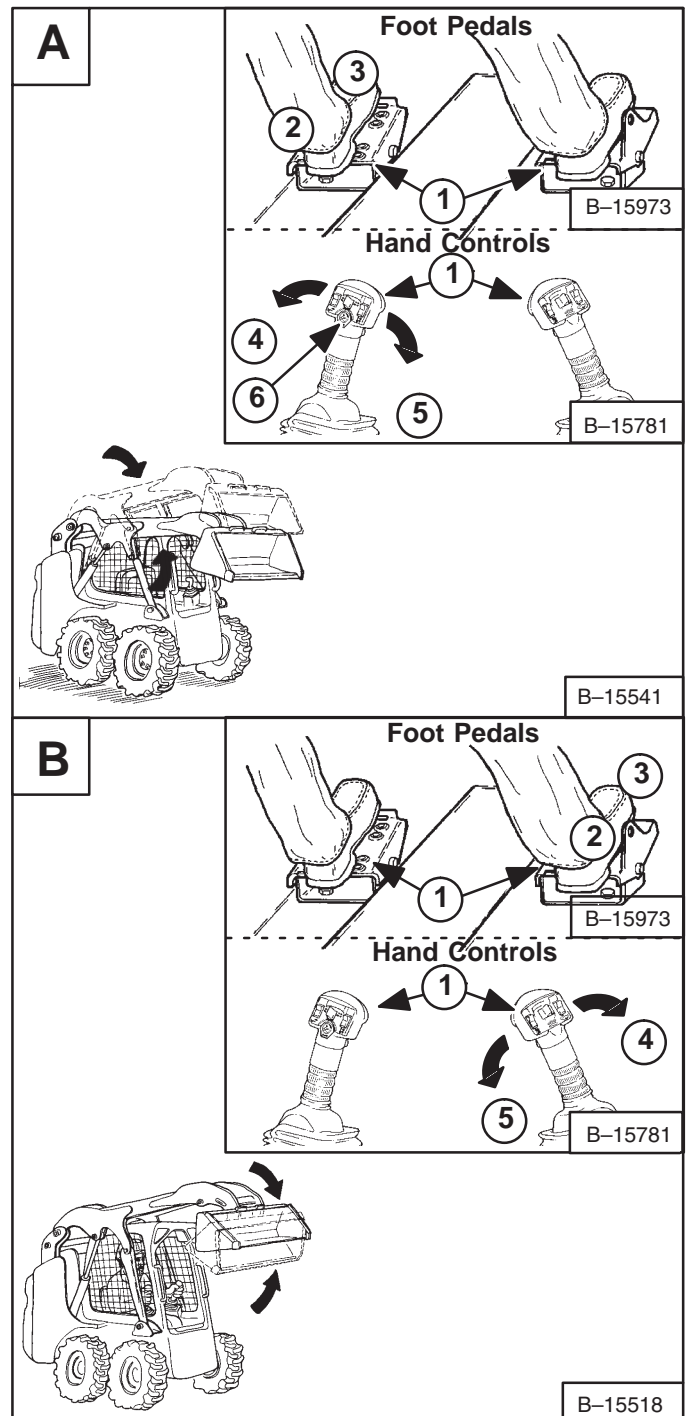

STARTING THE ENGINE (Cont'd)

Cold Temperature Starting

If the temperature is below freezing, perform the following to make starting the engine easier:

- Replace the engine oil with the correct type and viscosity for the anticipated starting temperature. (See *ENGINE LUBRICATION SYSTEM* Page 54.)
- Make sure the battery is fully charged.
- Install an engine heater, available from your Bobcat loader dealer.

NOTE: The LCD of the *Deluxe Panel* may not be immediately visible when the temperature is below -15°F (-26°C). It may take **30 seconds to several minutes** for the Display Panel to warm up. All systems remain monitored even when the display is off.

Warming the Hydraulic/Hydrostatic System

IMPORTANT

When the temperature is below -20°F (-30°C), hydrostatic oil must be warmed before starting. The hydrostatic system will not get enough oil at low temperatures and will be damaged. Park the machine in an area where the temperature will be above 0°F (-18°C) if possible.

I-2007-1285

Let the engine run for a minimum of 5 minutes to warm the engine and hydrostatic transmission fluid before operating the loader.

If the Fluid Pressure Icon light (Item 1) [A] (*Standard Panel*) or [B] (*Deluxe Panel*) comes ON when operating the loader (cold), more warm up time is needed.

STOPPING THE ENGINE

Pull the engine speed control fully backward [C] to decrease the engine speed.

Turn the key switch to the ST OP position [A] (*Standard Panel*) or press the ST OP Button (Item 2) [B] (*Deluxe Panel*).

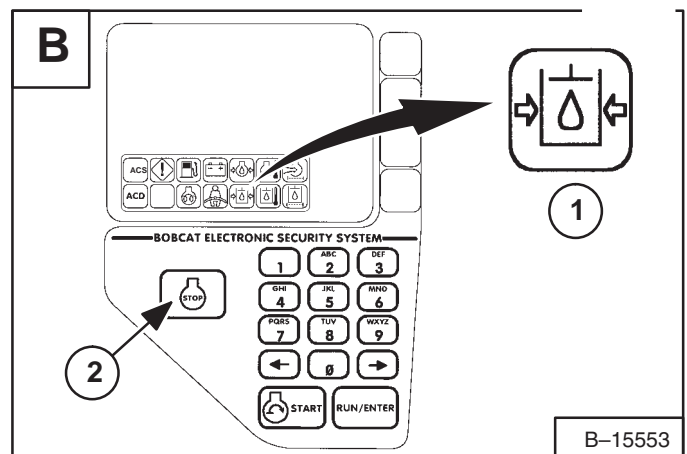
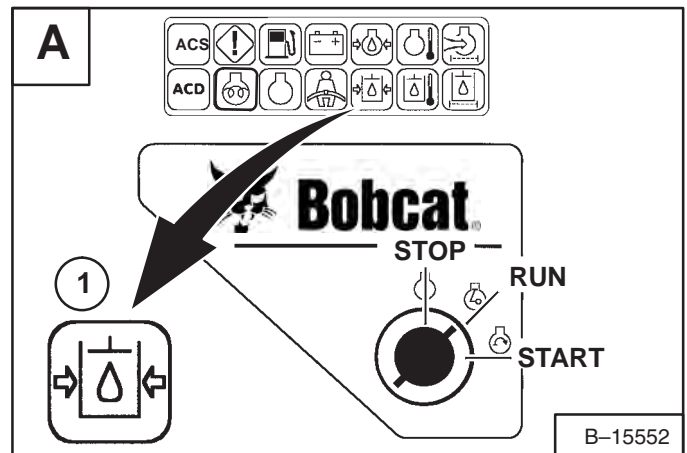
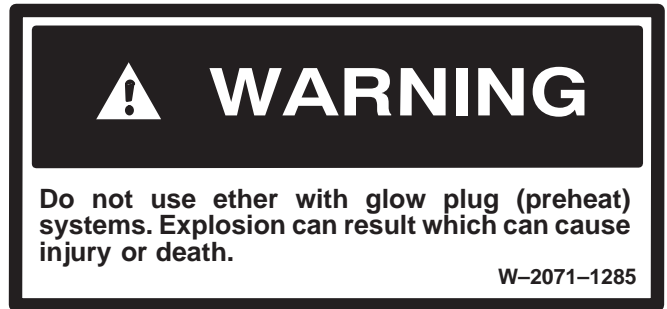

OPERATING PROCEDURES (FOOT PEDALS) (Cont'd)

Digging Into the Ground (Foot Pedals)

Put the lift arms all the way down. Push the top of the tilt pedal (Item 1) **[A]** until the cutting edge of the bucket is on the ground.

Drive forward slowly and continue to tilt the bucket down (Item 1) **[A]** until it enters the ground.

Push the bottom of the tilt pedal a small amount to increase traction and keep an even digging depth. Continue to drive forward until the bucket is full. When the ground is hard, raise and lower the cutting edge of the bucket with the tilt pedal while driving forward slowly.

Push the bottom of the tilt pedal (Item 1) **[B]** to tilt the bucket backward as far as it will go when the bucket is full.

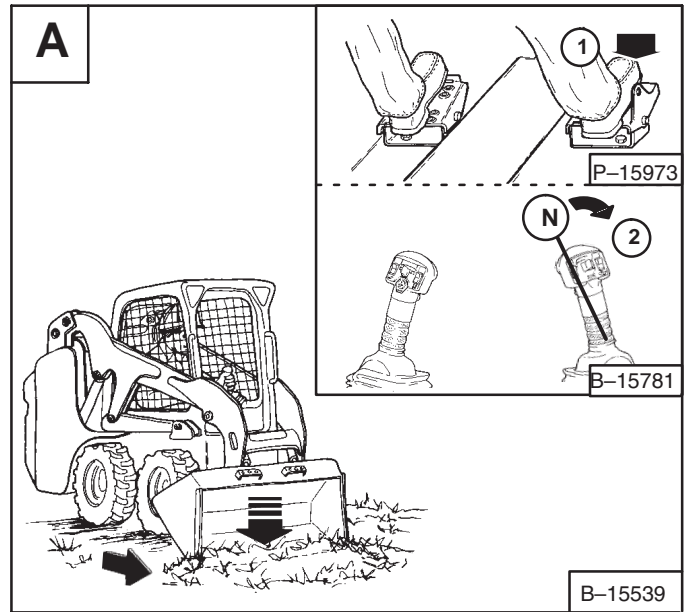

Digging Into the Ground (Hand Controls)

Put the lift arms all the way down. Move the right hand lever away from the operator (Item 2) **[A]** until the cutting edge of the bucket is on the ground. Drive forward slowly and continue to tilt the bucket down until it enters the ground.

Move the right hand lever toward the operator a small amount to increase traction and keep an even digging depth. Continue to drive forward until the bucket is full. When the ground is hard, raise and lower the cutting edge of the bucket with the hand lever while driving forward slowly.

Move the right hand lever toward the operator (Item 2) **[B]** to tilt the bucket backwards as far as it will go when the bucket is full.

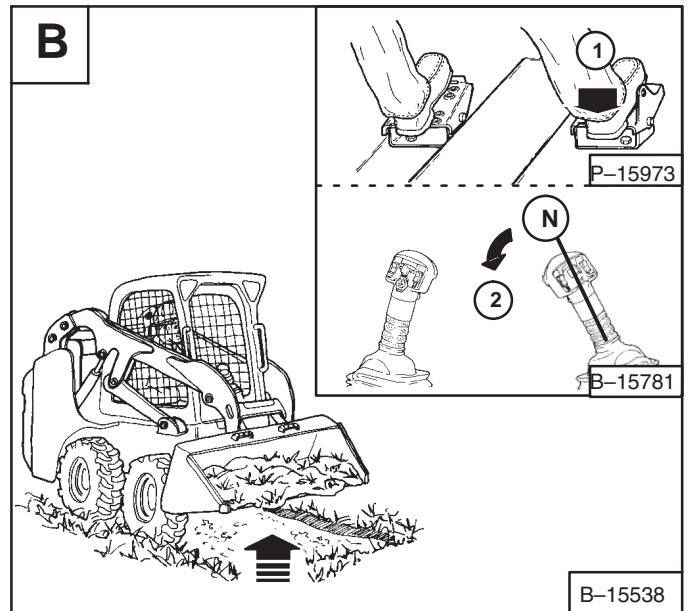

Backfilling (Foot Pedals)

Lower the lift arms (Item 1) **[C]** and put the cutting edge of the bucket on the ground. Drive forward to the edge of the hole to push the material into the hole.

Tilt the bucket forward (Item 2) **[C]** as soon as it is past the edge of the hole.

If necessary, raise the lift arms to empty the bucket.

Backfilling (Hand Controls)

Lower the lift arms (Item 3) **[C]** and put the cutting edge of the bucket on the ground. Drive forward to the edge of the hole to push the material into the hole.

Tilt the bucket forward (Item 4) **[C]** as soon as it is past the edge of the hole.

If necessary, raise the lift arms to empty the bucket.

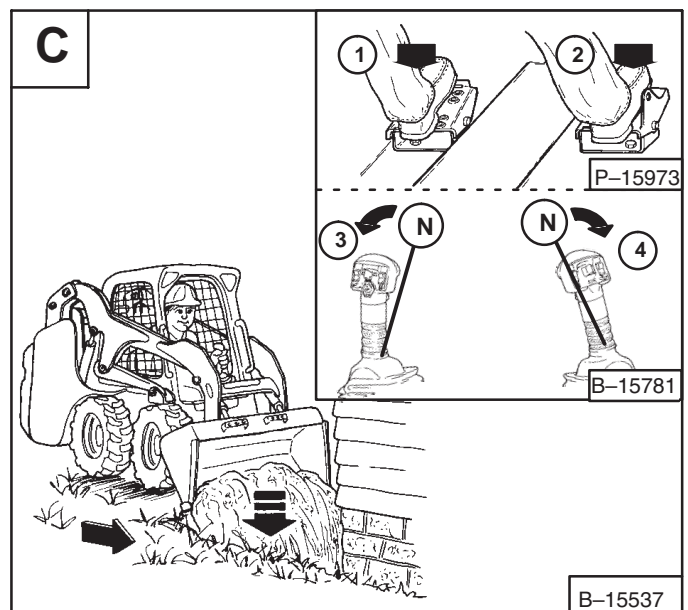

CLICK HERE TO **DOWNLOAD** THE COMPLETE MANUAL

- Thank you very much for reading the preview of the manual.
- You can download the complete manual from: www.heydownloads.com by clicking the link below



- Please note: If there is no response to CLICKING the link, please download this PDF first and then click on it.

CLICK HERE TO **DOWNLOAD** THE COMPLETE MANUAL

HEATING SYSTEM

Cleaning and Maintenance

The heating system requires regular inspection and maintenance. (See *SERVICE SCHEDULE*, Page 39 for intervals.)

Filters – The *Fresh Air Filter* is located below the rear window of the cab (Item 1) **[A]**.

Remove the bolts and remove the filter housing.

Shake the filter or use low air pressure to remove dirt.

Reinstall the filter and housing.

The *Recirculation Filter* is located in front of the rear window inside the cab (Item 2) **[A]**.

Remove the clamping knobs, grill and filter.

Clean the filter with water and mild detergent. Reinstall the filter.

Troubleshooting – If the fan does not run, check the fuse (See *ELECTRICAL SYSTEM*, Page 58.)

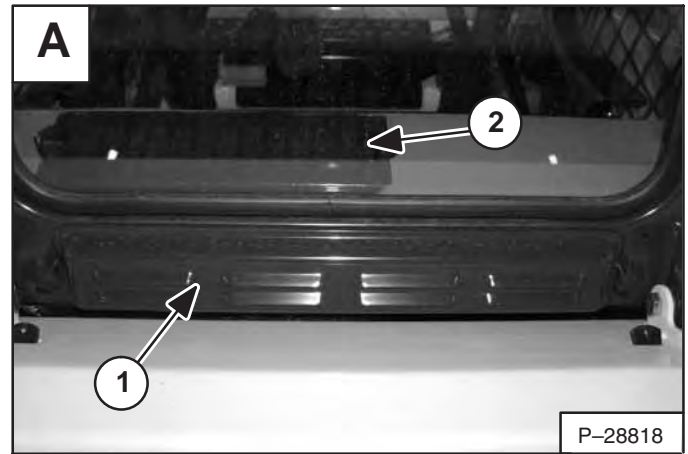

AIR CLEANER SERVICE (Cont'd)

Replacing Filter Element (Cont'd)

Inner Filter

Only replace the inner filter element under the following conditions:

- Replace the inner filter element every *third* time the outer filter is replaced.
- After the outer element has been replaced, start the engine and run at full RPM. If the HOURMETER / CODE DISPLAY shows [01-17] (**Air Filter Plugged**), replace the inner filter element.

Remove the wing nut and remove the inner filter element [A].

NOTE: Make sure all sealing surfaces are free of dirt and debris.

Install the new inner element.

Install the outer element.

Install the dust cover and the wing nut [B] (Be sure the evacuator is down).

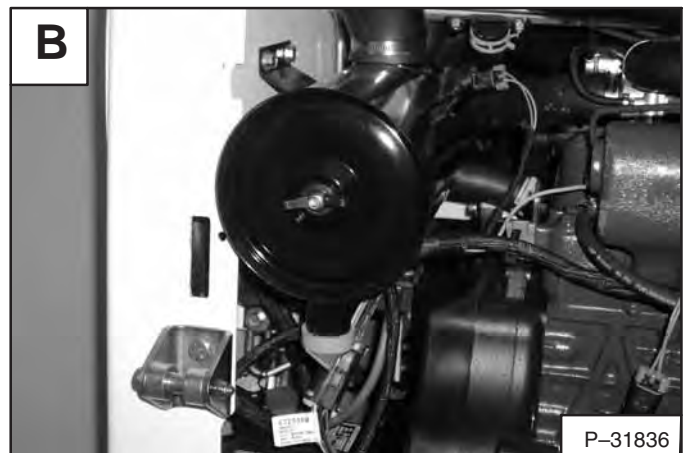
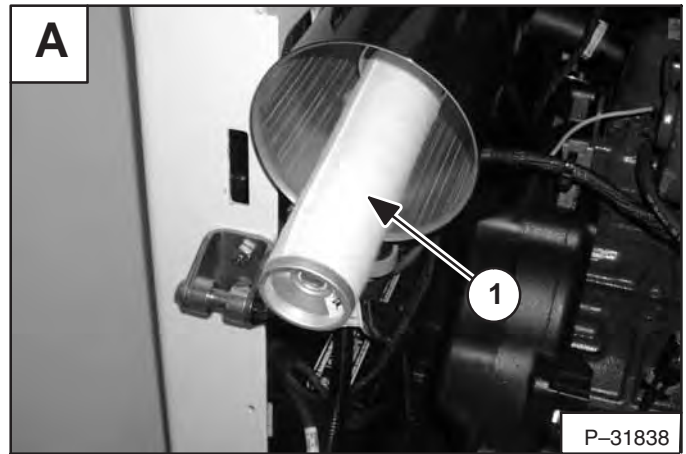

HYDRAULIC/HYDROSTATIC SYSTEM

Checking And Adding Fluid

Use only recommended fluid in the hydraulic system. (See *SPECIFICATIONS* Page 91.)

Stop the loader on a level surface,

Lower the lift arms and tilt the Bob-Tach fully back.

Stop the engine.

Check the fluid level in the sight gauge [A].

Open the rear door and raise the rear grill.

Remove the fill cap (Item 1) [B].

Add the fluid as needed to bring the level to the center of the sight gauge [A].

Install the fill cap.

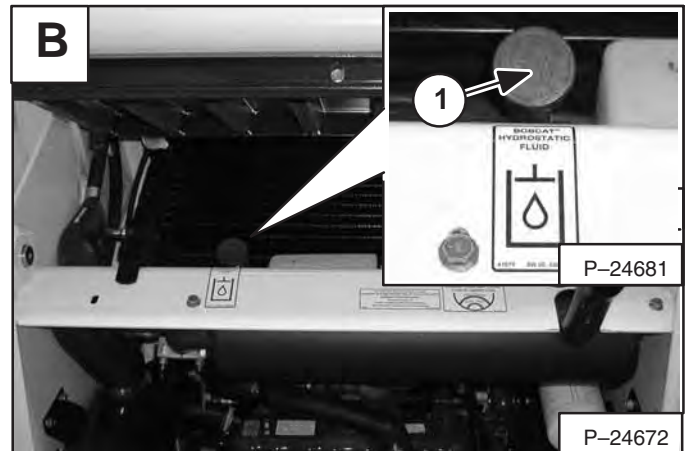
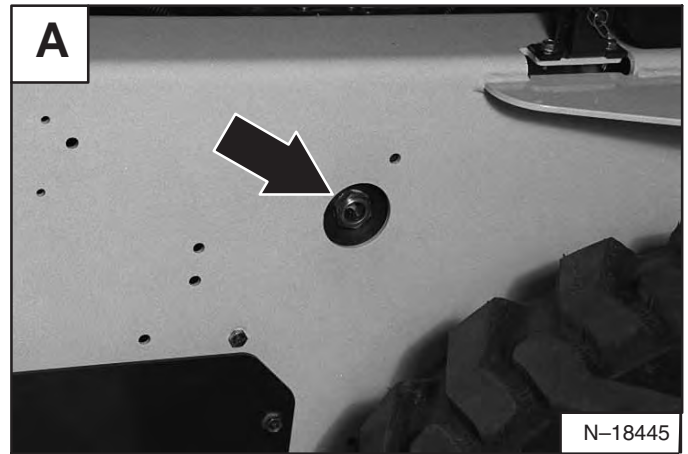

Replacing Hydraulic/Hydrostatic Filter

See the *SERVICE SCHEDULE* Page 39 for the correct service intervals.

Open the rear door.

Remove the filter element (Item 1) [C].

Clean the surface of the filter housing where the seal contacts the housing.

Put clean oil on the seal of the new filter element.

Install and hand tighten the filter element.

Close the rear door before operating the loader.

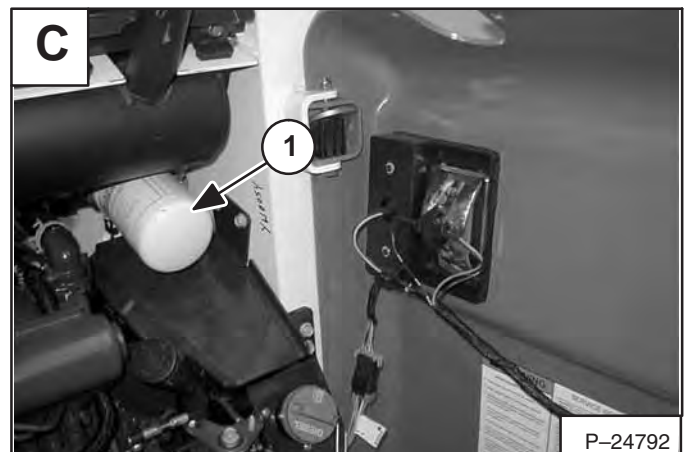

BOB-TACH (Hand Lever)

Inspection And Maintenance

Move the Bob-Tach levers down to engage the wedges [A].

The levers and wedges must move freely.

WARNING

Bob-Tach wedges must extend through the holes in attachment. Levers must be fully down and locked. Failure to secure wedges can allow attachment to come off and cause injury or death.

W-2102-0588

The wedges must extend through the holes in the attachment mounting frame (Item 2) [B].

The spring loaded wedge (Item 1) [B] must contact the lower edge of the hole in the attachment (Item 2) [B].

If the wedge does not contact the lower edge of the hole [B], the attachment will be loose and can come off the Bob-Tach.

Inspect the mounting frame on the attachment and the Bob-Tach, linkages and wedges for excessive wear or damage [C]. Replace any parts that are damaged, bent, or missing. Keep all fasteners tight.

Look for cracked welds. Contact your Bobcat dealer for repair or replacement parts.

Lubricate the wedges (See *SERVICE SCHEDULE*, Page 39 and *LUBRICATING THE BOBCAT LOADER*, Page 68).

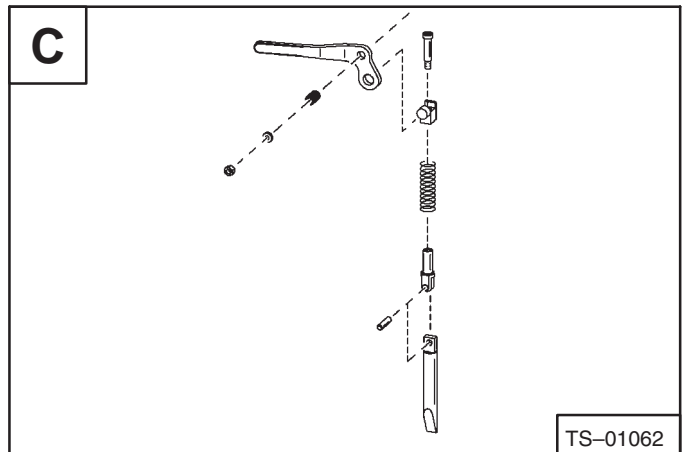
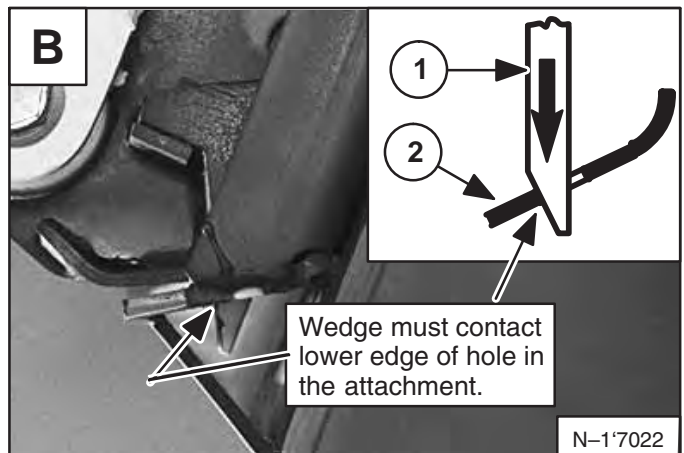
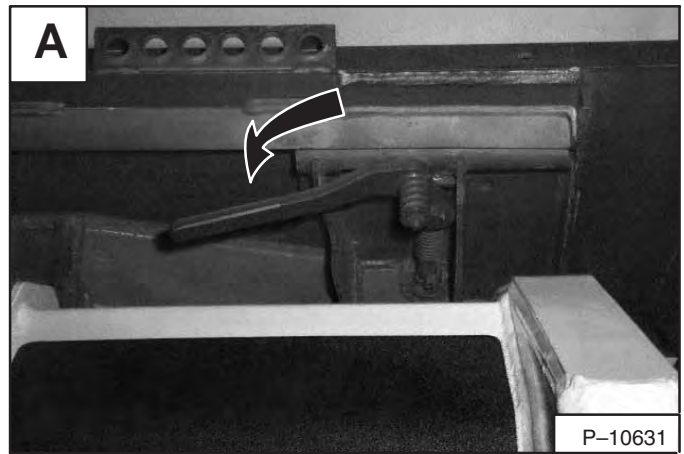

MACHINE SIGN TRANSLATIONS

SERVICE SCHEDULE (6718398)	83.
WARNING (6718698 Foot Pedals)	84.
WARNING (6718699 Advanced Hand Controls)	85
WARNING (6728539 Advanced Control System)	86
WARNING (6579528, 6577754), DANGER (6579639, 6579509)	87
DANGER (6717343), WARNING (6718706)	88
WARNING (6710358), IMPORTANT (6560573)	89

MACHINE SIGN TRANSLATIONS

MACHINE SIGNS (DECALS)

Machine signs (decals) are an essential part of the loader. (See Page xiv & xv.) This section provides French and Spanish translations of the machine signs that are in English.

SPECIFICATIONS

ADDITIONAL PUBLICATIONS AND TRAINING MATERIALS	99
BOBCAT APPROVED ATTACHMENTS AND ACCESSORIES	96
SKID STEER LOADER SPECIFICATIONS	93
Performance Specifications	
Engine	
Loader Controls	
Drive System	
Hydraulic System	
Electrical System	
Standard Instrument Panel	
Deluxe Instrument Panel (Option)	
Capacities	

SPECIFICATIONS

CLICK HERE TO **DOWNLOAD** THE COMPLETE MANUAL

- Thank you very much for reading the preview of the manual.
- You can download the complete manual from: www.heydownloads.com by clicking the link below



- Please note: If there is no response to CLICKING the link, please download this PDF first and then click on it.

CLICK HERE TO **DOWNLOAD** THE COMPLETE MANUAL