

EN

**MAN  
PLATFORM**



**Bobcat®**

**Operation  
&  
Maintenance  
Manual**

**(4m) S/N A6SH00101 & Above  
(1m<sup>2</sup>) S/N 00101 & Above**

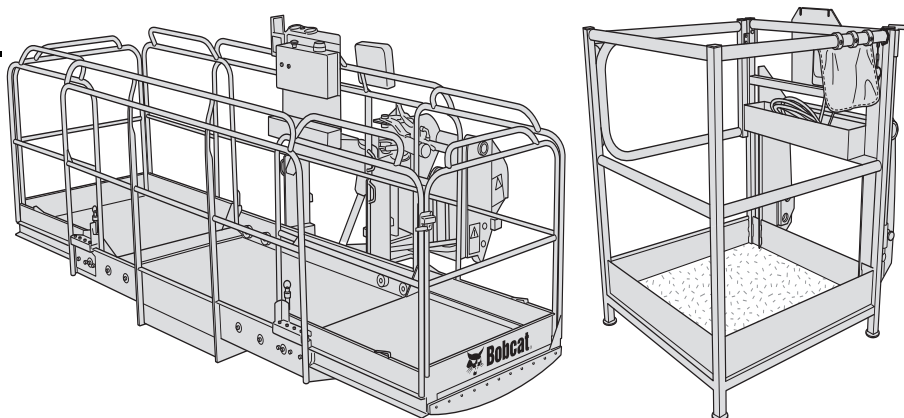

**For use on approved Telescopic Handler only**



CLICK HERE TO **DOWNLOAD** THE COMPLETE MANUAL

- Thank you very much for reading the preview of the manual.
- You can download the complete manual from: [www.heydownloads.com](http://www.heydownloads.com) by clicking the link below



- Please note: If there is no response to CLICKING the link, please download this PDF first and then click on it.

CLICK HERE TO **DOWNLOAD** THE COMPLETE MANUAL

# SAFETY

## Contents

Safety instructions for Bobcat Telescopic Handlers and Attachments .....3  
    Safety is the operator's responsibility.....3  
    Safety symbols.....4  
    Safe operation requires a qualified operator .....4

Fire prevention .....5

Maintenance instructions .....5

Warning of residual risks.....6

Specific instructions for Telescopic Handler & man platform .....7

## Controls and indicators



### WARNING

When using the remote control, the contact of the transmitter must always remain in position “1”.



### WARNING

Please make sure that all other energy demands (steering mode, headlights, cabin ventilation, etc.) remain switched off when using the remote control.

### IMPORTANT

This paragraph presents the controls, indicators and equipment that the machine is equipped with when used as a man platform.

Controls, indicators and equipment for use as a telescopic handler with man platform are the same as for the regular telescopic handler without specific man platform equipment; read the applicable paragraphs in the telescopic handler operator's instructions.

#### Radio control transmitter

This transmitter is composed of a box fixed onto the people carrier, which is the usual driving position when the machine is used as a man platform.

In this paragraph, the controls are described for an operator that is in a normal position in the driving post, i.e.:

- In the people carrier.
- Facing the transmitter, i.e. by the barrier on the handler side.

#### Front side

There are two adjusting screws on this side for fastening the transmitter onto the people carrier.

#### Right side

Figure 6

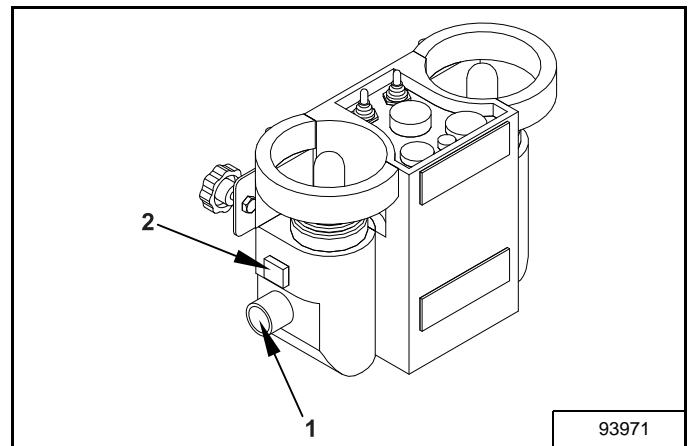
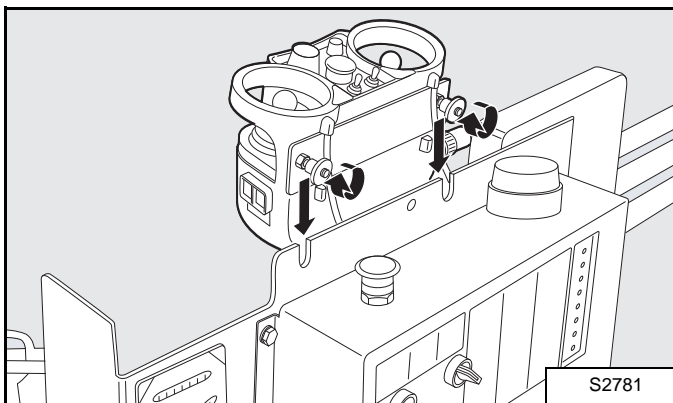

Figure 5



Reference	Description	Function
1	7-pin plug	This plug (7-pin) connects the transmitter to the platform via the cable located on the platform. <ul style="list-style-type: none"> <li>• If this plug is not connected to the platform, the radio control will not function.</li> <li>• Do not attempt to activate the machine by any other means if this plug is not connected.</li> </ul>
2	Horn	<ul style="list-style-type: none"> <li>• With symbol:                             <div style="text-align: center;"> </div> </li> <li>• Press the button to sound the horn.</li> </ul>

**Rotation control**

This system exists only on extendible platforms. It is comprised of a hydraulic cylinder controlled by the remote control (see "Radio control transmitter" on page 11).

**Figure 24**

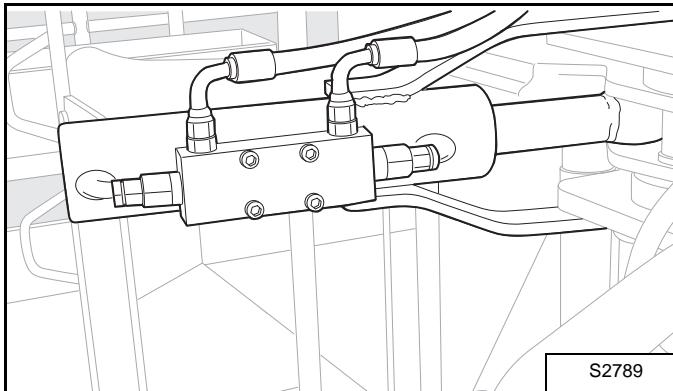

**Figure 26**

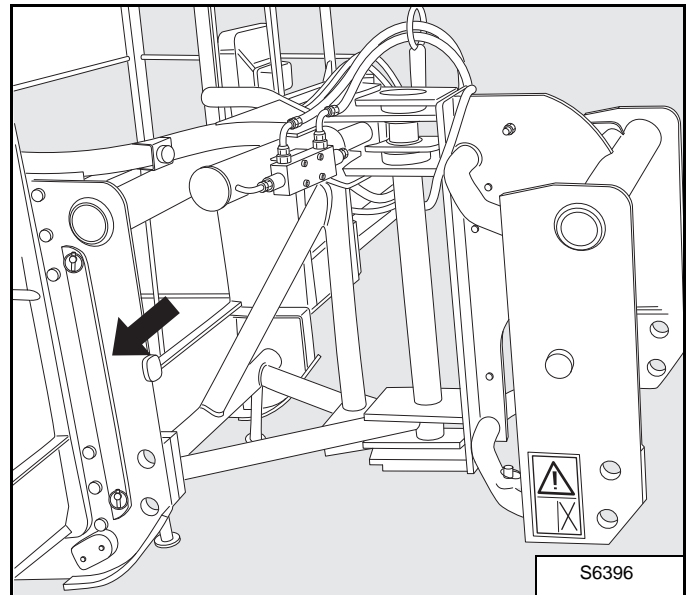

**Blocking track rod**

This track rod only exists on extendible platforms. It mechanically blocks the rotation system in the central position. It is systematically put into place [Figure 25] during people-lifting manoeuvres which do not require rotation and also when the machine is moved.

When unused, the track rod can be attached to the platform frame, see [Figure 26]

**Figure 25**

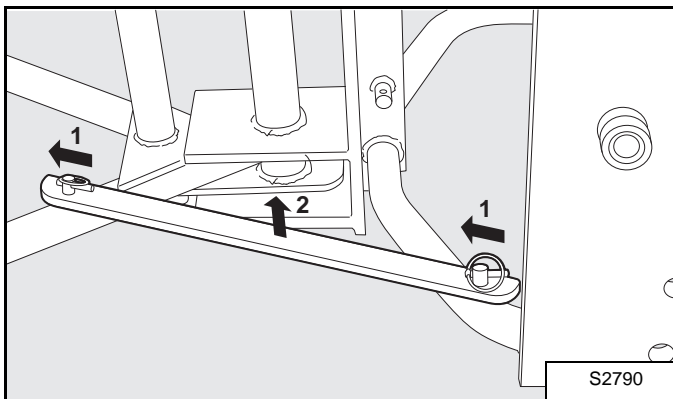

**Tilt indicators**

Two tilt indicators are mounted in the middle of the platform. They indicate the longitudinal and cross tilt angle of the platform.

**Figure 27**

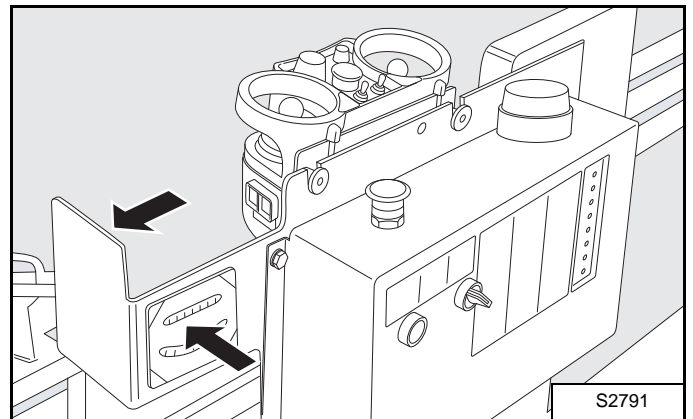

**⚠ WARNING**

**Do not attempt to remove or put this track rod back if the platform is more than 50 cm above the ground.**

**Indicators and limiters**

Several indicators give information to the operator. Check them regularly and carry out appropriate operations based on this information. Several limitation devices are activated to ensure that the machine functions safely.

**WARNING**

- Respect the authorised capacities for the platform being used.
- Respect the authorised charts for the platform being used.

**Indicator of longitudinal stability (ILS)**

When the alarm is activated and emits a fast intermittent sound, at least one of the following operations must be carried out to reduce the risk of the machine tipping forwards:

- Retract the boom telescoping.
- Lift the boom.
- Reduce the load in the platform.
- Reduce the manual exertions of the operator(s).

**WARNING**

**If the alarm is activated too frequently even though the load in the platform and the manual exertions of the operator(s) do not exceed authorised values, the man platform is in an unsuitable position on the ground. The man platform must be moved in order to sufficiently lessen the platform's forward slant.**

**Correction of cant - side offset (CCSO) (T40140-T40170) / Frame leveling (T35120)**

When the alarm is activated and emits a slow intermittent sound:

- The boom has reached an angle relative to the vertical of 2° on the side where the CCSO/frame leveling was controlled.
- The CCSO/frame leveling control towards this side has become inoperative.
- The CCSO/frame leveling control towards the other side remains operative.

**People carrier load indicator (only on extendible platforms)**

When the orange or red lights come on or when the alarm is activated and emits a continuous or intermittent sound, one of the operations below must be carried out in order to reduce the momentum of the machine tipping forwards:

- Reduce the load in the platform.
- Reduce the manual exertions of the operator(s).

**People carrier load limiting device (only on extendible platforms)**

When the load in the people carrier is over 100% of the authorised maximum value, the system causes all movements to stop until back in a safe situation.

**WARNING**

The stopping of the movements is intended as a last resort and is not a normal operation.

Do not allow this to happen. Take the necessary measures:

- As soon as the orange light comes on and the alarm makes an intermittent sound.
- In any event, as soon as the orange light comes on and the alarm makes a continuous sound.

**Aggravating Movements Arrester (AMA)**

When the combined load of the platform and its contents reaches 75% of the maximum authorized load, which tends to cause the machine to tilt forwards, this device renders certain boom movements inoperative whilst others remain operative.

At least one of the following operations must be carried out in order to reduce the risk of the machine tipping forwards:

- Retract the boom telescoping.
- Lift the boom.
- Reduce the load in the platform.
- Reduce the manual exertions of the operator(s).

**IMPORTANT**

Depending on the load in the platform, AMA can occur with various extension lengths: the heavier the load, the shorter the reach when AMA occurs.

**WARNING**

- If the AMA is activated too frequently even though the load in the platform does not exceed authorised values, the man platform is in an unsuitable position on the ground. The man platform must be moved in order to sufficiently lessen the platform's forward slant.
- AMA is intended as a last resort and does not constitute normal operation. Do not allow this to happen. Take the necessary measures as soon as the alarm is activated with a rapid intermittent ILS sound.

## Fault troubleshooting table

Your radio remote control system has been designed and manufactured using state-of-the-art technology. Every individual device is subjected to a stringent quality control process at the manufacturer's factory before being released for delivery to the customer.

Please check the following points in the event of a fault:

Trouble symptom	Possible causes	Remedies
On/Off function cannot be actuated or controlled.	Self-test routine	The transmitter is ready for operation after a 3 second self-test routine.
	Rechargeable battery/non-rechargeable batteries run down.	Insert charged rechargeable battery or check non-rechargeable batteries. Switch on the master switch of the machine.
No reaction to keying the transmitter.	Interrupton to receiver power supply.	Check connectors. Measure the power supply of the receiver.
	Rechargeable battery or battery compartment is defective (contact corrosion). Batteries are run down.	Check to see if the same effect occurs with the second rechargeable battery or with new batteries. Check the battery compartment and rechargeable battery compartment and clean if required. Please contact your dealer.
	A non-compatible transmitter and receiver combination is being used. Addresses of transmitter and receiver do not correspond with each other.	Check the system number on the stickers of the transmitter and receiver to see if you are using two compatible devices. The device numbers correspond to the system address and therefore must be identical.
Operating time is too short.	Incorrect or run down rechargeable batteries/non-rechargeable batteries were inserted.	Check if the power supply for the charger was switched off, or if the connection is faulty or loose. Only use rechargeable batteries approved by HETRONIC. <b>Only use alkaline batteries.</b>
There is interference with the transmission of the control commands to the machine.	No radio link.	Check that a yellow and red LED flash on the receiver, If not, please contact your dealer.
	Check to see if there is a large metal surface located between the transmitter and receiver.	A projecting aerial must be installed outside the steel cabinet, vehicle or the machine to be controlled. Try an alternative frequency setting for the transmitter and receiver. Please contact your dealer.
	The range has been exceeded. Please contact your dealer.	
The receiver is located in a steel cabinet or a vehicle, or is installed inside the machine to be controlled. The aerial is inadequate. A radio remote control system with the same frequency is being used within the vicinity.		
Individual functions cannot be actuated or controlled.	Break in the control lead between the machine and the receiver.	Check that the connector plug is properly seated. Check the connecting cable to the machine. Check the wiring and carry out cable-based control checks of the individual functions if necessary.
	Output module in receiver is defective.	Check that a LED illuminates on the output modules in the receiver in response to actuating the corresponding function. Please contact your dealer.

Charts

Load chart 1

Load chart for machine equipped with:

- The fixed platform.
- 4 identical DUNLOP 400/80 x 24 T37 156B TL tyres (4.75-bar pressure).

Figure 48

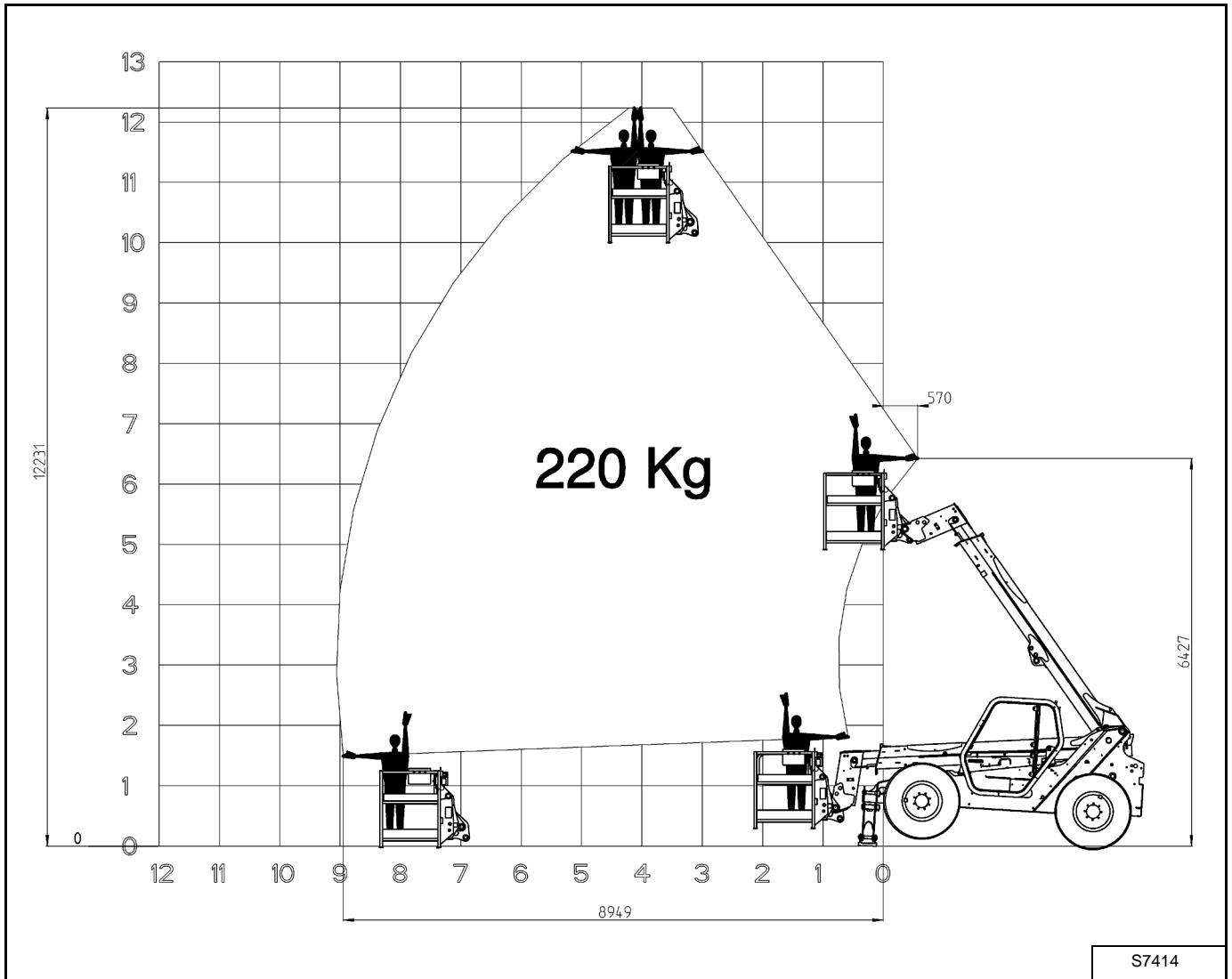

## Rotating extendible platform

Figure 56

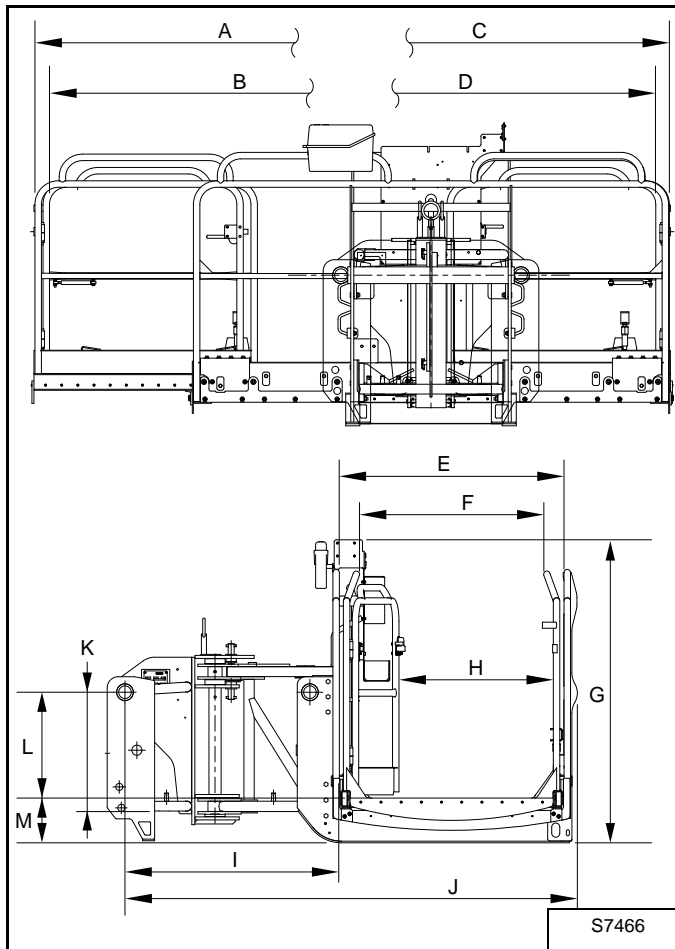

	Value (mm)
A	3954
B	3812,1
C	2404
D	2250
E	1008
F	912,2
G	1493
H	765
I	1065,2
J	2329
K (middle basket floor)	591,9
L (extension floor)	521,9
M	215

## Weights

Data with boom in transport position, all tanks full, with no driver and BFGOODRICH 400/70 x 20 tyres.

With platform	Weight (kg) of the platform	Weight (kg) of the machine		
		Total	On front axle	On rear axle
fixed	148	10525	4095	6430
extendible platform	630	10955	5150	5805

The maximum pressure on the ground under each stabiliser is 10 bar.

The maximum pressure on the ground under each tyre is 6,5 bar.

## Introduction

The specifications of the man platform are:

- For a certain number of them, identical to those of the telescopic handler.
- For a certain number of them, specifications of the telescopic handler which includes changes specific to the use of the machine as a man platform.
- For a certain number of them, specific to the use of the machine as a man platform.

The following specifications of the telescopic handler remain valid; see the applicable paragraphs in the manual of the telescopic handler:

- General characteristics.
- Stabilisers.
- Engine and transmission.
- Tyres.
- Steering.
- Braking system.

The other characteristics of the telescopic handler include changes specific to the use of the machine as a man platform.

## Dimensions and weights

### Dimensions

The dimensions of the man platform are:

- For the most part, identical to those of the telescopic handler; see the applicable paragraphs in the manual of the telescopic handler:
- For a certain number of them, specific to the mounting of the man platform.

The dimensions given hereafter are specific to the mounting of the man platform and to the machine fitted with BFGOODRICH 400/70 x 20 tyres.

#### Telescopic handler equipped with fixed man platform

Figure 60

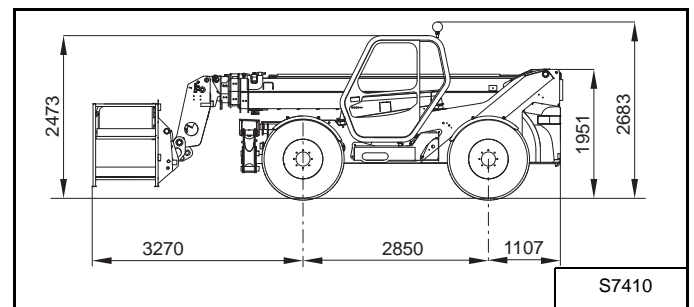
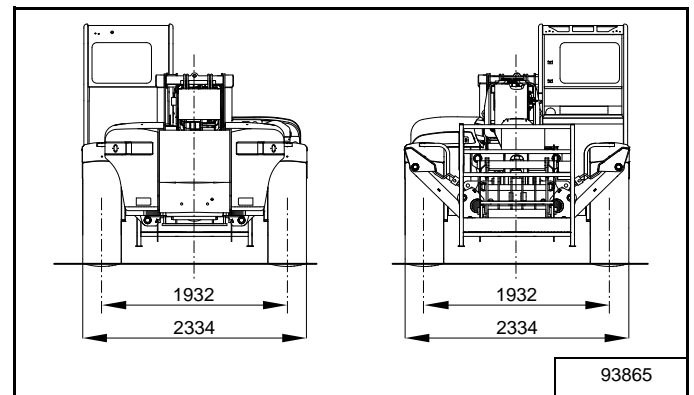

Figure 61



Reference	Value
<b>Maximum lifting height, from the ground to the upper level of the floor</b>	
Telescope fully retracted	5,880 m
Telescope fully extended	16,140 m
<b>Maximum reach, between the vertical plane passing in front of the front wheels and the foremost point of the platform</b>	
Telescope fully retracted	2,750 m
Telescope fully extended	14,170 m

CLICK HERE TO **DOWNLOAD** THE COMPLETE MANUAL

- Thank you very much for reading the preview of the manual.
- You can download the complete manual from: [www.heydownloads.com](http://www.heydownloads.com) by clicking the link below



- Please note: If there is no response to CLICKING the link, please download this PDF first and then click on it.

CLICK HERE TO **DOWNLOAD** THE COMPLETE MANUAL