

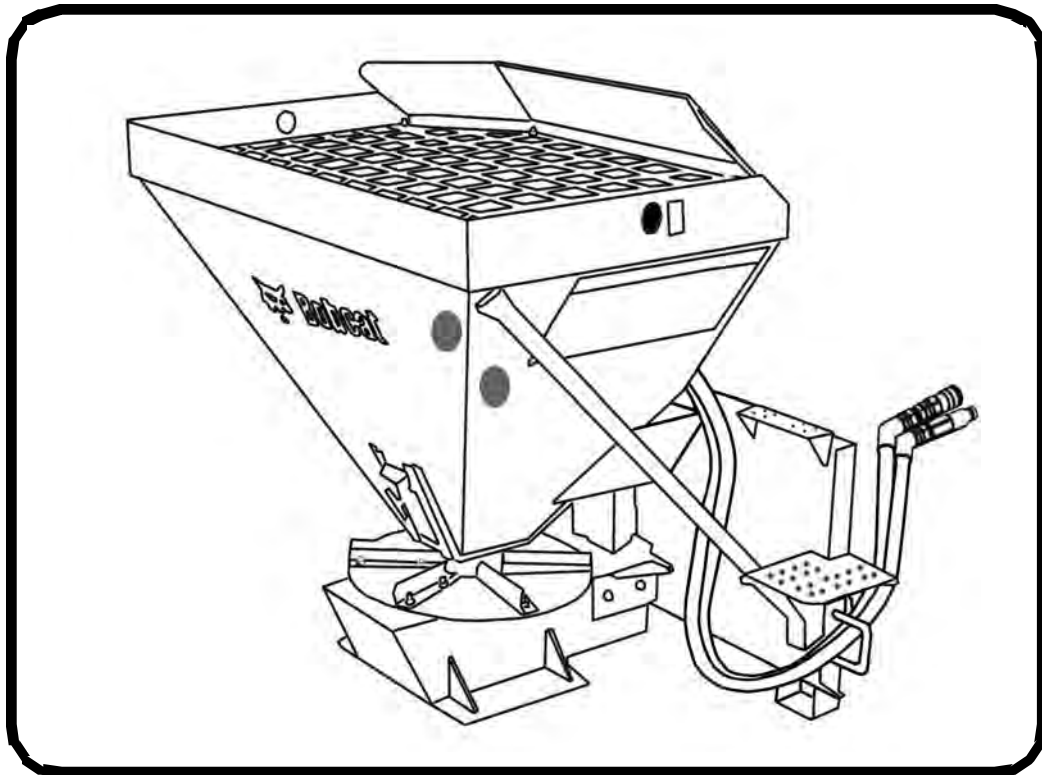

Bobcat®

Operation & Maintenance Manual Hydraulic Spreader

(Spreader HS8) S/N AC1N00101 & Above



CLICK HERE TO **DOWNLOAD** THE COMPLETE MANUAL

- Thank you very much for reading the preview of the manual.
- You can download the complete manual from: www.heydownloads.com by clicking the link below



- Please note: If there is no response to CLICKING the link, please download this PDF first and then click on it.

CLICK HERE TO **DOWNLOAD** THE COMPLETE MANUAL

FEATURES AND ACCESSORIES

Standard Items

The hydraulic spreader is equipped with the following Standard Items:

- Hopper Grate
- Adjustable Material Flow Gates
- Hydraulically Operated
- Self Loading Hopper With Cutting Edge
- Adjustable Spread Pattern
- Mechanical Agitator

Options And Accessories

- Sidewalk Kit

OPERATING INSTRUCTIONS

INITIAL SETUP	21
Material Flow Gate Adjustment	21
Sidewalk Kit Installation (If Equipped)	21
DAILY INSPECTION	22
Attachment Mounting Frame	22
Bob-Tach	23
Spreader Fins	25
Hopper Grate	25
Wheel And Agitator Fingers	25
OPERATING PROCEDURE WITH LOADERS	26
Approved Loader Models And Requirements	26
Machine / Attachment Setup	28
Entering And Exiting The Loader	30
Installation	31
Hydraulic Quick Couplers	39
Control Functions	40
Operation With The Loader	40
Removal	42
OPERATING PROCEDURE WITH VERSAHANDLERS	46
Approved VersaHANDLER Models And Requirements	46
Entering And Exiting The VersaHANDLER	47
Installation	48
Hydraulic Quick Couplers	52
Control Functions	53
Operation With The VersaHANDLER	54
Removal	58
OPERATING PROCEDURE WITH UTILITY WORK MACHINES	59
Approved Utility Work Machine Models And Requirements	59
Machine / Attachment Setup	60
Entering And Exiting The Work Machine	62
Installation	63
Hydraulic Quick Couplers	71
Control Functions	72
Operation With The Work Machine	72
Removal	75

OPERATING PROCEDURE WITH LOADERS (CONT'D)

Machine / Attachment Setup (Cont'd)

Hose Guide Installation (Removable - If Equipped) (Cont'd)

Figure 24

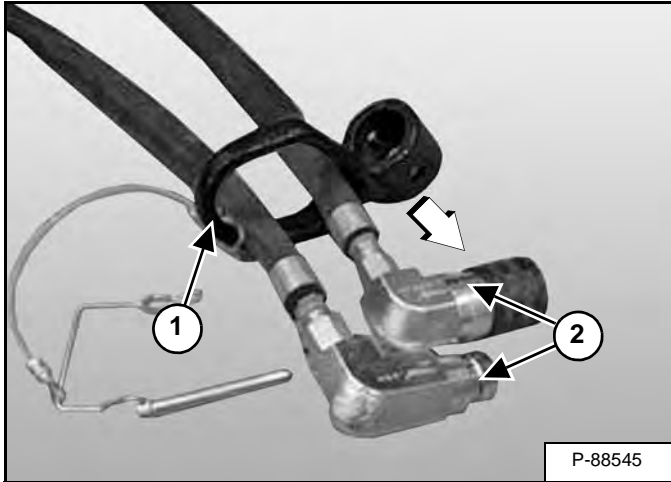

To change the removable hose guide (Item 1) [Figure 24] orientation, slide the removable hose guide off the hoses.

NOTE: It may be necessary to remove the hose couplers (Item 2) [Figure 24].

Figure 25

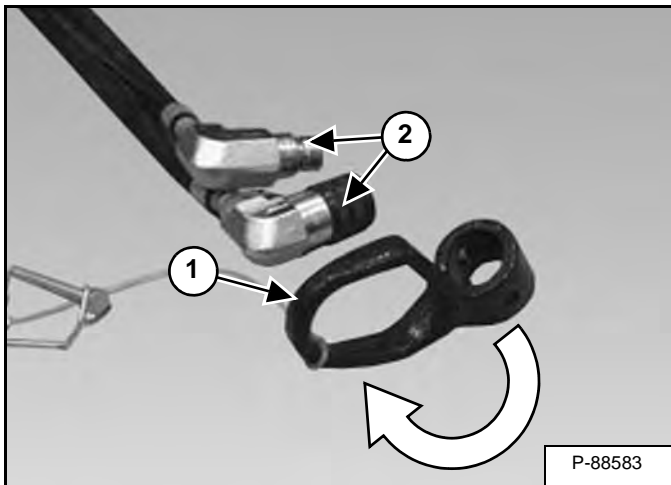

Flip the removable hose guide (Item 1) over to reverse its orientation on the hoses (Item 2) [Figure 25].

Figure 26

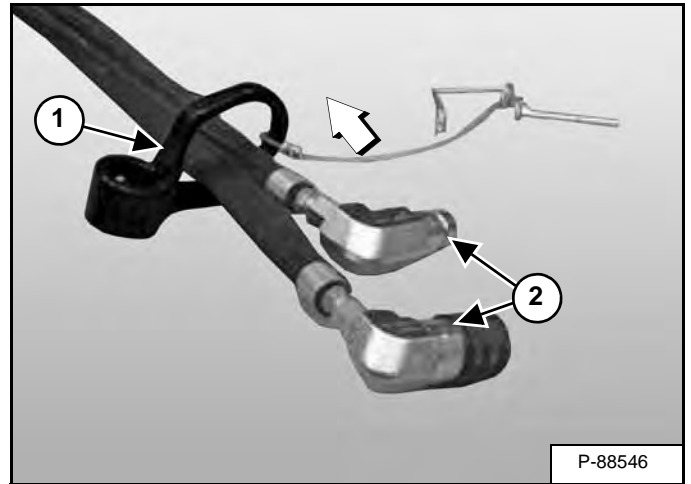

Slide the removable hose guide (Item 1) [Figure 26] back onto the hoses.

NOTE: If the couplers (Item 2) [Figure 26] were removed, reinstall at this time.

Hydraulic Quick Couplers

IMPORTANT

- Thoroughly clean the quick couplers before making connections. Dirt can quickly damage the system.
- Contain and dispose of any oil leakage in an environmentally safe manner.

I-2278-0608

New attachments and new loaders are factory equipped with flush face couplers. If installing an attachment equipped with poppet style couplers, the attachment couplers will have to be changed to match the loader. See your Bobcat dealer for parts information.

NOTE: Make sure the quick couplers are fully engaged. If the quick couplers do not fully engage, check to see that the couplers are the same size and type.

Figure 50

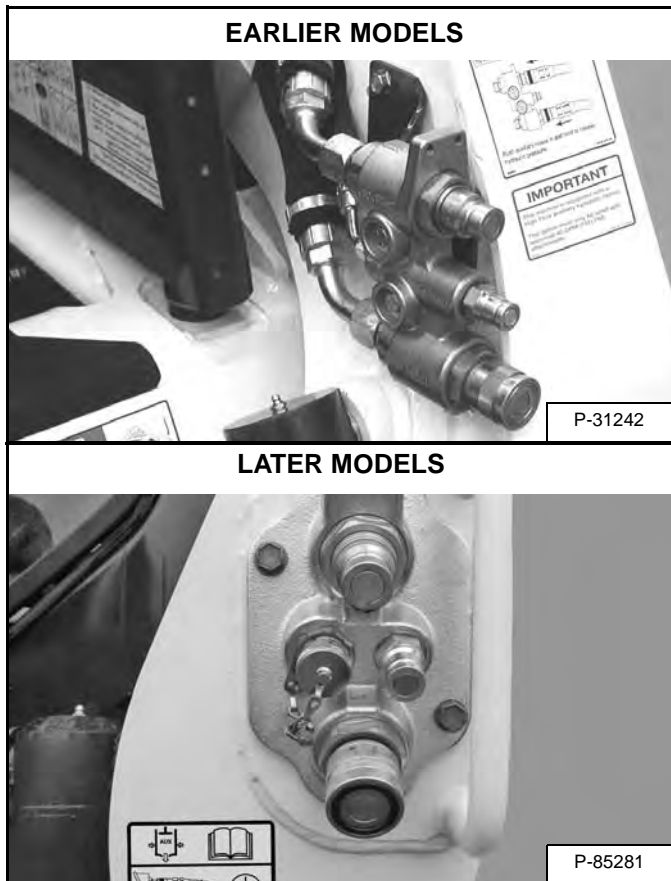

! WARNING

AVOID BURNS

Hydraulic fluid, tubes, fittings and quick couplers can get hot when running machine and attachments. Be careful when connecting and disconnecting quick couplers.

W-2220-0396

To Connect:

Remove any dirt or debris from the surface of both the male and female couplers, and from the outside diameter of the male coupler. Visually check the couplers for corroding, cracking, damage, or excessive wear. If any of these conditions exist, the coupler(s) must be replaced [Figure 50].

Install the male coupler into the female coupler. Full connection is made when the ball release sleeve slides forward on the female coupler [Figure 50].

NOTE: Check that the attachment hydraulic hoses are not twisted or contacting any moving parts of the loader or attachment. (See For First Time Installation on Page 38.) for proper adjustment.

To Disconnect:

Relieve hydraulic pressure. (See the loader's Operation & Maintenance Manual and Operator's Handbook for correct procedure.)

Push the couplers together, retract the sleeve on the female coupler until the couplers disconnect.

OPERATING PROCEDURE WITH VERSAHANDLERS (CONT'D)

Installation (Cont'd)

Hand Lever Bob-Tach (Cont'd)

WARNING

Before you leave the operator's position:

- Put the travel Direction Control Lever and the Joystick in neutral.
- Engage the parking brake.
- Retract and lower the boom and attachment flat on the ground.
- Stop the engine. Raise the restraint bar (if equipped).

SEE THE MACHINE OPERATION & MAINTENANCE MANUAL FOR MORE INFORMATION.

W-2637-0607

Figure 70

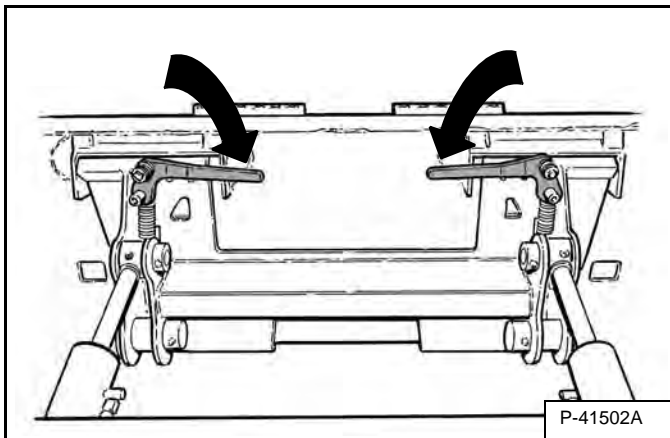

Push down on the Bob-Tach levers until they are fully engaged in the locked position [Figure 70] (wedges fully extended through the attachment mounting frame holes).

Figure 71

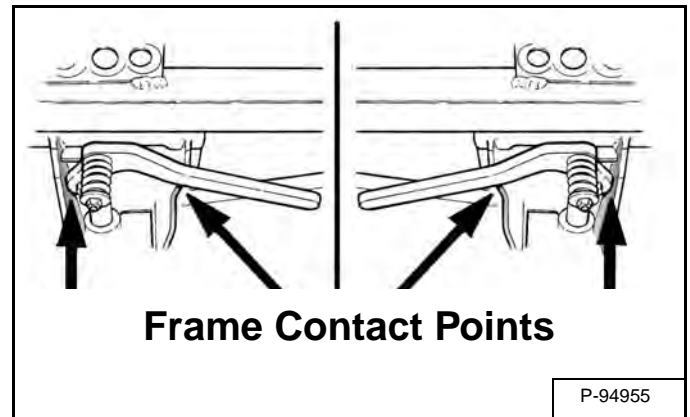

Both levers must contact the frame as shown when locked [Figure 71].

If both levers do not engage in the locked position, see your Bobcat dealer for maintenance.

WARNING

AVOID INJURY OR DEATH

The Bob-Tach wedges must extend through the holes in the attachment mounting frame. Levers must be fully down and locked. Failure to secure wedges can allow attachment to come off.

W-2715-0208

Figure 72

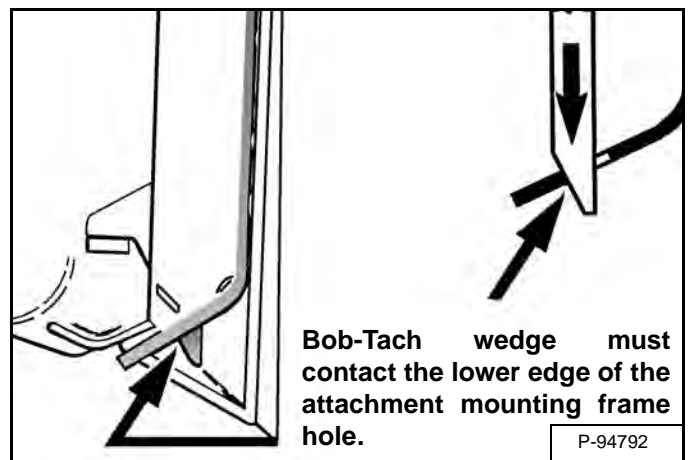

The wedges must extend through the holes in the attachment mounting frame, securely fastening the attachment to the Bob-Tach [Figure 72].

CLICK HERE TO **DOWNLOAD** THE COMPLETE MANUAL

- Thank you very much for reading the preview of the manual.
- You can download the complete manual from: www.heydownloads.com by clicking the link below



- Please note: If there is no response to CLICKING the link, please download this PDF first and then click on it.

CLICK HERE TO **DOWNLOAD** THE COMPLETE MANUAL

OPERATING PROCEDURE WITH UTILITY WORK MACHINES

Approved Utility Work Machine Models And Requirements

Figure 83

WORK MACHINE MODEL	HYDRAULIC SPREADER
	HS8
5600	X
5610	X

X = Approved

The chart [Figure 83] lists the work machine models approved for use with the hydraulic spreader.

Warranty on this attachment is void if used on a non-approved carrier. See your Bobcat dealer for a current list of approved carriers.

WARNING

Never use attachments or buckets which are not approved by the Bobcat Company. Attachments and buckets for safe loads of specified densities are approved for each model. Unapproved attachments and buckets can cause injury or death.

W-2662-0108

Figure 84

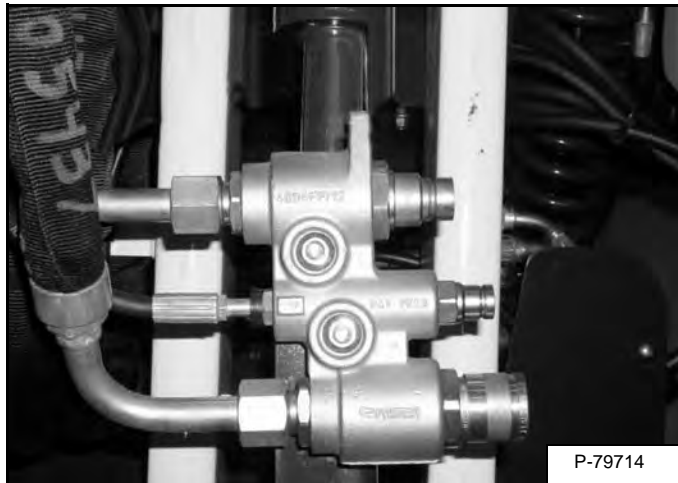

The work machine must be equipped with front auxiliary hydraulics [Figure 84]. See your Bobcat dealer for available kits.

IMPORTANT

- Operate auxiliary hydraulics on STANDARD flow only.
- Never exceed 91 L/min (24 U.S. gpm) auxiliary hydraulic flow. Hydraulic flow higher than recommended will cause attachment damage.

I-2216-0910

OPERATING PROCEDURE WITH UTILITY WORK MACHINES (CONT'D)

Installation (Cont'd)

Hose Routing (Removable - If Equipped) (Cont'd)

Figure 112

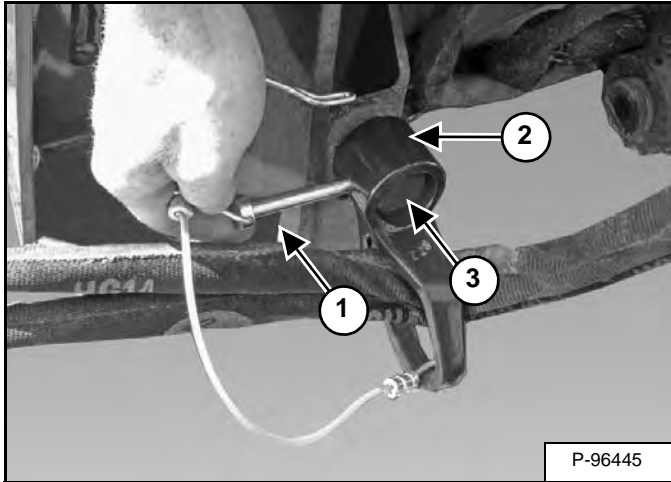

Insert lock pin (Item 1) through the removable hose guide (Item 2) and mounting post (Item 3) [Figure 112].

Figure 113

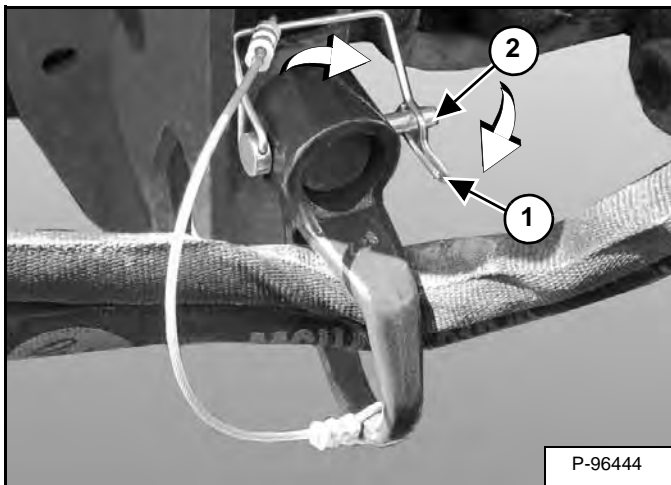

Secure the latch eye (Item 1) onto the lock pin (Item 2) [Figure 113].

Figure 114



Hose routing for work machines should be similar as shown [Figure 114].

OPERATING PROCEDURE WITH COMPACT TRACTORS (CONT'D)

Machine / Attachment Setup

Ballast

Figure 132

REAR BALLAST WEIGHT REQUIREMENTS	
TRACTOR MODEL	HYDRAULIC SPREADER
CT335	X
CT440	X
CT445	X
CT450	X

The chart **[Figure 132]** shows which compact tractor's will need rear ballast for use with the spreader.

Install the correct rear ballast on the compact tractor before installing the spreader. See the compact tractor's Operation & Maintenance Manual for rear ballast information.

OPERATING PROCEDURE WITH COMPACT TRACTORS (CONT'D)

Operation With The Compact Tractor (Cont'd)

Operating The Hydraulic Spreader

Move the compact tractor and hydraulic spreader to the work area, keeping the attachment as low as possible while traveling.

WARNING

TIPPING, ROLLOVER OR LOSS OF VISIBILITY CAN CAUSE SERIOUS INJURY OR DEATH

- Use spreader only on approved machines.
- Do not overload. Carry load low.

W-2713-0208

Stop the compact tractor and lower the attachment to the ground.

Stop the engine, engage the parking brake and exit the compact tractor (See Entering And Exiting The Compact Tractor on Page 80.)

WARNING

Before you leave the operator's position:

- Put the travel Direction Control Lever and the Joystick in neutral.
- Engage the parking brake.
- Retract and lower the boom and attachment flat on the ground.
- Stop the engine. Raise the restraint bar (if equipped).

SEE THE MACHINE OPERATION & MAINTENANCE MANUAL FOR MORE INFORMATION.

W-2637-0607

Adjust the material flow gates to the desired flow. (See Material Flow Gate Adjustment on Page 21.)

Enter the compact tractor. (See Entering And Exiting The Compact Tractor on Page 80.)

Figure 146



Raise the hydraulic spreader 508 mm (20 in) off the ground.

Adjust the hydraulic spreader so that it is level to the ground [Figure 146].

WARNING

CONTACT WITH SPREADER DISC OR FLYING OBJECTS CAN CAUSE SERIOUS INJURY OR DEATH

- Never operate in the vicinity of other persons.
- Objects can be thrown 10 m (30 ft).

W-2712-0910

While moving forward, activate the control to start spreader disc rotation.

Increase or decrease engine rpm to adjust spread pattern to desired coverage. (See Performance on Page 126.)

When spreading is complete, always completely empty the hopper of material. This will keep material from freezing in the spreader.

REGULAR MAINTENANCE ITEMS

Cleaning The Hydraulic Spreader

! WARNING

AVOID INJURY OR DEATH

Wear safety glasses to prevent eye injury when any of the following conditions exist:

- When fluids are under pressure.
- Flying debris or loose material is present.
- Engine is running.
- Tools are being used.

W-2019-0907

Figure 153

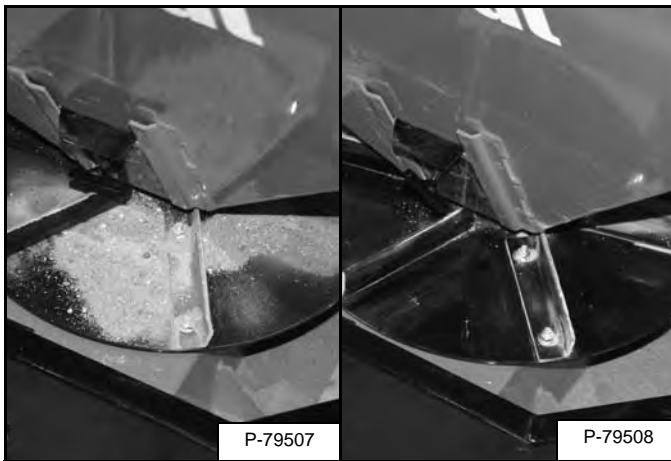

Flush with water.

Use compressed air to blow out excess material [Figure 153].

Figure 154

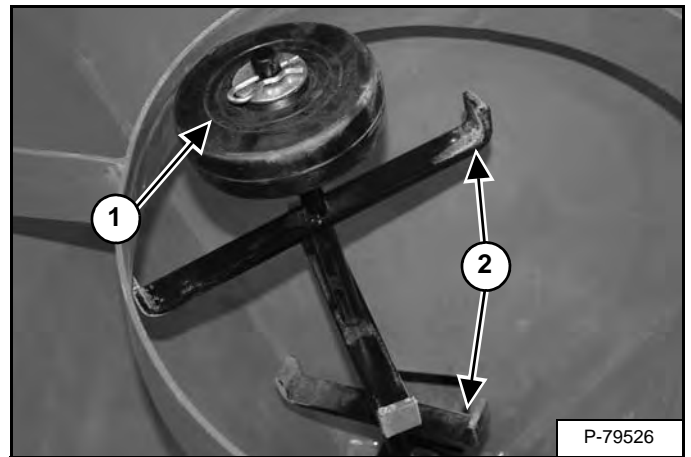

Clean and inspect the wheel (Item 1) and agitator fingers (Item 2) [Figure 154]. (Hopper grate has been removed for picture clarity.)

Figure 155

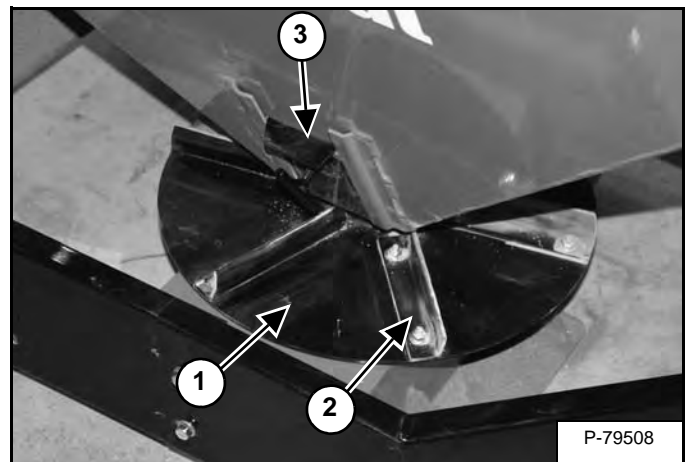

Clean and inspect the spreader wheel (Item 1) and spreader fins (Item 2) [Figure 155].

Dry the attachment with compressed air.

Make sure the hopper gates (Item 3) [Figure 155] are thoroughly dry.

HYDRAULIC MOTOR (CONT'D)

Assembly (Cont'd)

Figure 176

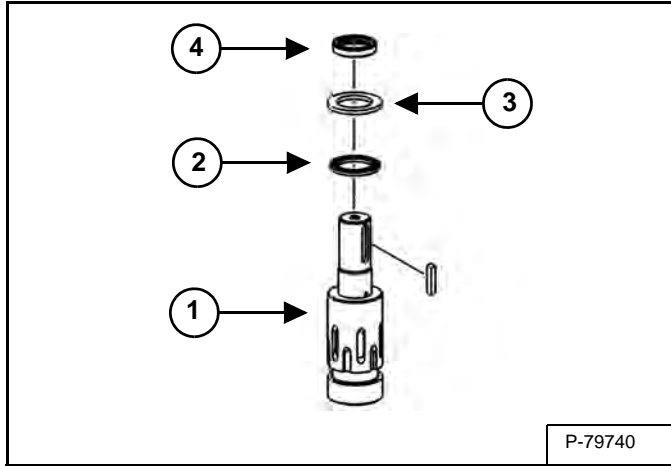

Place shaft (Item 1) on a clean flat surface with output end facing up. Install thrust bearing (Item 2) and thrust washer (Item 3) [Figure 176] on the shaft.

Install shaft seal (Item 4) [Figure 176] down onto shaft making sure that lip on the shaft seal faces down.

Figure 177

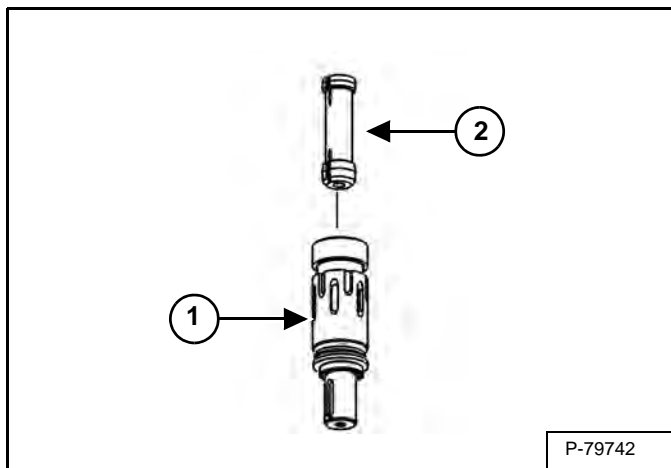

Turn shaft (Item 1) over so that output end of the shaft faces down. Lower drive link (Item 2) [Figure 177] into shaft making sure that the timing mark end of the drive link faces up and that the timing mark on the end of the drive link is aligned to the left of any short, open cutter slot on the shaft.

Figure 178

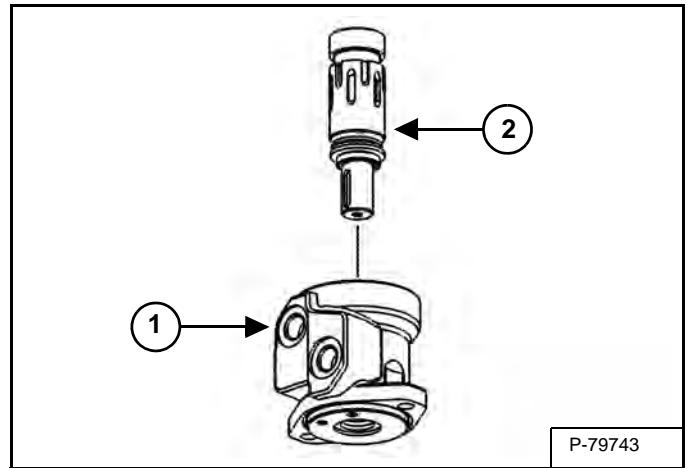

Turn housing (Item 1) over so that the pilot of housing faces down and secure housing in a vise. Without disturbing the shaft seal and drive link, carefully lower shaft assembly (Item 2) [Figure 178] into housing. Apply pressure using an arbor press or a rubber mallet to make sure that the shaft end is flush or slightly lower than the housing bolt hole surface.

MACHINE SIGN TRANSLATIONS

Warning (7154516)

⚠ WARNING		
		
<p>Read and understand Operation & Maintenance Manual before operating or servicing spreader attachment.</p>	<p>CONTACT WITH SPREADER DISC OR FLYING OBJECTS CAN CAUSE SERIOUS INJURY OR DEATH</p> <ul style="list-style-type: none"> • Never operate spreader in vicinity of other persons. • Objects can be thrown 30 ft. (10 m). 	<p>ENTANGLEMENT IN ROTATING AGITATOR CAN CAUSE SERIOUS INJURY OR DEATH</p> <ul style="list-style-type: none"> • Keep hands and feet out of hopper during operation. Do not operate with hopper grate removed. • Stop engine and disconnect auxiliary hydraulic hoses before servicing.

⚠ ADVERTENCIA		
		
<p>Lea y comprenda el Manual de funcionamiento y mantenimiento antes de comenzar la operación o realizar el servicio de mantenimiento del accesorio esparcidor.</p>	<p>EL CONTACTO CON EL DISCO DEL ESPARCIDOR O LOS OBJETOS VOLÁTILES PUEDEN PROVOCAR HERIDAS GRAVES O LA MUERTE</p> <ul style="list-style-type: none"> • No utilice el esparcidor cerca de otras personas. • Los objetos pueden ser arrojados a 30 pies (10 m) de distancia. 	<p>EL ENREDO CON EL AGITADOR GIRATORIO PUEDE PROVOCAR HERIDAS GRAVES O LA MUERTE</p> <ul style="list-style-type: none"> • Mantenga las manos y los pies alejados de la tolva durante su funcionamiento. No trabaje sin la rejilla de la tolva. • Detenga el motor y desconecte las mangueras hidráulicas auxiliares antes de realizar el servicio de mantenimiento.

⚠ AVERTISSEMENT		
		
<p>Lisez et comprenez le manuel d'utilisation et d'entretien avant d'utiliser l'accessoire épandeur ou d'y faire de l'entretien.</p>	<p>LE CONTACT AVEC LE DISQUE DE L'ÉPANDEUR OU DES OBJETS PROJÉTÉS PEUT ENTRAÎNER DES BLESSURES GRAVES VOIRE MORTELLES</p> <ul style="list-style-type: none"> • N'utilisez jamais l'épandeur à proximité d'autres personnes. • Les objets peuvent être projetés jusqu'à 30 pi (10 m). 	<p>UN ENCHEVÊTREMENT DANS L'AGITATEUR EN ROTATION PEUT PROVOQUER DES BLESSURES GRAVES OU LA MORT</p> <ul style="list-style-type: none"> • Gardez les mains et les pieds à l'écart de la trémie lors de l'utilisation. N'utilisez pas l'épandeur si la grille de la trémie est enlevée. • Arrêtez le moteur et déconnectez les flexibles des auxiliaires hydrauliques avant de faire tout entretien.

CLICK HERE TO **DOWNLOAD** THE COMPLETE MANUAL

- Thank you very much for reading the preview of the manual.
- You can download the complete manual from: www.heydownloads.com by clicking the link below



- Please note: If there is no response to CLICKING the link, please download this PDF first and then click on it.

CLICK HERE TO **DOWNLOAD** THE COMPLETE MANUAL