

ECE 320

03.08-

Operating Instructions

GB

51076425

07.08

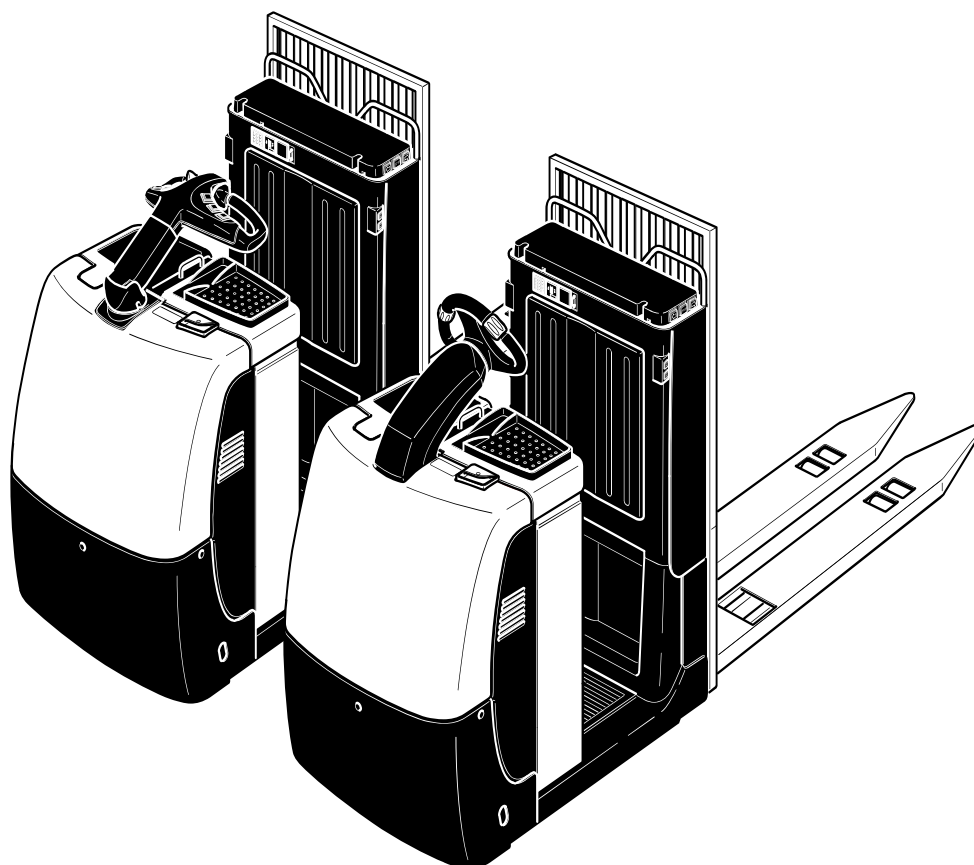

 **JUNGHEINRICH**

CLICK HERE TO **DOWNLOAD** THE COMPLETE MANUAL

- Thank you very much for reading the preview of the manual.
- You can download the complete manual from: www.heydownloads.com by clicking the link below



- Please note: If there is no response to CLICKING the link, please download this PDF first and then click on it.

CLICK HERE TO **DOWNLOAD** THE COMPLETE MANUAL

4 Identification points and data plates

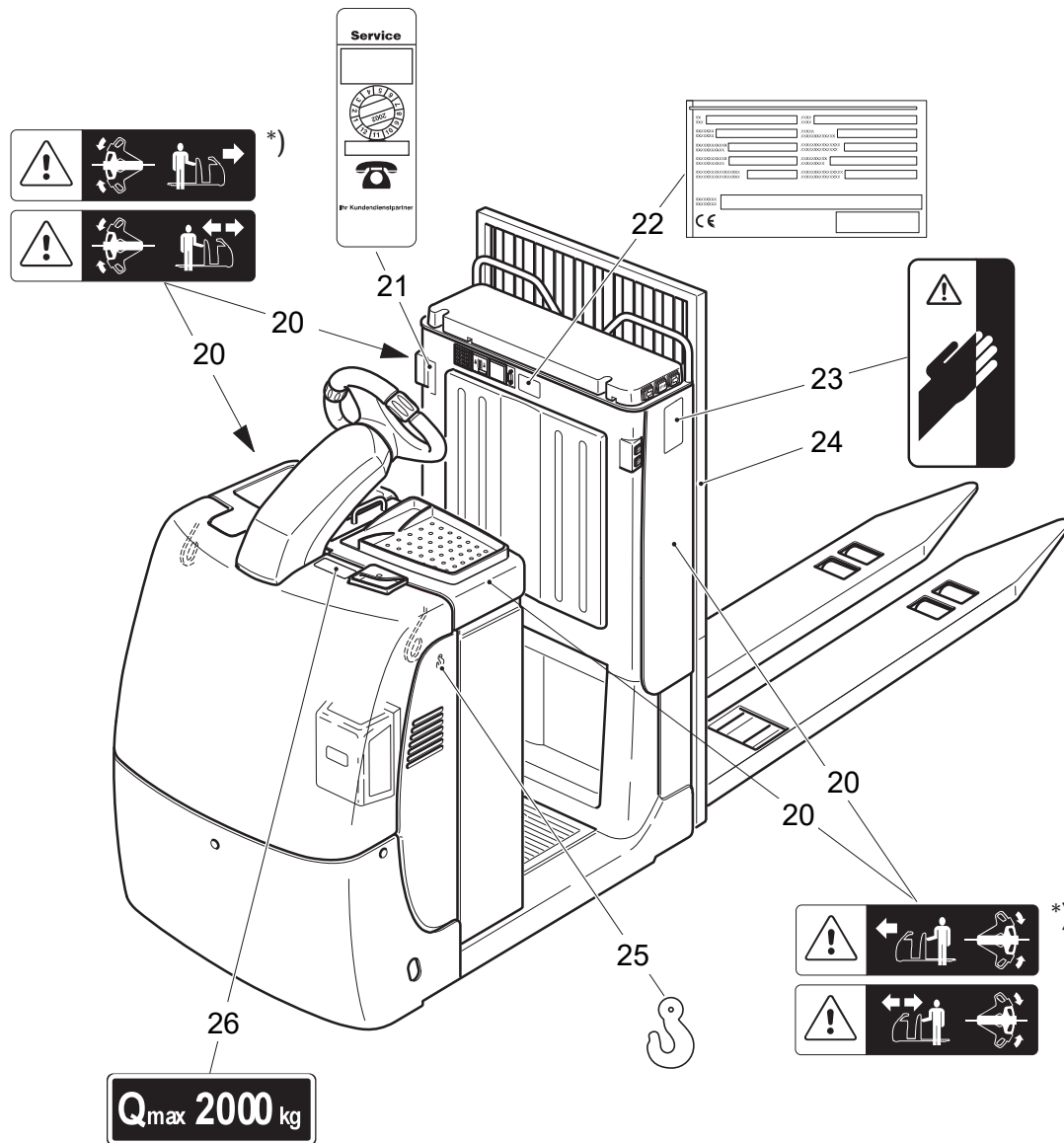

Item	Model
20	"Attention Touch Mode" warning decal *) for "Touch mode only in drive direction" option
21	Test sticker (○)
22	Truck data plate
23	Warning: "Do not reach into the mast"
24	Serial number, on the left or right of the mast section
25	Attachment point of crane loading (inside), hook symbol enhanced
26	Capacity Qmax



The capacity plate (26) indicates the maximum capacity of the truck, Qmax. The rated capacity as shown must not be exceeded. The plate stipulates that the load on the fork should be spread as evenly as possible.

E Operation

1 Safety Regulations for the Operation of Forklift Trucks

Driver authorisation: The forklift truck may only be used by suitably trained personnel, who have demonstrated to the proprietor or his representative that they can drive and handle loads and have been authorised to operate the truck by the proprietor or his representative.

Driver's rights, obligations and responsibilities: The driver must be informed of his duties and responsibilities and be instructed in the operation of the truck and shall be familiar with the operator manual. The driver shall be afforded all due rights. Safety shoes must be worn for pedestrian operated trucks.

Unauthorised use of truck: The driver is responsible for the truck during the time it is in use. The driver must prevent unauthorised persons from driving or operating the truck. Do not carry passengers or lift other people.

Damage and faults: The supervisor must be immediately informed of any damage or faults to the forklift truck or attachment. Trucks which are unsafe for operation (e.g. wheel or brake problems) must not be used until they have been rectified.

Repairs: The driver must not carry out any repairs or alterations to the industrial truck without the necessary training and authorisation to do so. The driver must never disable or adjust safety mechanisms or switches.

Hazardous area: A hazardous area is defined as the area in which a person is at risk due to truck movement, lifting operations, the load handler (e.g. forks or attachments) or the load itself. This also includes areas which can be reached by falling loads or lowering operating equipment.



Unauthorised persons must be kept away from the hazardous area. Where there is danger to personnel, a warning must be sounded with sufficient notice. If unauthorised personnel are still within the hazardous area the truck shall be brought to a halt immediately.

Safety devices and warning signs: Safety devices, warning signs and warning instructions shall be strictly observed.

Braking



The brake pattern of the truck depends largely on the ground conditions. The driver must take this into account when operating the truck.

The truck can brake in three different ways:

- with the service brake
- by regenerative braking (coasting)
- by plugging (controller)



In emergencies, always brake with the service brake.



During normal operation, the generator brake and plugging can be applied. These methods of braking reduce wear and require less energy (energy recovery).

Braking with the service brake:

- Apply the brake button (5).

The truck brakes at the maximum rate until it comes to a halt.



The mechanical brake is only applied when this brake fails to achieve the necessary braking force. The truck can only start again when the controller has been set to “0”.

Braking with the generator brake (coasting):

- Release the controller (6) - the controller assumes the zero position.

Depending on the setting, the truck brakes via the generator brake, coasting to a stop.



For the standard truck, the rate of deceleration can be adjusted by the manufacturer’s service department. For trucks with CANCODE and CANDIS it can be adjusted by entering the appropriate code.

Plugging:

- When travelling, set the controller (6) to the opposite direction.

The truck brakes regeneratively until it starts to move in the opposite direction.



The brake force depends on the position of the controller.

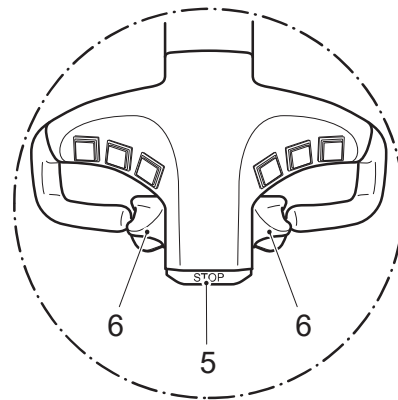
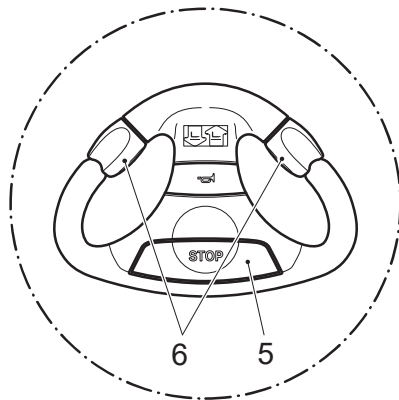

No.	Function	Setting range	Standard setting	Comments Procedure
Code Lock				
002	Change user code	0000 - 9999 or 00000 - 99999 or 000000 - 999999		(LED 23 flashes) Enter current code Confirm (Set) (LED 24 flashes) Enter a new code Confirm (Set) (LED 25 flashes) Repeat code entry Confirm
003	Delete user code	0000 - 9999 or 00000 - 99999 or 000000 - 999999		(LED 24 flashes) Enter a code Confirm (Set) (LED 25 flashes) Repeat code entry Confirm (Set)
004	Delete code log (Deletes all user codes)	3265		3265 = delete other inputs= do not delete
010	Automatic timeout	00 - 31	00	00 = No cutout 01 to 30 = Cutout time in minutes 31 = cutout in 10 seconds

LEDs 23-25 are located in key fields 1-3 (see Section 5.2)

9 Troubleshooting

This chapter is designed to help the user identify and rectify basic faults or the results of incorrect operation. When locating a fault, proceed in the order shown in the table.

Fault	Probable Cause	Action
Truck does not move	<ul style="list-style-type: none"> – Battery connector not connected. – Isolator (Emergency Stop) depressed. – Key switch set to "0" – Code lock switched off – Battery charge too low. – Platform switch not applied. – Faulty fuse. 	<ul style="list-style-type: none"> – Check the battery connector and connect if necessary. – Release isolator – Set the key switch to position "I". – Enter operator code. – Check the charging condition of the battery and recharge if necessary. – Press the platform switch. – Check fuses F1 and 1F1.
Lifting inhibited.	<ul style="list-style-type: none"> – Truck not operational. – Hydraulic oil level too low. – Battery discharge monitor has cut out and indicates "STOP". – Faulty fuse. – Excessive load. 	<ul style="list-style-type: none"> – Perform all remedial actions listed under the fault "Truck does not move". – Check hydraulic oil level. – Charge the battery. – Check fuse 2F1. – Note maximum capacity (see data plate)



If the fault cannot be rectified after carrying out the remedial procedure, notify the manufacturer's service department, as any further troubleshooting can only be performed by specially trained and qualified service personnel.

CLICK HERE TO **DOWNLOAD** THE COMPLETE MANUAL

- Thank you very much for reading the preview of the manual.
- You can download the complete manual from: www.heydownloads.com by clicking the link below



- Please note: If there is no response to CLICKING the link, please download this PDF first and then click on it.

CLICK HERE TO **DOWNLOAD** THE COMPLETE MANUAL