

it Read this handbook thoroughly and understand the whole information contained before trying to operate, inspect and service your machine!

**OPERATING &
MAINTENANCE
INSTRUCTIONS**

**VIBRATIN
G**

MODEL

SW800

SW850

SW900

From SW800 — VSW35 — 10101
SW850 — VSW32 — 10101
SW900 — VSW33 — 10101

CLICK HERE TO **DOWNLOAD** THE COMPLETE MANUAL

- Thank you very much for reading the preview of the manual.
- You can download the complete manual from: www.heydownloads.com by clicking the link below



- Please note: If there is no response to CLICKING the link, please download this PDF first and then click on it.

CLICK HERE TO **DOWNLOAD** THE COMPLETE MANUAL

A WARNING: Negligence of these instructions can lead to accidents.

1. BASIC PRECAUTIONS FOR SAFETY

- Know the stopping distance.
 - When traveling on a road, bear in mind the stopping distance. Avoid excessive speed, and abrupt starting and stopping, and moving in a zigzag direction.

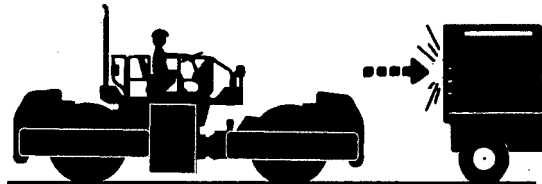

1.3 Before Starting the Engine

- **Adjust the operator's seat to your most effective operating position.**
 - Sit on the operator's seat. Adjust the seat so that your back will make contact with the seat back when the brake pedal is depressed to the full extent. Check to be sure that the brake pedal can be fully depressed without difficulty when you twist your body for reverse run.

- **Secure forward and backward visibilities.**
 - Adjust the rear view mirrors and under mirrors for good visibility. If dirty, clean them. If damaged, replace.

- **Check that the horn, lamps and gauges work correctly.**

- **Before starting, make certain that each lever is in the neutral position and the parking brake is applied.**

- **When starting, sound the horn.**
 - Before starting the engine. Make sure there is no one in the immediate vicinity and there are no obstructions around the machine.

k:74

A WARNING: Negligence of these instructions can lead to accidents.

1. BASIC PRECAUTIONS FOR SAFETY

SW800, SW850, SW900

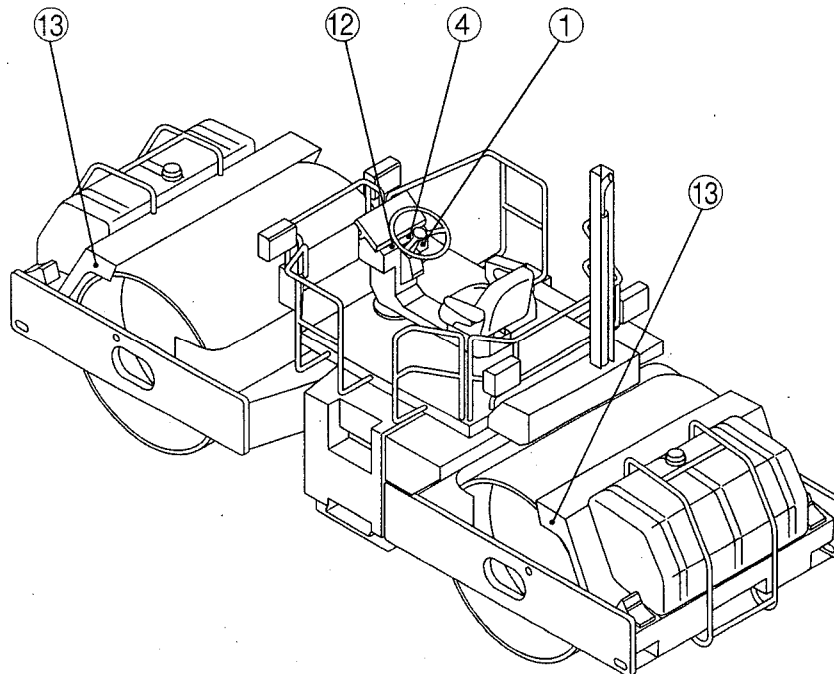
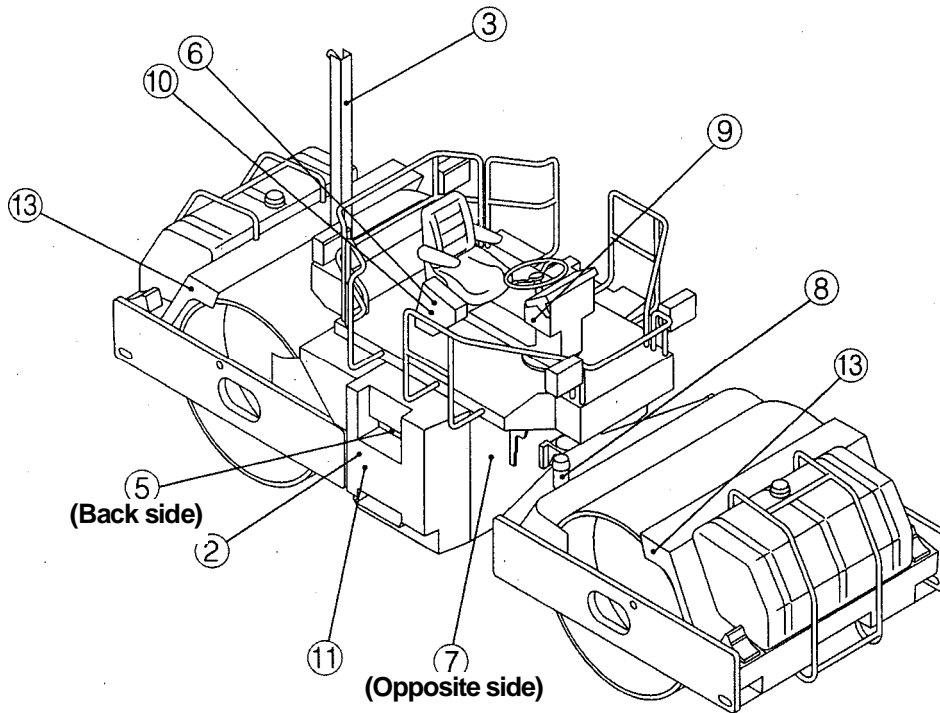

Brake pedal

In an emergency, push down on the pedal to the full extent, and the machine will come to a sudden stop.

_ IMPORTANT

Do not use the pedal wherever practicable except for an emergency. If used during the compacting operation of asphalt pavement, this can cause damage to its surface.

NOTE: Depressing the brake pedal brings the F-R lever into neutral position

Unloader valve

Lift the cover on the left side of the roller and you will find unloader valve.

The unloader valve disengages the drive, playing a role like a clutch. Use this valve for towing the machine when the engine is disabled or when troubles have developed in the hydraulic drive.

For towing:

Turn the valve counter-clockwise (Unload).

For normal traveling:

Turn the valve clockwise (Onload).

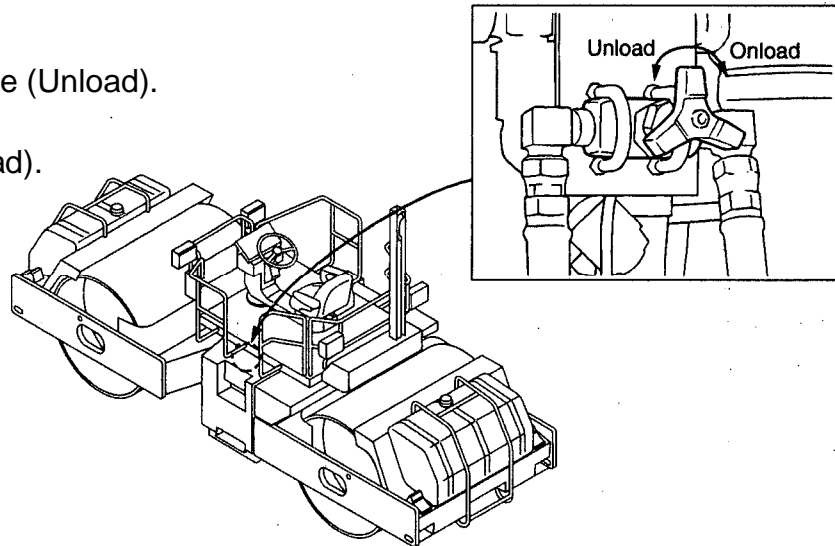

_ WARNING

- On a slope, chock the wheels and use extreme care when handling the unloader valve and towing the machine.
- Be sure to apply the parking brake when operating the unloader valve.

NOTE: For normal travel, be sure to hold the valve in the ONLOAD position.

(4) Vibration can be turned ON or OFF with the switch provided on the F-R lever as well. Pressing the switch starts the vibration and pressing it again stops the vibration. The switch on the F-R lever should be used with the vibration switch on the panel remaining at "4v" or "1N%" position.

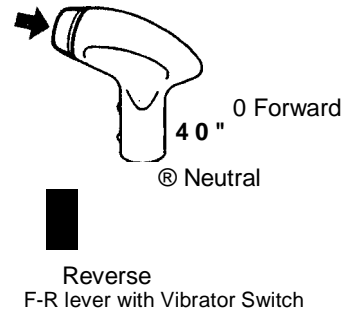

(5) Vibration mode selector switch allows you to select the mode of vibration between "CONT" and "AUTO". Vibration can be actuated in the following manner, in either case:

CONT position : With the vibration switch placed at "4v" or "1N%" position, turning the switch on F-R lever to ON position, causes the vibration to start.

CONT AUTO

When the vibration mode selector switch is at CONT position, turning either the vibration switch to OFF position or the switch on F-R lever to OFF position, cause the vibration to come to stop.

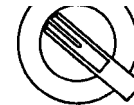

AUTO position : With the vibration switch placed at "AP" or " " position and the switch on F-R lever turned ON, placing the F-R lever at Forward or Reverse position causes the travel and vibration to start simultaneously.

Returning the F-R lever to neutral causes the vibration to stop.

(7) Proper travel speed for vibratory compaction is 2-7 km/h, however, select speeds depending upon job requirements.

A CAUTION

- **Keep the vibrator shut off when the machine is not rolling.**
- **Shut off the vibrator immediately when the machine has been caught in the mud during vibratory operation.**

2.12.3 Battery

IN

- Batteries generate explosive gases. Do not use an open flame close to batteries.
- The battery electrolyte is corrosive. Keep the electrolyte away from your eyes and skin. If you are affected by the electrolyte, flush with large quantities of water and get medical help.

At low temperature, batteries are less efficient. The level of charge is lowered and batteries will tend to freeze. Maintain batteries full charged wherever practicable, and give attention to heat insulation at night for the next day's operation.

For the level of charge, check the specific gravity of electrolyte and use the following table of conversion.

\	Temperature	20°C	0°C	-10°C	-20°C
	Level of charge (%)	(68°F)	(32°F)	(14°F)	(-4°F)
	100		1.29	1.30	1.31
	90	1.26	1.27	1.28	1.29
	80	1.24	1.25	1.26	1.27
	75	1.23	1.24	1.25	1.26

Battery

- (1) With the caps removed, check to see if the electrolyte level is above the plates.
- (2) Add distilled water or battery fluid commercially available if the level is too low.
- (3) Retighten any loose terminal. Apply grease or vaseline to the terminals to retard rusting.

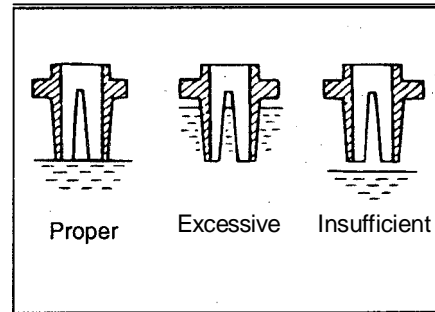

A WARNING

Using or charging battery with electrolyte level below LOWER LEVEL mark on its side, could result in explosion.

Continuing to use battery with insufficient electrolyte accelerates deterioration of the battery container internals. Be sure to have the electrolyte always replenished to the prescribed level.

Fuel sedimenter

Check the float level. If it comes up to the warning mark, take off the plug at the bottom and drain water.

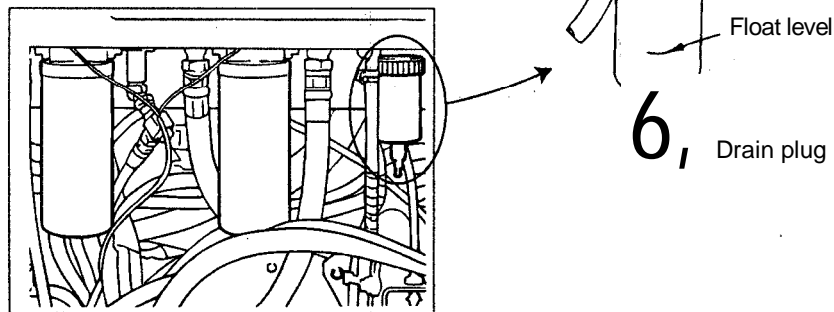

Hydraulic tank

Check the oil level with the sight glass on the side of tank. The level is proper if it is between H and L marks. If necessary, add the hydraulic oil from the fill port.

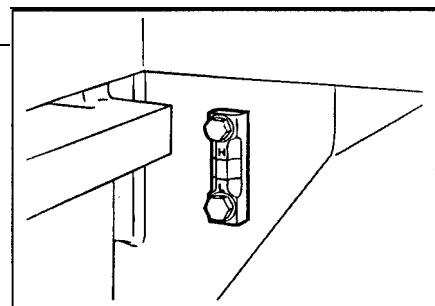

3. PERIODICAL MAINTENANCE

Standard dimensions		
Separate plate	4 plates:	2.3 (per plate)
Friction plate	3 plates:	3.3 (per plate)
Total thickness		19.1
Standard total thickness for replacement		18.5

Thickness of separate and friction plates for SW800 and SW850 are the same.

Checking procedure: Disassemble and measure the plate thickness in every 500 hours of operation in accordance with the instruction given earlier.

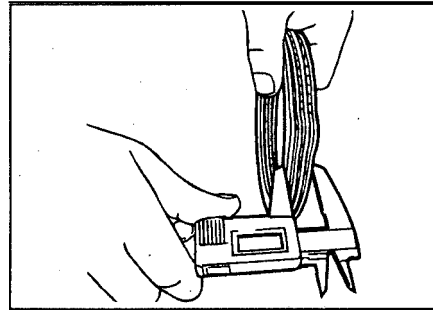

Vibrator

- (1) Rotate the drum till the drain plug comes to bottom.
- (2) Remove the drain and level plugs.
- (3) Drain the vibrator oil.
- (4) Rotate the roll ,until the mark on its inside comes to the bottom.
- (5) Feed oil from top filler port until oil overflows out of level gauge port.
- (6) After cleaning, reinstall level gauge plug and filler ports plug.

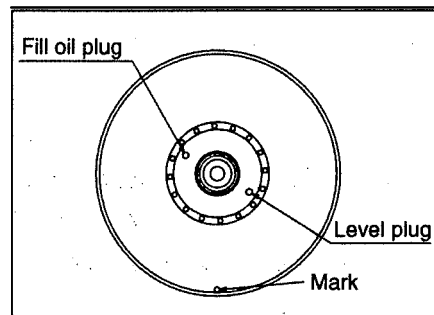

(6) As required

Sprinkler tank

- (1) With the drain cap removed, remove the water and sediment from the bottom of the tank.
- (2) If sedimentation is substantial, remove the drain plug and clean the interior of the tank.
- (3) When the necessary work is complete, refit the drain cap and filler cap.

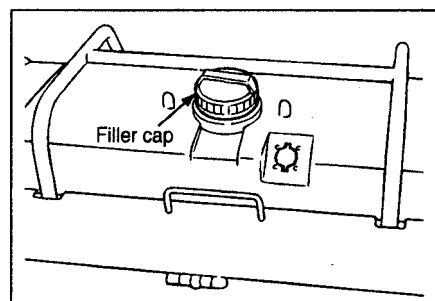
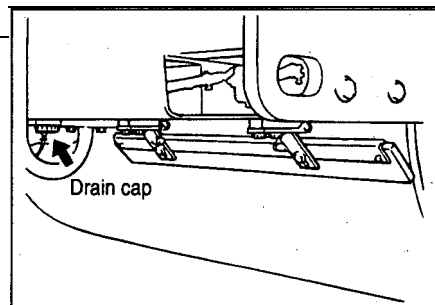

CLICK HERE TO **DOWNLOAD** THE COMPLETE MANUAL

- Thank you very much for reading the preview of the manual.
- You can download the complete manual from: www.heydownloads.com by clicking the link below



- Please note: If there is no response to CLICKING the link, please download this PDF first and then click on it.

CLICK HERE TO **DOWNLOAD** THE COMPLETE MANUAL