

ERD 220

11.03 -

Operating instructions



50428242

09.10

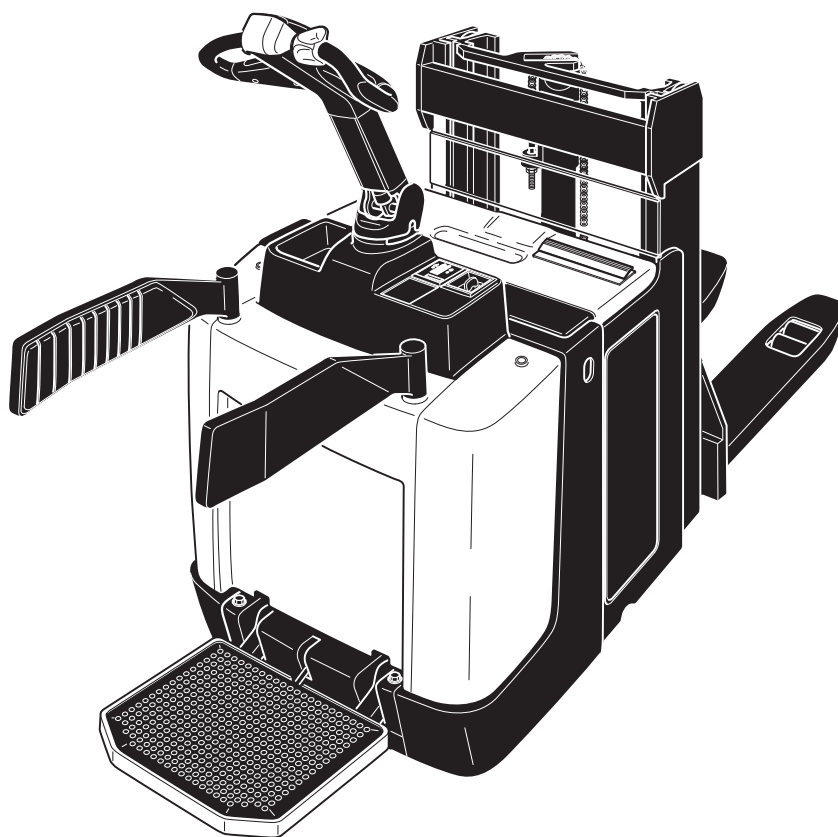

CLICK HERE TO **DOWNLOAD** THE COMPLETE MANUAL

- Thank you very much for reading the preview of the manual.
- You can download the complete manual from: www.heydownloads.com by clicking the link below



- Please note: If there is no response to CLICKING the link, please download this PDF first and then click on it.

CLICK HERE TO **DOWNLOAD** THE COMPLETE MANUAL

B Truck Description

1 Application

The truck is a wheel-based, electric tiller-operated stacker with a folding operator platform that can be used for lifting and stacking pallets and horizontal transportation. For stacking operations the capacity with 1000 kg with a load centre distance of 600 mm. For horizontal transport 2000 kg can be raised on a pallet or max. 2 x 1000 kg on two pallets on top of each other.

With its compact design and application as both stacker and for horizontal transportation, the ERS 220 is especially suited for use in retail environments, workshops, small warehouses and for assisting lorry loading and unloading.

The capacity of the truck is shown on the data plate or the data capacity plate Qmax.

1.1 Truck models and rated capacity

The rated capacity depends on the model. The rated capacity can be derived from the model description.

Tabelle 1: EJD220

EJD	Model Description
2	Series
20	Rated capacity x 100 kg

The rated capacity does not generally match the permissible capacity. The capacity can be found on the load chart attached to the rack.

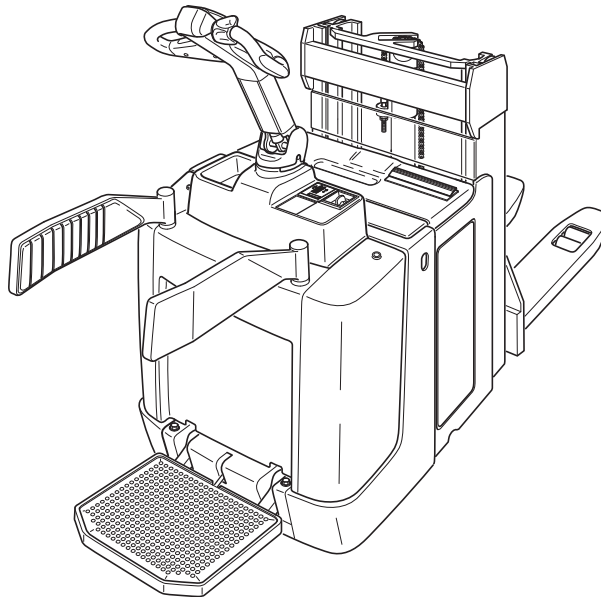

4 Identification points and data plates

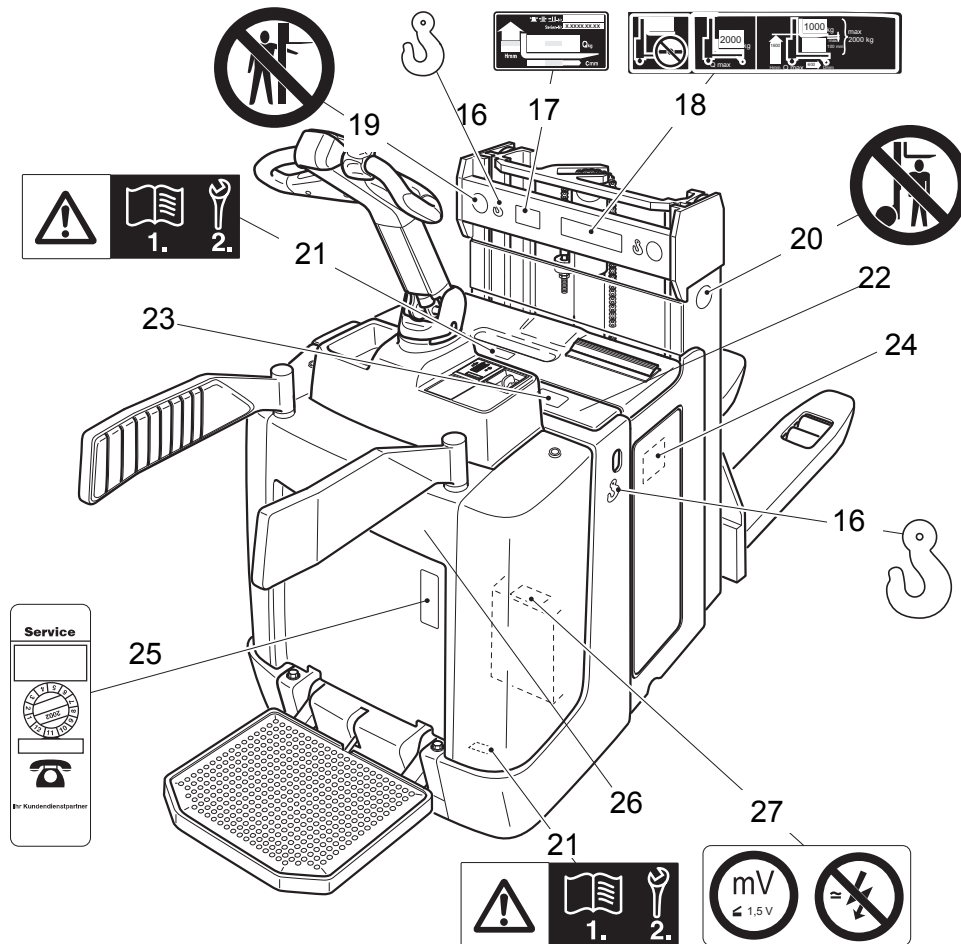

Item	Model
16	Strap points for crane lifting
17	Load chart
18	Capacity
19	"Do not reach through the mast" warning
20	"Do not step under the load handler" warning
21	"Read operating instructions" warning
22	Serial number
23	Data plate
24	Battery data plate
25	Test plaque
26	Model name
27	Caution: Low voltage electronics

The battery weights can be taken from the battery data plate. Batteries with non insulated terminals must be covered with a non slip insulating mat.

Item	Control / Display		Function
14	Fixed operator platform	○	rider mode only: <ul style="list-style-type: none"> – Deadman laden: Travel and all functions enabled. – Deadman unladen: The truck coasts.
15	Deadman button (function depends on the tiller version)	○	Trucks with moving tiller: <ul style="list-style-type: none"> – Deadman button pressed: Travel released. – Deadman button released: Truck coasts. Trucks with rigid tiller: <ul style="list-style-type: none"> – Deadman button pressed: Truck ready for operation. – Deadman button released: The truck decelerates.
50	Warning signal (horn) button	●	– “Warning” button
51	Collision safety switch	●	– Pedestrian mode: Collision safety switch function which, when activated, forces the truck to reverse for approx. 3 seconds and then cuts out until the controller is briefly restored to neutral. – Rider mode: Void
52	Wheel arm lower button	●	– Lowers the wheel arms at a constant speed.
53	Wheel arm lift button	●	– Lifts the wheel arms at a constant speed.
54	Fork raise button	●	– Raises the lift mechanism.
55	Fork lower button	●	– Lowers the lift mechanism.
		● = Standard equipment	○ = Optional equipment

4.2.2 Travel

CAUTION!

- ▶ Do not drive the truck unless the panels are closed and properly locked.
 - ▶ When travelling through swing doors etc. make sure that the doors do not activate the collision safety button.
-

WARNING!

Trapping hazard

Be extremely careful when driving and steering, especially if parts of your body extend outside the border of the truck.

- ▶ Do not reach between the standing platform and the truck frame when you fold up the platform.
 - ▶ In pedestrian mode make sure you have sufficient distance from the industrial truck.
-

NOTE

- ▶ Travelling is inhibited when the operator platform is unladen and the side arms are not folded out.
 - ▶ If the standing platform is occupied and the gates are not folded out, the industrial truck can only be operated at reduced speed.
 - ▶ If the operator platform is occupied and only one gate is folded out, travelling is inhibited.
-

Industrial trucks with a folding standing platform and moving tiller

We distinguish between two travel modes:

- Travel in pedestrian mode
- Travel in rider mode

Travel in pedestrian mode

Requirements

- Start up the truck, see "Starting up the truck" on page 43

Procedure

- Move the folding side arms (9) towards the inside.
- Fold up the standing platform (11).
- Set the tiller (2) to travel zone (F).
- Control the travel speed with the travel switch (1).
- Set the travel switch (1) to the desired travel direction: forward (V) or reverse (R).

 When the travel switch is released it automatically returns to its original position.

The brakes are released and the truck moves in the selected direction.

 In pedestrian mode the truck can only be operated at reduced speed.

7 Load handler emergency lowering

Load handler emergency lowering

Requirements

- Load handler is not in the rack.

Tools and Material Required

- Allen key (2.5 mm)

Procedure

- Set key switch (7) to “0”.
- Depress the Emergency Disconnect (5). see "Emergency Disconnect" on page 50.
- Open the front panel. see "Removing the front panel" on page 87.
- Undo the screw on the valve manifold (59).

The load handler is lowered.



After carrying out the emergency lowering, turn in the screw (59) as far as the stop.

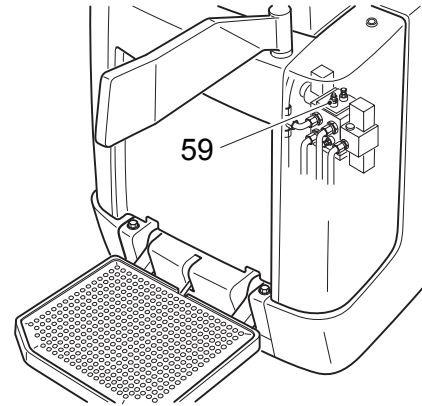

Setting the travel program configuration to a code

Procedure

- Press the O key (81).
- Enter the master code.
- Enter the three-digit parameter number 024.
- Confirm with the SET key (82).
- Enter the code to be changed and confirm with SET.
- Enter the configuration (4 digit) and confirm with SET.
- Enter the configuration (4 digit) again and confirm with SET.
- Repeat the procedure for other codes.
- Then press the O key.

The travel programs are assigned to the codes

Keypad event messages

The LED (83) flashes red to indicate the following events:

- New master code is already in use.
- New code is already the master code
- Code to be changed does not exist
- Attempt to change the code to one that already exists.
- Attempt to delete a code that does not exist
- Code memory full.

5 Lubricants and Lubrication Schedule

5.1 Handling consumables safely

Handling consumables

Consumables must always be handled correctly. Follow the manufacturer's instructions.

WARNING!

Improper handling is hazardous to health, life and the environment

Consumables can be flammable.

- ▶ Keep consumables away from hot components and naked flames.
 - ▶ Always keep consumables in prescribed containers.
 - ▶ Always fill consumables in clean containers.
 - ▶ Do not mix up different grades of consumable. The only exception to this is when mixing is expressly stipulated in the operating instructions.
-

CAUTION!

Spilled liquids can cause slipping and endanger the environment

Risk of slipping from spilled liquids. The risk is greater when combined with water.

- ▶ Do not spill fluids.
 - ▶ Spilled fluids must be removed immediately with an appropriate bonding agent.
 - ▶ The bonding agent / consumable mixture must be disposed of in accordance with regulations.
-

WARNING!

Oils (chain spray / hydraulic oil) are flammable and poisonous.

- ▶ Dispose of used oils in accordance with regulations. Store used oil safely until it can be disposed of in accordance with regulations.
 - ▶ Do not spill oil.
 - ▶ Spilled fluids must be removed immediately with an appropriate bonding agent.
 - ▶ The bonding agent / consumable mixture must be disposed of in accordance with regulations.
 - ▶ Observe national regulations when handling oils.
 - ▶ Wear safety gloves when handling oils.
 - ▶ Prevent oil from coming into contact with hot motor parts.
 - ▶ Do not smoke when handling oil.
 - ▶ Avoid contact and digestion. If you swallow oil do not induce vomiting but call for a doctor immediately.
 - ▶ Seek fresh air after breathing in oil fumes or vapours.
 - ▶ If oil has come into contact with your skin, rinse your skin with water.
 - ▶ If oil has come into contact with your eyes, rinse them with water and call for a doctor immediately.
 - ▶ Replace oil-soaked clothing and shoes immediately.
-

CLICK HERE TO **DOWNLOAD** THE COMPLETE MANUAL

- Thank you very much for reading the preview of the manual.
- You can download the complete manual from: www.heydownloads.com by clicking the link below



- Please note: If there is no response to CLICKING the link, please download this PDF first and then click on it.

CLICK HERE TO **DOWNLOAD** THE COMPLETE MANUAL