

# EPM113 / EPM113 W

11.13 -

Operating Instructions



51365238

04.14

EPM113  
EPM113 W

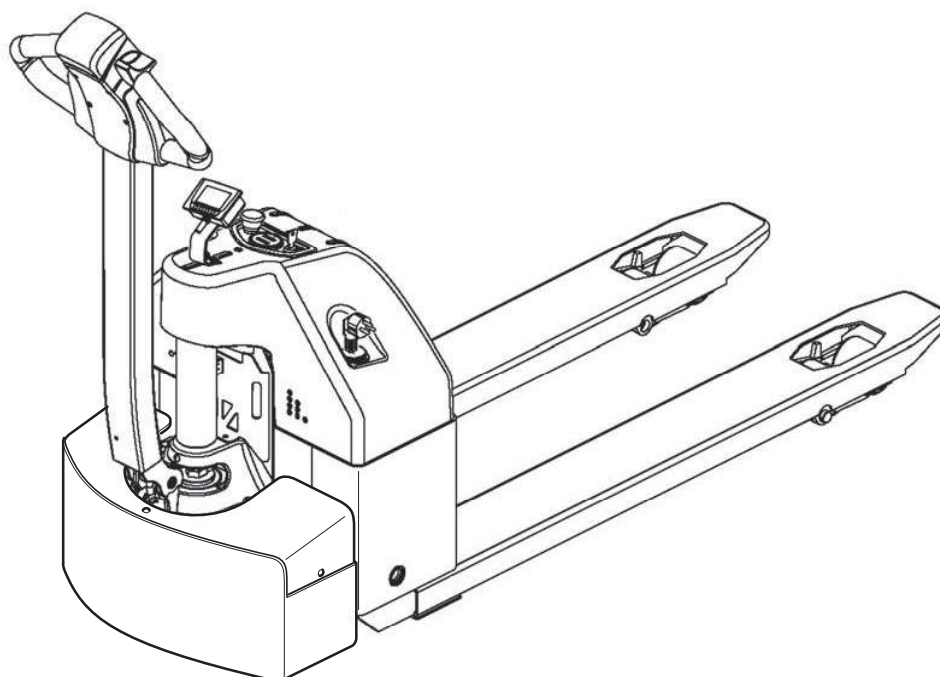

CLICK HERE TO **DOWNLOAD** THE COMPLETE MANUAL

- Thank you very much for reading the preview of the manual.
- You can download the complete manual from: [www.heydownloads.com](http://www.heydownloads.com) by clicking the link below



- Please note: If there is no response to CLICKING the link, please download this PDF first and then click on it.

CLICK HERE TO **DOWNLOAD** THE COMPLETE MANUAL

# B Truck Description

## 1 Application

The EPM113 / EPM113 W is an electric, tiller operated three-wheel truck with a steered drive wheel. Support wheels in the drive compartment ensure stability when steering.

It is designed for use on level surfaces to lift and transport palletised goods. Open bottom pallets or roll cages can be lifted.

→ The EPM is designed for light-duty operations; the maximum continuous operation time is two hours.

### 1.1 Truck Models and Rated Capacity

The rated capacity depends on the model. The rated capacity can be derived from the model name.

EPM	Model name
1	Series
13	Rated capacity x 100 kg
W	Weigher

The rated capacity is not generally the same as the permissible capacity. The capacity can be found on the capacity plate attached to the truck.

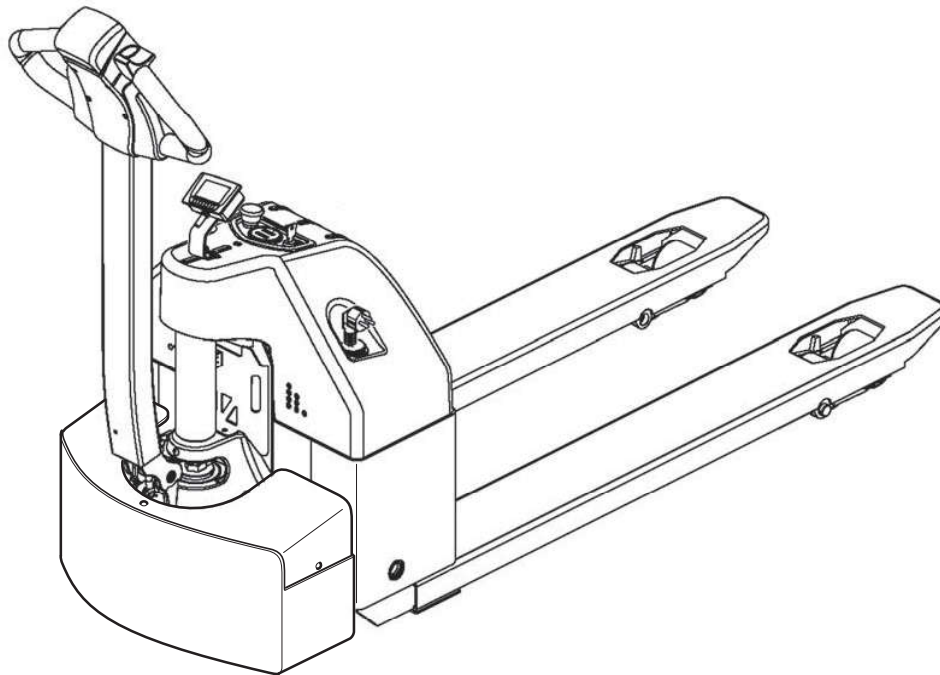

## 2 Transport

### **WARNING!**

#### **Accidental movement during transport**

Improper fastening of the truck and mast during transport can result in serious accidents.

- ▶ Loading must only be performed by specialist personnel trained for this purpose. The specialist personnel must be instructed in securing loads on road vehicles and handling load securing devices. In each case correct measurements must be made and appropriate safety measures adopted.
  - ▶ The truck must be securely fastened when transported on a lorry or a trailer.
  - ▶ The lorry or trailer must have fastening rings.
  - ▶ Use wedges to prevent the truck from moving.
  - ▶ Use only fastening belts with sufficient strength.
  - ▶ Use non-slip materials to securing the load aids (pallet, wedges, ...) e.g. non-slip mats.
- 

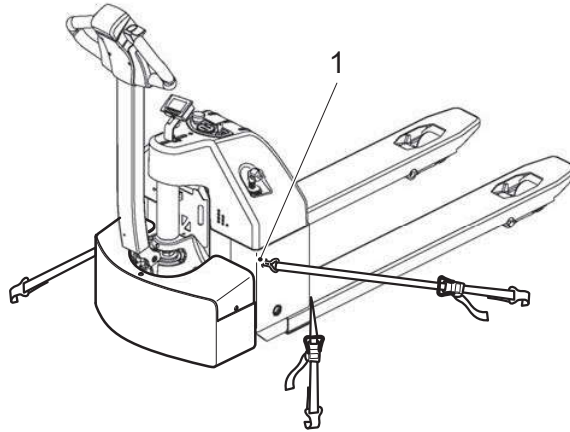

#### **Securing the industrial truck for transport**

##### *Tools and material required*

- Tensioning belts / tie down straps

##### *Procedure*

- Load the truck onto the transporting vehicle.
- Park the truck securely (see "Parking the truck securely" on page 36).
- Use the strap point (1) to fasten the truck.
- Sling the tensioning belt around the truck and attach it to the fastening rings of the transporting vehicle.
- Tighten the tensioning belt with the tensioner.

*The truck can now be transported.*

# E Operation

## 1 Safety Regulations for the Operation of the Forklift Truck

### Driver authorisation

The truck may only be used by suitably trained personnel, who have demonstrated to the operating company or its representative that they can drive and handle loads and have been authorised to operate the truck by the operating company or its representative.

### Operator's rights, obligations and responsibilities

The operator must be informed of his duties and responsibilities and be instructed in the operation of the truck and shall be familiar with the operating instructions. Safety shoes must be worn for pedestrian operated trucks.

### Unauthorised use of truck

The operator is responsible for the truck during the time it is in use. The operator must prevent unauthorised persons from driving or operating the truck. Do not carry passengers or lift other people.

### Damage and faults

The supervisor must be informed immediately of any damage or faults to the truck or attachment. Trucks which are unsafe for operation (e.g. wheel or brake problems) must not be used until they have been rectified.

### Repairs

The operator must not carry out any repairs or alterations to the truck without authorisation and the necessary training to do so. The operator must never disable or adjust safety mechanisms or switches.

### Hazardous area

#### **WARNING!**

#### **Risk of accidents / injury in the hazardous area of the truck**

The hazardous area is the area in which people can be endangered by the travel or lifting movements of the truck, its load handler or the load. This also includes areas which can be reached by falling loads or lowering operating equipment.

- ▶ Instruct unauthorised people to leave the hazardous area.
- ▶ Give a warning signal with plenty of time for people to leave.
- ▶ If unauthorised personnel are still within the hazardous area stop the truck immediately.

---

#### **Safety devices, warning signs and warning instructions**

Safety devices, warning signs and warning instructions in the present operating instructions must be strictly observed.

## 4.5 Steering

### *Procedure*

- Move the tiller (1) to the left or right.

*The truck is steered in the required direction.*

## 4.6 Brakes

### **WARNING!**

#### **Accident risk while braking**

The truck's braking response depends largely on the floor condition and the type of surface. The truck's braking distance increases when the ground is wet or dirty.

- ▶ The operator must be aware of floor conditions and take them into account when braking.
  - ▶ Brake with care to prevent the load from slipping.
- 

The truck can brake in two ways:

- By using the service brake (brake zone B).
- With the plugging brake.
- By regenerative braking (coasting brake).

### **CAUTION!**

- ▶ In hazardous situations set the tiller to the brake position.
- 

### **4.6.1 Braking with the service brake:**

#### *Procedure*

- Set the tiller (1) up or down to one of the brake zones (B).

*The truck decelerates at the maximum rate until it comes to a halt.*

### **4.6.2 Inversion braking**

#### *Procedure*

- During travel, set the controller (5) to the opposite direction.

*The truck brakes regeneratively until it starts to move in the opposite direction.*

## 2 Maintenance Safety Regulations

### Maintenance and repair personnel

- The manufacturer has a service department specially trained for these tasks. A maintenance contract with the manufacturer will ensure trouble-free operation.

Truck maintenance and repair work must only be carried out by specialist personnel. The activities to be carried out are divided into target groups.

#### Customer Service

Customer service personnel have been specifically trained on the truck and are able to carry out maintenance and repairs independently. The customer service personnel are aware of the relevant standards, guidelines and safety regulations necessary to carry out this work.

#### Operating Company

Due to their expert knowledge and experience, the operating company's maintenance personnel are able to carry out the activities described in the maintenance checklist for the operator below. The maintenance and repair work to be carried by the operating company are described below, see "Maintenance and Repairs" on page 58.

### 4.3.2 Cleaning the electrical system assemblies

#### CAUTION!

##### **Risk of electrical system damage**

Cleaning the electronic system assemblies (controllers, sensors, motors etc.) with water can damage the electrical system.

- ▶ Do not clean the electrical system with water.
- ▶ Clean the electrical system with weak suction or compressed air (use a compressor with a water trap) and not a conductive, anti-static brush.

#### ***Cleaning the electrical system assemblies***

##### *Requirements*

- Prepare the truck for maintenance and repairs (see "Preparing the Truck for Maintenance and Repairs" on page 58).

##### *Tools and material required*

- Compressor with water separator
- Non-conductive, antistatic brush

##### *Procedure*

- Expose the electrical system, see "Removing the Panel" on page 62.
- Clean the electrical system assemblies with weak suction or compressed air (use a compressor with a water trap) and not a conductive, anti-static brush.
- Fit the electrical system cover, see "Removing the Panel" on page 62.
- Perform the tasks contained in the "Recommissioning the truck after cleaning or maintenance work" section (see "Restoring the Truck to Service after Maintenance and Repairs" section on page 66).

*The electrical system assemblies are now clean.*

### 4.4 Removing the panel

#### ***Removing the panel***

##### *Requirements*

- Prepare the truck for maintenance and repairs (see "Preparing the Truck for Maintenance and Repairs" on page 58).

##### *Tools and material required*

- Large slotted screwdriver

##### *Procedure*

- Remove 2 screws (3).
- If necessary loosen the union nut (2) from the connection of the weigher (○) and undo the connection.
- Carefully lift off the panel while pressing the weigher cable through the duct (1).

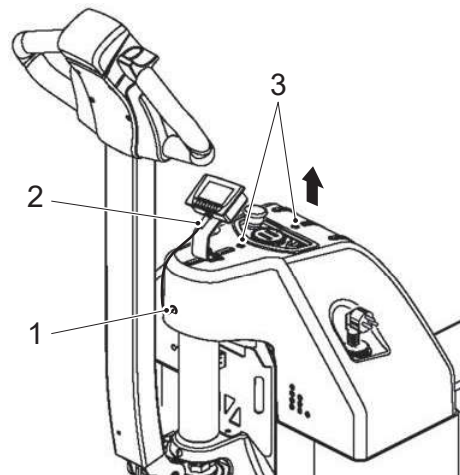

*The front cover has been removed.*

CLICK HERE TO **DOWNLOAD** THE COMPLETE MANUAL

- Thank you very much for reading the preview of the manual.
- You can download the complete manual from: [www.heydownloads.com](http://www.heydownloads.com) by clicking the link below



- Please note: If there is no response to CLICKING the link, please download this PDF first and then click on it.

CLICK HERE TO **DOWNLOAD** THE COMPLETE MANUAL