

ETM/V 214/216

10.03 -

Operating instructions

GB

50314468

10.03



 **JUNGHEINRICH**

CLICK HERE TO **DOWNLOAD** THE COMPLETE MANUAL

- Thank you very much for reading the preview of the manual.
- You can download the complete manual from: www.heydownloads.com by clicking the link below



- Please note: If there is no response to CLICKING the link, please download this PDF first and then click on it.

CLICK HERE TO **DOWNLOAD** THE COMPLETE MANUAL

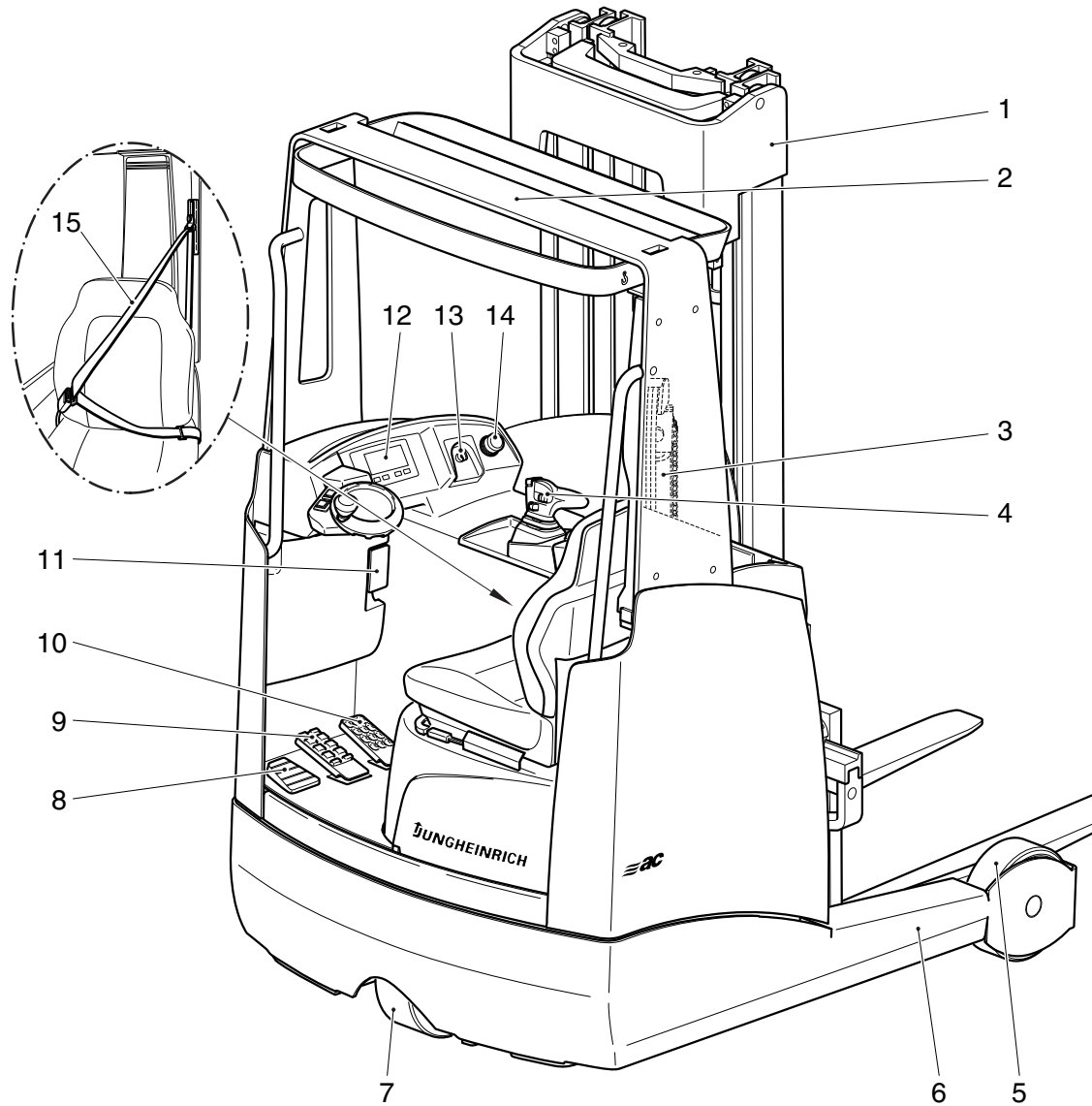

Item.		Description	Item.		Description
1	●	Clear View Lift Mast	10	●	Accelerator
2	●	Overhead Guard	11	●	Battery trolley unlocking
3	●	Free Lift Cylinder (not with ZT-Lifting Frame)	12	●	Driver's display
4	●	Multi-Pilot		○	On board computer
5	●	Load wheels	13	●	Two stage switch key with spare key (service).
6	●	Outriggers		○	CANCODE
7	●	Drive wheel	14	●	Emergency Stop Switch
8	●	Dead man pedal	15	○	Safety Belt
9	●	Brake Pedal			

●	Series Equipment	○	Auxiliary Equipment
---	------------------	---	---------------------

2 Lifting by Crane



Only use lifting equipment with sufficient capacity.
(Weight Lifted = Net Weight + Battery Weight; see data plate, truck).

- In order to lift the truck with a harness wrap slings around the strut of the overhead guard. Two suspension points (2) are located on the outriggers.
- Withdraw battery plug (1).
- Secure the truck with wedges to prevent it from rolling away!



Fasten the harness to the lifting points so that it cannot slip! Lifting slings should be fastened to the harness so that when lifting they do not come into contact with any attachments.

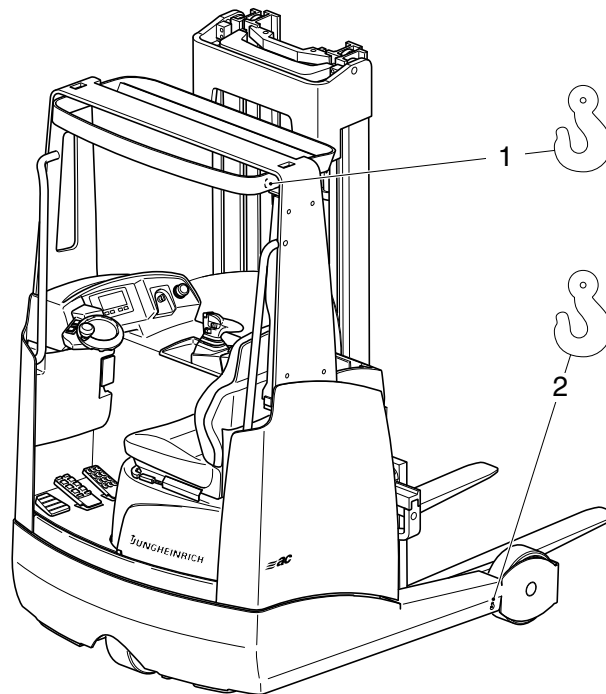

6.2 On Board Computer (○)

Battery Discharge Display: The charge status of the battery (15) is shown in 10% increments on the display.



The serial setting of the battery discharge display / discharge monitor is applied to standard batteries.

When using maintenance free batteries the display must be set so that the symbol (T) appears after the percentage figure. If this setting is not carried out the battery may be damaged because of excessive depletion.

When adjusting the instrument the manufacturer's service department must be called in.

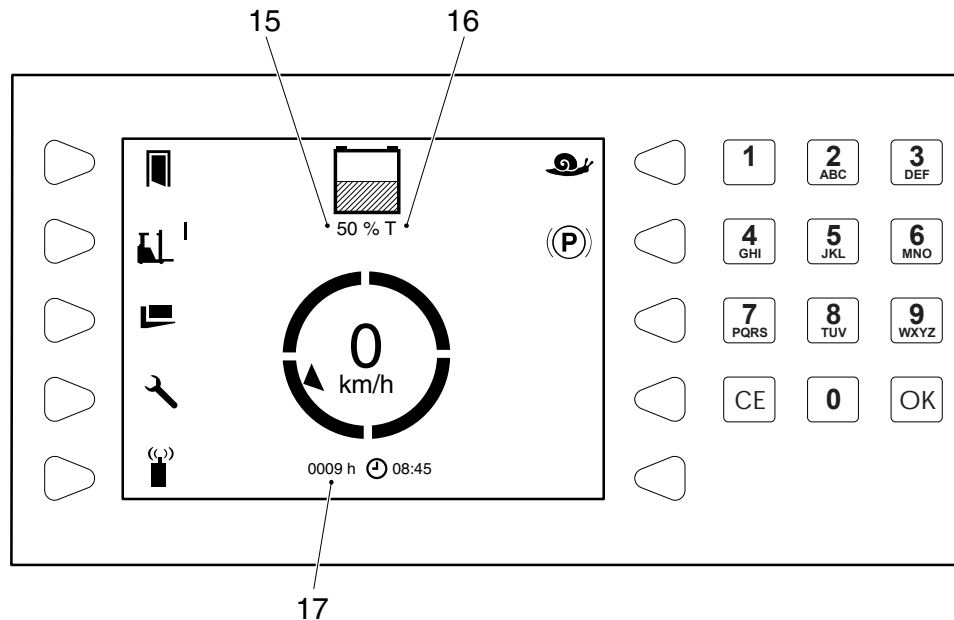

The battery must be charged when there is a battery residual capacitance of 20% for standard batteries or 40% for maintenance free batteries.

Battery Discharge Monitor: Lifting is cut out when the residual capacity falls below the required level. An appropriate message will be shown on the driver's display unit.

Lifting will only be restored when the connected battery is charged up to 70% of maximum.

Remaining Time Display: The Battery Remaining Time Display is an option which can be activated via a parameter in the service mode.

The remaining time is shown up to 20% residual capacity (for maintenance batteries 40%)

Alternatively the Battery Remaining Time display is shown as a percentage figure (15) under the battery symbol (Format R 00:00).

3.2 Preparation for Use

Pull out the main switch (2)

Insert the key in the key switch and turn to the right to position "I" or:

- for trucks without a key switch enter the free switch code via CANCODE (1a), or via the on board computer.

With **CANCODE** (○), the start **PIN 2580** is inserted via the control panel (1a) and confirmed by the set key.

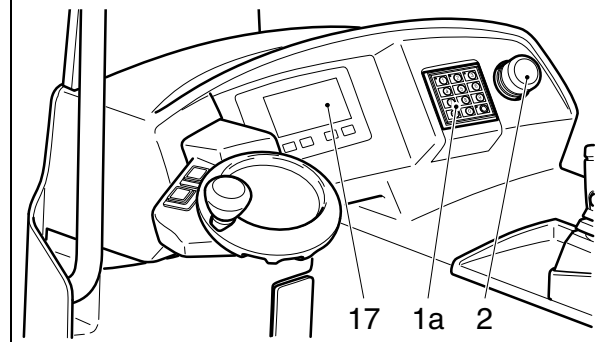
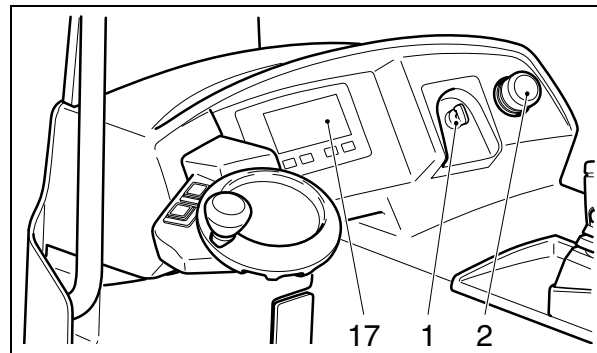

- For the on **board computer** (17a) (○), enter the start **PIN 14016** and confirm with OK.

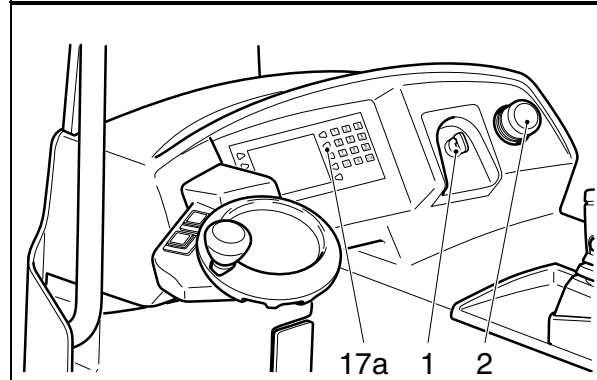

- Check the horn operation.

The truck is now ready for use. The battery charge monitor shows the battery capacity available.

- Check the brake and handbrake operation (see Section 4.2).
- On starting the dead man pedal must be activated.

5 Mechanical Back Up Steering (Emergency Steering Operation)

The mechanical back-up steering system is used to recover the truck in the event of an electrical failure.



It must only be implemented by trained maintenance personnel who have been trained to operate the truck.

- Turn off the main switch and the key switch
- Ensure that the truck cannot roll away.
- Push the seat from the guide towards the steering wheel.
- Disconnect fan connection
- Remove the cover above the seat by removing three fixing screws.
- Release the magnetic brake (see Chapter C).
- Remove the protective cover from the centre bolt.
- Before recovering the truck the drive wheel can be turned to the required position via the centre bolt of the steering motor by using a crank handle.

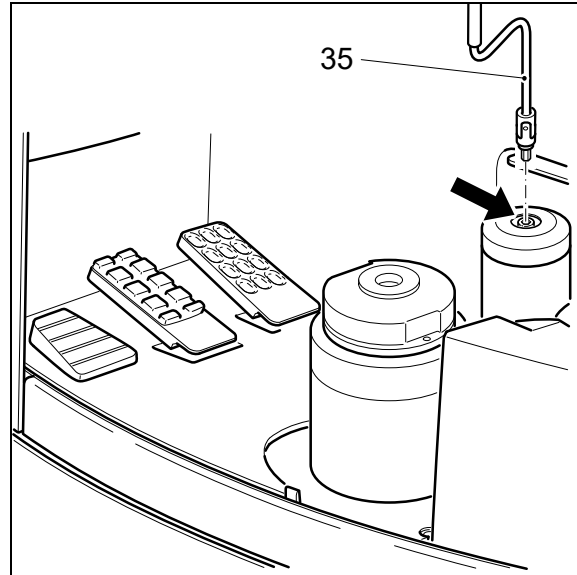

- Assemble the crank handle (35) as indicated in the tool set table.
- Fit handle to steering drive and turn the drive wheel to the desired steering position.

○ Crank Handle Tool Set (35)

Item.	Part	Order No.	Description
1	1	95 600 230	Box spanner 8 mm 1/2 " DIN 3120
2	1	95 608 130	Crank
3	1	27 636 010	Cardan joint

7 Operator Keypad (CANCODE) (○)

The keypad consists of 10 digit keys, one set key and one extra key ○□

The ○ key indicates the operational status via a red/ green LED.

It has the following functions:

- Code key function (starting the truck).

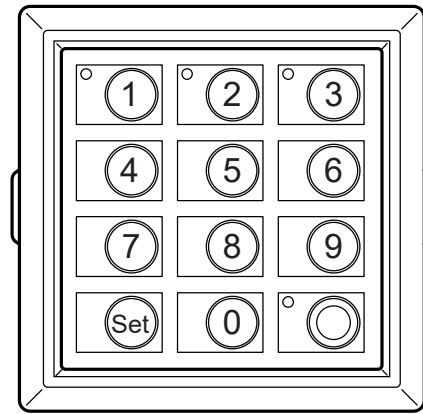

7.1 Code Key

After entering the correct code the truck is ready for use. It is possible to allocate an individual code to each truck, driver or group of drivers.



When delivered from the factory the operational codes are shown on the driver display unit and CANCODE (○) (factory setting 2-5-8-0) or for the on board computer (○) (factory setting (1-4-0-3-7) on a sticker.



When using the truck for the first time change the mast and operator code!

Working on Electrical Equipment: Any work on electrical equipment should only be undertaken by qualified electricians. Before starting work they must take all precautions necessary to prevent electrical accidents. Battery operated trucks should be made safe by removing the battery and thereby isolating the power.

Welding: In order to avoid damage to electrical and electronic components these must be removed from the truck before any welding work is carried out.

Settings: When repairs are being made or changes made to hydraulic, electric or electronic components the truck settings must be taken into consideration.

Tyres: The quality of the tyres affects the safety and driving pattern of the truck. When replacing tyres fitted at the factory, only use the manufacturer's original spare parts, otherwise the data plate details cannot be complied with. When changing wheels and tyres care should be taken to ensure that the truck does not slew (e.g. when wheel is changed there is no simultaneous left and right movement).

Lifting Chains: Non-lubricated chains will wear rapidly. Lubrication intervals shown in the check list refer to normal use. Abnormal conditions such as dust and high temperature may require more frequent lubrication. Prescribed chain sprays must be used in accordance with instructions. The external application of grease will not provide the necessary level of lubrication.

Hydraulic Hoses: All hydraulic hoses must be replaced after six years of use. If any hydraulic components are changed the hoses in that particular hydraulic system must also be changed.

Hydraulic Equipment: The mast reach damping cylinder (option) must not be opened!



The damping cylinder contains high tensioned springs. When opened up there could be serious danger if the springs are not handled correctly.

CLICK HERE TO **DOWNLOAD** THE COMPLETE MANUAL

- Thank you very much for reading the preview of the manual.
- You can download the complete manual from: www.heydownloads.com by clicking the link below



- Please note: If there is no response to CLICKING the link, please download this PDF first and then click on it.

CLICK HERE TO **DOWNLOAD** THE COMPLETE MANUAL