



# ESR 5000 SERIES MAINTENANCE MANUAL COLD STORE CABIN



Order number: 812751-006  
Revision: A • Printed in Germany

CLICK HERE TO **DOWNLOAD** THE COMPLETE MANUAL

- Thank you very much for reading the preview of the manual.
- You can download the complete manual from: [www.heydownloads.com](http://www.heydownloads.com) by clicking the link below



- Please note: If there is no response to CLICKING the link, please download this PDF first and then click on it.

CLICK HERE TO **DOWNLOAD** THE COMPLETE MANUAL

---

## Safety Notices

The following symbols will help you to assess the risk to yourself, other people and materials should you fail to comply with a safety notice:



### DANGER

***This symbol warns of immediate danger to the life and health of personnel.***

*Severe injury or death will result.*

- *Follow all instructions indicated by this symbol in order to avoid injury or death.*
- 



### WARNING

***This symbol warns of potential danger to the life and health of personnel.***

*Severe injury or death may result.*

- *Follow all instructions indicated by this symbol in order to avoid injury or death.*
- 



### CAUTION

***This symbol warns of possible danger to the health of personnel.***

*Injury may result.*

- *Follow all instructions indicated by this symbol in order to avoid injury.*
- 

---

### CAUTION

***This signal word without a symbol warns of material damage.***

*Damage to the truck, tools and mechanisms may result.*

- *Follow all instructions indicated by this signal word in order to avoid damage.*
-

## Replacing the Windows

### Important notes

#### Engineer qualifications

In order to ensure the adhesive quality and a visually appealing result you must be experienced in replacing adhesive windows. If in doubt arrange for a car bodybuilder to carry out the repair work.

#### Cure times

### CAUTION

#### **Premature load can cause the adhesive to loosen**

- *Wait for at least 1 h after gluing. The truck can then be moved carefully on level surfaces at room temperature, but no load can be placed on it yet.*
- *Allow the adhesive to cure for 24 h at room temperature and at least 50% relative air humidity. You can then start up the truck again with load or in the cold store.*

#### Approved adhesives and primers

The windows should only be glued with the following materials:

- Bostik Simson ISR70-08 adhesive
- Simson Primer M

#### Cleaning the glued surfaces and windows

**Always use isopropyl alcohol** as a general cleaning agent and for non-cured adhesive residue. Residue from other cleaning agents can considerably reduce the window adhesion.

**Do not use compressed air.** Compressed air can contain oil mist. Oil severely reduces adhesion.

#### Ambient conditions for repair work

The adhesive used must be applied in ambient temperatures of +5°C to +35°C.

Bostik Simson ISR70-08 is SMP based and cures through air humidity.

The application temperature can be +5°C to +35°C. We recommend approx. 20°C. Anything above that reduces the cure time significantly.

**Note:** Remove the truck from the cold store with plenty of time before the repair work to allow it to adapt to the ambient temperature.

## Safety Notices



### WARNING

#### Health risk

- *Observe the manufacturer's safety instructions when handling solvents and lubricants.*

### Tools required

In addition to the usual tools the following tools are essential:

- Special tool to cut out glued car windows (draw knife, draw wire or electrical device).
- Two or more rubber extractors of sufficient size to handle the window securely.

### Removing damaged windows

#### Securing the truck

1. Switch off the truck, disconnect the battery and prevent the truck from being switched on again.

#### Masking off the surrounding surfaces

2. Mask off the chassis areas next to the adhesive to avoid damaging the surface when the window is cut out.
3. Disconnect the window heater connecting cable and fix it to the window.

#### Cutting out the window



### WARNING

#### **Unsuitable tools can cause severe cuts and stab wounds**

*Standard knives can break or slip when the window is being cut out, causing severe cuts or stab wounds.*

- *Use the designated special tool to remove the window.*

4. Cut out the window with the special tool. Obtain the help of an assistant to secure the window with the rubber extractors to prevent it from falling out.

**Note:** It is important to leave a layer of the old adhesive on the frame (approx. 50 % of the original thickness). The new adhesive sticks perfectly to the old adhesive.

5. Lift out the defective window with the rubber extractors and dispose of it.

**Work light connections**

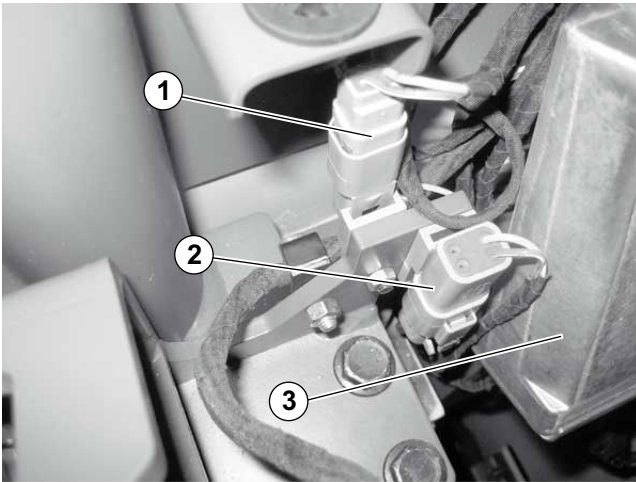

Fig. 13 Work light connections

1	JC 473
2	JC 433
3	Main control module VCM (Access 4)

**Interface bracket connections**

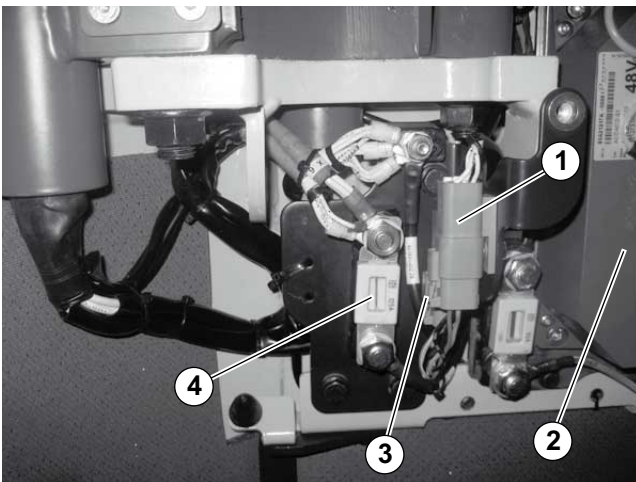

Fig. 14 Interface bracket connections

1	PC 445
2	Steering control module SCM (Access 5)
3	PC 405 (strobe)
4	Main fuse FU9 (cold store cab)

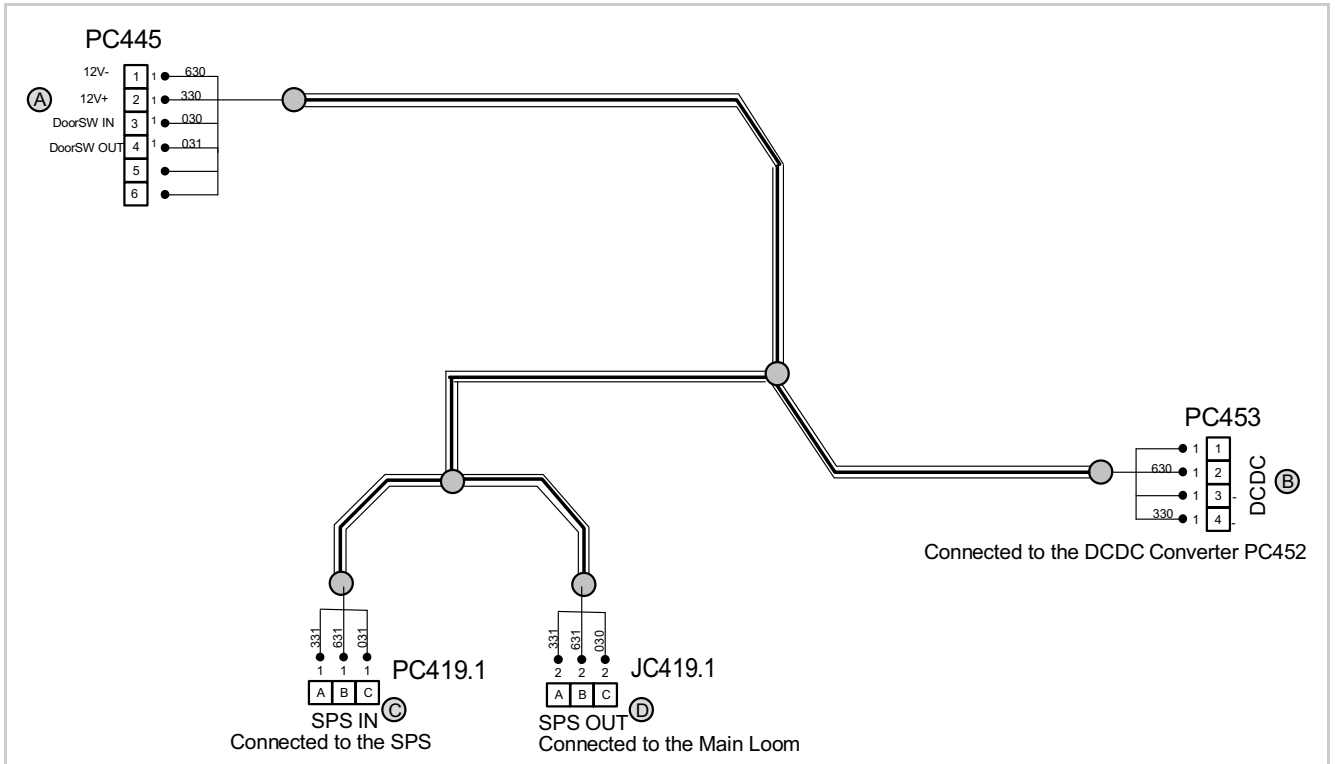

Fig. 25 Cabin connection harness

**Plug connector housing**

Model	Housing	Part No.	Description
A	PC 445	792881-004	Housing
B	PC 453	792881-003	Housing
C	PC 419.1	792881-002	Housing
D	JC 419.1	792880-002	Housing

**Replacement Parts**

Part No.	Description
824673	Harness, complete

**Contact pins**

Model	Part No.	Total
1	792883	4
1	792883	2
1	792883	3
2	792882	3



# ESR 5000 SERIES

## Cold Store Cabin

### PARTS MANUAL



Order Number: 812751-006  
Revision: A • Printed in Germany

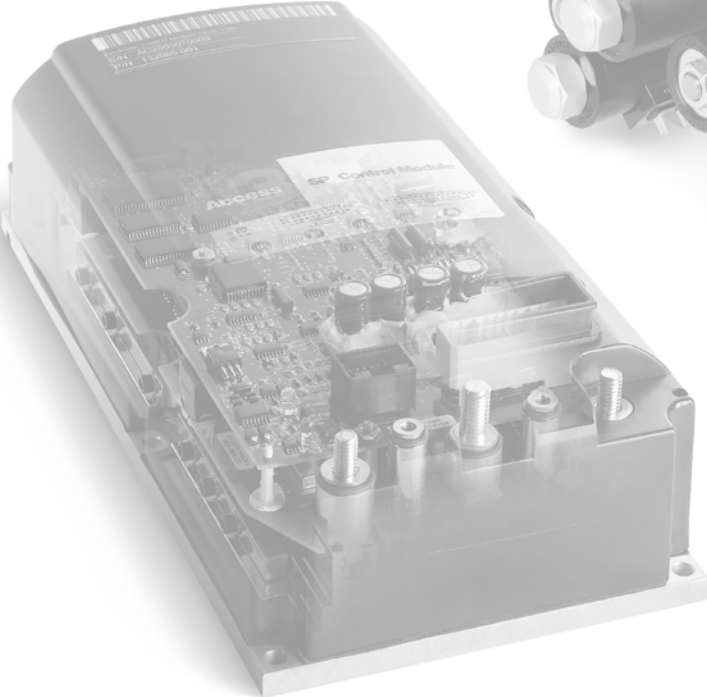
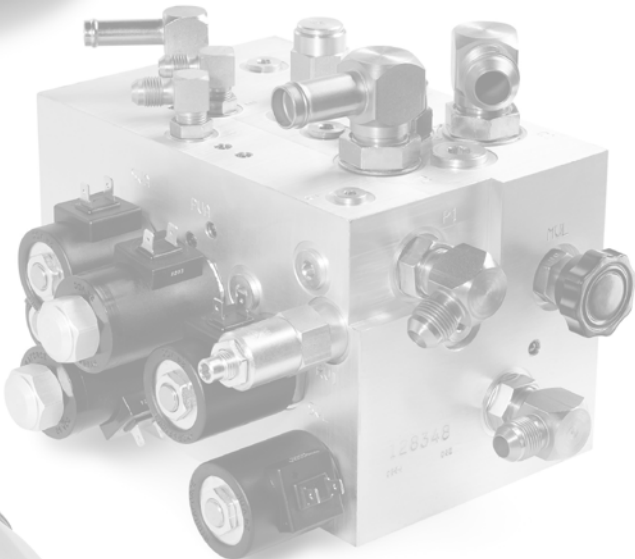

# **COVERS**

---

INDEX	PART NUMBER	PART NAME	NUMBER REQUIRED
1	050078-008	Blind Rivet Nut	17
2	050009-013	Washer	2
3	050005-080	Screw	6
4	824305	Cover	1
5	050006-035	Screw	5
6	050009-018	Washer	5
7	821635-014	Power Cable (B-)	1
8	821635-013	Power Cable (B+)	1
9	824862-001	Hydraulic Module	1
10	050071-037	Screw	2
11	821635-008	Power Cable (W)	1
12	821635-007	Power Cable (V)	1
13	821635-006	Power Cable (U)	1
14	050009-012	Washer	11
15	050006-024	Screw	4
16	050005-060	Screw	3
17	793364-003	Harness Clamp	1
18	050008-014	Nut	1
19	050068-002	Nut	1
20	820804	Cable Clamp	1
21	820805	Bracket	1
22	812318	Bushing	1
23	050008-008	Nut	1
24	793288	Retainer	1
25	050003-014	Screw	1
26	819912	Bracket	1
27	050008-001	Nut	4
28	790555	Cable Clamp	1
29	819501-100	Fan	1
30	050005-112	Screw	4
31	050067-012	Screw	2
32	050005-062	Screw	3
33	821741-001	Control Module	1
34	821273-001	Steering Control Module	1
35	050006-023	Screw	5
36	806720-002	Fuse	1
37	050005-054	Screw	2
38	821377	Fuse Holder	1
39	050078-006	Blind Rivet Nut	2
40	050078-001	Blind Rivet Nut	1

**Always Specify Model, Data & Serial Number**

INDEX	PART NUMBER	PART NAME	NUMBER REQUIRED
1	826220	Filter	1
2	050003-015	Screw	1
3	826224	Bracket (Filter)	1
4	826174	Thermal Switch	3
5	826215	Heat Shield	1
6	826170	Bracket	4
7	826169	Heater	2
8	826210	Housing	1
9	050009-002	Washer	8
10	050008-002	Nut	8
11	826216	Bracket	1
12	826214	Bushing	4
13	050006-026	Screw	4
14	826213	Washer	10
15	826212	Rubber Socket	4
16	050007-018	Screw	8
17	050009-004	Washer	8
18	826211	Blind Rivet Nut	8
19	826168	Fan	2
	826279	Connector Housing	2
	826281	Connector	4
	826280	Seal	4
20	050006-024	Screw	3
21	826173	Housing	2
22	826172	Duct	2
23	826171	Foam	3
24	050006-023	Screw	7
25	050009-012	Washer	7
26	826176	Housing	1
27	826175	Rubber Socket	4

**Always Specify Model, Data & Serial Number**

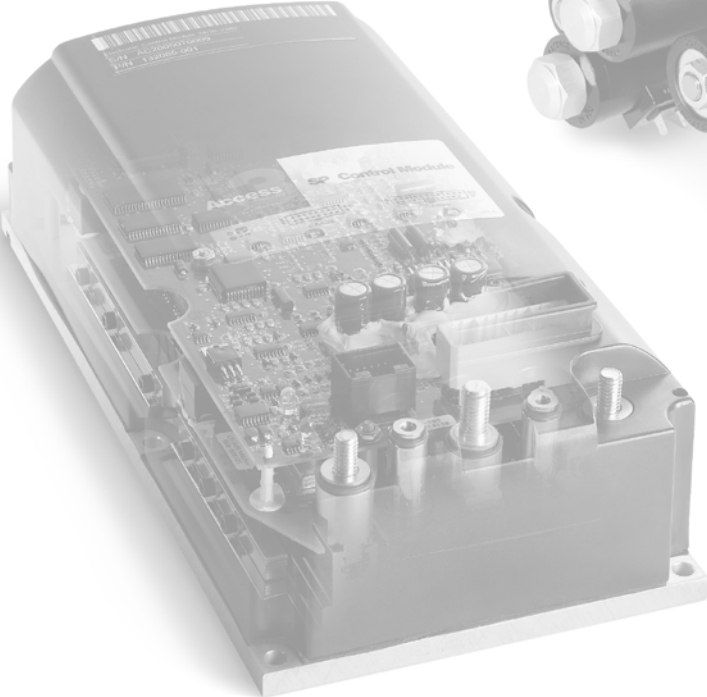
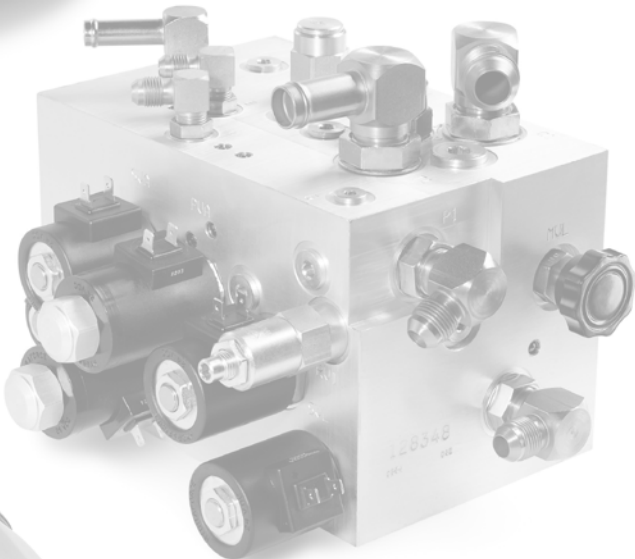

# ***PLATFORM***



CLICK HERE TO **DOWNLOAD** THE COMPLETE MANUAL

- Thank you very much for reading the preview of the manual.
- You can download the complete manual from: [www.heydownloads.com](http://www.heydownloads.com) by clicking the link below



- Please note: If there is no response to CLICKING the link, please download this PDF first and then click on it.

CLICK HERE TO **DOWNLOAD** THE COMPLETE MANUAL