



INSTALLATION INSTRUCTIONS

**KG0LP445-00
QUICK COUPLER LINE KIT (BOOM LINE)**

APPROXIMATE INSTALLATION TIME: 8.0 hours

CLICK HERE TO **DOWNLOAD** THE COMPLETE MANUAL

- Thank you very much for reading the preview of the manual.
- You can download the complete manual from: www.heydownloads.com by clicking the link below



- Please note: If there is no response to CLICKING the link, please download this PDF first and then click on it.

CLICK HERE TO **DOWNLOAD** THE COMPLETE MANUAL

6. Install the seating (boom top QC) (4) with two sems bolts (9).
 Install the two screw caps (10) on the seating (boom top QC) (4).
 Fasten the line assembly (left) (12) and line assembly (right) (14) with the pipe clamp (16) and sems bolt (8).

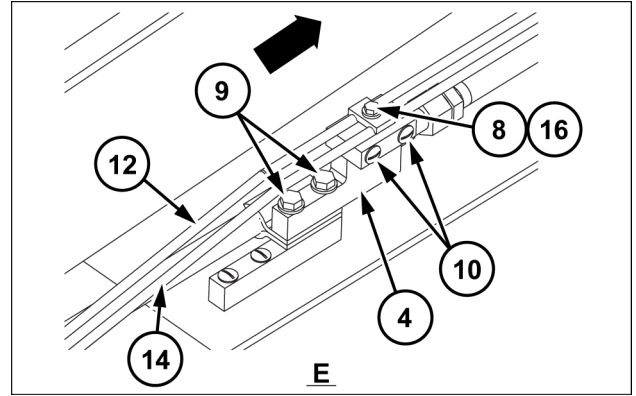

SMIL15CEXY311AB 7

7. Sandwich the line assembly (left) (12) with the seating (stopper BU QC) (1) and pipe clamp (15), and then fasten with the sems bolt (22).

- Fasten the seating (stopper BU QC) (1) at a position about **650 mm (25.591 in)** from the pipe clamp (16) in diagram E.

Fasten the line assembly (left) (12) and line assembly (right) (14) with two pipe clamps (16), one high-strength bolt (21), one high-strength washer (23), and one nut (7).

- Fasten the pipe clamps (16) at a position about **50 mm (1.969 in)** from the seating (stopper BU QC) (1).

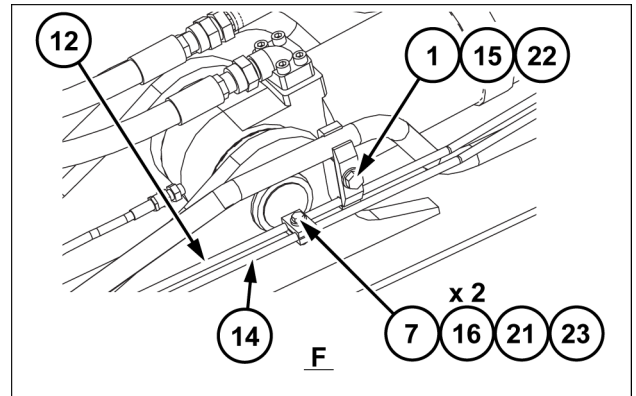

SMIL15CEXY312AB 8

8. Install the pipe clamp (17) and seating (boom top QC) (4) with two sems bolts (9).

Install the two screw caps (10) on the seating (boom top QC) (4).

Fasten the line assembly (left) (12) and line assembly (right) (14) with the pipe clamp (16) and sems bolt (8).

- Fasten the pipe clamp (16) in diagram G at a position about **550 mm (21.654 in)** from the pipe clamp (16) in diagram E.

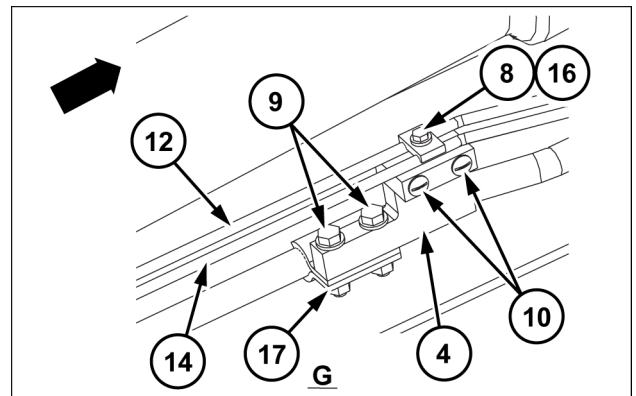

SMIL15CEXY313AB 9

9. Install the seating (boom top QC) (6) with two sems bolts (9).

Install the two screw caps (10) on the seating (boom top QC) (6).

Install the two body unions (19) and two plugs (24) on the front ends of the line assembly (left) (12) and line assembly (right) (14).

Fasten the line assembly (left) (12) and line assembly (right) (14) with the pipe clamp (16) and sems bolt (8).

- Fasten the pipe clamp (16) at a position about **100 mm (3.937 in)** from the front ends of the body unions (19).

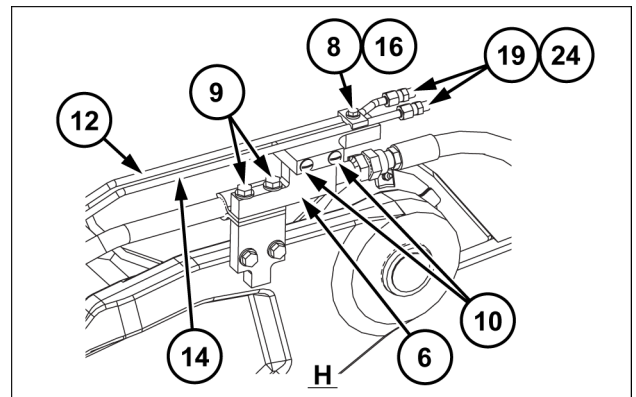

SMIL15CEXY314AB 10

2 - VORMONTAGE

VORBEREITUNG ZUR MONTAGE

Vorbereitung

Ein „*“ in diesem Dokument weist darauf hin, dass das Teil an der vorliegenden Maschine verbaut ist.

Vorzubereitende Elemente:

- Schraubenschlüssel (**13 mm, 19 mm**)
- Ringschlüssel (**13 mm, 19 mm**)
- Sechskantschlüssel (**12 mm**)
- Hebekran
- Schweißgerät
- Lappen

1. Bringen Sie die Haupteinheit in Position.

- Die Haupteinheit auf einem festen und flachen Untergrund abstellen, den Löffelzylinder bis zum Anschlag ausfahren, den Pendelarmzylinder bis zum Anschlag ausfahren, den Ausleger senken und mit dem Pendelarmoberteil den Boden berühren.

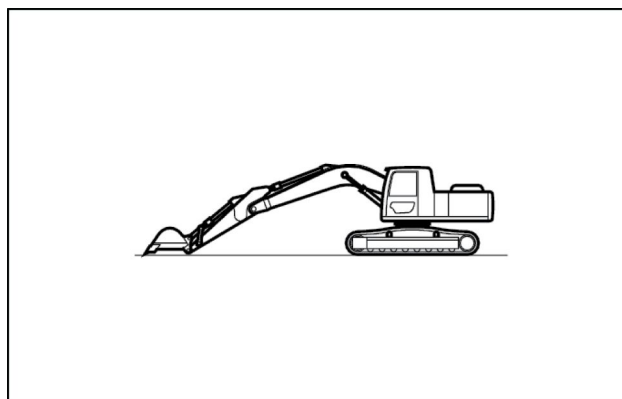

SMIL13II00106AA 1

2. Schalten Sie den Zündschlüssel auf „OFF“ (AUS) (**a**), vergewissern Sie sich, dass der Motor gestoppt ist, und schalten Sie dann den Zündschlüssel wieder auf „ON“ (EIN). (Den Motor nicht starten.)

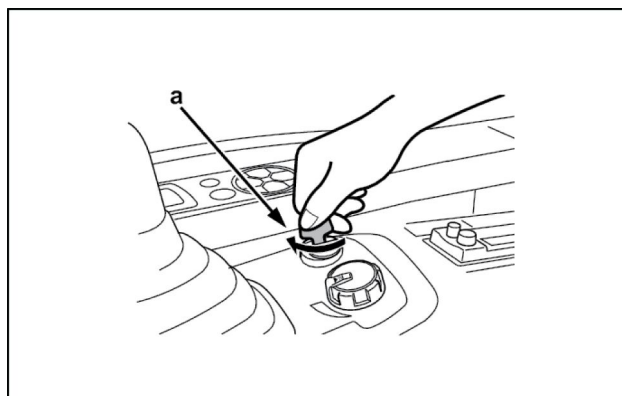

SMIL13II00107AA 2

Sommaire

1 CONTENU DU KIT	
Contenu du kit	1-1
2 AVANT-ASSEMBLAGE	
PREPARATION POUR L'ASSEMBLAGE	
Préparation	2-1
3 ASSEMBLAGE	
CONDUITE POUR RACCORD RAPIDE (CONDUITE DE FLECHE)	
Pose des conduites de flèche	3-1

Index

	C	
Contenu du kit		1-1
	P	
Pose des conduites de flèche		3-1
Préparation		2-1

3 - MONTAGGIO

TUBAZIONE ATTACCO RAPIDO (TUBAZIONE AVAMBRACCIO)

Montaggio della tubazione del braccio

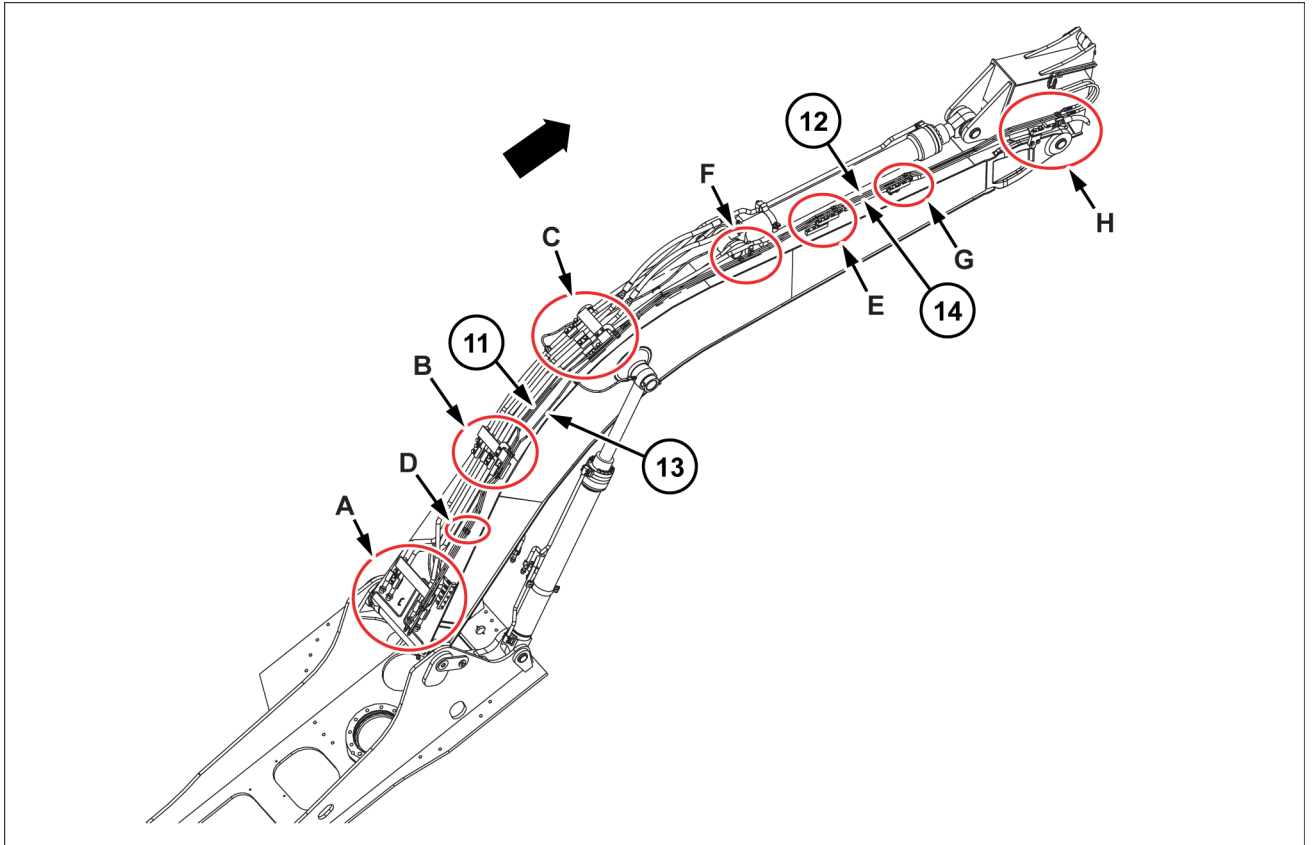

SMIL15CEXY305FB 1

NOTA: Applicare **LOCTITE® (20)** alla sezione filettata dei bulloni di tipo Sems e dei bullone ad alta resistenza.

1. Utilizzare una gru o un attrezzatura simile, per posizionare il complessivo tubazione (lato sinistro) **(11)** e il complessivo tubazione (lato destro) **(13)** sul braccio.

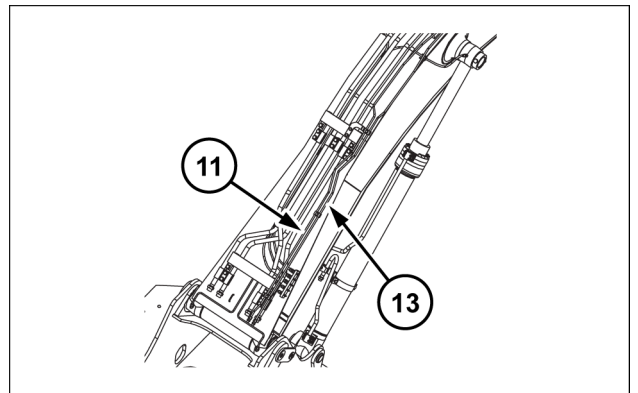

SMIL15CEXY306AB 2

1 - CONTENIDO DEL KIT

Contenido del kit

NOTA: consulte el manual de piezas para los pedidos.

Conducto de la pluma (consulte 3-1)

Elemento	Descripción	Cantidad	Referencia
1	Asiento (tope unión BU - acoplador rápido)	1	KRV46000
2	Asiento (centro de la pluma - acoplador rápido)	2	KHV13670
3	Asiento (centro de la pluma - acoplador rápido)	2	KNV29440
4	Asiento (tope de la pluma - acoplador rápido)	2	KBV38650
5	Asiento (base de la pluma - acoplador rápido)	1	KBV39430
6	Asiento (tope de la pluma - acoplador rápido)	1	KBV40860
7	Tuerca M8	2	162R008SR
8	Perno SEMS M8 x 25	9	105R008Y025R
9	Perno SEMS M12 x 60	12	105R012Y060R
10	Tapa de tornillo	6	KHV12270
11	Conjunto de conductos (izquierdo)	1	KLV16290
12	Conjunto de conductos (izquierdo)	1	KLV16640
13	Conjunto de conductos (derecho)	1	KLV16300
14	Conjunto de conductos (derecho)	1	KLV16650
15	Abrazadera	1	KRV46010
16	Abrazadera	10	KHV13660
17	Abrazadera	1	KHV11640
18	Unión	2	KMJ0602
19	Unión	4	KMJ0708
20	LOCTITE®	1	KRC5007
21	Perno de alta resistencia M8 x 35	5	102R008Y035R
22	Perno de alta resistencia M12 x 30	1	105R012Y030R
23	Arandela de alta resistencia M8	5	KAJ1500
24	Tapón G1/4	2	KHJ0632
25	Asiento (base de la pluma - acoplador rápido)	1	KLV16390

CLICK HERE TO **DOWNLOAD** THE COMPLETE MANUAL

- Thank you very much for reading the preview of the manual.
- You can download the complete manual from: www.heydownloads.com by clicking the link below



- Please note: If there is no response to CLICKING the link, please download this PDF first and then click on it.

CLICK HERE TO **DOWNLOAD** THE COMPLETE MANUAL