



INSTALLATION INSTRUCTIONS

51511422

JOYSTICK STEERING KIT WITH SECONDARY ELECTRICAL STEERING

APPROXIMATE INSTALLATION TIME: 4.0 hours

CLICK HERE TO **DOWNLOAD** THE COMPLETE MANUAL

- Thank you very much for reading the preview of the manual.
- You can download the complete manual from: www.heydownloads.com by clicking the link below



- Please note: If there is no response to CLICKING the link, please download this PDF first and then click on it.

CLICK HERE TO **DOWNLOAD** THE COMPLETE MANUAL

5 - ASSEMBLY

Install

Joystick steering

1. Install the straight connector (20) on the LS port of the steering EHPS valve (2).
2. Install the 90° elbow (6) on the T port of the steering EHPS valve (2).
3. Install the 90° elbow (7) on the P port of the steering EHPS valve (2).
4. Install the 90° long elbow (45) on the PS port of the steering EHPS valve (2).

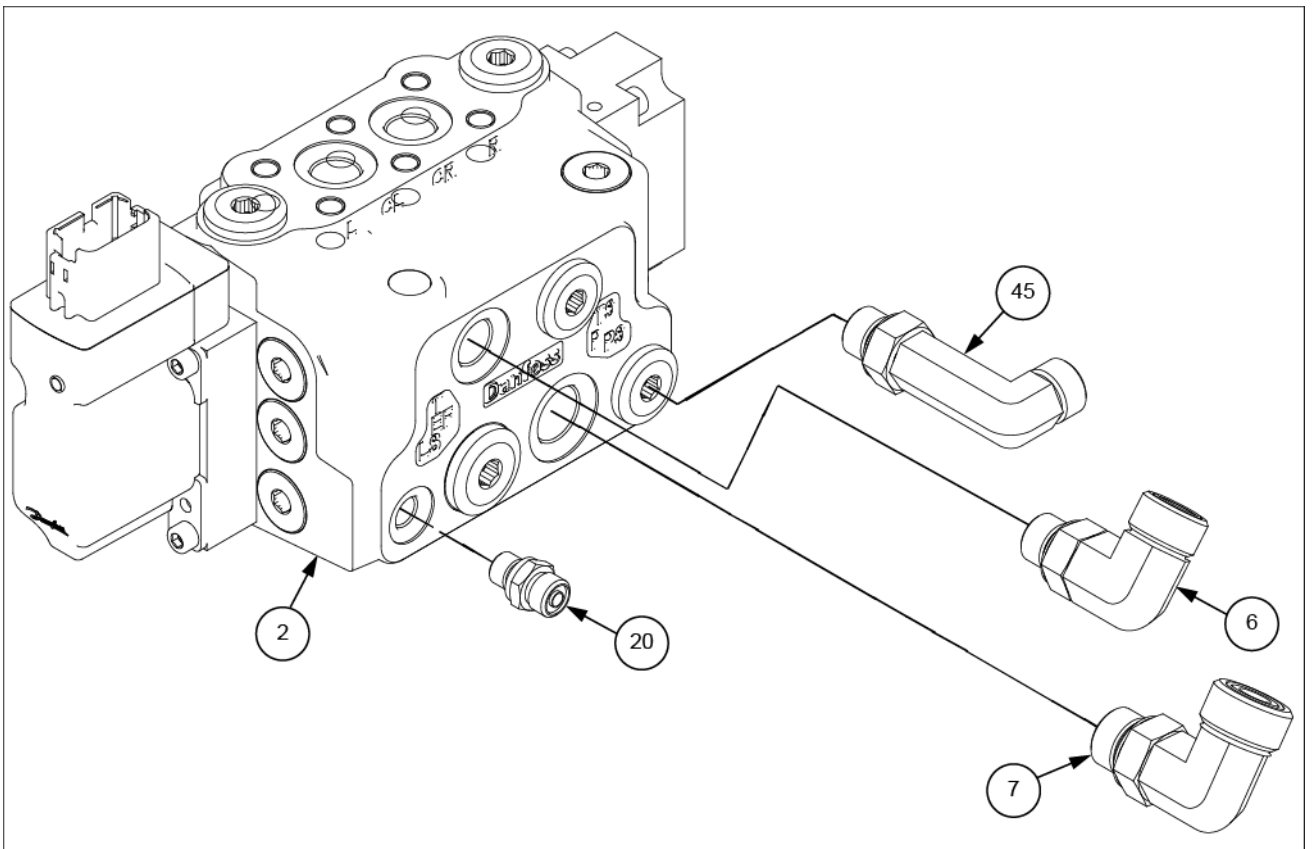

LEIL19WHL0739FB 1

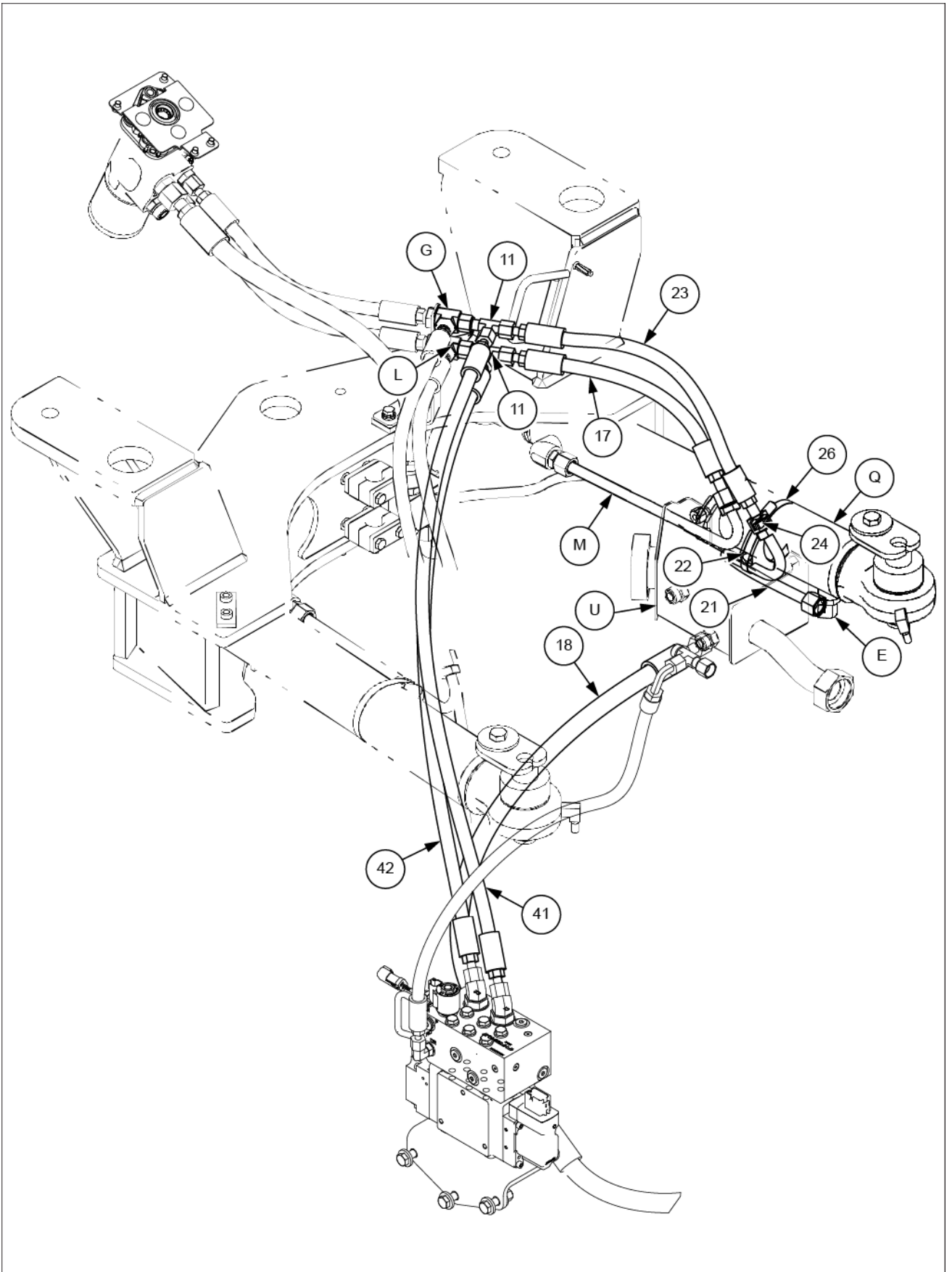

LEIL19WHL0748HB 10

6 - POST-ASSEMBLY

INSTRUCTIONS

Machine configuration

NOTE: kit installation requires to update the factory software of machine with the Electronic Service Tool (EST), with the latest software versions suitable for the machine configuration, and to configure it as reported into "Machine configuration".

NOTE: carefully read the SAFETY INFORMATION before proceeding with the "Machine configuration".

1. Locate in the cab the Diagnostic Connector , remove the plug and connect the adapter DPA5 and the EST (Electronic Service Tool)

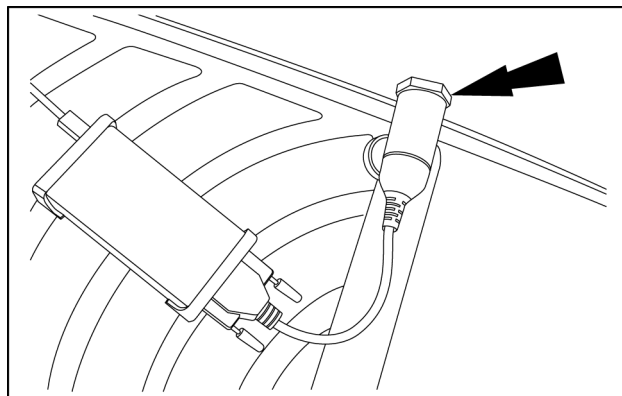

LEIL17WHL0442AB 1

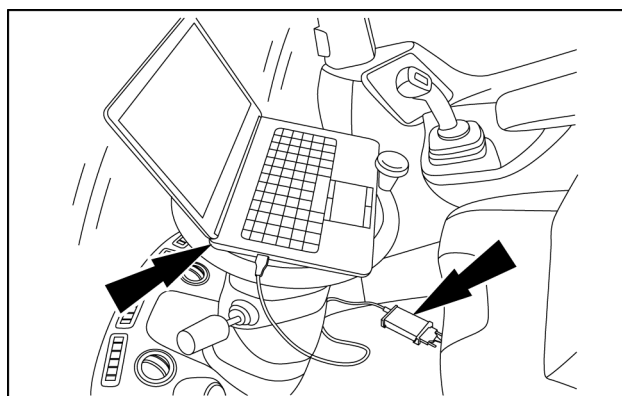

LEIL17WHL0436AB 2

2. Turn the key switch to "ON" position and start the EST.

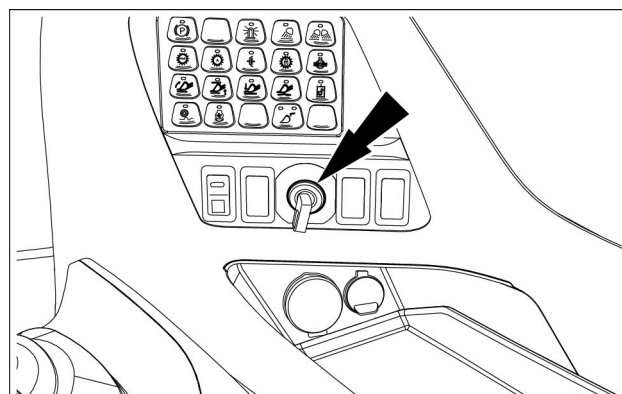

LEIL16WHL1281AB 3

3. Débrancher le flexible de pression (**L**) du connecteur (**C1**) posé sur l'orifice « ST » de la vanne de direction auxiliaire (**X**).
4. Débrancher et déposer le flexible de détection de charge (**D**) du connecteur (**C**) posé entre l'orifice « LS ST » sur la vanne de priorité (**V**) et le coude à 45° (**E**) installé sur l'orifice « LS » de la vanne de direction auxiliaire (**X**).

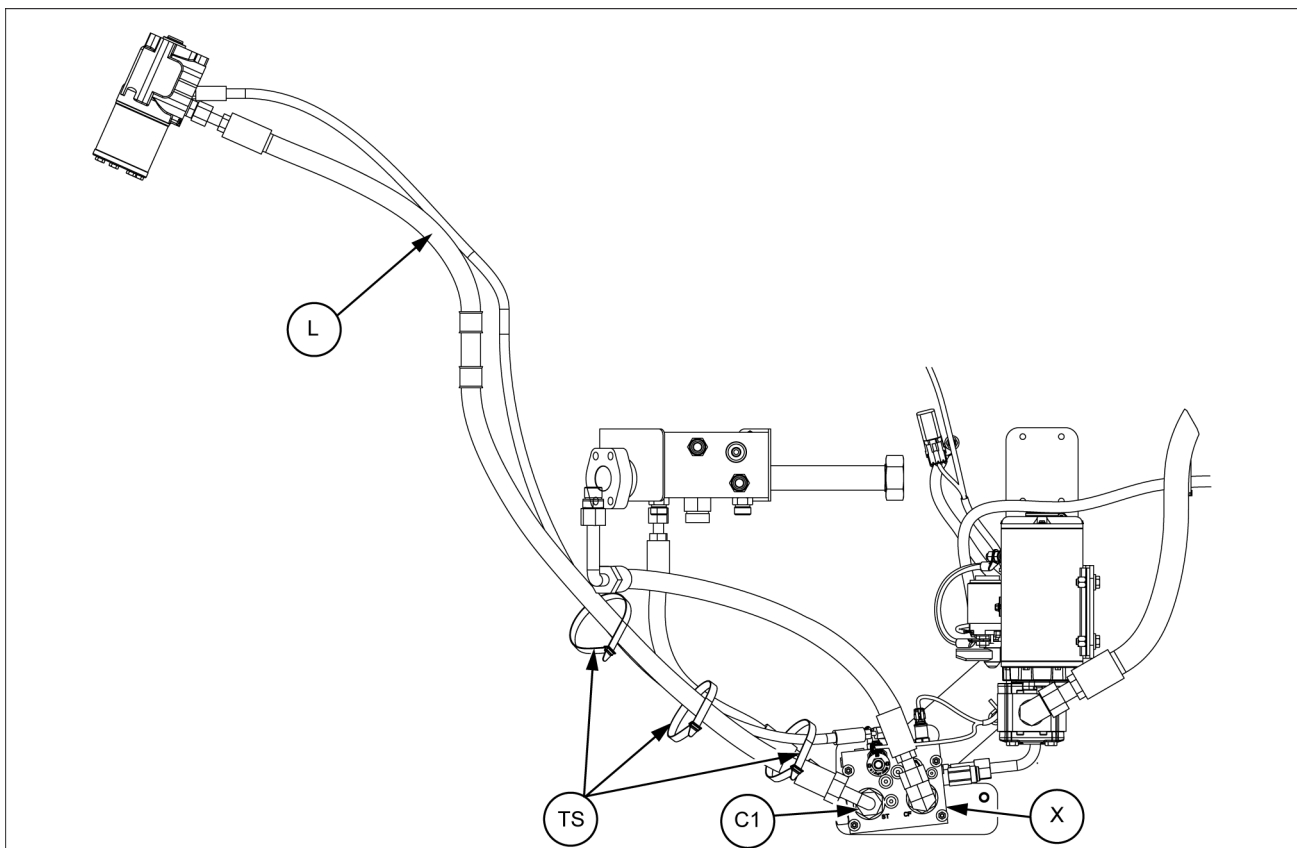

LEIL17WHL0447FB 3

5. Localiser la zone du vérin de direction de droite et déposer le collier de serrage du flexible (**H**) et le bloc (**G**).
6. Débrancher et déposer le flexible (**A**) du raccord en T (**T1**) et puis déposer le tuyau de tête (**I**) et le joint torique (**R**) du vérin de direction de droite (**RH**).
7. Débrancher et déposer le flexible (**B**) le raccord en T (**T2**) puis du tube cylindrique droit (**Z**).
8. Jeter les flexibles (**A**) et (**B**), le tuyau (**I**), le collier du flexible (**H**), le bloc (**G**), et le joint torique (**R**).
9. Sous le compartiment de la cabine, desserrer et déposer les quatre écrous de fixation et dégager la vanne orbitrol (**S**) de l'arbre de direction (**SC**).
10. Déposer les quatre boulons (**Q**), les rondelles de blocage (**P**), les douilles de montage en acier (**O**), et les douilles en caoutchouc (**N**) pour détacher le support (**BR**) de la vanne orbitrol (**S**).

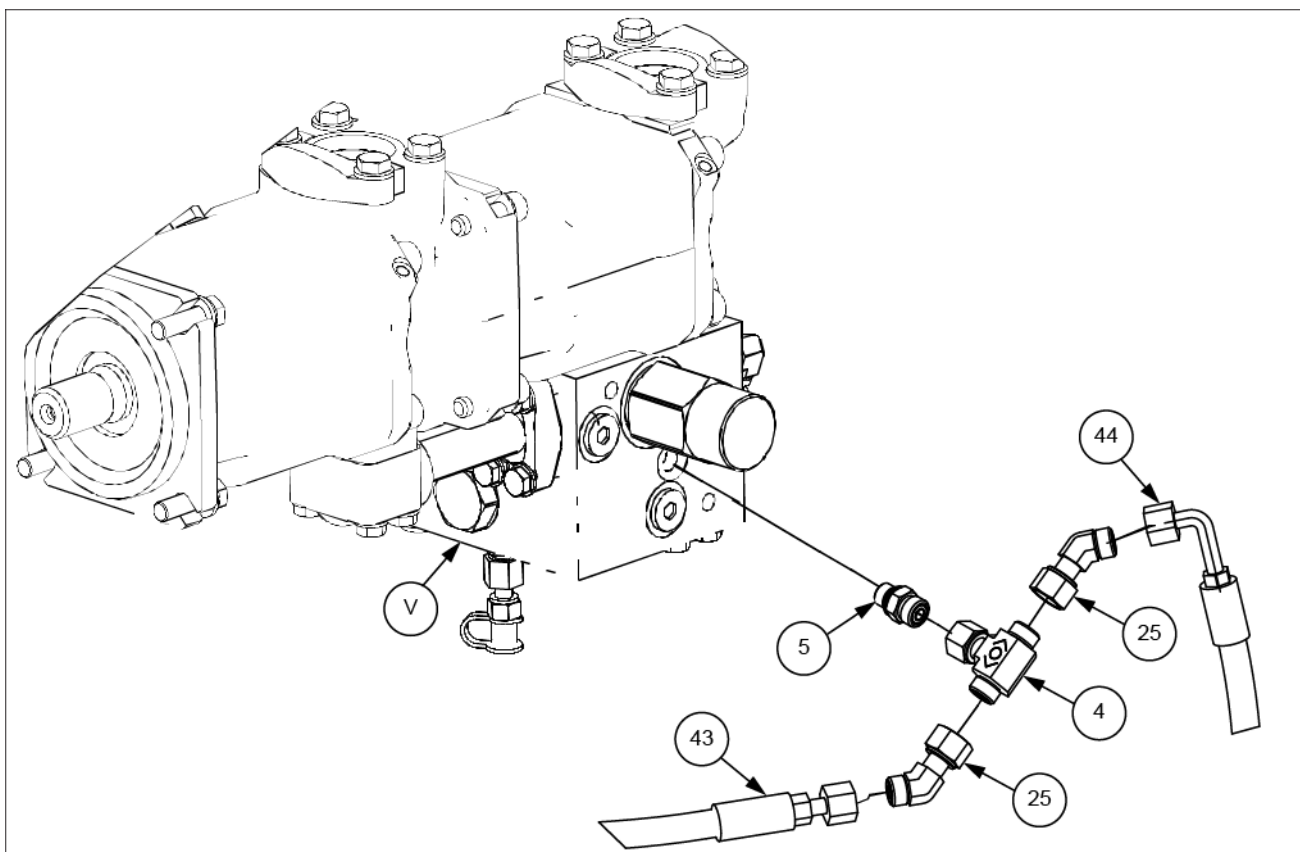

LEIL19WHL0746FB 8

Installation du faisceau de la manette de direction

1. Faire passer le faisceau (50) à travers l'ouverture entre la cabine et le châssis arrière, et le placer le long de la ligne de direction hydraulique.

Brancher les connecteurs du faisceau comme suit :

- (COV1) sur la soupape de coupure JSS (37) ;
- (JSS_CO_1) sur le côté droit de la soupape de coupure JSS (37) ;
- (Y-JSV) sur la soupape de direction (2) ;
- Fixer le connecteur R-TERM3 au faisceau à l'aide de l'attache de câbles (51) comme illustré.

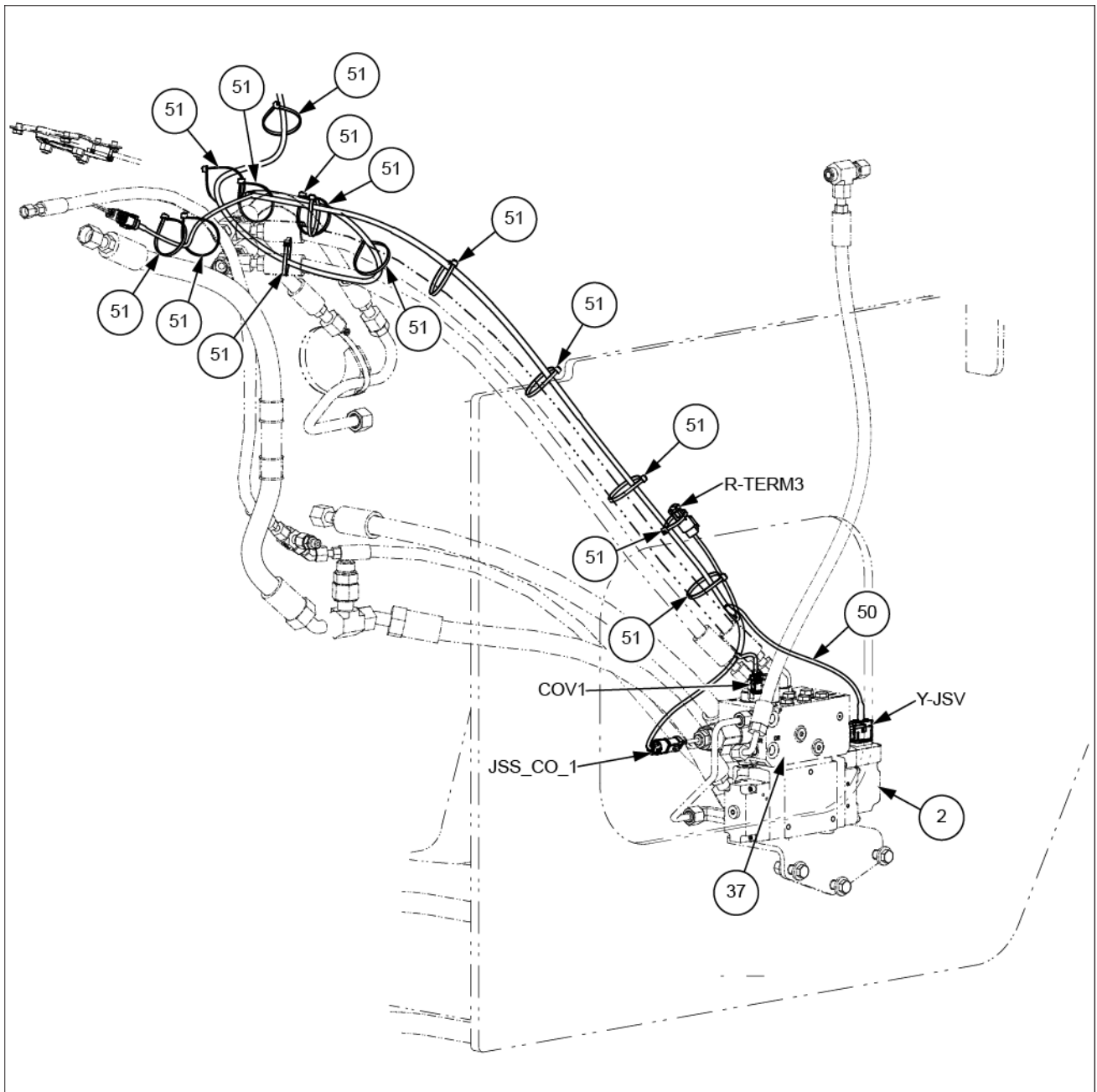

LEIL19WHL0752GB 18

9. Sélectionner « Configuration ».

CONTROLLER	HARDWARE VERSION	SOFTWARE VERSION	COMMUNICATION STATUS
ECM Engine Control Module			ON LINE
GDSP Color Display Module	5.1.0.0	1.3.0.0	ON LINE
KEYPD Key Pad	48.49.255.255	01.00.00.00	ON LINE
SFB Smart Fuse Box	1.0.0.1	1.0.0.0	ON LINE
TECM Transmission Controller			ON LINE
UCM Universal Control Module	2.0.0.0	1.0.0.0	ON LINE

LEIL17WHL0431FB 10

2 - SATZINHALT

Übersicht Montagesatz

HINWEIS: Die Teilenummern der Artikel in diesem Satz können dem Teilekatalog entnommen werden.

HINWEIS: in der folgenden Tabelle sind die Teile aufgeführt und wie in der Montageanleitung nummeriert.

Pos.	Beschreibung	Menge
2	Lenkventil EHPS	1
3	JSS Ventilhalterung	1
4	Hydraulisches T-Wechselventil	1
5	Gerader Steckverbinder	2
6	90°-Winkelstück	1
7	90°-Winkelstück	1
8	Mutter M10	3
9	Unterlegscheibe 9x21x2.5	3
10	Schraube M8x20	3
11	T-Stück	3
12	T-Stück	1
13	Ansaugventilschlauch 923 mm (36.3 in)	1
14	Unterlegscheibe 13.5x28x4	6
15	Mutter M12	3
16	Schraube M12x50	3
17	Stabschlauch rechts 435 mm (17.1 in)	1
18	Tankschlauch 894 mm (35.2 in)	1
19	Lenkwinkelsensor	1
20	Gerader Steckverbinder	1
21	Lenkzylinder rechtes Steuerrohr 36.2 mm (1.4 in)	1
22	Klemmblock	1
23	Basisschlauch rechts 545 mm (21.4 in)	1
24	O-Ring	1
25	45°-Winkelstück	2
26	Schlauchklemme	1
27	JSS-Sensorhalterung	1
28	Unterlegscheibe 9x16x1.6	4
29	Schraube M8x10	4
30	Milsco Armlehne	1
31	Unterlegscheibe 10.6x25x6	2
32	Schraube	4
33	Grammer Halterung Armstütze	1
34	Unterlegscheibe 9x16x1.6	3
35	Schraube M8x20	3
36	Sicherung 5 A	1
37	JSS Absperrventil	1
38	45°-Winkelstück	2
39	Unterlegscheibe 11x21x2.5	6
40	Schraube M10x105	6
41	Zylinderschlauch 1128 mm (44.4 in)	1
42	Zylinderschlauch 1054 mm (41.5 in)	1
43	LS Lenkschlauch 855 mm (33.7 in)	1
44	LS Lenkschlauch 810 mm (31.9 in)	1
45	90°-Winkelstück	1
46	Hydraulikleitung Joysticklenkung 203.1 mm (8 in)	1
47	Stopfen	2
48	90°-Winkelstück	1
49	Schlauch zwischen Absperrventil und Tank 965 mm (38 in)	1

CLICK HERE TO **DOWNLOAD** THE COMPLETE MANUAL

- Thank you very much for reading the preview of the manual.
- You can download the complete manual from: www.heydownloads.com by clicking the link below



- Please note: If there is no response to CLICKING the link, please download this PDF first and then click on it.

CLICK HERE TO **DOWNLOAD** THE COMPLETE MANUAL

10. Montieren Sie den LS-Hydraulikschlauch (43) der Joysticklenkung an dem geraden Verbinder (20).
11. Montieren Sie den Absaugventilschlauch (13) am 90°-Winkelstück (7).
12. Montieren Sie den Hydraulikschlauch (18) des Behälters am 90°-Winkelstück (6).
13. Montieren Sie die Hydraulikleitung der Joysticklenkung (46) an dem langen 90°-Winkelstück (45).
14. Montieren Sie den Hydraulikschlauch des Zylinders (42) am 45°-Winkelstück (38).
15. Montieren Sie den Hydraulikschlauch des Zylinders (41) am 45°-Winkelstück (38).

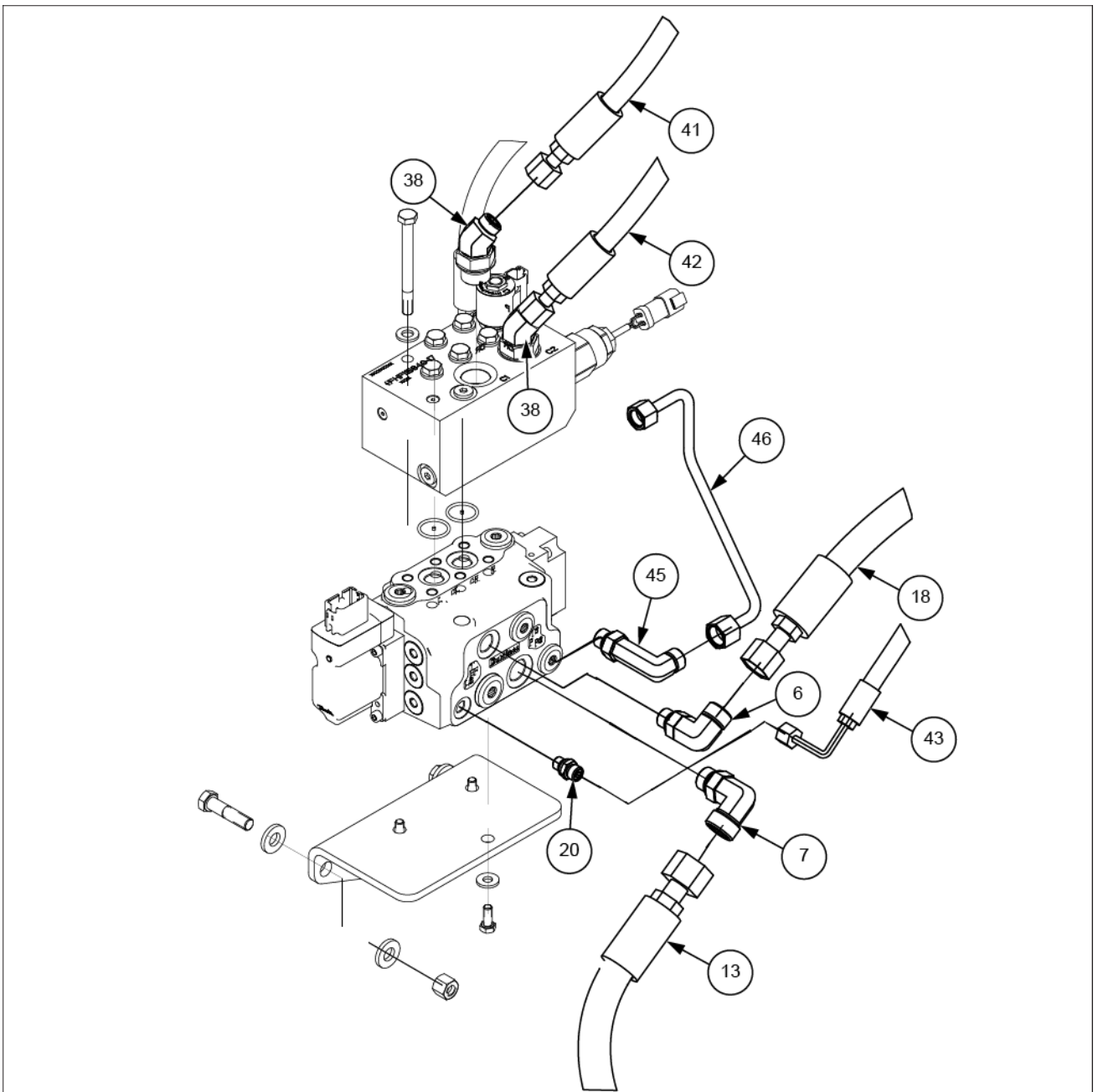

LEIL19WHL0742GB 4

38. Den geraden Steckverbinder **(5)** am JSS-Absperrventil **(37)** anbringen.
39. Montieren Sie das Rohr **(46)** der Joysticklenkung an dem geraden Steckverbinder **(5)**.
40. Das **90°**-Winkelstück **(48)** an den Anschluss DR des JSS-Abschaltventils **(37)** montieren.
41. Montieren Sie das T-Stück **(11)** auf dem Kühlrahmen **(R)**.
42. Montieren Sie den Rücklauf-Hydraulikschlauch zwischen Bremse und Tank **(V)** am T-Stück **(11)**.
43. Montieren Sie den Hydraulikschlauch zwischen Absperrventil und Tank **(49)** am **90°**-Winkelstück **(48)** und am T-Stück **(11)**.
44. Montieren Sie die Stopfen **(47)** an dem JSS-Abschaltventil **(37)**.

4. Das Hauptsteuergerät und das Sicherheitssteuergerät sollen On Line sein.
Wählen Sie das Konfigurationssymbol.

Electronic Service Tool - Case - Wheel Loaders (Models 512G, 621G, 721G, 821G, 921G, 1021G, 1121G) (Tier 4B / Tier 2)

File Tool View Communications Options Utilities Window Help

CONT... Configuration
STATUS - CAN Diagnostic Connector - Steering

CONTROLLER	SOFTWARE VERSION	COMMUNICATION STATUS
JOY Primary Implement Joystick		ON LINE
MC Main Controller	APP_CLS_M_R197_SEHS ----_11153340_-B04	ON LINE
SASA Steering Wheel Sensor		ON LINE
SC Safety Controller	APP_CLS_S_R197_SEHS ----_11153341_-B04	ON LINE

RETRIEVE VERSION INFORMATION FOR THE SELECTED CONTROLLER

RETRIEVE VERSION INFORMATION FROM ALL CONTROLLERS

Activate Configuration Window

CAN 2 Comm Link Up 11:13:10 AM



ISTRUZIONI DI INSTALLAZIONE

51511422

KIT STERZO A JOYSTICK CON STERZO ELETTRICO SECONDARIO

TEMPO DI MONTAGGIO APPROSSIMATIVO: 4.0 ore

5 - MONTAGGIO

Montaggio

Sterzo a joystick

1. Montare il connettore dritto (20) sull'attacco LS della valvola EHPS di sterzo (2).
2. Montare il gomito a 90° (6) sull'ingresso T della valvola EHPS di sterzo (2).
3. Montare il gomito a 90° (7) sull'ingresso P della valvola EHPS di sterzo (2).
4. Montare il gomito lungo a 90° (45) sull'ingresso PS della valvola EHPS di sterzo (2).

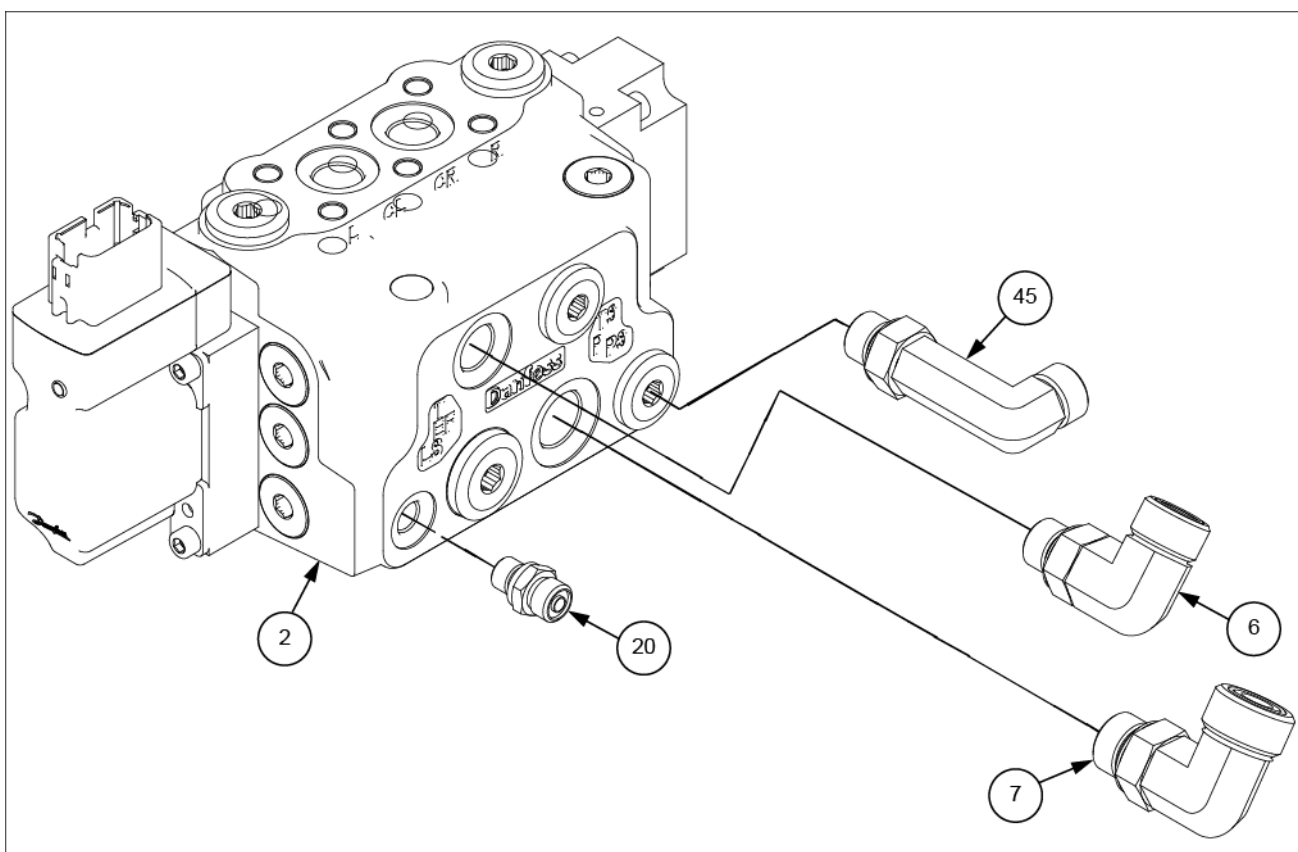

LEIL19WHL0739FB 1

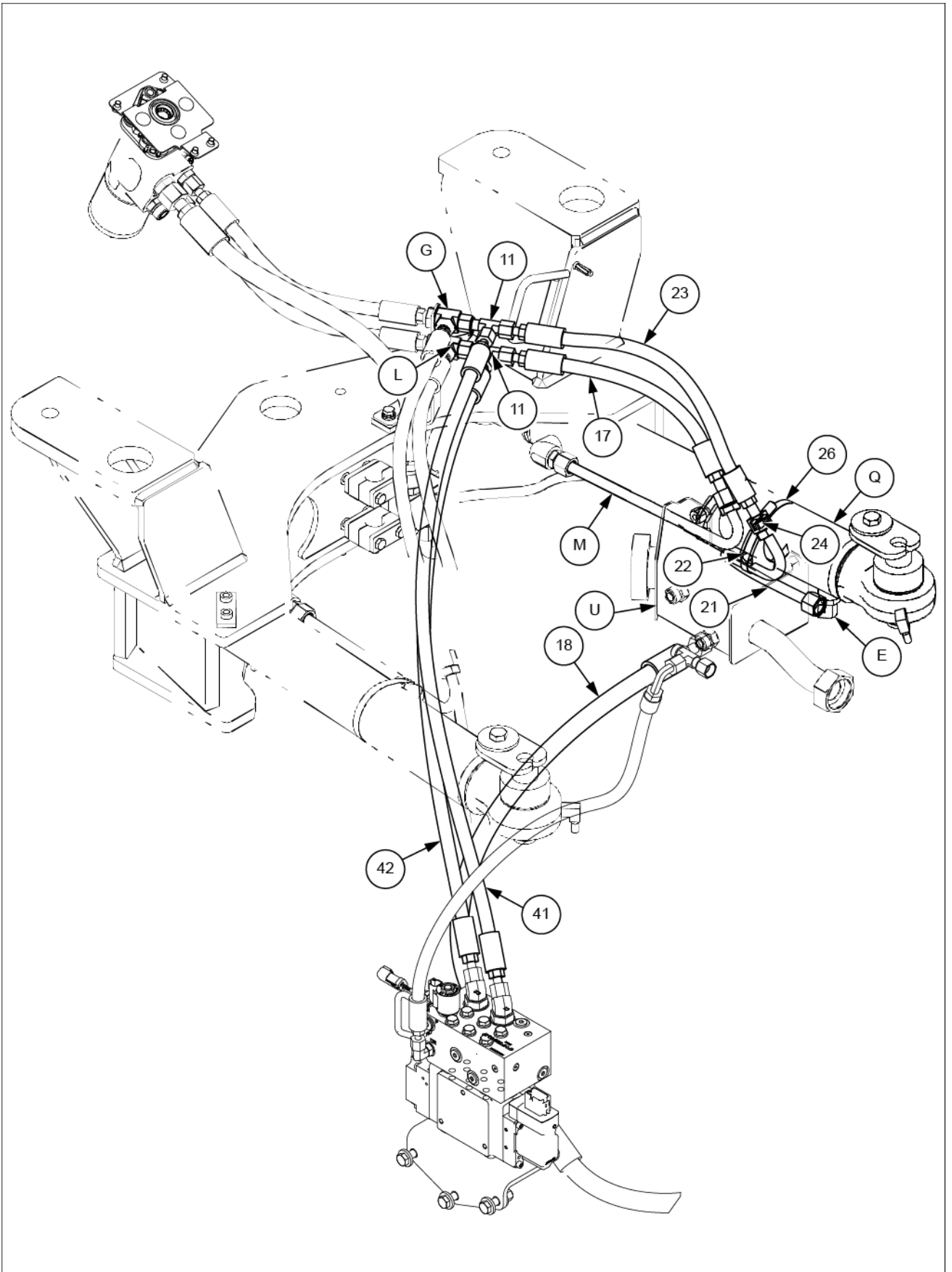

LEIL19WHL0748HB 10

Montaggio dei fusibili

1. Dietro il sedile operatore, rimuovere la protezione e individuare la scatola dei fusibili LC5.

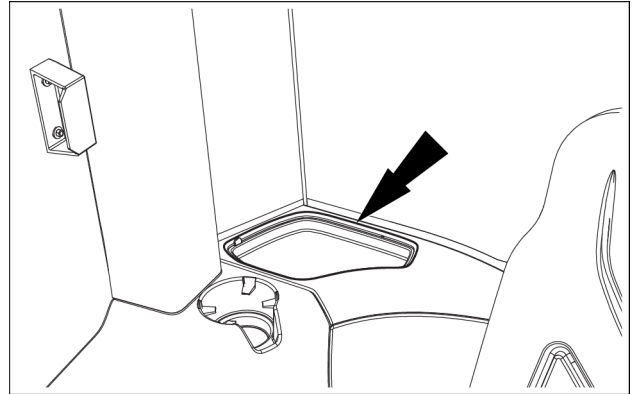

LEIL16WHL1357AB 21

2. Montare il fusibile **5 A (36)** sulla posizione F8

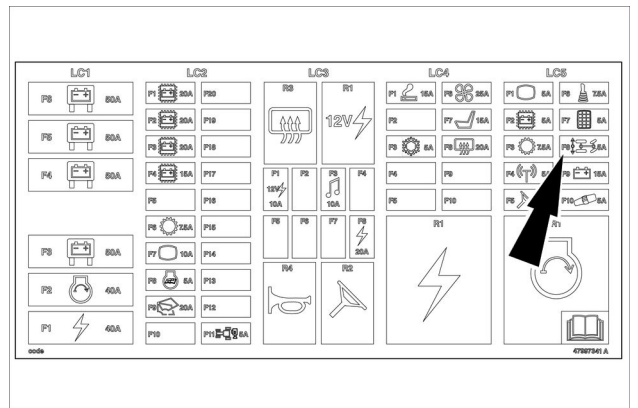

47997341_A 22

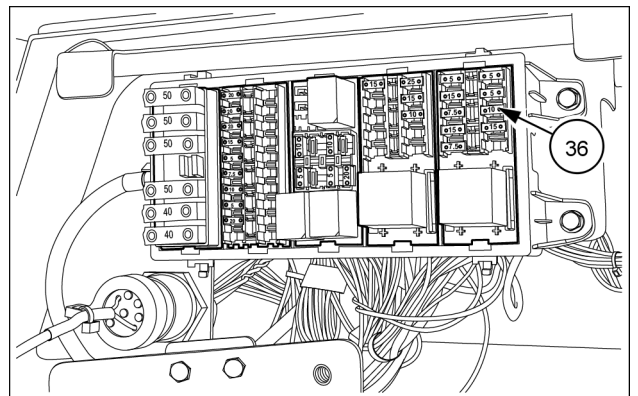

LEIL17WHL1717AB 23

12. Per confermare, selezionare "SEND MODIFIED VALUES TO CONTROLLER" (INVIA VALORI MODIFICATI ALLE CENTRALINE), per aggiornare la macchina con i nuovi valori.

Electronic Service Tool - Case - Wheel Loaders (Models 521G, 621G, 721G, 821G, 921G, 1021G, 1121G) (Tier 4B / Tier 2)

File Tool View Communications Options Window Help

MACHINE CONFIGURATIONS

SET UP CONTROLLERS

RETRIEVE CONTROLLERS VALUES

SEND MODIFIED VALUES TO CONTROLLERS

STATUS: **READY TO SEND**

REFERENCE	PARAMETER DESCRIPTION	CURRENT VALUES	MODIFIED VALUES
01	Brand	Case	Case
02	Vehicle Model	721G	721G
03	Launch Gear	2	2
04	Linkage Type	Z-Bar	Z-Bar
05	Hydraulics Type	Electro-Hydraulic	Electro-Hydraulic
06	Tire Size	Special	Special
07	Set Tire Circumference (cm)	349	349
08	Aux 1 Hydraulics	Installed	Installed
09	Aux 2 Hydraulics	Installed	Installed
10	Grid Heater	Installed	Installed
11	Joystick Steering Enable	Installed	Installed
12	Auto Ride Control	Installed	Installed

SAVE DATA TO FILE

EXIT

LEIL17WHL0435FB 13

13. Selezionare "EXIT" (ESCI) per tornare al menu principale, seguire le istruzioni.
14. Scollegare l'EST dal connettore diagnostico.
15. Ruotare l'interruttore a chiave su "OFF".

NOTA: attendere 5 secondi prima di ruotare nuovamente l'interruttore a chiave in posizione "ON".

3. Desconecte la manguera de presión (**L**) del conector (**C1**) instalado en el puerto "ST" de la válvula de dirección auxiliar (**X**).
4. Desconecte y retire la manguera de detección de carga (**D**) del conector (**C**) instalado en el puerto "LS ST" en la válvula de prioridad (**V**) y el codo de 45° (**E**) instalado en el puerto "LS" de la válvula de dirección auxiliar (**X**).

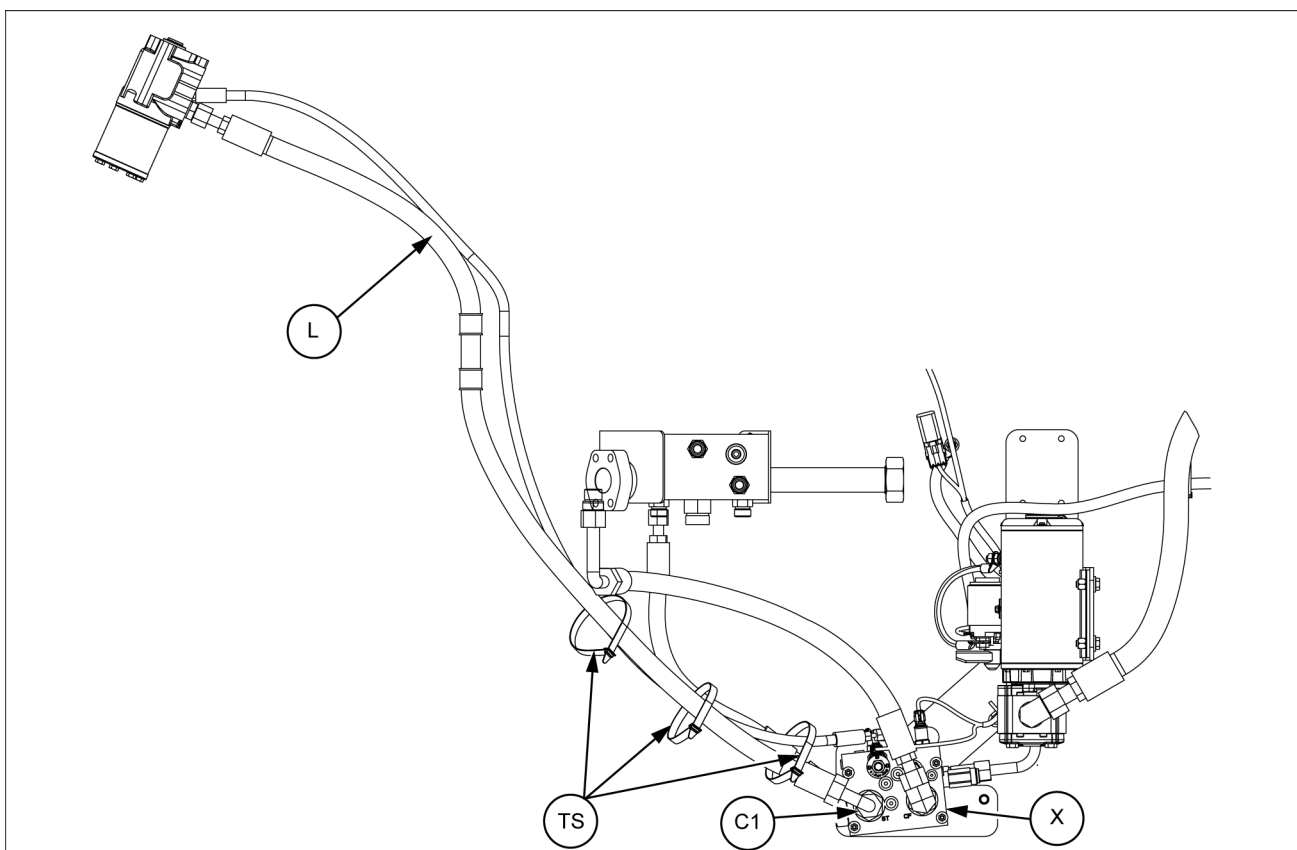

LEIL17WHL0447FB 3

5. Localice el área del cilindro de dirección derecho y retire la abrazadera de la manguera (**H**) y el bloque (**G**).
6. Desconecte y retire la manguera (**A**), de la unión en T (**T1**) y luego retire el tubo (**I**) y la junta tórica (**R**) del cilindro de dirección derecho (**RH**).
7. Desconecte y retire la manguera (**B**), de la unión en T (**T2**) y luego del tubo del cilindro derecho (**Z**).
8. Descarte las mangueras (**A**) y (**B**), el tubo (**I**), la abrazadera de la manguera (**H**), el bloque (**G**) y la junta tórica (**R**).
9. Bajo el compartimento de la cabina, afloje y retire las cuatro tuercas de fijación y desmonte la válvula orbitrol (**S**) del eje de dirección (**SC**).
10. Retire los cuatro pernos (**Q**), las arandelas de bloqueo (**P**), los cojinetes de montaje de acero (**O**) y los cojinetes de goma (**N**) para soltar el soporte (**BR**) de la válvula orbitrol (**S**).

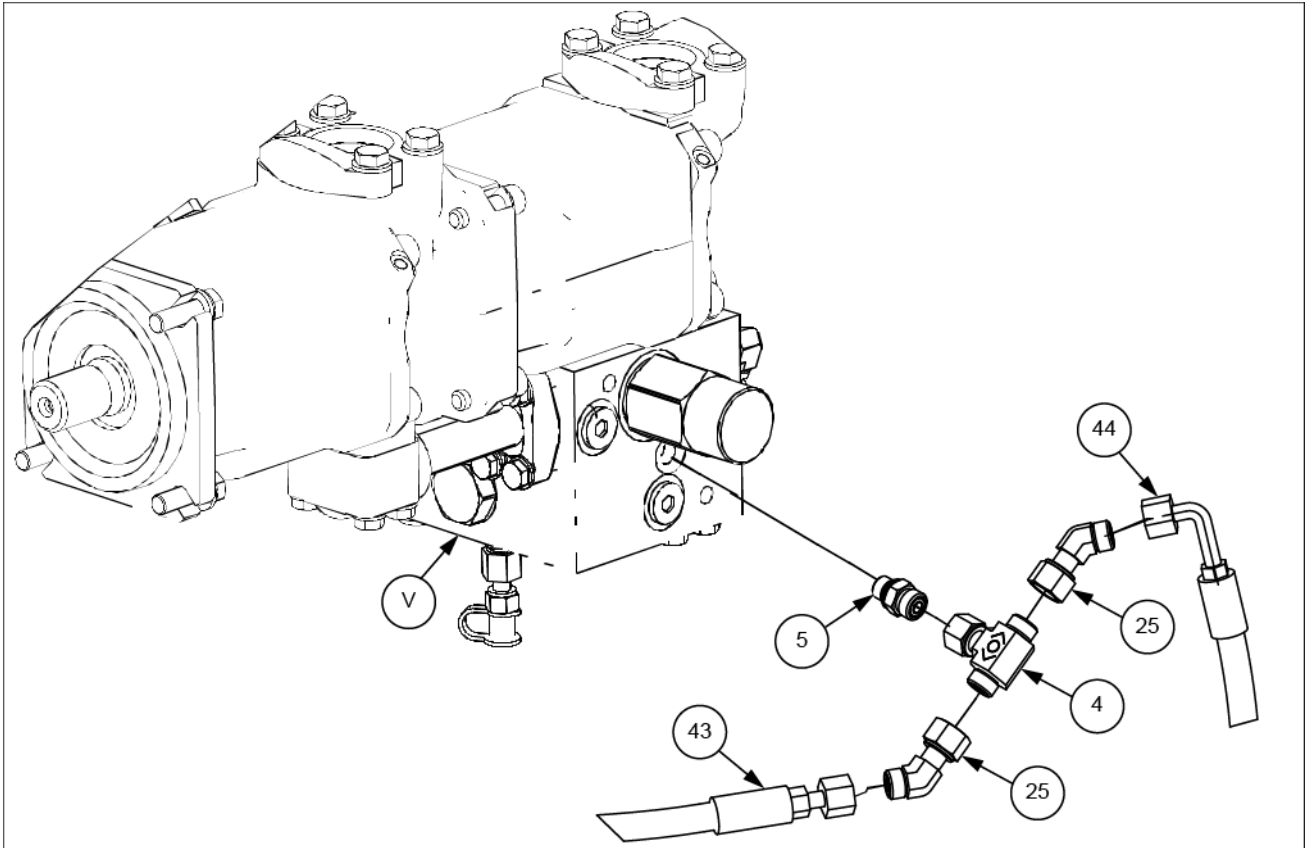

LEIL19WHL0746FB 8

2. En la válvula orbitrol localice el sensor de posición y conecte el conector B-STW del mazo de cables.

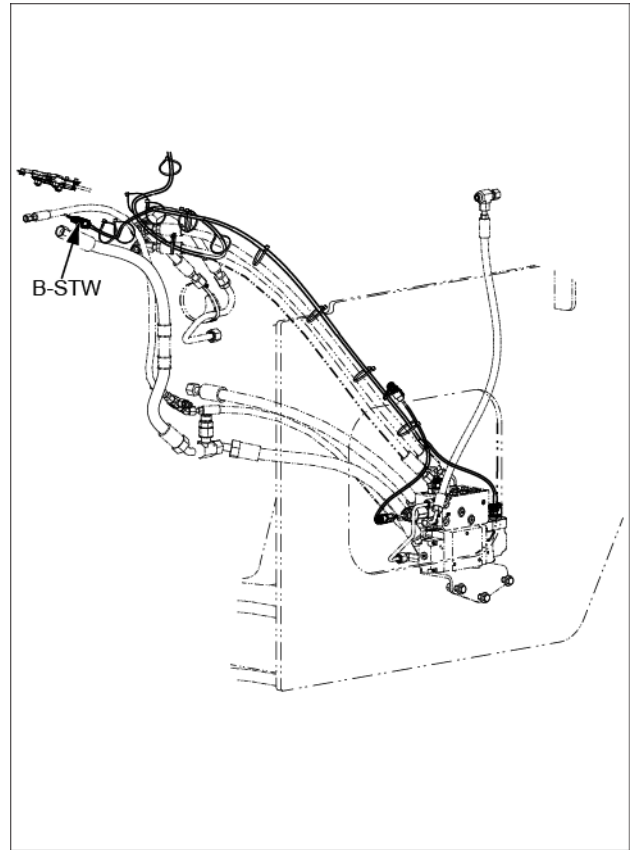

LEIL19WHL0517BB 19

CLICK HERE TO **DOWNLOAD** THE COMPLETE MANUAL

- Thank you very much for reading the preview of the manual.
- You can download the complete manual from: www.heydownloads.com by clicking the link below



- Please note: If there is no response to CLICKING the link, please download this PDF first and then click on it.

CLICK HERE TO **DOWNLOAD** THE COMPLETE MANUAL