



INSTALLATION INSTRUCTIONS

KG2RP461-00
MULTI-PURPOSE CIRCUIT PROPORTIONAL CONTROL KIT

APPROXIMATE INSTALLATION TIME: 32.0 hours

CLICK HERE TO **DOWNLOAD** THE COMPLETE MANUAL

- Thank you very much for reading the preview of the manual.
- You can download the complete manual from: www.heydownloads.com by clicking the link below



- Please note: If there is no response to CLICKING the link, please download this PDF first and then click on it.

CLICK HERE TO **DOWNLOAD** THE COMPLETE MANUAL

3 - ASSEMBLY

MULTI-PURPOSE CIRCUIT PROPORTIONAL CONTROL KIT

Boom line installation

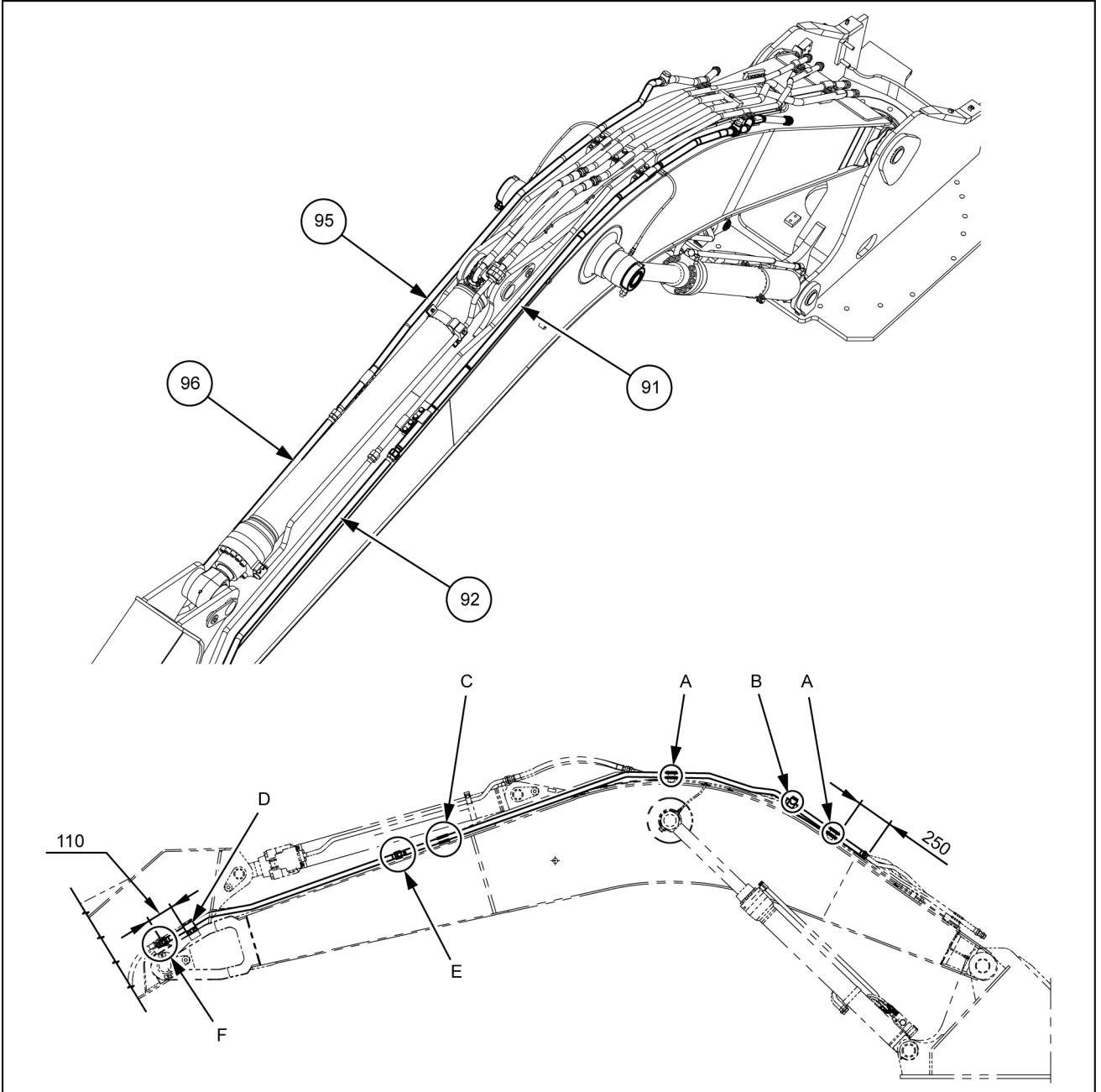

SML15CEX2829GB 1

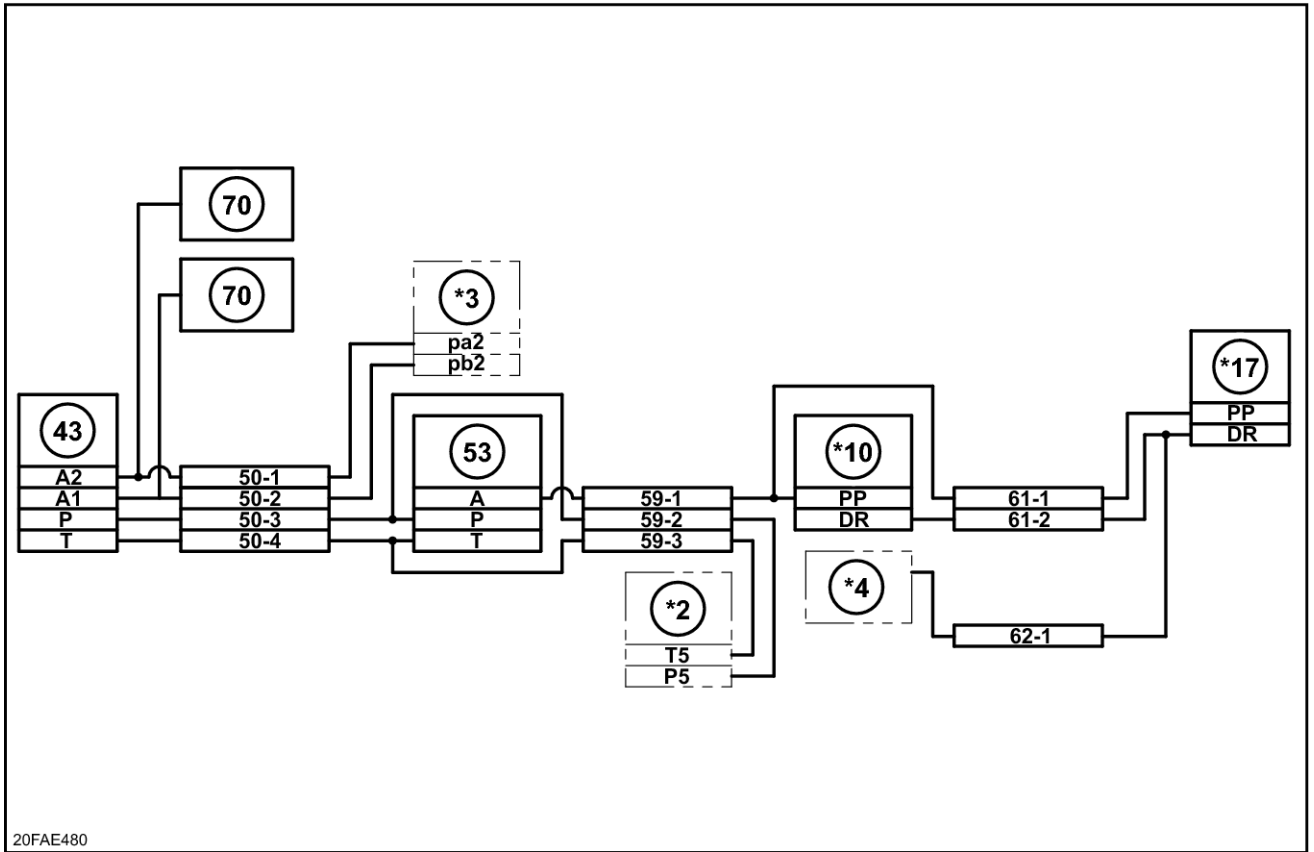

20FAE480 3

- *1. Floor
- *2. Manifold
- *3. Control valve
- *4. Hydraulic tank
- *10. Shut-off valve
- *17. Three-direction valve

1. Install the reducing valve (43) on the bracket (45) with two sems bolts (44).
Install the bracket (45) on the floor (*1) with two sems bolts (46).

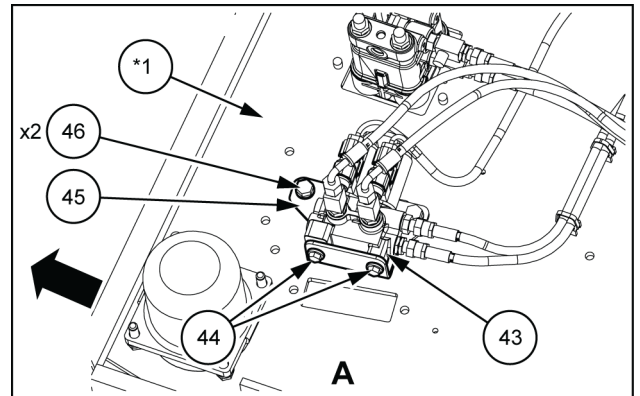

SMIL15CEX0822AB 4

1. Connect the wire harness (96) and the reducing valve (*1).

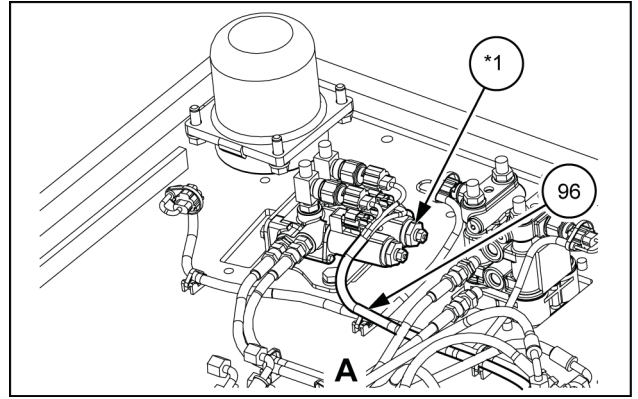

SMIL15CEX2575AB 3

2. Route the wire harness (96) as shown in the diagram.
Fasten the wire harness (96) at six locations with six wire bands (97).

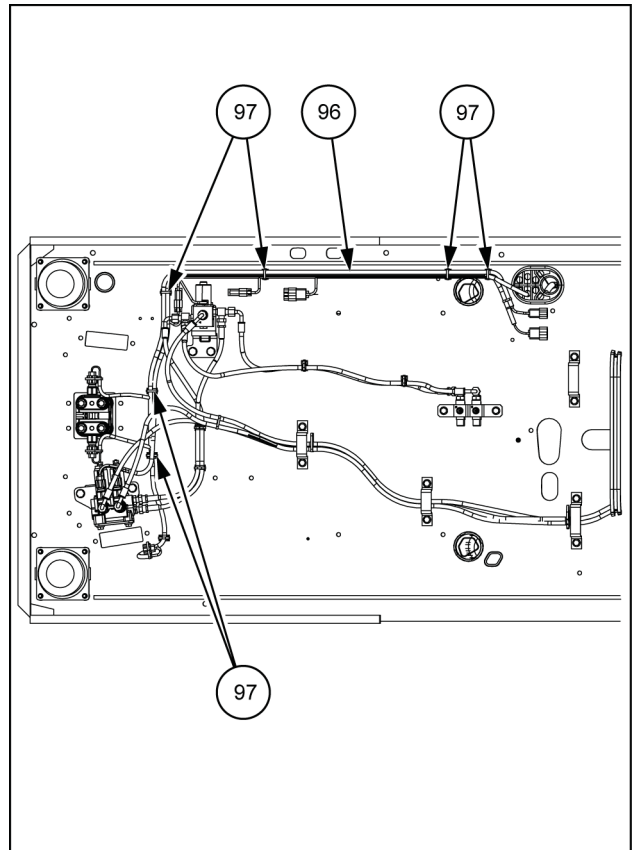

SMIL15CEX2576BB 4

3. Connect the wire harness (96) and solenoid valve (*2) as shown in the diagram.

Fasten the three couplers on the wire harness (96) with one clip (98) each and one bolt (99) each.

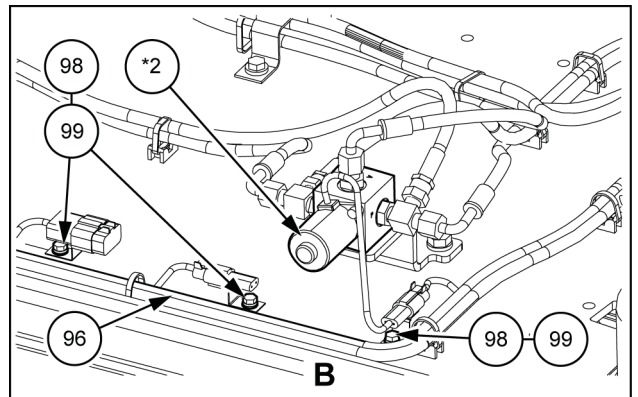

SMIL15CEX2577AB 5

Index

	B	
Boom line installation		3-1
	C	
Control lever installation		3-23
	H	
Harness installation - Proportional control		3-20
	I	
Installation of nameplate inside cab		3-29
	K	
Kit content		1-1
	P	
Pilot line installation - Proportional control		3-10
Port relief valve installation		3-28
Preparation		2-1
	T	
Tank indicator sensor installation (filter clog warning)		3-27
	U	
Upper main line installation		3-5

2 - VORMONTAGE

VORBEREITUNG ZUR MONTAGE

Vorbereitung

Ein „*“ in diesem Dokument weist darauf hin, dass das Teil an der vorliegenden Maschine verbaut ist.

Vorzubereitende Elemente:

- Schraubenschlüssel (**13 mm, 17 mm, 19 mm, 36 mm, 41 mm, 46 mm, 50 mm**)
- Sechskantschlüssel (**8 mm, 12 mm**)
- Kreuzschlitzschraubendreher (Nr. 3)
- Cuttermesser, Schere
- Lappen

1. Bringen Sie die Haupteinheit in Position.
 - Stellen Sie die Haupteinheit auf einem festen und ebenen Untergrund ab, fahren Sie den Löffelzylinder bis zum Anschlag aus, fahren Sie den Pendelarmzylinder bis zum Anschlag aus, senken Sie den Ausleger ab, und lassen Sie das Pendelarmoberteil den Boden berühren.

2. Schalten Sie den Zündschlüssel (**a**) auf „OFF“ (AUS), vergewissern Sie sich, dass der Motor ausgeschaltet ist, und schalten Sie dann den Zündschlüssel wieder auf „ON“ (EIN). (Den Motor nicht starten.)

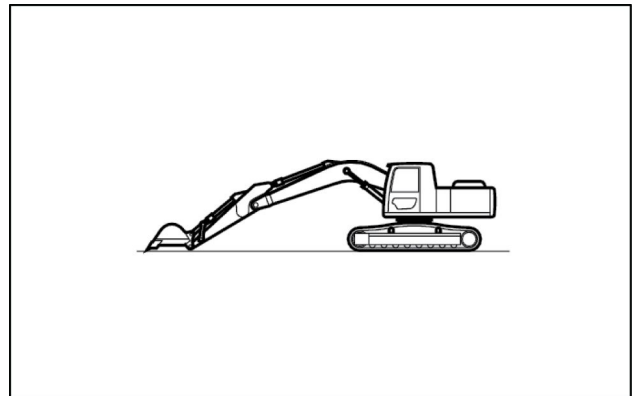

SMIL13II00106AA 1

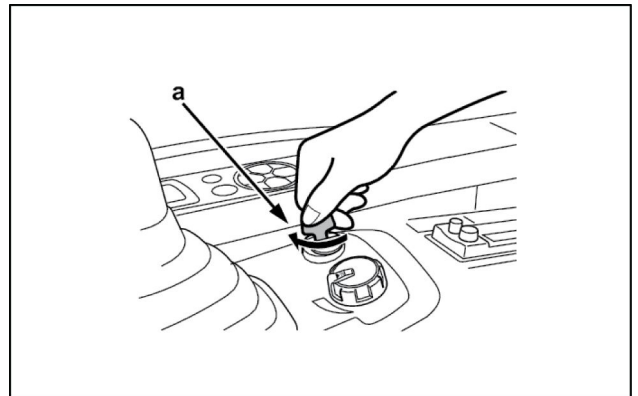

SMIL13II00107AA 2

9. Montieren Sie das Rückschlagventil **(33)** am Steuerventil **(*3)**, Anschluss P4.

Den O-Ring **(30)** am Rückschlagventil **(33)** einsetzen und den Hydraulikschlauch **(31)** anschließen.

Montieren Sie den Bolzen **(28)** am Steuerventil **(*3)**, Anschluss P3, montieren Sie dann das Winkelstück **(29)**.

Den O-Ring **(30)** am Kniestück **(29)** anbringen und den Hydraulikschlauch **(31)** anschließen.

- Hydraulikschlauch-Anzugsmoment: **157 - 193 N·m (116 - 142 lb ft)**.

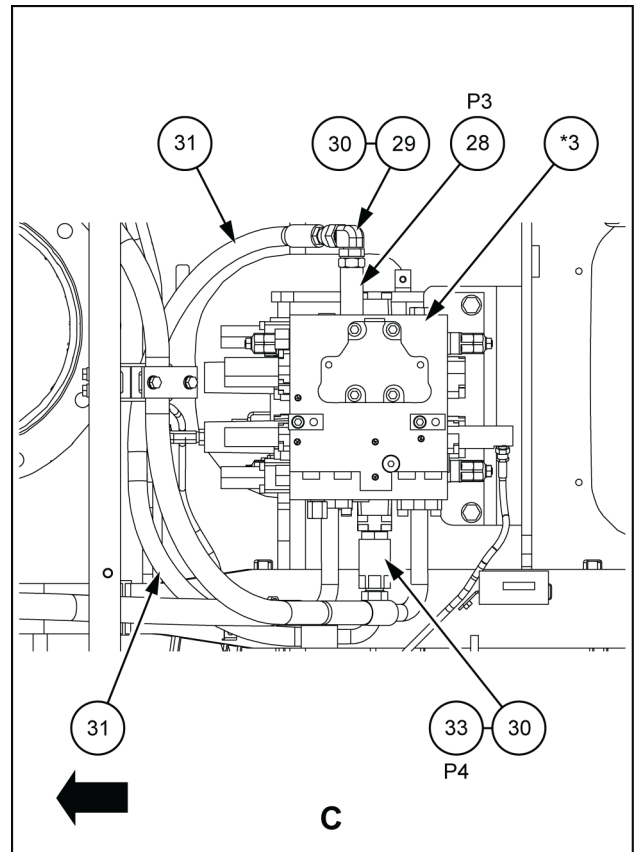

SMIL15CEX0817AB 14

10. Das Kniestück **(35)** an Anschluss T des Absperrventils **(10)** anbringen.

Das Kniestück **(35)** an Anschluss T2 des 3-Wege-Ventils **(17)** anbringen.

Anschluss T des Absperrventils **(10)** und Anschluss T2 des 3-Wege-Ventils **(17)** mit dem Hydraulikschlauch **(34)** verbinden.

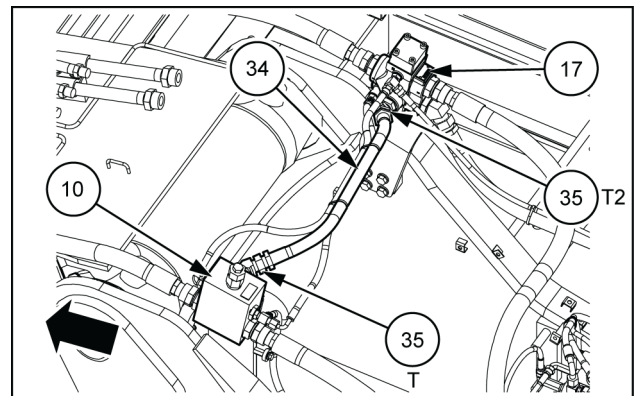

SMIL15CEX0818AB 15

20. Befestigen Sie den Nylonschlauch mit vier Befestigungsschellen (77), vier Kreuzschlitz-Flachkopfschrauben (78) und vier Kabelbindern (79). Befestigen Sie den Nylonschlauch mit vier Kabelbindern (71).

- Den Nylonschlauch an der Vorsteuerleitung befestigen.

Montieren Sie die zwei Drucksensoren (70) am Reduzierventil (43).

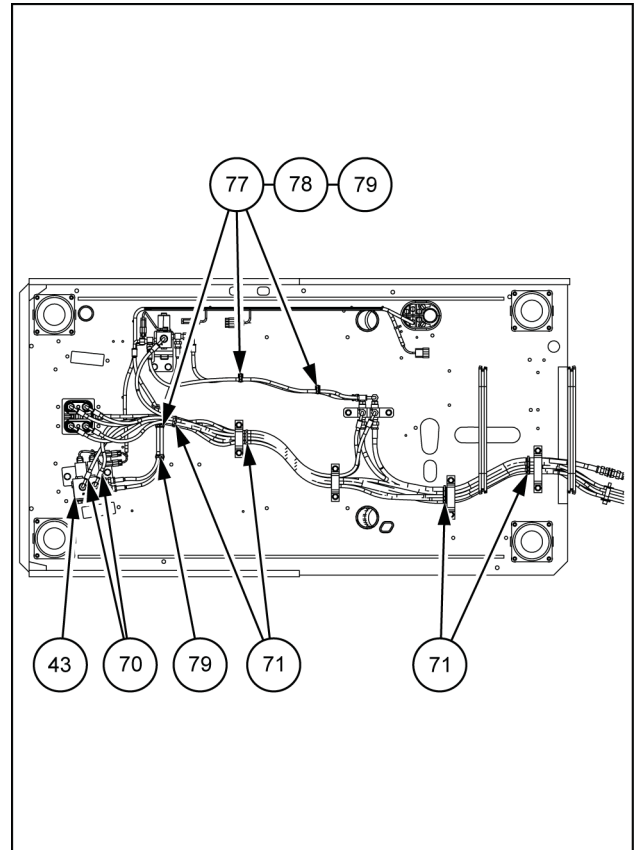

SMIL15CEX2572BB 23

21. Den Nylonschlauch mit vier Kabelbindern (71) befestigen.

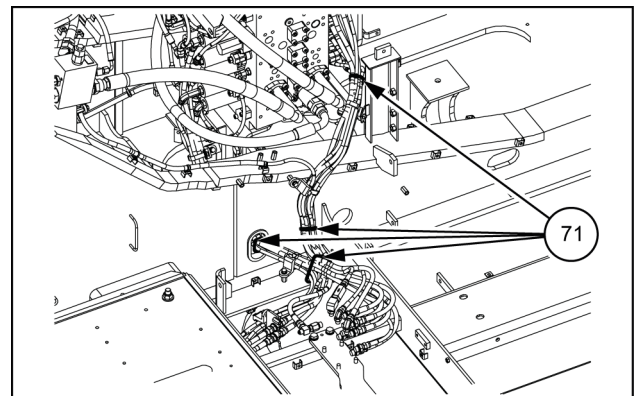

SMIL15CEX2854AB 24

Montage des Typenschilds in der Kabine

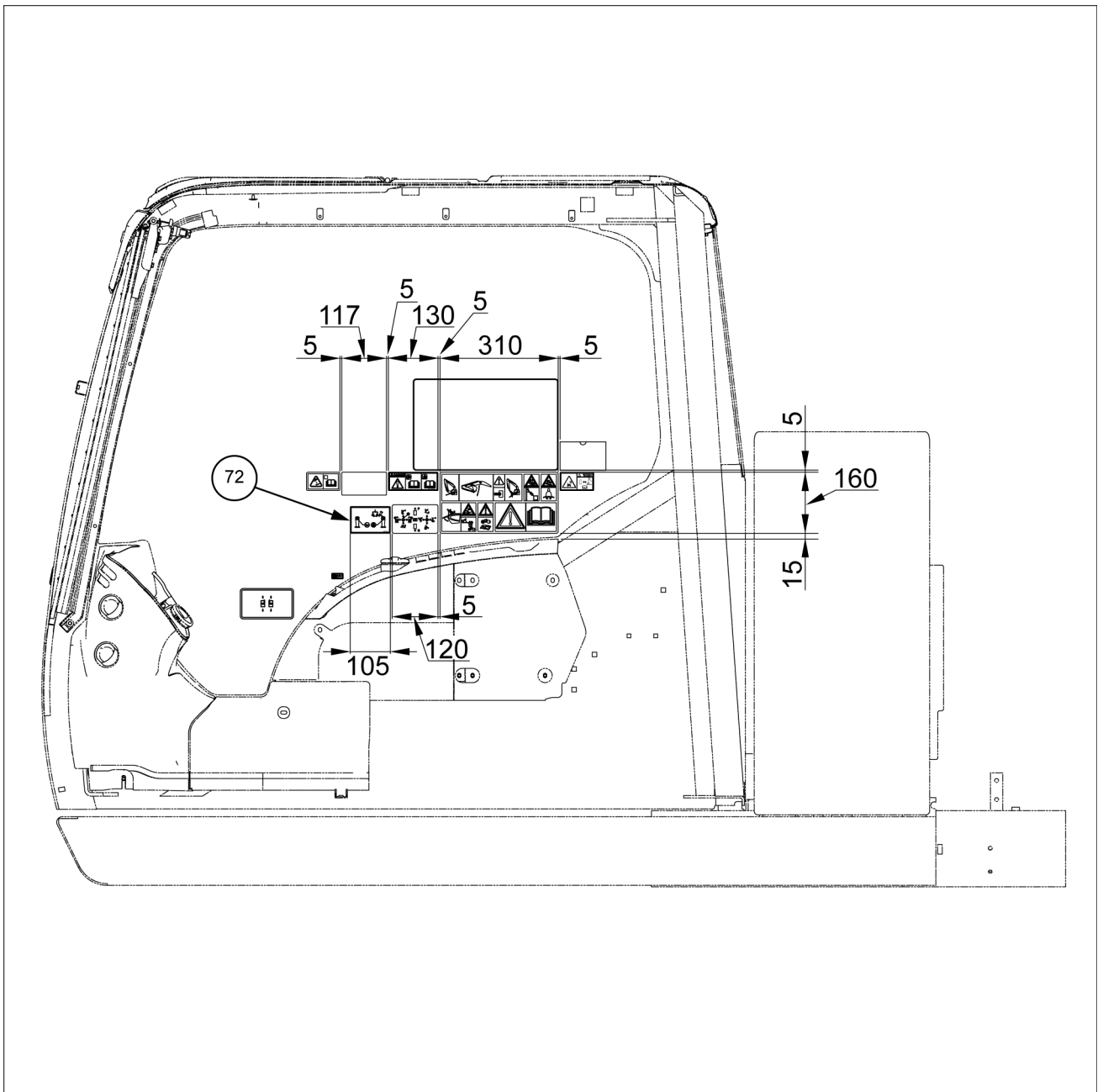

SMIL15CEX3044GB 1

1. Wischen Sie den Schmutz vollständig von der Einbauposition des Etiketts ab.
2. Befestigen Sie die Betriebskennzeichnung (Proportionalregelung) **(72)**.

1 - CONTENU DU KIT

Élément	Description	Quantité	Référence de pièce
67	Attache de montage	2	KHR10220
68	Collier (L = 250)	2	KHH0142
69	Collier	1	KHR1317
70	Vis spéciale M8x16	1	KHJ1213

Plaque (voir 3-29)

Élément	Description	Quantité	Référence de pièce
72	Étiquette de fonctionnement (commande proportionnelle)	1	KHP27030

Collier de serrage (voir 3-1)

Élément	Description	Quantité	Référence de pièce
86	Collier de serrage	8	KHV10610
87	Collier de serrage	4	KHV10630
88	Vis Sems M12x30	4	105R012Y030R
89	Collier de serrage	2	KHV10640

Conduite (voir 3-1)

Élément	Description	Quantité	Référence de pièce
91	Conduite (gauche)	1	KRV32661
92	Conduite (gauche)	1	KRV40160
93	Joint torique	2	KHJ1361
94	Bouchon G3/4	2	BRJ1286
95	Conduite (droite)	1	KRV32671
96	Conduite (droite)	1	KRV40170

Obturateur (voir 3-1)

Élément	Description	Quantité	Référence de pièce
100	Bouchon	2	KHJ1899
101	Joint torique	2	KHJ1361

CLICK HERE TO **DOWNLOAD** THE COMPLETE MANUAL

- Thank you very much for reading the preview of the manual.
- You can download the complete manual from: www.heydownloads.com by clicking the link below



- Please note: If there is no response to CLICKING the link, please download this PDF first and then click on it.

CLICK HERE TO **DOWNLOAD** THE COMPLETE MANUAL

2. Mettre en place la vanne à trois voies (17) sur le support (18) avec les deux vis Sems (19). Mettre en place l'adaptateur de flexible (15) sur l'orifice A de la vanne à trois voies (17).

Placer le joint torique (13) sur l'adaptateur de flexible (15) et raccorder le flexible hydraulique (14).

- Couple de serrage de flexible hydraulique : **184 - 226 N·m (136 - 167 lb ft)**.

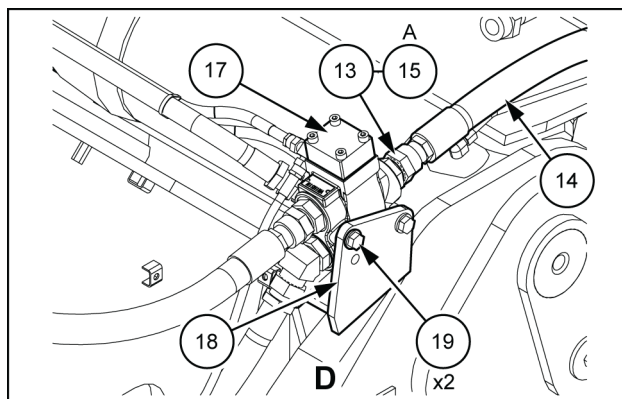

SMIL15CEX2560AB 7

3. Placer le joint torique (13) sur l'ensemble conduite (droite) (*4) et raccorder le flexible hydraulique (14).

- Couple de serrage de flexible hydraulique : **184 - 226 N·m (136 - 167 lb ft)**.

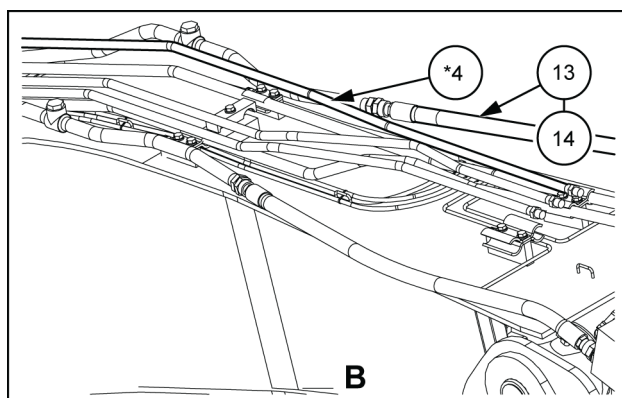

SMIL15CEX2561AB 8

4. Mettre en place l'adaptateur de flexible (38) sur l'orifice T1 de la soupape à 3 voies (17). Raccorder le flexible hydraulique (36) à l'adaptateur de flexible (38).

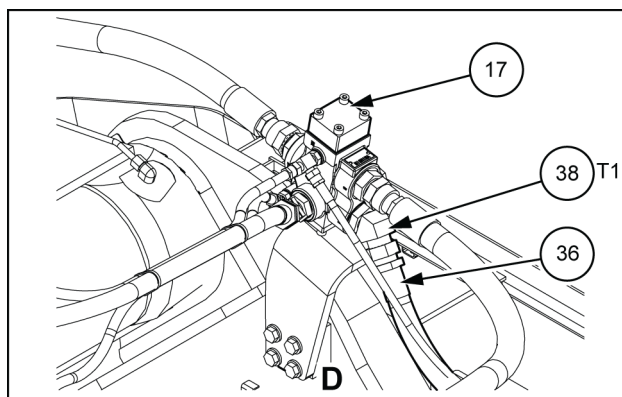

SMIL15CEX2562AB 9

5. Poser le coude allongé (37) sur la pompe hydraulique (*5).

- Fixer le coude (37) en orientant l'angle horizontal à **20°** vers le haut.

Connectez le flexible hydraulique (36) au coude allongé (37).

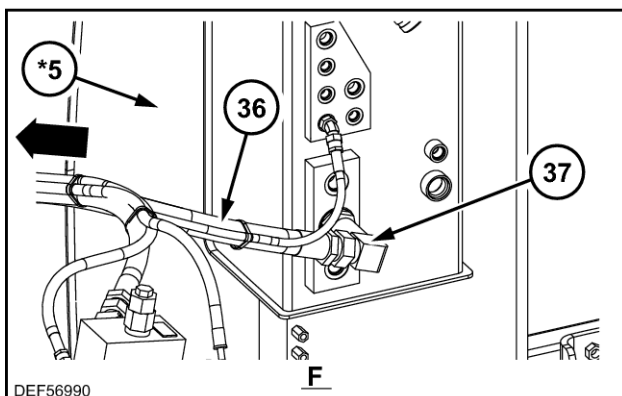

DEF56990

DEF56990 10

14. Poser le raccord en T (**63**) sur l'orifice PP de la vanne d'arrêt (***10**).
Raccorder l'orifice A de l'électrovanne (**53**) et l'orifice PP de la vanne d'arrêt (***10**) avec l'ensemble flexible (59-1).

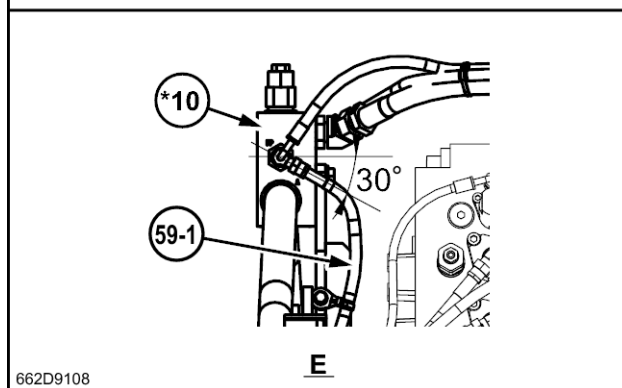
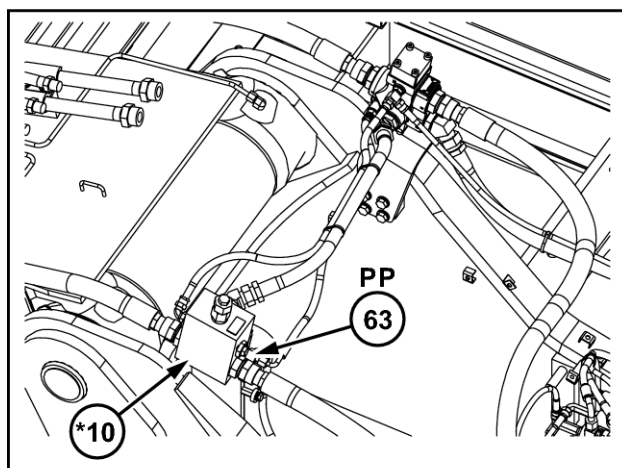

662D9108

662D9108 17

15. Serrer l'ensemble en nylon (59-1) avec le collier, le bracelet (**66**) et le boulon spécial (**67**).
- Couple de serrage : **23.5 - 35.3 N·m (17.3 - 26.0 lb ft)**
- Fixer l'ensemble flexible (59-1) à trois endroits à l'aide du collier de fixation (**68**) et du bracelet (**69**).

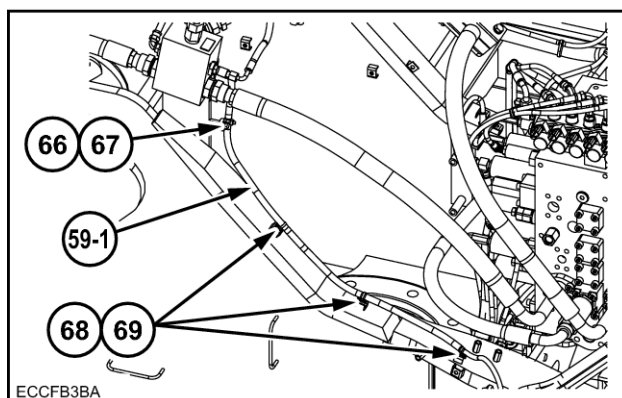

ECCFB3BA

ECCFB3BA 18

16. Mettre en place le coude (**65**) sur l'orifice PP de la vanne à trois voies (***17**).
Raccorder l'orifice PP de la vanne d'arrêt (***10**) et l'orifice PP de la vanne à trois voies (***17**) à l'aide du flexible en nylon (61-1).

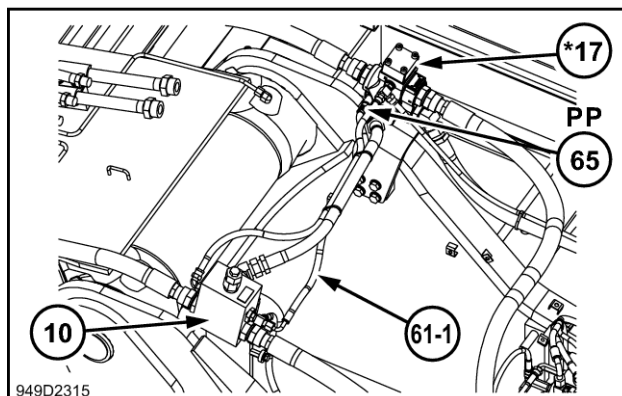

949D2315

949D2315 19

Installation du capteur de témoin du réservoir (avertissement de colmatage du filtre)

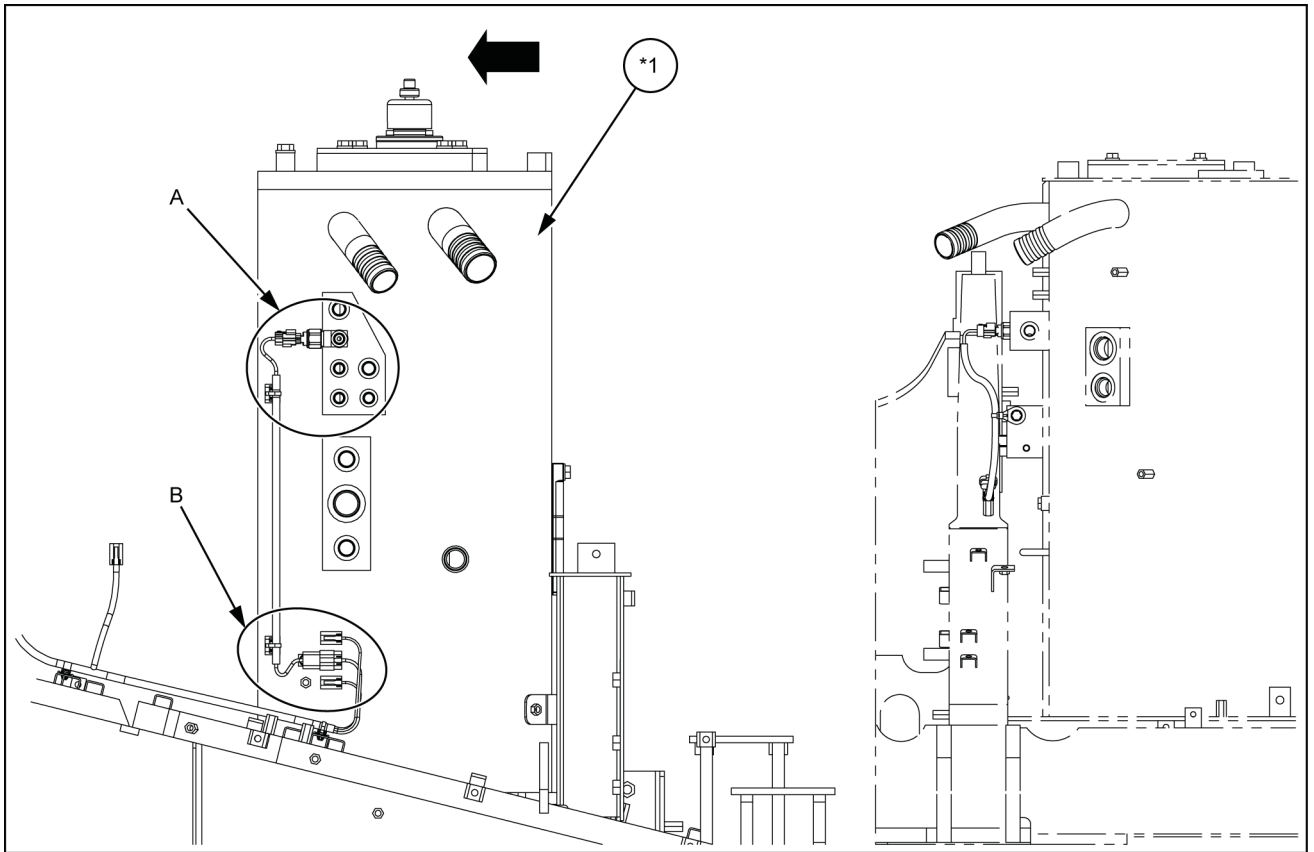

SMIL15CEX3045FB 1

1. Déposer le coude et les conduites de pilotage P et T du collecteur du réservoir hydraulique (*1), puis installer la pièce en T (64).
2. Installez le capteur de pression (65) sur le raccord en T (64).
Brancher le faisceau électrique du capteur (66) sur le capteur de pression (65).

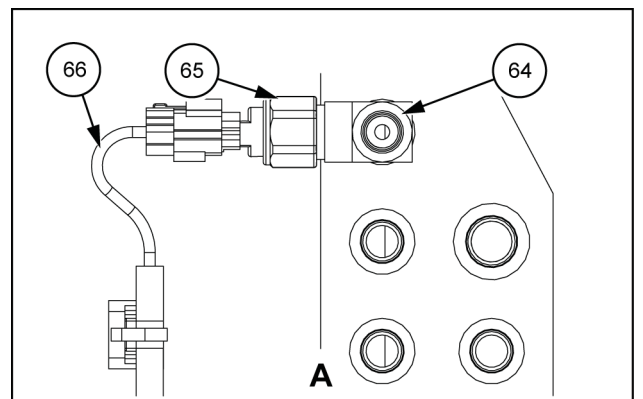

SMIL15CEX2527AB 2

3. Raccorder le faisceau de câblage du capteur (66) au faisceau de câblage principal de châssis (*4).
Fixer le faisceau électrique du capteur (66) avec la vis spéciale (70) et l'attache (69).

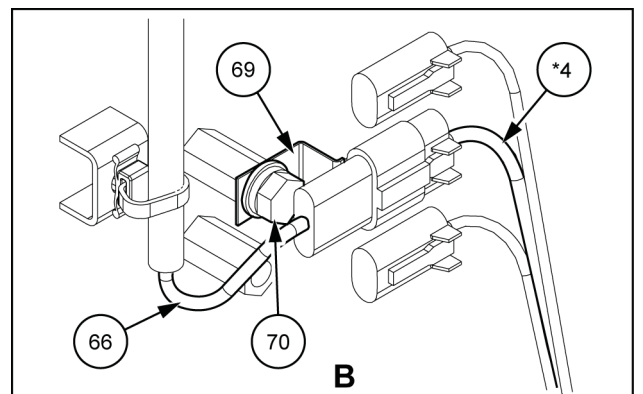

SMIL15CEX2528AB 3

1 - CONTENUTO DEL KIT

Contenuto del kit

NOTA: fare riferimento al catalogo dei ricambi per gli ordini.

Leva di comando (lato destro) (fare riferimento a 3-23)

Componente	Descrizione	Quantità	Riferimento parte
75	Manopola comando proporzionale (lato destro)	1	KHJ28550

Circuito principale multiuso (fare riferimento a 3-5)

Componente	Descrizione	Quantità	Riferimento parte
4	Flessibile idraulico	1	KBJ19770
5	O-ring	1	KHJ0914
6	Semiflangia G1	2	KRJ2682
7	Bullone a testa esagonale incassata M10x30	4	108R010Y030R
8	Adattatore tubo flessibile	2	KHJ1349
10	Valvola di arresto	1	KHJ10410
11	Staffa	1	KRJ11470
12	Bullone tipo Sems M12x30	6	105R012Y030R
13	O-ring	6	KHJ1361
14	Flessibile idraulico	2	KSJ13741
15	Adattatore tubo flessibile	2	KHJ1349
17	Valvola a tre vie	1	KHJ10420
18	Staffa	1	KRJ16050
19	Bullone tipo Sems M12x30	6	105R012Y030R
20	Flessibile idraulico	1	KRJ36930
21	O-ring	1	KHJ0914
22	Semiflangia G1	2	KRJ2682
23	Bullone a testa esagonale incassata M10x30	4	108R010Y030R
24	Staffa	1	KBJ19820
25	Piastra	1	KRJ10800
26	Fascetta stringitubo flessibile	2	KRJ11450
27	Bullone tipo Sems M10x25	4	105R010Y025R
28	Prigioniero	1	KHJ26310
29	Raccordo a gomito G3/4	1	KHJ1804
30	O-ring	2	KHJ1360
31	Flessibile idraulico	1	KBJ19810
33	Valvola di ritegno	1	KHJ10480
34	Flessibile idraulico	1	KRJ11540
35	Raccordo a gomito G3/4	2	KHJ0351
36	Flessibile idraulico	1	KRJ37590
37	Gomito lungo	1	KHJ24380
38	Adattatore tubo flessibile G1	1	KNJ0606

Circuito pilota multiuso, controllo proporzionale (fare riferimento a 3-10)

Componente	Descrizione	Quantità	Riferimento parte
43	Valvola di regolazione	1	MFJ71500
44	Bullone tipo Sems M8x16	2	105R008Y016R
45	Staffa	1	KHJ28770
46	Bullone tipo Sems M10x20	2	105R010Y020R
47	Adattatore tubo flessibile G1/4	1	KNJ0758
48	Raccordo a T G1/4	2	KAJ3807
49	Nipplo con filtro G1/4	1	CNA0584
50	Tubo flessibile del complessivo (da 50-1 a 50-4)		KBJ24030
50-1	Tubo flessibile in nylon Y1	1	KHJ2581

Montaggio della tubazione principale superiore

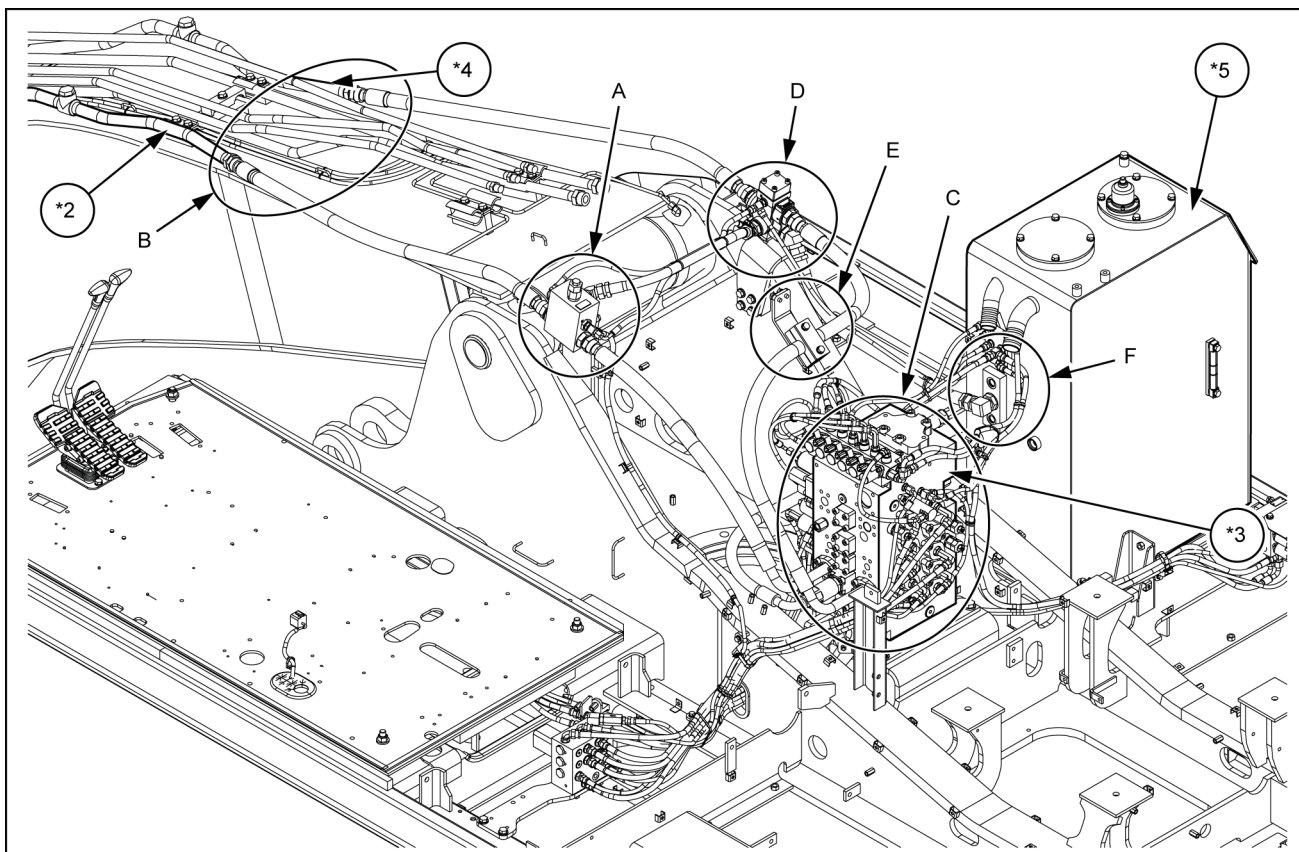

SMIL15CEX2554FB 1

Montaggio della tubazione principale superiore (lato sinistro)

1. Montare la staffa (11) sul telaio con quattro bulloni tipo Sems (12).

Montare la valvola di arresto (10) sulla staffa (11) con due bulloni tipo Sems (12).

- Regolare la pressione impostata per la valvola di sfiato (*1) della valvola di arresto (10) in base al tipo di attrezzatura utilizzata.

Montare l'adattatore per flessibile (8) sulla valvola di arresto (10), luce B.

Posizionare l'O-ring (13) sull'adattatore per flessibile (8) e collegare il flessibile idraulico (14).

- Coppia di serraggio del tubo flessibile idraulico: **184 - 226 N·m (136 - 167 lb ft)**.

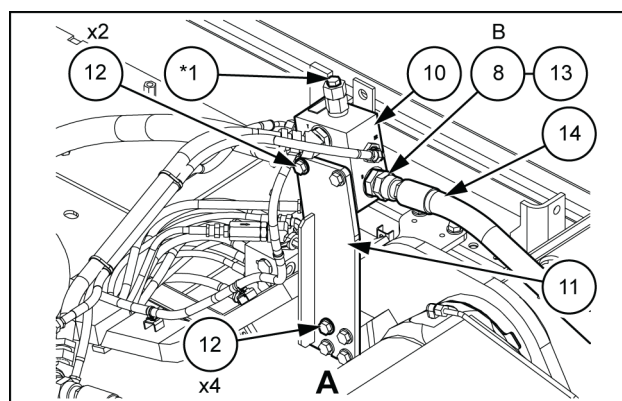

SMIL15CEX2555AB 2

9. Montare il raccordo a T (48) sulla valvola riduttrice (43), luce A2.
- Coppia di serraggio: **25.4 - 31.4 N·m (18.7 - 23.2 lb ft)**

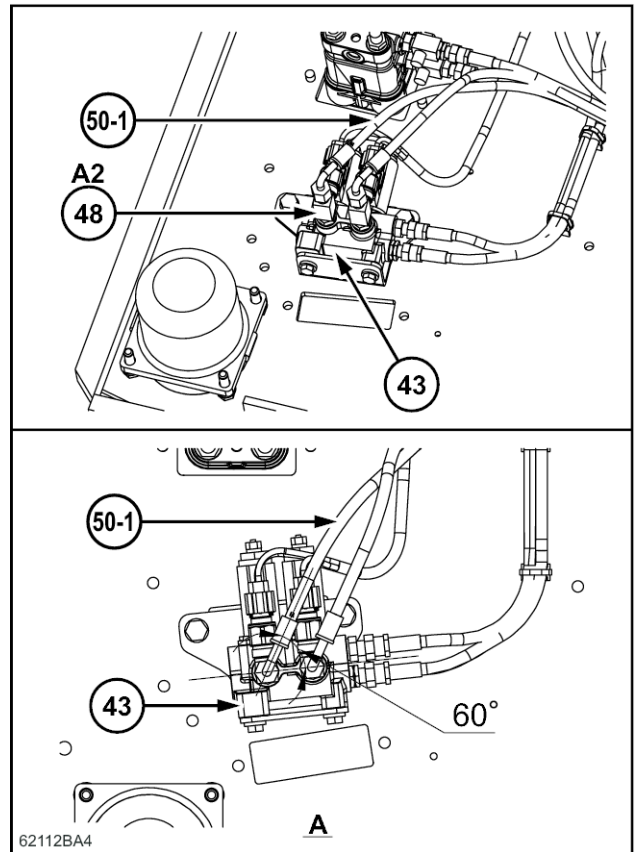

62112BA4 12

10. Montare il raccordo a gomito (60) sul distributore (*3), luce pa2. Collegare la valvola riduttrice (43), luce A2, e il distributore (*3), luce pa2, al flessibile in nylon (50-1).

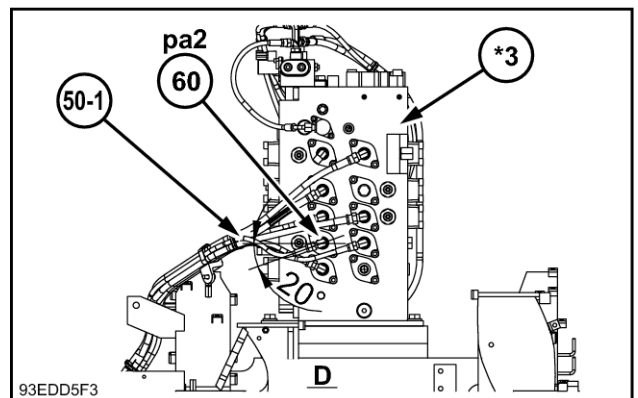

93EDD5F3 13

11. Montare il gomito (64) sul collettore (*2), luce T5. Collegare l'elettrovalvola (53), luce T, e il collettore (*2), luce T5, al flessibile in nylon (59-3).

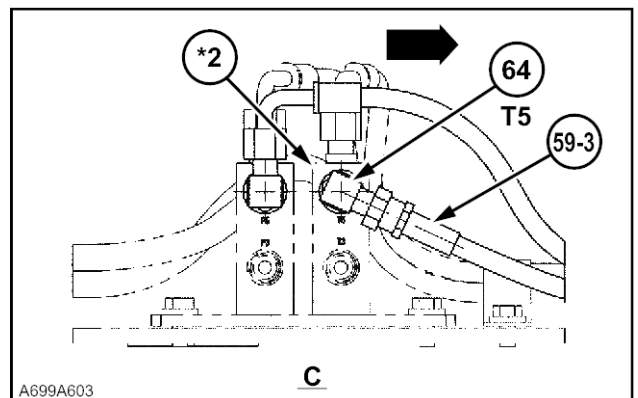

A699A603 14

- Montare il connettore dell'interruttore avvisatore acustico (*11), legarlo con la fascetta serrafili (*12), quindi riabbassare la cuffia di protezione della leva di comando (*10).

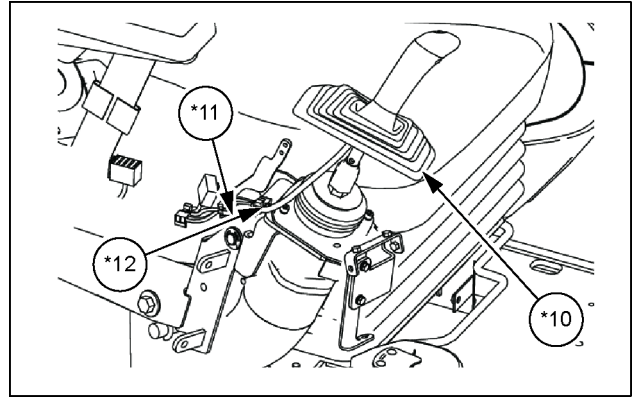

SMIL14II00174AB 9

- Utilizzare un cacciavite Phillips o una chiave a tubo da **10 mm** per montare il coperchio (*9) con cinque bulloni (*8).

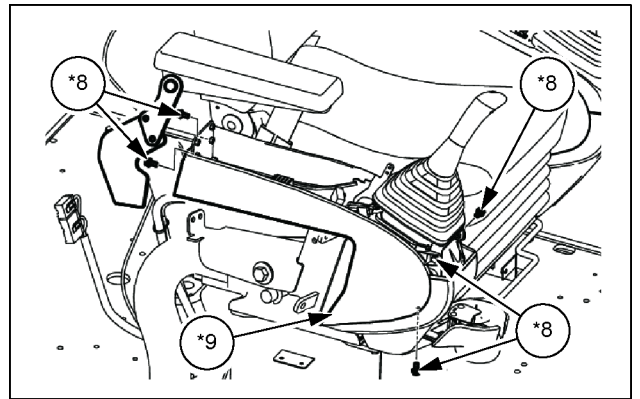

SMIL14II00175AB 10

- Montare i connettori (*6), quindi montare il coperchio superiore della console (*7).

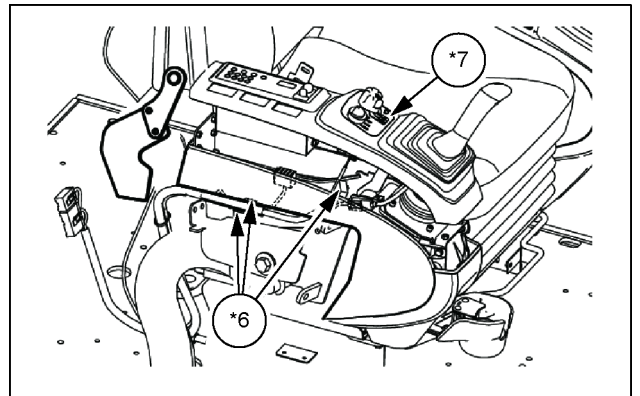

SMIL14II00176AB 11

- Utilizzare il cacciavite Phillips per montare le due viti (*5) del coperchio superiore della console.

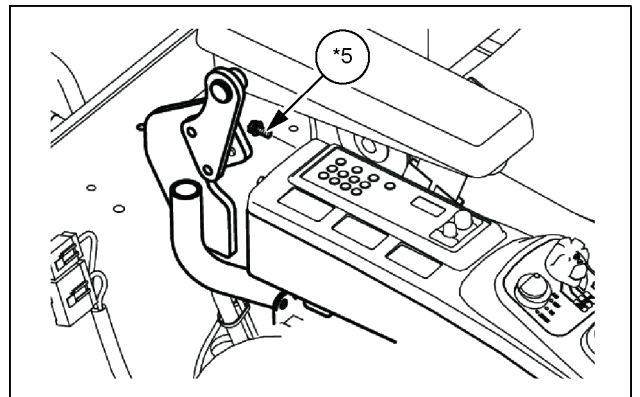

SMIL14II00177AB 12

Contenido

1 CONTENIDO DEL KIT

Contenido del kit.....	1-1
------------------------	-----

2 PREENSAMBLADO

PREPARACIÓN PARA MONTAJE

Preparación.....	2-1
------------------	-----

3 MONTAJE

KIT DE CONTROL PROPORCIONAL DEL CIRCUITO MULTIFUNCIÓN

Instalación del conducto del brazo	3-1
Instalación del conducto principal superior.....	3-5
Instalación de la línea de pilotaje - Control proporcional	3-10
Instalación del mazo de cables - Control proporcional	3-20
Instalación de la palanca de control	3-23
Instalación del sensor indicador del depósito (aviso de obstrucción del filtro)	3-27
Instalación de la válvula de descarga del puerto.....	3-28
Instalación de la placa del nombre dentro de la cabina	3-29

4. Sujete el conjunto de conductos (izquierdo) **(91)** con dos abrazaderas para tubos **(87)** y apriételas con dos pernos SEMS **(*2)**.
 - Fije las abrazaderas para tubos **(87)** a **285.0 mm (11.2 in)** del extremo delantero del conjunto de conductos (izquierdo) **(91)**.
5. Instale el conjunto de conductos (derecha) **(95)** de la misma forma que el conjunto de conductos (izquierda) **(91)**.

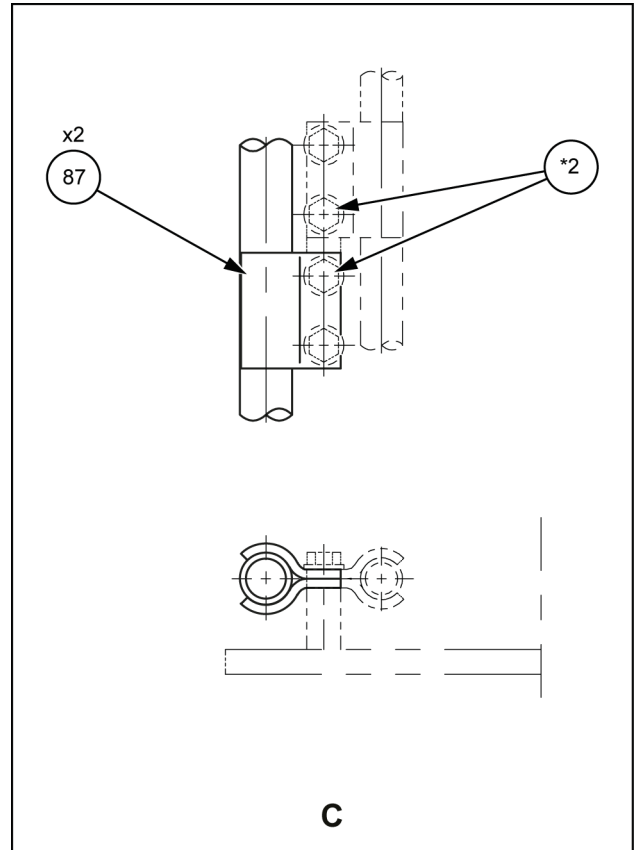

SMIL15CEX2470BB 5

Conjuntos de conductos (92) y (96)

1. Coloque el conjunto de conductos (izquierdo) **(92)**.

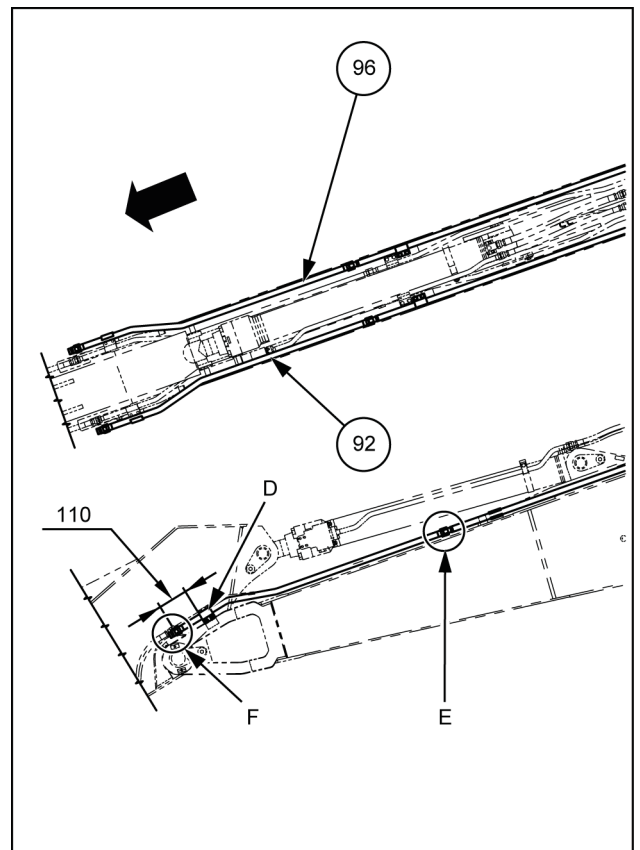

SMIL15CEX2831BB 6

5. Instale el racor con filtro (49) en el puerto P de la válvula reductora (43).
- Par de apriete: **25.4 - 31.4 N·m (18.7 - 23.2 lb ft)**

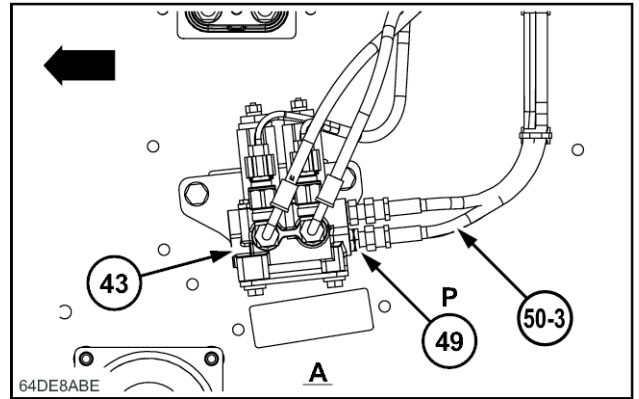

64DE8ABE 8

6. Instale el racor en T (57) en el puerto P de la válvula solenoide (53). Conecte el puerto P de la válvula reductora (43) y el puerto P de la válvula solenoide (53) con la manguera de nailon (50-3). Fije las mangueras de nailon (50-3) y (50-4) con la brida especial (51).

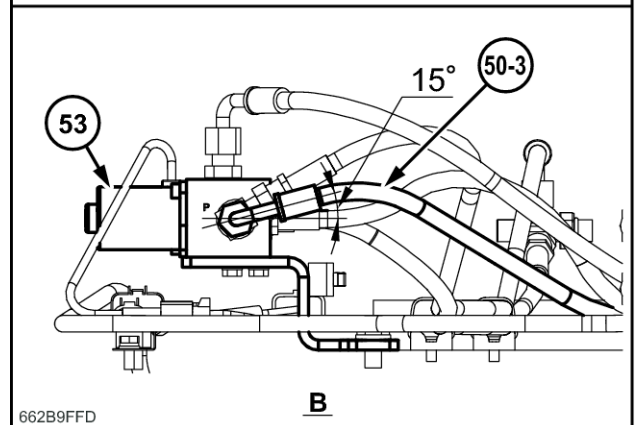
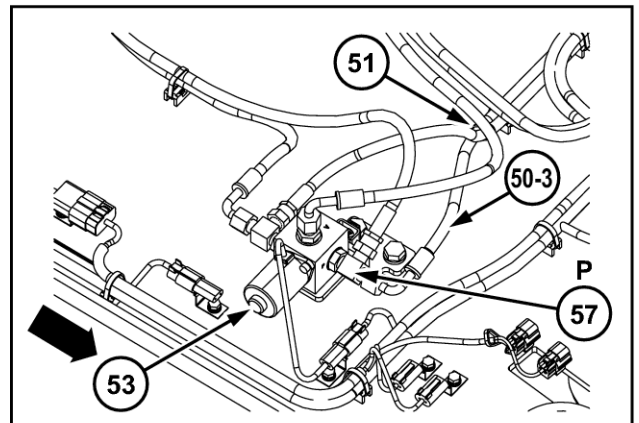

662B9FFD 9

Instalación de la palanca de control

Extracción de la palanca de control (derecha)

1. Enrolle la funda (*1) de la palanca de control y use un destornillador Phillips o una llave de vaso 10 mm para retirar los 2 pernos (*2) de la tapa superior de la consola.

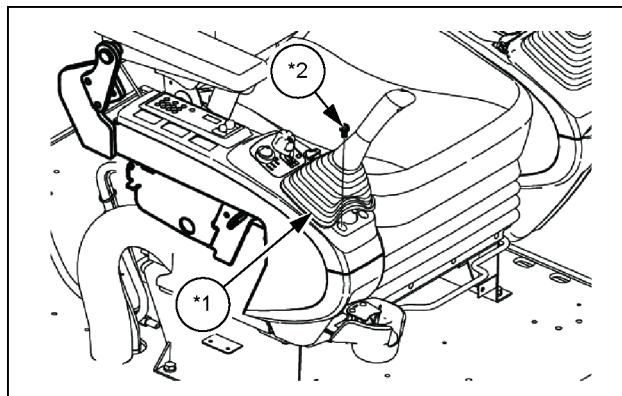

SMIL14II00167AB 1

2. Utilice el destornillador Phillips para retirar los 2 tornillos (*3) y retire luego el tirador de la palanca de inclinación (*4).

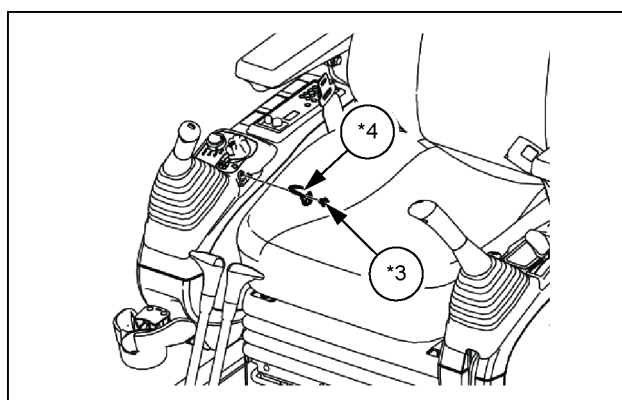

SMIL14II00168AB 2

3. Use un destornillador Phillips para desinstalar los 2 tornillos (*5), de la tapa superior de la consola.

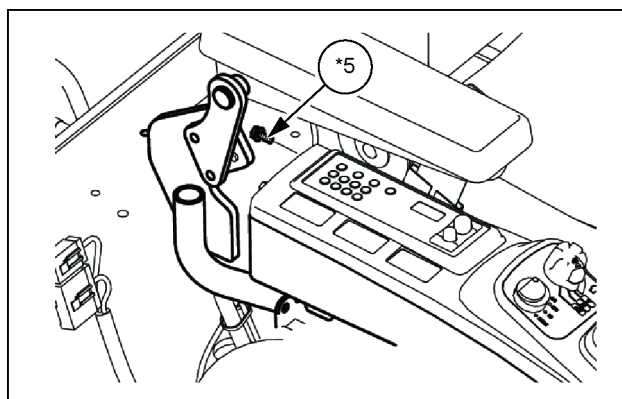

SMIL14II00169AB 3

4. Retire los conectores (*6) y extraiga la cubierta superior de la consola (*7).

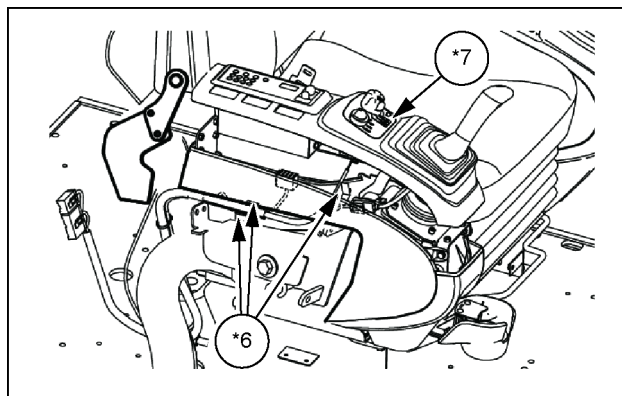

SMIL14II00170AB 4

CLICK HERE TO **DOWNLOAD** THE COMPLETE MANUAL

- Thank you very much for reading the preview of the manual.
- You can download the complete manual from: www.heydownloads.com by clicking the link below



- Please note: If there is no response to CLICKING the link, please download this PDF first and then click on it.

CLICK HERE TO **DOWNLOAD** THE COMPLETE MANUAL