



INSTALLATION INSTRUCTIONS

KG1RP708-00
HIGH FLOW HYDRAULIC KIT

APPROXIMATE INSTALLATION TIME: 32 hours

CLICK HERE TO **DOWNLOAD** THE COMPLETE MANUAL

- Thank you very much for reading the preview of the manual.
- You can download the complete manual from: www.heydownloads.com by clicking the link below



- Please note: If there is no response to CLICKING the link, please download this PDF first and then click on it.

CLICK HERE TO **DOWNLOAD** THE COMPLETE MANUAL

2. Set the line assembly (left) (10) and line assembly (right) (9) on the pipe clamp (11), and then fasten with the high-strength bolt (12) and high-strength washer (13).
Fasten the pipe clamp (11) at a position **176 mm (6.9 in)** from the rear end of line assembly (left) (10) and **161 mm (6.3 in)** from the end of line assembly (right) (9).

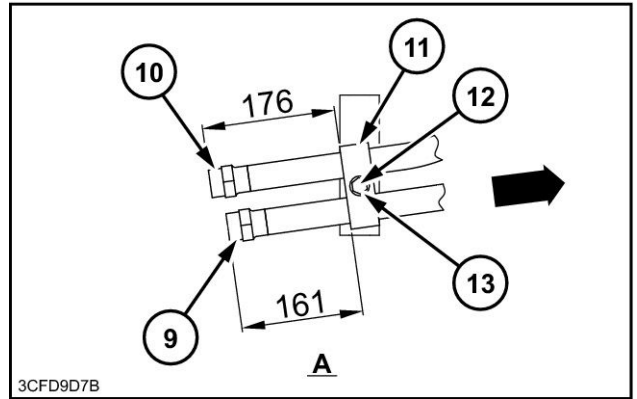

3CFD9D7B

3CFD9D7B 3

3. Install 1 plug (5) each on line assembly (left) (10) and line assembly (right) (9).
Tightening torque:
153 - 187 N·m (1354.2 - 1655 lb in).

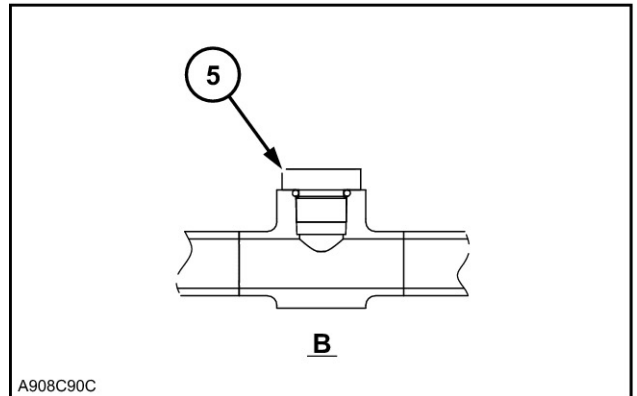

A908C90C

A908C90C 4

4. Sandwich the line assembly (left) (10) with 2 pipe clamps (3), and then fasten with 2 sems bolts (2).
Fasten the pipe clamp (3) at a position **285 mm (11.2 in)** from the front end of the line assembly (left) (10).
Sandwich the line assembly (right) (9) with 2 pipe clamps (3), and then fasten with 2 sems bolts (2).
Fasten the pipe clamp (3) at a position **285 mm (11.2 in)** from the front end of the line assembly (right) (9).

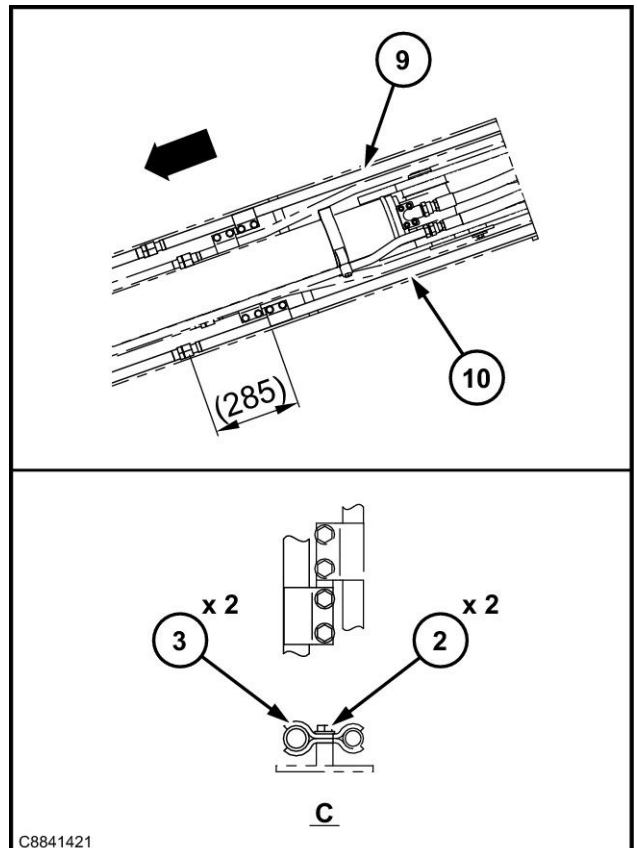

C8841421

C8841421 5

3. Set the lock lever (10) and the compression spring (14) on the lock bracket (12), and then fasten with the high-strength nut (16) and plain washer (15). Fit the lock lever (10) onto the slot of the option right pedal bracket (9), and then install the lock bracket (12) on the floor with 2 hexagon socket head bolts (11) and 2 high-strength washers (4).

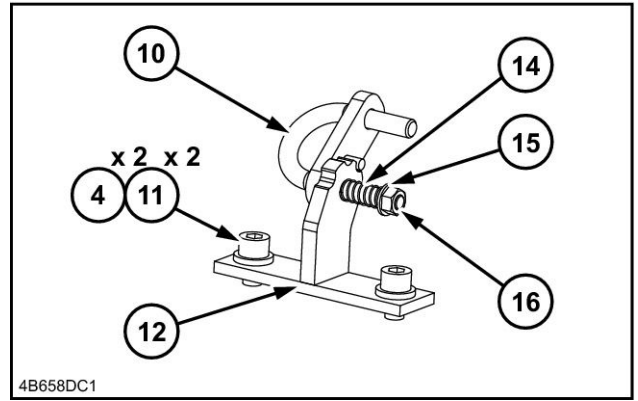

4B658DC1 3

4. Install the option pedal bracket (13) and option pedal (2) with 2 hexagon socket head bolts (5) and 2 high-strength washers (4). Cover the option pedal (2) with the pedal plastic cover (8).

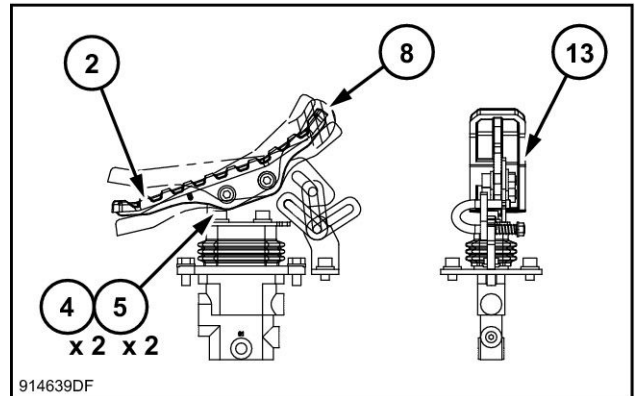

914639DF 4

23. Fasten the assembly hose (**18/Y4**) and assembly hose (**18/D12**) with the special bolt (**16**) and clamp with band (**17**).
 Bolt tightening torque:
23.5 - 35.3 N·m (208.0 - 312.4 lb in).

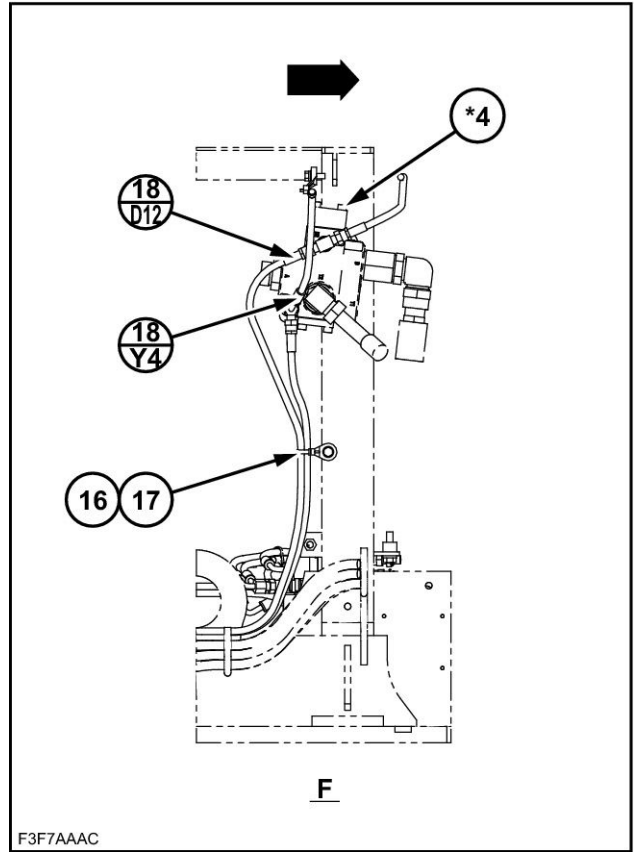

F3F7AAAC 25

24. Install the pressure switch (**6**) on the remote control valve (***1**) C1 port.

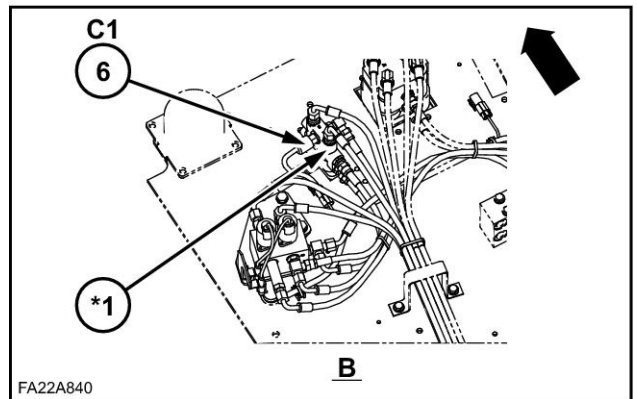

FA22A840 26



INSTRUCTIONS D'INSTALLATION

KG1RP708-00
KIT DE CIRCUIT HYDRAULIQUE HAUT DEBIT

TEMPS D'INSTALLATION APPROXIMATIF : 32 heure(s)

2. Placez l'ensemble conduite (gauche) (10) et l'ensemble conduite (droit) (9) sur le collier de serrage (11), puis le fixer à l'aide de la vis haute résistance (12) et la rondelle haute résistance (13).

Fixez le collier de serrage (11) à 176 mm (6.9 in) de l'extrémité arrière de l'ensemble conduite (gauche) (10) et à 161 mm (6.3 in) de l'extrémité de l'ensemble conduite (droit) (9).

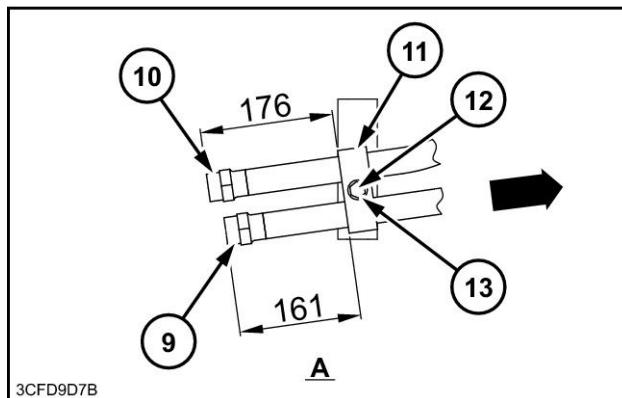

3CFD9D7B 3

3. Installez 1 bouchon (5) sur l'ensemble conduite (gauche) (10) et l'ensemble conduite (droit) (9).

Couple de serrage :
153 - 187 N·m (1354.2 - 1655 lb in).

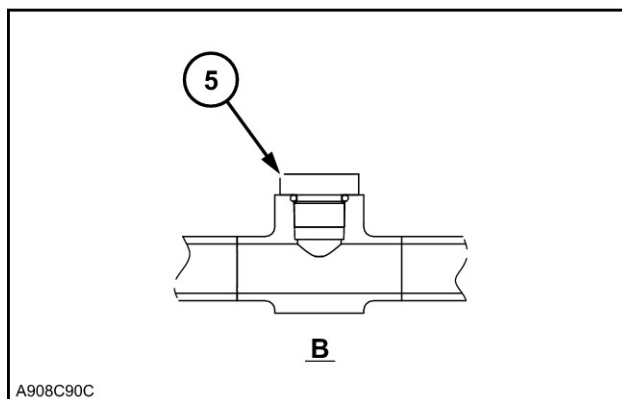

A908C90C 4

4. Serrez l'ensemble conduite (gauche) (10) au moyen de 2 colliers de serrage (3), puis fixez au moyen de 2 vis à rondelle (2).

Fixez le collier de serrage (3) à 285 mm (11.2 in) de l'extrémité avant de l'ensemble conduite (gauche) (10).

Serrez l'ensemble conduite (droit) (9) au moyen de 2 colliers de serrage (3), puis fixez au moyen de 2 vis à rondelle (2).

Fixez le collier de serrage (3) à 285 mm (11.2 in) de l'extrémité avant de l'ensemble conduite (droite) (9).

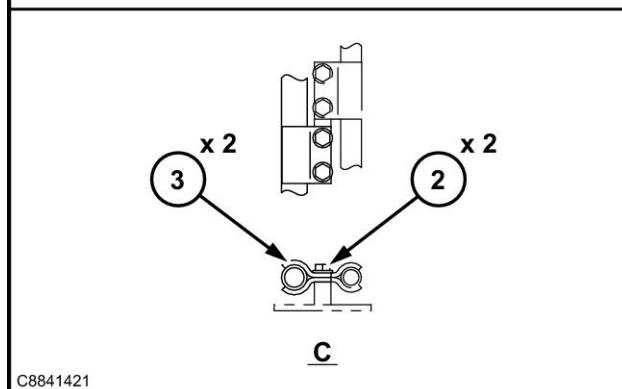
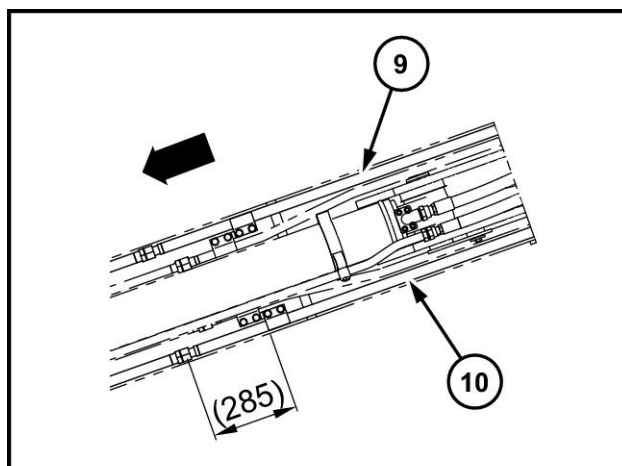

C8841421 5

3. Placez le levier de verrouillage (10) et le ressort de compression (14) sur le support de verrouillage (12), puis fixez-les à l'aide de l'écrou haute résistance (16) et d'une rondelle plate (15).
Installez le levier de verrouillage (10) sur la fente du support de pédale de droite en option (9), puis installez le support de verrouillage (12) sur le plancher avec 2 vis à tête creuse hexagonale (11) et 2 rondelles haute résistance (4).

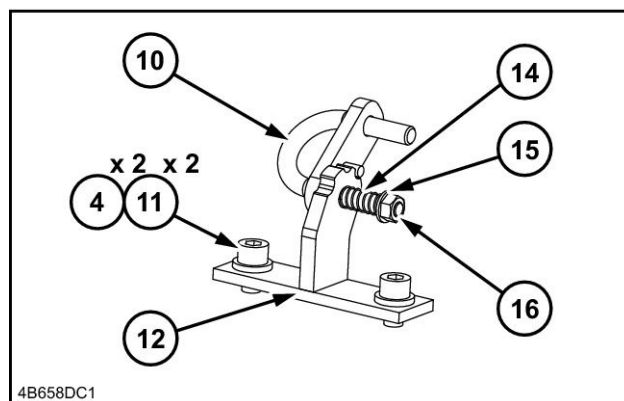

4B658DC1 3

4. Installez le support de pédale de droite en option (13) et la pédale en option (2) avec 2 vis à tête creuse hexagonale (5) et 2 rondelles haute résistance (4). Recouvrez la pédale en option (2) avec le couvercle en plastique (8).

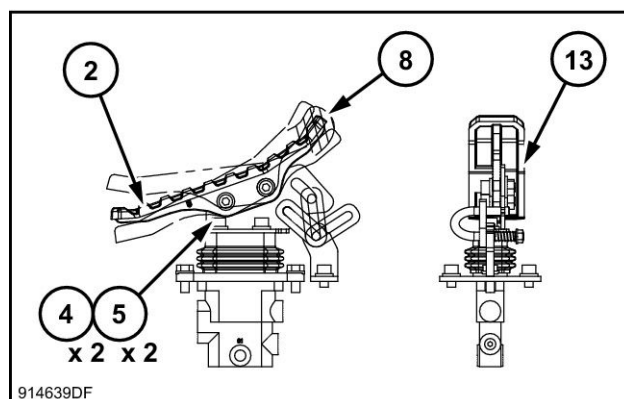

914639DF 4

23. Fixez l'ensemble flexible (**18/Y4**) et l'ensemble flexible (**18/D12**) à l'aide de la vis spéciale (**16**) et attachez au moyen du collier (**17**).
Couple de serrage de la vis :
23.5 - 35.3 N·m (208.0 - 312.4 lb in).

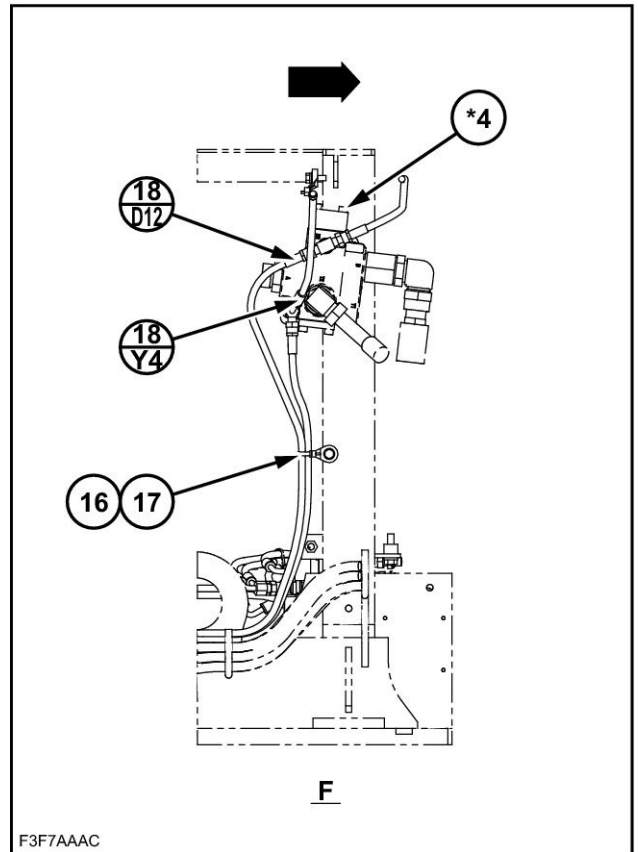

F3F7AAAC

F3F7AAAC 25

24. Mettre en place le pressostat (**6**) sur l'orifice C1 du distributeur à distance (***1**).

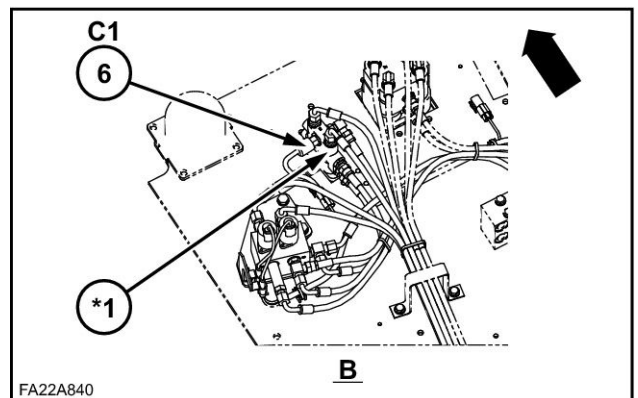

FA22A840

FA22A840 26



INSTALLATIONSANWEISUNG

KG1RP708-00
SATZ FÜR HOCHLEISTUNGSHYDRAULIK

UNGEFÄHRE EINBAUZEIT: 32 Stunden

2. Bringen Sie die Leitungsbaugruppe (links) (10) und die Leitungsbaugruppe (rechts) (9) an der Rohrschelle (11) an, und befestigen Sie sie mit der hochfesten Schraube (12) und der hochfesten Unterlegscheibe (13).
Befestigen Sie die Rohrschelle (11) in einem Abstand von **176 mm (6.9 in)** vom hinteren Ende der Leitungsbaugruppe (links) (10) und in einem Abstand von **161 mm (6.3 in)** vom Ende der Leitungsbaugruppe (rechts) (9).

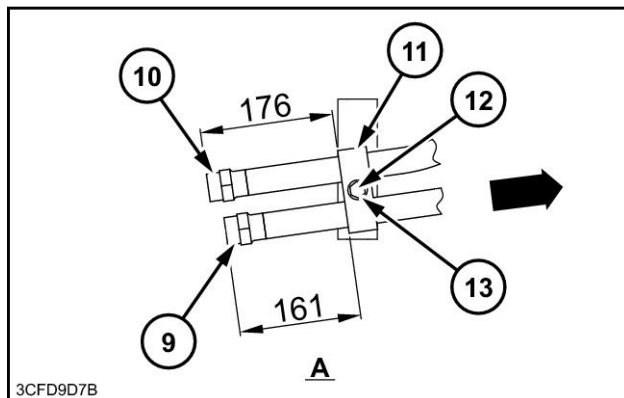

3CFD9D7B 3

3. Montieren Sie je 1 Verschluss (5) an jeder Leitungsbaugruppe (links) (10) und an der Leitungsbaugruppe (rechts) (9).
Anzugsmoment:
153 - 187 N·m (1354.2 - 1655 lb in).

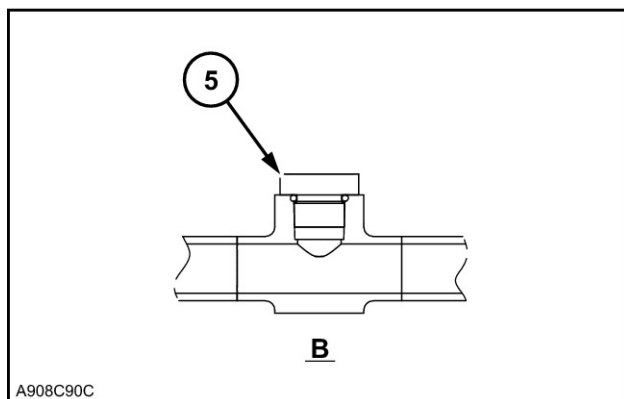

A908C90C 4

4. Setzen Sie die Leitungsbaugruppe (links) (10) zwischen 2 Leitungsklemmen (3), und befestigen Sie sie mit 2 Schrauben mit unverlierbarer Unterlegscheibe (2).
Befestigen Sie die Rohrschelle (3) in einem Abstand von **285 mm (11.2 in)** vom vorderen Ende der Leitungsbaugruppe (links) (10).
Setzen Sie die Leitungsbaugruppe (rechts) (9) zwischen 2 Rohrschellen (3), und befestigen Sie sie mit 2 unverlierbaren Schrauben (2).
Befestigen Sie die Rohrschelle (3) in einem Abstand von **285 mm (11.2 in)** vom vorderen Ende der Leitungsbaugruppe (rechts) (9).

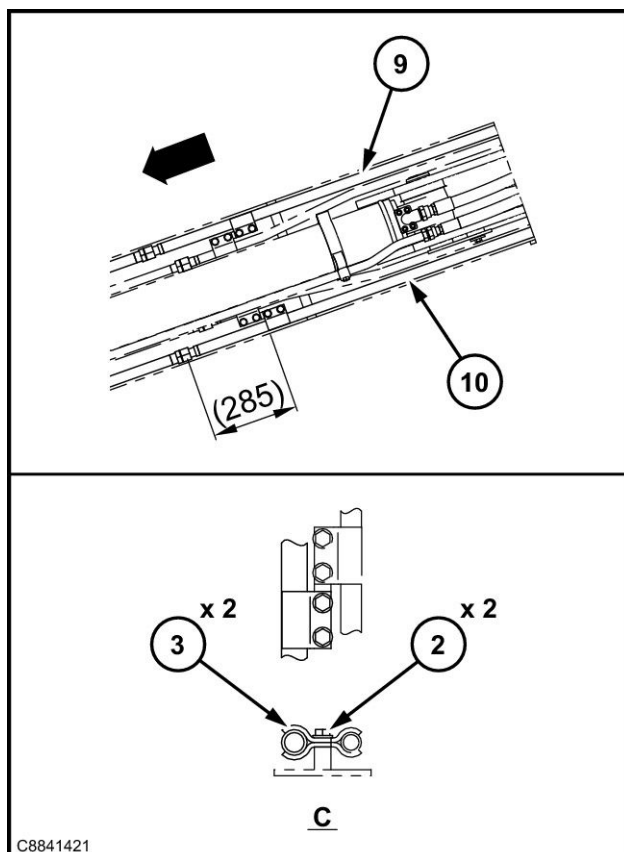

C8841421 5

CLICK HERE TO **DOWNLOAD** THE COMPLETE MANUAL

- Thank you very much for reading the preview of the manual.
- You can download the complete manual from: www.heydownloads.com by clicking the link below



- Please note: If there is no response to CLICKING the link, please download this PDF first and then click on it.

CLICK HERE TO **DOWNLOAD** THE COMPLETE MANUAL

3. Bringen Sie den Verriegelungshebel (10) und die Druckfeder (14) an der Verriegelungshalterung (12) an, und befestigen Sie alles mit der hochfesten Mutter (16) und einer Unterlegscheibe (15).
Montieren Sie den Verriegelungshebel (10) auf den Schlitz der optionalen rechten Pedalhalterung (9), und montieren Sie dann die Verriegelungshalterung (12) am Boden mit 2 Innensechskantschrauben (11) und 2 hochfesten Unterlegscheiben (4).

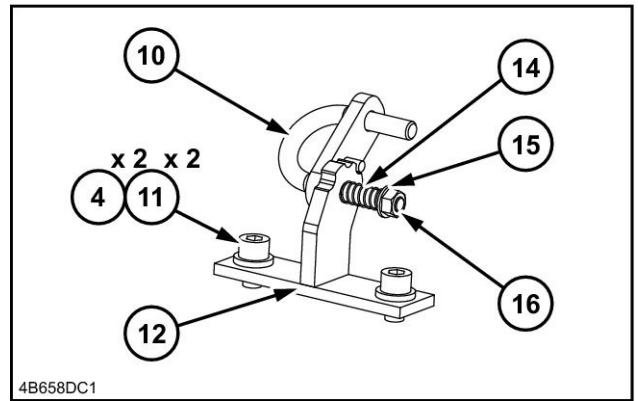

4B658DC1 3

4. Montieren Sie die optionale Pedalhalterung (13) und das optionale Pedal (2) mit 2 Innensechskantschrauben (5) und 2 hochfesten Unterlegscheiben (4).
Decken Sie das optionale Pedal (2) mit der Kunststoffabdeckung (8) ab.

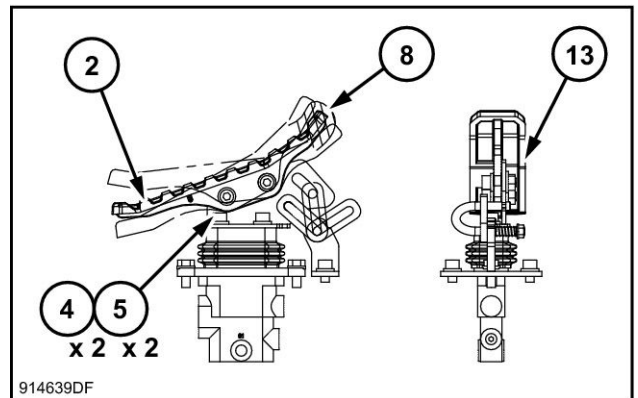

914639DF 4

23. Befestigen Sie den Baugruppenschlauch (18/Y4) und den Baugruppenschlauch (18/D12) mit der Spezialschraube (16) und Schelle mit Band (17).
Schrauben-Anzugsmoment: 23.5 - 35.3 N·m (208.0 - 312.4 lb in).

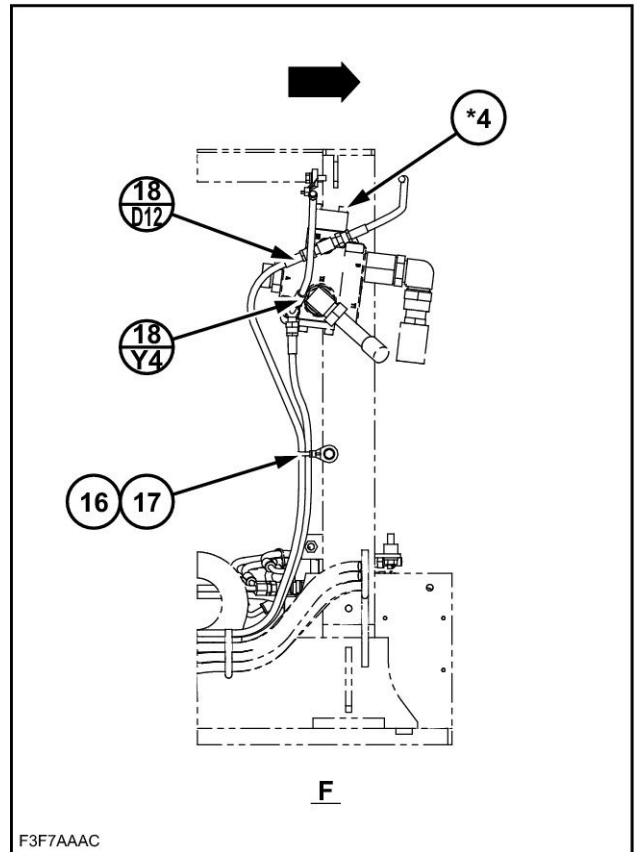

F3F7AAAC 25

24. Den Druckschalter (6) an Anschluss C1 des Fernsteuerventils (*1) anbringen.

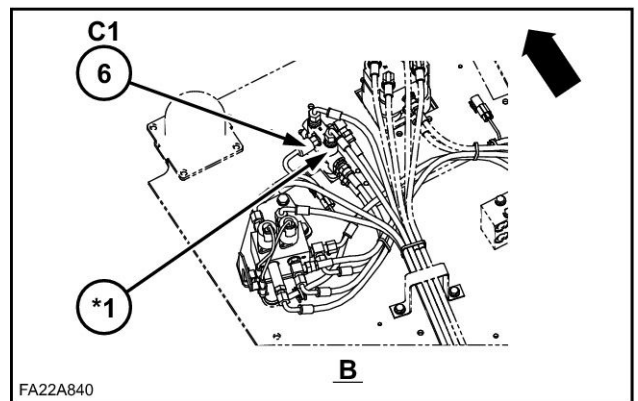

FA22A840 26



INSTRUCCIONES DE INSTALACIÓN

**KG1RP708-00
KIT DE AUMENTO DEL FLUJO HIDRÁULICO**

TIEMPO DE INSTALACIÓN APROXIMADO: 32 horas

2. Sujete el conducto (izquierdo) (10) y el conducto (derecho) (9) con la brida (11) y, a continuación, sujételos con el perno (12) y la arandela (13) de alta resistencia.

Coloque la brida (11) a **176 mm (6.9 in)** del extremo trasero del conducto (izquierdo) (10) y a **161 mm (6.3 in)** del extremo del conducto (derecho) (9).

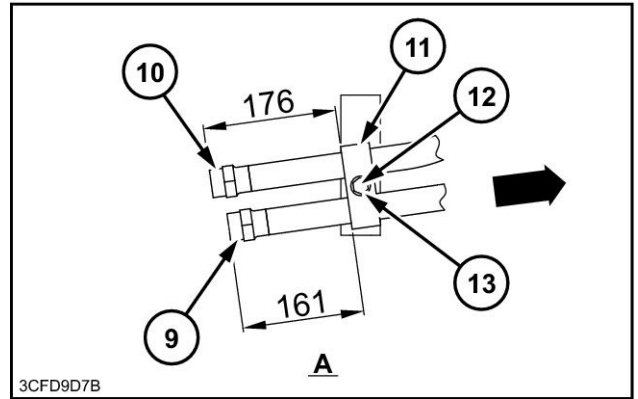

3CFD9D7B

3CFD9D7B 3

3. Monte 1 tapón (5) tanto en el conducto (izquierdo) (10) como en el conducto (derecho) (9).

Par de apriete:

153 - 187 N·m (1354.2 - 1655 lb in).

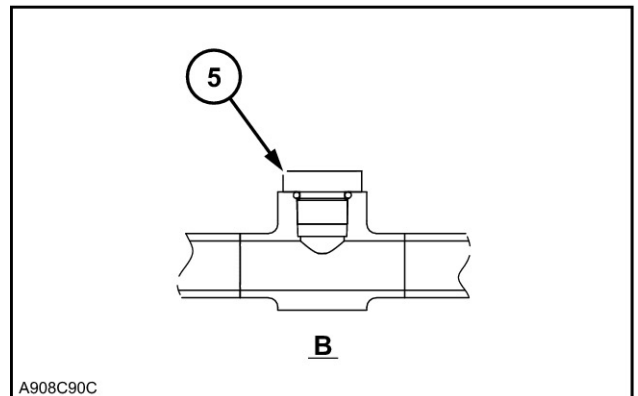

A908C90C

A908C90C 4

4. Sujete el conducto (izquierdo) (10) con 2 bridas (3) y, a continuación, fíjelo con 2 pernos SEMS (2).

Coloque la brida (3) a **285 mm (11.2 in)** del extremo frontal del conducto (izquierdo) (10).

Sujete el conducto (derecho) (9) con 2 bridas (3) y, a continuación, fíjelo con 2 pernos SEMS (2).

Coloque la brida (3) a **285 mm (11.2 in)** del extremo frontal del conducto (derecho) (9).

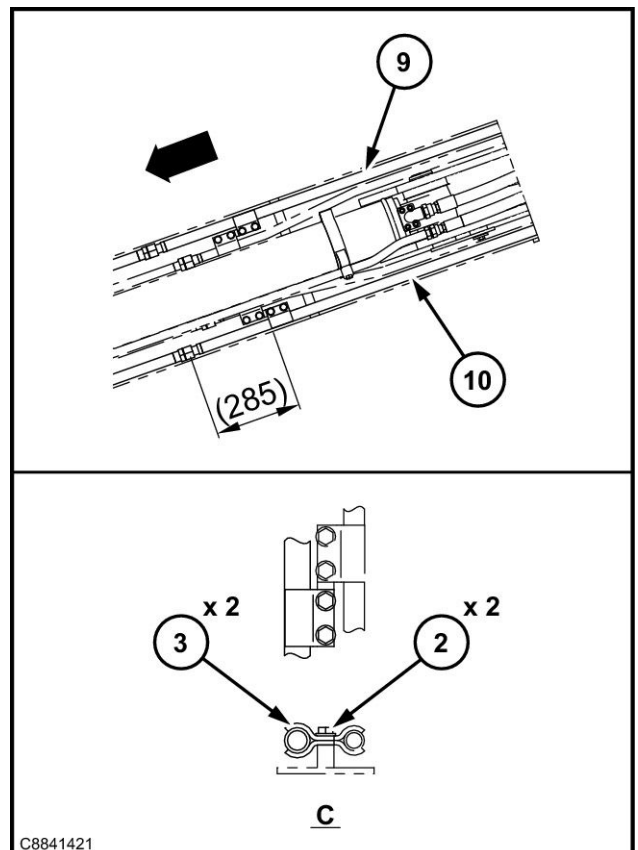

C8841421

C8841421 5

3. Coloque la palanca de bloqueo (10) y el muelle (14) en el soporte de bloqueo (12) y, a continuación, fíjelos con la tuerca de alta resistencia (16) y la arandela plana (15).
 Introduzca la palanca de bloqueo (10) en la ranura del soporte del pedal derecho opcional (9) y, a continuación, monte el soporte de bloqueo (12) en el suelo con 2 pernos hexagonales (11) y 2 arandelas de alta resistencia (4).

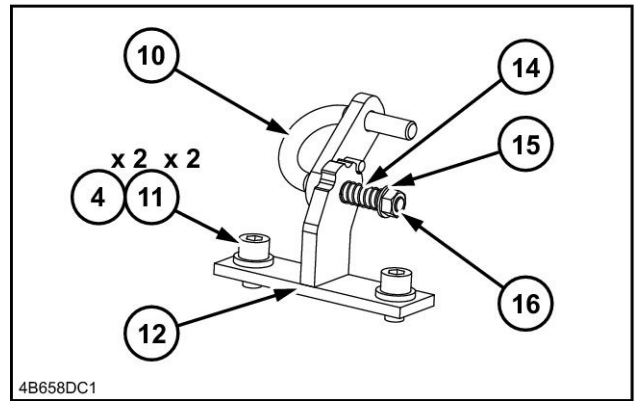

4B658DC1 3

4. Monte el soporte del pedal opcional (13) y el pedal opcional (2) con 2 pernos hexagonales (5) y 2 arandelas de alta resistencia (4).
 Cubra el pedal opcional (2) con la tapa de plástico (8).

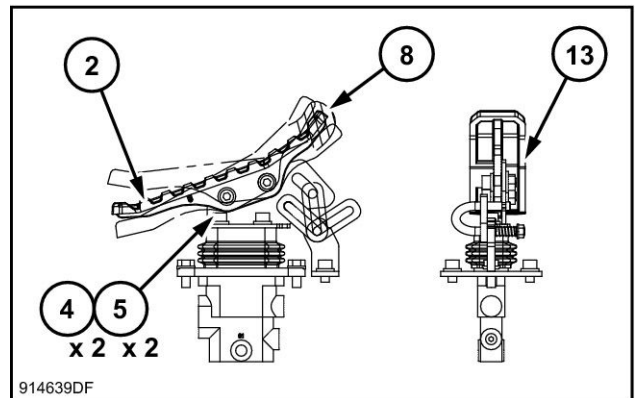

914639DF 4

23. Sujete las mangueras (18/Y4) y (18/D12) con el perno especial (16) y con la brida (17).
Bolt tightening torque:
23.5 - 35.3 N·m (208.0 - 312.4 lb in).

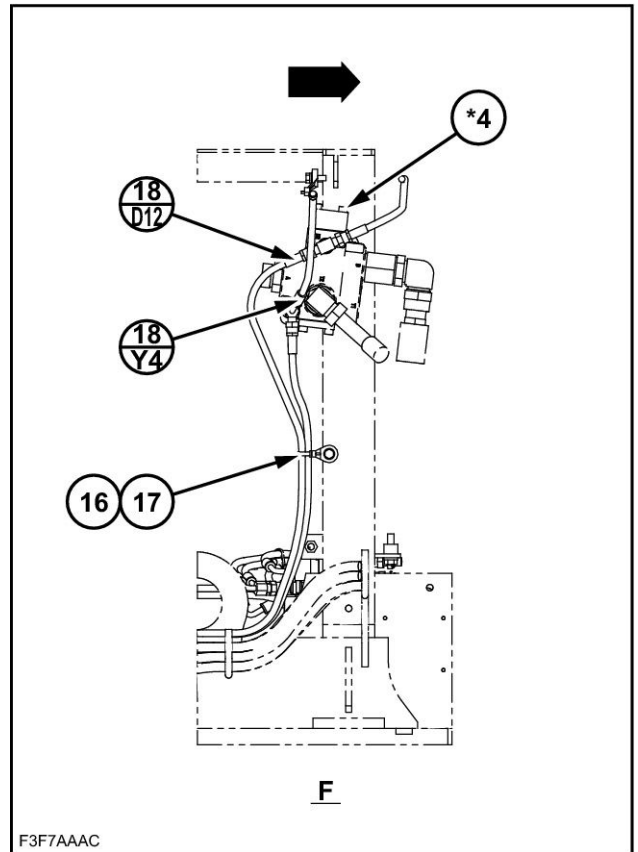

F3F7AAAC

F3F7AAAC 25

24. Instale el presostato (6) en el puerto C1 de la válvula de control remoto (*1).

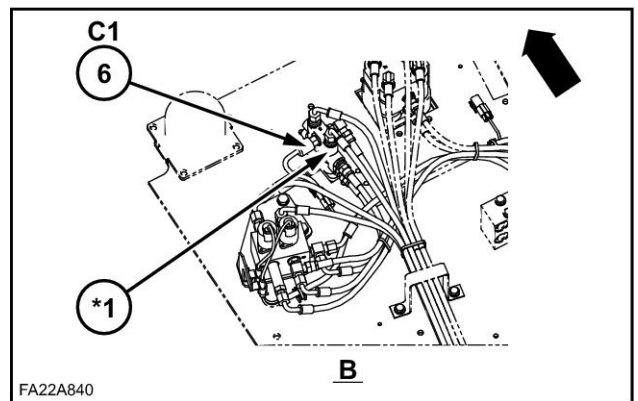

FA22A840

FA22A840 26



ISTRUZIONI DI MONTAGGIO

**KG1RP708-00
KIT IDRAULICO AD ALTA PORTATA.**

TEMPO DI MONTAGGIO APPROSSIMATIVO: 32 ore

2. Posizionare il complessivo tubazione (sinistra) (10) e il complessivo tubazione (destra) (9) sulla fascetta stringitubo (11), quindi serrare con il bullone ad alta resistenza (12) e la rondella ad alta resistenza (13). Fissare la fascetta stringitubo (11) su un punto a **176 mm (6.9 in)** dall'estremità posteriore del complessivo tubazione (sinistro) (10) e **161 mm (6.3 in)** dall'estremità del complessivo tubazione (destra) (9).

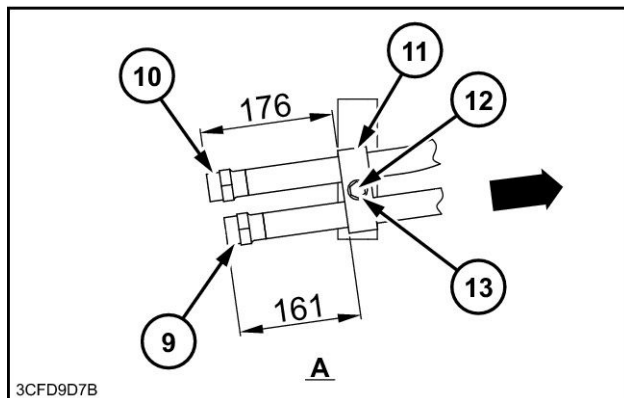

3. Montare 1 tappo (5) sul complessivo tubazione (sinistra) (10) e 1 tappo sul complessivo tubazione (destra) (9).
Coppia di serraggio:
153 - 187 N·m (1354.2 - 1655 lb in).

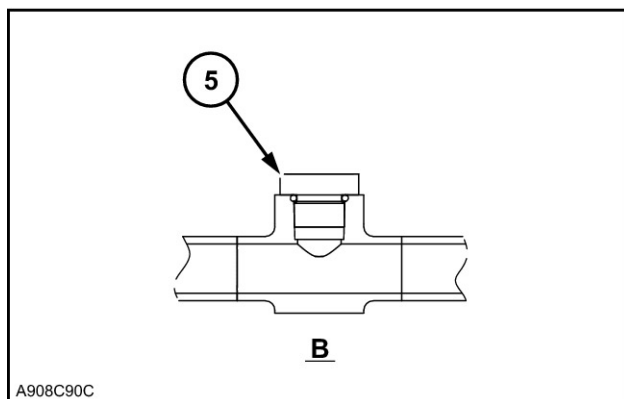

4. Inserire il complessivo tubazione (lato sinistro) (10) con 2 fascette stringitubo (3) e serrare con 2 bulloni tipo Sems (2). Fissare la fascetta stringitubo (3) su un punto a **285 mm (11.2 in)** dall'estremità anteriore del complessivo tubazione (sinistro) (10). Inserire il complessivo tubazione (destra) (9) con 2 fascette stringitubo (3) e serrare con 2 bulloni tipo Sems (2). Fissare la fascetta stringitubo (3) su un punto a **285 mm (11.2 in)** dall'estremità anteriore del complessivo tubazione (destra) (9).

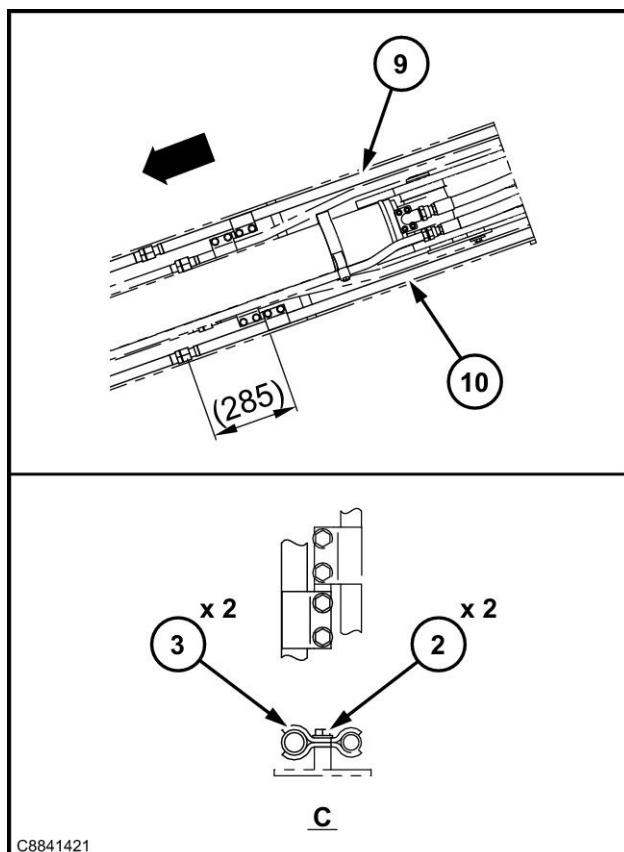

3. Porre la leva di bloccaggio (10) e la molla a compressione (14) sulla staffa di blocco (12), quindi serrare con il dado ad alta resistenza (16) e le rondelle piane (15).

Montare la leva di bloccaggio (10) sulla scanalatura della staffa del pedale destro opzionale, (9), quindi montare la staffa di blocco (12) sul pianale con 2 bulloni a testa esagonale incassata (11) e 2 rondelle ad alta resistenza (4).

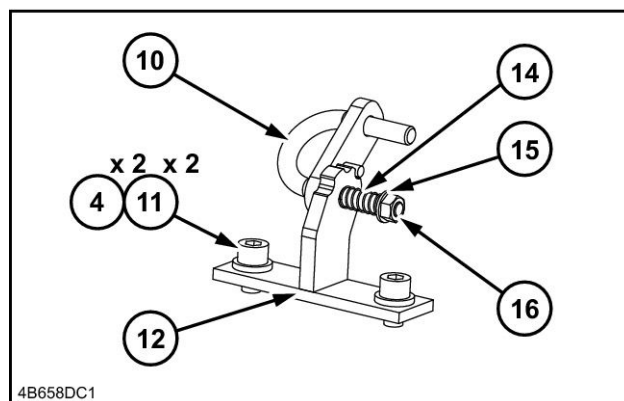

4B658DC1 3

4. Montare la staffa del pedale opzionale (13) e il pedale opzionale (2) con 2 bulloni a testa esagonale incassata (5) e 2 rondelle ad alta resistenza (4). Coprire il pedale opzionale (2) con il coperchio in plastica (8).

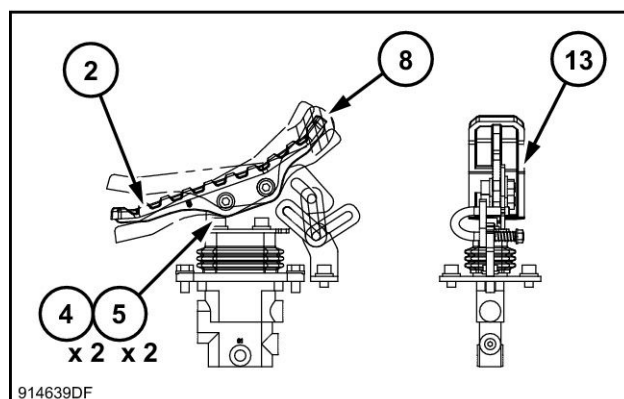

914639DF 4

23. Fissare il flessibile del complessivo (18/Y4) e il flessibile del complessivo (18/D12) con il bullone speciale (16) e fissarlo con un nastro (17).
Coppia di serraggio delle viti: 23.5 - 35.3 N·m (208.0 - 312.4 lb in).

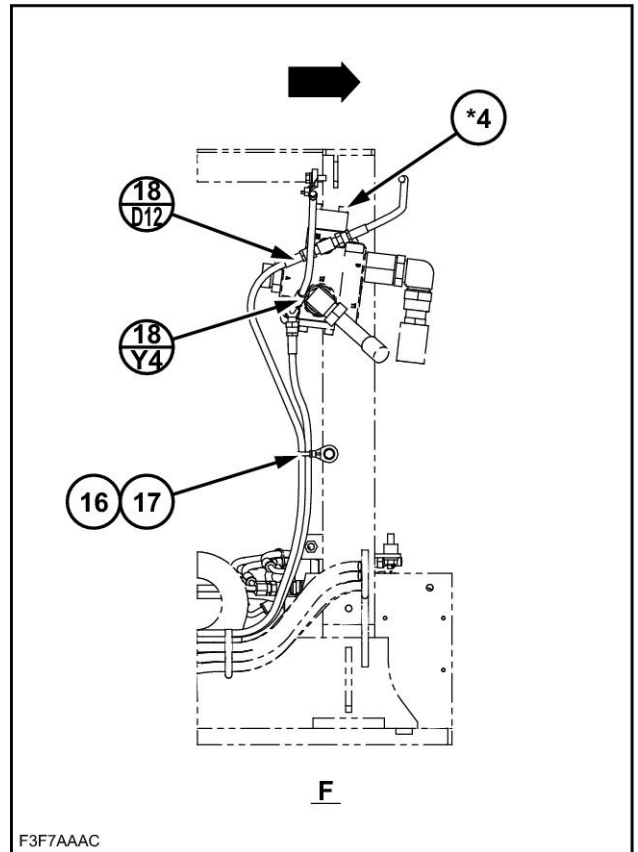

F3F7AAAC

F3F7AAAC 25

24. Montare il pressostato (6) sul foro C1 del comando remoto (*1).

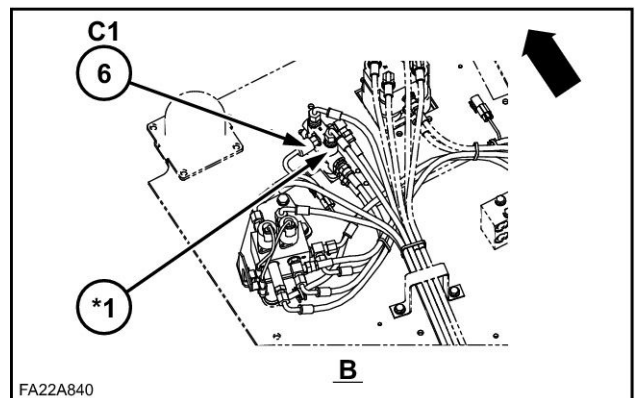

FA22A840

FA22A840 26

CLICK HERE TO **DOWNLOAD** THE COMPLETE MANUAL

- Thank you very much for reading the preview of the manual.
- You can download the complete manual from: www.heydownloads.com by clicking the link below



- Please note: If there is no response to CLICKING the link, please download this PDF first and then click on it.

CLICK HERE TO **DOWNLOAD** THE COMPLETE MANUAL