



INSTALLATION INSTRUCTIONS

KG1NP106-00
HOSE BURST CHECK VALVE (HBCV) KIT

APPROXIMATE INSTALLATION TIME: 8.0 hours

CLICK HERE TO **DOWNLOAD** THE COMPLETE MANUAL

- Thank you very much for reading the preview of the manual.
- You can download the complete manual from: www.heydownloads.com by clicking the link below



- Please note: If there is no response to CLICKING the link, please download this PDF first and then click on it.

CLICK HERE TO **DOWNLOAD** THE COMPLETE MANUAL

Installation on Right-hand Boom Cylinder

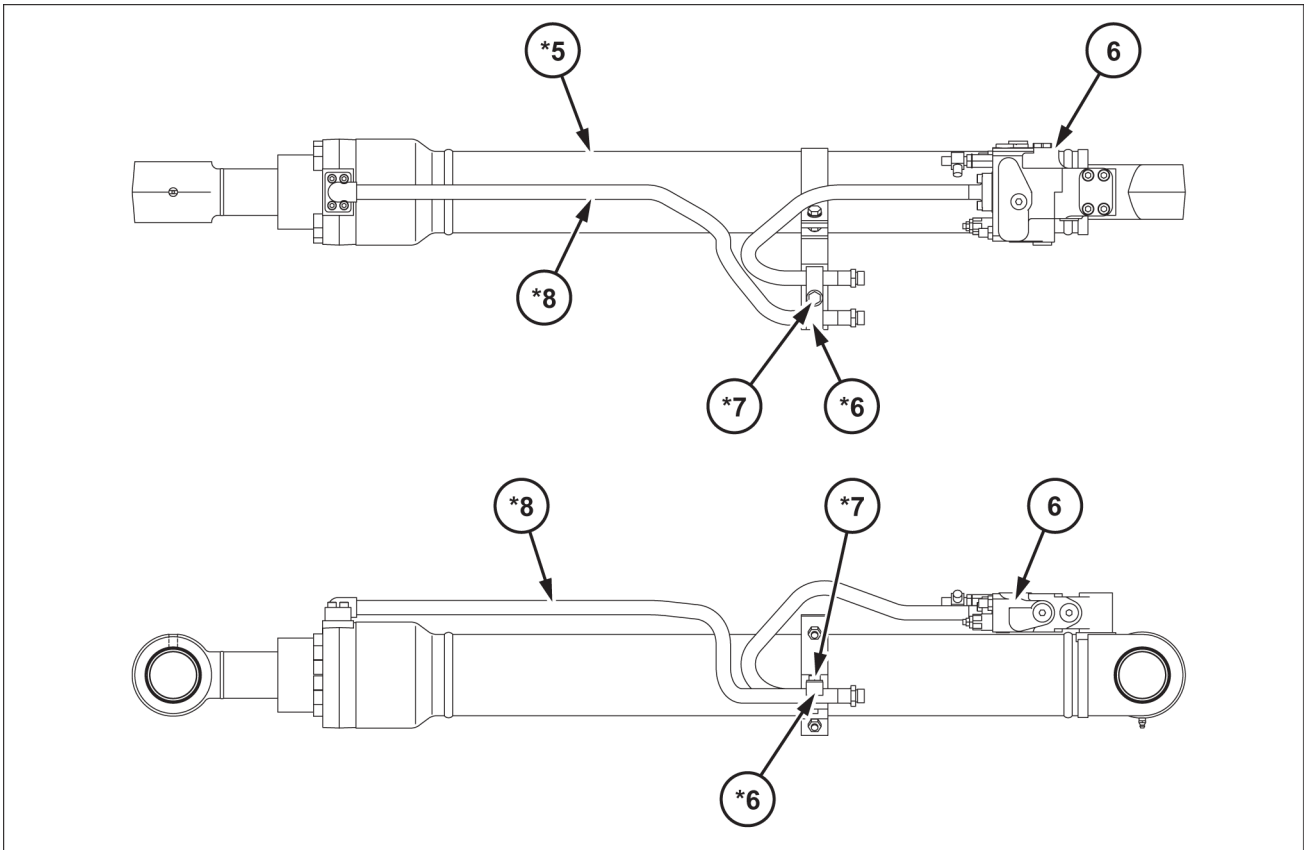

SMIL15CEX8764FB 4

1. Remove the bolt (M10×1.5) (*7), and then remove the clamp (*6).
Set the O-ring (9) on the holding valve (6), and then install on the boom cylinder (right) (*5) with four hexagon socket head bolts (7).
 - Tightening torque: **41.6 - 60.8 N·m (30.683 - 44.844 lb ft)**

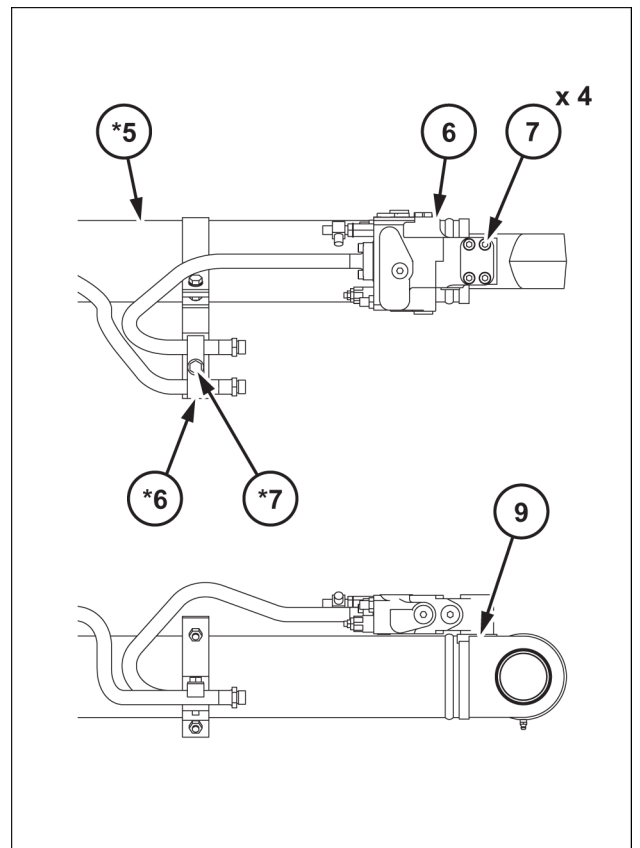

SMIL15CEX8765BB 5

Pilot line installation

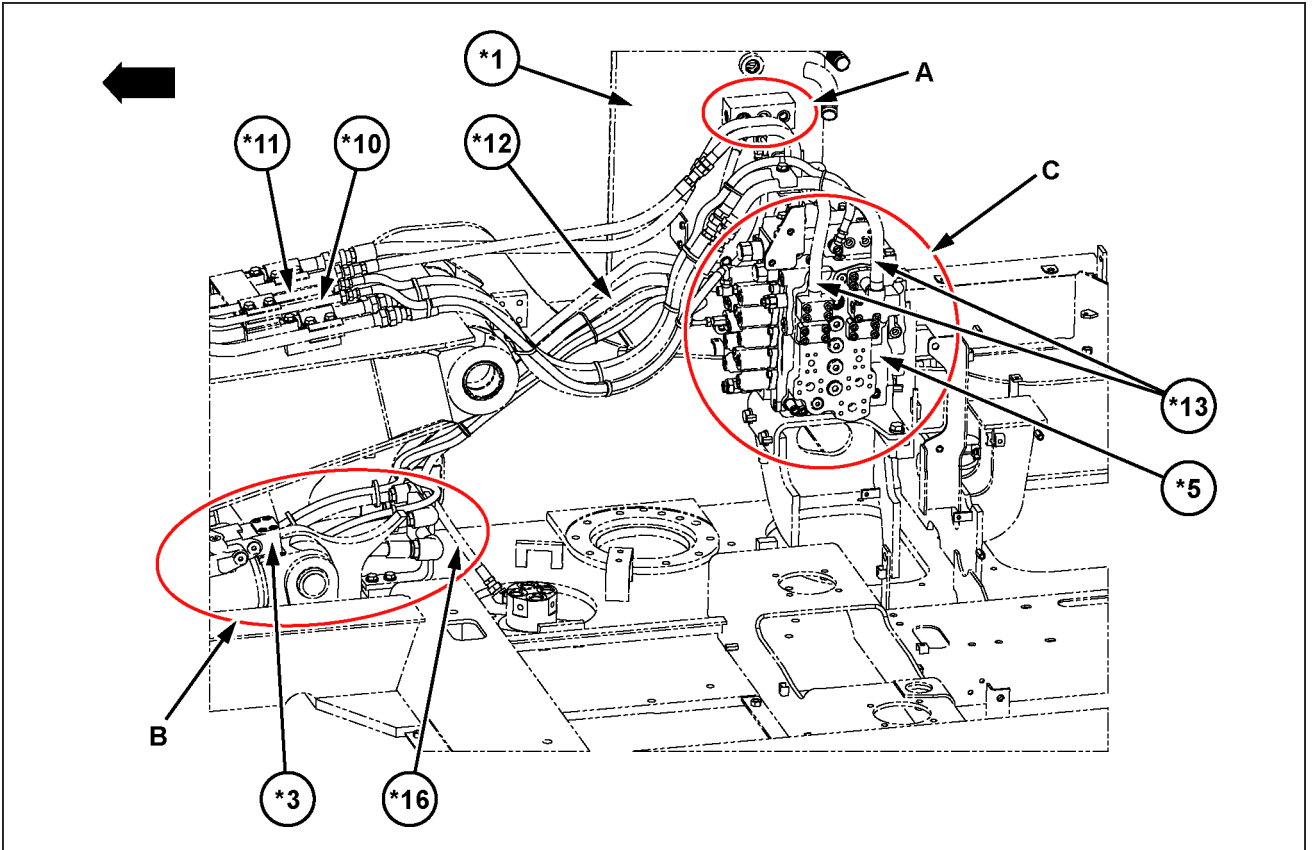

SML15CEXX822FB 1

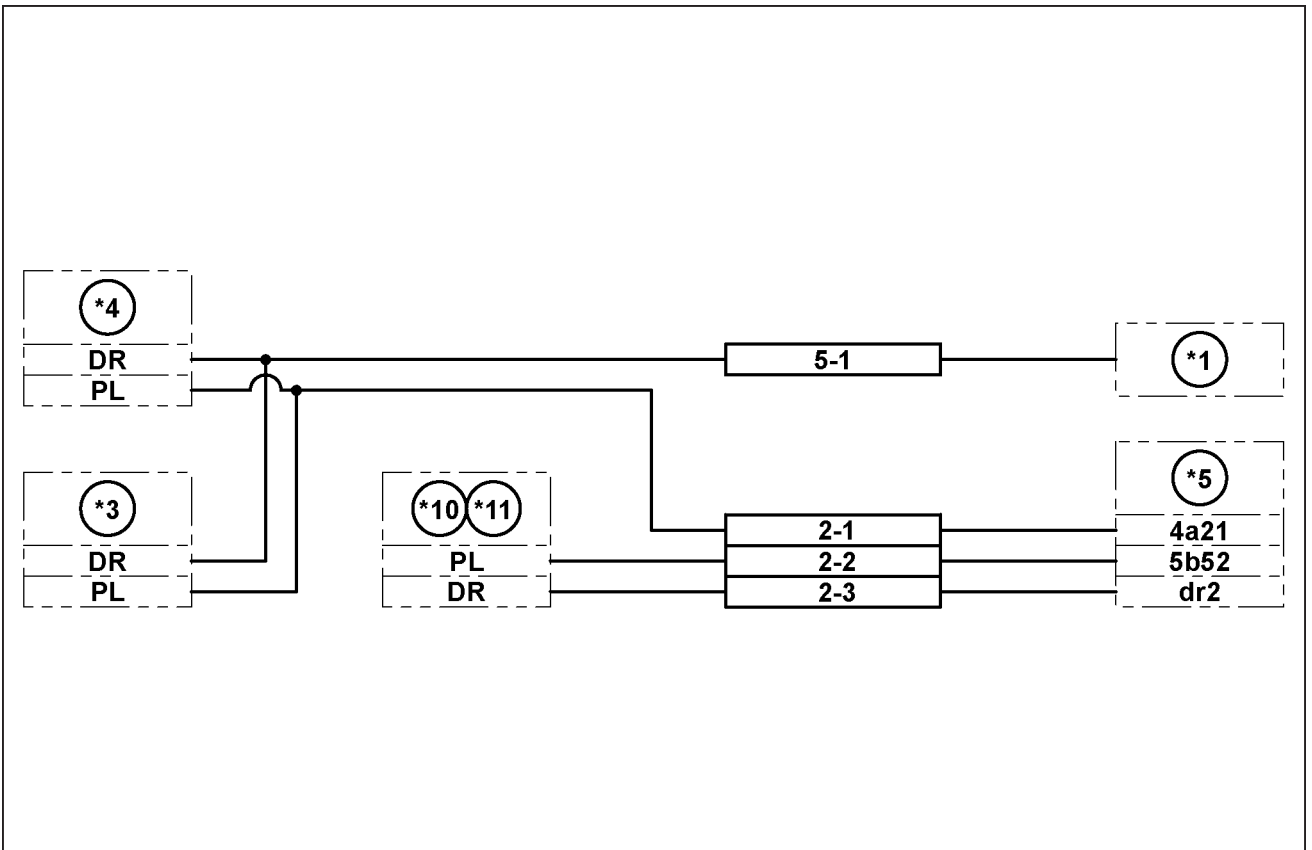

SML15CEXX823FB 2



INSTALLATIONSANWEISUNG

KG1NP106-00

MONTAGESATZ SCHLAUCHRISSE-RÜCKSCHLAGVENTIL (HBCV)

UNGEFÄHRE EINBAUZEIT: 8.0 Stunden

Montage am rechten Auslegerzylinder

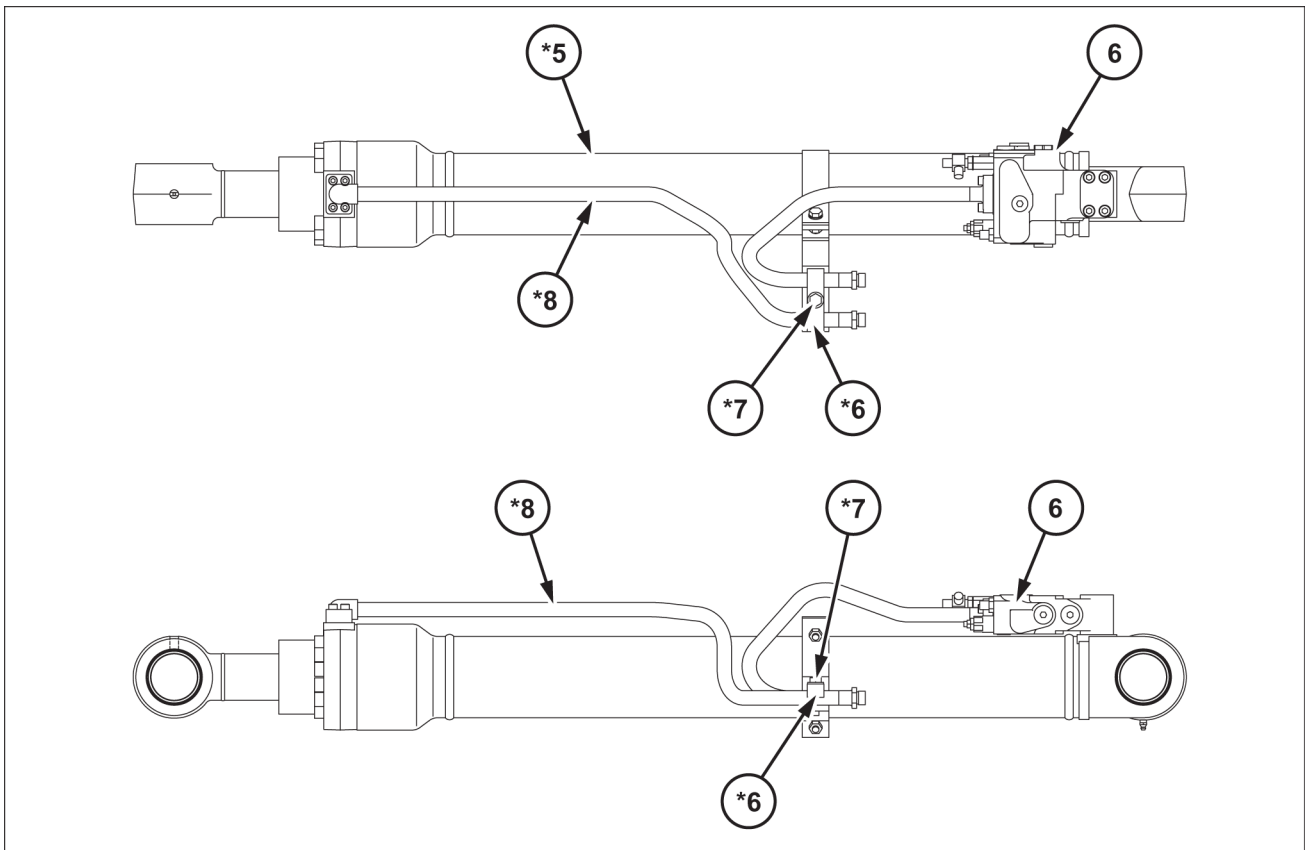

SMIL15CEX8764FB 4

1. Die Schraube (M10×1.5) (*7) herausdrehen und die Schelle (*6) entfernen. Bringen Sie den O-Ring (9) am Lasthalteventil (6) an, und montieren Sie dann das Ventil am Auslegerzylinder (rechts) (*5) mit 4 Innensechskantschrauben (7).
 - Anzugsmoment: **41.6 - 60.8 N·m (30.683 - 44.844 lb ft)**

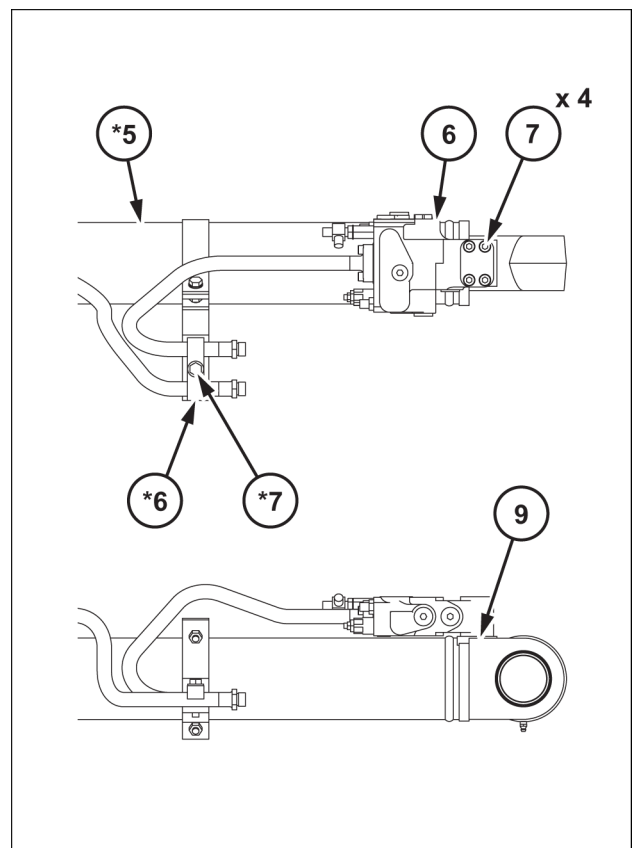

SMIL15CEX8765BB 5

Einbau der Vorsteuerleitung

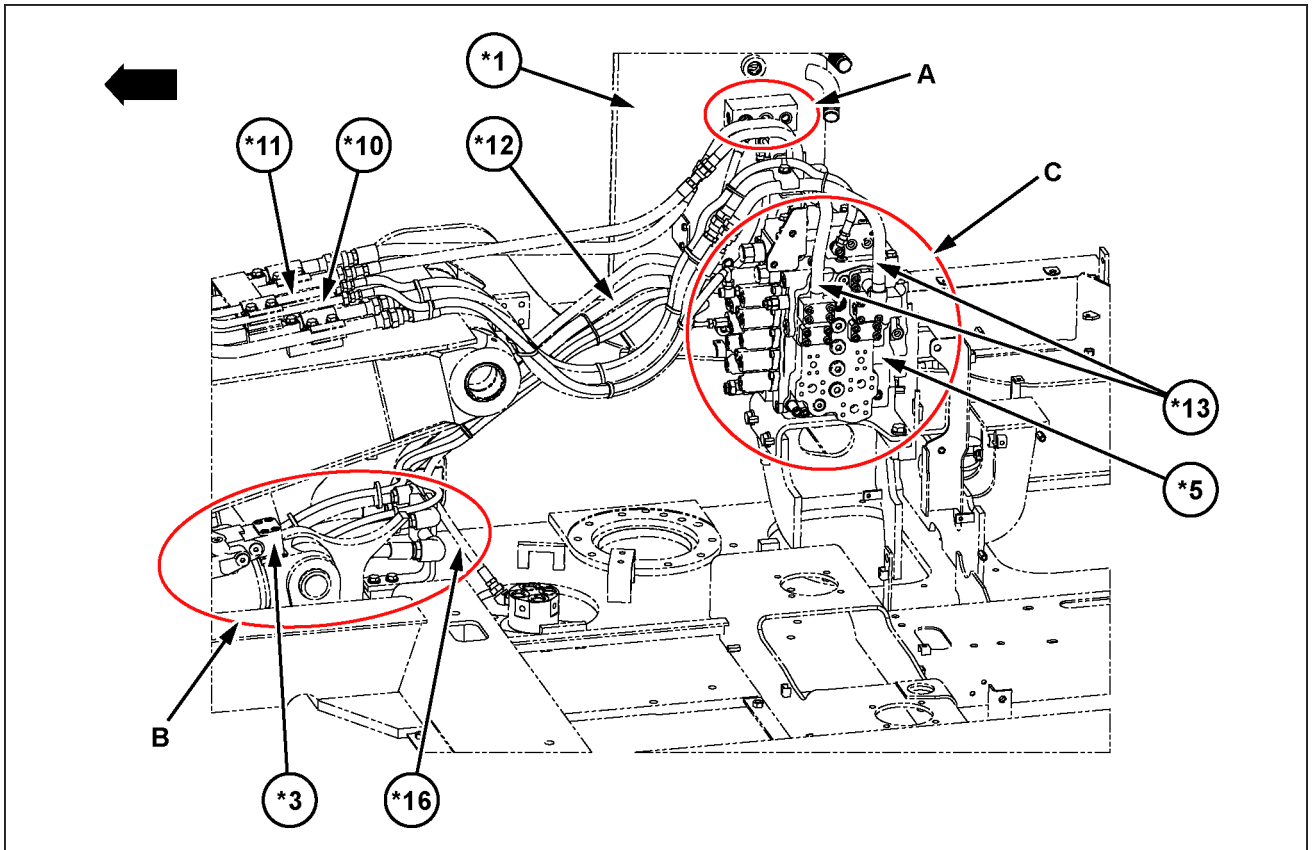

SMIL15CEXX822FB 1

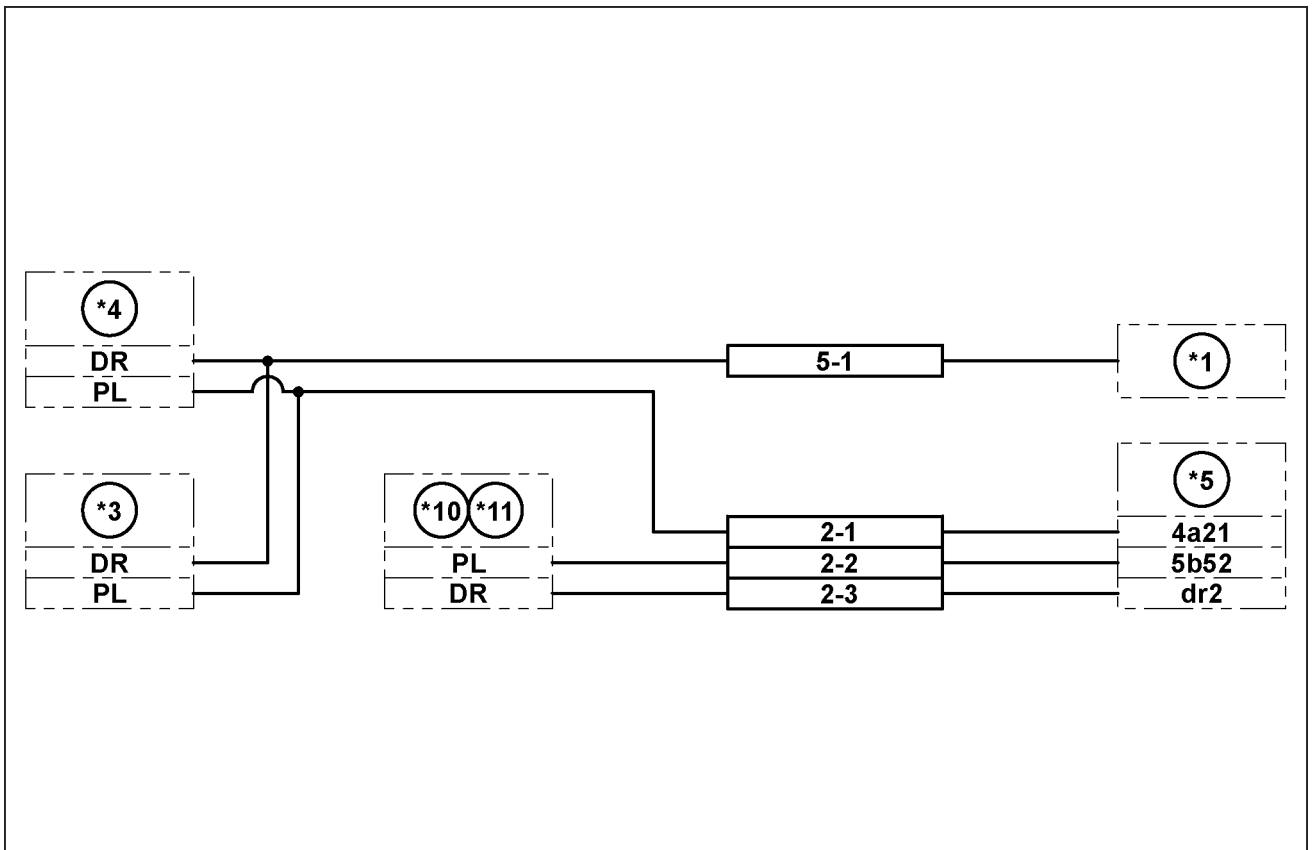

SMIL15CEXX823FB 2



INSTRUCTIONS D'INSTALLATION

KG1NP106-00

KIT DE CLAPETS ANTI-RETOUR EN CAS DE RUPTURE DE FLEXIBLE (HBCV)

TEMPS D'INSTALLATION APPROXIMATIF : 8.0 heure(s)

CLICK HERE TO **DOWNLOAD** THE COMPLETE MANUAL

- Thank you very much for reading the preview of the manual.
- You can download the complete manual from: www.heydownloads.com by clicking the link below



- Please note: If there is no response to CLICKING the link, please download this PDF first and then click on it.

CLICK HERE TO **DOWNLOAD** THE COMPLETE MANUAL

Installation sur le vérin de flèche droit

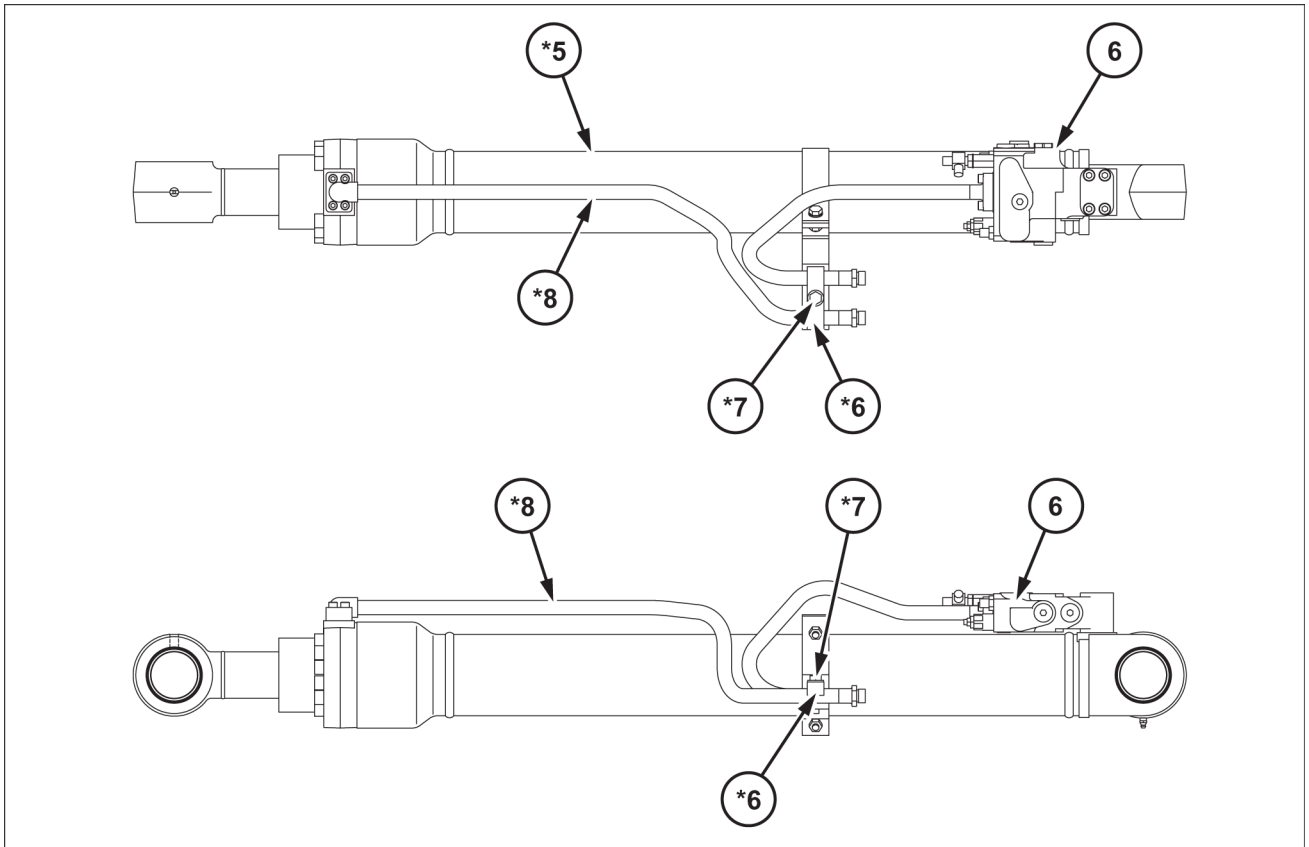

SMIL15CEX8764FB 4

- Retirer la vis (M10×1,5) (*7), puis le collier (*6). Placer le joint torique (9) sur la soupape de maintien (6), puis l'installer sur le vérin de flèche (droite) (*5) à l'aide de quatre vis à six pans creux (7).
 - Couple de serrage : **41.6 - 60.8 N·m (30.683 - 44.844 lb ft)**

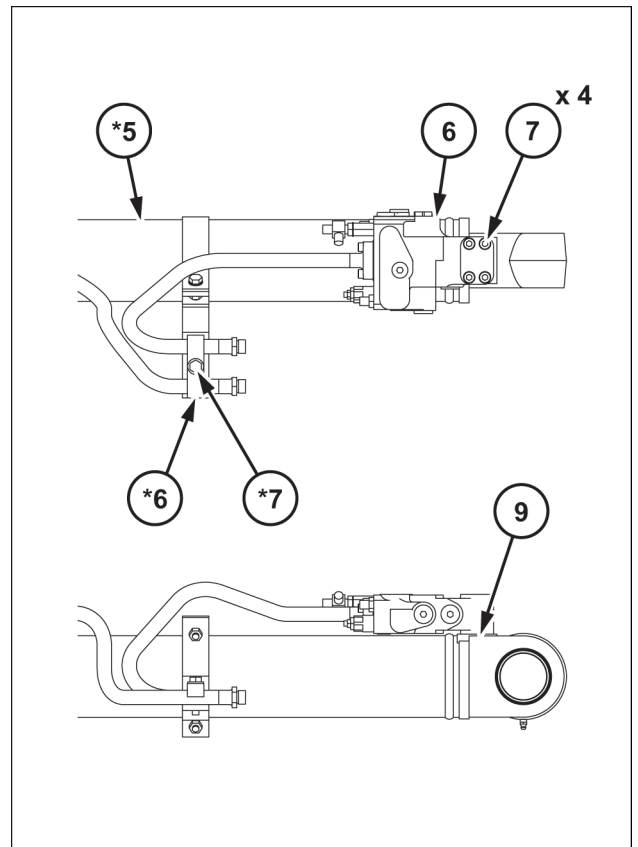

SMIL15CEX8765BB 5

Installation de la conduite pilote

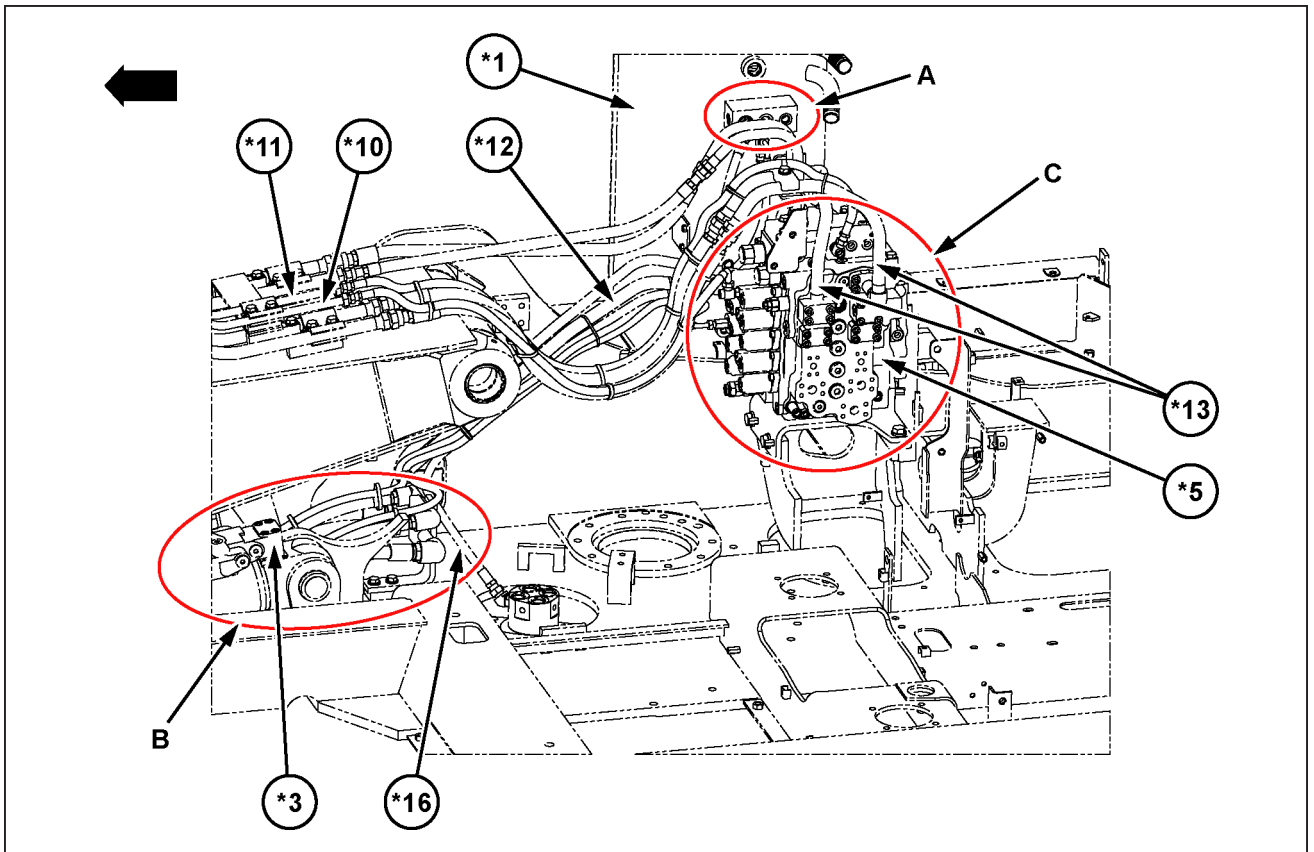

SMIL15CEXX822FB 1

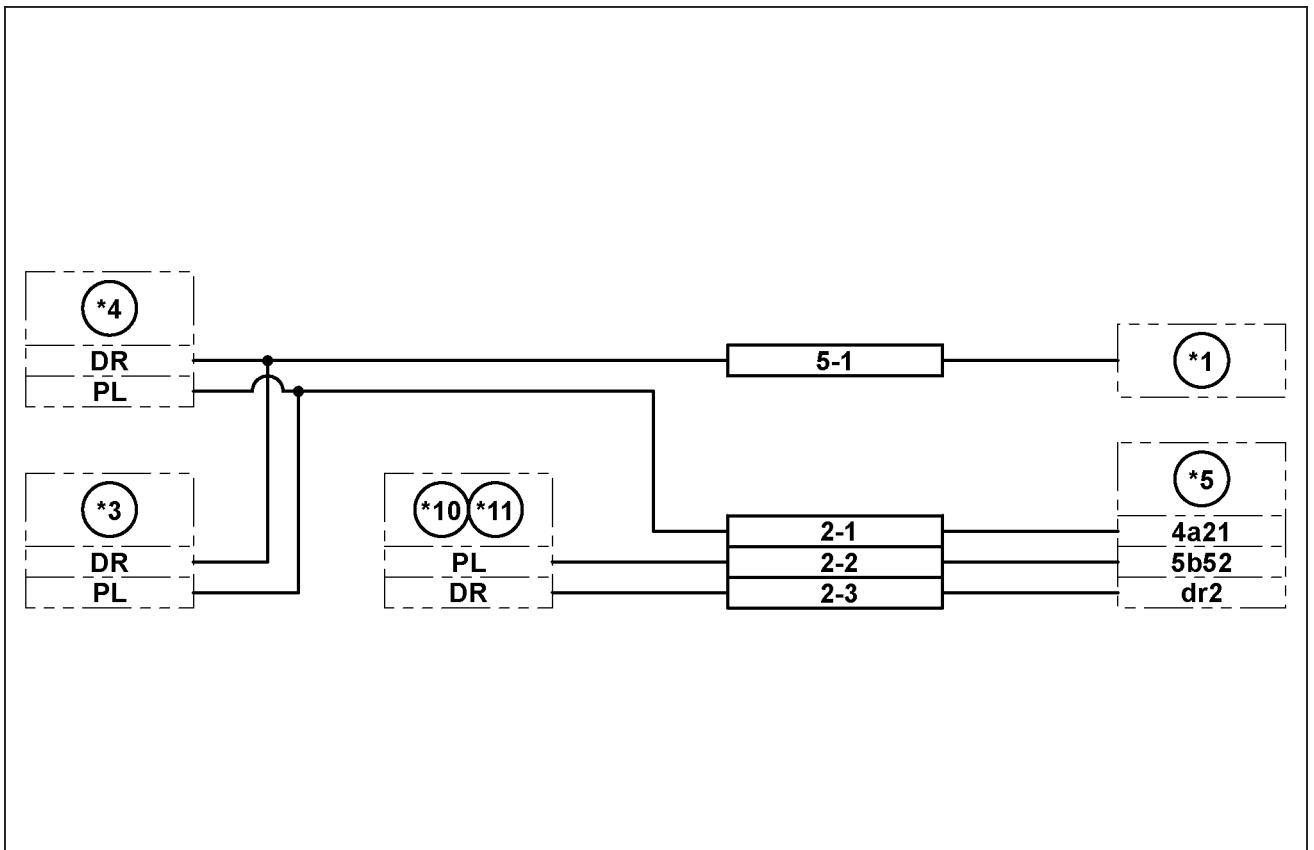

SMIL15CEXX823FB 2



ISTRUZIONI DI INSTALLAZIONE

KG1NP106-00
KIT VALVOLE DI RITEGNO SCOPPIO FLESSIBILI (HBCV)

TEMPO DI MONTAGGIO APPROSSIMATIVO: 8.0 ore

Montaggio sul cilindro destro del braccio

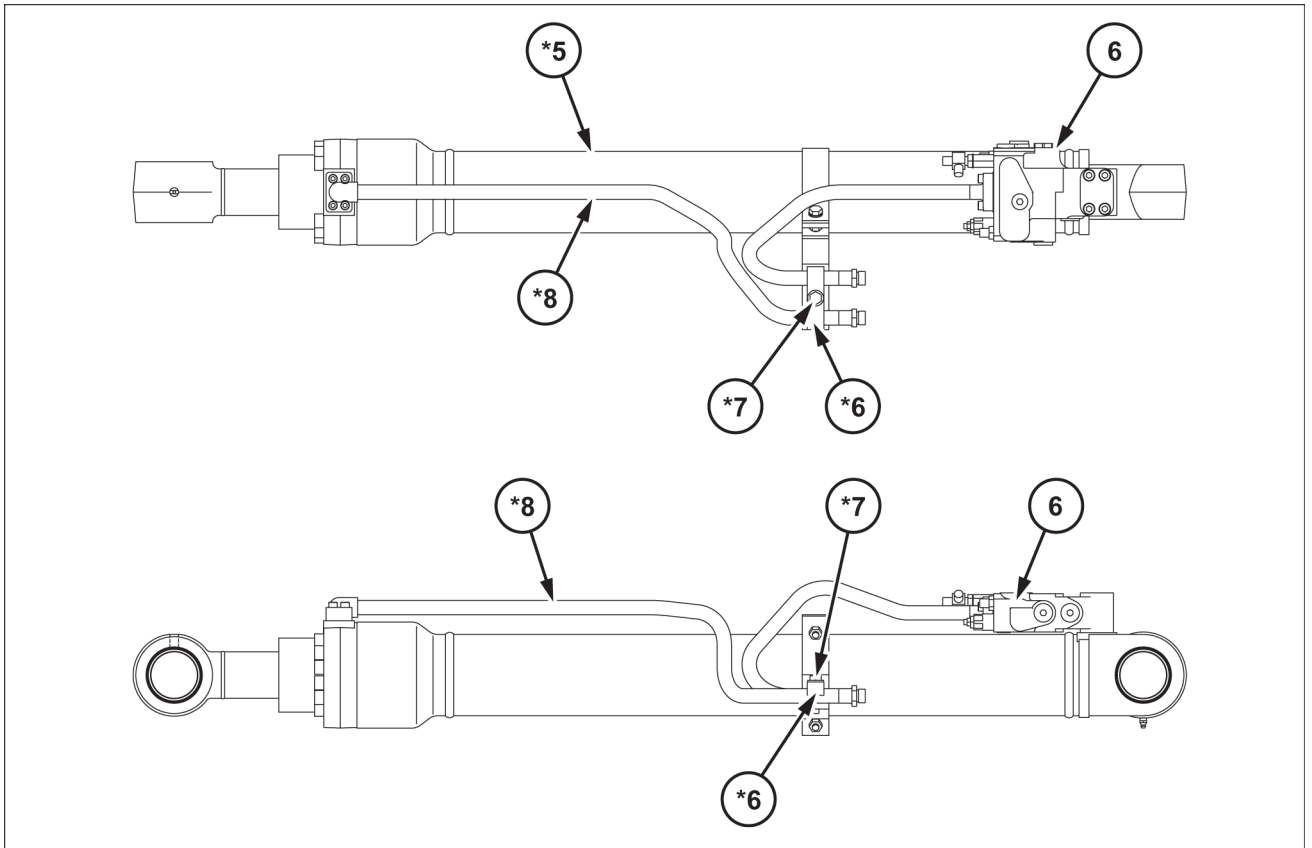

SMIL15CEX8764FB 4

1. Rimuovere il bullone (M10 x 1,5) (*7), quindi rimuovere la fascetta (*6).
Inserire l'O-ring (9) sulla valvola di ritegno (6), quindi montarlo sul cilindro del braccio (lato destro) (*5) con 4 viti a brugola (7).

- Coppia di serraggio: **41.6 - 60.8 N·m (30.683 - 44.844 lb ft)**

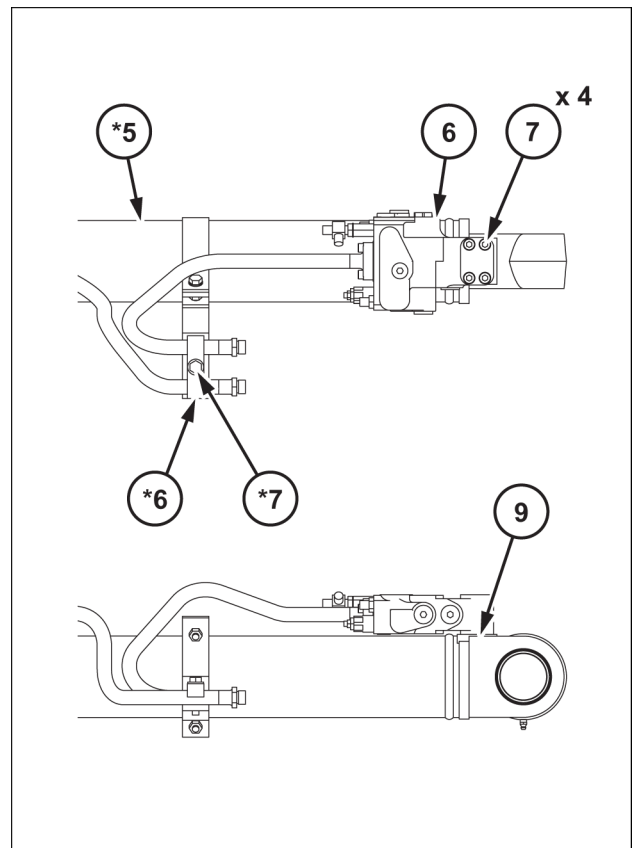

SMIL15CEX8765BB 5

Montaggio della tubazione pilota

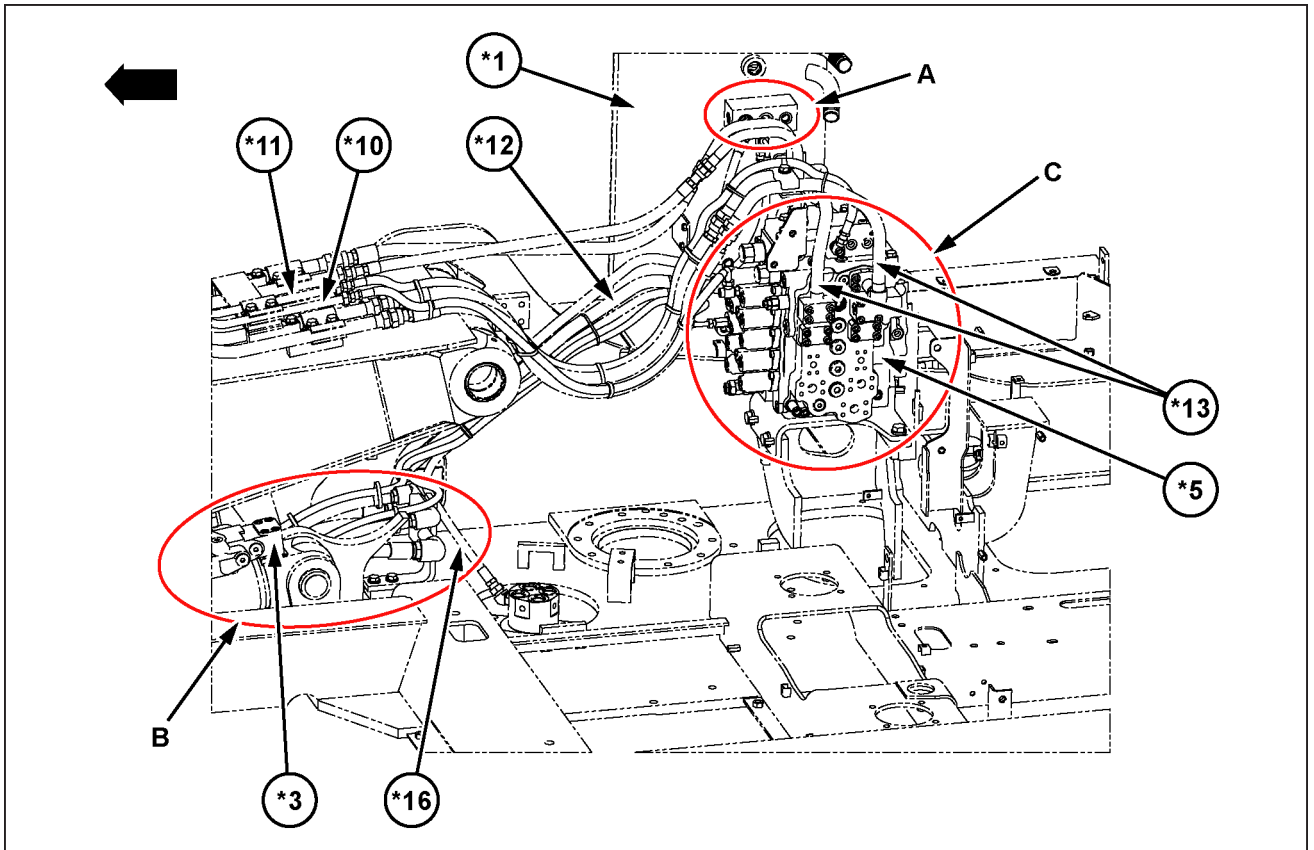

SMIL15CEXX822FB 1

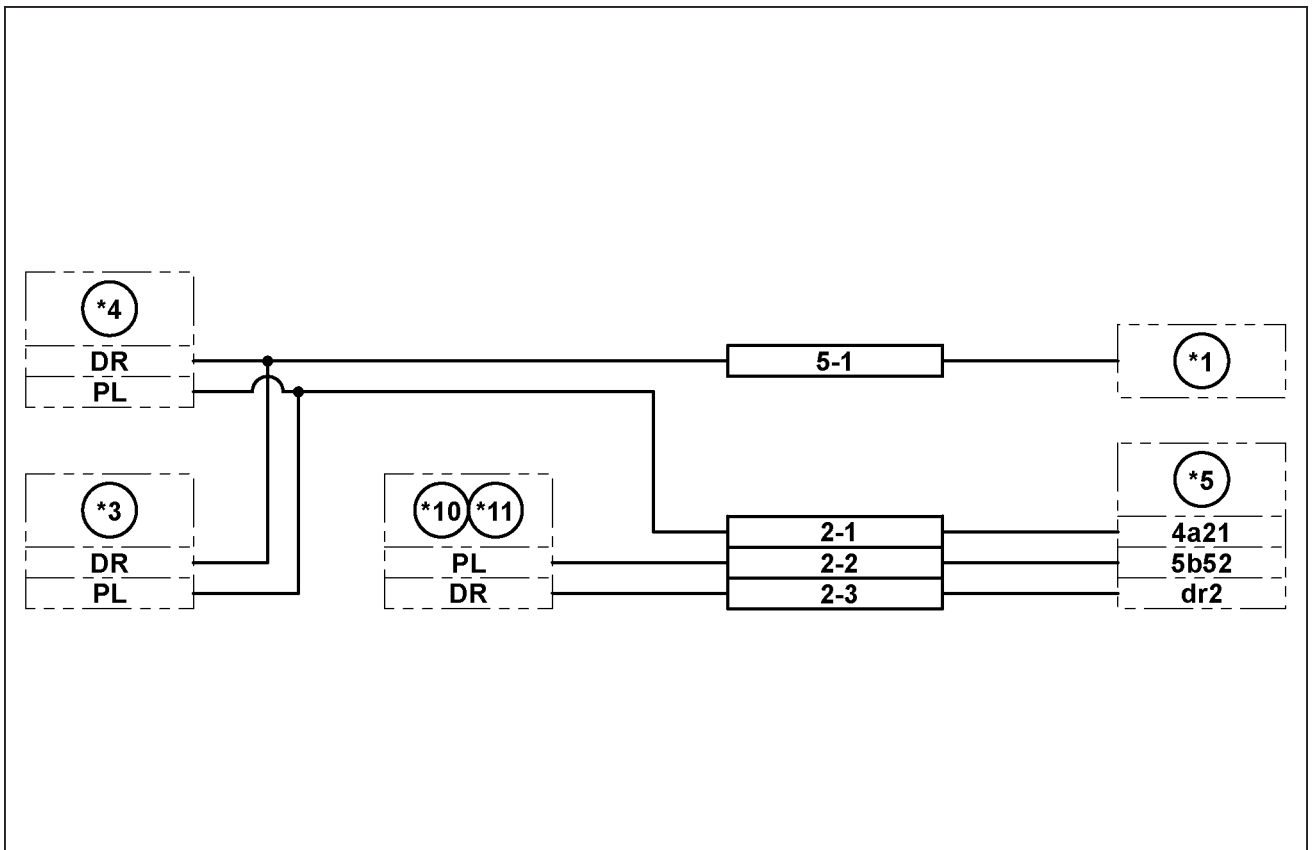

SMIL15CEXX823FB 2



INSTRUCCIONES DE INSTALACIÓN

KG1NP106-00

**KIT DE VÁLVULA DE RETENCIÓN ANTIEXPLOSIONES DE MANGUERAS
(HBCV)**

TIEMPO DE INSTALACIÓN APROXIMADO: 8.0 horas

Instalación en el cilindro de la pluma del lado derecho

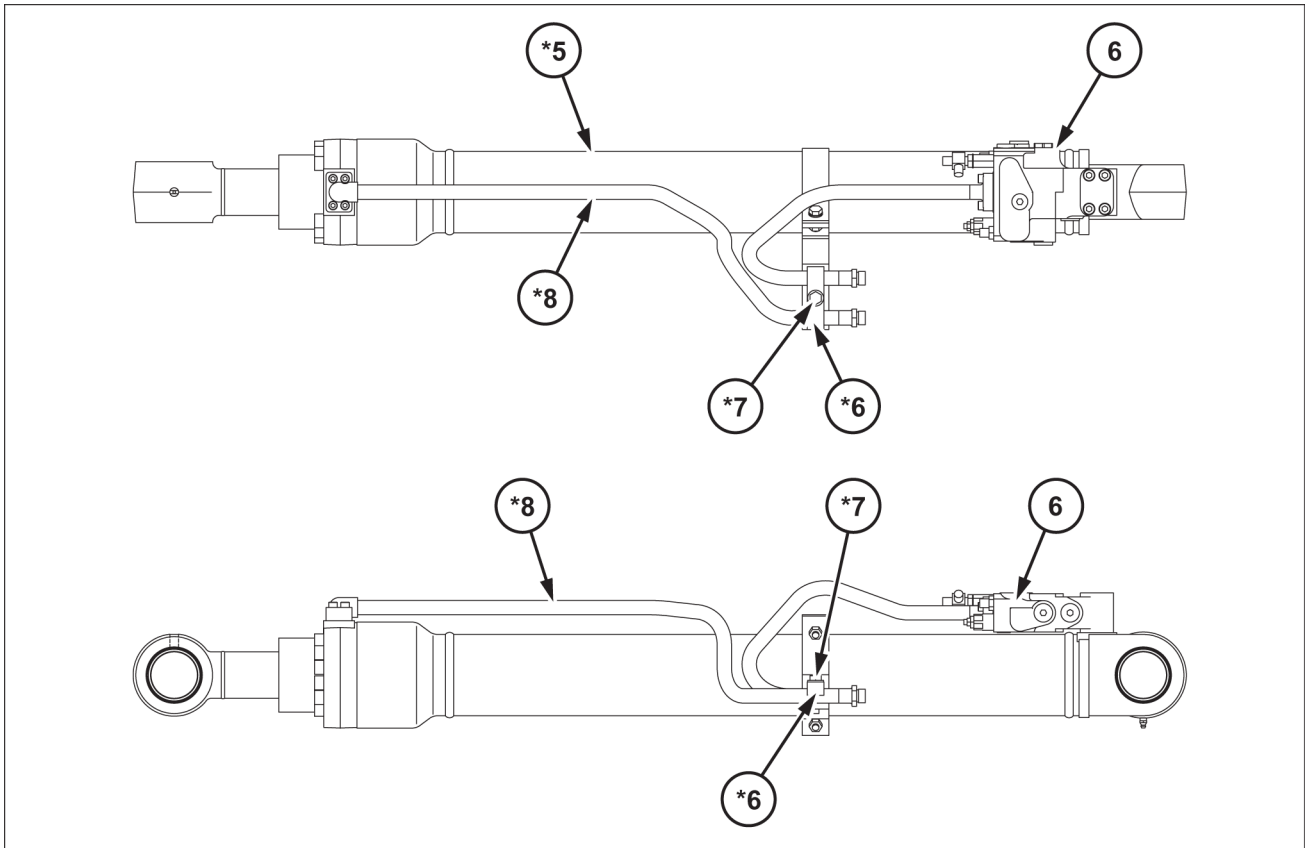

SMIL15CEX8764FB 4

1. Retire el perno (M10x1.5) (*7) y la abrazadera (*6). Coloque la junta tórica (9) en la válvula de retención (6) y, a continuación, instálela en el cilindro de la pluma (lado derecho) (*5) con cuatro pernos de cabeza hueca hexagonales (7).
 - Par de apriete: **41.6 - 60.8 N·m (30.683 - 44.844 lb ft)**

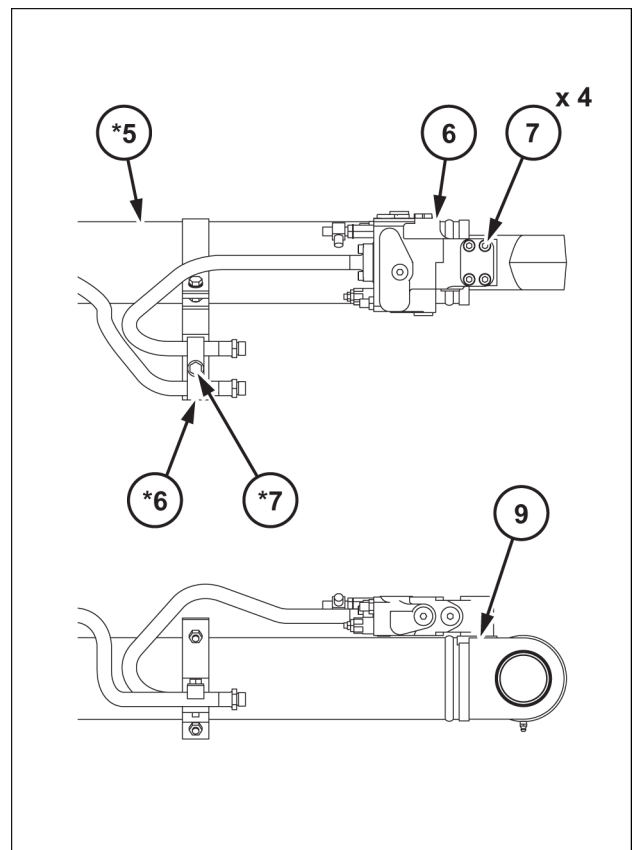

SMIL15CEX8765BB 5

Instalación del conducto piloto

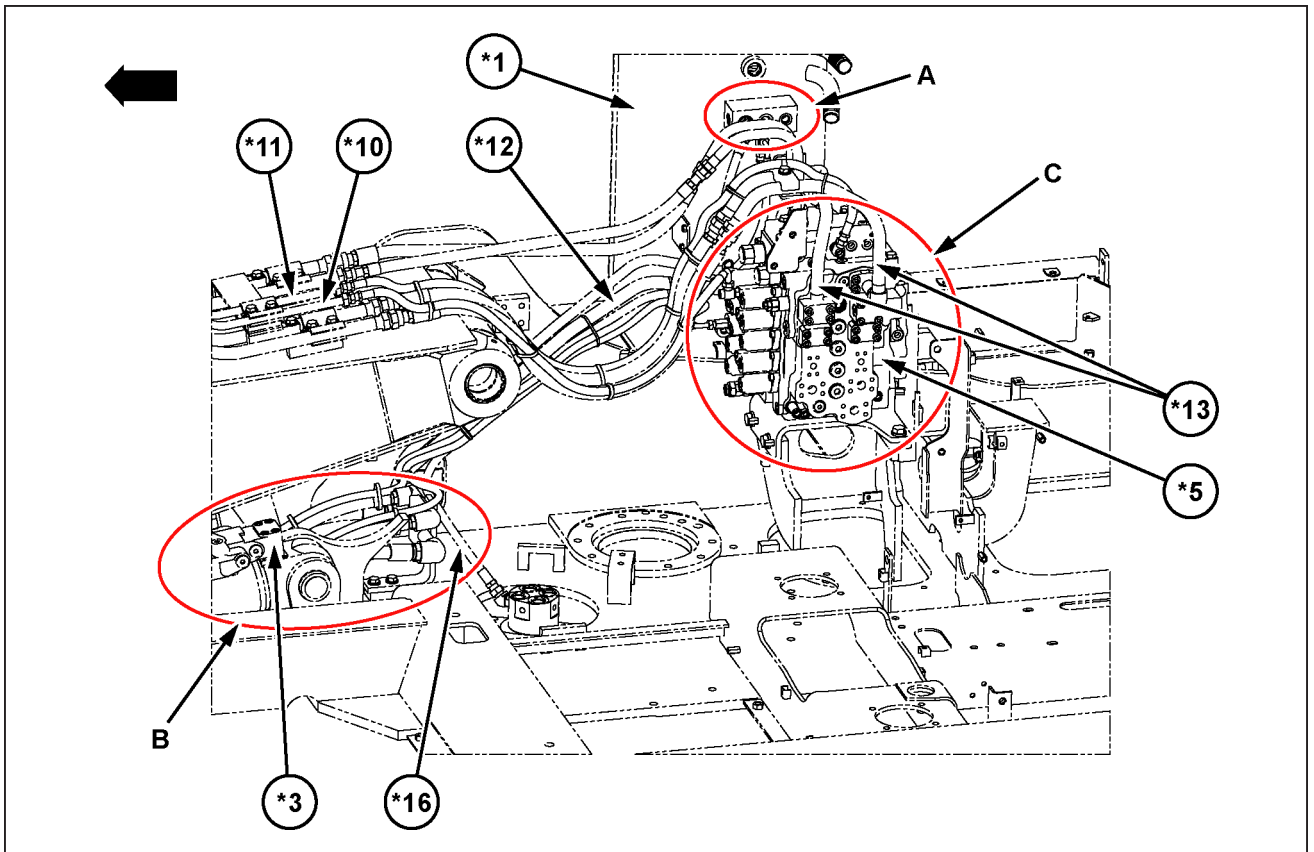

SMIL15CEXX822FB 1

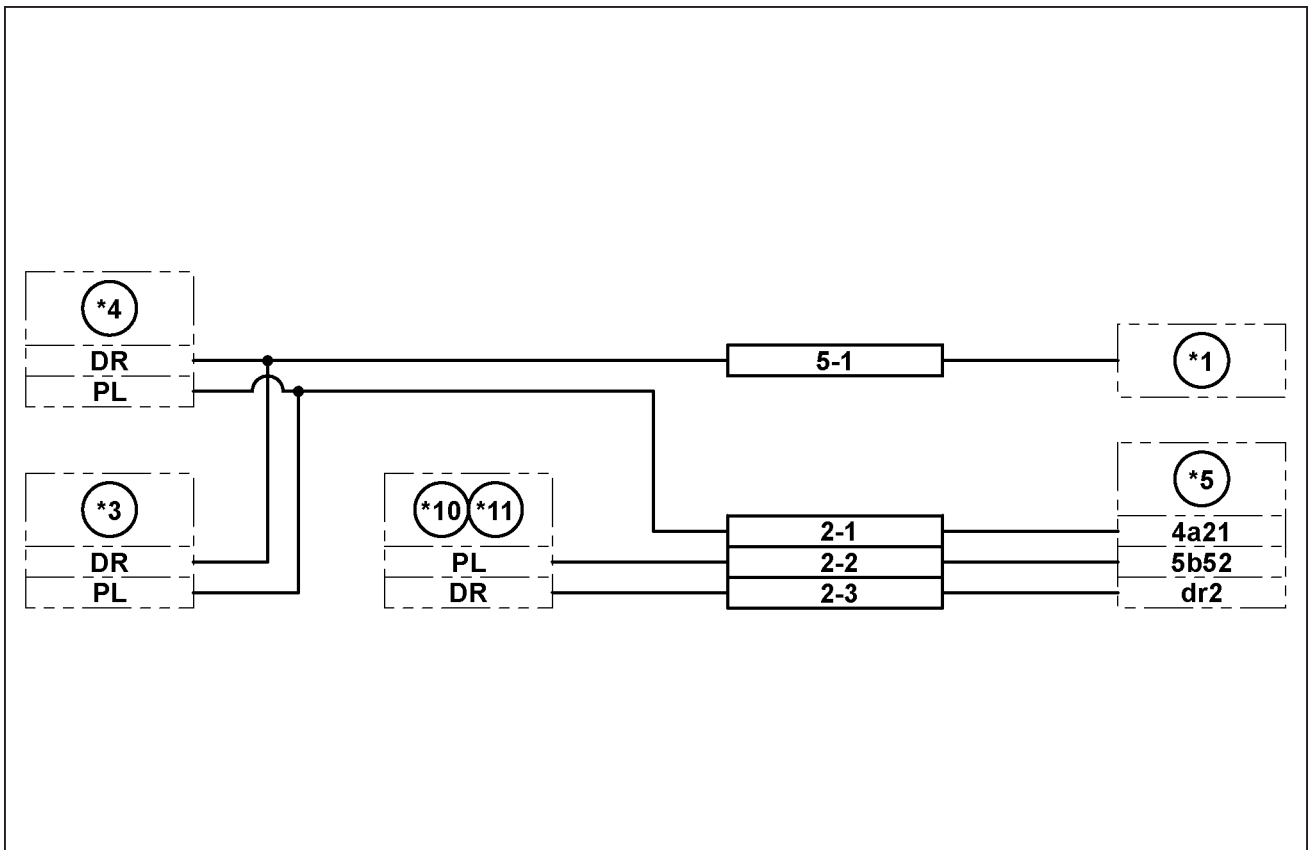

SMIL15CEXX823FB 2

CLICK HERE TO **DOWNLOAD** THE COMPLETE MANUAL

- Thank you very much for reading the preview of the manual.
- You can download the complete manual from: www.heydownloads.com by clicking the link below



- Please note: If there is no response to CLICKING the link, please download this PDF first and then click on it.

CLICK HERE TO **DOWNLOAD** THE COMPLETE MANUAL