



INSTALLATION INSTRUCTIONS

51587776

**HYDRAULIC SYSTEM FOR 4X1 BUCKET (FOR MACHINES WITH
MECHANICAL CONTROL, POWER SHUTTLE, AND GEAR PUMP)**

APPROXIMATE INSTALLATION TIME: 3.0 hours

CLICK HERE TO **DOWNLOAD** THE COMPLETE MANUAL

- Thank you very much for reading the preview of the manual.
- You can download the complete manual from: www.heydownloads.com by clicking the link below



- Please note: If there is no response to CLICKING the link, please download this PDF first and then click on it.

CLICK HERE TO **DOWNLOAD** THE COMPLETE MANUAL

36. Connect the bent end **(12A)** of the left-hand side tube **(12)** to the connector **(2)** on the three spool loader control valve **(1)** as shown.
37. Connect the bent end **(13A)** of the right-hand side tube **(13)** to the connector **(2)** on the three spool loader control valve **(1)** as shown.
38. Route the left-hand side tube **(10)** and the right-hand side tube **(13)** towards the loader attachment.

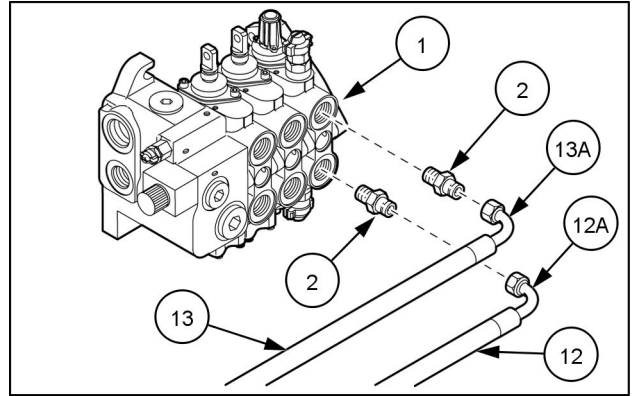

RAIL16TLB1424AA 12

39. Disconnect the hose **(H1)** from the fitting **(H2)**.
40. Install the tee fitting **(14)** onto the fitting **(H2)**.
41. Connect the straight end **(10B)** of the hose **(12)** to the tee fitting **(14)**.

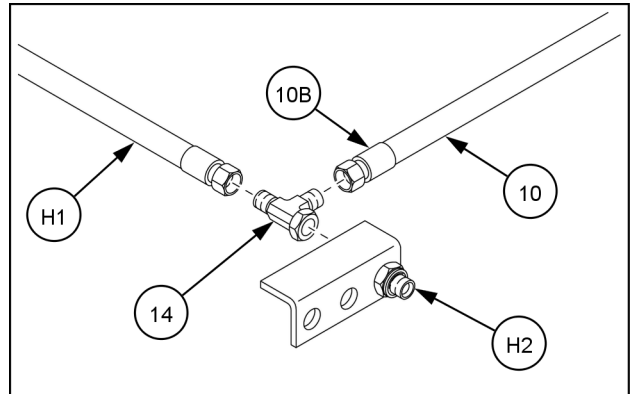

RAIL16TLB1458AA 13

42. Remove the existing plug **(K)** from the rear part on the oil tank **(J)**.
43. Install the adapter **(16)** into the port on the oil tank **(J)**.
44. Install the tee fitting **(15)** into the adapter **(16)**.
45. Connect the straight end **(11B)** of the hose **(11)** to the tee fitting **(15)**.

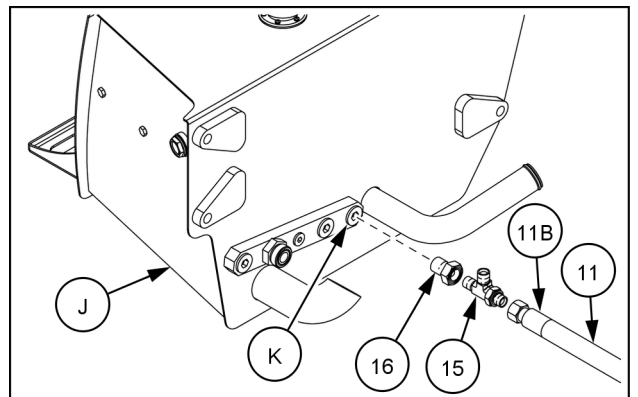

RAIL16TLB1459AA 14

46. Remove the screws **(L)**.
47. Retain the screws **(L)** for reuse.
48. Remove the joystick **(M)**.

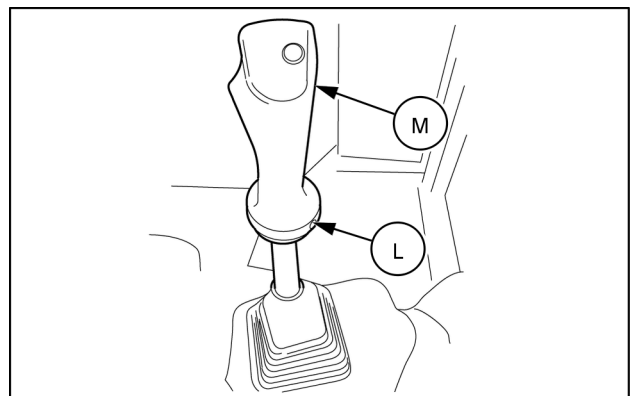

RAIL16TLB1427AA 15

2 - CONTENU DU KIT

Élément	Description	Quantité	Référence de pièce
10	Ensemble flexible	1	87316092
11	Ensemble flexible	1	87316096
12	Tube gauche 4 x 1	1	48002044
13	Tube droit 4 x 1	1	48002049
14	Raccord en T	1	201-422
15	Raccord en T, régl. 37FL 3/8 X 3/8 X 3/8	1	218-5243
16	Adaptateur, bossage	1	85826100
17	Autocollant, commandes du chargeur	1	47489566
18	Autocollant, commandes aux. du chargeur	1	47489698
19	Plaque	2	85805340
20	Bloc de serrage, hydraulique	2	87525943
21	Plaque	2	85805195
22	Rondelle Belleville, 8.4 x 22 x 1.5 mm	8	11193979
23	Vis M8 X 30	8	16043821
24	Tuyau, gauche, bras de chargeur 4 x 1	1	48001688
25	Fixation de tube, collier	6	84264121
26	Bouchon, à six pans	2	9847692
27	Tuyau, gauche, bras de chargeur 4 x 1	1	48001689
28	Réducteur, -8 m x -10 m ORFS (non illustré)	2	84989629

13. Instale la tercera válvula de control de corredera (**1A**) con los tirantes (**1B**).

NOTA: No mueva las válvulas para evitar daños en las juntas tóricas.

14. Instale la placa de cobertura (**F**) que desmontó anteriormente.
15. Fije la placa de cobertura (**F**) con las tuercas (**1C**).

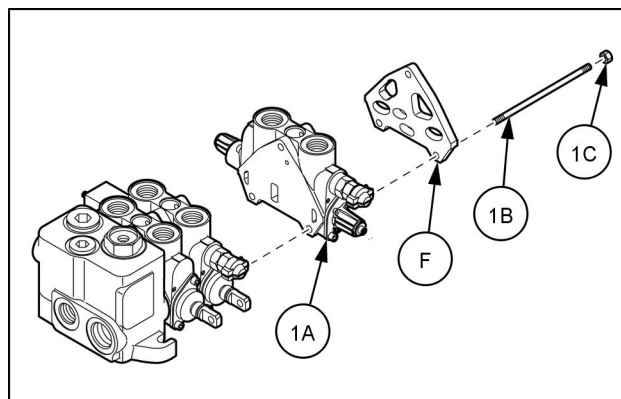

RAIL16TLB1418AA 4

16. Instale los conectores (**2**) en los puertos de la válvula de control del cargador de tres correderas (**1**) como se muestra.
17. Instale los racores acodados (**3**) en los puertos de la válvula de control del cargador de tres correderas (**1**) como se muestra.

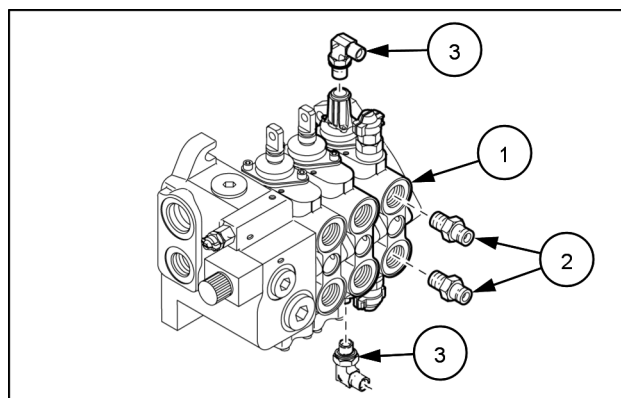

RAIL16CTL0002AA 5

18. Instale la válvula de control del cargador de tres correderas (**1**) en el soporte (**G**) utilizando los pernos (**D**) que retiró anteriormente.
19. Identifique y conecte los brazos de control (**C**) en la válvula de control del cargador de tres correderas (**1**).

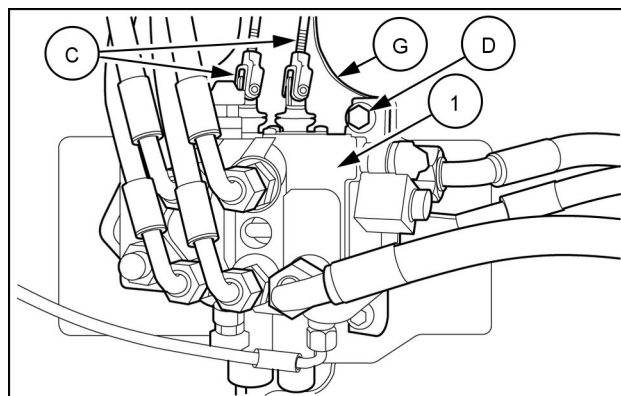

RAIL16TLB1421AA 6

20. Identifique y conecte las mangueras (**B2**) en sus puertos correspondientes de la válvula de control del cargador de tres correderas (**1**).
21. Identifique y conecte las mangueras (**B1**) en sus puertos correspondientes de la válvula de control del cargador de tres correderas (**1**).
22. Identifique y conecte las mangueras (**B4**) en sus puertos correspondientes de la válvula de control del cargador de tres correderas (**1**).
23. Identifique y conecte la manguera (**B3**) en su puerto correspondiente de la válvula de control del cargador de tres correderas (**1**).

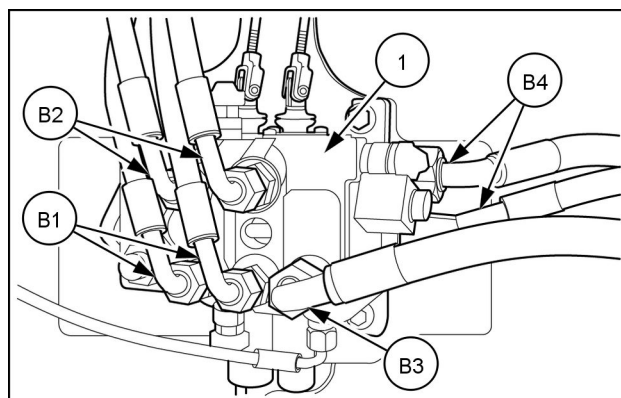

RAIL16TLB1421AA 7

1 - INFORMAZIONI DI SICUREZZA

Messaggi di sicurezza raggruppati

▲ AVVERTENZA

Pericolo di schiacciamento!

Non entrare o uscire dal posto di guida in caso di bracci del caricatore non supportati. Poggiare i bracci del caricatore a terra o innestare il dispositivo di supporto prima di entrare o uscire dal posto di guida.

La mancata osservanza di tali indicazioni potrebbe causare infortuni gravi o mortali.

W0306B

▲ AVVERTENZA

Pericolo di schiacciamento!

Prima di eseguire operazioni di manutenzione sotto la macchina, collocarla su una superficie piana, innestare il freno di stazionamento e spegnere il motore. Collocare dei blocchi davanti e dietro ai pneumatici.

La mancata osservanza di tali indicazioni potrebbe causare infortuni gravi o mortali.

W0350A

54. Collegare il tubo lato sinistro (24) al tubo lato sinistro (12).
55. Fissare il tubo lato sinistro (24) sul braccio del caricatore con il fermo (25), la rondella 8.4 x 22 x 1.5 mm (22) e il bullone M8 x 30 (23).
56. Montare il tappo (26) sul tubo lato sinistro (24).

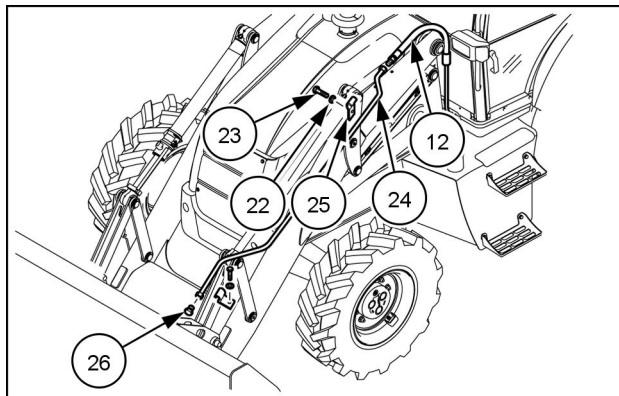

RAIL16TLB1432AA 20

57. Collegare il tubo lato destro (27) al tubo lato destro (13).
58. Fissare il tubo lato destro (27) sul braccio del caricatore con il fermo (25), la rondella 8.4 x 22 x 1.5 mm (22) e il bullone M8 x 30 (23).
59. Montare il tappo (26) sul tubo lato sinistro (27).

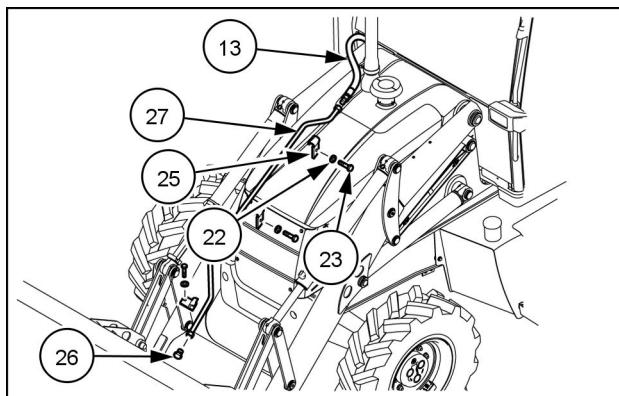

RAIL16TLB1431AA 21

AVVISO: conservare in un luogo sicuro il riduttore (28). Quando vengono montati i tubi flessibili della benna 4X1 (numero di parte 48005119), smontare il tappo (26) e montare il riduttore (28) tra i tubi flessibili della benna 4X1 e il tubo lato sinistro (24) e il tubo lato destro (27)

7. Trennen Sie die elektrische Anlage ab, indem Sie den Batterieauptschalter auf OFF (AUS) stellen.
8. Der Batterieauptschalter **(A)** befindet sich im Batteriefach.
Wenn der Batterieauptschalter in senkrechter Position steht, ist die elektrische Anlage verbunden. Wenn der Batterieauptschalter auf **45°** gekippt ist, ist die elektrische Anlage getrennt.

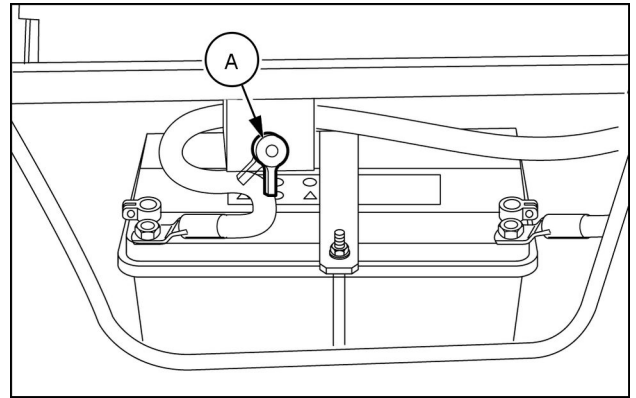

RAIL16TLB1021AA 3

9. Bei Maschinen mit mechanischer Steuerung bewegen Sie die Tieföffelstellhebel in alle Richtungen, um vorhandene Hydraulikkreislaufdrücke abzulassen.

Für Maschinen mit Vorsteuerung:

- A. Drehen Sie den Zündschlüssel in die Stellung „ON“ („EIN“), und drücken Sie den Vorsteuerungsschalter am Vorsteuerungsturm. Eine grüne Leuchte, die die Aktivierung des Vorsteuerungssystems anzeigt, muss aufleuchten und eingeschaltet bleiben.
- B. Bewegen Sie die Tieföffelsteuerhebel in alle Richtungen, um den Druck in allen Hydraulikkreisläufen abzubauen.
- C. Drehen Sie den Zündschalter in die Stellung „OFF“ („AUS“).

CLICK HERE TO **DOWNLOAD** THE COMPLETE MANUAL

- Thank you very much for reading the preview of the manual.
- You can download the complete manual from: www.heydownloads.com by clicking the link below



- Please note: If there is no response to CLICKING the link, please download this PDF first and then click on it.

CLICK HERE TO **DOWNLOAD** THE COMPLETE MANUAL